

LOCATION OF THE APPLICATION SITE

APPLICATION SITE AREA: 1,879m² (ABOUT)

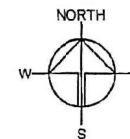

Sha Kong
Tsuen

DEEP BAY ROAD

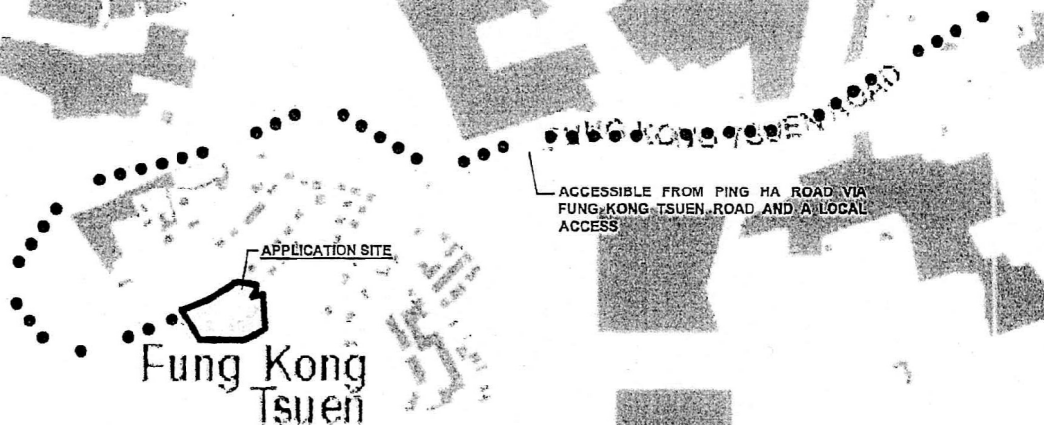

APPLICATION SITE

Fung Kong
Tsuen

ACCESSIBLE FROM PING HA ROAD VIA
FUNG KONG TSUEN ROAD AND A LOCAL
ACCESS

LEGEND



Drawing No. P01	Ver. 01
Project PROPOSED TEMPORARY WHOLESALE TRADE AND SHOP AND SERVICES FOR A PERIOD OF 5 YEARS	
LOT 108 SA (PART) AND VARIOUS LOTS IN D.D. 128, HA TSUEN, YUEN LONG, NEW TERRITORIES	
Drawing Title LOCATION PLAN	
Scale of A4 1:5000	
Drawn Date	10.8.2020
Revised Date	

(摘錄自申請人於 21.9.2020 呈交的申請書)
(Extract from Applicant's
Submission of 21.9.2020)

參考編號
REFERENCE No.
A/HSK/255

繪圖 DRAWING
A-1

DEVELOPMENT PARAMETERS

APPLICATION SITE AREA	: 1,679m ² (ABOUT)
COVERED AREA	: 241.6m ² (ABOUT)
UNCOVERED AREA	: 1,637.4m ² (ABOUT)
PLOT RATIO	: 0.16 (ABOUT)
SITE COVERAGE	: 13% (ABOUT)
NO. OF STRUCTURE	: 11
DOMESTIC GFA	: N/A
NON-DOMESTIC GFA	: 307.5m ² (ABOUT)
BUILDING HEIGHT	: 2.5m TO 6m (ABOUT)
NO. OF STOREY	: 1 TO 2

STRUCTURE	USE	COVERED AREA	GFA	BUILDING HEIGHT
B1	DISPLAY OF GOODS	COVERED BY B10	N/A	2.5m (ABOUT)(1-STOREY)
B2	DISPLAY OF GOODS	COVERED BY B10	N/A	2.5m (ABOUT)(1-STOREY)
B3	STORAGE OF GOODS	COVERED BY B10	N/A	2.5m (ABOUT)(1-STOREY)
B4	WHOLESALE TRADE	COVERED BY B10	20m ² (ABOUT)	2.5m (ABOUT)(1-STOREY)
B5	WHOLESALE TRADE (OFFICE)	COVERED BY B10	15.3m ² (ABOUT)	2.5m (ABOUT)(1-STOREY)(ABOVE B1)
B6	SHOP AND SERVICES (OFFICE)	COVERED BY B10	15.3m ² (ABOUT)	2.5m (ABOUT)(1-STOREY)(ABOVE B2)
B7	STORAGE OF GOODS	COVERED BY B10	15.3m ² (ABOUT)	2.5m (ABOUT)(1-STOREY)(ABOVE B3)
B8	ELEVATED PLATFORM	COVERED BY B10	N/A	2.6m (ABOUT)(1-STOREY)
B9	CANOPY (RAIN SHELTER)	13.6m ² (ABOUT)*	13.6m ² (ABOUT)	2.6m (ABOUT)
B10	CANOPY (RAIN SHELTER)	224m ² (ABOUT)	224m ² (ABOUT)	6m (ABOUT)
B11	CARETAKER OFFICE	4m ² (ABOUT)	4m ² (ABOUT)	2.5m (ABOUT)(1-STOREY)
TOTAL		241.6m ² (ABOUT)	307.5m ² (ABOUT)	

*PARTIALLY COVERED BY STRUCTURE B10, COVERED AREA OF B9 IS THE AREA NOT COVERED BY B10

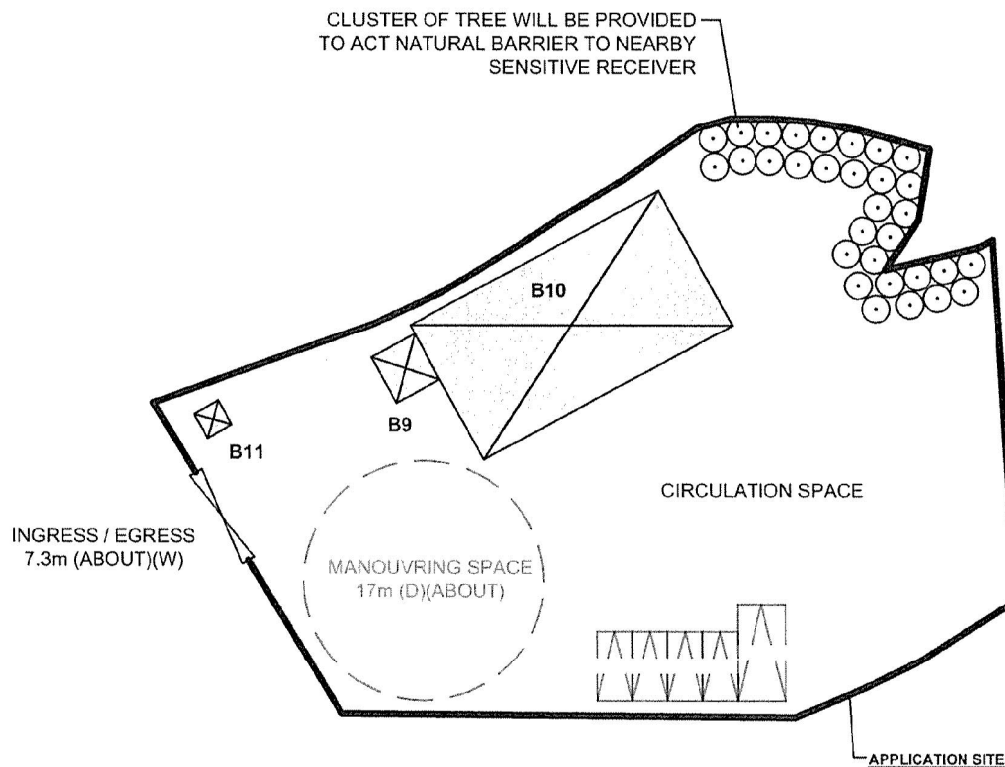

PARKING PROVISION

NO. OF PRIVATE CAR PARKING SPACE	: 4
DIMENSION OF PARKING SPACE	: 2.5m (W) X 5m (L)
NO. OF L/U/L SPACE FOR LGV	: 1
DIMENSION OF L/U/L SPACE	: 3.5m (W) X 7m (L)

LEGEND

	STRUCTURE
	PARKING / L/U/L SPACE
	INGRESS / EGRESS

Drawing No P04	Ver. 01
Project PROPOSED TEMPORARY WHOLESALE TRADE AND SHOP AND SERVICES FOR A PERIOD OF 5 YEARS LOT 108 S.A (PART) AND VARIOUS LOTS IN D.D. 128, HA TSUEN, YUEN LONG, NEW TERRITORIES	

Drawing Title LAYOUT PLAN	Scale of A4 1:500
Drawn Revised	Date 25.9.2020

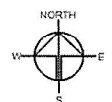

(摘錄自申請人於 25.9.2020 呈交的補充資料)
(Extract from Applicant's Supplementary
Information Submitted on 25.9.2020)

參考編號
REFERENCE No.
A/HSK/255

繪圖 DRAWING
A-2

DEVELOPMENT PARAMETERS

APPLICATION SITE AREA	: 1,879m ² (ABOUT)
COVERED AREA	: 241.6m ² (ABOUT)
UNCOVERED AREA	: 1,637.4m ² (ABOUT)
PLOT RATIO	: 0.16 (ABOUT)
SITE COVERAGE	: 13% (ABOUT)
NO. OF STRUCTURE	: 11
DOMESTIC GFA	: N/A
NON-DOMESTIC GFA	: 307.5m ² (ABOUT)
BUILDING HEIGHT	: 2.5m TO 6m (ABOUT)
NO. OF STOREY	: 1 TO 2

STRUCTURE	USE	COVERED AREA	GFA	BUILDING HEIGHT
B1	DISPLAY OF GOODS	COVERED BY B10	N/A	2.5m (ABOUT)(1-STOREY)
B2	DISPLAY OF GOODS	COVERED BY B10	N/A	2.5m (ABOUT)(1-STOREY)
B3	STORAGE OF GOODS	COVERED BY B10	N/A	2.5m (ABOUT)(1-STOREY)
B4	WHOLESALE TRADE	COVERED BY B10	20m ² (ABOUT)	2.5m (ABOUT)(1-STOREY)
B5	WHOLESALE TRADE (OFFICE)	COVERED BY B10	15.3m ² (ABOUT)	2.5m (ABOUT)(1-STOREY)(ABOVE B1)
B6	SHOP AND SERVICES (OFFICE)	COVERED BY B10	15.3m ² (ABOUT)	2.5m (ABOUT)(1-STOREY)(ABOVE B2)
B7	STORAGE OF GOODS	COVERED BY B10	15.3m ² (ABOUT)	2.5m (ABOUT)(1-STOREY)(ABOVE B3)
B8	ELEVATED PLATFORM	COVERED BY B10	N/A	2.6m (ABOUT)(1-STOREY)
B9	CANOPY (RAIN SHELTER)	13.6m ² (ABOUT)*	13.6m ² (ABOUT)	2.6m (ABOUT)
B10	CANOPY (RAIN SHELTER)	224m ² (ABOUT)	224m ² (ABOUT)	6m (ABOUT)
B11	CARETAKER OFFICE	4m ² (ABOUT)	4m ² (ABOUT)	2.5m (ABOUT)(1-STOREY)
TOTAL		241.6m ² (ABOUT)	307.5m ² (ABOUT)	

*PARTIALLY COVERED BY STRUCTURE B10, COVERED AREA OF B9 IS THE AREA NOT COVERED BY B10

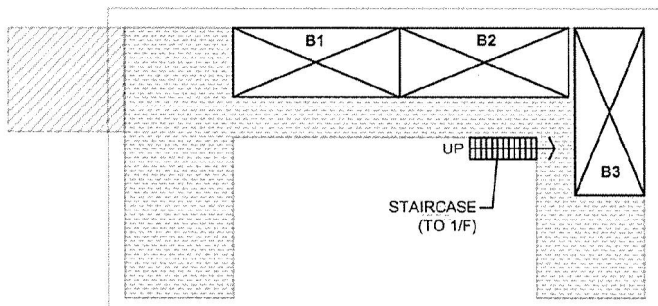

GROUND FLOOR
LAYOUT

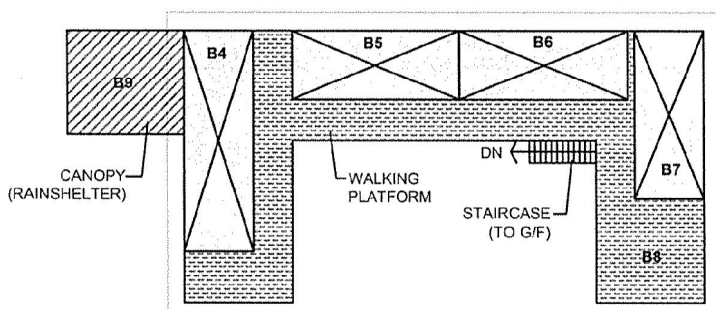

FIRST FLOOR
LAYOUT

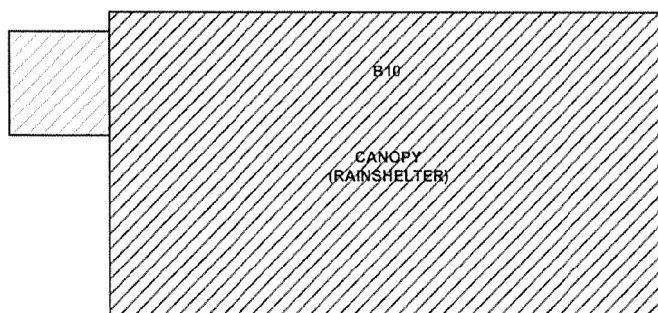

CANOPY
(COVERED AREA)

LEGEND

	STRUCTURE (ENCLOSED)
	CANOPY

Drawing No. P05
Project
PROPOSED TEMPORARY WHOLESALE TRADE AND SHOP AND SERVICES FOR A PERIOD OF 5 YEARS
LOT 106 S.A (PART) AND VARIOUS LOTS IN D.D. 128, HA TSUEN, YUEN LONG, NEW TERRITORIES

Drawing Title LAYOUT OF STRUCTURE	
Scale of A4 1:500	
Drawn	Date 25.9.2020
Revised	Date



(摘錄自申請人於 25.9.2020 呈交的補充資料)
(Extract from Applicant's Supplementary
Information Submitted on 25.9.2020)

參考編號
REFERENCE No.
A/HSK/255

繪圖 DRAWING
A-3

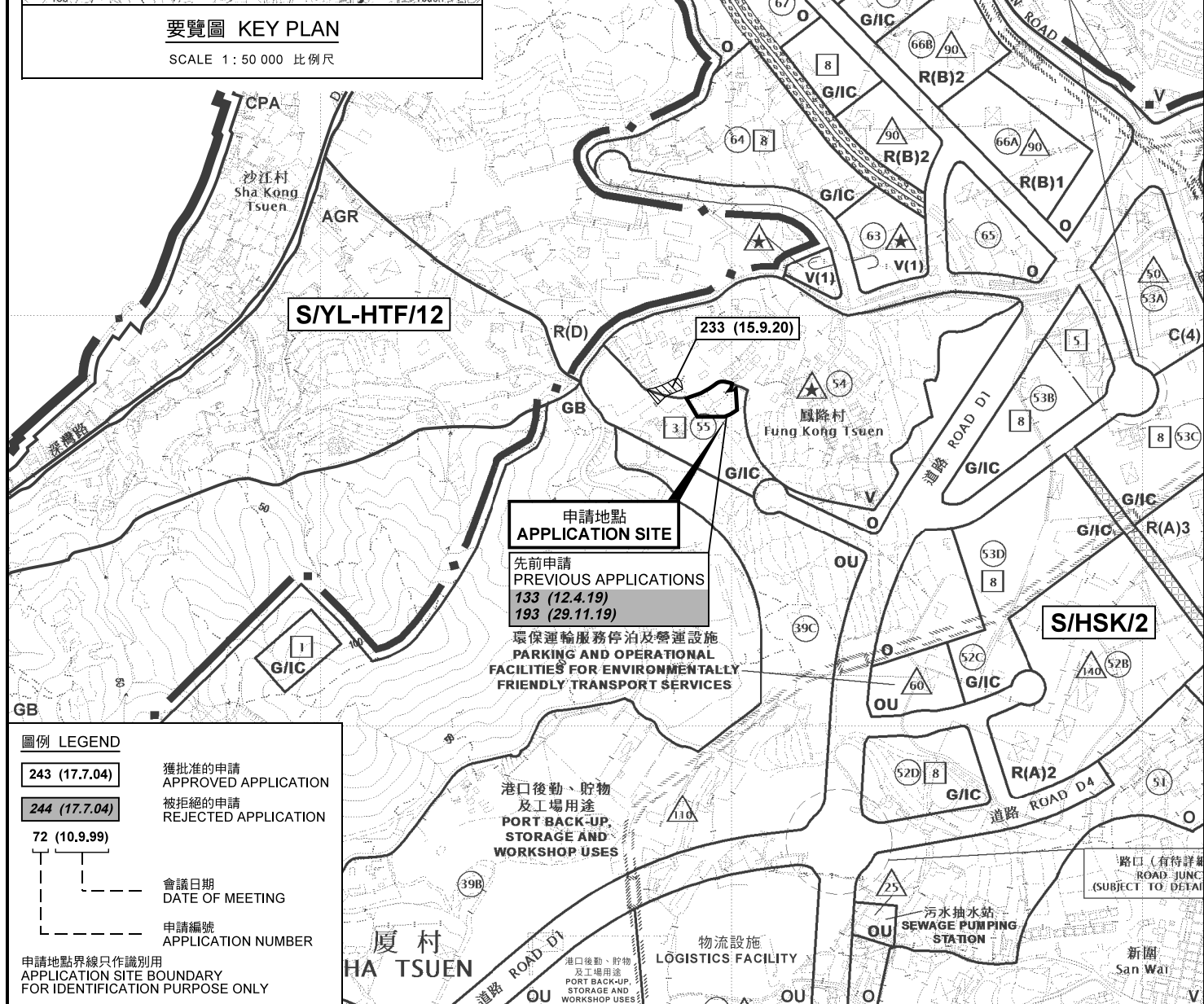
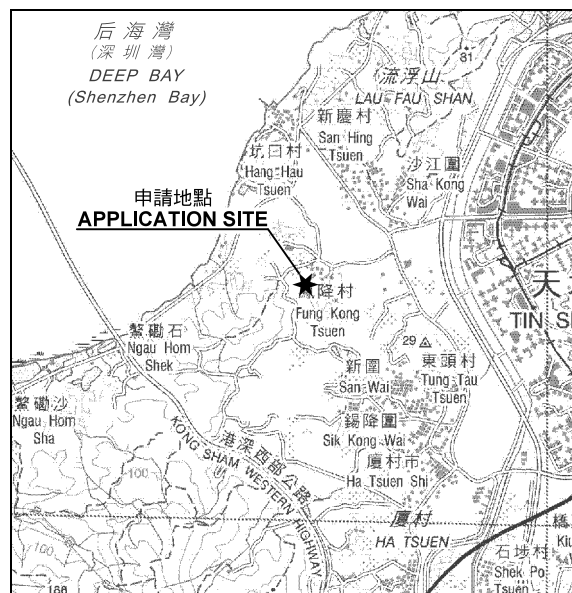

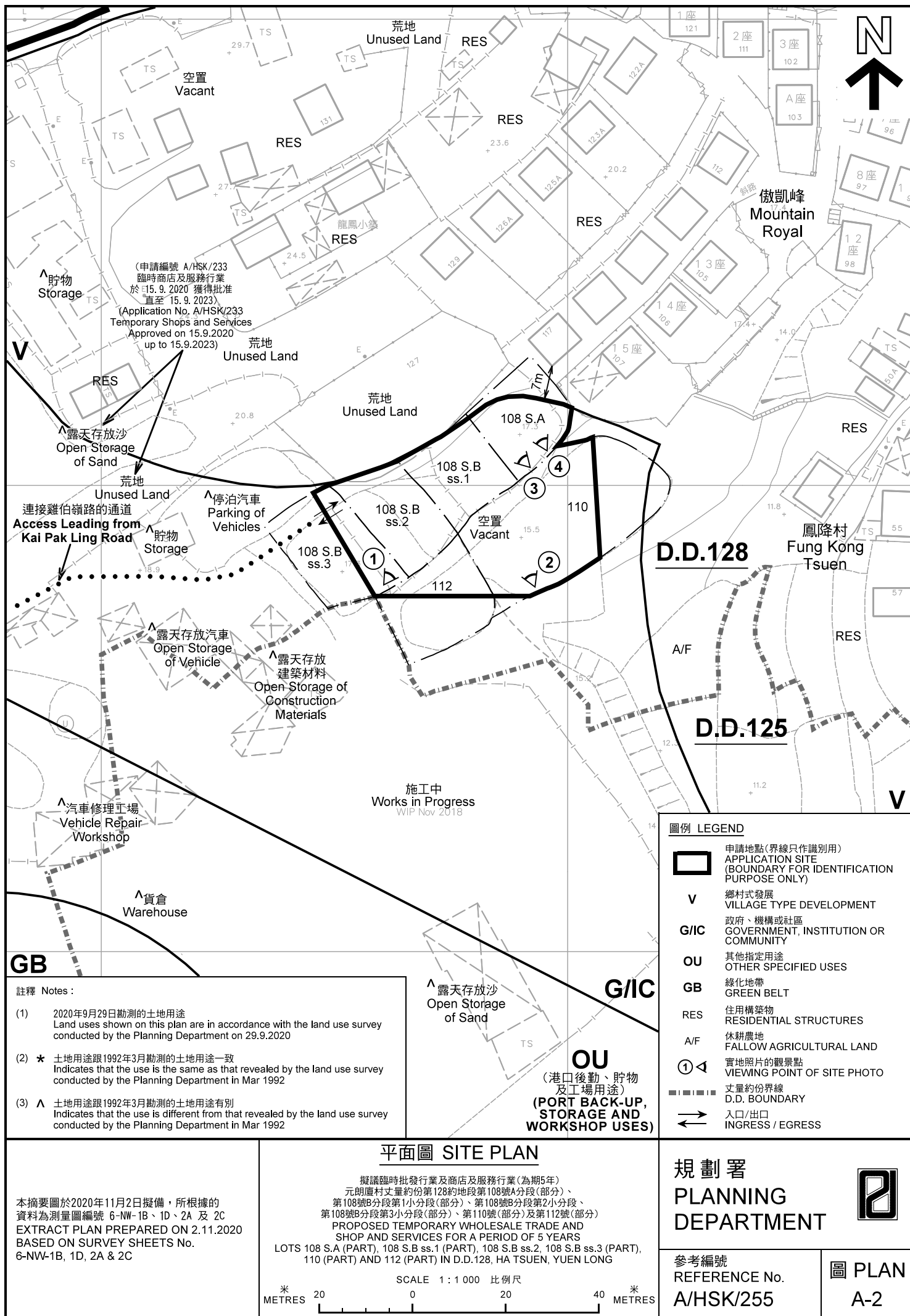



圖例 LEGEND



申請地點(界線只作識別用)
APPLICATION SITE
(BOUNDARY FOR IDENTIFICATION
PURPOSE ONLY)

本摘要圖於2020年10月28日擬備，所根據的資料為地政總署於2019年10月18日拍得的航攝照片編號 E072623C
EXTRACT PLAN PREPARED ON 28.10.2020
BASED ON AERIAL PHOTO No.
E072623C TAKEN ON 18.10.2019
BY LANDS DEPARTMENT

航攝照片 AERIAL PHOTO

擬議臨時批發行業及商店及服務行業(為期5年)
元朗唐村丈量約份第128約地段第108號A分段(部分)、
第108號B分段第1小分段(部分)、第108號B分段第2小分段、
第108號B分段第3小分段(部分)、第110號(部分)及第112號(部分)
PROPOSED TEMPORARY WHOLESALE TRADE AND
SHOP AND SERVICES FOR A PERIOD OF 5 YEARS
LOTS 108 S.A (PART), 108 S.B ss.1 (PART), 108 S.B ss.2, 108 S.B ss.3 (PART),
110 (PART) AND 112 (PART) IN D.D.128, HA TSUEN, YUEN LONG

規劃署
PLANNING
DEPARTMENT



參考編號
REFERENCE No.
A/HSK/255

圖 PLAN
A-3

1



申請地點
APPLICATION SITE

2



申請地點
APPLICATION SITE

實地照片 SITE PHOTOS

擬議臨時批發行業及商店及服務行業(為期5年)
元朗廈村丈量約份第128約地段第108號A分段(部分)、
第108號B分段第1小分段(部分)、第108號B分段第2小分段、
第108號B分段第3小分段(部分)、第110號(部分)及第112號(部分)
PROPOSED TEMPORARY WHOLESALE TRADE AND
SHOP AND SERVICES FOR A PERIOD OF 5 YEARS
LOTS 108 S.A (PART), 108 S.B ss.1 (PART), 108 S.B ss.2, 108 S.B ss.3 (PART),
110 (PART) AND 112 (PART) IN D.D.128, HA TSUEN, YUEN LONG

規劃署
PLANNING
DEPARTMENT



參考編號
REFERENCE No.
A/HSK/255

圖 PLAN
A-4a

本圖於2020年11月2日擬備，所根據的
資料為攝於2020年9月29日的實地照片
PLAN PREPARED ON 2.11.2020
BASED ON SITE PHOTOS TAKEN
ON 29.9.2020

3



申請地點
APPLICATION SITE

4



申請地點
APPLICATION SITE

申請地點界線只作識別用 APPLICATION SITE BOUNDARY FOR IDENTIFICATION PURPOSE ONLY

實地照片 SITE PHOTOS

擬議臨時批發行業及商店及服務行業(為期5年)
元朗唐村丈量約份第128約地段第108號A分段(部分)、
第108號B分段第1小分段(部分)、第108號B分段第2小分段、
第108號B分段第3小分段(部分)、第110號(部分)及第112號(部分)
PROPOSED TEMPORARY WHOLESALE TRADE AND
SHOP AND SERVICES FOR A PERIOD OF 5 YEARS
LOTS 108 S.A (PART), 108 S.B ss.1 (PART), 108 S.B ss.2, 108 S.B ss.3 (PART),
110 (PART) AND 112 (PART) IN D.D.128, HA TSUEN, YUEN LONG

規劃署
PLANNING
DEPARTMENT



參考編號
REFERENCE No.
A/HSK/255

圖 PLAN
A-4b

本圖於2020年11月2日擬備，所根據的
資料為攝於2020年9月29日的實地照片
PLAN PREPARED ON 2.11.2020
BASED ON SITE PHOTOS TAKEN
ON 29.9.2020