

Total Site Area: 1,547m²
 Covered Area: 210m²
 Uncovered Area: 1337
 No. of Structures: 6

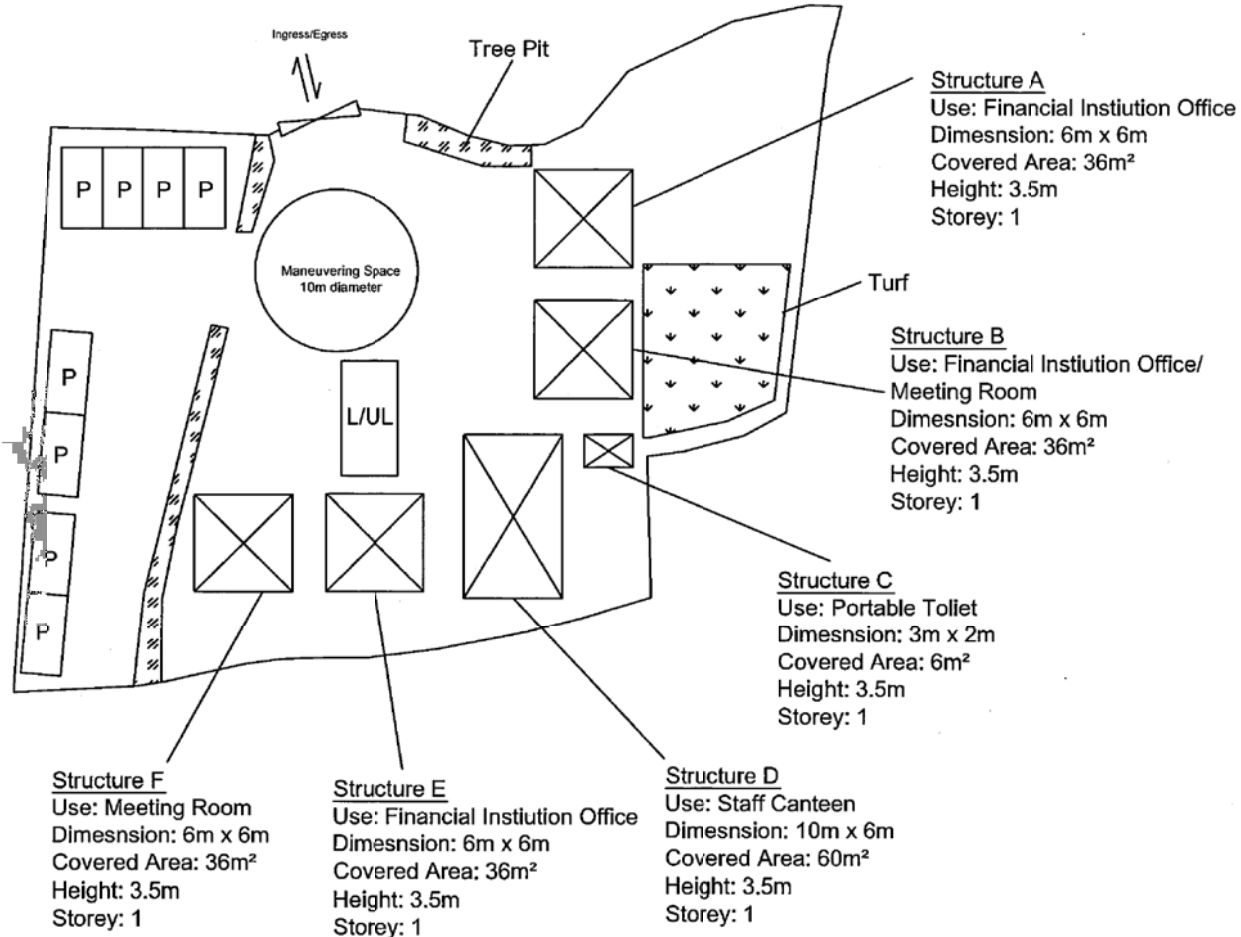

District: San Tam Road
 Sheet no: 6-NE-6B
 OZP: OU (Railway Reserve)

Lot 4122, 4123, 4124,
 4125(Part) and adjoining
 Gov Land in DD104, San
 Tam Road

Proposed Temporary Shop and Services
 (Financial Institution) with Ancillary Staff
 Canteen for a Period of 3 Years

Title:
Layout Plan

Scale:
1 : 400

(摘錄自申請人於 12.2.2018 呈交的申請書)
 (Extract from Applicant's
 Submission of 12.2.2018)

參考編號 REFERENCE No. A/YL-KTN/592	繪圖 DRAWING A-1
---------------------------------------	-------------------

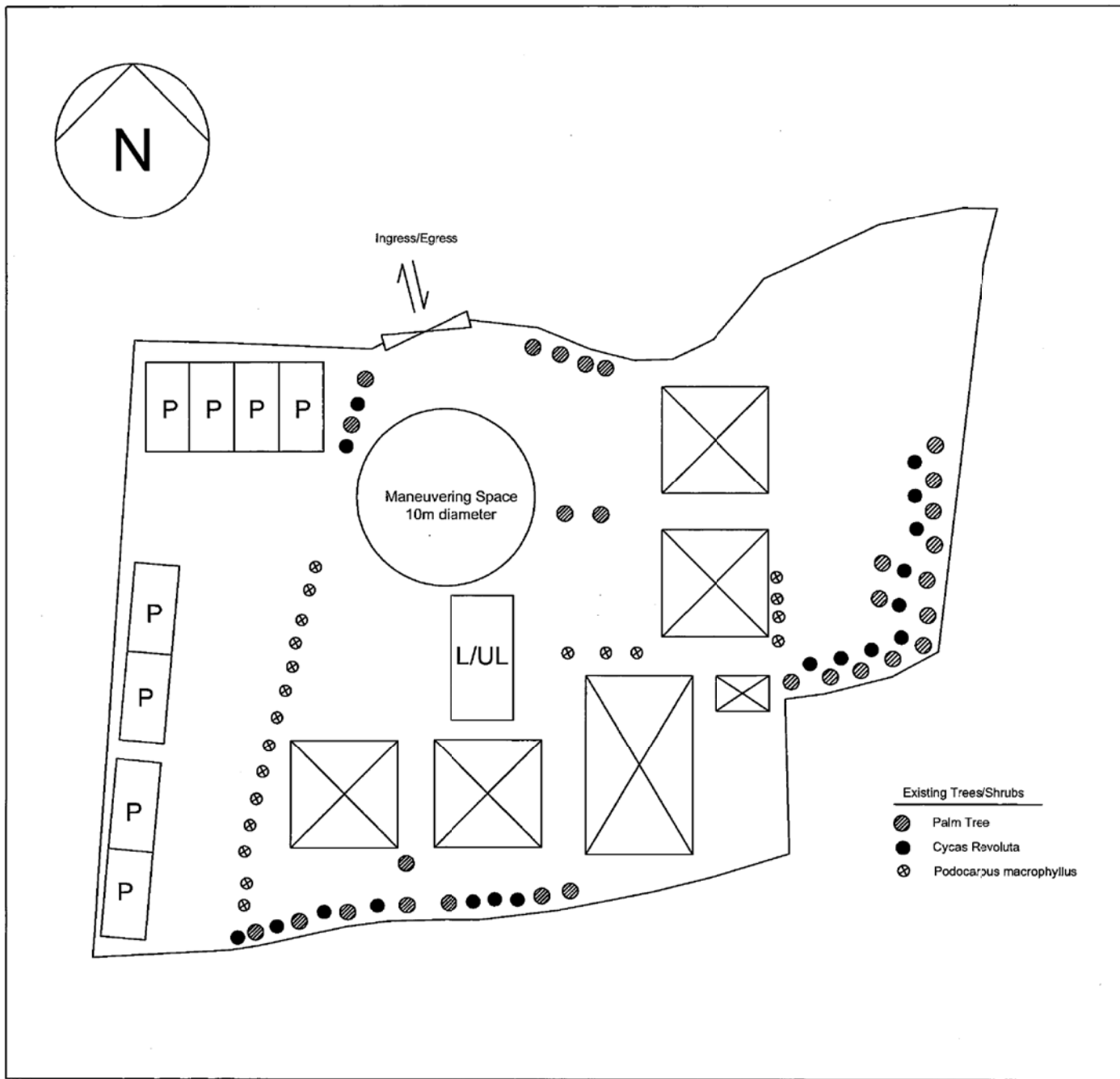

District : San Tam Road
 Sheet no : 6-NE-6B
 OZP : OU (Railway Reserve)

**Lot 4122, 4123, 4124,
 4125(Part) and adjoining
 Gov Land in DD104, San
 Tam Road**

Proposed Temporary Shop and Services
 (Financial Institution) with Ancillary Staff
 Canteen for a Period of 3 Years

Title:
Landscape Proposal

Scale:
~~1 : 400~~

(摘錄自申請人於 12. 2. 2018 呈交的申請書)
 (Extract from Applicant's
 Submission of 12.2.2018)

參考編號 REFERENCE No. A/YL-KTN/592	繪圖 DRAWING A-2
---------------------------------------	-------------------

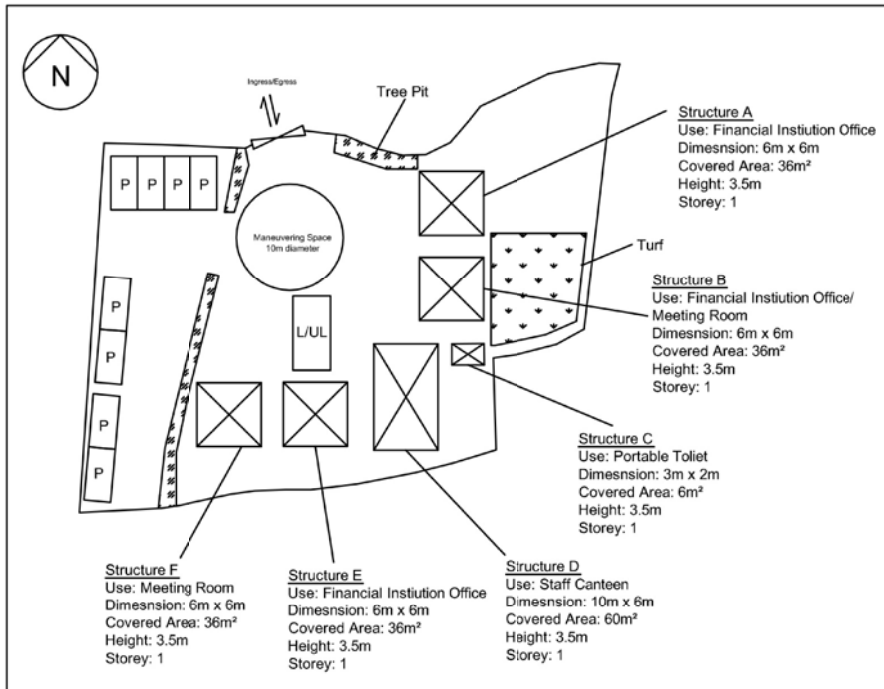

FS NOTE:

1. Sufficient emergency lighting shall be provided throughout the entire building in accordance with BS5266: Part1 and BS EN1838
2. Sufficient directional and exit sign shall be provided in accordance with BS5266: Part 1 and FSD Circular Letter 5/2008.

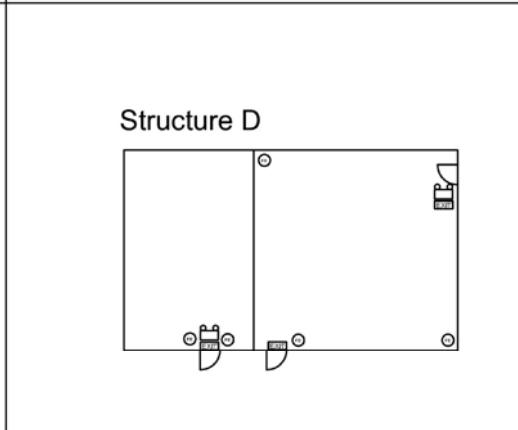
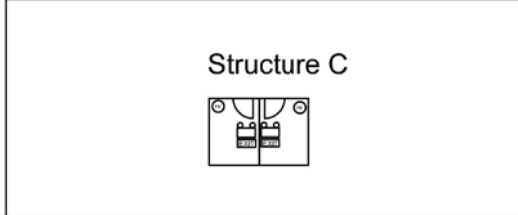
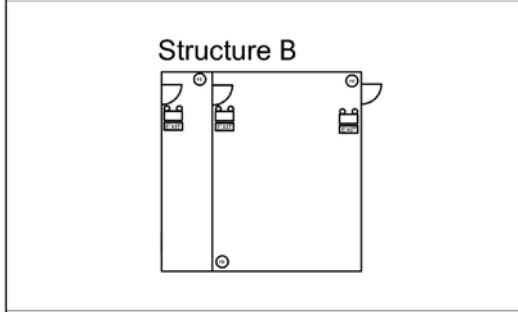
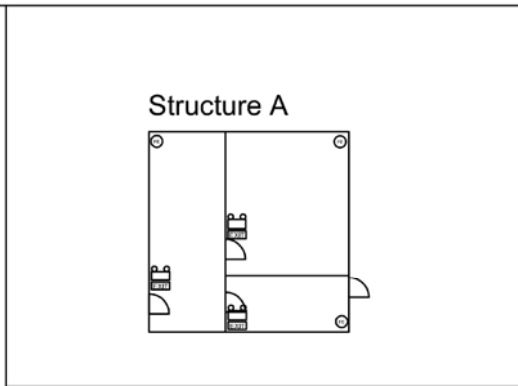
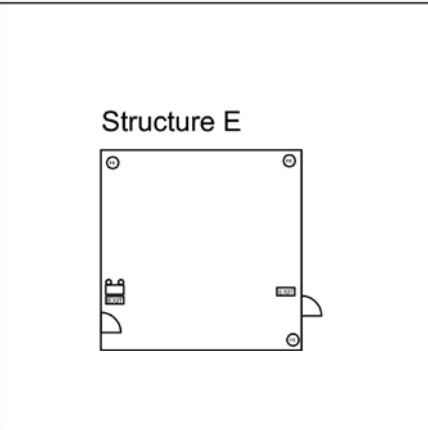
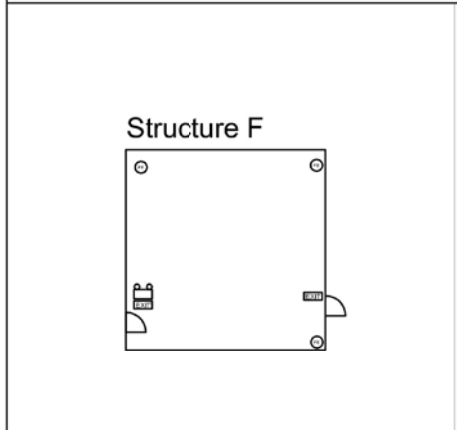

District : San Tam Road
Sheet no : 6-NE-6B
OZP : OU (Railway Reserve)/CA

Lot 4122 - 4125 and adjoining Gov Land in DD104, San Tam Road

Proposed Temporary Shop and Services (Financial Institution) with Ancillary Staff Canteen for a Period of 3 Years

Title: **FSI Proposal**

Scale: **Not to Scale**

Legend:

- EXIT Exit Sign
- Emergency Light
- 4.5kg CO2 Gas Type Fire Extinguisher

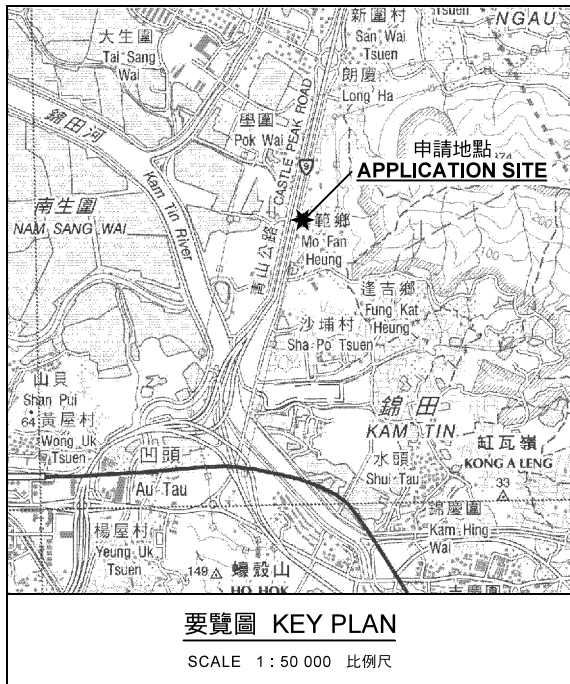
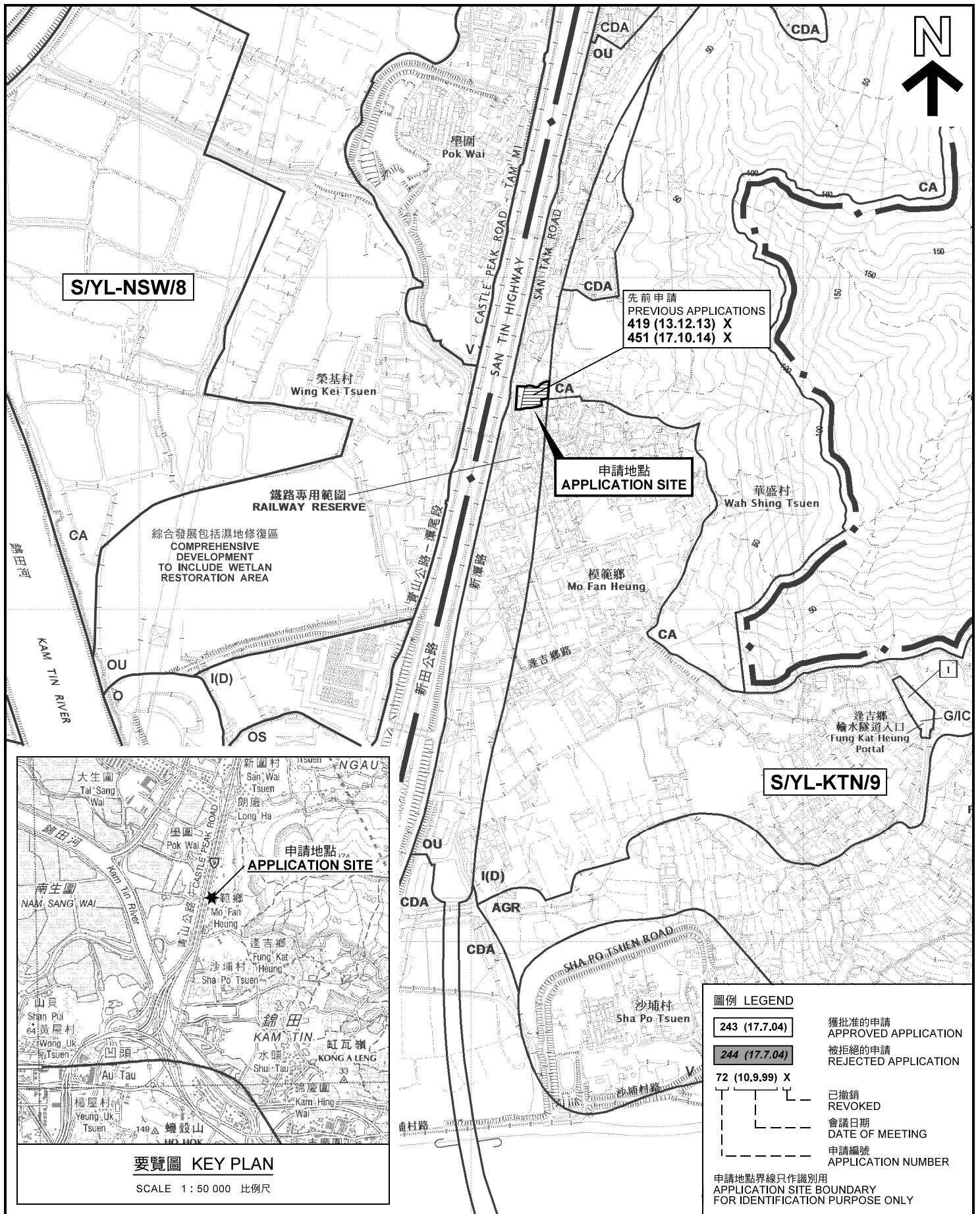

位置圖 LOCATION PLAN

臨時商店及服務行業(財務公司)連附屬員工食堂(為期3年)
元朗錦田新潭路丈量約份第104約地段第4122號、第4123號、
第4124號及第4125號(部分)和毗連政府土地
TEMPORARY SHOP AND SERVICES (FINANCIAL INSTITUTION)
WITH ANCILLARY STAFF CANTEEN FOR A PERIOD OF 3 YEARS
LOTS 4122, 4123, 4124 AND 4125 (PART) IN D.D. 104 AND
ADJOINING GOVERNMENT LAND, SAN TAM ROAD,
KAM TIN, YUEN LONG
SCALE 1 : 7 500 比例尺

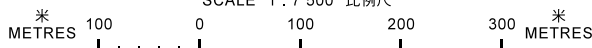

圖例 LEGEND

- 243 (17.7.04) 獲批准的申請
APPROVED APPLICATION
- 244 (17.7.04) 被拒絕的申請
REJECTED APPLICATION
- 72 (10.9.99) X 已撤銷
REVOKED
- - - 會議日期
DATE OF MEETING
- - - 申請編號
APPLICATION NUMBER

申請地點界線只作識別用
APPLICATION SITE BOUNDARY
FOR IDENTIFICATION PURPOSE ONLY

**規劃署
PLANNING
DEPARTMENT**



參考編號
REFERENCE No.
A/YL-KTN/592

圖 PLAN
A-1

本摘要圖於2018年3月15日擬備，
所根據的資料為於2014年12月2日
核准的分區計劃大綱圖編號 S/YL-KTN/9
EXTRACT PLAN PREPARED ON 15.3.2018
BASED ON OUTLINE ZONING PLAN No.
S/YL-KTN/9 APPROVED ON 2.12.2014

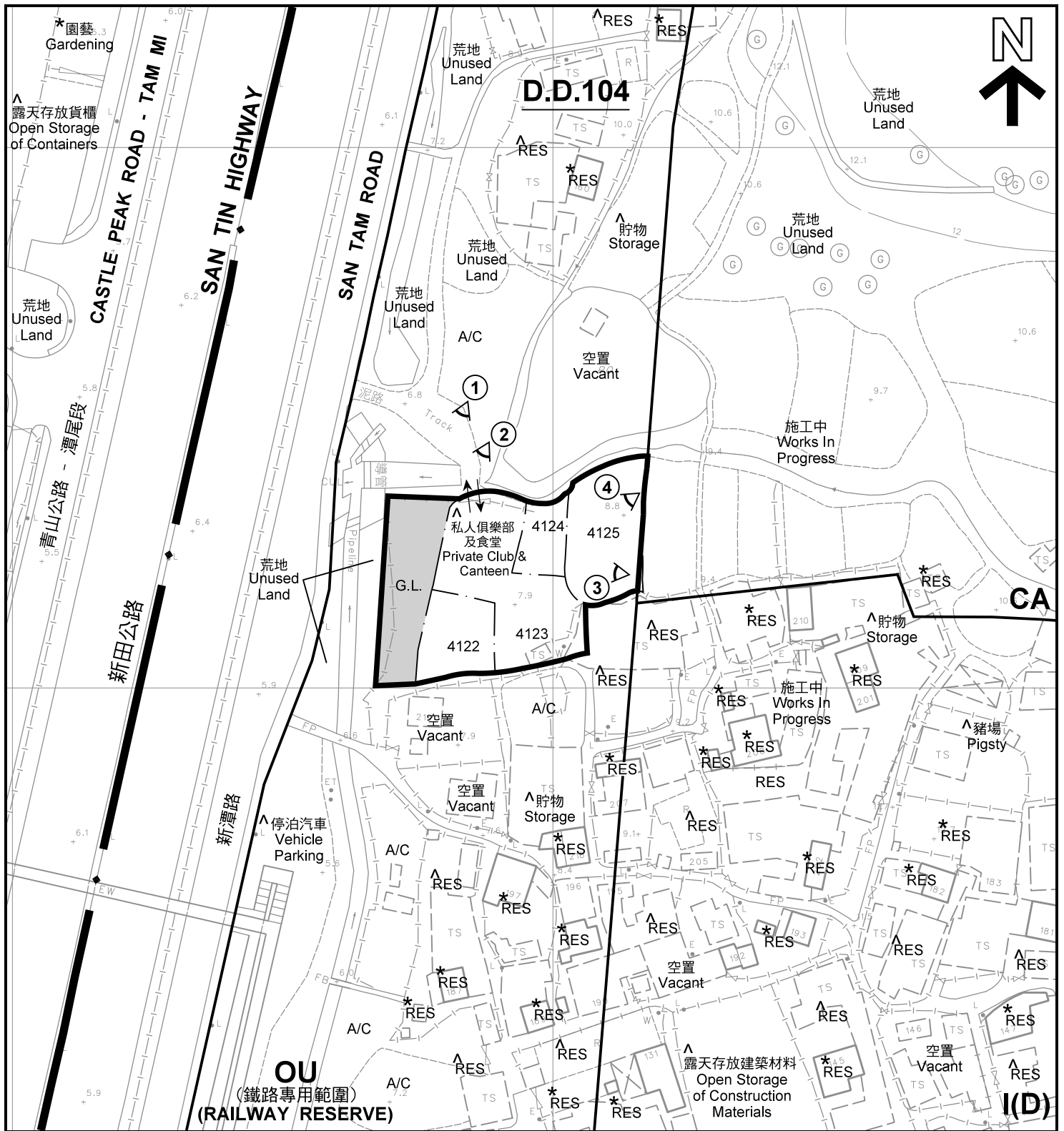

註釋 Notes :

- (1) 2018年2月20日勘測的土地用途
Land uses shown on this plan are in accordance with the land use survey conducted by the Planning Department on 20.2.2018
- (2) * 土地用途跟1992年2月勘測的土地用途一致
Indicates that the use is the same as that revealed by the land use survey conducted by the Planning Department in Feb 1992
- (3) ^ 土地用途跟1992年2月勘測的土地用途有別
Indicates that the use is different from that revealed by the land use survey conducted by the Planning Department in Feb 1992

圖例 LEGEND

- 申請地點(界線只作識別用)
APPLICATION SITE
(BOUNDARY FOR IDENTIFICATION PURPOSE ONLY)
- I(D) 工業(丁類)
INDUSTRIAL (GROUP D)
- OU 其他指定用途
OTHER SPECIFIED USES
- CA 自然保育區
CONSERVATION AREA
- G.L. 政府土地
GOVERNMENT LAND
- RES 住用構築物
RESIDENTIAL STRUCTURES
- A/C 常耕農地
CULTIVATED AGRICULTURAL LAND
- ① 實地照片的觀景點
VIEWING POINT OF SITE PHOTO
- 入口/出口
INGRESS / EGRESS

平面圖 SITE PLAN

臨時商店及服務行業(財務公司)連附屬員工食堂(為期3年)
元朗錦田新潭路丈量約份第104約地段第4122號、第4123號、
第4124號及第4125號(部分)和毗連政府土地
TEMPORARY SHOP AND SERVICES (FINANCIAL INSTITUTION)
WITH ANCILLARY STAFF CANTEEN FOR A PERIOD OF 3 YEARS
LOTS 4122, 4123, 4124 AND 4125 (PART) IN D.D. 104 AND
ADJOINING GOVERNMENT LAND, SAN TAM ROAD,
KAM TIN, YUEN LONG
SCALE 1 : 1 000 比例尺

米 METRES 20 0 20 40 米 METRES

規劃署
PLANNING
DEPARTMENT



參考編號
REFERENCE No.
AYL-KTN/592

圖 PLAN
A-2

本摘要圖於2018年3月15日擬備, 所根據的
資料為測量圖編號 6-NE-1B
EXTRACT PLAN PREPARED ON 15.3.2018
BASED ON SURVEY SHEET No.
6-NE-1B

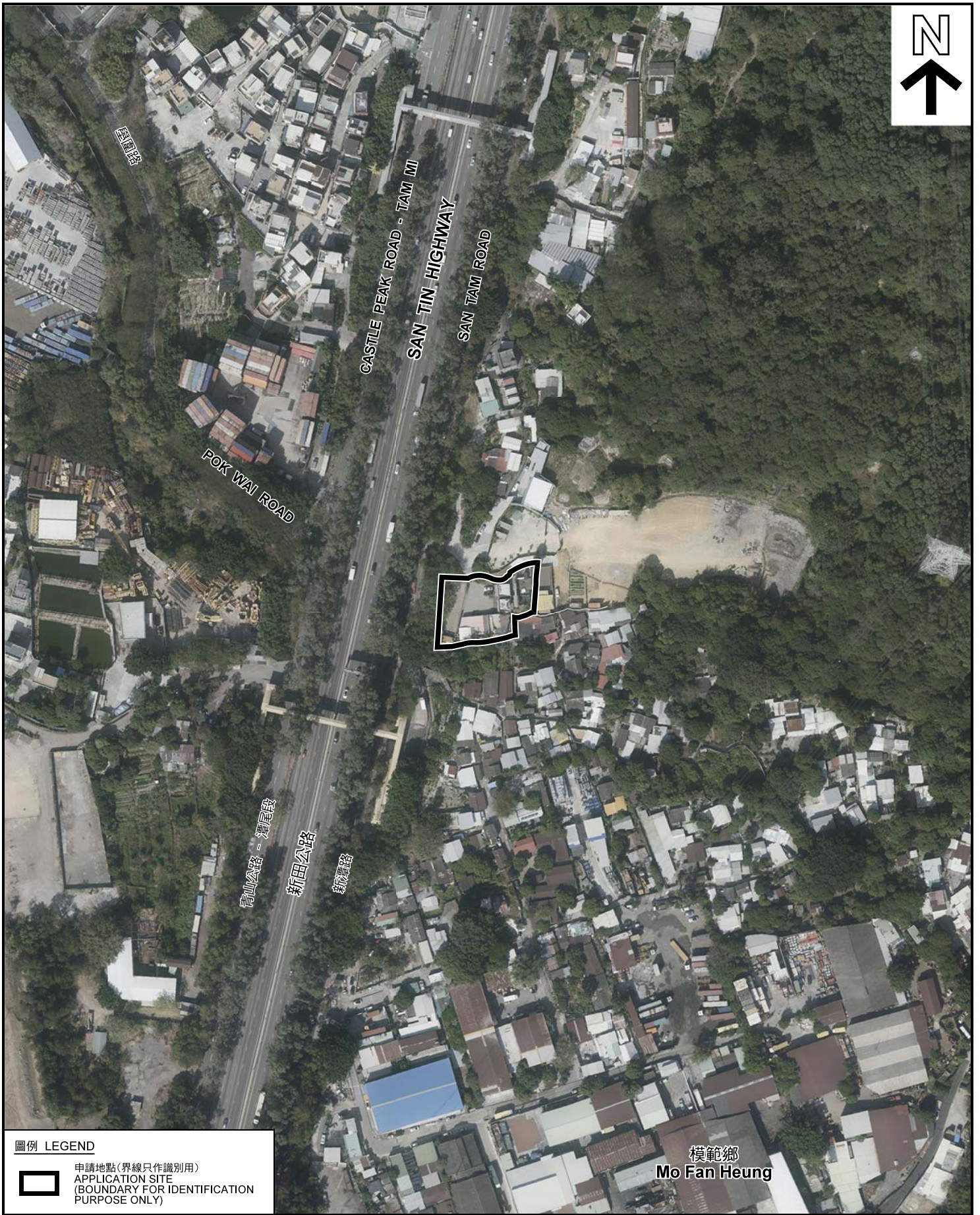

圖例 LEGEND



申請地點(界線只作識別用)
APPLICATION SITE
(BOUNDARY FOR IDENTIFICATION
PURPOSE ONLY)

本摘要圖於2018年3月15日擬備，所根據的資料為地政總署於2018年1月3日拍得的航攝照片編號 E033592C
EXTRACT PLAN PREPARED ON 15.3.2018
BASED ON AERIAL PHOTO No.
3.1.2018 TAKEN ON E033592C
BY LANDS DEPARTMENT

航攝照片 AERIAL PHOTO

臨時商店及服務行業(財務公司)連附屬員工食堂(為期3年)
元朗錦田新潭路丈量約份第104約地段第4122號、第4123號、
第4124號及第4125號(部分)和毗連政府土地
TEMPORARY SHOP AND SERVICES (FINANCIAL INSTITUTION)
WITH ANCILLARY STAFF CANTEEN FOR A PERIOD OF 3 YEARS
LOTS 4122, 4123, 4124 AND 4125 (PART) IN D.D. 104 AND
ADJOINING GOVERNMENT LAND, SAN TAM ROAD,
KAM TIN, YUEN LONG

模範鄉
Mo Fan Heung

規劃署
PLANNING
DEPARTMENT



參考編號
REFERENCE No.
A/YL-KTN/592

圖 PLAN
A-3

1



2



3



4



實地照片 SITE PHOTOS

本圖於2018年3月15日擬備，所根據的資料為攝於2018年2月23日的實地照片
PLAN PREPARED ON 15.3.2018
BASED ON SITE PHOTOS
TAKEN ON 23.2.2018

臨時商店及服務行業(財務公司)連附屬員工食堂(為期3年)
元朗錦田新潭路丈量約份第104約地段第4122號、第4123號、
第4124號及第4125號(部分)和毗連政府土地
TEMPORARY SHOP AND SERVICES (FINANCIAL INSTITUTION)
WITH ANCILLARY STAFF CANTEEN FOR A PERIOD OF 3 YEARS
LOTS 4122, 4123, 4124 AND 4125 (PART) IN D.D. 104 AND
ADJOINING GOVERNMENT LAND, SAN TAM ROAD,
KAM TIN, YUEN LONG

規劃署
PLANNING
DEPARTMENT



參考編號
REFERENCE No.
A/YL-KTN/592

圖 PLAN
A-4