

BMI APPRAISALS

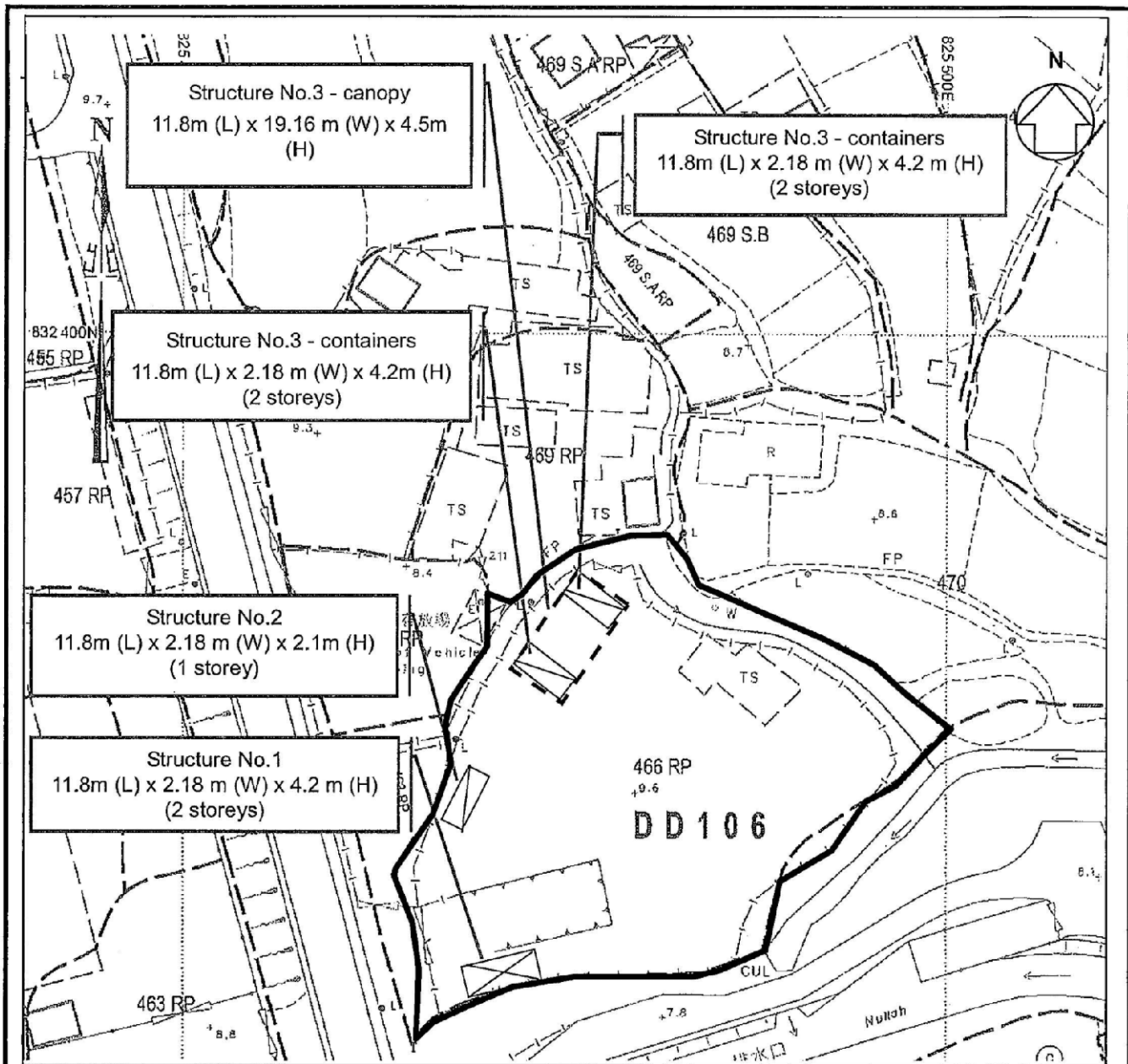

Legends	
	Site Boundary
	Site Office
	Storage for Vehicle Parts
	Canopy

Not to Scale (For Identification Purposes Only)	Site Plan Lot No. 466RP in DD 106 and Adjoining Government Land, Kam Sheung Road, Kam Tin, Yuen Long, New Territories, Hong Kong	APPENDIX B
	BMI APPRAISALS	

(摘錄自申請人於 27.8.2018 呈交的申請書)
 (Extract from Applicant's
 Submission of 27.8.2018)

參考編號 REFERENCE No. A/YL-KTS/798	繪圖 DRAWING A-1
--	--------------------------

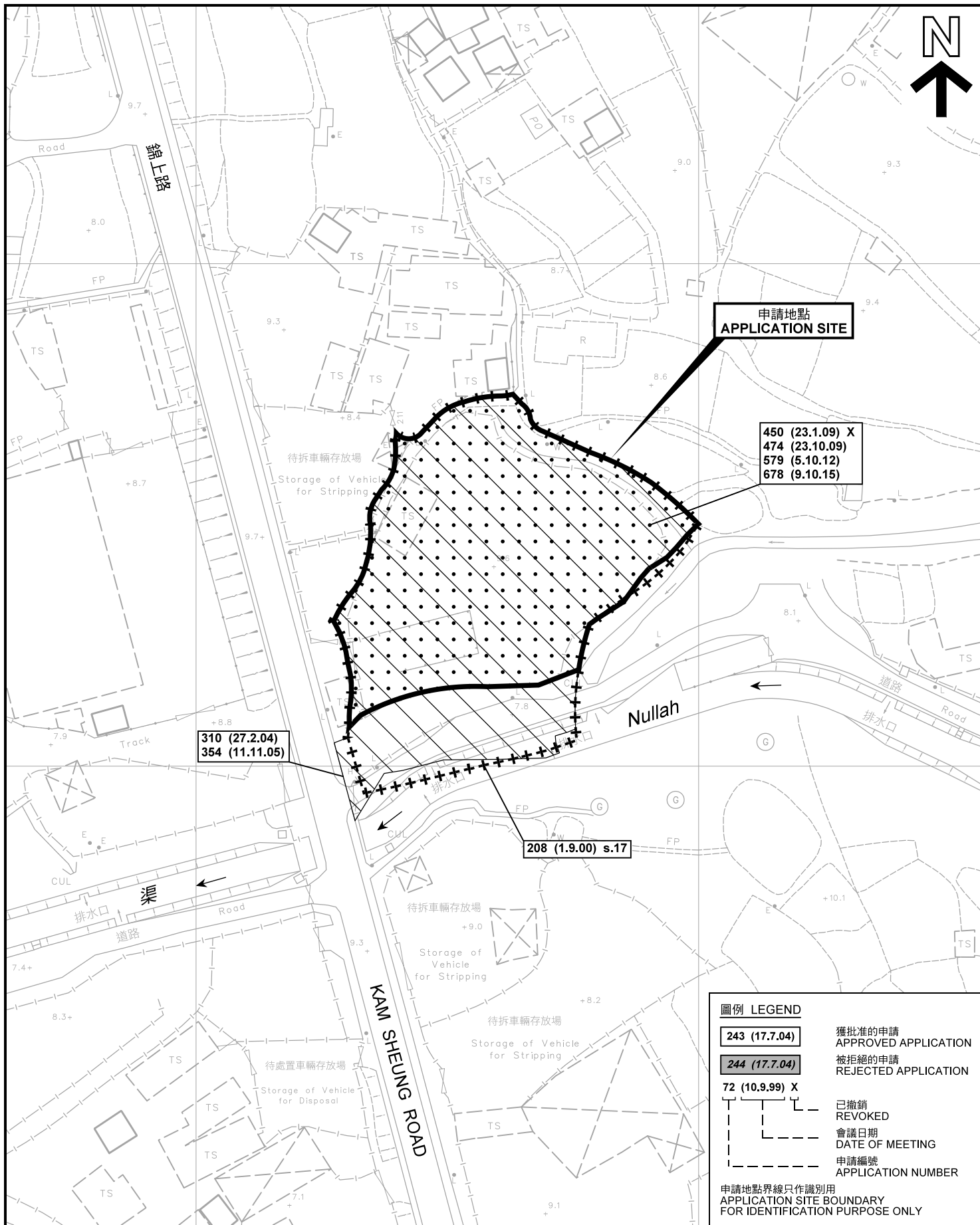

申請地點
APPLICATION SITE

450 (23.1.09) X
474 (23.10.09)
579 (5.10.12)
678 (9.10.15)

310 (27.2.04)
354 (11.11.05)

208 (1.9.00) s.17

圖例 LEGEND

243 (17.7.04)

獲批准的申請
APPROVED APPLICATION

244 (17.7.04)

被拒絕的申請
REJECTED APPLICATION

72 (10.9.99) X

已撤銷
REVOKED

會議日期
DATE OF MEETING

申請編號
APPLICATION NUMBER

申請地點界線只作識別用
APPLICATION SITE BOUNDARY
FOR IDENTIFICATION PURPOSE ONLY

先前申請圖 PREVIOUS APPLICATION PLAN

臨時「露天存放汽車及汽車零件」用途的規劃許可續期（為期3年）
元朗錦田錦上路丈量約份第106約地段第466號餘段和毗連政府土地
RENEWAL OF PLANNING APPROVAL FOR TEMPORARY
"OPEN STORAGE OF VEHICLES AND VEHICLE PARTS"
FOR A PERIOD OF 3 YEARS
LOT 466 RP IN D. D. 106 AND ADJOINING GOVERNMENT LAND,
KAM SHEUNG ROAD, KAM TIN, YUEN LONG

SCALE 1 : 1 000 比例尺

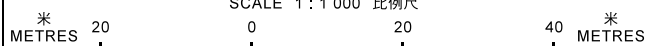

本摘要圖於2018年10月4日擬備，所根據的資料為測量圖編號 6-NE-12D, 13C, 17B 及 18A
EXTRACT PLAN PREPARED ON 4.10.2018
BASED ON SURVEY SHEETS No. 6-NE-12D, 13C, 17B & 18A

規劃署
PLANNING
DEPARTMENT



參考編號
REFERENCE No.
A/YL-KTS/798

圖 PLAN
A-1b

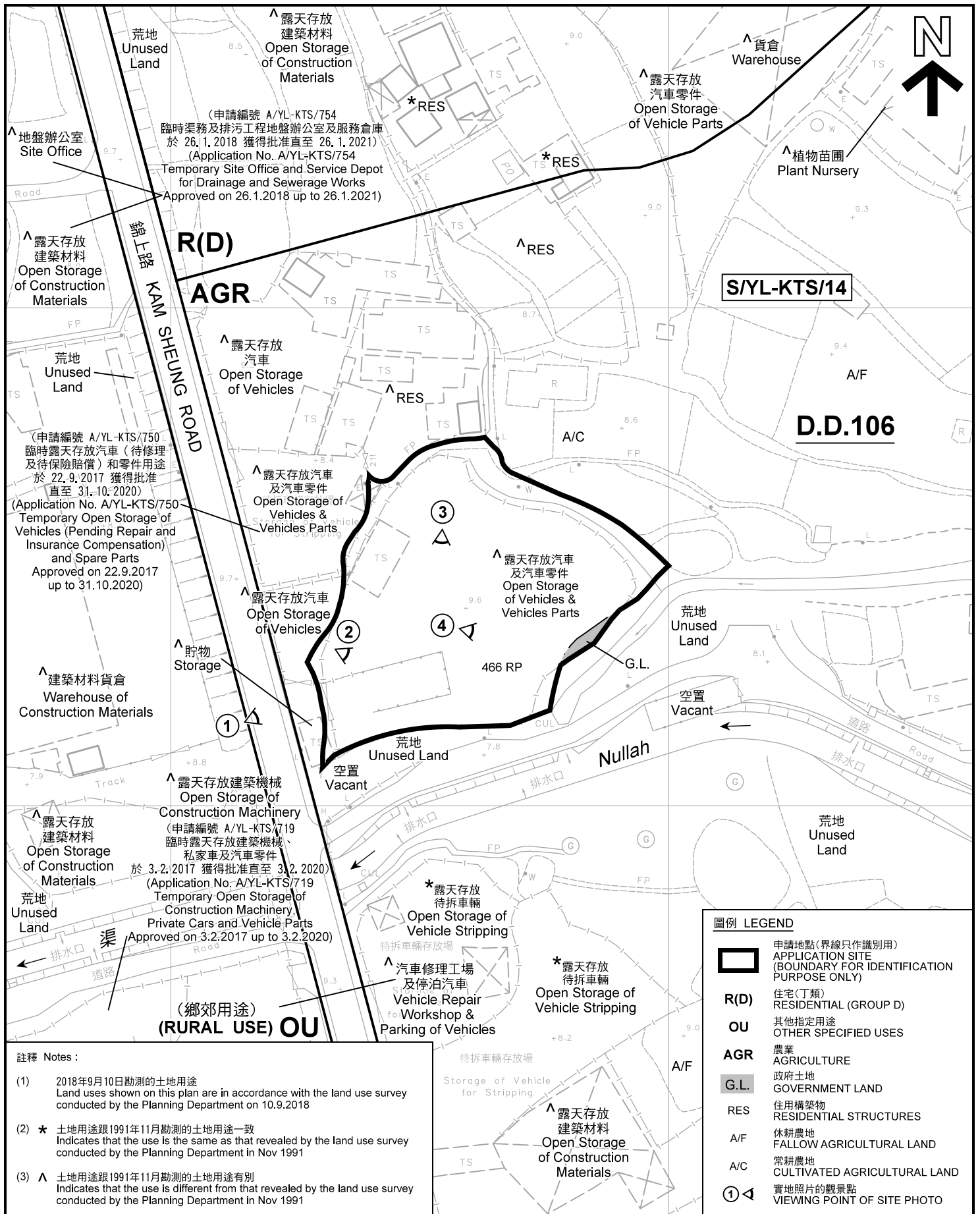

平面圖 SITE PLAN

臨時「露天存放汽車及汽車零件」用途的規劃許可續期(為期3年)
元朗錦田錦上路丈量約份第106約地段第466號餘段和毗連政府土地
RENEWAL OF PLANNING APPROVAL FOR TEMPORARY
"OPEN STORAGE OF VEHICLES AND VEHICLE PARTS"
FOR A PERIOD OF 3 YEARS
LOT 466 RP IN D. D. 106 AND ADJOINING GOVERNMENT LAND,
KAM SHEUNG ROAD, KAM TIN, YUEN LONG

SCALE 1 : 1 000 比例尺

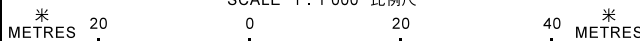

本摘要圖於2018年10月4日擬備, 所根據的資料為測量圖編號 6-NE-12D、13C、17B 及 18A
EXTRACT PLAN PREPARED ON 4.10.2018
BASED ON SURVEY SHEETS No. 6-NE-12D, 13C, 17B & 18A

**規劃署
PLANNING
DEPARTMENT**



參考編號
REFERENCE No.
A/YL-KTS/798

圖 PLAN
A-2



圖例 LEGEND



申請地點(界線只作識別用)
APPLICATION SITE
(BOUNDARY FOR IDENTIFICATION
PURPOSE ONLY)

本摘要圖於2018年10月4日擬備，所根據的資料為地政總署於2018年3月13日拍得的航攝照片編號 E035392C
EXTRACT PLAN PREPARED ON 4.10.2018
BASED ON AERIAL PHOTO No.
E035392C TAKEN ON 13.3.2018
BY LANDS DEPARTMENT

航攝照片 AERIAL PHOTO

臨時「露天存放汽車及汽車零件」用途的規劃許可續期(為期3年)
元朗錦田錦上路丈量約份第106約地段第466號餘段和毗連政府土地
RENEWAL OF PLANNING APPROVAL FOR TEMPORARY
"OPEN STORAGE OF VEHICLES AND VEHICLE PARTS"
FOR A PERIOD OF 3 YEARS
LOT 466 RP IN D.D.106 AND ADJOINING GOVERNMENT LAND,
KAM SHEUNG ROAD, KAM TIN, YUEN LONG

規劃署
PLANNING
DEPARTMENT



參考編號
REFERENCE No.
AYL-KTS/798

圖 PLAN
A-3



本圖於2018年10月4日擬備，所根據的資料為攝於2018年9月4日的實地照片
 PLAN PREPARED ON 4.10.2018
 BASED ON SITE PHOTOS
 TAKEN ON 4.9.2018

實地照片 SITE PHOTOS

臨時「露天存放汽車及汽車零件」用途的規劃許可續期（為期3年）
 元朗錦田錦上路丈量約份第106約地段第466號餘段和毗連政府土地
 RENEWAL OF PLANNING APPROVAL FOR TEMPORARY
 "OPEN STORAGE OF VEHICLES AND VEHICLE PARTS"
 FOR A PERIOD OF 3 YEARS
 LOT 466 RP IN D.D.106 AND ADJOINING GOVERNMENT LAND,
 KAM SHEUNG ROAD, KAM TIN, YUEN LONG

**規劃署
 PLANNING
 DEPARTMENT**



參考編號
 REFERENCE No.
 A/YL-KTN/798

圖 PLAN
 A-4a



本圖於2018年10月4日擬備，所根據的資料為攝於2018年9月4日的實地照片
 PLAN PREPARED ON 4.10.2018
 BASED ON SITE PHOTOS
 TAKEN ON 4.9.2018

實地照片 SITE PHOTOS

臨時「露天存放汽車及汽車零件」用途的規劃許可續期（為期3年）
 元朗錦田錦上路丈量約份第106約地段第466號餘段和毗連政府土地
 RENEWAL OF PLANNING APPROVAL FOR TEMPORARY
 "OPEN STORAGE OF VEHICLES AND VEHICLE PARTS"
 FOR A PERIOD OF 3 YEARS
 LOT 466 RP IN D.D.106 AND ADJOINING GOVERNMENT LAND,
 KAM SHEUNG ROAD, KAM TIN, YUEN LONG

規劃署
 PLANNING
 DEPARTMENT



參考編號
 REFERENCE No.
 A/YL-KTN/798

圖 PLAN
 A-4b