

a3-1  
Detail plan

(摘錄自申請人於 12.8.2020 呈交的進一步資料)  
(Extract from Applicant's Further Information Submitted on 12.8.2020)

|                                       |                   |
|---------------------------------------|-------------------|
| 參考編號<br>REFERENCE No.<br>A/YL-NTM/406 | 繪圖 DRAWING<br>A-1 |
|---------------------------------------|-------------------|

# Sketch of Proposed Building on Lot 127 in D.D.104(Part), Yuen Long

Septic Tank Location      Stairhood  
(7.44m<sup>2</sup>)

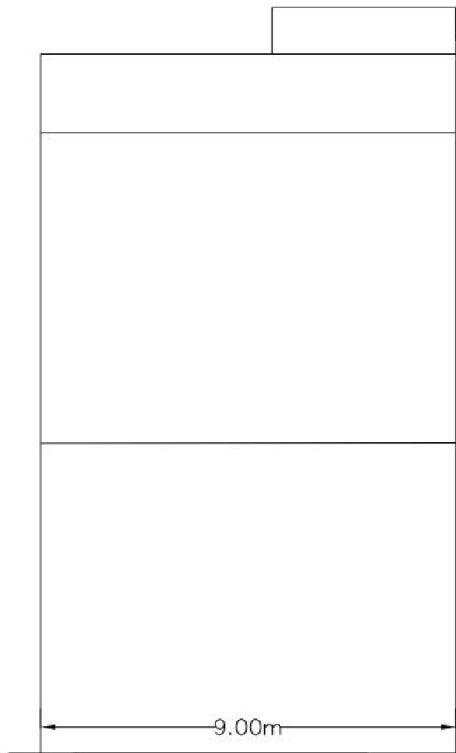

Front Elevation

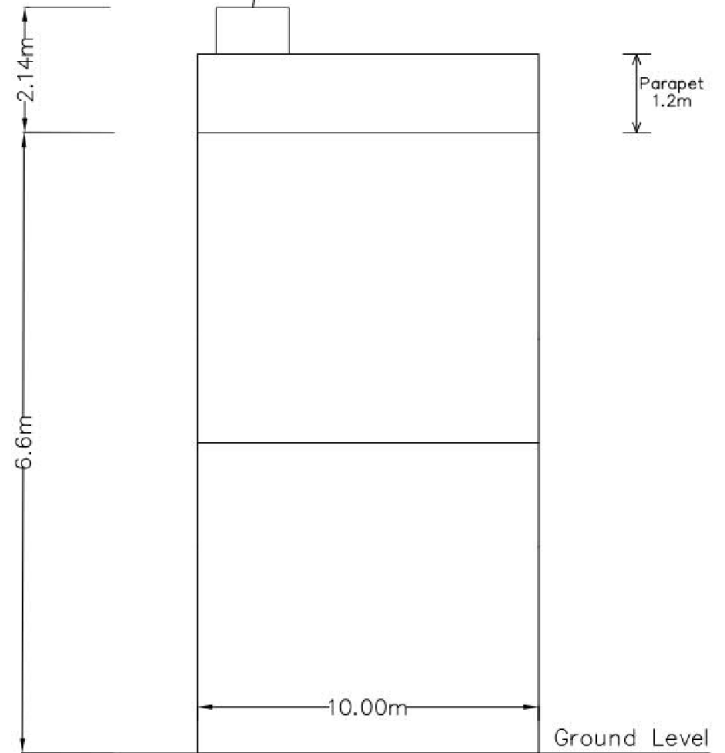

Side View

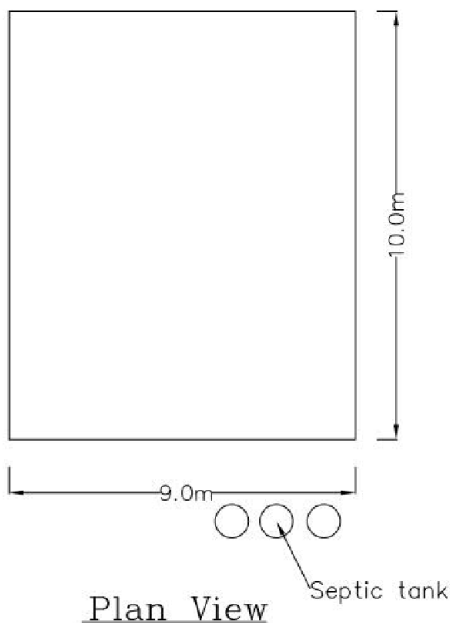

Plan View

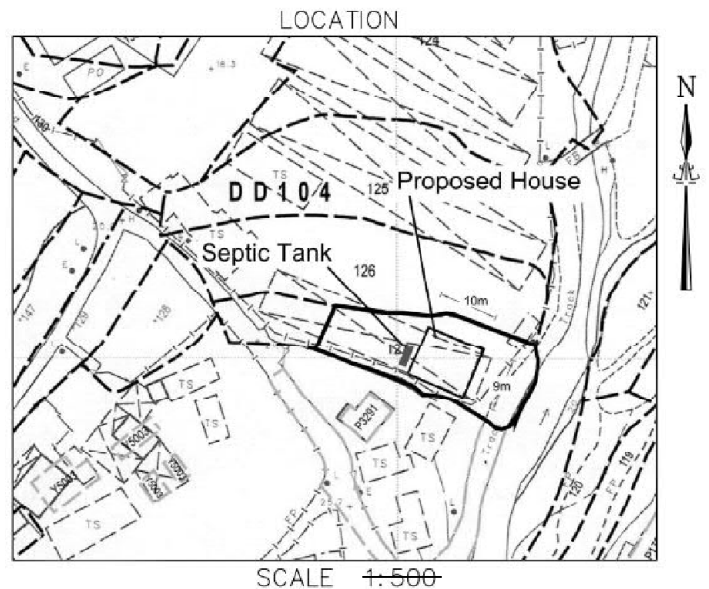

Applicant's Signature :  
Date: 11 AUG 2020

a4-1

Floor Plan On Lot No. 127 (Part) in D.D.104

Scale 1 : 200

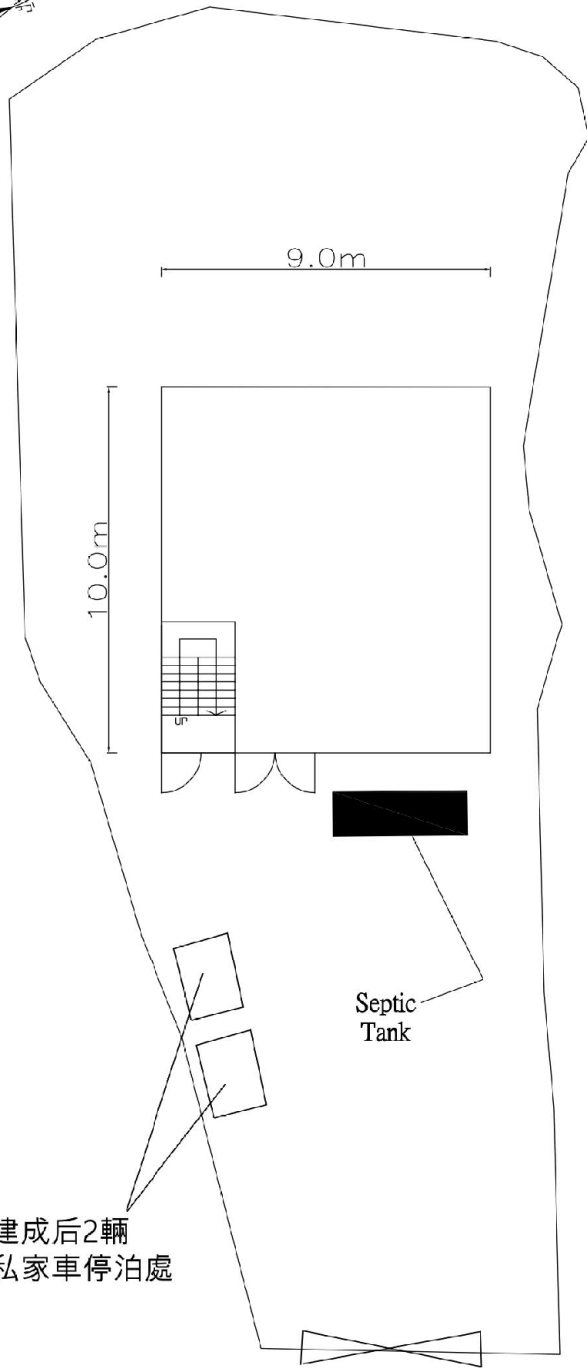

Ground Floor

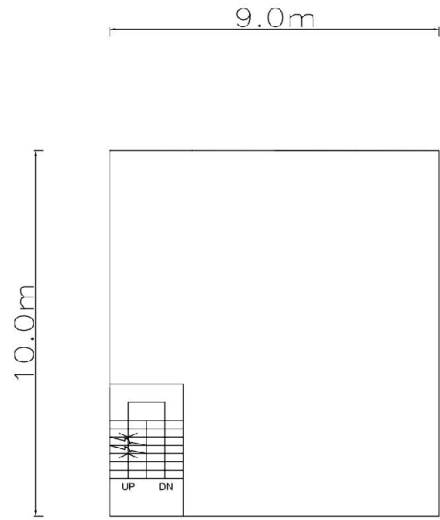

First Floor

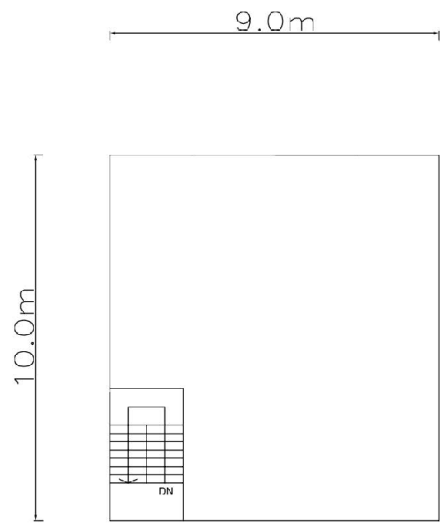

Roof

(摘錄自申請人於 17.8.2020 呈交的進一步資料)  
(Extract from Applicant's Further  
Information Submitted on 17.8.2020)

參考編號  
REFERENCE No.  
A/YL-NTM/406

繪圖 DRAWING  
A-3



不列入分區計劃大綱圖內  
AREA EXCLUDED FROM OUTLINE ZONING PLAN

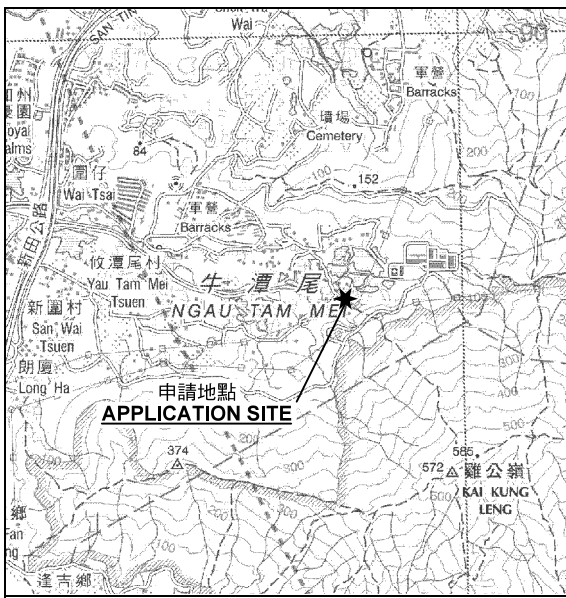

**要覽圖 KEY PLAN**

SCALE 1 : 50 000 比例尺

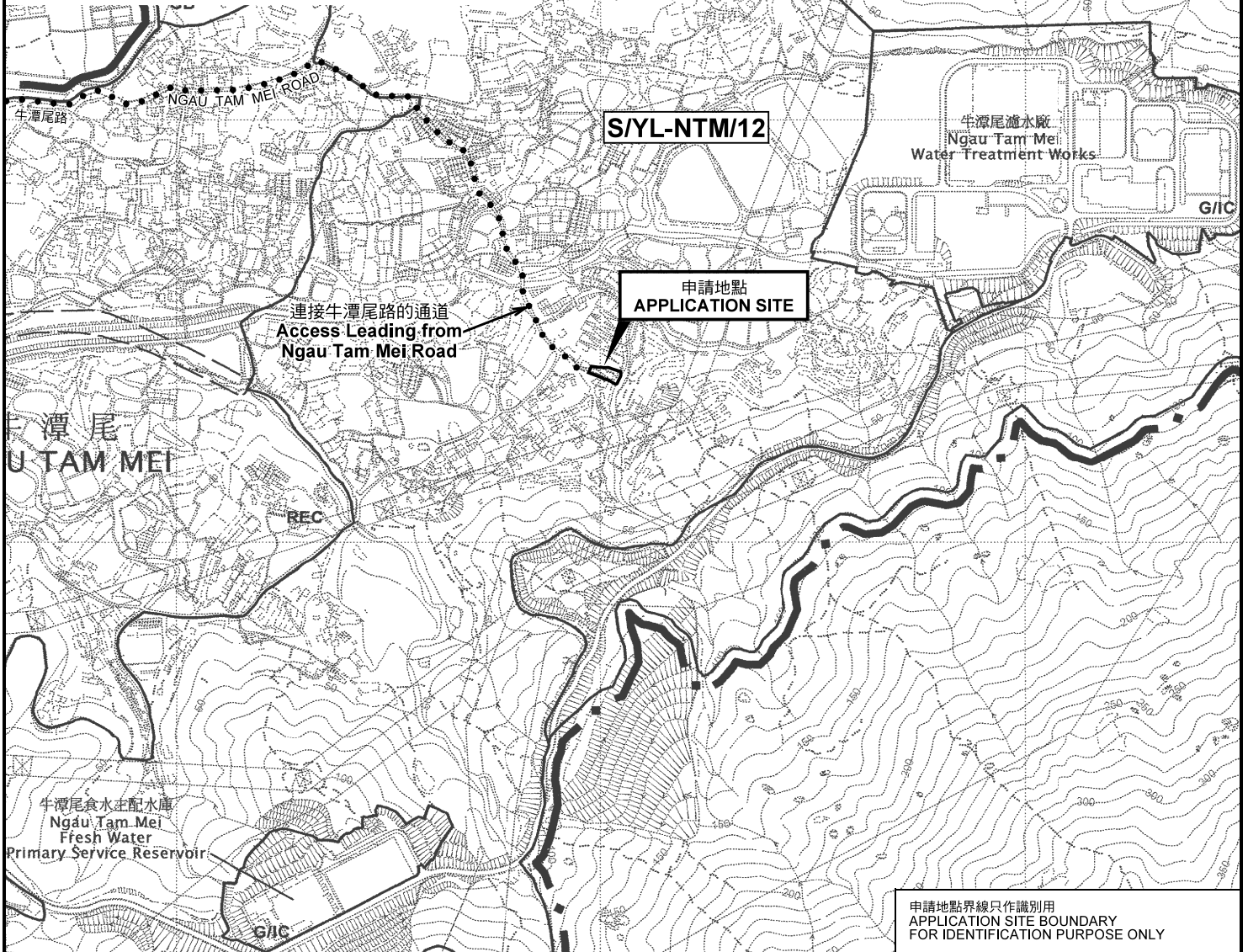

申請地點界線只作識別用  
APPLICATION SITE BOUNDARY  
FOR IDENTIFICATION PURPOSE ONLY

**位置圖 LOCATION PLAN**

擬議分層樓宇  
元朗牛潭尾丈量約份第104約  
地段第127號(部分)  
PROPOSED FLATS  
LOT 127 (PART) IN D.D. 104,  
NGAU TAM MEI, YUEN LONG

SCALE 1 : 7 500 比例尺

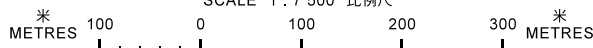

本摘要圖於2020年8月14日擬備，  
所根據的資料為於2006年12月5日  
核准的分區計劃大綱圖編號 S/YL-NTM/12  
EXTRACT PLAN PREPARED ON 14.8.2020  
BASED ON OUTLINE ZONING PLAN No.  
S/YL-NTM/12 APPROVED ON 5.12.2006

規劃署  
PLANNING  
DEPARTMENT



參考編號  
REFERENCE No.  
A/YL-NTM/406

圖 PLAN  
A-1

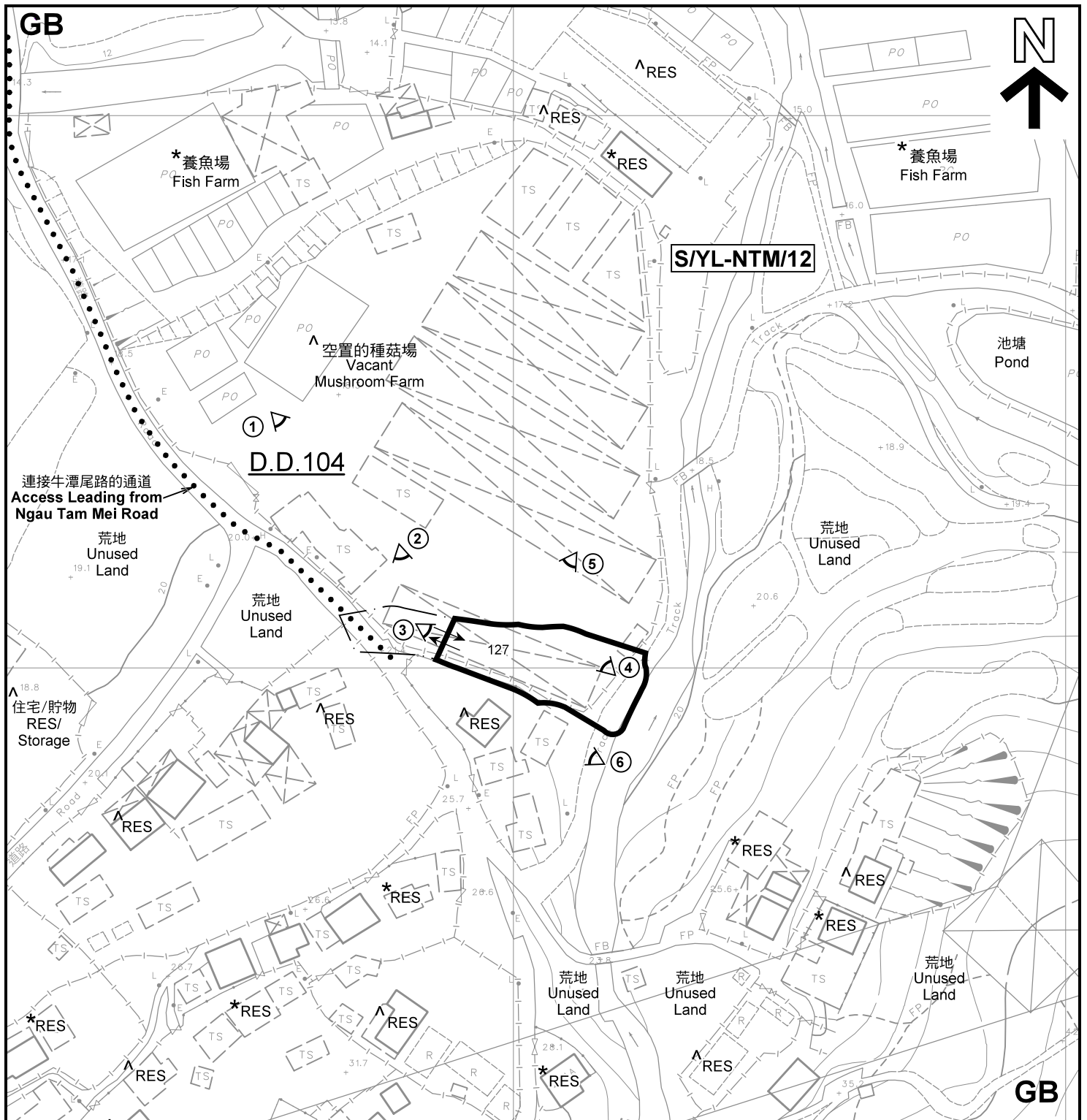

S/YL-NTM/12

D.D.104

連接牛潭尾路的通道  
Access Leading from  
Ngau Tam Mei Road

荒地  
Unused  
Land

荒地  
Unused  
Land

荒地  
Unused  
Land

荒地  
Unused  
Land

荒地  
Unused  
Land

荒地  
Unused  
Land

註釋 Notes :

- (1) 2020年7月3日勘測的土地用途  
Land uses shown on this plan are in accordance with the land use survey conducted by the Planning Department on 3.7.2020
- (2) \* 土地用途跟1992年5月勘測的土地用途一致  
Indicates that the use is the same as that revealed by the land use survey conducted by the Planning Department in May 1992
- (3) ^ 土地用途跟1992年5月勘測的土地用途有別  
Indicates that the use is different from that revealed by the land use survey conducted by the Planning Department in May 1992

圖例 LEGEND

- 申請地點(界線只作識別用)  
APPLICATION SITE  
(BOUNDARY FOR IDENTIFICATION  
PURPOSE ONLY)
- GB** 綠化地帶  
GREEN BELT
- RES** 住用構築物  
RESIDENTIAL STRUCTURES
- 實地照片的觀景點  
VIEWING POINT OF SITE PHOTO
- 入口/出口  
INGRESS / EGRESS

平面圖 SITE PLAN

擬議分層樓宇  
元朗牛潭尾丈量約份第104約  
地段第127號(部分)  
PROPOSED FLATS  
LOT 127 (PART) IN D.D. 104,  
NGAU TAM MEI, YUEN LONG

本摘要圖於2020年8月14日擬備, 所根據的資料為測量圖編號 2-SE-18C 及 23A  
EXTRACT PLAN PREPARED ON 14.8.2020  
BASED ON SURVEY SHEETS No.  
2-SE-18C & 23A

規劃署  
PLANNING  
DEPARTMENT



參考編號  
REFERENCE No.  
A/YL-NTM/406

圖 PLAN  
A-2

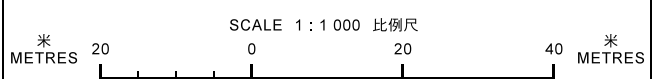

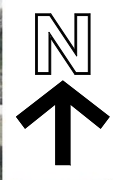

圖例 LEGEND



申請地點 (界線只作識別用)  
APPLICATION SITE  
(BOUNDARY FOR IDENTIFICATION PURPOSE ONLY)

本摘要圖於2020年8月13日擬備，所根據的資料為地政總署於2018年1月3日拍得的航攝照片編號 E032287C  
EXTRACT PLAN PREPARED ON 13.8.2020  
BASED ON AERIAL PHOTO No. E032287C TAKEN ON 3.1.2018  
BY LANDS DEPARTMENT

航攝照片 AERIAL PHOTO

擬議分層樓宇  
元朗牛潭尾丈量約份第104約  
地段第127號 (部分)  
PROPOSED FLATS  
LOT 127 (PART) IN D.D. 104,  
NGAU TAM MEI, YUEN LONG

規劃署  
PLANNING  
DEPARTMENT



參考編號  
REFERENCE No.  
A/YL-NTM/406

圖 PLAN  
A-3



申請地點界線只作識別用 APPLICATION SITE BOUNDARY FOR IDENTIFICATION PURPOSE ONLY

**實地照片 SITE PHOTOS**

擬議分層樓宇  
元朗牛潭尾丈量約份第104約  
地段第127號(部分)  
PROPOSED FLATS  
LOT 127 (PART) IN D.D. 104,  
NGAU TAM MEI, YUEN LONG

規劃署  
PLANNING  
DEPARTMENT



參考編號  
REFERENCE No.  
A/YL-NTM/406

圖 PLAN  
A-4a

本圖於2020年8月12日擬備，所根據的資料為攝於2020年7月3日的實地照片  
PLAN PREPARED ON 12.8.2020  
BASED ON SITE PHOTOS  
TAKEN ON 3.7.2020



申請地點界線只作識別用 APPLICATION SITE BOUNDARY FOR IDENTIFICATION PURPOSE ONLY

**實地照片 SITE PHOTOS**

本圖於2020年8月12日擬備，所根據的資料為攝於2020年7月3日的實地照片  
 PLAN PREPARED ON 12.8.2020  
 BASED ON SITE PHOTOS  
 TAKEN ON 3.7.2020

擬議分層樓宇  
 元朗牛潭尾丈量約份第104約  
 地段第127號（部分）  
 PROPOSED FLATS  
 LOT 127 (PART) IN D.D. 104,  
 NGAU TAM MEI, YUEN LONG

規劃署  
 PLANNING  
 DEPARTMENT



參考編號  
 REFERENCE No.  
 A/YL-NTM/406

圖 PLAN  
 A-4b