

LEGEND:

-  Application Site (Area = 1,333 sq. m.)
-  Canopy for Parking of Lorry Cranes for Sale
-  Shelter (Ancillary Maintenance Workshop)
-  Parking Space for lorry crane (2.5m x 7m)



Top Bright Consultants Ltd.

Drawing No. :TB/18/558/05

Layout Plan

Lots 155(Part), 157 and Adjoining Government Land in DD105, San Tin, Yuen Long, N.T.

FIGURE 5

FOR IDENTIFICATION PURPOSE

Date: 1.11.2018

Scale: 1 : 1 000

(摘錄自申請人於2. 1. 2019呈交的進一步資料)
(Extract from Applicant's Further Information Submitted on 2.1.2019)

參考編號

REFERENCE No.



A/YL-ST/535

繪圖 DRAWING

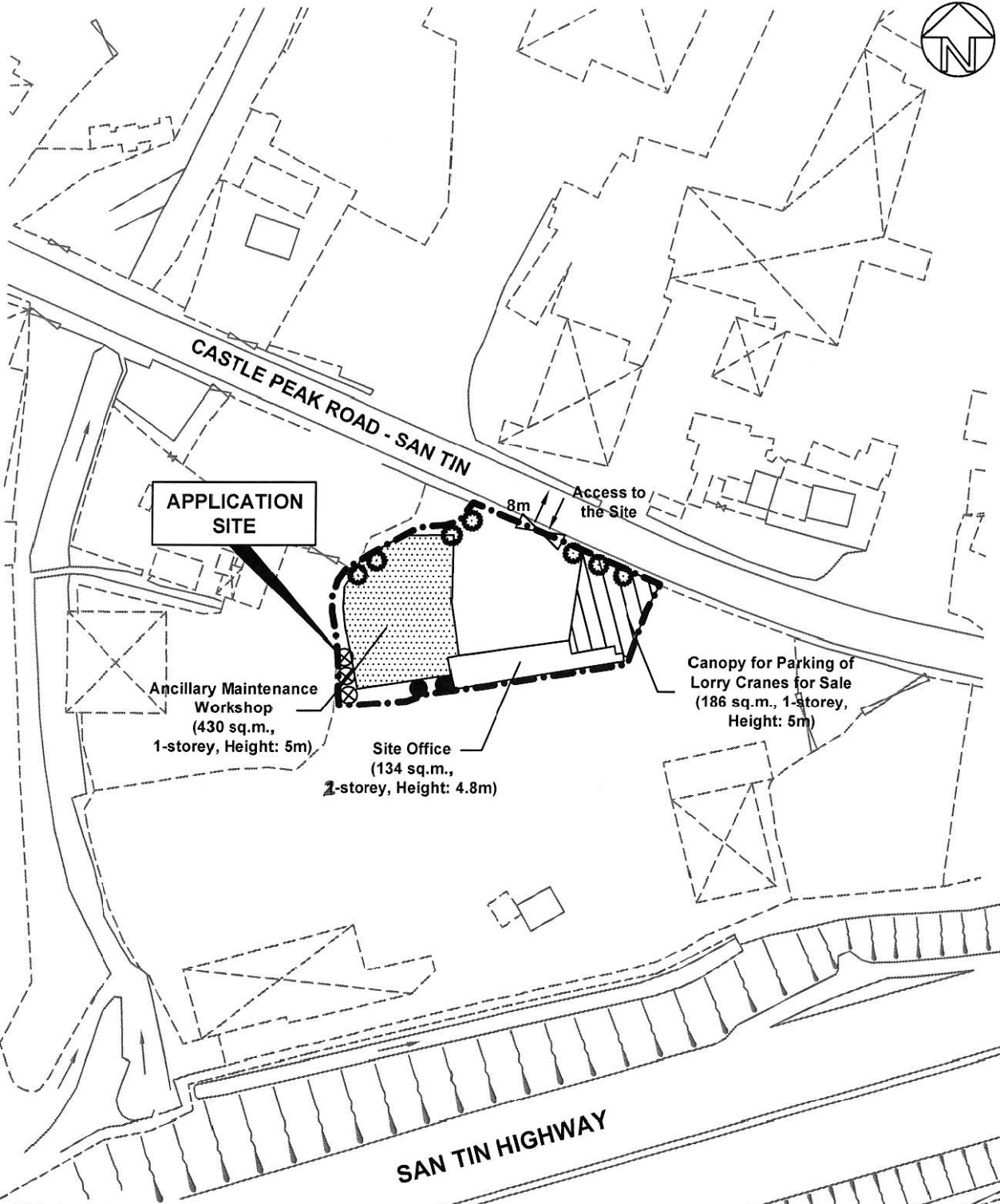
A-1



Plant Schedule:

Existing Trees to be Preserved	Spacing (centre to centre)	Size (height / span)	Quantity
*Ficus Benjamina 	3000-4000mm	2750-3750mm	7
Banana Trees 	3000-4000mm	—	2
Ficus Microcarpa 	3000-4000mm	2750-3750mm	3

* Trees planted to comply with condition under Application No. A/YL-ST/191



Top Bright Consultants Ltd.

Drawing No. :TB/18/558/06

Landscape and Tree Preservation Proposal

Lots 155(Part), 157 and Adjoining Government Land in DD105, San Tin, Yuen Long, N.T.

FIGURE 6

FOR IDENTIFICATION PURPOSE

Date: 1.11.2018

Scale: 1 : 1 000

(摘錄自申請人於2. 1. 2019呈交的進一步資料)
(Extract from Applicant's Further Information Submitted on 2.1.2019)

參考編號
REFERENCE No.
A/YL-ST/535

繪圖 DRAWING
A-2

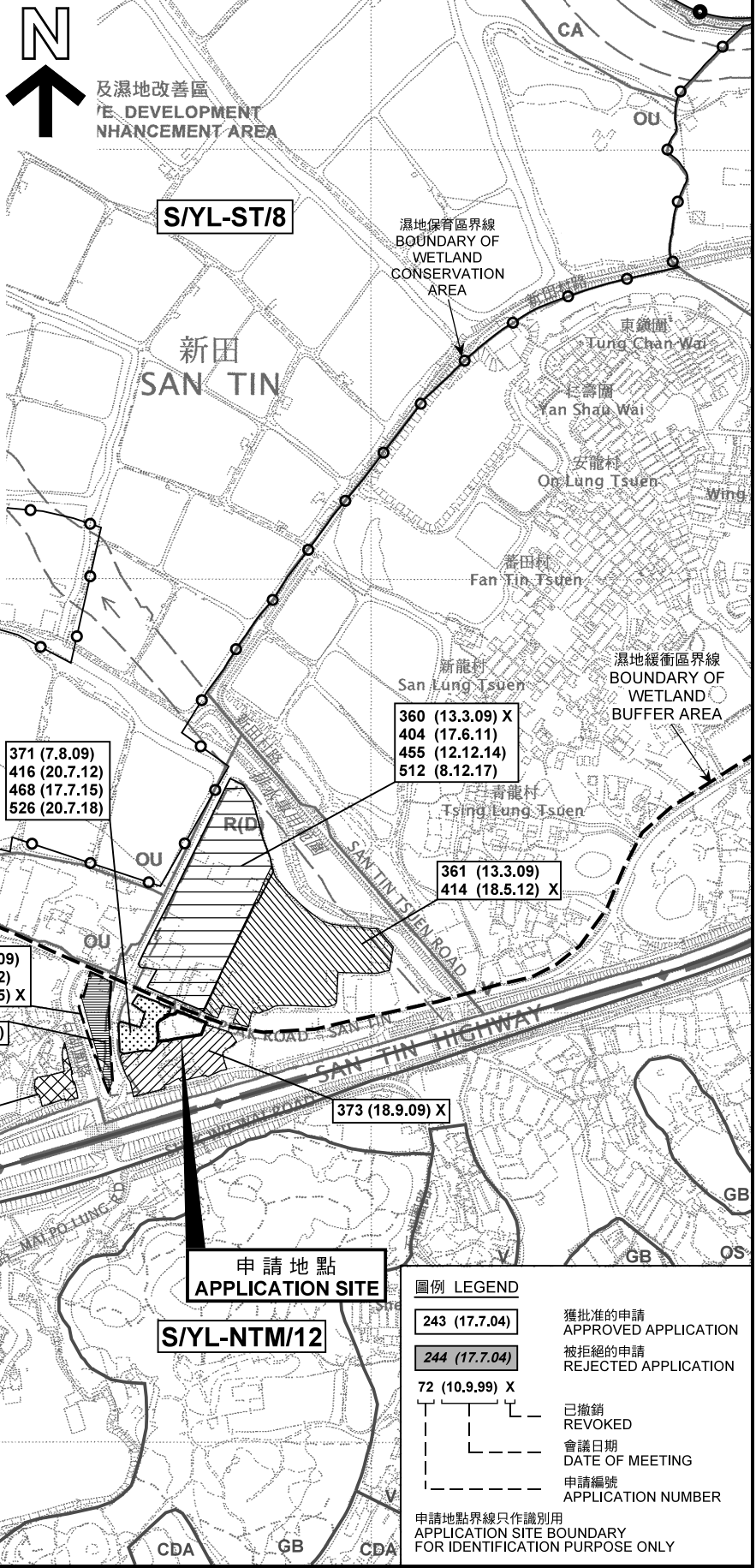
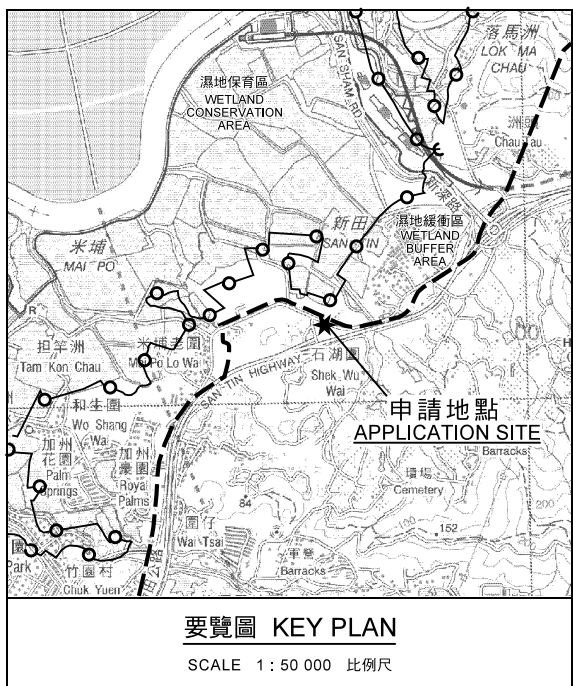

本摘要圖於2019年1月15日擬備，
所根據的資料為於2006年12月5日
核准的分區計劃大綱圖編號S/YL-ST/8
EXTRACT PLAN PREPARED ON 15.1.2019
BASED ON OUTLINE ZONING PLAN No.
S/YL-ST/8 APPROVED ON 5.12.2006

位置圖及同類申請 LOCATION PLAN WITH SIMILAR APPLICATIONS

臨時停泊吊臂車作銷售連附屬維修工場（為期3年）
元朗新田丈量約份第105約地段第155號（部分）及
第157號和毗連政府土地
TEMPORARY PARKING OF LORRY CRANES FOR SALE
WITH ANCILLARY MAINTENANCE WORKSHOP FOR A PERIOD OF 3 YEARS
LOTS 155(PART) AND 157 IN D.D.105 AND
ADJOINING GOVERNMENT LAND, SAN TIN, YUEN LONG

SCALE 1: 7 500 比例尺

米 100 0 100 200 300 米
METRES

**規劃署
PLANNING
DEPARTMENT**



參考編號
REFERENCE No.
A/YL-ST/535

**圖 PLAN
A-1a**

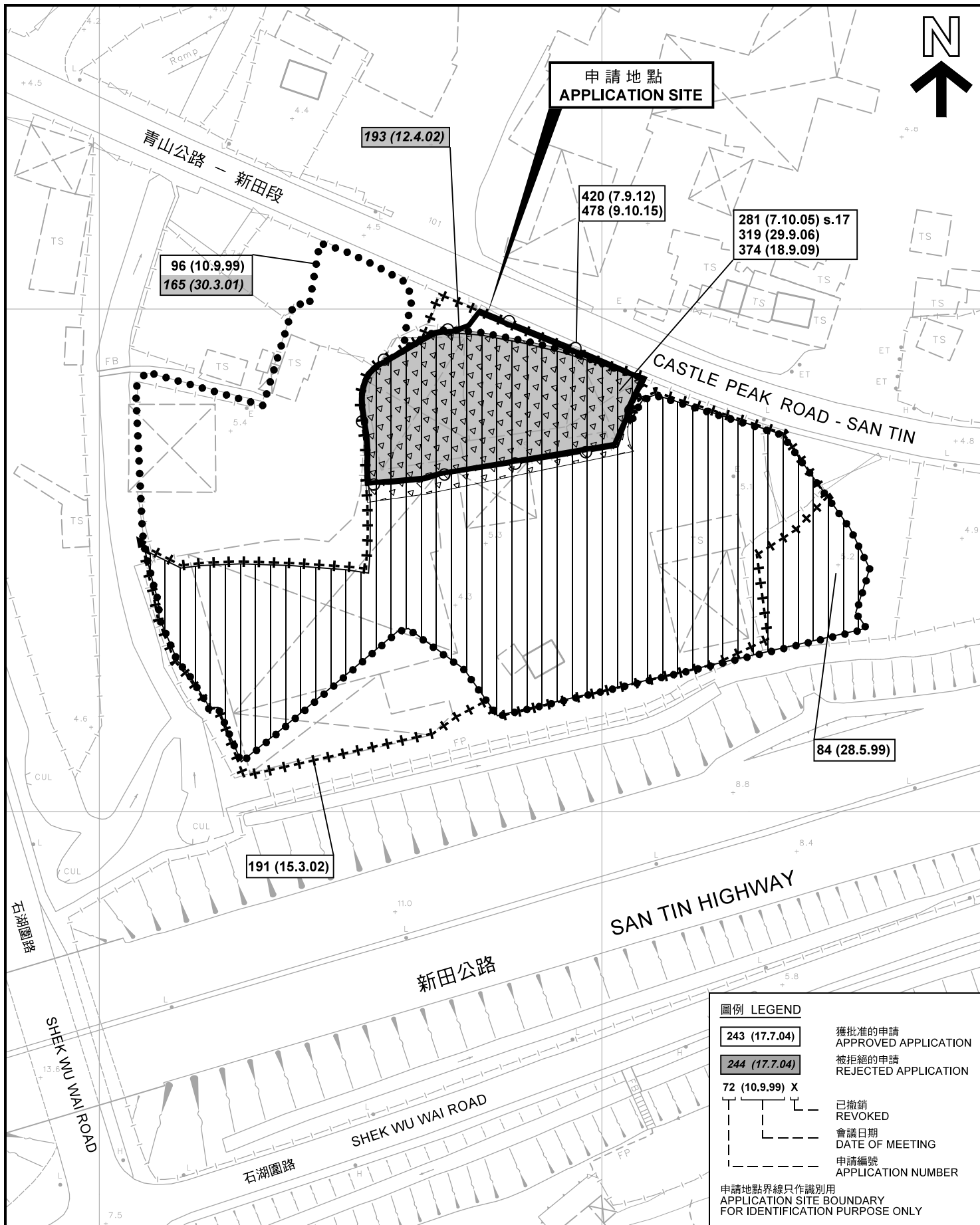

先前申請圖 PREVIOUS APPLICATION PLAN

臨時停泊吊臂車作銷售連附屬維修工場（為期3年）
 元朗新田丈量約份第105約地段第155號（部分）及
 第157號和毗連政府土地
 TEMPORARY PARKING OF LORRY CRANES FOR SALE
 WITH ANCILLARY MAINTENANCE WORKSHOP FOR A PERIOD OF 3 YEARS
 LOTS 155(PART) AND 157 IN D.D.105 AND
 ADJOINING GOVERNMENT LAND, SAN TIN, YUEN LONG

SCALE 1 : 1 000 比例尺

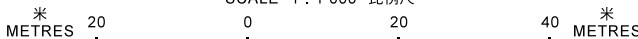

本摘要圖於2018年12月18日擬備，所根據的資料為測量圖編號2-SE-12B
 EXTRACT PLAN PREPARED ON 18.12.2018
 BASED ON SURVEY SHEET No. 2-SE-12B

圖例 LEGEND

- 243 (17.7.04) 獲批准的申請
APPROVED APPLICATION
- 244 (17.7.04) 被拒絕的申請
REJECTED APPLICATION
- 72 (10.9.99) X 已撤銷
REVOKED
- - - 會議日期
DATE OF MEETING
- - - 申請編號
APPLICATION NUMBER

申請地點界線只作識別用
 APPLICATION SITE BOUNDARY
 FOR IDENTIFICATION PURPOSE ONLY

**規劃署
 PLANNING
 DEPARTMENT**



參考編號
 REFERENCE No.
 A/YL-ST/535

圖 PLAN
 A-1b

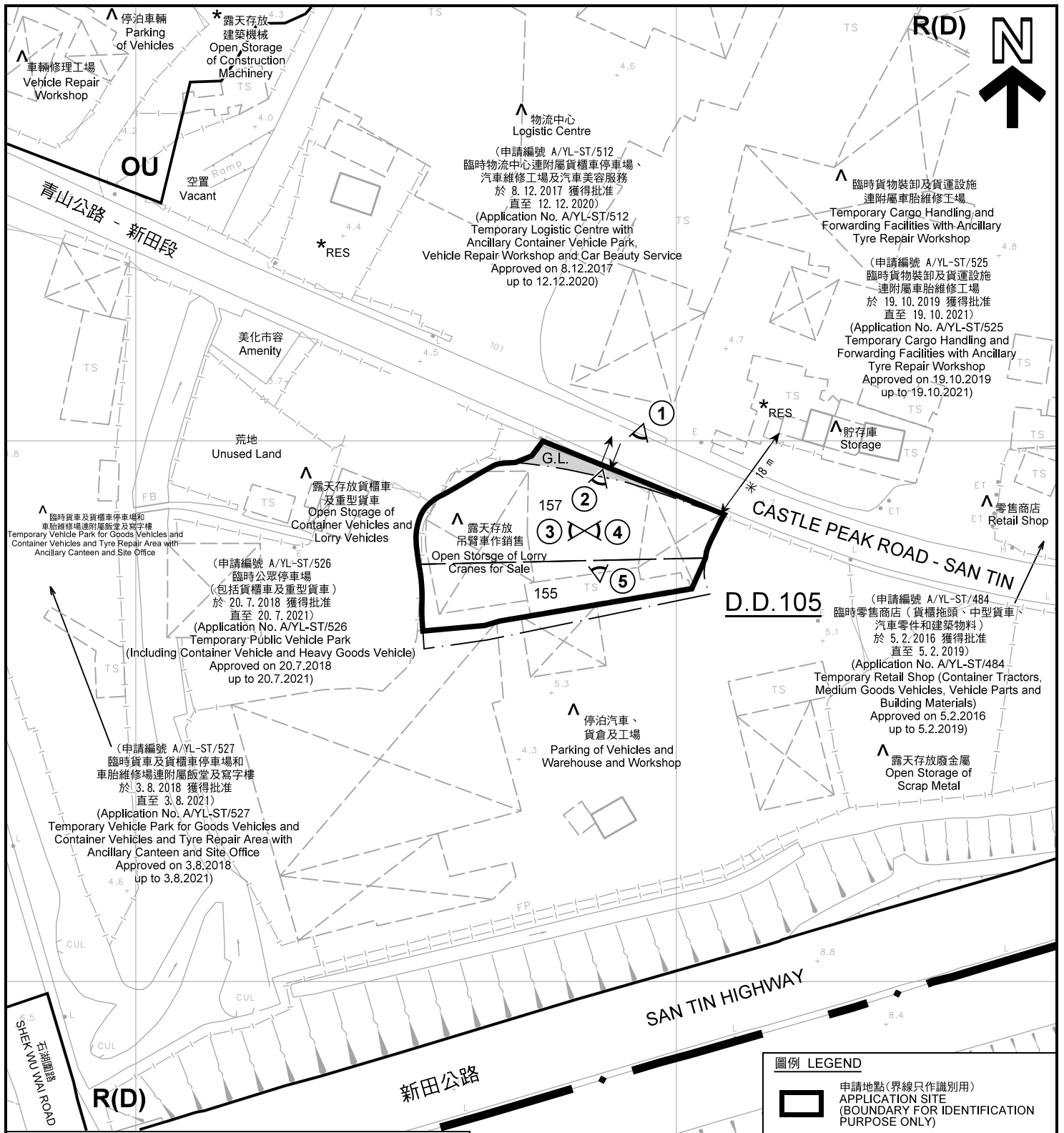

註釋 Notes:

- (1) 2018年12月11日勘測的土地用途
Land uses shown on this plan are in accordance with the land use survey conducted by the Planning Department on 11.12.2018
- (2) * 土地用途跟1992年3月勘測的土地用途一致
Indicates that the use is the same as that revealed by the land use survey conducted by the Planning Department in March 1992
- (3) ^ 土地用途跟1992年3月勘測的土地用途有別
Indicates that the use is different from that revealed by the land use survey conducted by the Planning Department in March 1992

圖例 LEGEND

- 申請地點(界線只作識別用)
APPLICATION SITE
(BOUNDARY FOR IDENTIFICATION PURPOSE ONLY)
- R(D)** 住宅(丁類)
RESIDENTIAL (GROUP D)
- OU** 其他指定用途
OTHER SPECIFIED USES
- G.L.** 政府土地
GOVERNMENT LAND
- RES** 住用構築物
RESIDENTIAL STRUCTURES
- 實地照片的觀景點
VIEWING POINT OF SITE PHOTO
- 入口/出口
INGRESS / EGRESS

平面圖 SITE PLAN

臨時停泊吊臂車作銷售連附屬維修工場 (為期3年)
元朗新田丈量約份第105約地段第155號 (部分) 及
第157號和毗連政府土地
TEMPORARY PARKING OF LORRY CRANES FOR SALE
WITH ANCILLARY MAINTENANCE WORKSHOP FOR A PERIOD OF 3 YEARS
LOTS 155(PART) AND 157 IN D.D.105 AND
ADJOINING GOVERNMENT LAND, SAN TIN, YUEN LONG

SCALE 1 : 1 000 比例尺

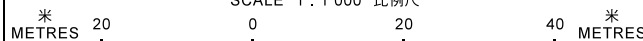

本摘要圖於2019年1月9日擬備，所根據
的資料為測量圖編號2-SE-12B
EXTRACT PLAN PREPARED ON 9.1.2019
BASED ON SURVEY SHEET
No. 2-SE-12B

規劃署
PLANNING
DEPARTMENT



參考編號
REFERENCE No.
A/YL-ST/535

圖 PLAN
A-2

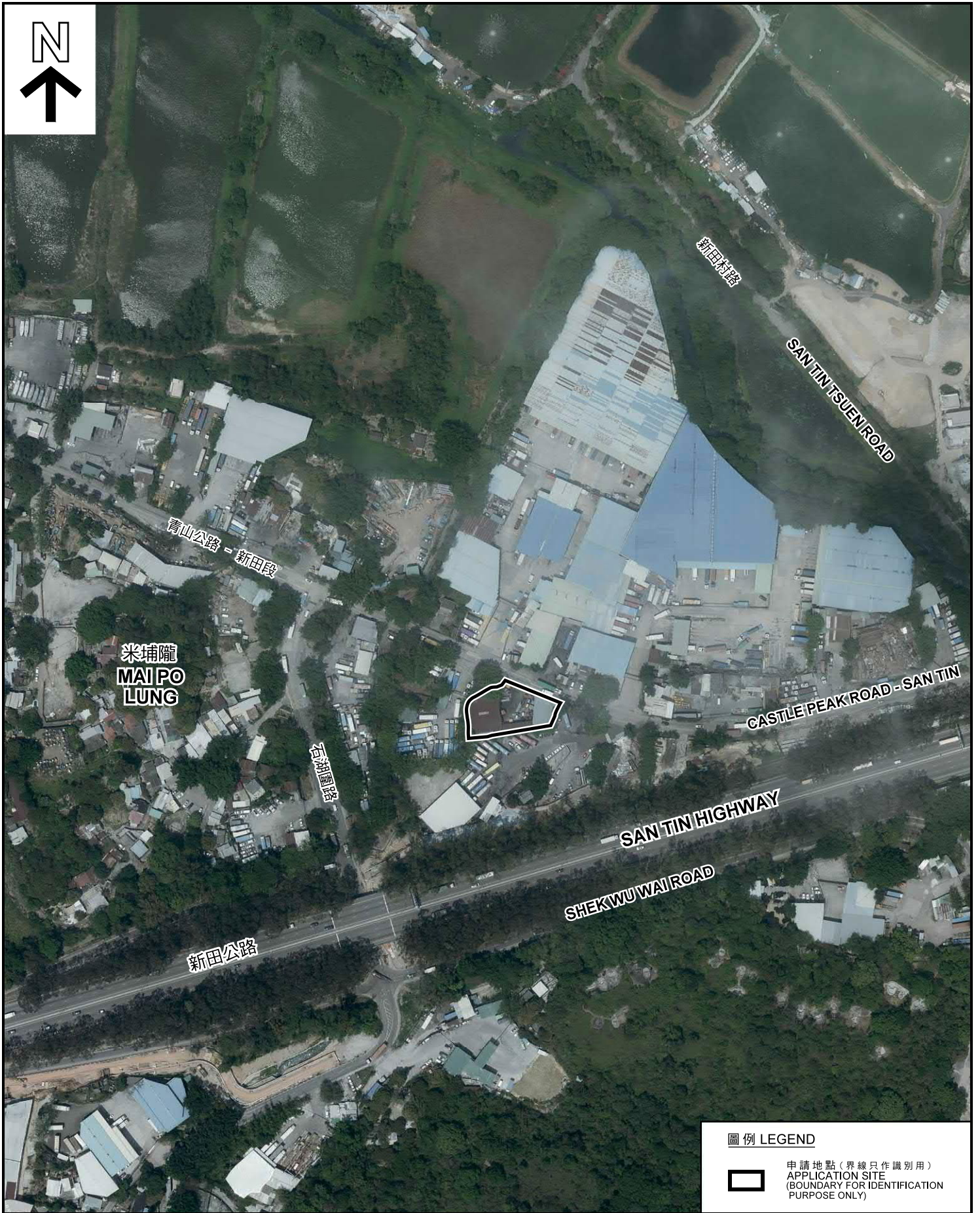

圖例 LEGEND



申請地點 (界線只作識別用)
APPLICATION SITE
(BOUNDARY FOR IDENTIFICATION
PURPOSE ONLY)

本摘要圖於2018年12月18日擬備，所根據的資料為地政總署於2018年4月10日拍得的航攝照片編號 E040768C
EXTRACT PLAN PREPARED ON 18.12.2018
BASED ON AERIAL PHOTO No.
E040768C TAKEN ON 10.4.2018
BY LANDS DEPARTMENT

航攝照片 AERIAL PHOTO

臨時停泊吊臂車作銷售連附屬維修工場 (為期3年)
元朗新田丈量約份第105約地段第155號 (部分) 及
第157號和毗連政府土地
TEMPORARY PARKING OF LORRY CRANES FOR SALE
WITH ANCILLARY MAINTENANCE WORKSHOP FOR A PERIOD OF 3 YEARS
LOTS 155(PART) AND 157 IN D.D.105 AND
ADJOINING GOVERNMENT LAND, SAN TIN, YUEN LONG

規劃署
PLANNING
DEPARTMENT



參考編號
REFERENCE No.
AYL-ST/535

圖 PLAN
A-3



申請地點界線只作識別用 APPLICATION SITE BOUNDARY FOR IDENTIFICATION PURPOSE ONLY

實地照片 SITE PHOTOS

本圖於2018年12月18日擬備，所根據的資料為攝於2018年12月7日的實地照片
PLAN PREPARED ON 18.12.2018
BASED ON SITE PHOTOS
TAKEN ON 7.12.2018

臨時停泊吊臂車作銷售連附屬維修工場（為期3年）
元朗新田丈量約份第105約地段第155號（部分）及
第157號和毗連政府土地
TEMPORARY PARKING OF LORRY CRANES FOR SALE
WITH ANCILLARY MAINTENANCE WORKSHOP FOR A PERIOD OF 3 YEARS
LOTS 155(PART) AND 157 IN D.D.105 AND
ADJOINING GOVERNMENT LAND, SAN TIN, YUEN LONG

規劃署
PLANNING
DEPARTMENT



參考編號
REFERENCE No.
AYL-ST/535

圖 PLAN
A-4