

Project 項目名稱:

Proposed Temporary Shop and Services (Selling of Converted Container & Showrooms for Koi, Steel Door and Aluminium Window) & Office for a Period of 3 Years at Lot 540RP (Part) in D.D. 92 and Adjoining Government Land, Castle Peak Road, Kwu Tung, Sheung Shui, N.T.

Drawing Title 圖目:

Proposed Layout Plan

Drawing No. 圖號:

Figure 2

Remarks 備註:

 Uncovered area

Scale 比例:

1:500

(資料來源:申請人於 14. 3. 2019 呈交的資料)  
(Source : Applicant's Submission of 14.3.2019)

參考編號  
REFERENCE No.  
A/KTN/58

繪圖 DRAWING  
A-1

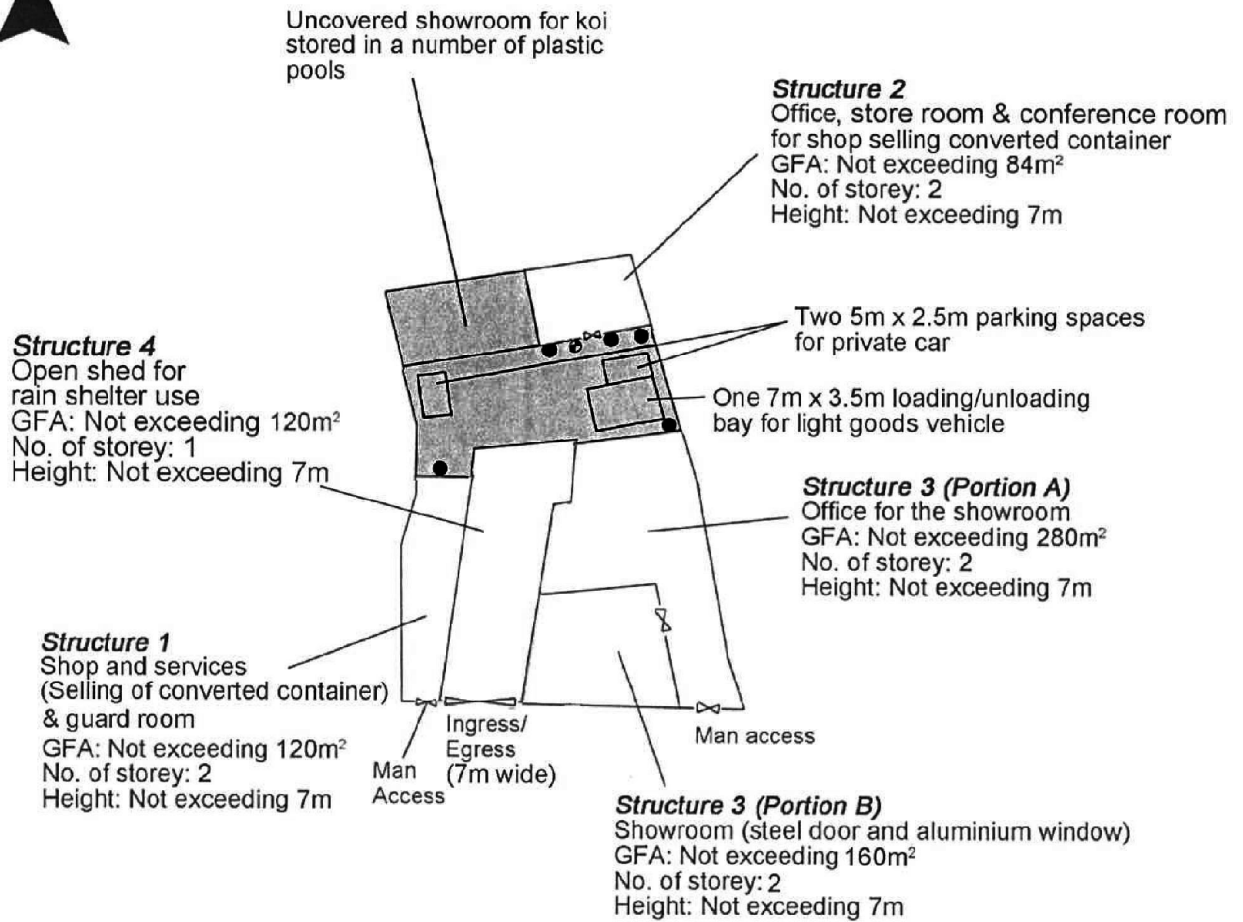

Tree	Quantity	Approximate Height	Spacing
● Proposed <i>Bauhinia blakeana</i> to replace the broken trees	5	About 2.75m	3m
⊙ Existing <i>Podocarpus macrophylla</i> to be preserved	1	About 2.75m	NA

Project 項目名稱: Proposed Temporary Shop and Services (Selling of Converted Container & Showrooms for Koi, Steel Door and Aluminium Window) & Office for a Period of 3 Years at Lot 540RP (Part) in D.D. 92 and Adjoining Government Land, Castle Peak Road, Kwu Tung, Sheung Shui, N.T.	Drawing Title 圖目: Proposed Landscape & Tree Preservation Plan	Remarks 備註:  Uncovered area
	Drawing No. 圖號: Figure 3	Scale 比例: 1:500

(資料來源:申請人於 14. 3. 2019 呈交的資料)  
 (Source : Applicant's Submission of 14.3.2019)

參考編號  
 REFERENCE No.  
 A/KTN/58

繪圖 DRAWING  
 A-2



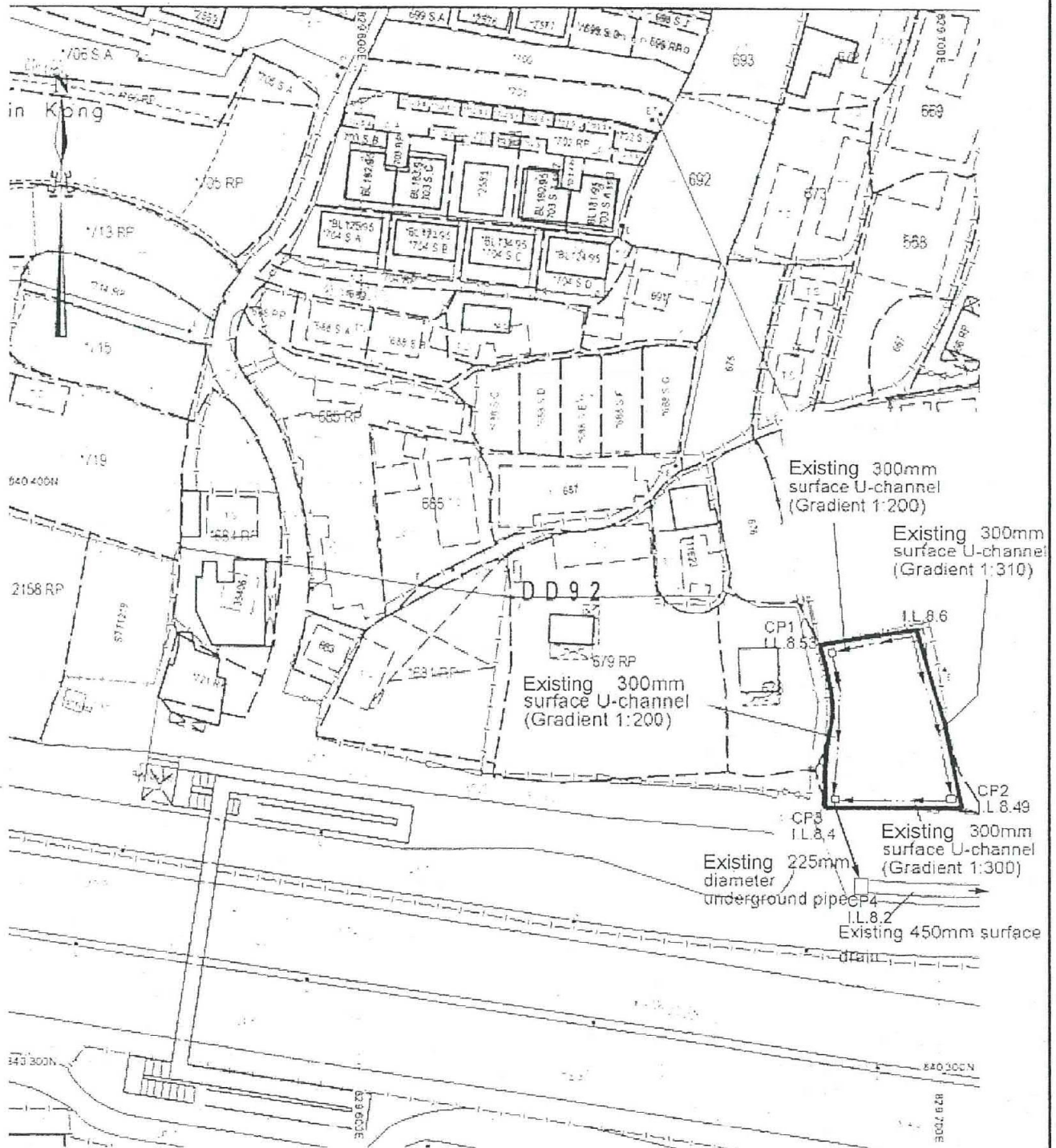

<p>Project No. 17/13</p> <p>Proposed Temporary Shop and Services (Selling of Converted Container &amp; Showrooms for Koi, Steel Door and Aluminium Window) &amp; Office for a Period of 3 Years at Lot 540RP (Part) in D.D. 92 and Adjoining Government Land, Castle Peak Road, Kwu Tung, Sheung Shui, N.T.</p>	<p>Drawing Title: As-built Drainage Plan</p> <p>Drawing No.: Figure 4</p>	<p>Remarks:</p> <p>⇒ Flow of Surface Runoff</p> <p>+8.7 level (in mPD)</p> <p>□ Proposed catchpit (CP)</p> <p>Scale: 1:1000</p>
---	---	---

(資料來源:申請人於 30.11.2018 呈交的資料)  
 (Source : Applicant's Submission of 30.11.2018)

參考編號 REFERENCE No. A/KTN/58  
 繪圖 DRAWING A-3

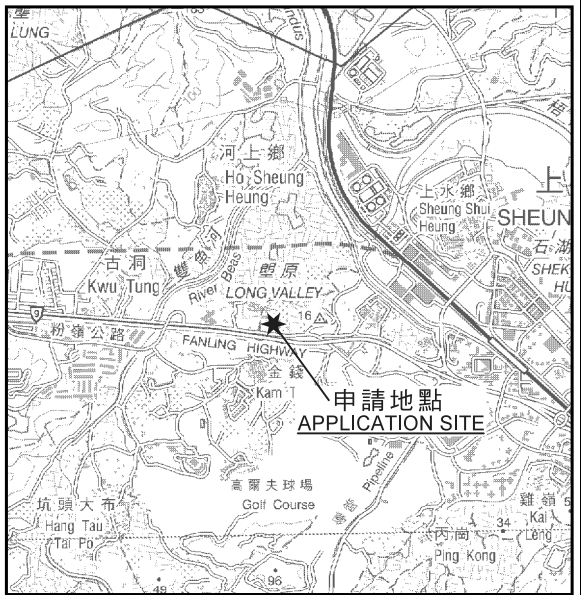
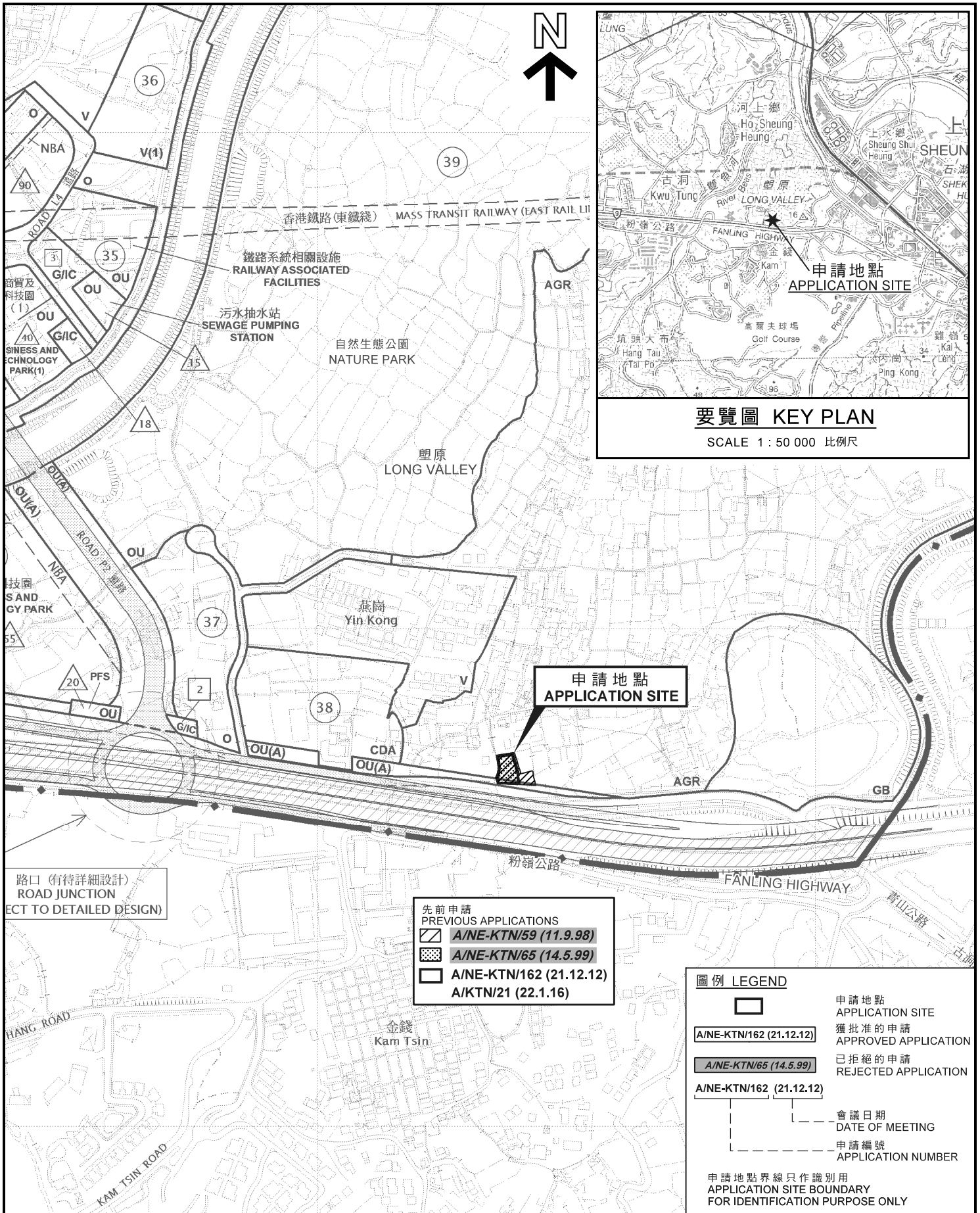

**要覽圖 KEY PLAN**  
SCALE 1 : 50 000 比例尺

路口 (有待詳細設計)  
ROAD JUNCTION  
(SUBJECT TO DETAILED DESIGN)

- 先前申請  
PREVIOUS APPLICATIONS
- A/NE-KTN/59 (11.9.98)
  - A/NE-KTN/65 (14.5.99)
  - A/NE-KTN/162 (21.12.12)  
A/KTN/21 (22.1.16)

- 圖例 LEGEND**
- 申請地點  
APPLICATION SITE
  - 獲批准的申請  
APPROVED APPLICATION
  - 已拒絕的申請  
REJECTED APPLICATION
  - A/NE-KTN/162 (21.12.12)
  - A/NE-KTN/65 (14.5.99)
  - A/NE-KTN/162 (21.12.12)
  - 會議日期  
DATE OF MEETING
  - 申請編號  
APPLICATION NUMBER
- 申請地點界線只作識別用  
APPLICATION SITE BOUNDARY  
FOR IDENTIFICATION PURPOSE ONLY

**位置圖 LOCATION PLAN**

臨時商店及服務行業 (售賣經改裝的貨櫃箱, 以及錦鯉、鋼門及鋁窗的陳列室) 及辦公室 (為期3年)  
古洞北青山公路丈量約份第 92 約地段第 540 號餘段(部分)及毗連政府土地  
TEMPORARY SHOP AND SERVICES (SELLING OF CONVERTED CONTAINER & SHOWROOMS FOR KOI, STEEL DOOR AND ALUMINIUM WINDOW) AND OFFICE FOR A PERIOD OF 3 YEARS  
LOT 540 RP (PART) IN D.D. 92 AND ADJOINING GOVERNMENT LAND, CASTLE PEAK ROAD, KWU TUNG NORTH

本摘要圖於2019年1月4日擬備, 所根據的資料為於2015年6月16日核准的分區計劃大綱圖編號S/KTN/2  
EXTRACT PLAN PREPARED ON 4.1.2019  
BASED ON OUTLINE ZONING PLAN  
No. S/KTN/2 APPROVED ON 16.6.2015

**規劃署  
PLANNING  
DEPARTMENT**



參考編號  
REFERENCE No.  
**A/KTN/58**

**圖 PLAN  
A-1**

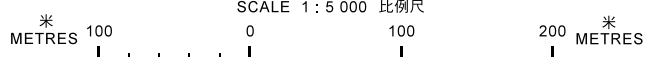



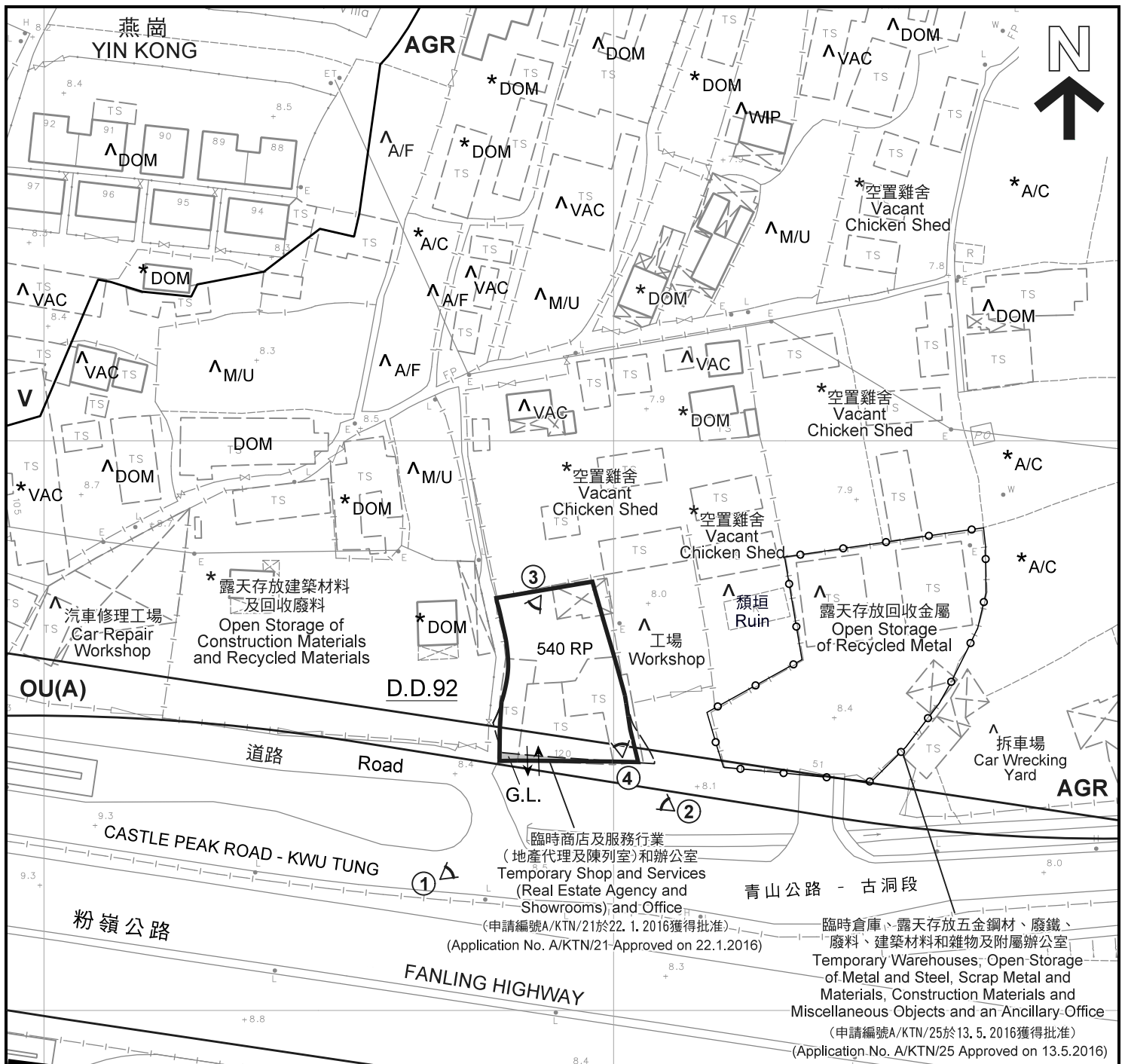

**圖例 LEGEND**

- 申請地點 (界線只作識別用)  
APPLICATION SITE (BOUNDARY FOR IDENTIFICATION PURPOSE ONLY)
- AGR** 農業  
AGRICULTURE
- V** 鄉村式發展  
VILLAGE TYPE DEVELOPMENT
- OU(A)** 其他指定用途(美化市容地帶)  
OTHER SPECIFIED USES (AMENITY AREA)
- A/C** 常耕農地  
ACTIVE AGRICULTURAL LAND
- A/F** 休耕農地  
FALLOW AGRICULTURAL LAND
- DOM** 住用構築物  
DOMESTIC STRUCTURE
- M/U** 荒地  
UNUSED LAND

- VAC** 空置  
VACANT
- G.L.** 政府土地  
GOVERNMENT LAND
- 入口/出口  
INGRESS / EGRESS
- 實地照片的觀景點  
VIEWING POINT OF SITE PHOTO

**註釋 Notes:**

- (1) 2019年4月3日勘測的土地用途  
Land uses shown on this plan are in accordance with the land use survey conducted by the Planning Department on 3.4.2019
- (2) \* 土地用途跟1992年勘測的土地用途一致  
Indicates that the use is the same as that revealed by the land use survey conducted by the Planning Department in 1992
- (3) ^ 土地用途跟1992年勘測的土地用途有別  
Indicates that the use is different from that revealed by the land use survey conducted by the Planning Department in 1992

**平面圖 SITE PLAN**

臨時商店及服務行業 (售賣經改裝的貨櫃箱, 以及錦鯉、鋼門及鋁窗的陳列室) 及辦公室 (為期3年)  
TEMPORARY SHOP AND SERVICES (SELLING OF CONVERTED CONTAINER & SHOWROOMS FOR KOI, STEEL DOOR AND ALUMINIUM WINDOW) AND OFFICE FOR A PERIOD OF 3 YEARS  
LOT 540 RP (PART) IN D.D. 92 AND ADJOINING GOVERNMENT LAND, CASTLE PEAK ROAD, KWU TUNG NORTH  
SCALE 1 : 1 000 比例尺

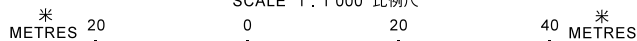

臨時倉庫、露天存放五金鋼材、廢鐵、廢料、建築材料和雜物及附屬辦公室  
Temporary Warehouses; Open-Storage of Metal and Steel, Scrap Metal and Materials, Construction Materials and Miscellaneous Objects and an Ancillary-Office  
(申請編號A/KTN/25於13. 5. 2016獲得批准)  
(Application No. A/KTN/25 Approved on 13.5.2016)

臨時商店及服務行業 (地產代理及陳列室) 和辦公室  
Temporary Shop and Services (Real Estate Agency and Showrooms) and Office  
(申請編號A/KTN/21於22. 1. 2016獲得批准)  
(Application No. A/KTN/21-Approved on 22.1.2016)

本摘要圖於2019年4月9日擬備，  
所根據的資料為測量圖編號  
2-SE-10B

EXTRACT PLAN PREPARED ON 9.4.2019  
BASED ON SURVEY SHEET No.  
2-SE-10B

規劃署  
PLANNING  
DEPARTMENT



參考編號  
REFERENCE No.  
A/KTN/58

圖 PLAN  
A-2





**圖例 LEGEND**

 申請地點 (界線只作識別用)  
APPLICATION SITE (BOUNDARY FOR IDENTIFICATION PURPOSE ONLY)

本摘要圖於2018年12月24日擬備，  
所根據的資料為地政總署  
於2018年3月27日拍得的航攝照片  
編號E040033C  
EXTRACT PLAN PREPARED ON 24.12.2018  
BASED ON AERIAL PHOTO No.E040033C  
TAKEN ON 27.3.2018 BY  
LANDS DEPARTMENT

**航攝照片 AERIAL PHOTO**

臨時商店及服務行業 (售賣經改裝的貨櫃箱，以及錦鯉、  
鋼門及鋁窗的陳列室) 及辦公室 (為期3年)  
古洞北青山公路丈量約份第 92 約地段第 540 號餘段 (部分) 及毗連政府土地  
TEMPORARY SHOP AND SERVICES (SELLING OF CONVERTED CONTAINER &  
SHOWROOMS FOR KOI, STEEL DOOR AND ALUMINIUM WINDOW)  
AND OFFICE FOR A PERIOD OF 3 YEARS  
LOT 540 RP (PART) IN D.D. 92 AND ADJOINING GOVERNMENT LAND,  
CASTLE PEAK ROAD, KWU TUNG NORTH

**規 劃 署**  
**PLANNING**  
**DEPARTMENT**



參考編號  
REFERENCE No.  
A/KTN/58

**圖 PLAN**  
**A-3**



申請地點  
APPLICATION SITE



申請地點  
APPLICATION SITE



申請地點界線只作識別用  
APPLICATION SITE BOUNDARY FOR IDENTIFICATION PURPOSE ONLY

實地照片 SITE PHOTO

本圖於2019年4月4日擬備，所根據的資料為攝於2019年4月3日的實地照片

PLAN PREPARED ON 4.4.2019 BASED ON SITE PHOTOS TAKEN ON 3.4.2019

臨時商店及服務行業（售賣經改裝的貨櫃箱，以及錦鯉、鋼門及鋁窗的陳列室）及辦公室（為期3年）  
古洞北青山公路丈量約份第 92 約地段第 540 號餘段（部分）及毗連政府土地  
TEMPORARY SHOP AND SERVICES (SELLING OF CONVERTED CONTAINER & SHOWROOMS FOR KOI, STEEL DOOR AND ALUMINIUM WINDOW) AND OFFICE FOR A PERIOD OF 3 YEARS  
LOT 540 RP (PART) IN D.D. 92 AND ADJOINING GOVERNMENT LAND, CASTLE PEAK ROAD, KWU TUNG NORTH

規劃署  
PLANNING  
DEPARTMENT



參考編號  
REFERENCE No.  
A/KTN/58

圖 PLAN  
A-4a





申請地點  
APPLICATION SITE

3



申請地點  
APPLICATION SITE

4

實地照片 SITE PHOTO

本圖於2019年4月4日擬備，所根據的資料為攝於2019年4月3日的實地照片

PLAN PREPARED ON 4.4.2019 BASED ON SITE PHOTOS TAKEN ON 3.4.2019

臨時商店及服務行業（售賣經改裝的貨櫃箱，以及錦鯉、鋼門及鋁窗的陳列室）及辦公室（為期3年）  
古洞北青山公路丈量約份第 92 約地段第 540 號餘段(部分)及毗連政府土地  
TEMPORARY SHOP AND SERVICES (SELLING OF CONVERTED CONTAINER & SHOWROOMS FOR KOI, STEEL DOOR AND ALUMINIUM WINDOW) AND OFFICE FOR A PERIOD OF 3 YEARS  
LOT 540 RP (PART) IN D.D. 92 AND ADJOINING GOVERNMENT LAND, CASTLE PEAK ROAD, KWU TUNG NORTH

規劃署  
PLANNING  
DEPARTMENT



參考編號  
REFERENCE No.  
A/KTN/58

圖 PLAN  
A-4b