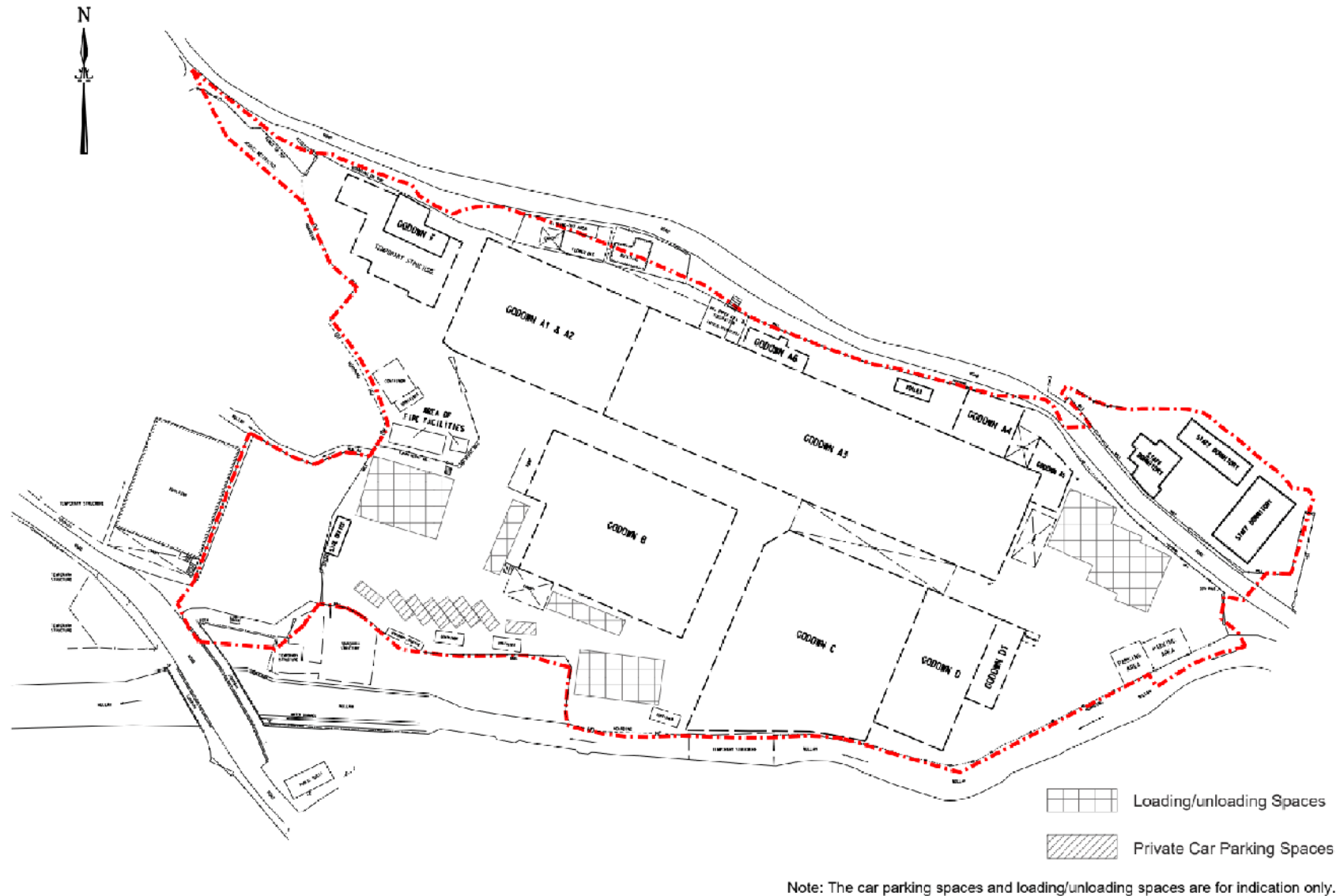

Figure 3.1 Layout Plan



Existing Layout of 22 private Lots in D.D.100 and the Adjoining Government Land in Ying Pun, Kwu Tung South

SCALE 1:800 AT A3

(資料來源:申請人於 3.4.2020 呈交的資料)  
(Source : Applicant's Submission of 3.4.2020)

參考編號  
REFERENCE No.  
A/NE-KTS/486

繪圖 DRAWING  
A-1

**LEGEND:**

- - - PROPOSED APPLICATION BOUNDARY
- PROPOSED EDGE OF FOOTPATH
- EXISTING TRAFFIC SIGN
- EXISTING GUIDE KIOSK
- EXISTING CAMERA
- PROPOSED CAMERA
- EXISTING CONVEX MIRROR
- PROPOSED CONVEX MIRROR
- EXISTING REMOVABLE TRAFFIC BOLLARD
- EXISTING TRAFFIC HAZARD WARNING LIGHT
- PROPOSED DROP-KERB
- PROPOSED TYPE II RAILING
- PROPOSED SHORT TERM TENANCY

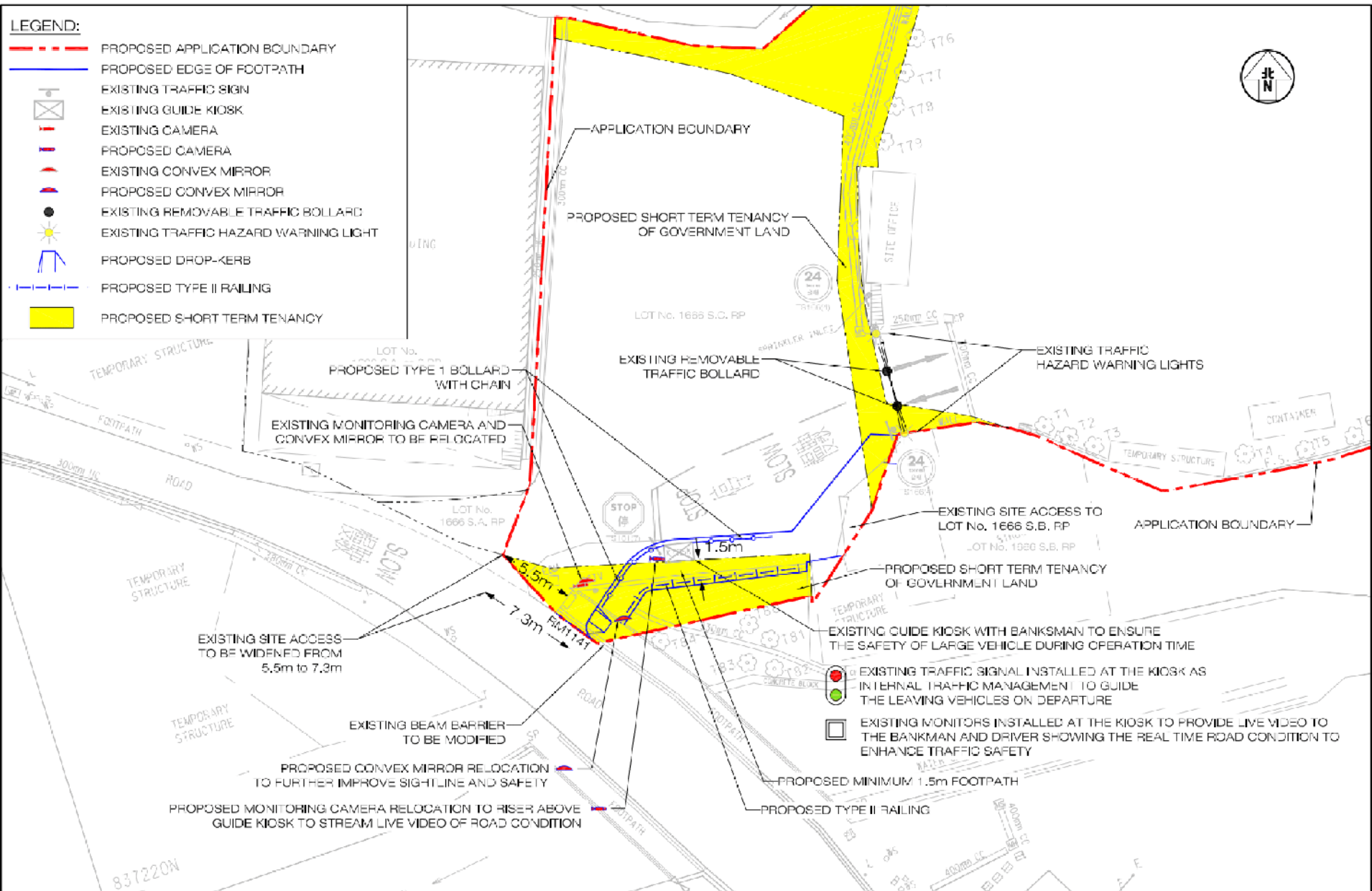

Project Title S16 Planning Application for Temporary Godown with Ancillary Office and Staff Quarters for a Period of 3 Years at Various Lots in D.D.100 and Adjoining Government Land, Ying Pun, Kwu Tung South, N.T.

Figure Title

**UPDATED TRAFFIC IMPROVEMENT MEASURE PROPOSAL AT THE SHORT TERM TENANCY**

Figure No.	101	Revision	A	<b>CKM Asia Limited</b> Traffic and Transportation Planning Consultants 21st Floor, Methodist House, 36 Hennessy Road Wan Chai, Hong Kong Tel: (852) 2570 5900 Fax: (852) 2570 6744 Email: mail@ckmasia.com.hk
Designed by	W C H	Drawn by	S C Y	
Checked by	K C			
Scale in A3	1 : 250	Date	25 FEB 2020	

(資料來源:申請人於 3. 4. 2020 呈交的資料)  
 (Source : Applicant's Submission of 3.4.2020)

參考編號 REFERENCE No. <b>A/NE-KTS/486</b>	繪圖 DRAWING <b>A-2</b>
--	--------------------------

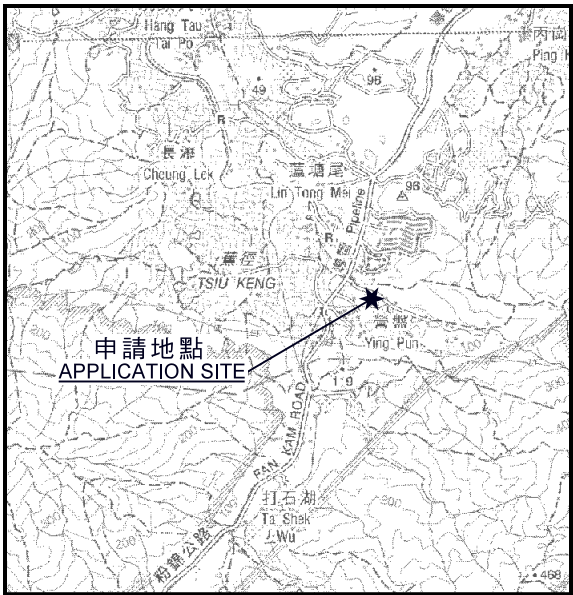
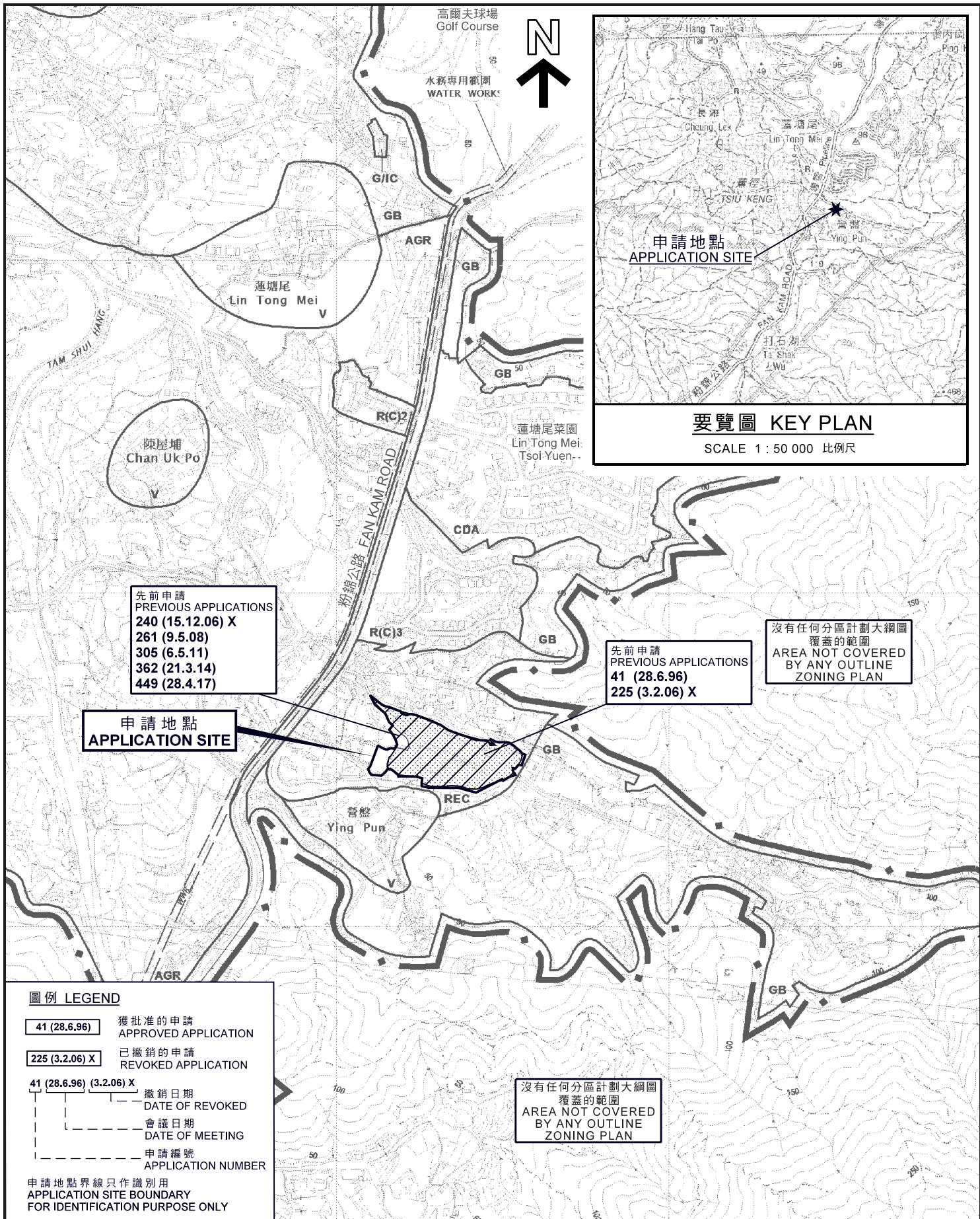

**要覽圖 KEY PLAN**

SCALE 1 : 50 000 比例尺

先前申請  
PREVIOUS APPLICATIONS  
240 (15.12.06) X  
261 (9.5.08)  
305 (6.5.11)  
362 (21.3.14)  
449 (28.4.17)

申請地點  
APPLICATION SITE

先前申請  
PREVIOUS APPLICATIONS  
41 (28.6.96)  
225 (3.2.06) X

沒有任何分區計劃大綱圖  
覆蓋的範圍  
AREA NOT COVERED  
BY ANY OUTLINE  
ZONING PLAN

沒有任何分區計劃大綱圖  
覆蓋的範圍  
AREA NOT COVERED  
BY ANY OUTLINE  
ZONING PLAN

**圖例 LEGEND**

- 41 (28.6.96) 獲批准的申請  
APPROVED APPLICATION
- 225 (3.2.06) X 已撤銷的申請  
REVOKED APPLICATION
- 41 (28.6.96) (3.2.06) X 撤銷日期  
DATE OF REVOKED
- 會議日期  
DATE OF MEETING
- 申請編號  
APPLICATION NUMBER

申請地點界線只作識別用  
APPLICATION SITE BOUNDARY  
FOR IDENTIFICATION PURPOSE ONLY

**位置圖 LOCATION PLAN**

臨時貨倉連附屬辦公室及員工宿舍用途(為期3年)  
古洞南營盤丈量約份第100約多幅地段和毗連政府土地  
TEMPORARY GODOWN WITH ANCILLARY OFFICE  
AND STAFF QUARTERS USE FOR A PERIOD OF 3 YEARS  
VARIOUS LOTS IN D.D.100 AND ADJOINING GOVERNMENT LAND,  
YING PUN, KWU TUNG SOUTH

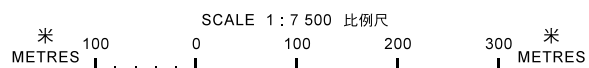

規劃署  
PLANNING  
DEPARTMENT



參考編號  
REFERENCE No.  
A/NE-KTS/486

圖 PLAN  
A-1

本摘要圖於2020年5月14日擬備，  
所根據的資料為於2018年1月30日展示的分區計劃大綱圖編號S/NE-KTS/16  
EXTRACT PLAN PREPARED ON 14.5.2020  
BASED ON OUTLINE ZONING PLAN  
No. S/NE-KTS/16 EXHIBITED ON 30.1.2018

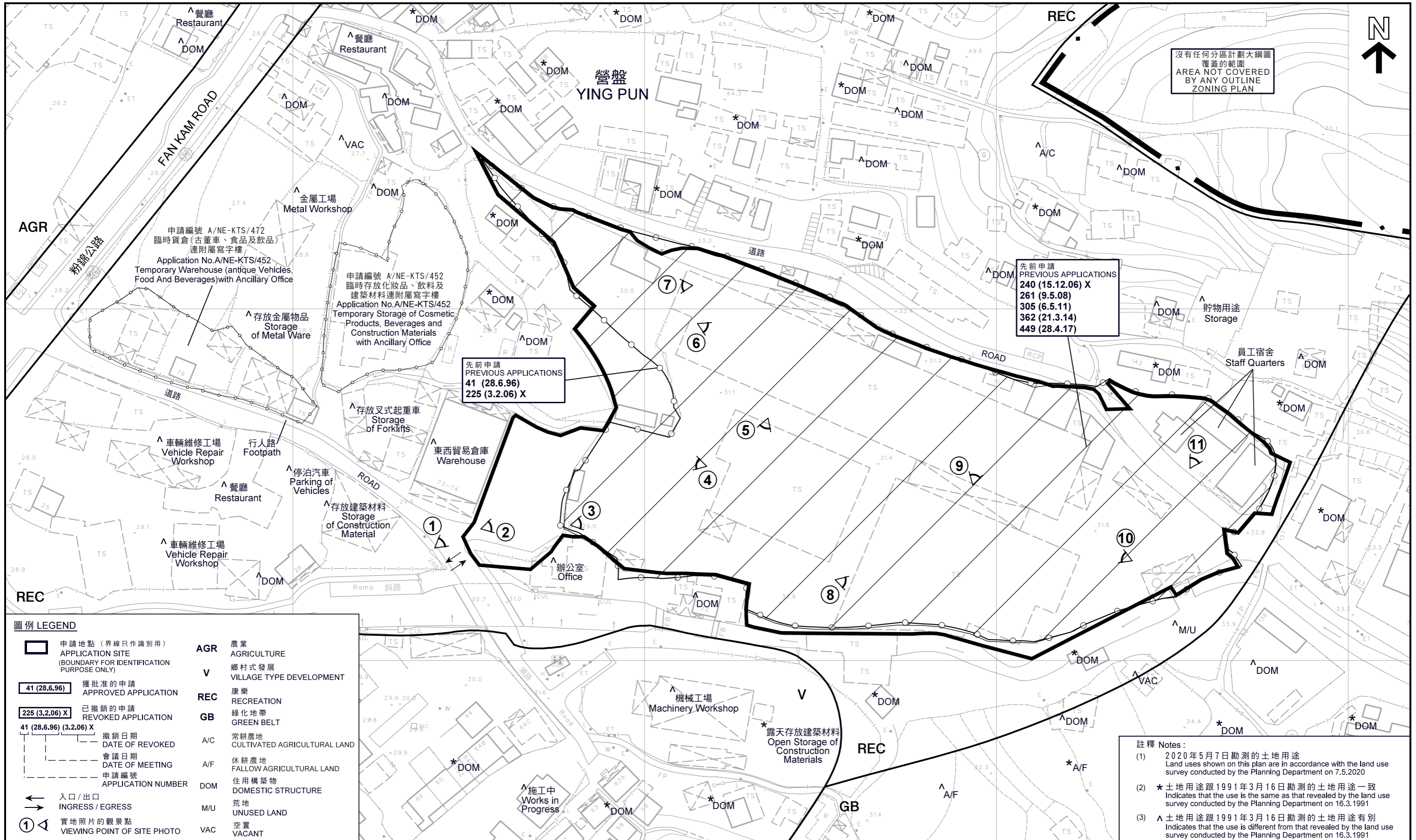

平面圖 SITE PLAN

臨時貨倉連附屬辦公室及員工宿舍用途(為期3年)  
古洞南營盤丈量約份第100約多幅地段和毗連政府土地  
TEMPORARY GODOWN WITH ANCILLARY OFFICE AND STAFF QUARTERS USE FOR A PERIOD OF 3 YEARS  
VARIOUS LOTS IN D.D.100 AND ADJOINING GOVERNMENT LAND, YING PUN, KWU TUNG SOUTH

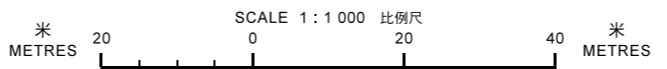

本摘要圖於2020年5月14日擬備，  
所根據的資料為測量圖編號  
2-SE-20D及25B  
EXTRACT PLAN PREPARED ON 14.5.2020  
BASED ON SURVEY SHEETS No.  
2-SE-20D AND 25B

規劃署  
PLANNING  
DEPARTMENT



參考編號  
REFERENCE No.  
A/NE-KTS/486

圖 PLAN  
A-2a

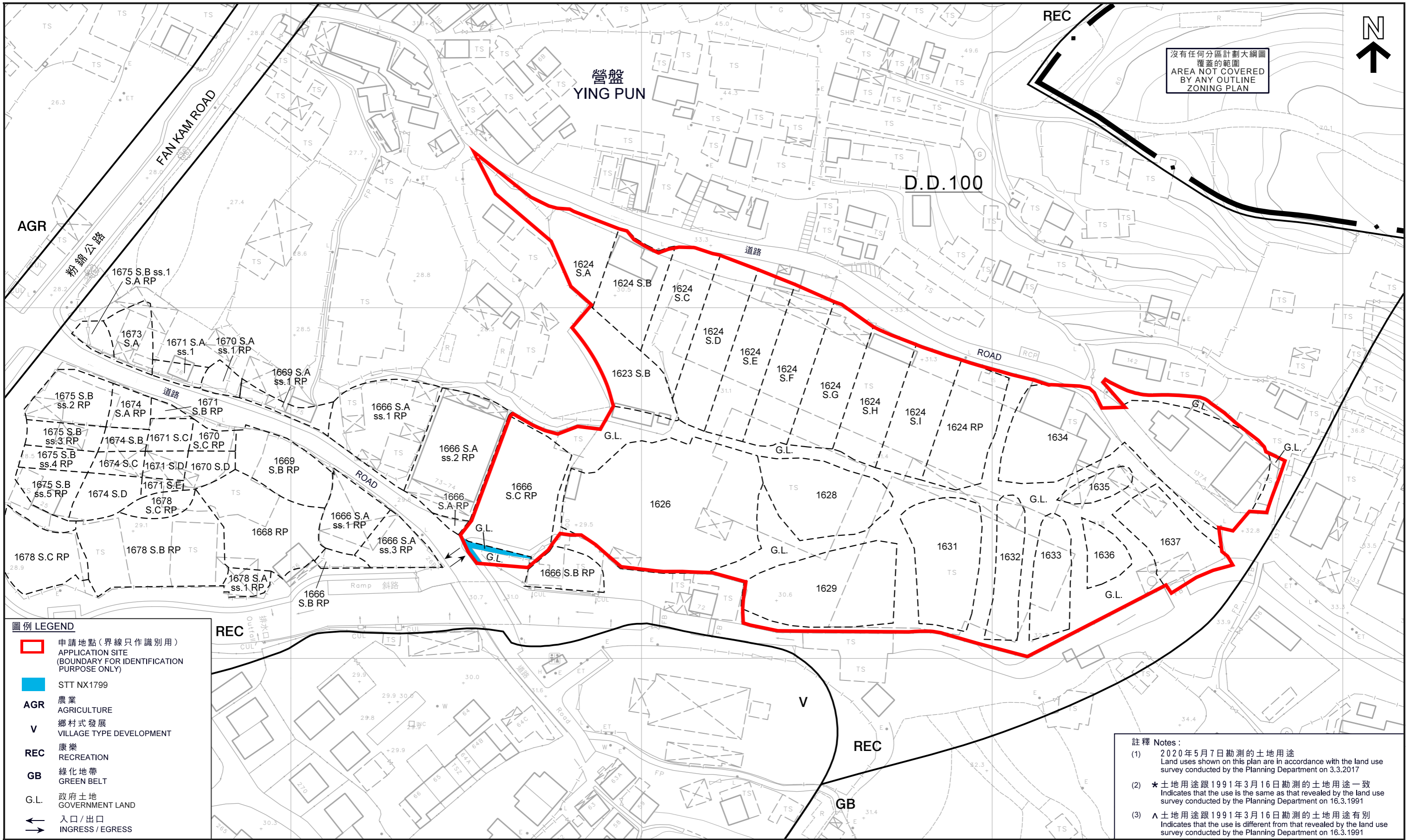

沒有任何分區計劃大綱圖  
覆蓋的範圍  
AREA NOT COVERED  
BY ANY OUTLINE  
ZONING PLAN

- 圖例 LEGEND**
- 申請地點(界線只作識別用)  
APPLICATION SITE (BOUNDARY FOR IDENTIFICATION PURPOSE ONLY)
  - STT NX1799
  - AGR** 農業  
AGRICULTURE
  - V** 鄉村式發展  
VILLAGE TYPE DEVELOPMENT
  - REC** 康樂  
RECREATION
  - GB** 綠化地帶  
GREEN BELT
  - G.L.** 政府土地  
GOVERNMENT LAND
  - 入口/出口  
INGRESS / EGRESS

- 註釋 Notes:**
- (1) 2020年5月7日勘測的土地用途  
Land uses shown on this plan are in accordance with the land use survey conducted by the Planning Department on 3.3.2017
  - (2) \* 土地用途跟1991年3月16日勘測的土地用途一致  
Indicates that the use is the same as that revealed by the land use survey conducted by the Planning Department on 16.3.1991
  - (3) ^ 土地用途跟1991年3月16日勘測的土地用途有別  
Indicates that the use is different from that revealed by the land use survey conducted by the Planning Department on 16.3.1991

**申請地點內和出入口附近的私家地段 PRIVATE LOTS IN THE SITE AND NEAR THE INGRESS / EGRESS**

本摘要圖於2020年5月21日擬備，  
所根據的資料為測量圖編號  
2-SE-20D及25B  
EXTRACT PLAN PREPARED ON 21.5.2020  
BASED ON SURVEY SHEETS No.  
2-SE-20D AND 25B

臨時貨倉連附屬辦公室及員工宿舍用途(為期3年)  
古洞南營盤丈量約份第100約多幅地段和毗連政府土地  
TEMPORARY GODOWN WITH ANCILLARY OFFICE AND STAFF QUARTERS USE FOR A PERIOD OF 3 YEARS  
VARIOUS LOTS IN D.D.100 AND ADJOINING GOVERNMENT LAND, YING PUN, KWU TUNG SOUTH

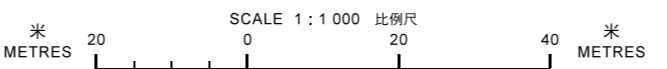

規劃署  
**PLANNING DEPARTMENT**

參考編號  
REFERENCE No.  
**A/NE-KTS/486**

圖 **PLAN**  
**A-2b**



**圖例 LEGEND**  
 申請地點 (界線只作識別用)  
 APPLICATION SITE  
 (BOUNDARY FOR IDENTIFICATION  
 PURPOSE ONLY)

航攝照片 AERIAL PHOTO

本摘要圖於2020年5月14日擬備，  
 所根據的資料為地政總署  
 於2019年9月26日拍得的航攝照片  
 編號E065242C  
 EXTRACT PLAN PREPARED ON 14.5.2020  
 BASED ON AERIAL PHOTO No. E065242C  
 TAKEN ON 26.9.2019 BY  
 LANDS DEPARTMENT

臨時貨倉連附屬辦公室及員工宿舍用途(為期3年)  
 古洞南營盤丈量約份第100約多幅地段和毗連政府土地  
 TEMPORARY GODOWN WITH ANCILLARY OFFICE AND STAFF QUARTERS USE FOR A PERIOD OF 3 YEARS  
 VARIOUS LOTS IN D.D.100 AND ADJOINING GOVERNMENT LAND, YING PUN, KWU TUNG SOUTH

規劃署  
 PLANNING  
 DEPARTMENT



參考編號  
 REFERENCE No.  
 A/NE-KTS/486

圖 PLAN  
 A-3



申請地點界線只作識別用  
APPLICATION SITE BOUNDARY FOR IDENTIFICATION PURPOSE ONLY

**實地照片 SITE PHOTO**

本圖於2020年5月14日擬備，所根據的資料為攝於2020年5月7日的實地照片

PLAN PREPARED ON 14.5.2020 BASED ON SITE PHOTOS TAKEN ON 7.5.2020

臨時貨倉連附屬辦公室及員工宿舍用途(為期3年)  
古洞南營盤丈量約份第100約多幅地段和毗連政府土地  
TEMPORARY GODOWN WITH ANCILLARY OFFICE  
AND STAFF QUARTERS USE FOR A PERIOD OF 3 YEARS  
VARIOUS LOTS IN D.D.100 AND ADJOINING GOVERNMENT LAND,  
YING PUN, KWU TUNG SOUTH

**規劃署  
PLANNING  
DEPARTMENT**



參考編號  
REFERENCE No.  
**A/NE-KTS/486**

圖 **PLAN  
A-4a**



**實地照片 SITE PHOTO**

本圖於2020年5月14日擬備，所根據的資料為攝於2020年5月7日的實地照片

PLAN PREPARED ON 14.5.2020 BASED ON SITE PHOTOS TAKEN ON 7.5.2020

臨時貨倉連附屬辦公室及員工宿舍用途(為期3年)  
古洞南營盤丈量約份第100約多幅地段和毗連政府土地  
TEMPORARY GODOWN WITH ANCILLARY OFFICE  
AND STAFF QUARTERS USE FOR A PERIOD OF 3 YEARS  
VARIOUS LOTS IN D.D.100 AND ADJOINING GOVERNMENT LAND,  
YING PUN, KWU TUNG SOUTH

**規劃署  
PLANNING  
DEPARTMENT**



參考編號  
REFERENCE No.  
**A/NE-KTS/486**

**圖 PLAN  
A-4b**





實地照片 SITE PHOTO

本圖於2020年5月14日擬備，所根據的資料為攝於2020年5月7日的實地照片

PLAN PREPARED ON 14.5.2020 BASED ON SITE PHOTOS TAKEN ON 7.5.2020

臨時貨倉連附屬辦公室及員工宿舍用途(為期3年)  
古洞南營盤丈量約份第100約多幅地段和毗連政府土地  
TEMPORARY GODOWN WITH ANCILLARY OFFICE  
AND STAFF QUARTERS USE FOR A PERIOD OF 3 YEARS  
VARIOUS LOTS IN D.D.100 AND ADJOINING GOVERNMENT LAND,  
YING PUN, KWU TUNG SOUTH

規劃署  
PLANNING  
DEPARTMENT



參考編號  
REFERENCE No.  
A/NE-KTS/486

圖 PLAN  
A-4c