

DEVELOPMENT PARAMETERS

APPLICATION SITE AREA: 1,757m² (ABOUT)
COVERED AREA: 325.2m² (ABOUT)
UNCOVERED AREA: 1,431.8m² (ABOUT)

NO. OF STRUCTURE: 4
DOMESTIC GFA: N/A
NON-DOMESTIC GFA: 469.2m² (ABOUT)
BUILDING HEIGHT: 3.5 - 7m (ABOUT)
NO. OF STOREY: 1 - 2

NO. OF PRIVATE CAR PARKING SPACE (2.5m X 5m): 3
NO. OF L/UL SPACE FOR LGV (3.5m X 7m): 1

Plan 2

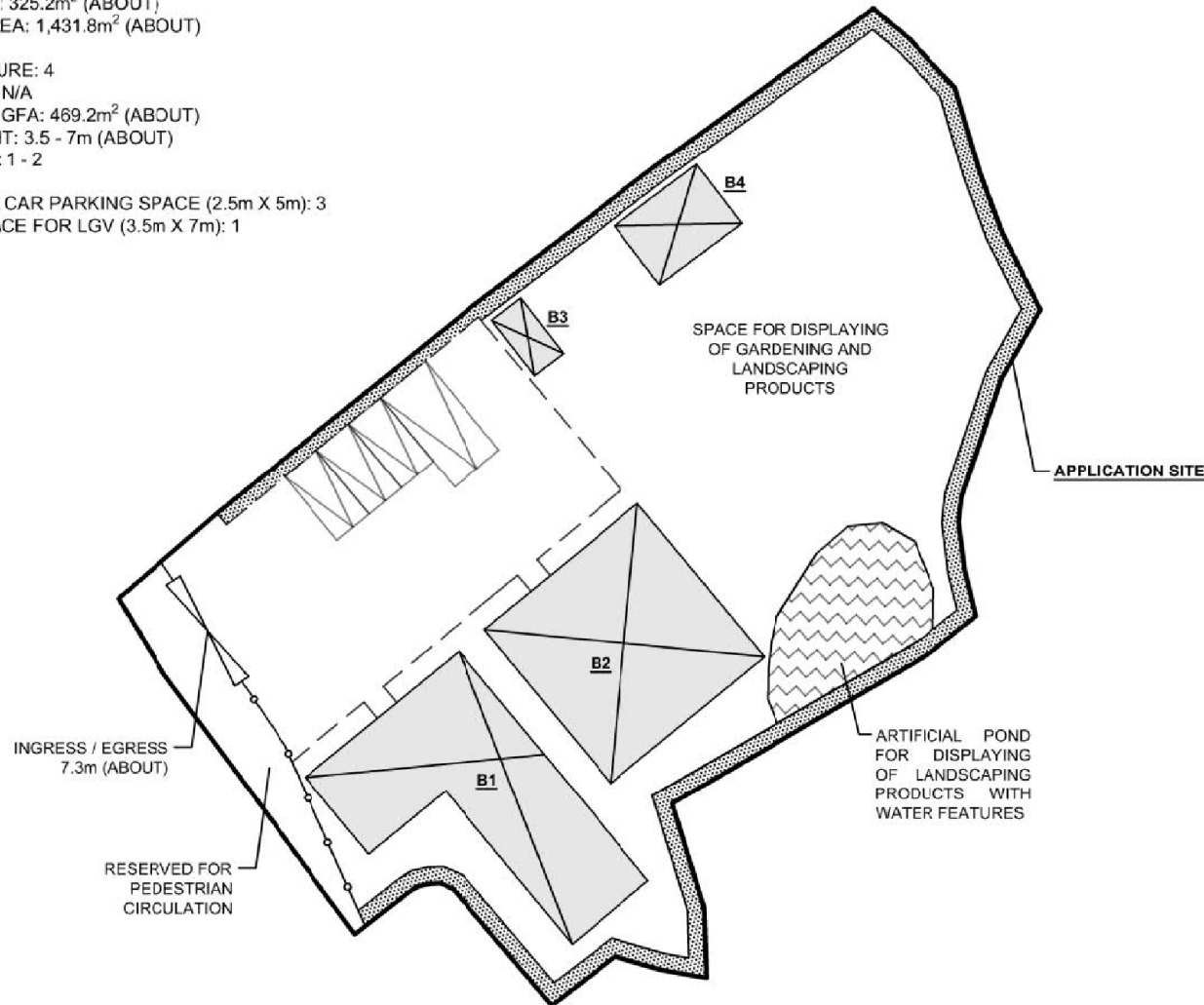
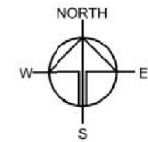

STRUCTURE	USE	COVERED AREA	GFA	BUILDING HEIGHT
B1	ANCILARY OFFICE	144m ² (ABOUT)	216m ² (ABOUT)	7m (ABOUT)(2-STOREY)
B2	SHOP AND SERVICES & TOILET	144m ² (ABOUT)	216m ² (ABOUT)	7m (ABOUT)(2-STOREY)
B3	CARETAKER OFFICE	9.3m ² (ABOUT)	9.3m ² (ABOUT)	3.5m (ABOUT)(1-STOREY)
B4	STORAGE OF GOODS	27.9m ² (ABOUT)	27.3m ² (ABOUT)	3.5m (ABOUT)(1-STOREY)
TOTAL		325.2m ² (ABOUT)	469.2m ² (ABOUT)	

LEGEND

	STRUCTURE
	PARKING / L/UL SPACE
	ARTIFICIAL POND
	LANDSCAPE BELT

Drawing No.	Ver.
P02	01
Project	
PROPOSED TEMPORARY SHOP AND SERVICES (LANDSCAPING AND GARDENING SHOWROOM) FOR A PERIOD OF 3 YEARS AND LAND FILLING	
LOT 1892 RP IN D.D. 106 AND ADJACINING G.L.	
Drawing Title	
LAYOUT PLAN	
Scale of A4	
1:400	
Drawn	Date
	10.10.2019
Revised	Date
	9.12.2019

(摘錄自申請人於 9. 12. 2019 呈交的進一步資料)
(Extract from Applicant's Further Information Submitted on 9.12.2019)

參考編號
REFERENCE No.
A/YL-KTS/833

繪圖 DRAWING
A-1

Plan 3

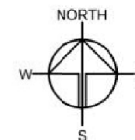

DEVELOPMENT PARAMETERS

APPLICATION SITE AREA: 1,757m² (ABOUT)
COVERED AREA: 325.2m² (ABOUT)
UNCOVERED AREA: 1,431.8m² (ABOUT)

NO. OF STRUCTURE: 4
DOMESTIC GFA: N/A
NON-DOMESTIC GFA: 469.2m² (ABOUT)
BUILDING HEIGHT: 3.5 - 7m (ABOUT)
NO. OF STOREY: 1 - 2

STRUCTURE	USE	COVERED AREA	GFA	BUILDING HEIGHT
B1	ANCILARY OFFICE	144m ² (ABOUT)	216m ² (ABOUT)	7m (ABOUT)(2-STOREY)
B2	SHOP AND SERVICES & TOILET	144m ² (ABOUT)	216m ² (ABOUT)	7m (ABOUT)(2-STOREY)
B3	CARETAKER OFFICE	9.3m ² (ABOUT)	9.3m ² (ABOUT)	3.5m (ABOUT)(1-STOREY)
B4	STORAGE OF GOODS	27.9m ² (ABOUT)	27.9m ² (ABOUT)	3.5m (ABOUT)(1-STOREY)
TOTAL		325.2m ² (ABOUT)	469.2m ² (ABOUT)	

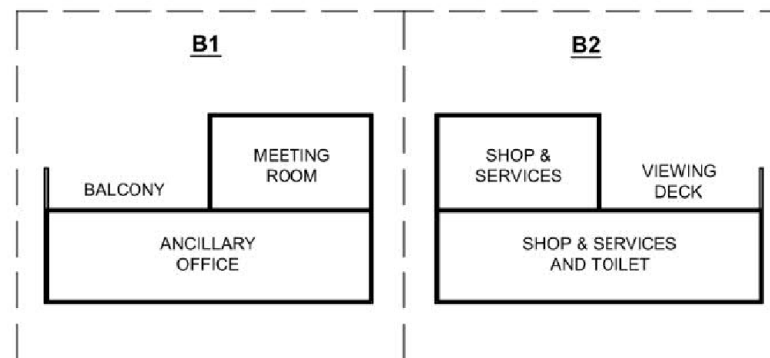
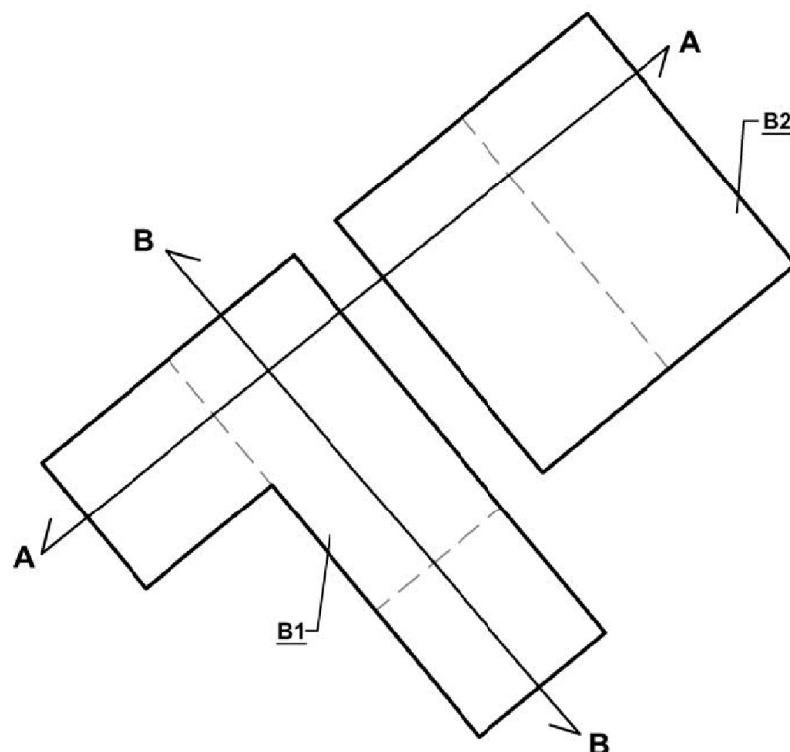

SECTION A-A

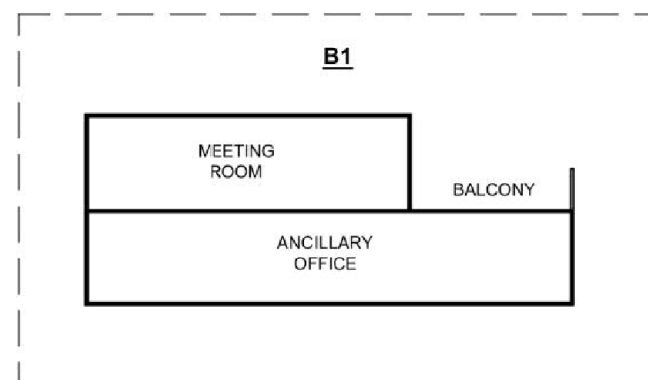

SECTION B-B

Drawing No.	Ver.
P03	01
Project	
PROPOSED TEMPORARY SHOP AND SERVICES (LANDSCAPING AND GARDENING SHOWROOM) FOR A PERIOD OF 3 YEARS AND LAND FILLING	
LOT 1892 RP IN D.D. 106 AND ADJACING G.L.	
Drawing Title	
LAYOUT PLAN	
Scale of A1	
1:250	
Drawn	Date
	10.10.2019
Revised	Date
	9.12.2019

(摘錄自申請人於 9.12.2019 呈交的進一步資料)
(Extract from Applicant's Further Information Submitted on 9.12.2019)

參考編號
REFERENCE No.
A/YL-KTS/833

繪圖 DRAWING
A-2

PROPOSED PAVED RATIO OF THE SITE

APPLICATION SITE AREA	: 1,757m ² (ABOUT)
EXISTING SOILED GROUND AREA	: 1,689m ² (96%)(ABOUT)
EXISTING HARD-PAVED AREA	: 68m ² (4%)(ABOUT)
PROPOSED SOILED GROUND AREA	: 785m ² (45%)(ABOUT)
PROPOSED HARD-PAVED AREA*	: 738m ² (42%)(ABOUT)
PROPOSED ARTIFICIAL POND	: 75m ² (4%)(ABOUT)
PROPOSED LANDSCAPING AREA	: 159m ² (9%)(ABOUT)

*INCLUDING EXISTING HARD-PAVED AREA

THE SITE WILL BE REINSTATED TO AN AMENITY AREA AFTER THE PLANNING APPROVAL PERIOD. ALL THE HARD-PAVING WILL BE REMOVED AND LAND WILL BE REINSTATED FOR AGRICULTURAL PURPOSE.

Plan 4

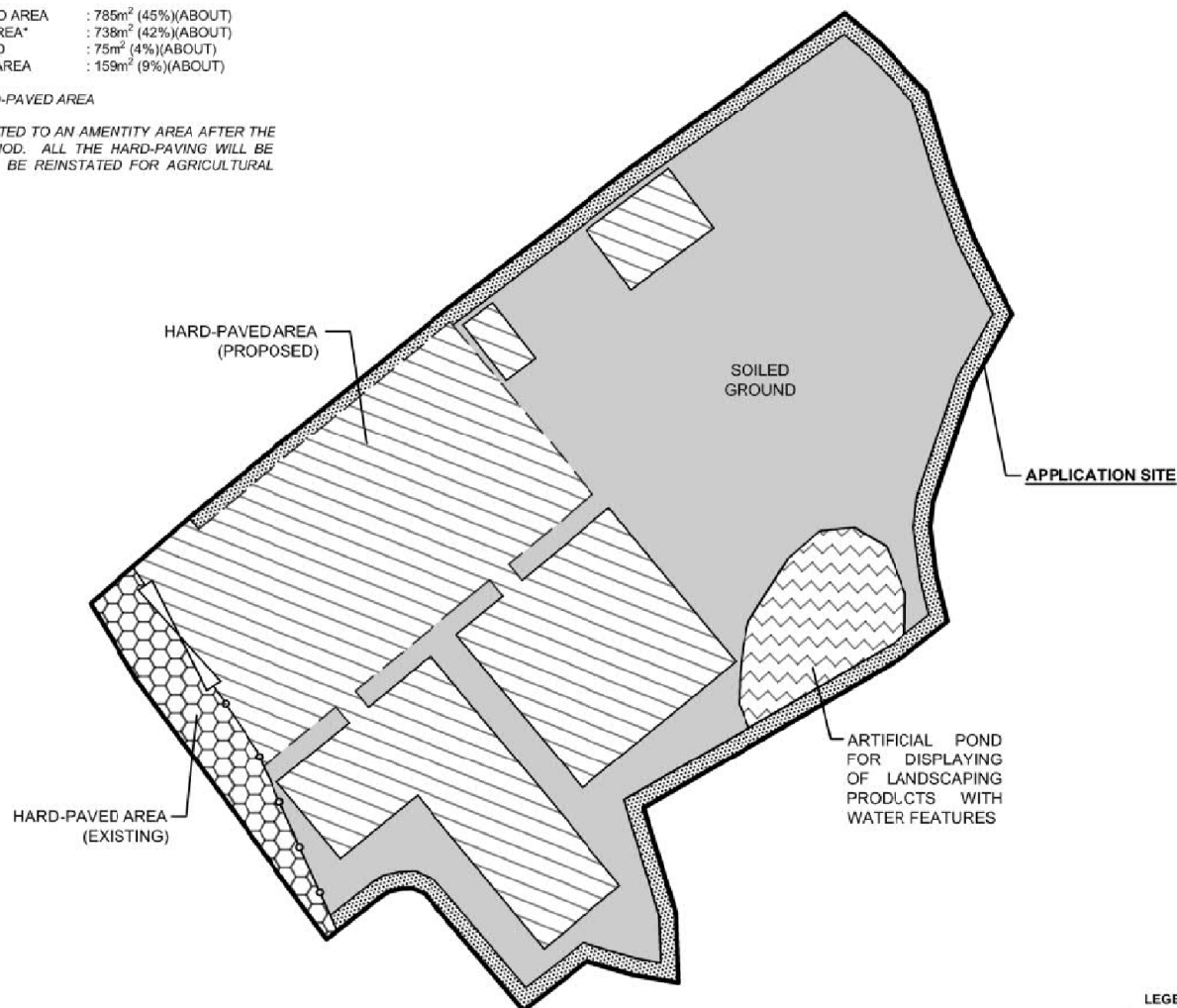
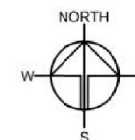

LEGEND	
	HARD-PAVED AREA (PROPOSED)
	HARD-PAVED AREA (EXISTING)
	SOILED GROUND
	ARTIFICIAL POND
	LANDSCAPE BELT

Drawing No.	Ver.
04	01
Project	
PROPOSED TEMPORARY SHOP AND SERVICES (LANDSCAPING AND GARDENING SHOWROOM) FOR A PERIOD OF 3 YEARS AND LAND FILLING	
LOT 1892 RP IN D.D. 106 AND ADJACINING G.L.	
Drawing Title	
PROPOSED PAVED RATIO	
Scale of A4	
1:400	
Drawn	Date
	4.12.2019
Revised	Date
	9.12.2019

(摘錄自申請人於 9. 12. 2019 呈交的進一步資料)
(Extract from Applicant's Further Information Submitted on 9.12.2019)

參考編號
REFERENCE No.
A/YL-KTS/833

繪圖 DRAWING
A-3

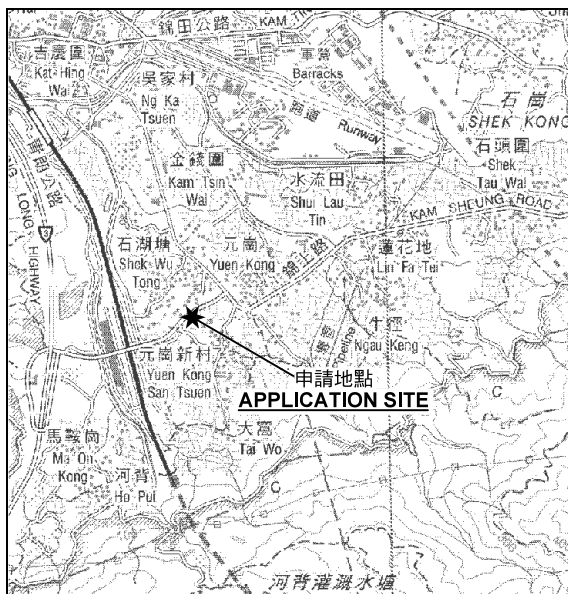
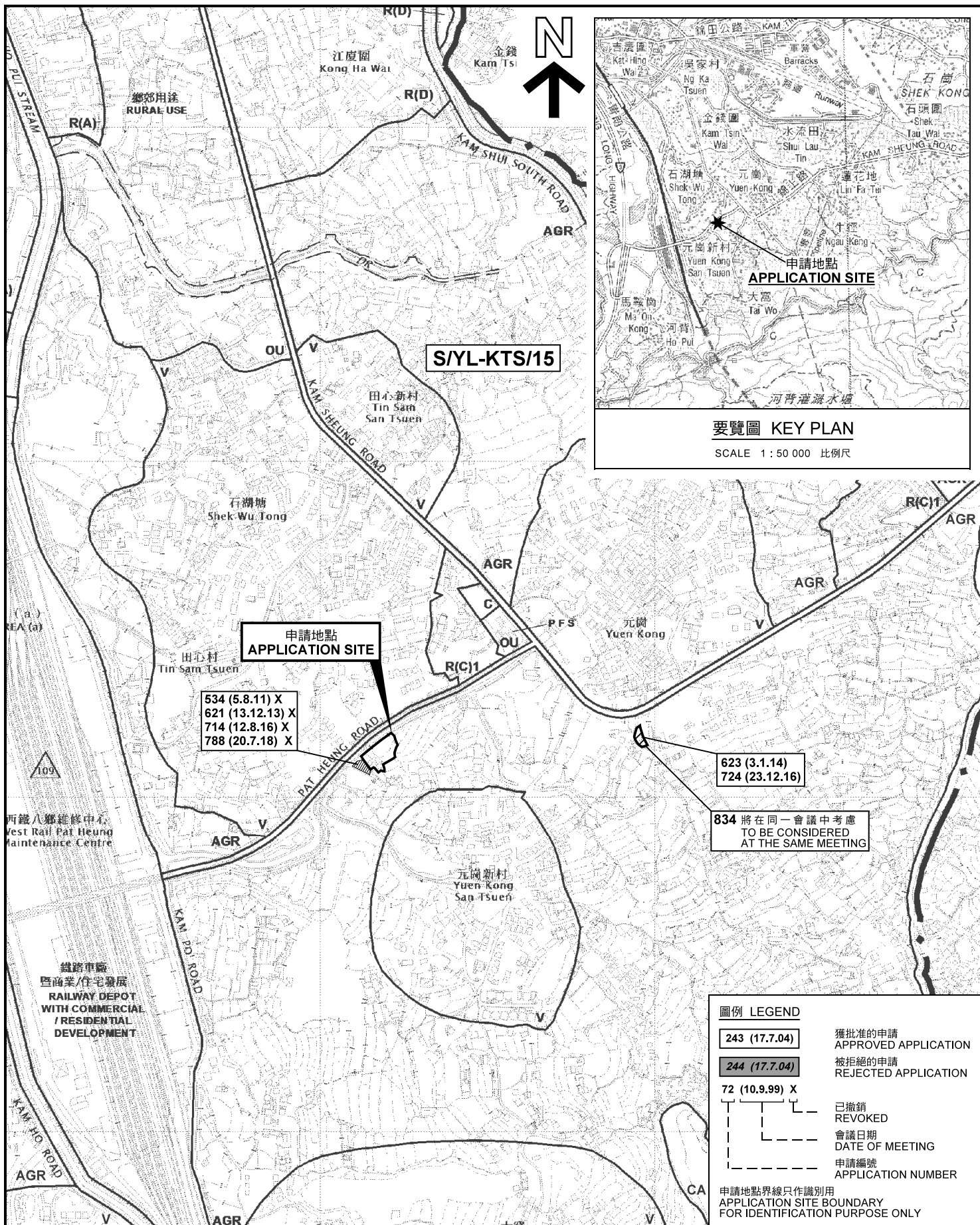

位置圖及同類申請 LOCATION PLAN WITH SIMILAR APPLICATIONS

擬議臨時商店及服務行業
(綠化及園藝陳列室) (為期3年) 及填土
元朗八鄉丈量約份第106約地段第1892號餘段
PROPOSED TEMPORARY SHOP AND SERVICES
(LANDSCAPING AND GARDENING SHOWROOM)
FOR A PERIOD OF 3 YEARS AND LAND FILLING
LOT 1892 RP IN D.D. 106, PAT HEUNG, YUEN LONG

SCALE 1 : 7 500 比例尺

米 100 0 100 200 300 米
METRES

本摘要圖於2019年12月10日擬備，
所根據的資料為於2018年12月11日
核准的分區計劃大綱圖編號 S/YL-KTS/15
EXTRACT PLAN PREPARED ON 10.12.2019
BASED ON OUTLINE ZONING PLAN No.
S/YL-KTS/15 APPROVED ON 11.12.2018

**規劃署
PLANNING
DEPARTMENT**



參考編號
REFERENCE No.
A/YL-KTS/833

圖 PLAN
A-1



本摘要圖於2019年12月9日擬備，所根據的資料為地政總署於2018年3月22日拍得的航攝照片編號 E036622C
EXTRACT PLAN PREPARED ON 9.12.2019
BASED ON AERIAL PHOTO No.
E036622C TAKEN ON 22.3.2018
BY LANDS DEPARTMENT

航攝照片 AERIAL PHOTO

擬議臨時商店及服務行業
(綠化及園藝陳列室) (為期3年) 及填土
元朗八鄉丈量約份第106約地段第1892號餘段
PROPOSED TEMPORARY SHOP AND SERVICES
(LANDSCAPING AND GARDENING SHOWROOM)
FOR A PERIOD OF 3 YEARS AND LAND FILLING
LOT 1892 RP IN D.D. 106, PAT HEUNG, YUEN LONG

**規劃署
PLANNING
DEPARTMENT**

參考編號
REFERENCE No.
AYL-KTS/833

**圖 PLAN
A-3**



申請地點界線只作識別用 APPLICATION SITE BOUNDARY FOR IDENTIFICATION PURPOSE ONLY

實地照片 SITE PHOTOS

本圖於2019年12月9日擬備，所根據的資料為攝於2019年10月25日的實地照片
PLAN PREPARED ON 9.12.2019
BASED ON SITE PHOTOS
TAKEN ON 25.10.2019

擬議臨時商店及服務行業
(綠化及園藝陳列室) (為期3年) 及填土
元朗八鄉丈量約份第106約地段第1892號餘段
PROPOSED TEMPORARY SHOP AND SERVICES
(LANDSCAPING AND GARDENING SHOWROOM)
FOR A PERIOD OF 3 YEARS AND LAND FILLING
LOT 1892 RP IN D.D. 106, PAT HEUNG, YUEN LONG

規劃署
PLANNING
DEPARTMENT



參考編號
REFERENCE No.
AYL-KTS/833

圖 PLAN
A-4a



申請地點界線只作識別用 APPLICATION SITE BOUNDARY FOR IDENTIFICATION PURPOSE ONLY

實地照片 SITE PHOTOS

擬議臨時商店及服務行業
(綠化及園藝陳列室) (為期3年) 及填土
元朗八鄉丈量約份第106約地段第1892號餘段
PROPOSED TEMPORARY SHOP AND SERVICES
(LANDSCAPING AND GARDENING SHOWROOM)
FOR A PERIOD OF 3 YEARS AND LAND FILLING
LOT 1892 RP IN D.D. 106, PAT HEUNG, YUEN LONG

規 劃 署
PLANNING
DEPARTMENT



參考編號
REFERENCE No.
AYL-KTS/833

圖 PLAN
A-4b

本圖於2019年12月9日擬備，所根據的
資料為攝於2019年10月25日的實地照片
PLAN PREPARED ON 9.12.2019
BASED ON SITE PHOTOS
TAKEN ON 25.10.2019