

1:200	Site Plan	Goldrich Planners & Surveyors Ltd.
February 2019	Lot 225 D (Part) in D. D. 112 Kam Sheung Road, Yuen Long	Plan 3 (A 9027)

(資料來源:申請人於 7.3.2019 呈交的資料)
(Source : Applicant's Submission of 7.3.2019)

參考編號
REFERENCE No.
AYL-SK/253

繪圖 DRAWING
A-1



Kam Sheung Road

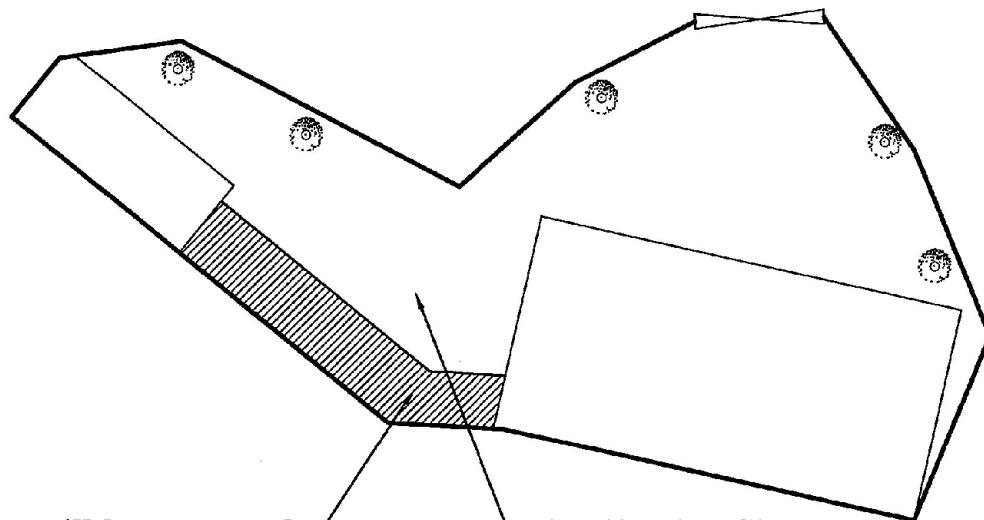

No tree will be proposed
(Underground Facilities)

Application Site

Note: Landscape works has been approved on 6th October 2011 (A/YL-SK/160)
The existing trees on site are well maintained.

Existing Trees on Site	Species	Size	Quantity
	 Ficus Microcarpa (細葉榕)	4m (Distance), 2.75m (H)	5 nos.
1:200	Landscape and Tree Preservation Plan Lot 225 D (Part) in D. D. 112 Kam Sheung Road, Yuen Long		Goldrich Planners & Surveyors Ltd.
February 2019			Plan 4 (A 9027)

(資料來源:申請人於 7.3.2019 提交的資料)
(Source : Applicant's Submission of 7.3.2019)

參考編號
REFERENCE No.
A/YL-SK/253

繪圖 DRAWING
A-2

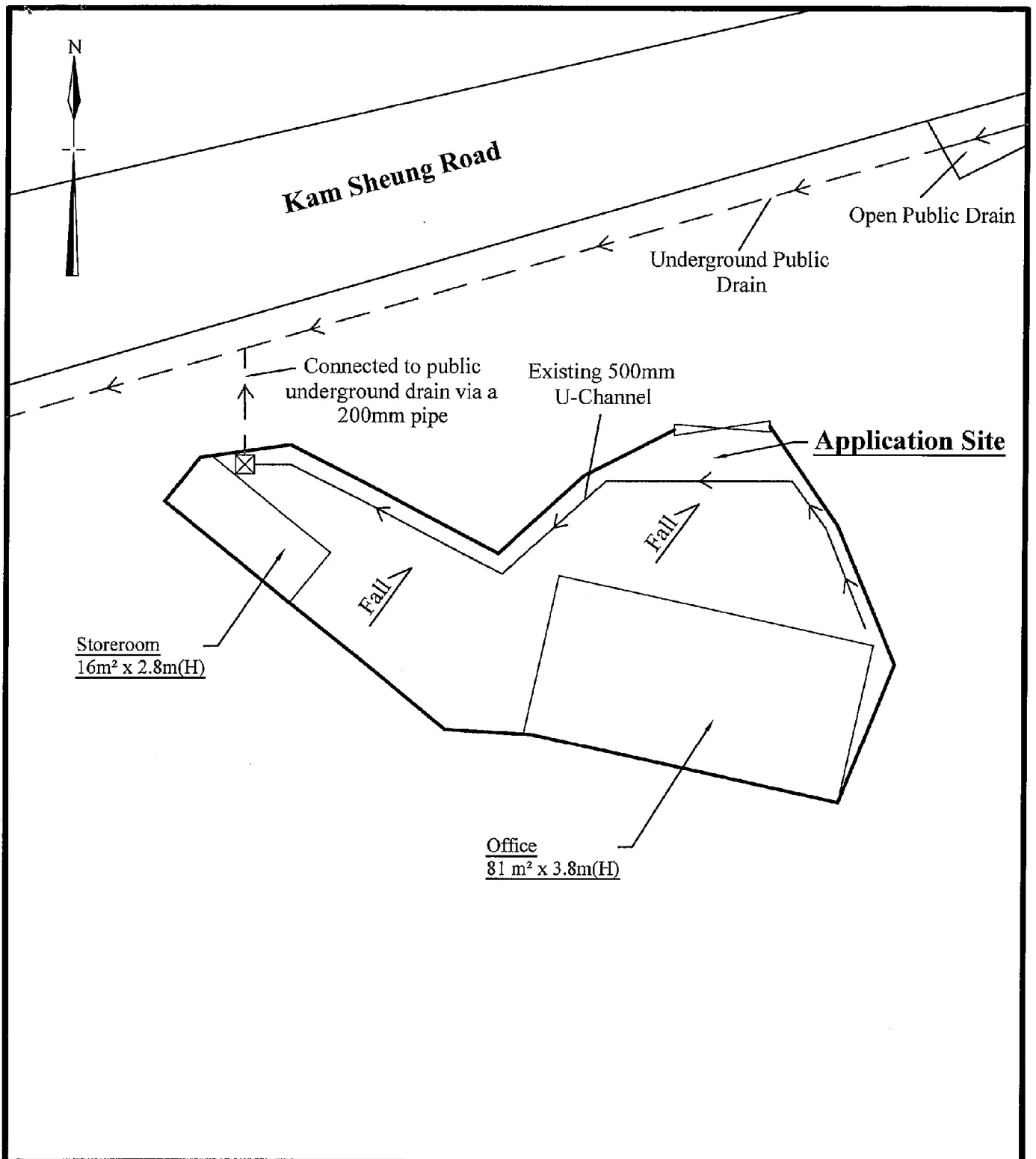

Legend	
☒	Existing Catchpit
—>	Existing U-Channel

1:200	Drainage Implementation Plan Lot 225 D (Part) in D. D. 112 Kam Sheung Road, Yuen Long	Goldrich Planners & Surveyors Ltd.
February 2019		Plan 5 (A 9027)

(資料來源:申請人於 7.3.2019 呈交的資料)
 (Source : Applicant's Submission of 7.3.2019)

參考編號
 REFERENCE No.
 A/YL-SK/253

繪圖 DRAWING
 A-3

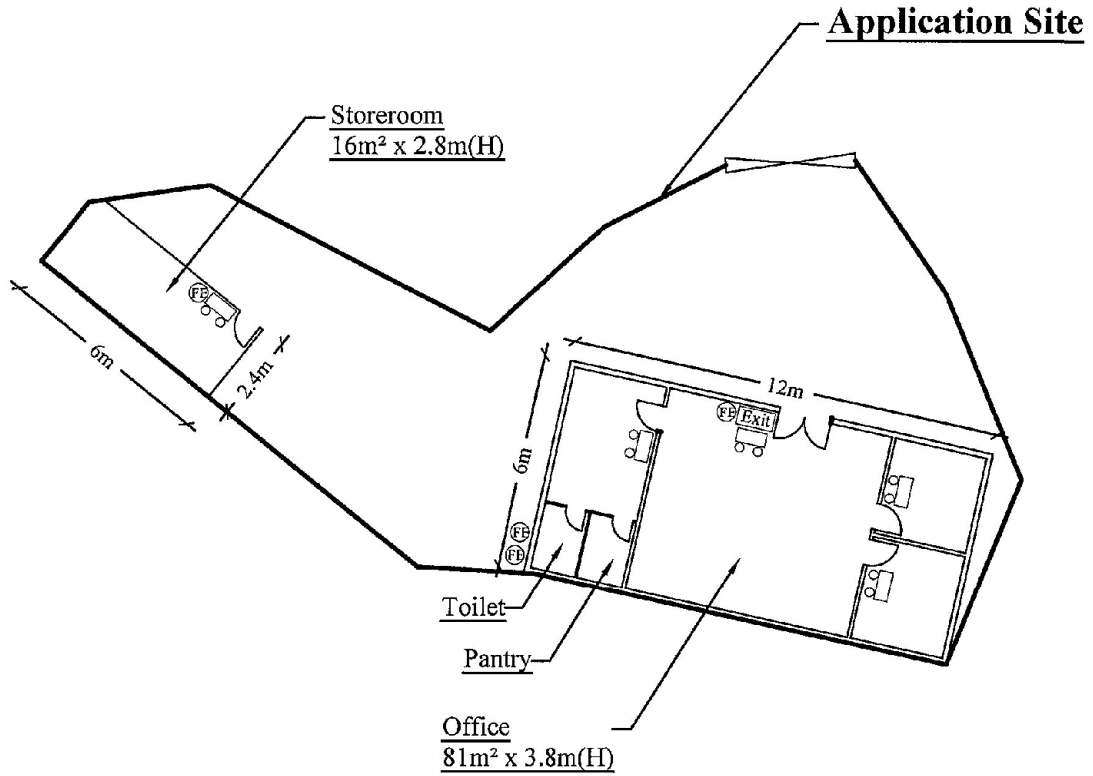

FS Notes:

- (i) Sufficient emergency lighting shall be provided throughout the entire building in accordance with BS 5266: Part 1 and BS EN 1838.
- (ii) Sufficient directional and exit sign shall be provided in accordance with BS 5266: Part 1.
- (iii) Portable hand-operated approved appliances shall be provided as indicated on plans (1 no 5KG Co2 FE for office area).

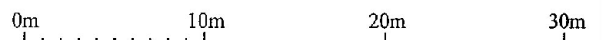

Legend :

- Ⓢ 5.0公斤二氧化碳氣體滅火筒 5.0kg CO2 Gas type Fire Extinguisher
- Ⓢ 沙筒 Sand Bucket
- Exit 出口 Exit sign
- Ⓢ 緊急照明燈 Emergency Light

1 : 200

**Fire Service Installations Proposal
Lot 225 D (Part) in D. D. 112
Kam Sheung Road, Yuen Long**

**Goldrich Planners &
Surveyors Ltd.**

February 2019

**Plan 6
(A 9027)**

(資料來源:申請人於 7.3.2019 呈交的資料)
(Source : Applicant's Submission of 7.3.2019)

參考編號
REFERENCE No.
AYL-SK/253

繪圖 DRAWING
A-4



要覽圖 KEY PLAN

SCALE 1 : 50 000 比例尺

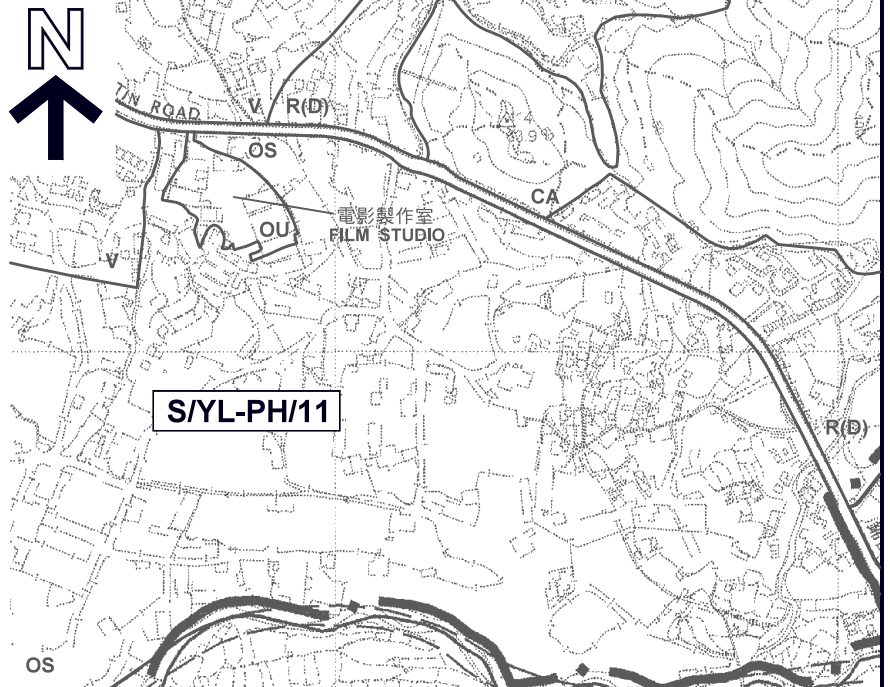

S/YL-PH/11

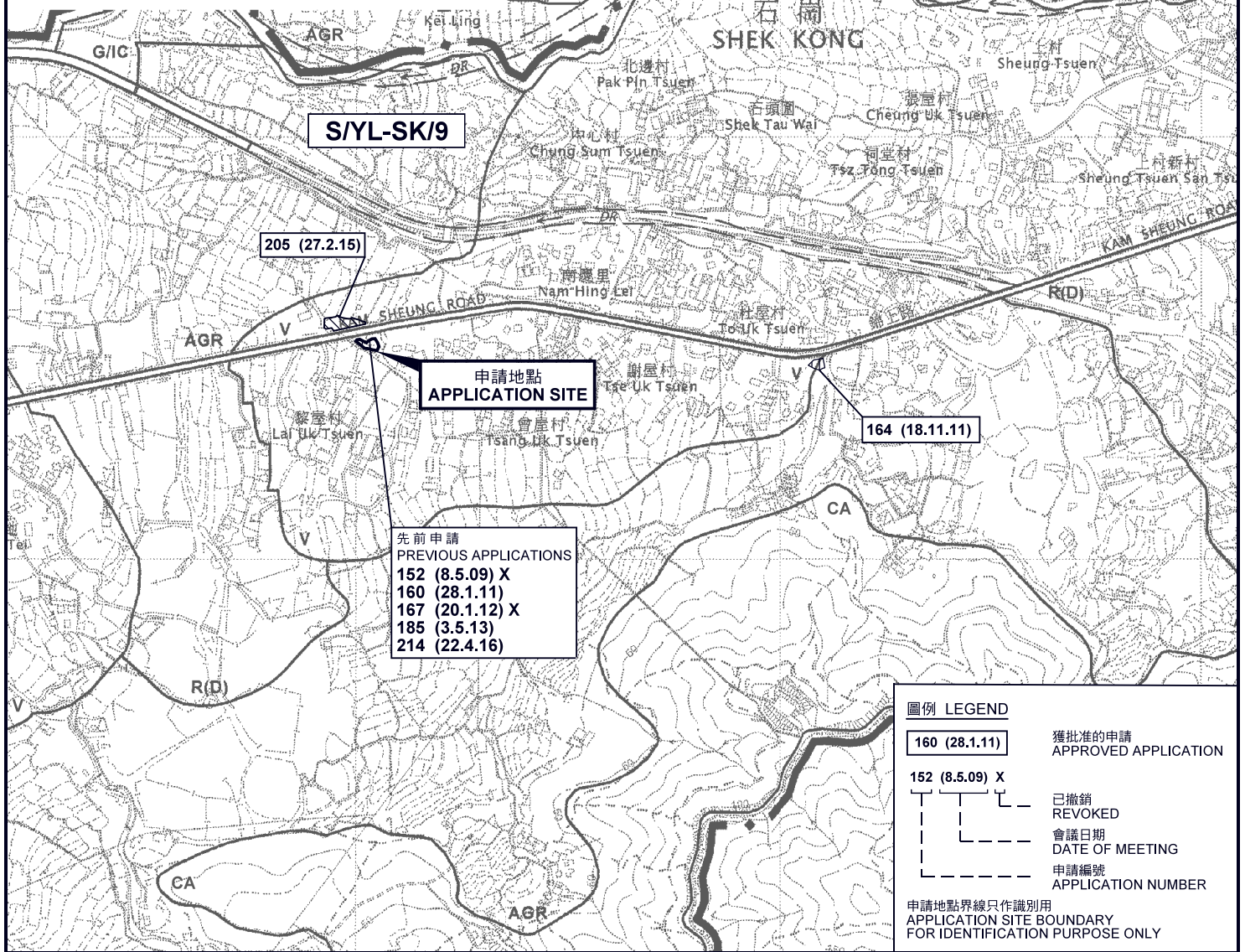

S/YL-SK/9

申請地點 APPLICATION SITE

- 先前申請
PREVIOUS APPLICATIONS
- 152 (8.5.09) X
 - 160 (28.1.11)
 - 167 (20.1.12) X
 - 185 (3.5.13)
 - 214 (22.4.16)

圖例 LEGEND

- 160 (28.1.11) 獲批准的申請 APPROVED APPLICATION
- 152 (8.5.09) X 已撤銷 REVOKED
- 會議日期 DATE OF MEETING
- 申請編號 APPLICATION NUMBER
- 申請地點界線只作識別用 APPLICATION SITE BOUNDARY FOR IDENTIFICATION PURPOSE ONLY

位置圖 LOCATION PLAN

臨時「商店及服務行業（地產代理）」用途的規劃許可續期（為期3年）
元朗錦上路丈量約份第112約地段第225號D分段（部分）
RENEWAL OF PLANNING APPROVAL FOR TEMPORARY
"SHOP AND SERVICES (REAL ESTATE AGENCY)"
FOR A PERIOD OF 3 YEARS
LOT 225 S.D (PART) IN D.D. 112,
KAM SHEUNG ROAD, YUEN LONG

SCALE 1 : 7 500 比例尺

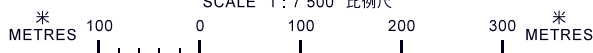

本摘要圖於2019年4月4日擬備，
所根據的資料為於2006年10月17日
核准的分區計劃大綱圖編號 S/YL-SK/9
EXTRACT PLAN PREPARED ON 4.4.2019
BASED ON OUTLINE ZONING PLAN No.
S/YL-SK/9 APPROVED ON 17.10.2006

規劃署
PLANNING
DEPARTMENT



參考編號
REFERENCE No.
A/YL-SK/253

圖 PLAN
A-1

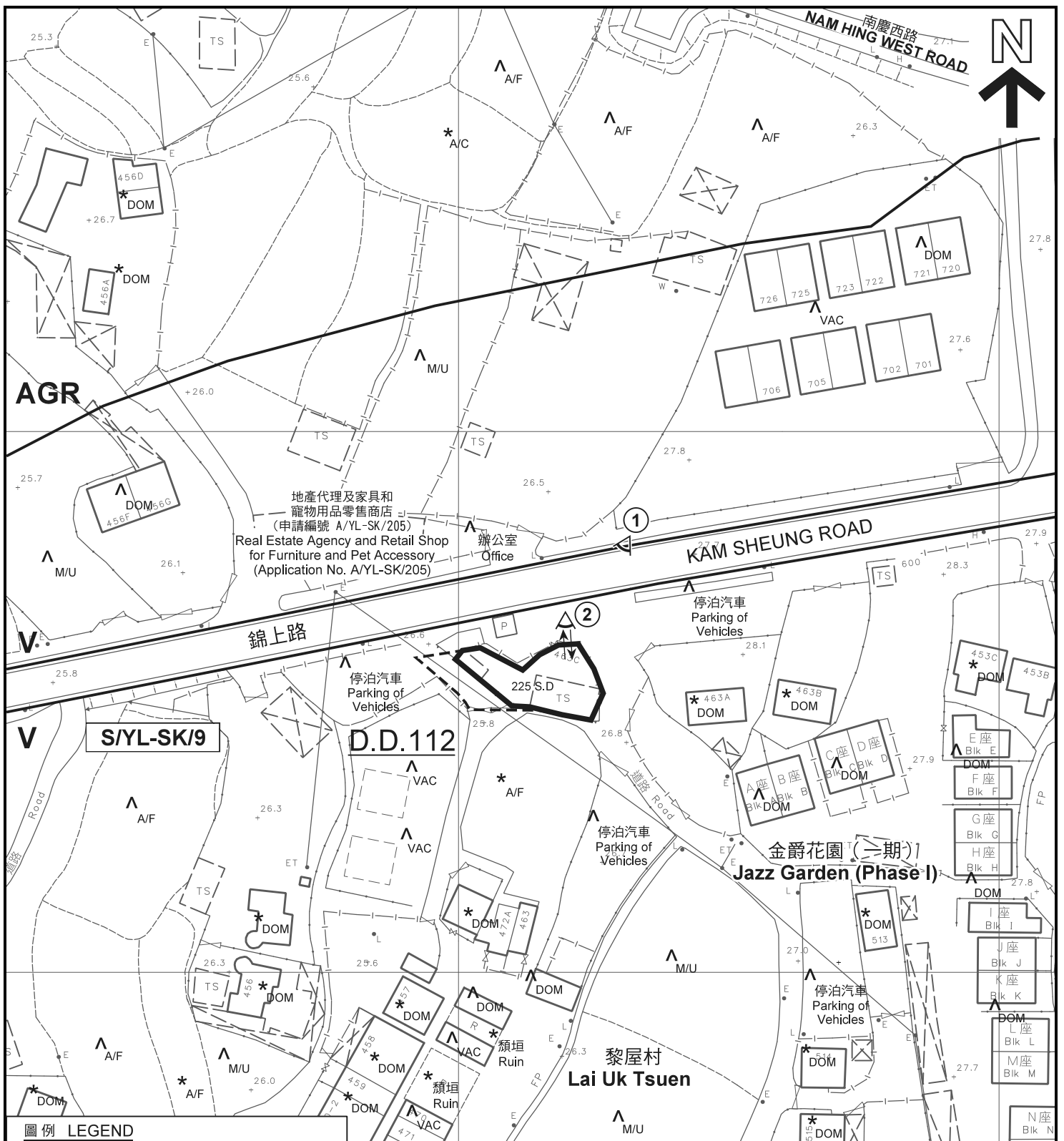

圖例 LEGEND

- 申請地點 (界線只作識別用)
APPLICATION SITE (BOUNDARY FOR IDENTIFICATION PURPOSE ONLY)
- AGR** 農業
AGRICULTURE
- V** 鄉村式發展
VILLAGE TYPE DEVELOPMENT
- M/U** 荒地
UNUSED LAND
- A/C** 常耕農地
ACTIVE AGRICULTURAL LAND

- A/F** 休耕農地
FALLOW AGRICULTURAL LAND
- DOM** 住用構築物
DOMESTIC STRUCTURE
- VAC** 空置
VACANT
- 入口/出口
INGRESS / EGRESS
- 實地照片的觀景點
VIEWING POINT OF SITE PHOTO

註釋 Notes:

- (1) 2019年3月21日勘测的土地用途
Land uses shown on this plan are in accordance with the land use survey conducted by the Planning Department on 21.3.2019
- (2) * 土地用途跟1991年勘测的土地用途一致
Indicates that the use is the same as that revealed by the land use survey conducted by the Planning Department in 1991
- (3) ^ 土地用途跟1991年勘测的土地用途有別
Indicates that the use is different from that revealed by the land use survey conducted by the Planning Department in 1991

平面圖 SITE PLAN

臨時「商店及服務行業(地產代理)」用途的規劃許可續期(為期3年)
元朗錦上路丈量約份第112約地段第225號D分段(部分)
RENEWAL OF PLANNING APPROVAL FOR TEMPORARY
"SHOP AND SERVICES (REAL ESTATE AGENCY)"
FOR A PERIOD OF 3 YEARS
LOT 225 S.D (PART) IN D.D. 112,
KAM SHEUNG ROAD, YUEN LONG

SCALE 1:1 000 比例尺

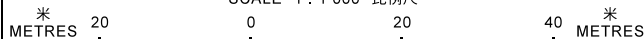

本摘要圖於2019年4月23日擬備，所根據的資料為測量圖編號 6-NE-19A
EXTRACT PLAN PREPARED ON 23.4.2019
BASED ON SURVEY SHEET No. 6-NE-19A

規劃署
PLANNING DEPARTMENT



參考編號
REFERENCE No.
A/YL-SK/253

圖 PLAN
A-2



圖例 LEGEND



申請地點 (界線只作識別用)
APPLICATION SITE
(BOUNDARY FOR IDENTIFICATION
PURPOSE ONLY)

本摘要圖於2019年4月3日擬備，所根據的資料為地政總署於2018年3月13日拍得的航攝照片編號E035404C

EXTRACT PLAN PREPARED ON 3.4.2019
BASED ON AERIAL PHOTO No.
E035404C TAKEN ON 13.3.2018
BY LANDS DEPARTMENT

航攝照片 AERIAL PHOTO

臨時「商店及服務行業（地產代理）」用途的規劃許可續期（為期3年）
元朗錦上路丈量約份第112約地段第225號D分段（部分）
RENEWAL OF PLANNING APPROVAL FOR TEMPORARY
"SHOP AND SERVICES (REAL ESTATE AGENCY)"
FOR A PERIOD OF 3 YEARS
LOT 225 S.D (PART) IN D.D. 112,
KAM SHEUNG ROAD, YUEN LONG

規劃署
PLANNING
DEPARTMENT



參考編號
REFERENCE No.
A/YL-SK/253

圖 PLAN
A-3



實地照片 SITE PHOTO

本摘要圖於2019年4月23日擬備，
所根據的資料為攝於
2019年3月21日的實地照片
PLAN PREPARED ON 23.4.2019
BASED ON SITE PHOTOS
TAKEN ON 21.3.2019

臨時「商店及服務行業（地產代理）」用途的規劃許可續期（為期3年）
元朗錦上路丈量約份第112約地段第225號D分段（部分）
RENEWAL OF PLANNING APPROVAL FOR TEMPORARY
"SHOP AND SERVICES (REAL ESTATE AGENCY)"
FOR A PERIOD OF 3 YEARS
LOT 225 S.D (PART) IN D.D. 112,
KAM SHEUNG ROAD, YUEN LONG

規劃署
PLANNING
DEPARTMENT



參考編號
REFERENCE No.
AYL-SK/253

圖 PLAN
A-4