

**Application Site**

**Site Area: about 738.1m<sup>2</sup>**

**Legend**

- P Parking space for private cars  
(2.5m (W) x 5m (L)) x 18nos.
- LGV Parking space for light goods vehicles  
(3.5m (W) x 7m (L)) x 3nos.

— Boundary fencing (about 2.4m high)

|                    |   |   |
|--------------------|---|---|
| <b>scale 1:250</b> | <b>Layout Plan</b>  | <b>Goldrich Planners &amp; Surveyors Ltd.</b> |
| <b>April 2019</b>  | <b>Lot 196 (Part) and adjoining Government Land<br/>in D. D. 102,<br/>Lok Ma Chau, San Tin, New Territories</b> | <b>Plan 3a<br/>( P 19009 )</b>                |

(摘錄自申請人於 8.4.2019 呈交的進一步資料)  
(Extract from Applicant's Further  
Information Submitted on 8.4.2019)

|   |                          |
|---|--------------------------|
| 參考編號<br>REFERENCE No.<br><b>A/YL-ST/540</b> | 繪圖 DRAWING<br><b>A-1</b> |
|---|--------------------------|

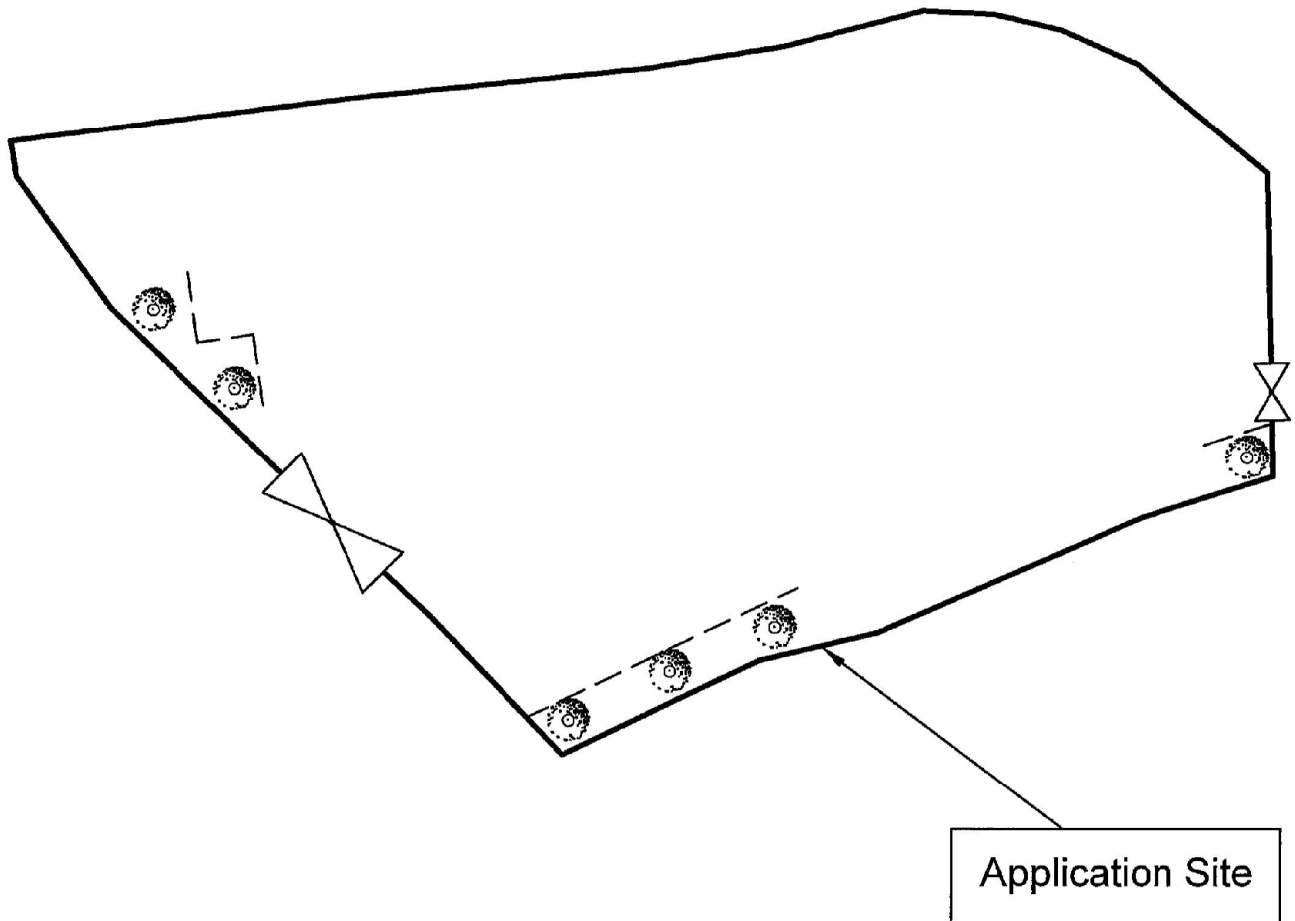

--- Car stopper (about 15cm thick each)

**Site Area: about 738.1m<sup>2</sup>**

|  | Spacing (Centre to Centre) | Min. Size (Height) | Quantity |
|--|----------------------------|--------------------|----------|
|  Existing Natural Trees | 4m                         | 2.75m              | 6        |

|                      |   |   |
|----------------------|---|---|
| <b>-scale 1:250-</b> | <b>Landscape Proposal</b><br><br>Lot 196 (Part) and adjoining Government Land<br>in D. D. 102,<br>Lok Ma Chau, San Tin, New Territories | <b>Goldrich Planners &amp;<br/>Surveyors Ltd.</b> |
| <b>February 2019</b> |   | <b>Plan 4<br/>( P 19009 )</b>                     |

(摘錄自申請人於 27.2.2019 呈交的申請書)  
(Extract from Applicant's  
Submission of 27.2.2019)

|   |                          |
|---|--------------------------|
| 參考編號<br>REFERENCE No.<br><b>A/YL-ST/540</b> | 繪圖 DRAWING<br><b>A-2</b> |
|---|--------------------------|

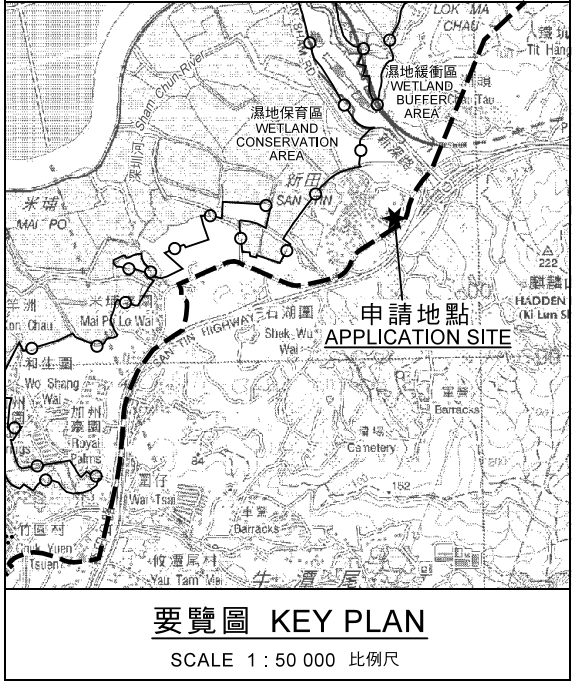
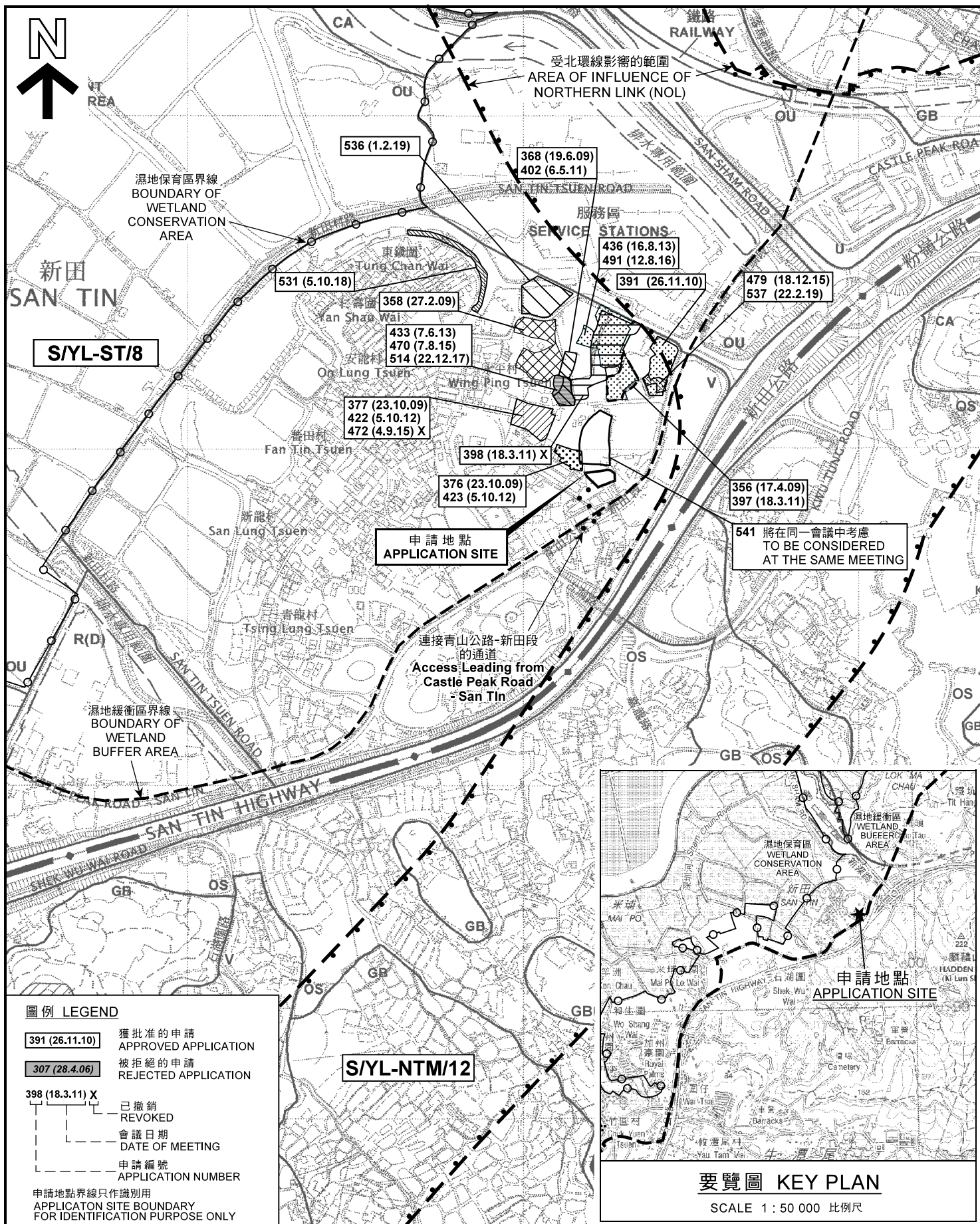

本摘要圖於2019年4月4日擬備，所根據的資料為於2006年12月5日核准的分區計劃大綱圖編號S/YL-ST/8及S/YL-NTM/12 EXTRACT PLAN PREPARED ON 4.4.2019 BASED ON OUTLINE ZONING PLANS No. S/YL-ST/8 & S/YL-NTM/12 APPROVED ON 5.12.2006

**位置圖及同類申請 LOCATION PLAN WITH SIMILAR APPLICATIONS**

臨時公眾停車場(私家車及輕型貨車不超過5.5噸) (為期3年)  
元朗新田丈量約份第102約地段第196號(部分)和毗連政府土地  
**TEMPORARY PUBLIC CAR PARK (PRIVATE CARS AND LIGHT GOODS VEHICLES UNDER 5.5 TONNES) FOR A PERIOD OF 3 YEARS**  
LOT 196 (PART) IN D.D.102  
AND ADJOINING GOVERNMENT LAND,  
SAN TIN, YUEN LONG

SCALE 1 : 7 500 比例尺

米 METRES 100 0 100 200 300 METRES

**規劃署 PLANNING DEPARTMENT**

參考編號 REFERENCE No. A/YL-ST/540

**圖 PLAN A-1a**



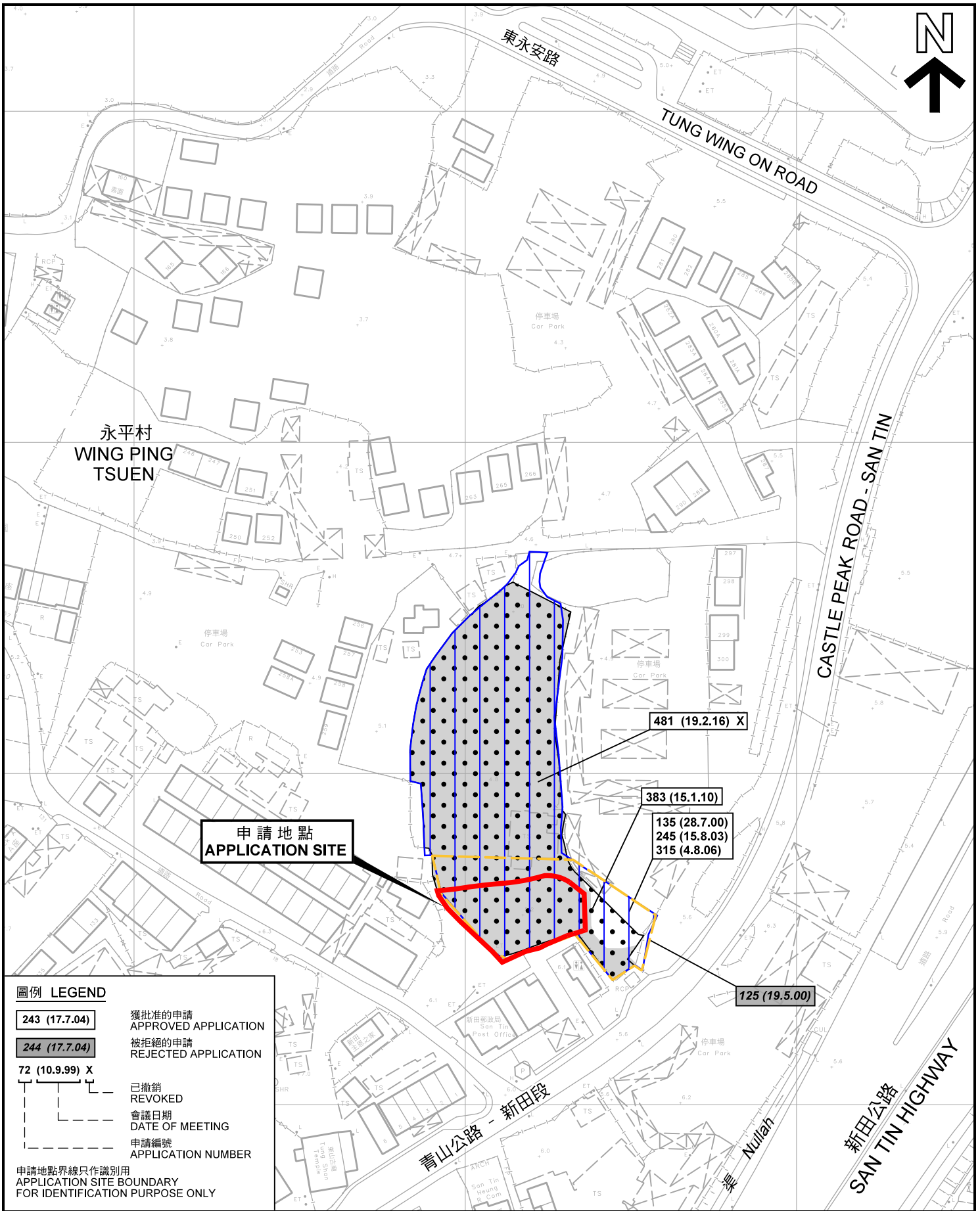

**圖例 LEGEND**

- 243 (17.7.04) 獲批准的申請  
APPROVED APPLICATION
- 244 (17.7.04) 被拒絕的申請  
REJECTED APPLICATION
- 72 (10.9.99) X 已撤銷  
REVOKED
- 會議日期  
DATE OF MEETING
- 申請編號  
APPLICATION NUMBER

申請地點界線只作識別用  
APPLICATION SITE BOUNDARY  
FOR IDENTIFICATION PURPOSE ONLY

**先前申請圖 PREVIOUS APPLICATION PLAN**

臨時公眾停車場(私家車及輕型貨車不超過5.5噸)(為期3年)  
元朗新田丈量約份第102約地段第196號(部分)和毗連政府土地  
TEMPORARY PUBLIC CAR PARK  
(PRIVATE CARS AND LIGHT GOODS VEHICLES  
UNDER 5.5 TONNES) FOR A PERIOD OF 3 YEARS  
LOT 196 (PART) IN D.D.102  
AND ADJOINING GOVERNMENT LAND,  
SAN TIN, YUEN LONG

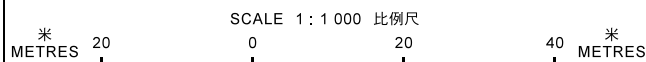

規劃署  
PLANNING  
DEPARTMENT



參考編號  
REFERENCE No.  
AYL-ST/540

圖 PLAN  
A-1b

本摘要圖於2019年4月4日擬備，  
所根據的資料為測量圖編號  
2-SE-8A、B、C及D  
EXTRACT PLAN PREPARED ON 4.4.2019  
BASED ON SURVEY SHEETS No.  
2-SE-8A, B, C & D

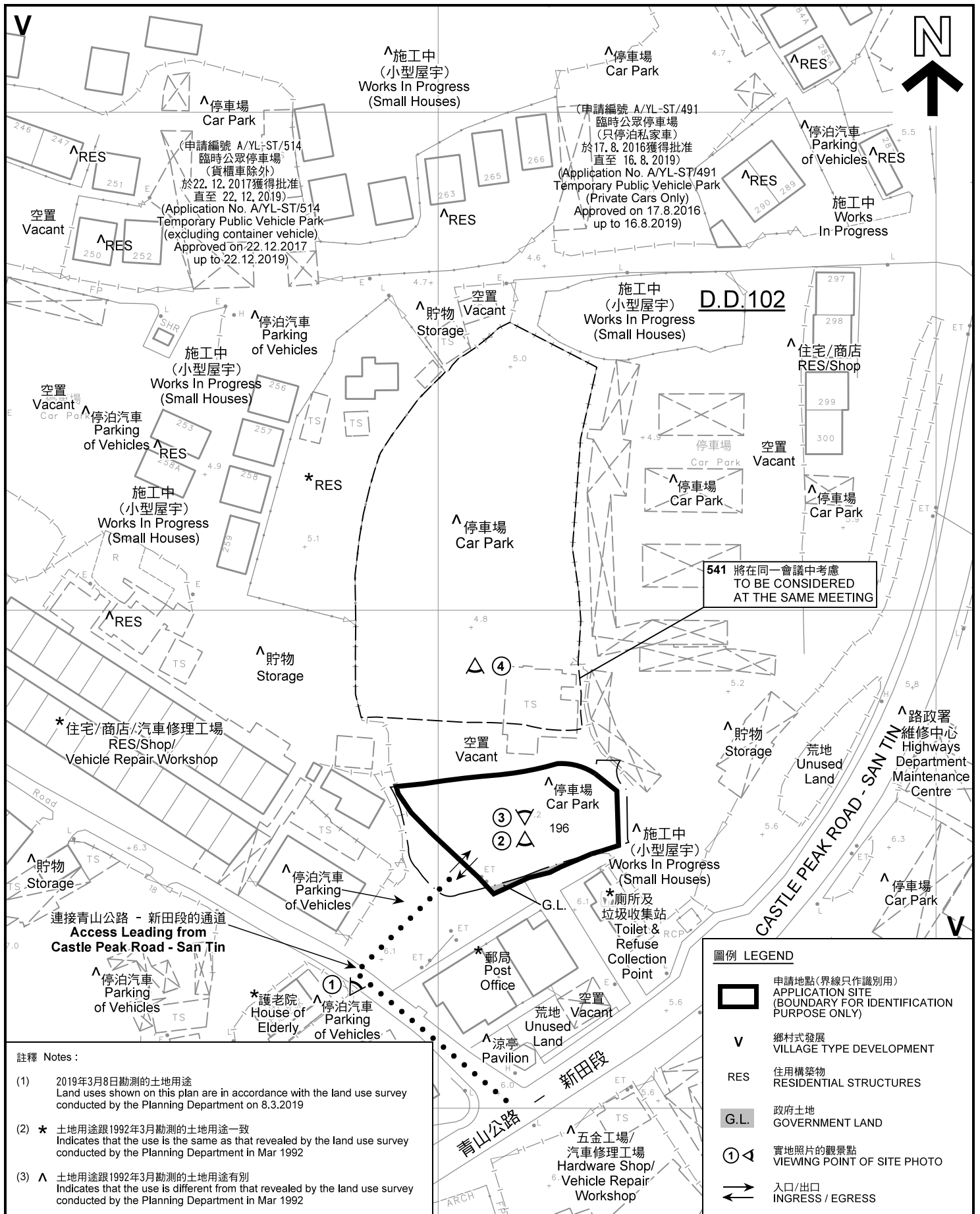

註釋 Notes:

- (1) 2019年3月8日勘測的土地用途  
Land uses shown on this plan are in accordance with the land use survey conducted by the Planning Department on 8.3.2019
- (2) \* 土地用途跟1992年3月勘測的土地用途一致  
Indicates that the use is the same as that revealed by the land use survey conducted by the Planning Department in Mar 1992
- (3) ^ 土地用途跟1992年3月勘測的土地用途有別  
Indicates that the use is different from that revealed by the land use survey conducted by the Planning Department in Mar 1992

圖例 LEGEND

- 申請地點(界線只作識別用)  
APPLICATION SITE (BOUNDARY FOR IDENTIFICATION PURPOSE ONLY)
- V** 鄉村式發展  
VILLAGE TYPE DEVELOPMENT
- RES** 住用構築物  
RESIDENTIAL STRUCTURES
- G.L.** 政府土地  
GOVERNMENT LAND
- 實地照片的觀景點  
VIEWING POINT OF SITE PHOTO
- 入口/出口  
INGRESS / EGRESS

平面圖 SITE PLAN

臨時公眾停車場(私家車及輕型貨車不超過5.5噸)(為期3年)  
元朗新田丈量約份第102約地段第196號(部分)和毗連政府土地  
TEMPORARY PUBLIC CAR PARK  
(PRIVATE CARS AND LIGHT GOODS VEHICLES  
UNDER 5.5 TONNES) FOR A PERIOD OF 3 YEARS  
LOT 196 (PART) IN D.D. 102  
AND ADJOINING GOVERNMENT LAND,  
SAN TIN, YUEN LONG  
SCALE 1 : 1 000 比例尺

米 20 0 20 40 米  
METRES

本摘要圖於2019年4月4日擬備，所根據的資料為測量圖編號 2-SE-8A、B、C及D  
EXTRACT PLAN PREPARED ON 4.4.2019  
BASED ON SURVEY SHEETS No. 2-SE-8A, B, C & D

規劃署  
PLANNING  
DEPARTMENT



參考編號  
REFERENCE No.  
A/YL-ST/540

圖 PLAN  
A-2





**圖例 LEGEND**

 申請地點 (界線只作識別用)  
APPLICATION SITE  
(BOUNDARY FOR IDENTIFICATION  
PURPOSE ONLY)

本摘要圖於2019年3月12日擬備，所根據的資料為地政總署於2018年4月10日拍得的航攝照片編號 E040602C  
EXTRACT PLAN PREPARED ON 12.3.2019  
BASED ON AERIAL PHOTO No.  
E040602C TAKEN ON 10.4.2018  
BY LANDS DEPARTMENT

**航攝照片 AERIAL PHOTO**

臨時公眾停車場(私家車及輕型貨車不超過5.5噸) (為期3年)  
元朗新田丈量約份第102約地段第196號(部分)和毗連政府土地  
TEMPORARY PUBLIC CAR PARK  
(PRIVATE CARS AND LIGHT GOODS VEHICLES  
UNDER 5.5 TONNES) FOR A PERIOD OF 3 YEARS  
LOT 196 (PART) IN D.D.102  
AND ADJOINING GOVERNMENT LAND,  
SAN TIN, YUEN LONG

規劃署  
PLANNING  
DEPARTMENT



參考編號  
REFERENCE No.  
A/YL-ST/540

圖 PLAN  
A-3





申請地點界線只作識別用 APPLICATION SITE BOUNDARY FOR IDENTIFICATION PURPOSE ONLY

**實地照片 SITE PHOTOS**

本圖於2019年3月15日擬備，所根據的資料為攝於2019年3月8日的實地照片  
 PLAN PREPARED ON 15.3.2019  
 BASED ON SITE PHOTOS  
 TAKEN ON 8.3.2019

臨時公眾停車場(私家車及輕型貨車不超過5.5噸)(為期3年)  
 元朗新田丈量約份第102約地段第196號(部分)和毗連政府土地  
 TEMPORARY PUBLIC CAR PARK  
 (PRIVATE CARS AND LIGHT GOODS VEHICLES  
 UNDER 5.5 TONNES) FOR A PERIOD OF 3 YEARS  
 LOT 196 (PART) IN D.D. 102  
 AND ADJOINING GOVERNMENT LAND,  
 SAN TIN, YUEN LONG

規 劃 署  
 PLANNING  
 DEPARTMENT



參考編號  
 REFERENCE No.  
 A/YL-ST/540

圖 PLAN  
 A-4