

Structure "A" 13.5m x 5.8m x 4.5m (汽車儲物室)
 Structure "B" 19.5m x 9.4m x 4.5m (機械零件儲物室)
 Structure "C" 13.2m x 11.4m x 4.5m (辦公室, 汽車及汽車零件儲物室)
 Container Office 12m x 3.3m x 4.5m

(貨柜兩層, 上層儲物, 下層辦公室)
 上層為1個貨柜: 面積為: 6M x 3.3M x 2.25M
 下層為2個貨柜: 面積為: 12M x 3.3M x 2.25M

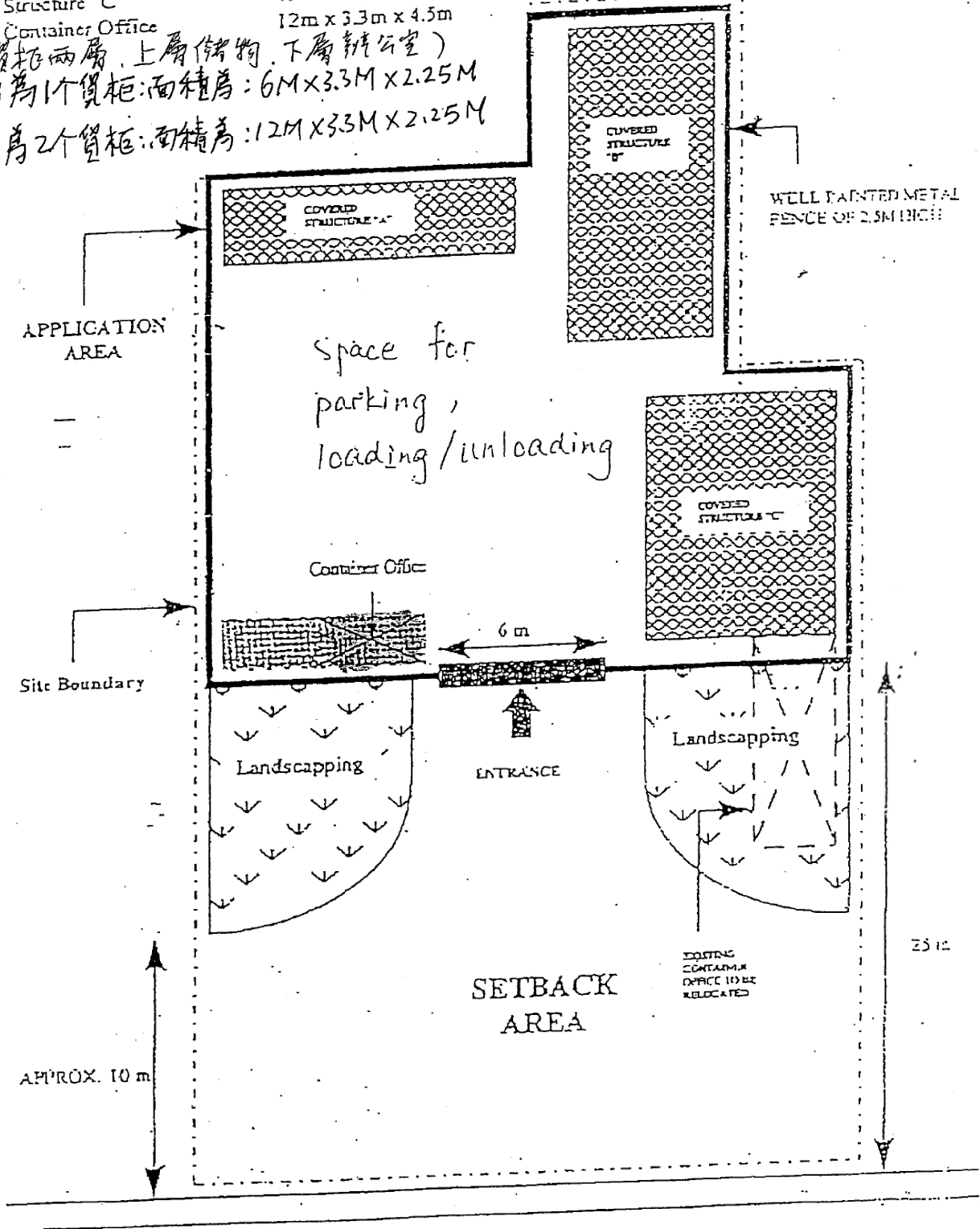

KAM TIN ROAD

PROJECT:
 LOTS 629T, 629U, 630B16 & 630B17,
 DD 110, KAM TIN NORTH,
 YUEN LONG, N.T.
 DRG. TITLE:
 SCHEMATIC LAYOUT PLAN

NOT TO SCALE
 FOR IDENTIFICATION PURPOSE ONLY

(摘錄自申請人於 4. 4. 2018 提交的申請書)
 (Extract from Applicant's
 Submission of 4.4.2018)

參考編號 REFERENCE No. A/YL-KTN/601	繪圖 DRAWING A-1
---------------------------------------	-------------------

EXISTING STRUCTURES
 ESTIMATED SIZE & NOT TO SCALE
 SCALE: 1:333

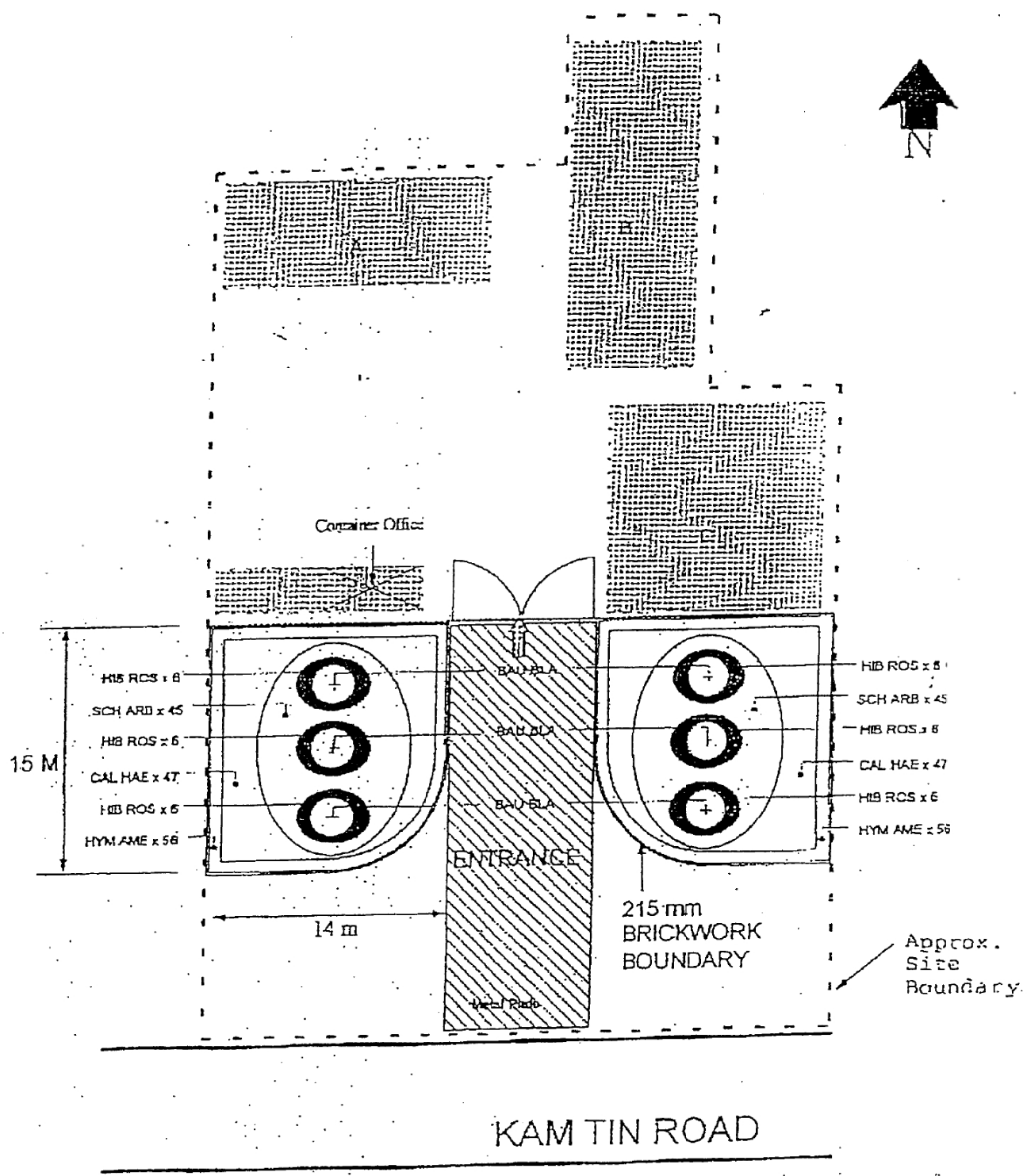

PROJECT:
 LOTS 629T, 629U, 630B16 & 630B17,
 DD 110, KAM TIN NORTH,
 YUEN LONG, N.T.









DRG. TITLE:
 LANDSCAPE PLAN

(摘錄自申請人於 4.4.2018 呈交的申請書)
 (Extract from Applicant's
 Submission of 4.4.2018)

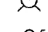
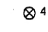
參考編號 REFERENCE No. A/YL-KTN/601	繪圖 DRAWING A-2
---------------------------------------	-------------------

Fire Notes :

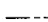
Legend :

-  New hose reel set c/w 30 m long rubber hose, jet nozzle, hose guide, nozzle cabinet and etc
-  Break Glass Call Point
-  Ø150 mm Fire Alarm Bell
-  Visual Alarm Device
-  5 kg 5.0 kg CO2 type fire extinguisher
-  4 kg 4.0 kg Dry Powder type fire extinguisher
-  9 L 9.0 litre Foam type fire extinguisher
-  Gate Valve
-  Non-return Valve
-  FS Pump (for hose reel only)

--- Fencing Line

1. Sufficient emergency lighting shall be provided throughout the entire building in accordance with BS 5266 : Part 1 and BS EN 1838 ;
2. Sufficient directional and exit sign shall be provided in accordance with BS 5266 : Part 1 ;
3. Fire alarm system shall be provided to the entire building in accordance with BS 5839 : Part 1 : 2002 + A2:2008 and FSD Circular Letter No. 1/2009. One actuating point and one audio warning device to be located at each hose reel point. This actuation point shall include facilities for fire pump start and audio/visual warning device initiation ;
4. The 2 m³ FS water tank and FS pump for the modified hose reel system shall be indicated on plans ; and
5. Portable hand-operated approved appliance shall be provided as indicated on plans.
6. The hose reels to ensure that every part of each part of each building can be reached by a length of not more than 30m of hose reel tubing.

- A WAREHOUSE FOR STORAGE (13.5mx5.8m=78.3m sq.)
- B WAREHOUSE OF VEHICLES PARTS STORAGE (19.3mx9.4m=181.4m sq.)
- C ONE CONTAINER FOR OFFICE(6.0mx2.4m=14.4msq.) AND ONE WAREHOUSE FOR STORAGE (3.9mx3.2m=12.5msq.) UNDER PORCH (13.2mx11.4m=150.5m sq.)
- D 3 NO CONTAINER FOR STORAGE(6.0mx2.4m+12.2mx2.4m=73msq.)

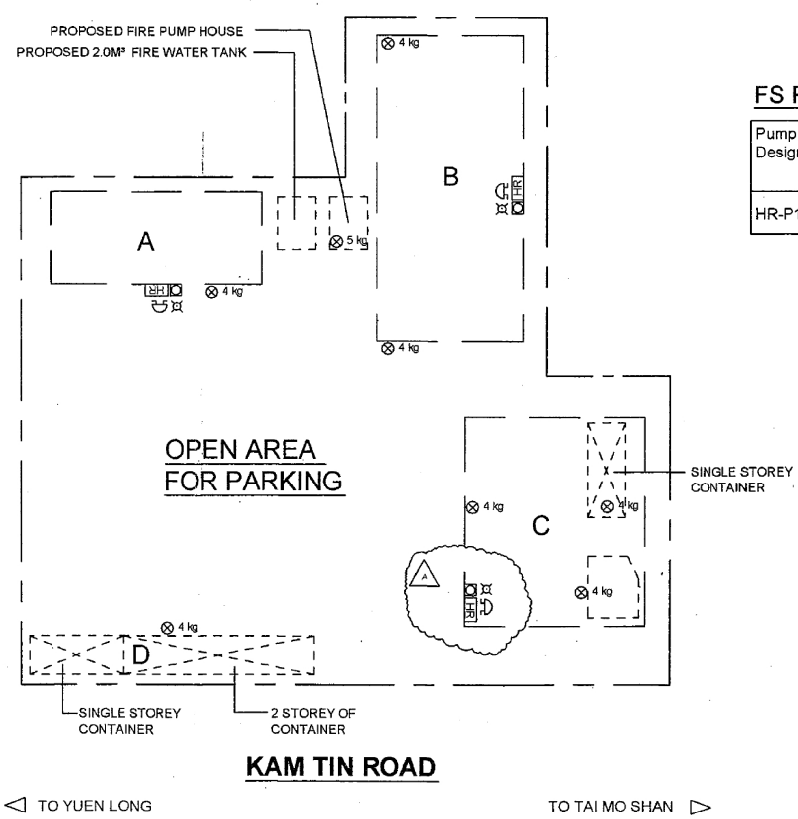
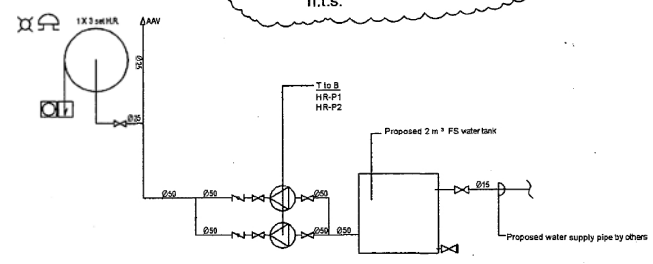
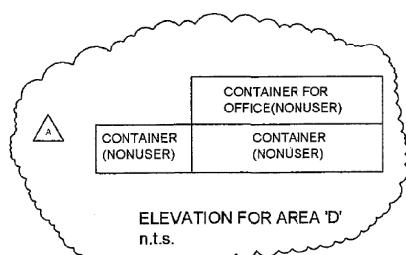

FS Pump Schedule :

Pump Designation	Flow Rate (l/min)	Pump Head (kpa)	Motor Rating (kw)
HR-P1 & P2	100	600	2.2

A	AS PER FSD COMMENT	2010/4/	KANT
REV.	DESCRIPTION	DATE	BY
KEI YIP FIRE ENGINEERING LTD. Rm. 727A, Block 1, Wang Cheong Factory Estate, Cheung Sha Wan, Kowloon Email : yuenfatco@yahoo.com.hk Tel.: (852) 2387 8772 Fax: (852) 2748 0011			
PROJECT : *OPEN STORAGE* OF CONSTRUCTION MACHINERY OF PRIVATE VEHICLE & VEHICLE PARTS FOR A PERIOD YEARS IN "RESIDENTIAL GROUP D" ZONE D.D.110 LOTS 629 S.T., 629 S.U., 630 S.B.SS16 & 630 S.B.SS17 SHEK KONG SAN TSUEN, KAM TIN ROAD, YUEN LONG.			
TITLE : FIRE SERVICES INSTALLATION LAYOUT PLAN			
DRAWN BY :	KANT		
CHECKED BY :	CAD		
DRAWING NO. :			
T.P.B. REF. NO. :	A/YL-KTN462		
DATE :	27-02-2010		
SCALE :	1 : 300		

(摘錄自申請人於 4. 4. 2018 提交的申請書)
 (Extract from Applicant's Submission of 4.4.2018)

參考編號 REFERENCE No. A/YL-KTN/601	繪圖 DRAWING A-3
---------------------------------------	-------------------

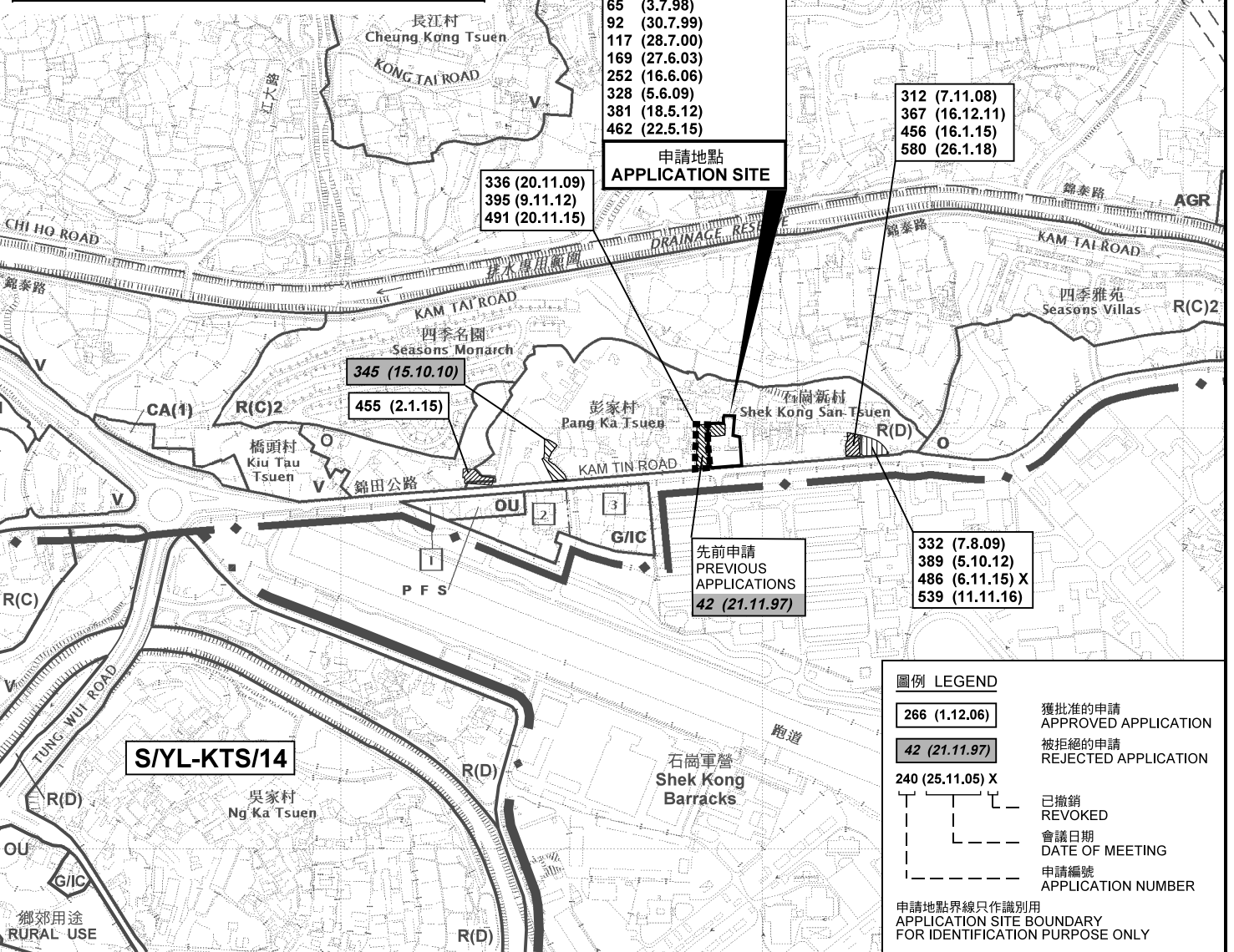
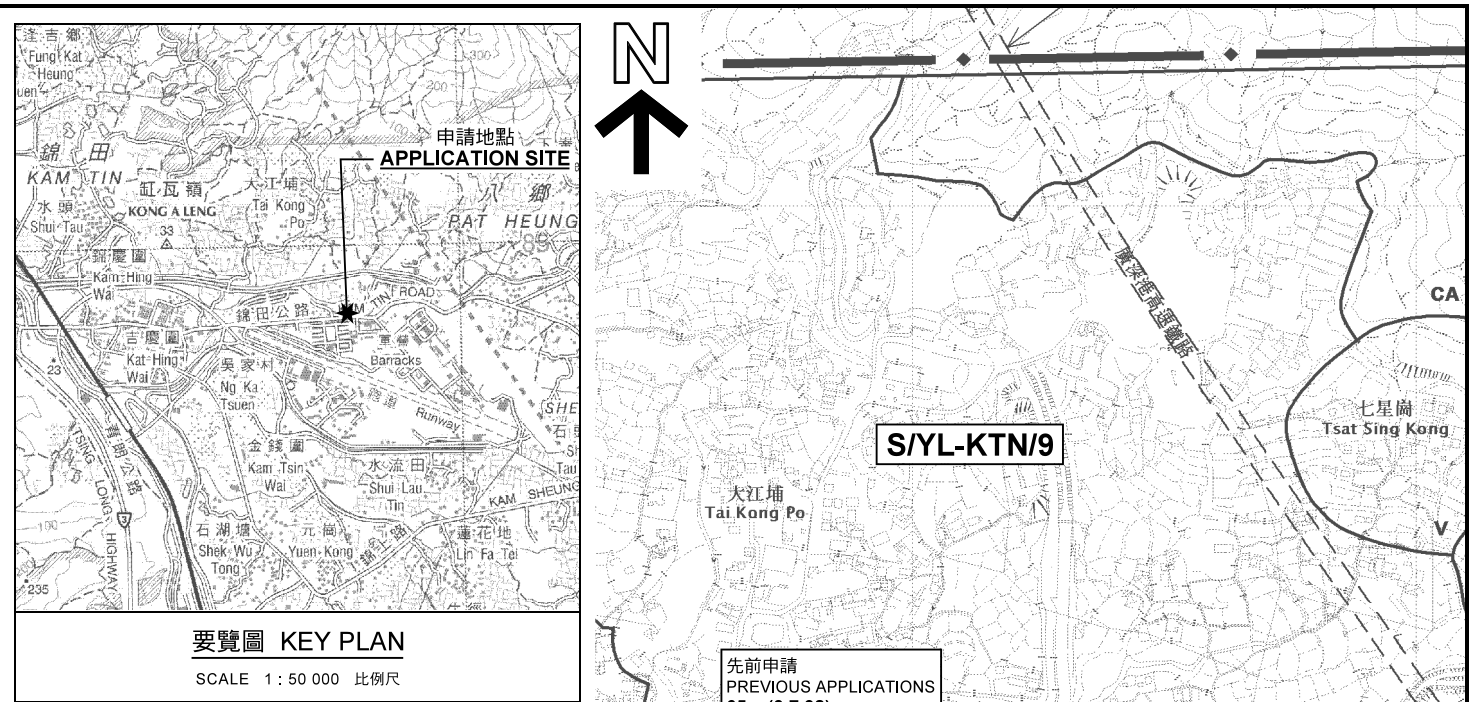

本摘要圖於2018年5月28日擬備，所根據的資料為於2014年12月2日核准的分區計劃大綱圖編號 S/YL-KTN/9 EXTRACT PLAN PREPARED ON 28.5.2018 BASED ON OUTLINE ZONING PLAN No. S/YL-KTN/9 APPROVED ON 2.12.2014

位置圖及同類申請 LOCATION PLAN WITH SIMILAR APPLICATIONS

臨時「露天存放建築機械、私家車及汽車零件」用途的規劃許可續期（為期3年）
元朗錦田錦田公路石崗新村丈量約份第110約地段第629號T分段、第629號U分段、第630號B分段第16小分段及第630號B分段第17小分段
RENEWAL OF PLANNING APPROVAL FOR TEMPORARY
"OPEN STORAGE OF CONSTRUCTION MACHINERY, PRIVATE VEHICLES AND VEHICLE PARTS" FOR A PERIOD OF 3 YEARS
LOTS 629 S.T., 629 S.U., 630 S.B SS.16 AND 630 S.B ss.17 IN D.D. 110, SHEK KONG SAN TSUEN, KAM TIN ROAD, KAM TIN, YUEN LONG

SCALE 1 : 7 500 比例尺

米 100 0 100 200 300 米
METRES

規劃署 PLANNING DEPARTMENT

參考編號 REFERENCE No. A/YL-KTN/601

圖 PLAN A-1

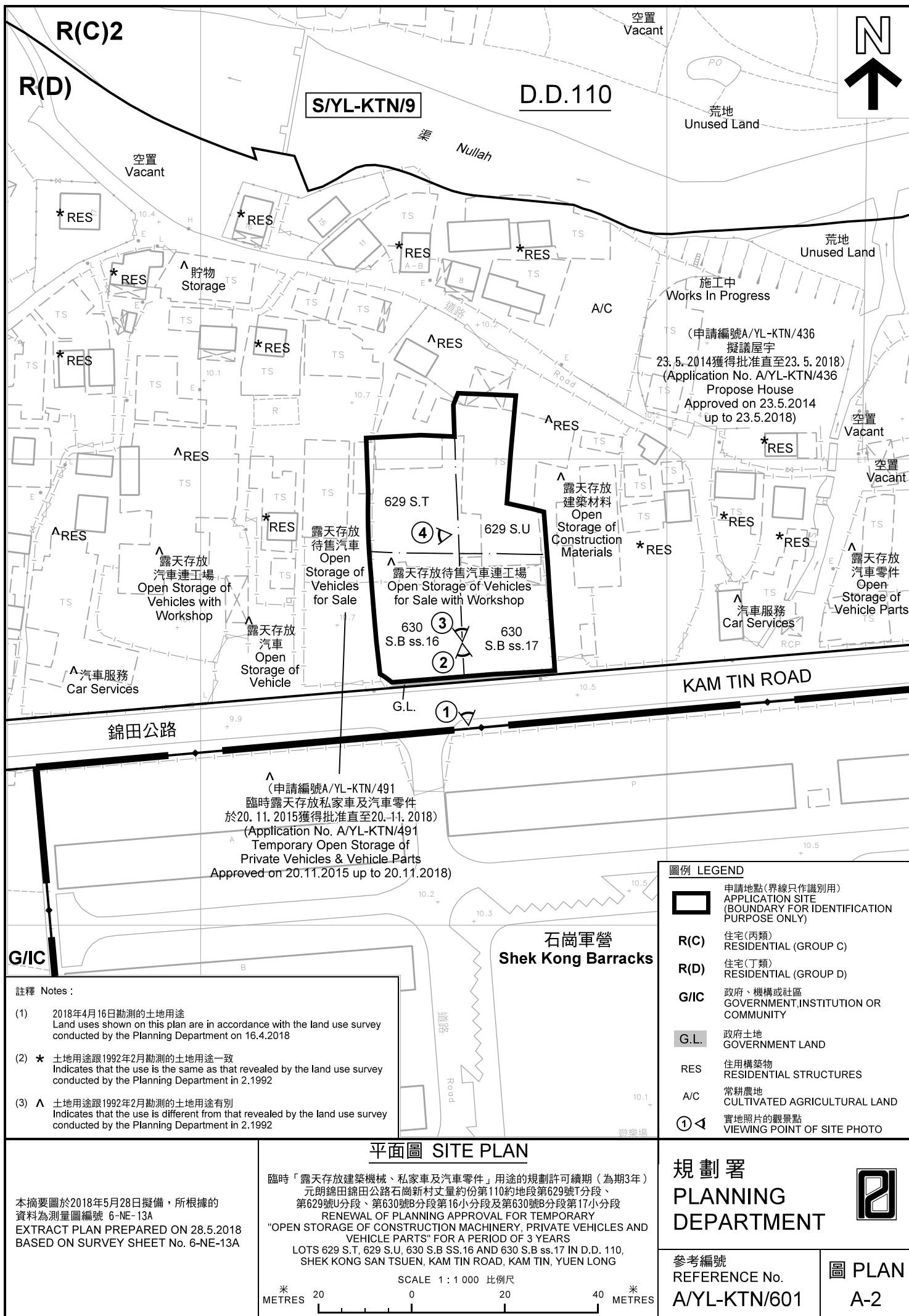

施工
Works In Progress
 (申請編號A/YL-KTN/436
 擬議屋宇
 23.5.2014獲得批准直至23.5.2018)
 (Application No. A/YL-KTN/436
 Propose House
 Approved on 23.5.2014
 up to 23.5.2018)

(申請編號A/YL-KTN/491
 臨時露天存放私家車及汽車零件
 於20.11.2015獲得批准直至20.11.2018)
 (Application No. A/YL-KTN/491
 Temporary Open Storage of
 Private Vehicles & Vehicle Parts
 Approved on 20.11.2015 up to 20.11.2018)

圖例 LEGEND	
	申請地點(界線只作識別用) APPLICATION SITE (BOUNDARY FOR IDENTIFICATION PURPOSE ONLY)
R(C)	住宅(丙類) RESIDENTIAL (GROUP C)
R(D)	住宅(丁類) RESIDENTIAL (GROUP D)
G/IC	政府、機構或社區 GOVERNMENT, INSTITUTION OR COMMUNITY
G.L.	政府土地 GOVERNMENT LAND
RES	住用構築物 RESIDENTIAL STRUCTURES
A/C	常耕農地 CULTIVATED AGRICULTURAL LAND
①	實地照片的觀景點 VIEWING POINT OF SITE PHOTO

- 註釋 Notes :
- (1) 2018年4月16日勘測的土地用途
Land uses shown on this plan are in accordance with the land use survey conducted by the Planning Department on 16.4.2018
 - (2) * 土地用途跟1992年2月勘測的土地用途一致
Indicates that the use is the same as that revealed by the land use survey conducted by the Planning Department in 2.1992
 - (3) ^ 土地用途跟1992年2月勘測的土地用途有別
Indicates that the use is different from that revealed by the land use survey conducted by the Planning Department in 2.1992

本摘要圖於2018年5月28日擬備，所根據的資料為測量圖編號 6-NE-13A
 EXTRACT PLAN PREPARED ON 28.5.2018
 BASED ON SURVEY SHEET No. 6-NE-13A

平面圖 SITE PLAN

臨時「露天存放建築機械、私家車及汽車零件」用途的規劃許可續期(為期3年)
 元朗錦田錦田公路石崗新村丈量約份第110約地段第629號T分段、
 第629號U分段、第630號B分段第16小分段及第630號B分段第17小分段
 RENEWAL OF PLANNING APPROVAL FOR TEMPORARY
 "OPEN STORAGE OF CONSTRUCTION MACHINERY, PRIVATE VEHICLES AND
 VEHICLE PARTS" FOR A PERIOD OF 3 YEARS
 LOTS 629 S.T, 629 S.U, 630 S.B SS.16 AND 630 S.B ss.17 IN D.D. 110,
 SHEK KONG SAN TSUEN, KAM TIN ROAD, KAM TIN, YUEN LONG

SCALE 1 : 1 000 比例尺

米 20 0 20 40 米
 METRES

規劃署
PLANNING
DEPARTMENT

參考編號 REFERENCE No. A/YL-KTN/601	圖 PLAN A-2
---------------------------------------	---------------



圖例 LEGEND



申請地點(界線只作識別用)
APPLICATION SITE
(BOUNDARY FOR IDENTIFICATION
PURPOSE ONLY)

本摘要圖於2018年5月11日擬備，所根據的資料為地政總署於2017年4月29日拍得的航攝照片編號 E023743C
EXTRACT PLAN PREPARED ON 11.5.2018
BASED ON AERIAL PHOTO No.
E023743C TAKEN ON 29.4.2017
BY LANDS DEPARTMENT

航攝照片 AERIAL PHOTO

臨時「露天存放建築機械、私家車及汽車零件」用途的規劃許可續期(為期3年)
元朗錦田錦田公路石崗新村丈量約份第110約地段第629號T分段、
第629號U分段、第630號B分段第16小分段及第630號B分段第17小分段
RENEWAL OF PLANNING APPROVAL FOR TEMPORARY
"OPEN STORAGE OF CONSTRUCTION MACHINERY, PRIVATE VEHICLES AND
VEHICLE PARTS" FOR A PERIOD OF 3 YEARS
LOTS 629 S.T, 629 S.U, 630 S.B SS.16 AND 630 S.B ss.17 IN D.D. 110,
SHEK KONG SAN TSUEN, KAM TIN ROAD, KAM TIN, YUEN LONG

規劃署
PLANNING
DEPARTMENT



參考編號
REFERENCE No.
A/YL-KTN/601

圖 PLAN
A-3

1



2



3



4



實地照片 SITE PHOTOS

本圖於2018年5月18日擬備，所根據的資料為攝於2018年4月13日的實地照片
 PLAN PREPARED ON 18.5.2018
 BASED ON SITE PHOTOS
 TAKEN ON 13.4.2018

臨時「露天存放建築機械、私家車及汽車零件」用途的規劃許可續期（為期3年）
 元朗錦田錦田公路石崗新村丈量約份第110約地段第629號T分段、
 第629號U分段、第630號B分段第16小分段及第630號B分段第17小分段
 RENEWAL OF PLANNING APPROVAL FOR TEMPORARY
 "OPEN STORAGE OF CONSTRUCTION MACHINERY, PRIVATE VEHICLES AND
 VEHICLE PARTS" FOR A PERIOD OF 3 YEARS
 LOTS 629 S.T., 629 S.U., 630 S.B SS.16 AND 630 S.B ss.17 IN D.D. 110,
 SHEK KONG SAN TSUEN, KAM TIN ROAD, KAM TIN, YUEN LONG

規劃署
 PLANNING
 DEPARTMENT



參考編號
 REFERENCE No.
 A/YL-KTN/601

圖 PLAN
 A-4