

**DEVELOPMENT PARAMETERS**

APPLICATION SITE AREA : 1,829m<sup>2</sup> (ABOUT)  
 COVERED AREA : 161.8m<sup>2</sup> (ABOUT)  
 UNCOVERED AREA : 1,667.2m<sup>2</sup> (ABOUT)

NO. OF STRUCTURE : 4  
 DOMESTIC GFA : NOT APPLICABLE  
 NON-DOMESTIC GFA : 161.8m<sup>2</sup> (ABOUT)  
 BUILDING HEIGHT : 2.6m - 3.7m (ABOUT)  
 NO. OF STOREY : 1

PLOT RATIO : 0.09 (ABOUT)  
 SITE COVERAGE : 9% (ABOUT)

STRUCTURE	USE	COVERED AREA	GFA	BUILDING HEIGHT
B1	AGRICULTURE LEARNING CENTRE	83m <sup>2</sup> (ABOUT)	83m <sup>2</sup> (ABOUT)	3.5m (ABOUT)(1-STOREY)
B2	STORAGE OF FARM TOOL	15.4m <sup>2</sup> (ABOUT)	15.4m <sup>2</sup> (ABOUT)	2.6m (ABOUT)(1-STOREY)
B3	HOBBY FARM LOUNGE	49.6m <sup>2</sup> (ABOUT)	49.6m <sup>2</sup> (ABOUT)	3.7m (ABOUT)(1-STOREY)
B4	ELECTRICITY METER ROOM	13.8m <sup>2</sup> (ABOUT)	13.8m <sup>2</sup> (ABOUT)	2.6m (ABOUT)(1-STOREY)
		<b>161.8m<sup>2</sup> (ABOUT)</b>	<b>161.8m<sup>2</sup> (ABOUT)</b>	

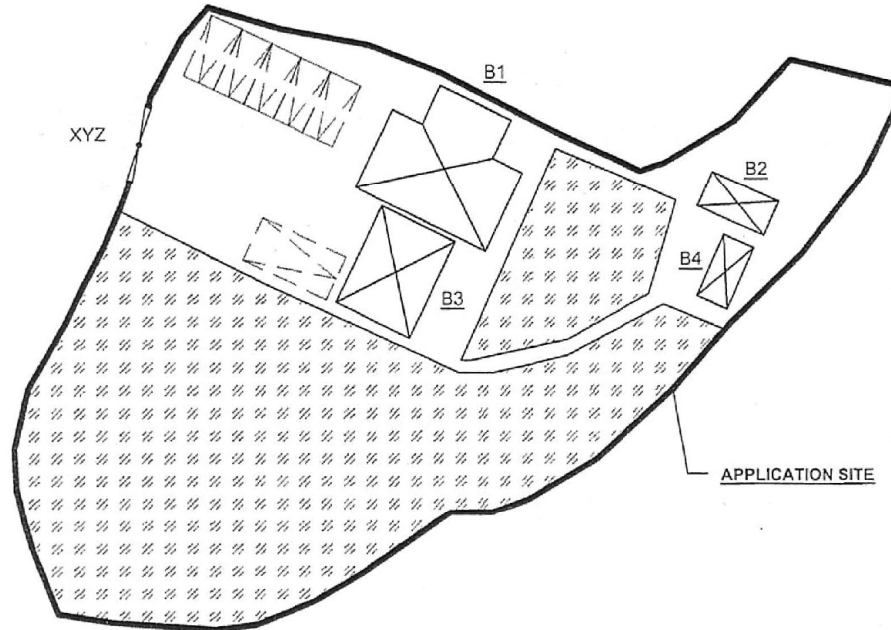
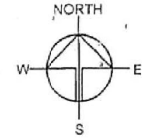

WIDTH OF INGRESS / EGRESS OF THE SITE (XYZ) : 6m (ABOUT)  
 NO. OF PRIVATE CAR PARKING SPACE : 5  
 DIMENSION OF PRIVATE CAR PARKING SPACE : 2.5m (W) X 5m (L)  
 NO. OF L/JL SPACE FOR LGV : 1  
 DIMENSION OF L/JL SPACE FOR LGV : 3.5m (W) X 7m (L)

**LEGEND**

	APPLICATION SITE
	STRUCTURE
	PARKING / L/JL SPACE
	FARM AREA

Drawing No.	Ver
P04	01
Project	
TEMPORARY PLACE OF RECREATION, SPORTS OR CULTURE (HOBBY FARM) FOR A PERIOD OF 3 YEARS	
LOT 1467 (PART) AND 1485 (PART) IN D.D. 107	
Drawing Title	
LAYOUT PLAN	
Scale of A4	
1:500	
Drawn	Date
	20.2.2020
Revised	Date

(摘錄自申請人於 26. 2. 2020 呈交的申請書)  
 (Extract from Applicant's Submission of 26.2.2020)

參考編號  
 REFERENCE No.  
 A/YL-KTN/697

繪圖 DRAWING  
 A-1

**PAVED RATIO OF THE APPLICATION SITE**

APPLICATION SITE AREA : 1,829m<sup>2</sup> (ABOUT)  
 COVERED AREA : 161.8m<sup>2</sup> (ABOUT)  
 FARM AREA : 1,042m<sup>2</sup> (57%)(ABOUT)  
 EXISTING HARD PAVED AREA : 625.2m<sup>2</sup> (34%)(ABOUT)

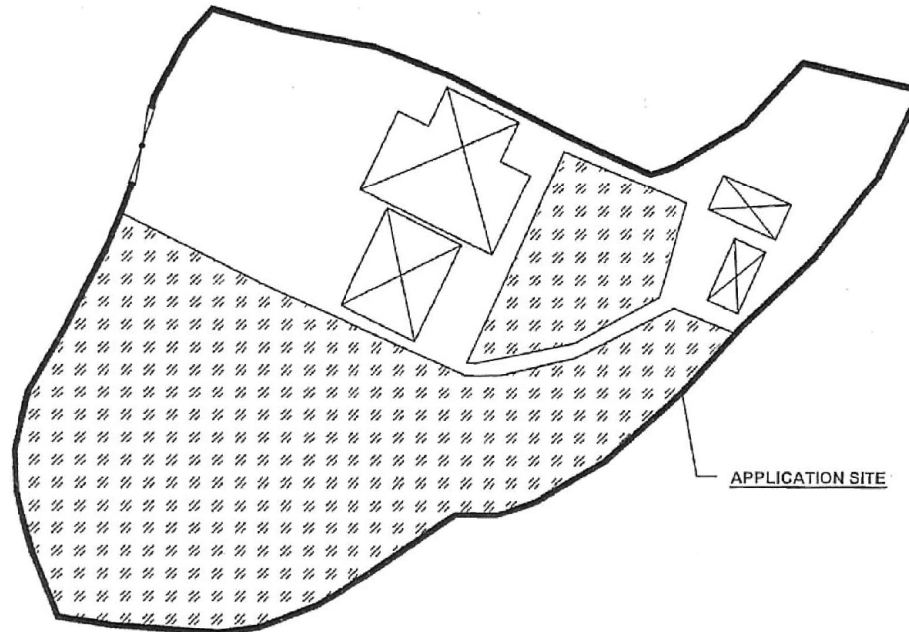
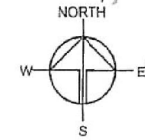

**LEGEND**

- APPLICATION SITE
- STRUCTURE
- EXISTING PAVED AREA
- FARM AREA

Drawing No.	Var.
POS	01
Project	
TEMPORARY PLACE OF RECREATION, SPORTS OR CULTURE (HOBBY FARM) FOR A PERIOD OF 3 YEARS	
LOT 1467 (PART) AND 1485 (PART) IN D.D. 107	
Drawing Title	
PAVED RATIO OF THE SITE	
Scale of A4	
1:500	
Drawn	Date
	15.1.2020
Revised	Date

(摘錄自申請人於 26. 2. 2020 呈交的申請書)  
 (Extract from Applicant's Submission of 26.2.2020)

參考編號 REFERENCE No.	繪圖 DRAWING
A/YL-KTN/697	A-2

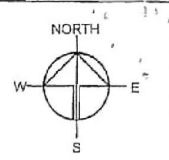
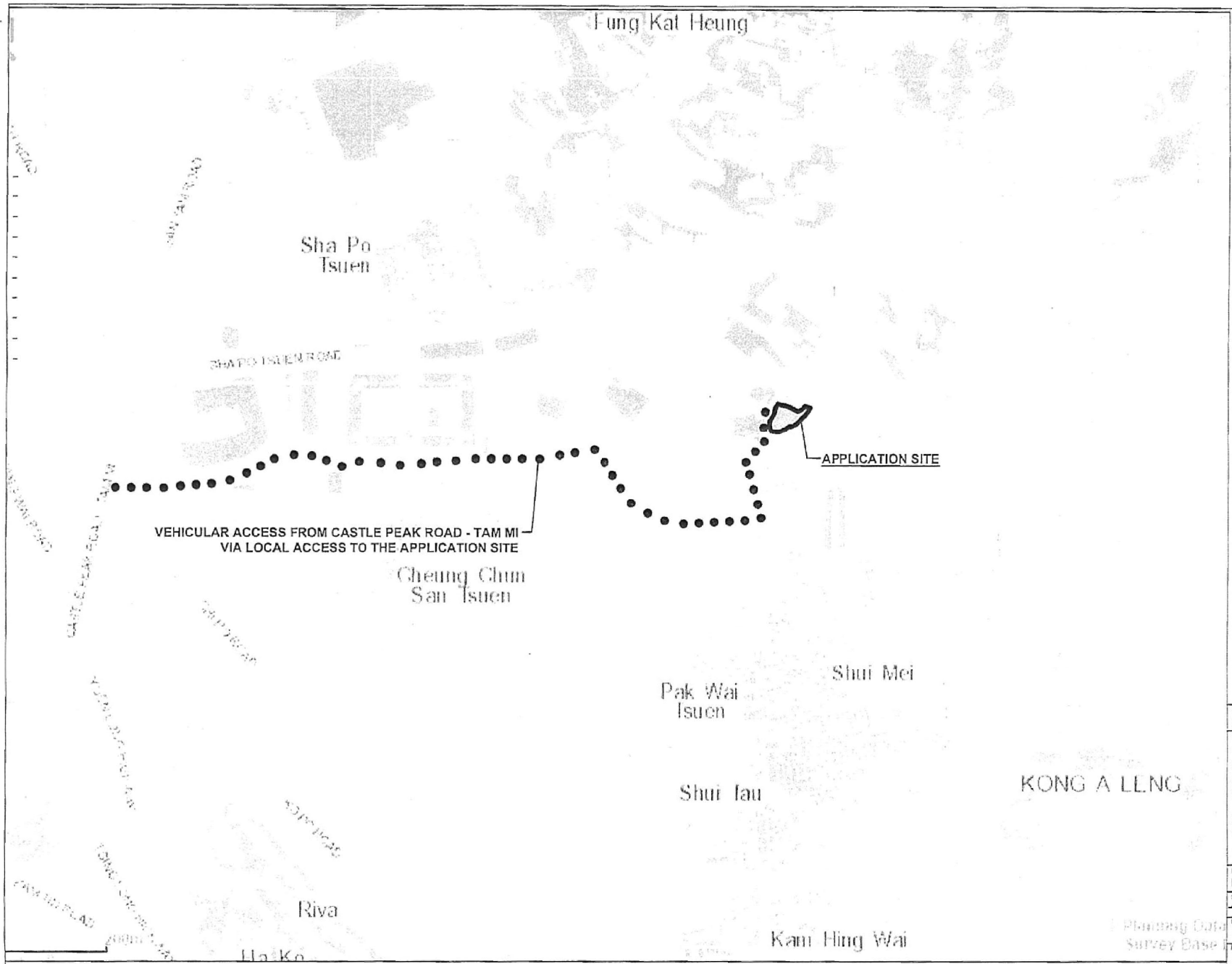

Drawing No.	Ver.
P01	01
Project	
TEMPORARY PLACE OF RECREATION, SPORTS OR CULTURE (HOBBY FARM) FOR A PERIOD OF 3 YEARS	
LOT 1467 (PART) AND 1485 (PART) IN D.D. 107	
Drawing Title	
LOCATION PLAN	
Scale of A4	
1 : 8000	
Drawn	Utd
8.1.2020	
Revised	Utd

(摘錄自申請人於 26. 2. 2020 呈交的申請書)  
 (Extract from Applicant's  
 Submission of 26.2.2020)

參考編號 REFERENCE No.	繪圖 DRAWING
A/YL-KTN/697	A-3

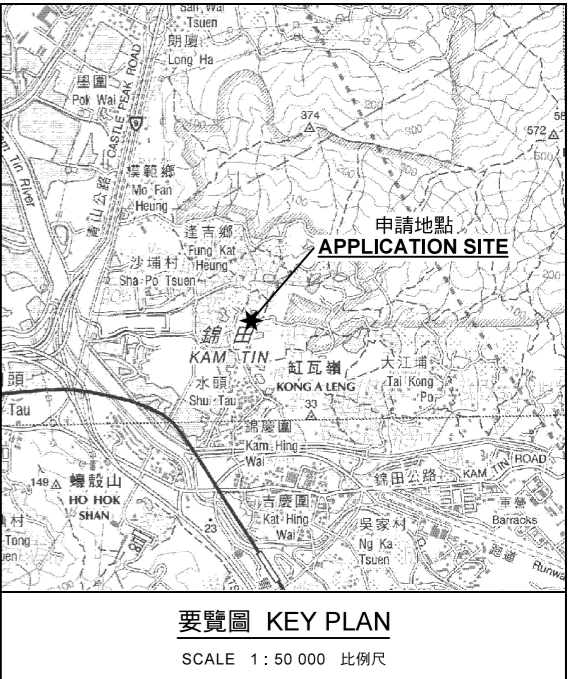
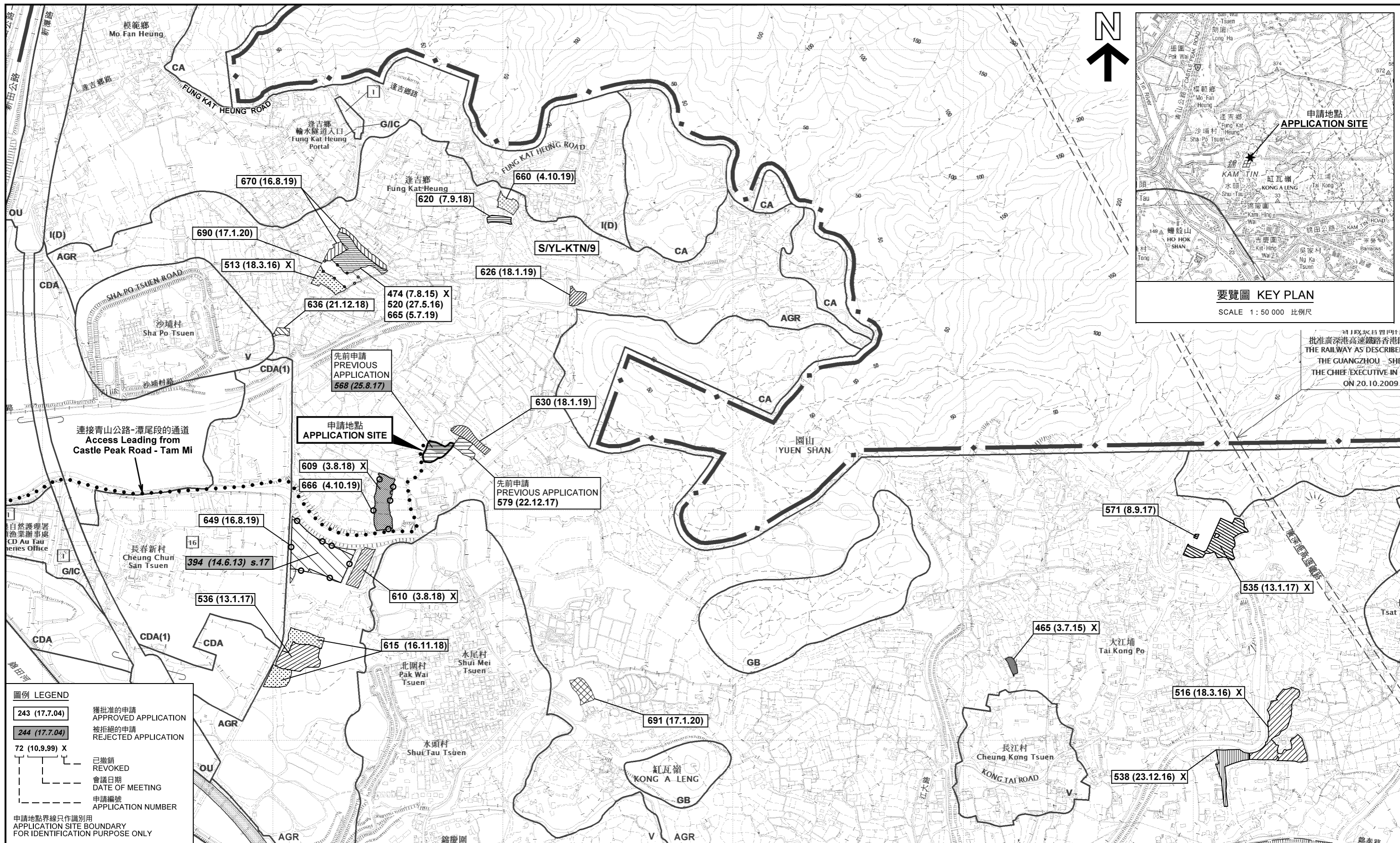

批准廣深港高速鐵路香港段  
THE RAILWAY AS DESCRIBED  
THE GUANGZHOU - SHE  
THE CHIEF EXECUTIVE IN C  
ON 20.10.2009

**圖例 LEGEND**

243 (17.7.04)	獲批准的申請 APPROVED APPLICATION
244 (17.7.04)	被拒絕的申請 REJECTED APPLICATION
72 (10.9.99) X	已撤銷 REVOKED
- - -	會議日期 DATE OF MEETING
- - -	申請編號 APPLICATION NUMBER

申請地點界線只作識別用  
APPLICATION SITE BOUNDARY  
FOR IDENTIFICATION PURPOSE ONLY

**位置圖及同類申請 LOCATION PLAN WITH SIMILAR APPLICATIONS**

擬議臨時康體文娛場所 (休閒農莊) (為期3年)  
元朗錦田水尾村丈量約份第107約  
地段第1467號(部分)及第1485號(部分)  
PROPOSED TEMPORARY PLACE OF RECREATION,  
SPORTS OR CULTURE (HOBBY FARM)  
FOR A PERIOD OF 3 YEARS  
LOTS 1467(PART) AND 1485(PART) IN D.D.107,  
SHUI MEI TSUEN, KAM TIN, YUEN LONG  
SCALE 1:7 500 比例尺

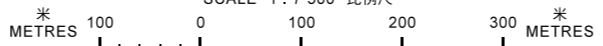

本摘要圖於2020年4月20日擬備，  
所根據的資料為於2014年12月2日  
核准的分區計劃大綱圖編號 S/YL-KTN/9  
EXTRACT PLAN PREPARED ON 20.4.2020  
BASED ON OUTLINE ZONING PLAN No.  
S/YL-KTN/9 APPROVED ON 2.12.2014

規劃署  
PLANNING DEPARTMENT



參考編號 REFERENCE No.  
A/YL-KTN/697

圖 PLAN  
A-1

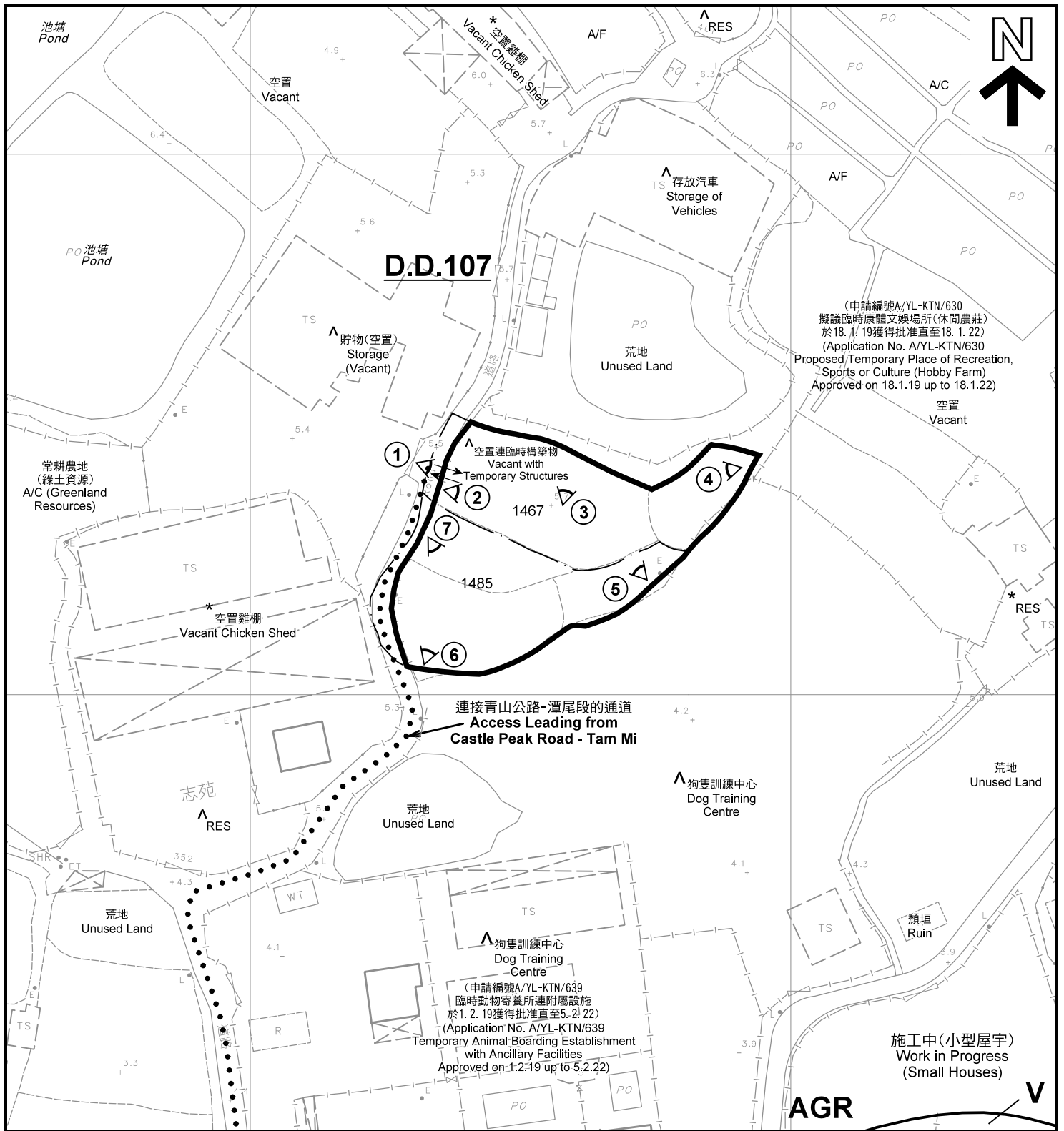

(申請編號A/YL-KTN/630  
擬議臨時康體文娛場所(休閒農莊)  
於18.1.19獲得批准直至18.1.22)  
(Application No. A/YL-KTN/630  
Proposed/Temporary Place of Recreation,  
Sports or Culture (Hobby Farm)  
Approved on 18.1.19 up to 18.1.22)

連接青山公路-潭尾段的通道  
Access Leading from  
Castle Peak Road - Tam Mi

(申請編號A/YL-KTN/639  
臨時動物寄養所連附屬設施  
於1.2.19獲得批准直至5.2.22)  
(Application No. A/YL-KTN/639  
Temporary Animal Boarding Establishment  
with Ancillary Facilities  
Approved on 1.2.19 up to 5.2.22)

註釋 Notes :

- (1) 2020年3月9日勘測的土地用途  
Land uses shown on this plan are in accordance with the land use survey conducted by the Planning Department on 9.3.2020
- (2) \* 土地用途跟1992年2月勘測的土地用途一致  
Indicates that the use is the same as that revealed by the land use survey conducted by the Planning Department in Feb 1992
- (3) ^ 土地用途跟1992年2月勘測的土地用途有別  
Indicates that the use is different from that revealed by the land use survey conducted by the Planning Department in Feb 1992

圖例 LEGEND

- 申請地點(界線只作識別用)  
APPLICATION SITE  
(BOUNDARY FOR IDENTIFICATION  
PURPOSE ONLY)
- V** 鄉村式發展  
VILLAGE TYPE DEVELOPMENT
- AGR** 農業  
AGRICULTURE

- A/C 常耕農地  
CULTIVATED AGRICULTURAL LAND
- RES 空置屋地/雜項  
RESIDENTIAL STRUCTURES
- A/F 休耕農地  
FALLOW AGRICULTURAL LAND
- 實地照片的觀景點  
VIEWING POINT OF SITE PHOTO
- 入口/出口  
INGRESS / EGRESS

平面圖 SITE PLAN

擬議臨時康體文娛場所(休閒農莊)(為期3年)  
元朗錦田水尾村丈量約份第107約  
地段第1467號(部分)及第1485號(部分)  
PROPOSED TEMPORARY PLACE OF RECREATION,  
SPORTS OR CULTURE (HOBBY FARM)  
FOR A PERIOD OF 3 YEARS  
LOTS 1467(PART) AND 1485(PART) IN D.D.107,  
SHUI MEI TSUEN, KAM TIN, YUEN LONG  
SCALE 1 : 1 000 比例尺

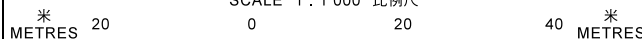

規劃署  
PLANNING  
DEPARTMENT



參考編號  
REFERENCE No.  
A/YL-KTN/697

圖 PLAN  
A-2

本摘要圖於2020年4月20日擬備, 所根據的資料為測量圖編號 6-NE-7A  
EXTRACT PLAN PREPARED ON 20.4.2020  
BASED ON SURVEY SHEET No.  
6-NE-7A

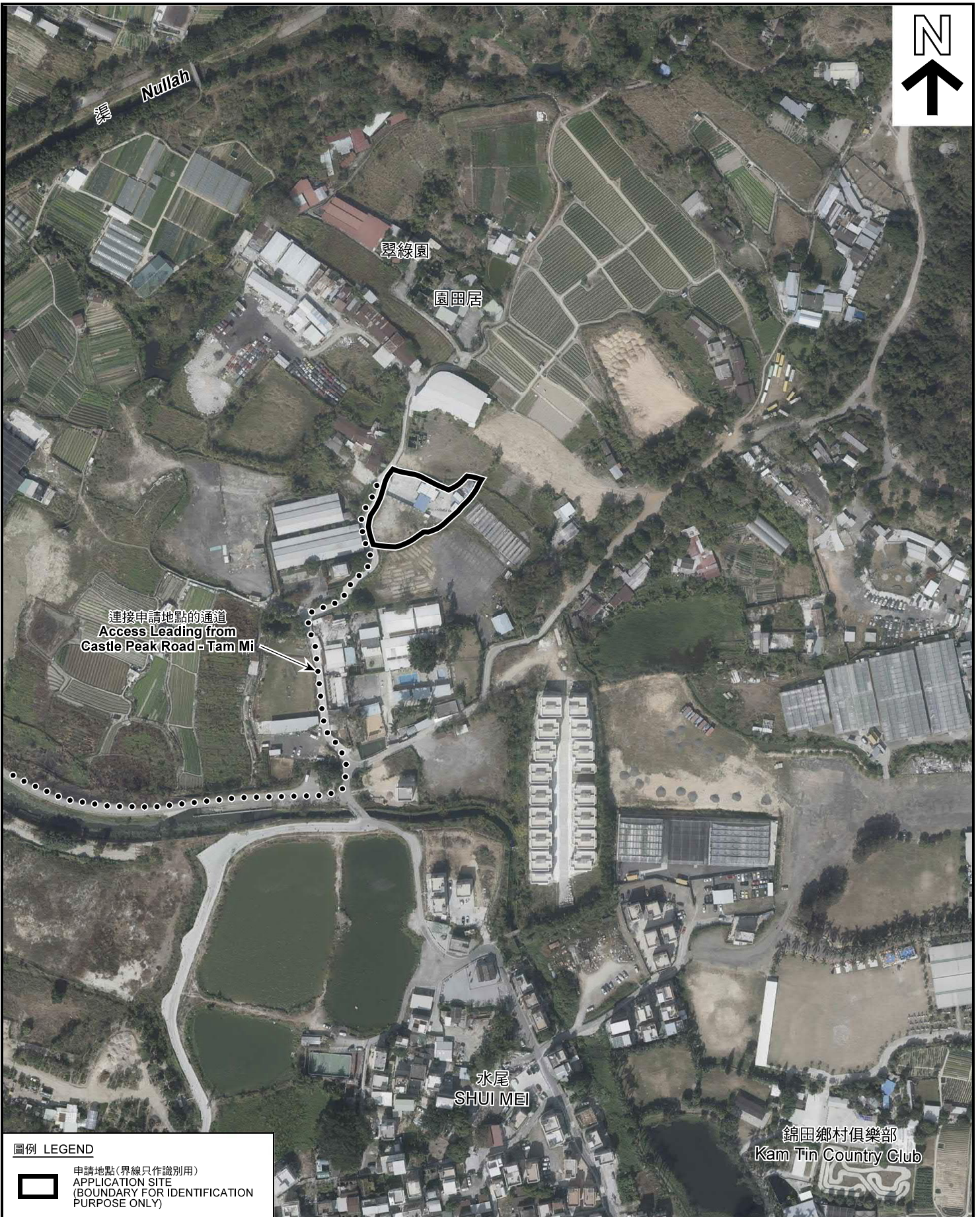

連接申請地點的通道  
Access Leading from  
Castle Peak Road - Tam Mi

圖例 LEGEND



申請地點(界線只作識別用)  
APPLICATION SITE  
(BOUNDARY FOR IDENTIFICATION  
PURPOSE ONLY)

本摘要圖於2020年4月20日擬備，所根據的資料為地政總署於2018年1月3日拍得的航攝照片編號 E033252C  
EXTRACT PLAN PREPARED ON 20.4.2020  
BASED ON AERIAL PHOTO No.  
E033252C TAKEN ON 3.1.2018  
BY LANDS DEPARTMENT

航攝照片 AERIAL PHOTO  
擬議臨時康體文娛場所(休閒農莊)(為期3年)  
元朗錦田水尾村丈量約份第107約  
地段第1467號(部分)及第1485號(部分)  
PROPOSED TEMPORARY PLACE OF RECREATION,  
SPORTS OR CULTURE (HOBBY FARM)  
FOR A PERIOD OF 3 YEARS  
LOTS 1467(PART) AND 1485(PART) IN D.D.107,  
SHUI MEI TSUEN, KAM TIN, YUEN LONG

規劃署  
PLANNING  
DEPARTMENT



參考編號  
REFERENCE No.  
A/YL-KTN/697

圖 PLAN  
A-3



申請地點界線只作識別用 APPLICATION SITE BOUNDARY FOR IDENTIFICATION PURPOSE ONLY

本圖於2020年4月20日擬備，所根據的資料為攝於2020年3月16日的實地照片  
 PLAN PREPARED ON 20.4.2020  
 BASED ON SITE PHOTOS  
 TAKEN ON 16.3.2020

**實地照片 SITE PHOTOS**  
 擬議臨時康體文娛場所（休閒農莊）（為期3年）  
 元朗錦田水尾村丈量約份第107約  
 地段第1467號（部分）及第1485號（部分）  
 PROPOSED TEMPORARY PLACE OF RECREATION,  
 SPORTS OR CULTURE (HOBBY FARM)  
 FOR A PERIOD OF 3 YEARS  
 LOTS 1467(PART) AND 1485(PART) IN D.D.107,  
 SHUI MEI TSUEN, KAM TIN, YUEN LONG

規劃署  
 PLANNING  
 DEPARTMENT



參考編號  
 REFERENCE No.  
 A/YL-KTN/697

圖 PLAN  
 A-4a



5

申請地點  
APPLICATION SITE



6

申請地點  
APPLICATION SITE



7

申請地點  
APPLICATION SITE

申請地點界線只作識別用 APPLICATION SITE BOUNDARY FOR IDENTIFICATION PURPOSE ONLY

本圖於2020年4月20日擬備，所根據的資料為攝於2020年3月16日的實地照片  
PLAN PREPARED ON 20.4.2020  
BASED ON SITE PHOTOS  
TAKEN ON 16.3.2020

**實地照片 SITE PHOTOS**  
擬議臨時康體文娛場所（休閒農莊）（為期3年）  
元朗錦田水尾村丈量約份第107約  
地段第1467號（部分）及第1485號（部分）  
PROPOSED TEMPORARY PLACE OF RECREATION,  
SPORTS OR CULTURE (HOBBY FARM)  
FOR A PERIOD OF 3 YEARS  
LOTS 1467(PART) AND 1485(PART) IN D.D.107,  
SHUI MEI TSUEN, KAM TIN, YUEN LONG

規劃署  
PLANNING  
DEPARTMENT



參考編號  
REFERENCE No.  
A/YL-KTN/697

圖 PLAN  
A-4b