







Legend:

-  Proposed covered-land area (storeroom) (approx. 7m²)
-  Proposed covered land area (office/staff restroom) Approx. 14m² each (total area: approx. 56m²)
-  Applicant Site Area (Approx. 596m²)
-  Proposed loading/unloading area
-  Proposed Car Park Space for Staff
-  Entrance Gate (5800mm Width)
-  Existing Vehicular Routing



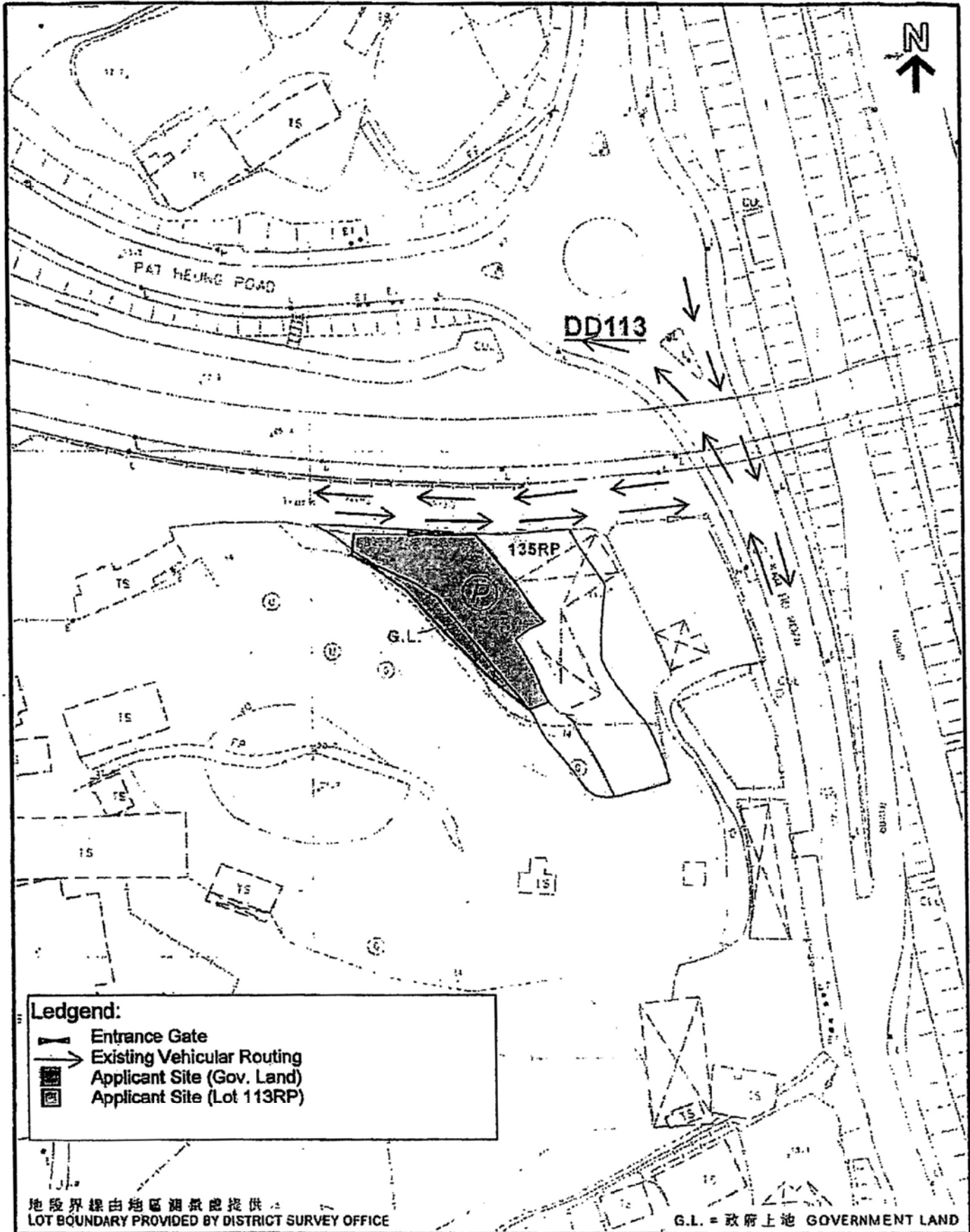

Remarks: All buildings/structures are 1 floor only (no different floors)

(摘錄自申請人於 30.4.2018 呈交的申請書)
 (Extract from Applicant's
 Submission of 30.4.2018)

參考編號 REFERENCE No. A/YL-KTS/786	繪圖 DRAWING A-1
---------------------------------------	-------------------



Legend:

-  Entrance Gate
-  Existing Vehicular Routing
-  Applicant Site (Gov. Land)
-  Applicant Site (Lot 113RP)

地段界線由地區測量處提供
 LOT BOUNDARY PROVIDED BY DISTRICT SURVEY OFFICE

G.L. = 政府上地 GOVERNMENT LAND

Government Land
Applicant Site in Lot 113RP
 二零一五年十一月十二日根據測量條例
 6-NE-17D/22B製繪的圖則
 EXTRACT PLAN PREPARED ON 12.11.2015
 BASED ON SURVEY SHEET No(s).
 6-NE-17D/22B

圖則所示第113約
 的地段及毗鄰政府土地
**LOT(S) AS SHOWN ON THIS PLAN IN DD113
 AND ADJOINING GOVERNMENT LAND**
 SCALE 1:1000 比例尺

--	--

(摘錄自申請人於 30.4.2018 提交的申請書)
 (Extract from Applicant's
 Submission of 30.4.2018)

參考編號
 REFERENCE No.
A/YL-KTS/786

繪圖 DRAWING
A-2

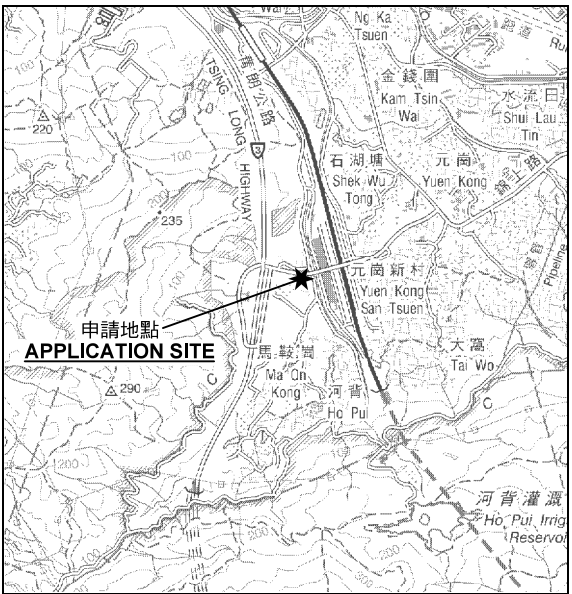
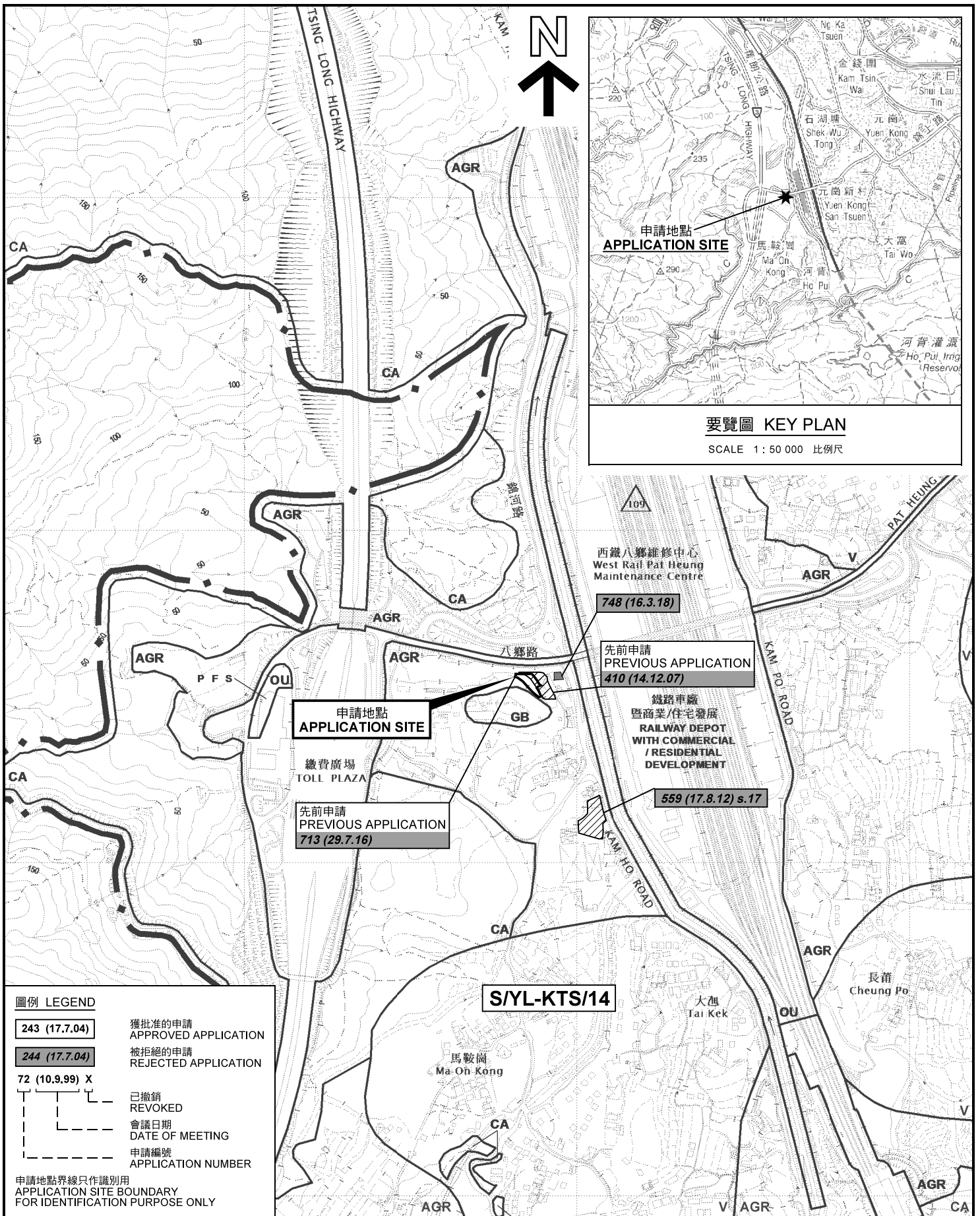

要覽圖 KEY PLAN

SCALE 1 : 50 000 比例尺

圖例 LEGEND

- 243 (17.7.04) 獲批准的申請
APPROVED APPLICATION
- 244 (17.7.04) 被拒絕的申請
REJECTED APPLICATION
- 72 (10.9.99) X 已撤銷
REVOKED
- 會議日期
DATE OF MEETING
- 申請編號
APPLICATION NUMBER

申請地點界線只作識別用
APPLICATION SITE BOUNDARY
FOR IDENTIFICATION PURPOSE ONLY

位置圖及同類申請 LOCATION PLAN WITH SIMILAR APPLICATION

臨時露天存放建築材料及機械和辦公室、
員工休息室及儲物室（為期3年）
元朗錦田丈量約份第113約地段第133號餘段（部分）和毗連政府土地
TEMPORARY OPEN STORAGE OF CONSTRUCTION MATERIALS AND
MACHINERY, OFFICE, STAFF RESTROOM AND STORE ROOM
FOR A PERIOD OF 3 YEARS
LOT 133 RP (PART) IN D.D. 113 AND
ADJOINING GOVERNMENT LAND, KAM TIN, YUEN LONG
SCALE 1 : 7 500 比例尺

米 100 0 100 200 300 米
METRES

規劃署
PLANNING
DEPARTMENT



參考編號
REFERENCE No.
A/YL-KTS/786

圖 PLAN
A-1

本摘要圖於2018年5月25日擬備，
所根據的資料為於2017年11月3日
展示的分區計劃大綱圖編號 S/YL-KTS/14
EXTRACT PLAN PREPARED ON 25.5.2018
BASED ON OUTLINE ZONING PLAN NO.
S/YL-KTS/14 EXHIBITED ON 3.11.2017

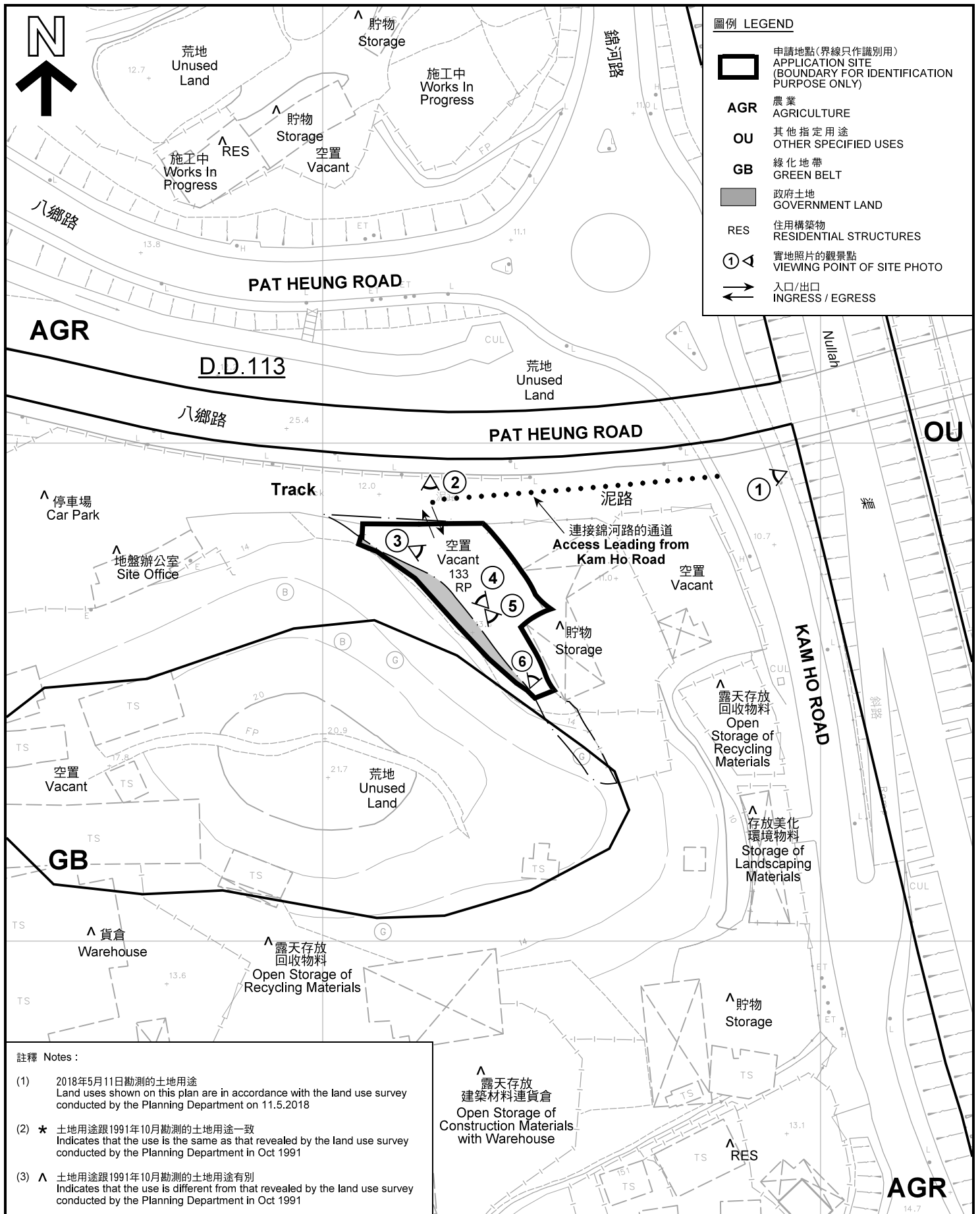

平面圖 SITE PLAN

臨時露天存放建築材料及機械和辦公室、
員工休息室及儲物室 (為期3年)
元朗錦田丈量約份第113約地段第133號餘段(部分)和毗連政府土地
TEMPORARY OPEN STORAGE OF CONSTRUCTION MATERIALS AND
MACHINERY, OFFICE, STAFF RESTROOM AND STORE ROOM
FOR A PERIOD OF 3 YEARS
LOT 133 RP (PART) IN D.D. 113 AND
ADJOINING GOVERNMENT LAND, KAM TIN, YUEN LONG
SCALE 1 : 1 000 比例尺

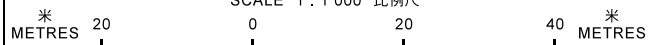

**規劃署
PLANNING
DEPARTMENT**



參考編號
REFERENCE No.
A/YL-KTS/786

圖 PLAN
A-2

本摘要圖於2018年5月25日擬備，所根據的資料為測量圖編號 6-NE-17D 及 6-NE-22B
EXTRACT PLAN PREPARED ON 25.5.2018
BASED ON SURVEY SHEETS No.
6-NE-17D & 6-NE-22B

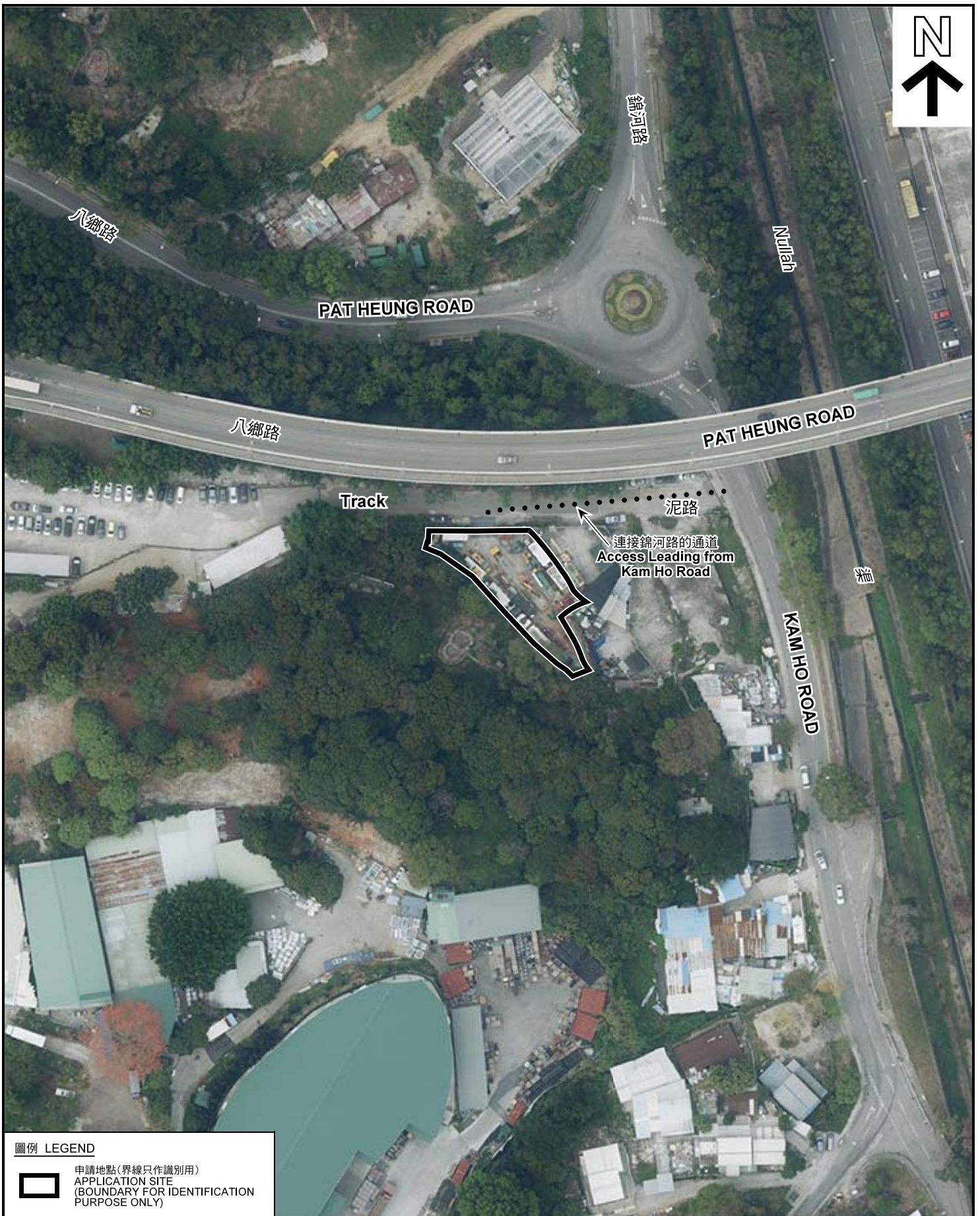

圖例 LEGEND



申請地點(界線只作識別用)
APPLICATION SITE
(BOUNDARY FOR IDENTIFICATION
PURPOSE ONLY)

本摘要圖於2018年5月25日擬備，所根據的資料為地政總署於2018年3月13日拍得的航攝照片編號 E035938C

EXTRACT PLAN PREPARED ON 25.5.2018
BASED ON AERIAL PHOTO No.
E035938C TAKEN ON 13.3.2018
BY LANDS DEPARTMENT

航攝照片 AERIAL PHOTO

臨時露天存放建築材料及機械和辦公室、
員工休息室及儲物室 (為期3年)
元朗錦田丈量約份第113約地段第133號餘段(部分)和毗連政府土地
TEMPORARY OPEN STORAGE OF CONSTRUCTION MATERIALS AND
MACHINERY, OFFICE, STAFF RESTROOM AND STORE ROOM
FOR A PERIOD OF 3 YEARS
LOT 133 RP (PART) IN D.D. 113 AND
ADJOINING GOVERNMENT LAND, KAM TIN, YUEN LONG

規劃署
PLANNING
DEPARTMENT



參考編號
REFERENCE No.
AYL-KTS/786

圖 PLAN
A-3

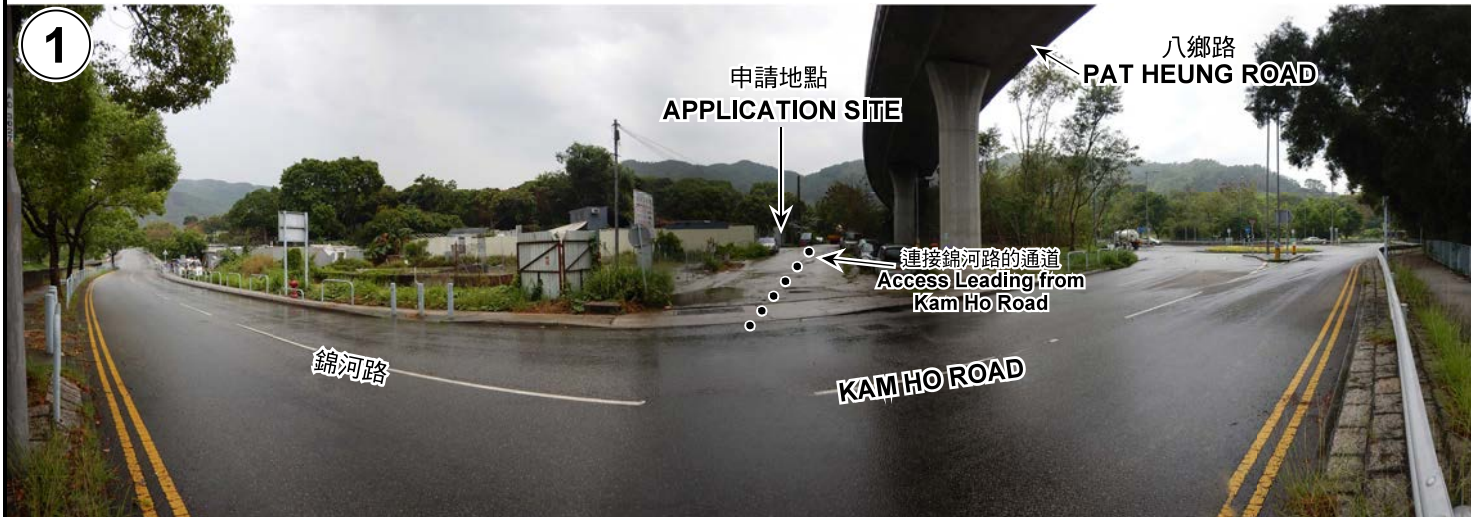

申請地點界線只作識別用 APPLICATION SITE BOUNDARY FOR IDENTIFICATION PURPOSE ONLY

實地照片 SITE PHOTOS

臨時露天存放建築材料及機械和辦公室、
員工休息室及儲物室（為期3年）
元朗錦田丈量約份第113約地段第133號餘段（部分）和毗連政府土地
TEMPORARY OPEN STORAGE OF CONSTRUCTION MATERIALS AND
MACHINERY, OFFICE, STAFF RESTROOM AND STORE ROOM
FOR A PERIOD OF 3 YEARS
LOT 133 RP (PART) IN D.D. 113 AND
ADJOINING GOVERNMENT LAND, KAM TIN, YUEN LONG

規劃署
PLANNING
DEPARTMENT



參考編號
REFERENCE No.
A/YL-KTS/786

圖 PLAN
A-4a

本圖於2018年5月25日擬備，所根據的資料為攝於2018年5月8日的實地照片
PLAN PREPARED ON 25.5.2018
BASED ON SITE PHOTOS
TAKEN ON 8.5.2018



實地照片 SITE PHOTOS

臨時露天存放建築材料及機械和辦公室、
員工休息室及儲物室（為期3年）
元朗錦田丈量約份第113約地段第133號餘段（部分）和毗連政府土地
TEMPORARY OPEN STORAGE OF CONSTRUCTION MATERIALS AND
MACHINERY, OFFICE, STAFF RESTROOM AND STORE ROOM
FOR A PERIOD OF 3 YEARS
LOT 133 RP (PART) IN D.D. 113 AND
ADJOINING GOVERNMENT LAND, KAM TIN, YUEN LONG

規劃署
PLANNING
DEPARTMENT



參考編號
REFERENCE No.
A/YL-KTS/786

圖 PLAN
A-4b

本圖於2018年5月25日擬備，所根據的資料為攝於2018年5月8日的實地照片
PLAN PREPARED ON 25.5.2018
BASED ON SITE PHOTOS
TAKEN ON 8.5.2018