

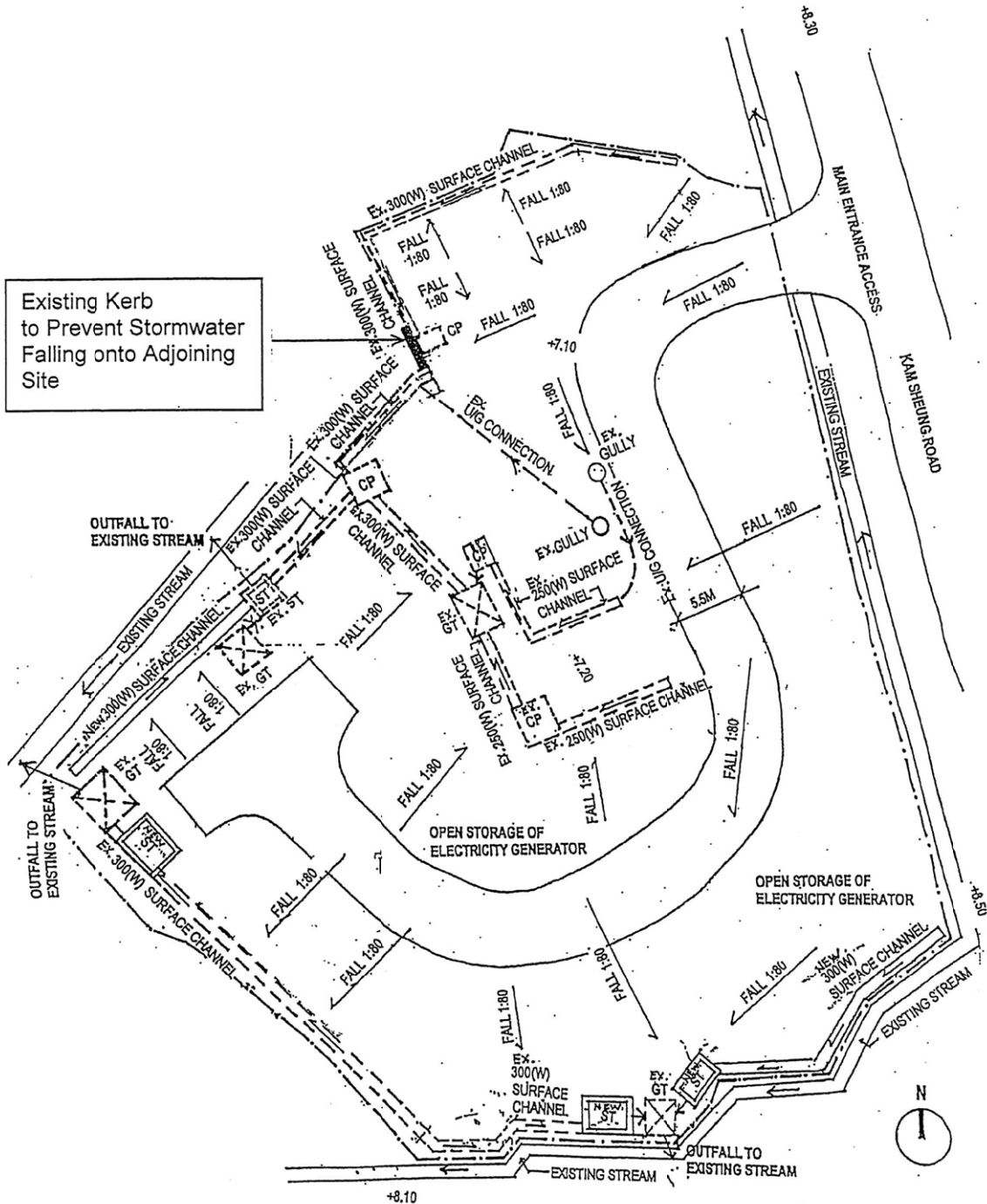





Existing Kerb  
to Prevent Stormwater  
Falling onto Adjoining  
Site



**Legend**

-  GT GREASE TRAP
-  CP CATCHPIT
-  SITE BOUNDARY
-  ST STAND TRAP

**Approved Drainage Proposal**

Renewal of Permission for  
an Approved Temporary Open Storage of  
Electricity Generators and Compressors  
with Maintenance Work  
at Various Lots in DD106,  
Kam Tin, Yuen Long



Plan 4

**PlanArch Consultants Ltd.**

Revision:                      Date: 19.4.2018

(摘錄自申請人於 3.5.2018 呈交的申請書)  
(Extract from Applicant's  
Submission of 3.5.2018)

參考編號  
REFERENCE No.  
**A/YL-KTS/787**

繪圖 DRAWING  
**A-2**

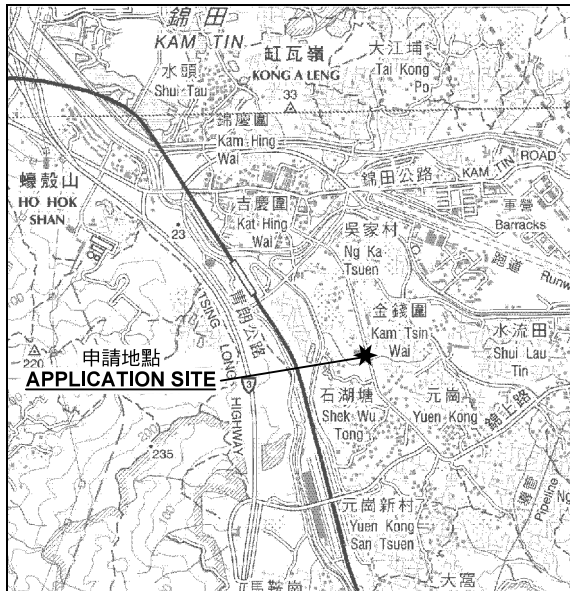
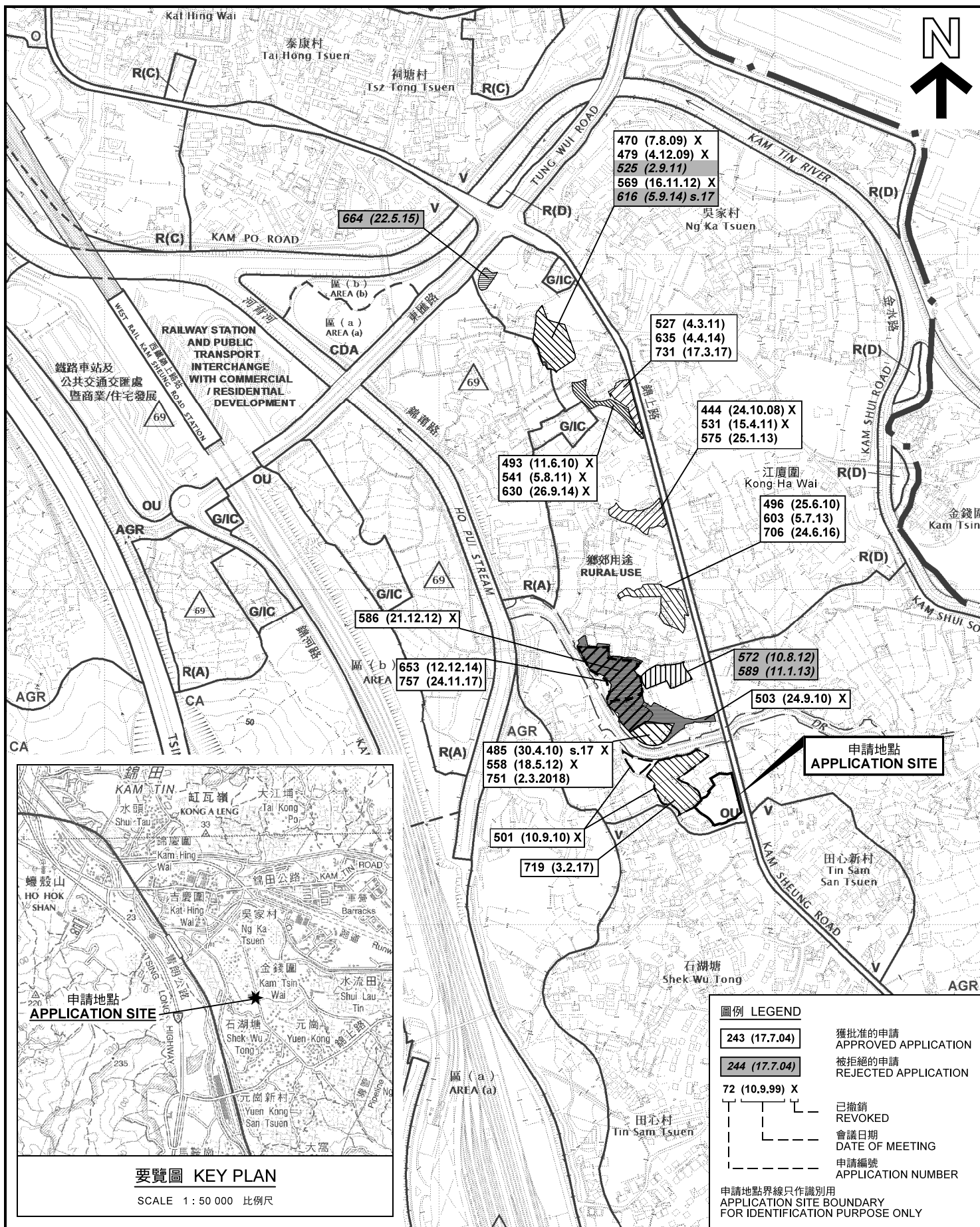

要覽圖 KEY PLAN

SCALE 1 : 50 000 比例尺

**圖例 LEGEND**

243 (17.7.04)	獲批准的申請 APPROVED APPLICATION
244 (17.7.04)	被拒絕的申請 REJECTED APPLICATION
72 (10.9.99) X	已撤銷 REVOKED
---	會議日期 DATE OF MEETING
---	申請編號 APPLICATION NUMBER

申請地點界線只作識別用  
APPLICATION SITE BOUNDARY  
FOR IDENTIFICATION PURPOSE ONLY

本摘要圖於2018年6月5日擬備，  
所根據的資料為於2017年11月3日  
展示的分區計劃大綱圖編號 S/YL-KTS/14  
EXTRACT PLAN PREPARED ON 5.6.2018  
BASED ON OUTLINE ZONING PLAN No.  
S/YL-KTS/14 EXHIBITED ON 3.11.2017

位置圖及同類申請 LOCATION PLAN WITH SIMILAR APPLICATIONS

臨時露天存放發電機及壓縮器包括維修工序用途的規劃許可續期 (為期1年)  
元朗錦田石湖塘丈量約份第106約地段第391號餘段(部分)及第392號餘段  
RENEWAL OF PLANNING APPROVAL FOR  
TEMPORARY OPEN STORAGE OF ELECTRICITY GENERATORS AND  
COMPRESSORS WITH MAINTENANCE WORK FOR A PERIOD OF 1 YEAR  
LOTS 391 RP (PART) AND 392 RP IN D.D.106, SHEK WU TONG,  
KAM TIN, YUEN LONG

SCALE 1 : 7 500 比例尺

米 100 0 100 200 300 米  
METRES

規劃署  
PLANNING  
DEPARTMENT



參考編號  
REFERENCE No.  
A/YL-KTS/787

圖 PLAN  
A-1a

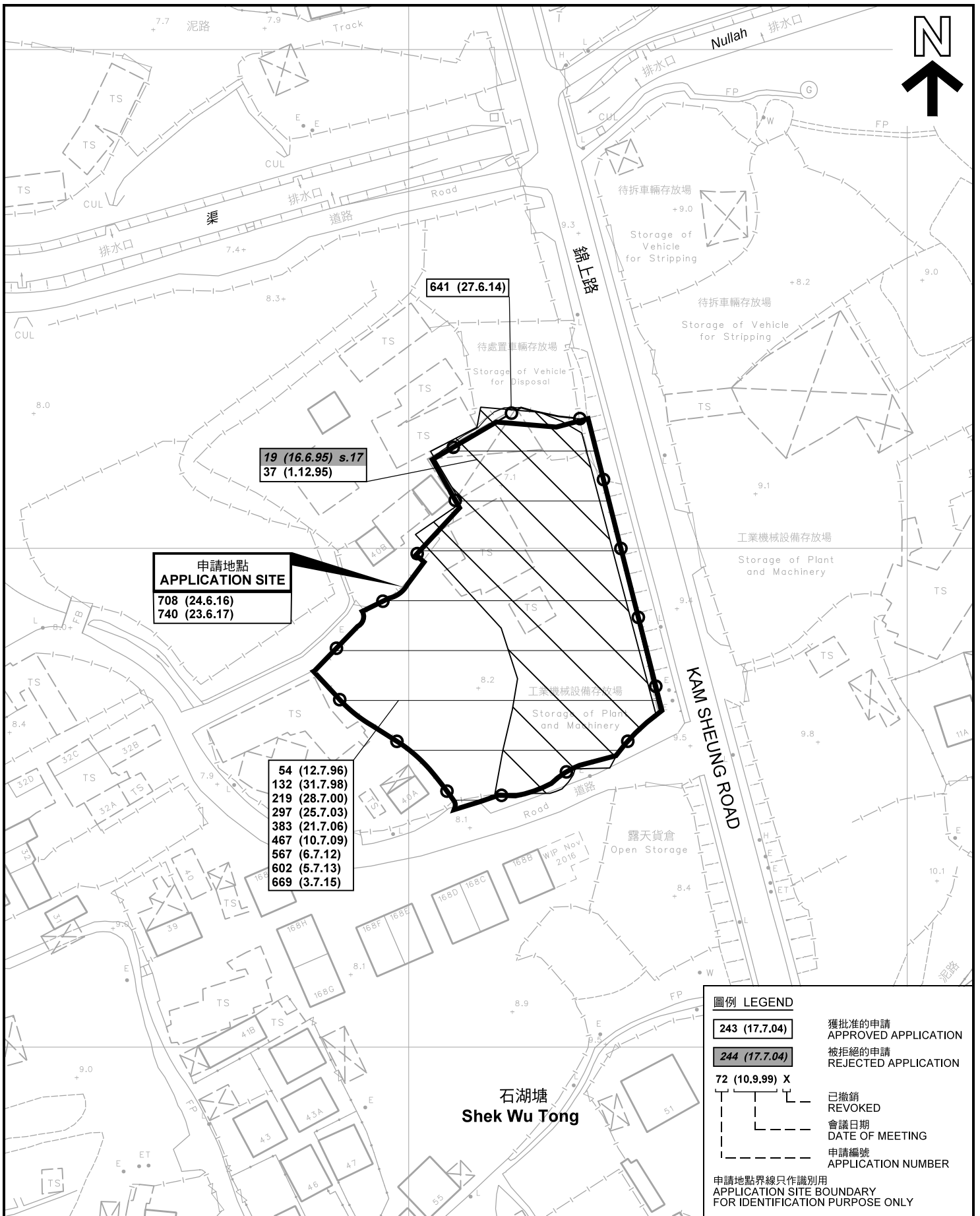

申請地點  
**APPLICATION SITE**  
708 (24.6.16)  
740 (23.6.17)

19 (16.6.95) s.17  
37 (1.12.95)

641 (27.6.14)

54 (12.7.96)  
132 (31.7.98)  
219 (28.7.00)  
297 (25.7.03)  
383 (21.7.06)  
467 (10.7.09)  
567 (6.7.12)  
602 (5.7.13)  
669 (3.7.15)

**圖例 LEGEND**

243 (17.7.04)

獲批准的申請  
APPROVED APPLICATION

244 (17.7.04)

被拒絕的申請  
REJECTED APPLICATION

72 (10.9.99) X

已撤銷  
REVOKED

會議日期  
DATE OF MEETING

申請編號  
APPLICATION NUMBER

申請地點界線只作識別用  
APPLICATION SITE BOUNDARY  
FOR IDENTIFICATION PURPOSE ONLY

石湖塘  
Shek Wu Tong

**先前申請圖 PREVIOUS APPLICATION PLAN**

臨時露天存放發電機及壓縮器包括維修工序用途的規劃許可續期(為期1年)  
元朗錦田石湖塘丈量約份第106約地段第391號餘段(部分)及第392號餘段  
RENEWAL OF PLANNING APPROVAL FOR  
TEMPORARY OPEN STORAGE OF ELECTRICITY GENERATORS AND  
COMPRESSORS WITH MAINTENANCE WORK FOR A PERIOD OF 1 YEAR  
LOTS 391 RP (PART) AND 392 RP IN D.D.106, SHEK WU TONG,  
KAM TIN, YUEN LONG

SCALE 1 : 1 000 比例尺

米 20 0 20 40 米  
METRES

本摘要圖於2018年6月4日擬備，所根據的資料為測量圖編號 6-NE-17B 及 18A  
EXTRACT PLAN PREPARED ON 4.6.2018  
BASED ON SURVEY SHEETS No.  
6-NE-17B & 18A

規劃署  
PLANNING  
DEPARTMENT



參考編號  
REFERENCE No.  
A/YL-KTS/787

圖 PLAN  
A-1b

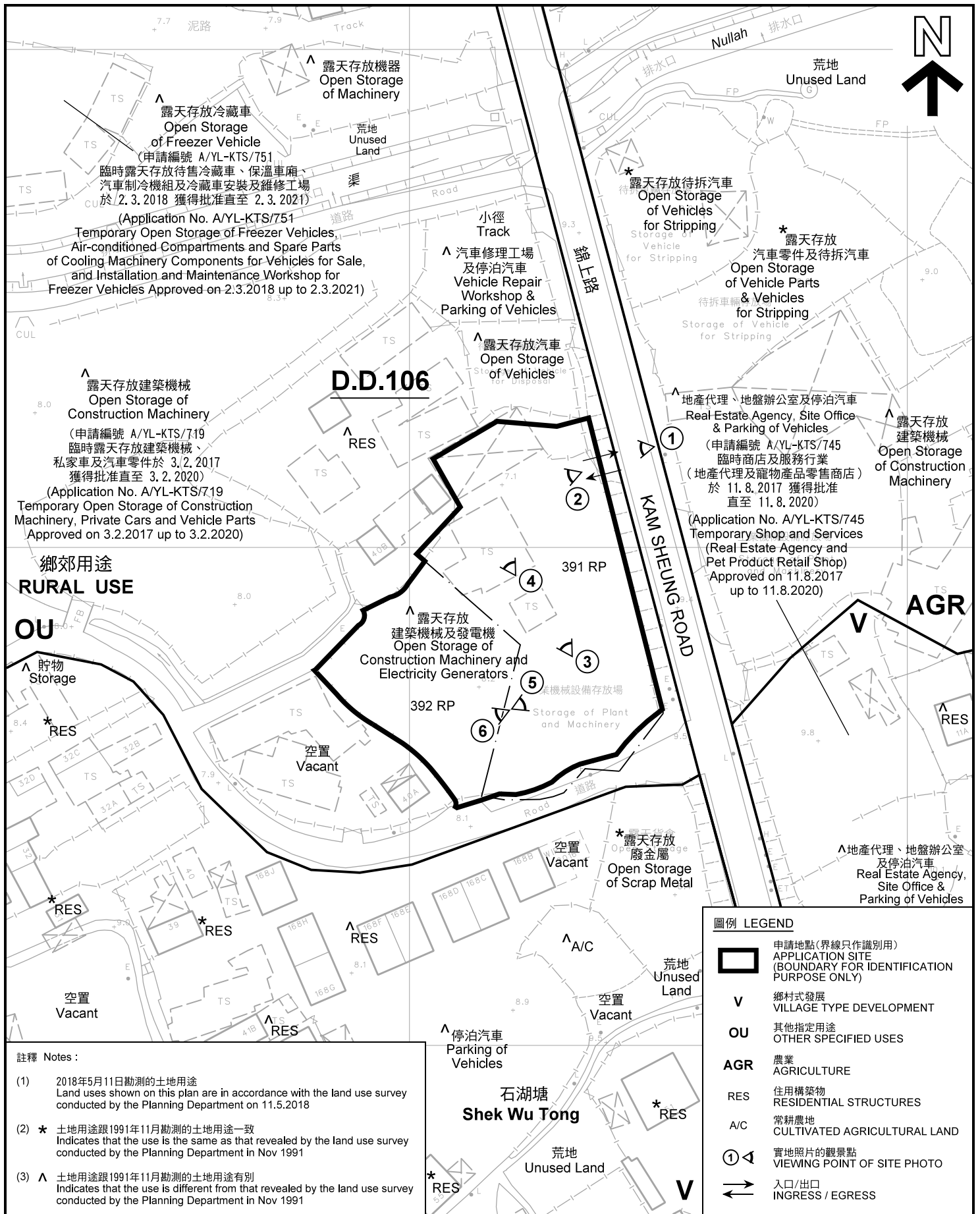

**註釋 Notes :**

- (1) 2018年5月11日勘測的土地用途  
Land uses shown on this plan are in accordance with the land use survey conducted by the Planning Department on 11.5.2018
- (2) \* 土地用途跟1991年11月勘測的土地用途一致  
Indicates that the use is the same as that revealed by the land use survey conducted by the Planning Department in Nov 1991
- (3) ^ 土地用途跟1991年11月勘測的土地用途有別  
Indicates that the use is different from that revealed by the land use survey conducted by the Planning Department in Nov 1991

**圖例 LEGEND**

- 申請地點(界線只作識別用)  
APPLICATION SITE (BOUNDARY FOR IDENTIFICATION PURPOSE ONLY)
- V** 鄉村式發展  
VILLAGE TYPE DEVELOPMENT
- OU** 其他指定用途  
OTHER SPECIFIED USES
- AGR** 農業  
AGRICULTURE
- RES** 住用構築物  
RESIDENTIAL STRUCTURES
- A/C** 常耕農地  
CULTIVATED AGRICULTURAL LAND
- 實地照片的觀景點  
VIEWING POINT OF SITE PHOTO
- 入口/出口  
INGRESS / EGRESS

**平面圖 SITE PLAN**

臨時露天存放發電機及壓縮器包括維修工用途的規劃許可續期(為期1年)  
元朗錦田石湖塘文量約份第106約地段第391號餘段(部分)及第392號餘段  
RENEWAL OF PLANNING APPROVAL FOR  
TEMPORARY OPEN STORAGE OF ELECTRICITY GENERATORS AND  
COMPRESSORS WITH MAINTENANCE WORK FOR A PERIOD OF 1 YEAR  
LOTS 391 RP (PART) AND 392 RP IN D.D.106, SHEK WU TONG,  
KAM TIN, YUEN LONG

SCALE 1 : 1 000 比例尺

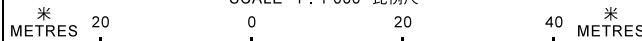

本摘要圖於2018年6月4日擬備，所根據的資料為測量圖編號 6-NE-17B 及 18A  
EXTRACT PLAN PREPARED ON 4.6.2018  
BASED ON SURVEY SHEETS No. 6-NE-17B & 18A

**規劃署  
PLANNING  
DEPARTMENT**



參考編號  
REFERENCE No.  
**A/YL-KTS/787**

圖 **PLAN**  
**A-2**

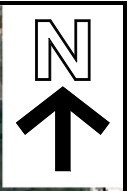

圖例 LEGEND



申請地點(界線只作識別用)  
APPLICATION SITE  
(BOUNDARY FOR IDENTIFICATION  
PURPOSE ONLY)

本摘要圖於2018年6月4日擬備，所根據的資料為地政總署於2017年4月2日拍得的航攝照片編號 E016592C  
EXTRACT PLAN PREPARED ON 4.6.2018  
BASED ON AERIAL PHOTO No.  
E016592C TAKEN ON 2.4.2017  
BY LANDS DEPARTMENT

航攝照片 AERIAL PHOTO

臨時露天存放發電機及壓縮器包括維修工序用途的規劃許可續期(為期1年)  
元朗錦田石湖塘丈量約份第106約地段第391號餘段(部分)及第392號餘段  
RENEWAL OF PLANNING APPROVAL FOR  
TEMPORARY OPEN STORAGE OF ELECTRICITY GENERATORS AND  
COMPRESSORS WITH MAINTENANCE WORK FOR A PERIOD OF 1 YEAR  
LOTS 391 RP (PART) AND 392 RP IN D.D.106, SHEK WU TONG,  
KAM TIN, YUEN LONG

規劃署  
PLANNING  
DEPARTMENT



參考編號  
REFERENCE No.  
AYL-KTS/787

圖 PLAN  
A-3



申請地點界線只作識別用 APPLICATION SITE BOUNDARY FOR IDENTIFICATION PURPOSE ONLY

### 實地照片 SITE PHOTOS

臨時露天存放發電機及壓縮器包括維修工序用途的規劃許可續期（為期1年）  
元朗錦田石湖塘丈量約份第106約地段第391號餘段（部分）及第392號餘段  
RENEWAL OF PLANNING APPROVAL FOR  
TEMPORARY OPEN STORAGE OF ELECTRICITY GENERATORS AND  
COMPRESSORS WITH MAINTENANCE WORK FOR A PERIOD OF 1 YEAR  
LOTS 391 RP (PART) AND 392 RP IN D.D.106, SHEK WU TONG,  
KAM TIN, YUEN LONG

規劃署  
PLANNING  
DEPARTMENT



參考編號  
REFERENCE No.  
AYL-KTS/787

圖 PLAN  
A-4a

本圖於2018年6月4日擬備，所根據的資料為攝於2018年5月11日的實地照片  
PLAN PREPARED ON 4.6.2018  
BASED ON SITE PHOTOS  
TAKEN ON 11.5.2018



申請地點  
APPLICATION SITE



申請地點  
APPLICATION SITE

實地照片 SITE PHOTOS

臨時露天存放發電機及壓縮器包括維修工序用途的規劃許可續期 (為期1年)  
元朗錦田石湖墟丈量約份第106約地段第391號餘段(部分)及第392號餘段  
RENEWAL OF PLANNING APPROVAL FOR  
TEMPORARY OPEN STORAGE OF ELECTRICITY GENERATORS AND  
COMPRESSORS WITH MAINTENANCE WORK FOR A PERIOD OF 1 YEAR  
LOTS 391 RP (PART) AND 392 RP IN D.D.106, SHEK WU TONG,  
KAM TIN, YUEN LONG

規劃署  
PLANNING  
DEPARTMENT



參考編號  
REFERENCE No.  
AYL-KTS/787

圖 PLAN  
A-4b

本圖於2018年6月4日擬備，所根據的資料為攝於2018年5月11日的實地照片  
PLAN PREPARED ON 4.6.2018  
BASED ON SITE PHOTOS  
TAKEN ON 11.5.2018