

DEVELOPMENT PARAMETERS

APPLICATION SITE AREA : 1,131m² (ABOUT)
 COVERED AREA : 90m² (ABOUT)
 UNCOVERED AREA : 1,041m² (ABOUT)

PLOT RATIO : 0.08
 SITE COVERAGE : 8%

NO. OF STRUCTURE : 1
 DOMESTIC GFA : N/A
 NON-DOMESTIC GFA : 90m² (ABOUT)
 BUILDING HEIGHT : 3.5m (ABOUT)
 NO. OF STOREY : 1

STRUCTURE	PROPOSED USE	COVERED AREA	NON-DOM.GFA	BUILDING HEIGHT
B1	AGRICULTURAL EDUCATION ROOM, STORAGE OF FARM TOOL, METER ROOM AND CHANGING ROOM	90m ² (ABOUT)	90m ² (ABOUT)	3.5m (ABOUT)(1-STOREY)
TOTAL		90m² (ABOUT)	90m² (ABOUT)	

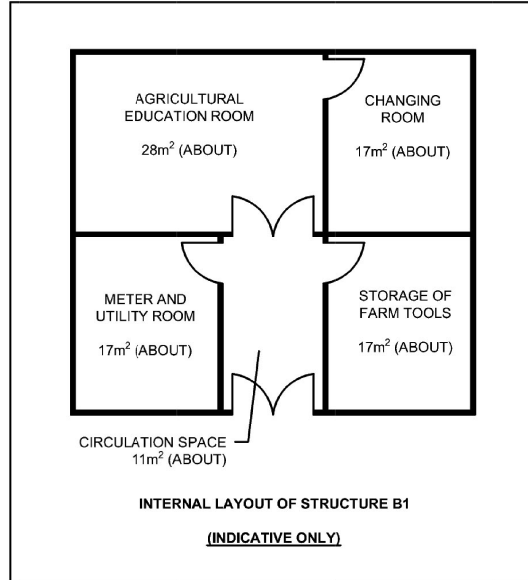
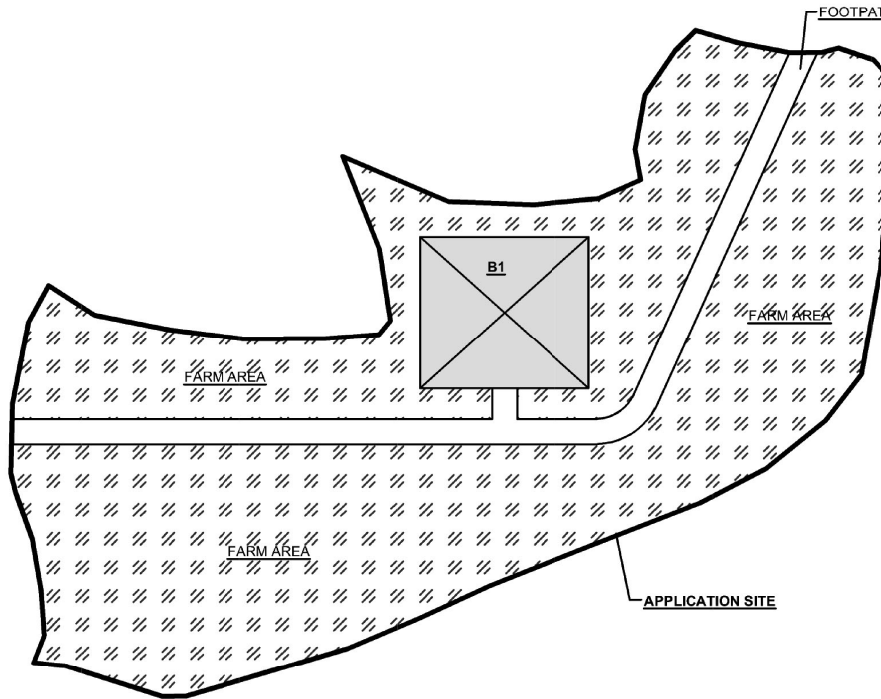
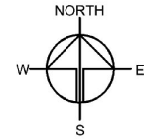

LEGEND

- APPLICATION SITE
- STRUCTURE

PLAN 1

Drawing No. P04	Ver. 01
Project PROPOSED TEMPORARY PLACE OF RECREATION, SPORTS OR CULTURE (HOBBY FARM) FOR A PERIOD OF 5 YEARS AND LAND FILLING	
LOT 1644 S.C IN D.D. 112	
Drawing Title LAYOUT PLAN	
Scale of A4 1:400	
Drawn	Date 1.6.2020
Revised	Date 10.8.2020

(資料來源:申請人於 17. 8. 2020 呈交的資料)
 (Source : Applicant's Submission of 17.8.2020)

參考編號
 REFERENCE No.
 A/YL-SK/283

繪圖 DRAWING
 A-1

PAVED RATIO OF THE APPLICATION SITE

APPLICATION SITE AREA : 1,131m² (ABOUT)
 FARM AREA : 947m² (84%)(ABOUT)
 SOILED GROUND : 94m² (8%)(ABOUT)
 PURPOSE : FOOTPATH
 LAND FILLING AREA : 90m² (8%)(ABOUT)
 LAND FILLING MATERIAL : CONCRETE
 DEPTH OF LAND FILLING : NOT MORE THAN 0.2m
 PURPOSE OF LAND FILLING : SITE FORMATION OF STRUCTURE B1

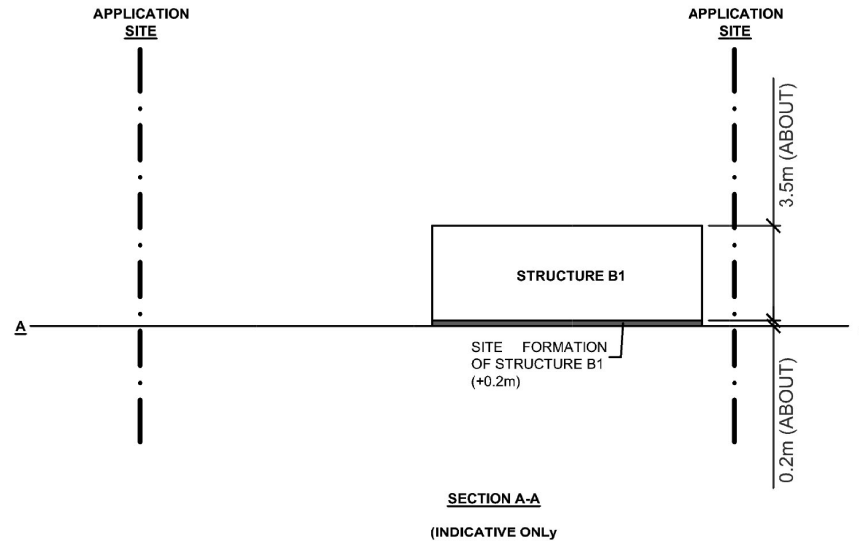
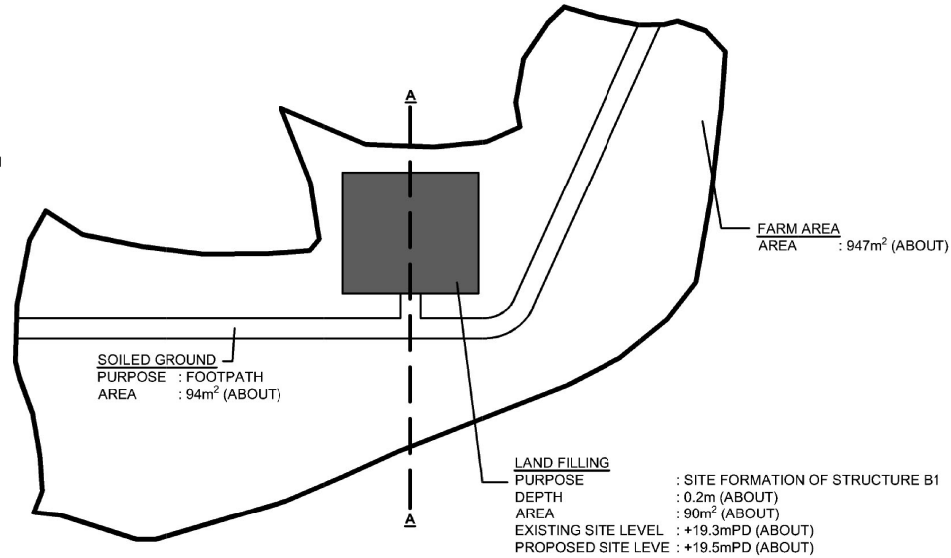

LEGEND

- APPLICATION SITE
- PAVED AREA

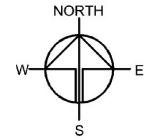

PLAN 2

Drawing No. P05	Ver. 01
Project PROPOSED TEMPORARY PLACE OF RECREATION, SPORTS OR CULTURE (HOBBY FARM) FOR A PERIOD OF 5 YEARS AND LAND FILLING	
LOT 1644 S.C IN D.D. 112	
Drawing Title PAVED RATIO OF THE SITE	
Scale of A4 INDICATIVE ONLY	
Drawn	Date 9.6.2020
Revised	Date 10.8.2020

(資料來源:申請人於 17.8.2020 呈交的資料)
 (Source : Applicant's Submission of 17.8.2020)

參考編號
 REFERENCE No.
 A/YL-SK/283

繪圖 DRAWING
 A-2

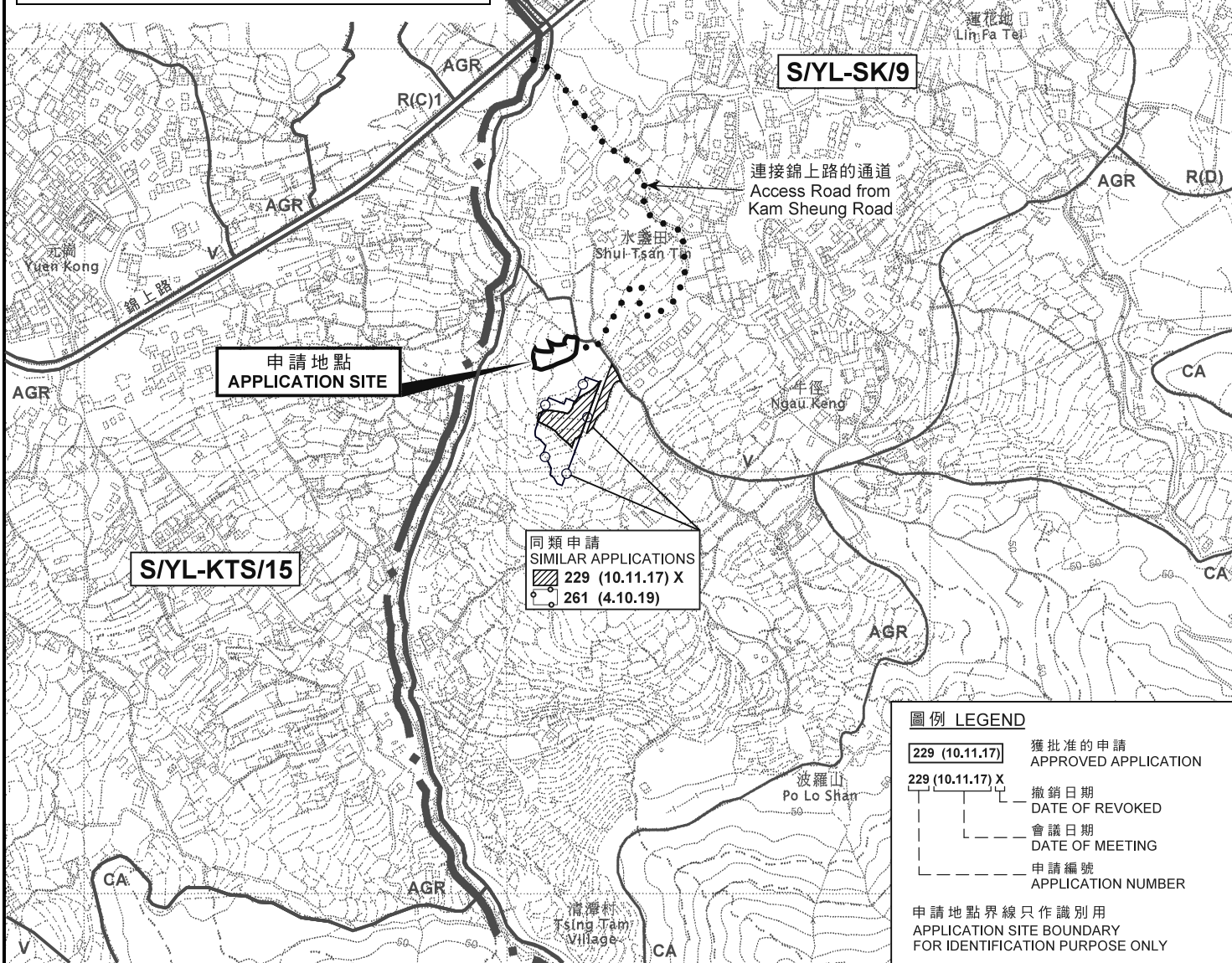
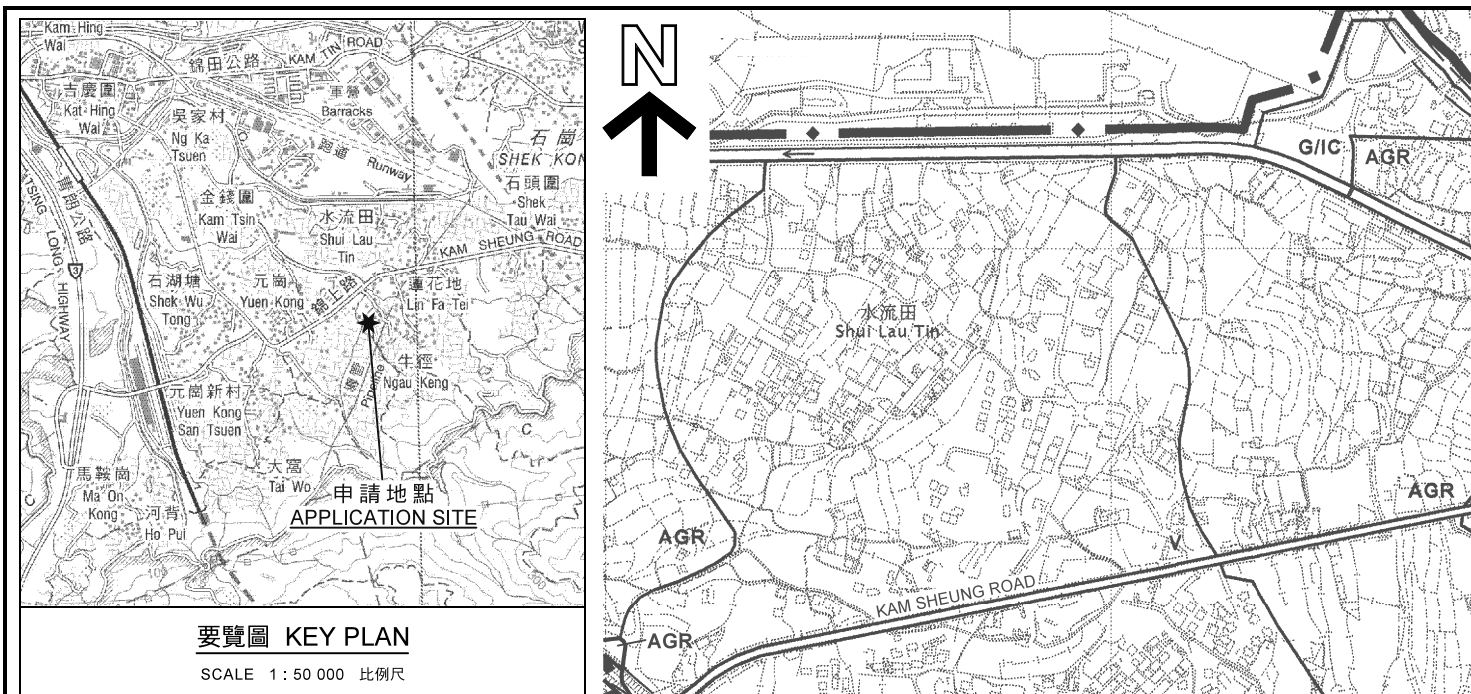

本摘要圖於2020年7月14日擬備，
所根據的資料為於2006年10月17日
核准的分區計劃大綱圖編號 S/YL-SK/9
EXTRACT PLAN PREPARED ON 14.7.2020
BASED ON OUTLINE ZONING PLAN No.
S/YL-SK/9 APPROVED ON 17.10.2006

擬議臨時康體文娛場所（休閒農場）（為期5年）及填土工程
元朗石崗水盞田丈量約份第112約地段第1644號C分段
PROPOSED TEMPORARY PLACE OF RECREATION, SPORTS OR
CULTURE (HOBBY FARM) FOR A PERIOD OF 5 YEARS AND FILLING OF LAND
LOT 1644 S.C IN D.D. 112, SHUI TSAN TIN, SHEK KONG, YUEN LONG

SCALE 1 : 7 500 比例尺
米 100 0 100 200 300 米
METRES

規劃署
PLANNING
DEPARTMENT



參考編號
REFERENCE No.
A/YL-SK/283

圖 PLAN
A-1

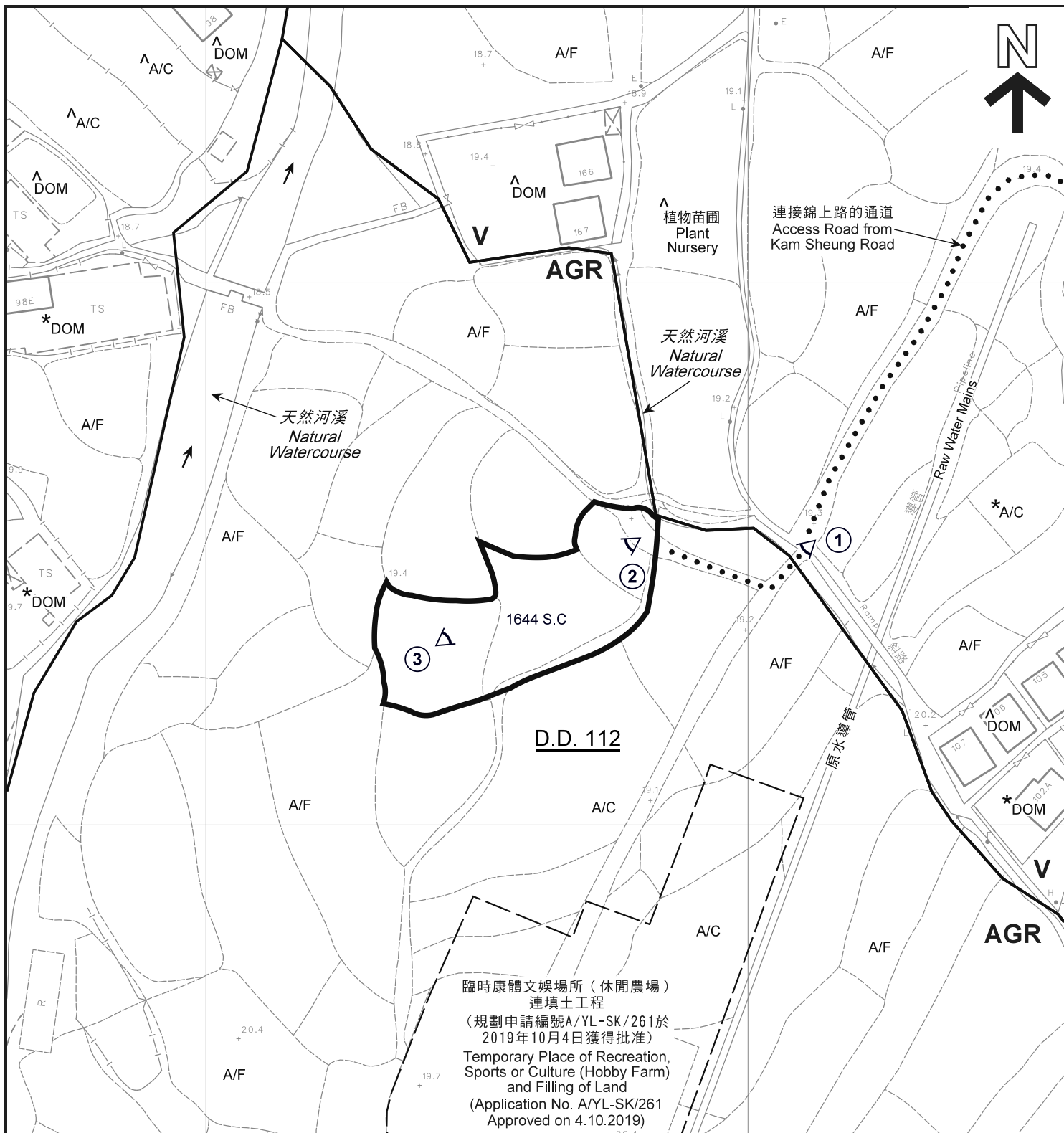

臨時康體文娛場所（休閒農場）
 連填土工程
 （規劃申請編號A/YL-SK/261於
 2019年10月4日獲得批准）
 Temporary Place of Recreation,
 Sports or Culture (Hobby Farm)
 and Filling of Land
 (Application No. A/YL-SK/261
 Approved on 4.10.2019)

圖例 LEGEND

- 申請地點(界線只作識別用)
APPLICATION SITE
(BOUNDARY FOR IDENTIFICATION
PURPOSE ONLY)
- V** 鄉村式發展
VILLAGE TYPE DEVELOPMENT
- AGR** 農業
AGRICULTURE

- DOM** 住用構築物
DOMICILIAR STRUCTURE
- A/F** 休耕農地
FALLOW AGRICULTURAL LAND
- A/C** 常耕農地
CULTIVATED AGRICULTURAL LAND
- 實地照片的觀景點
VIEWING POINT OF SITE PHOTO

註釋 Notes :

- (1) 2020年7月7日勘測的土地用途
Land uses shown on this plan are in accordance with the land use survey conducted by the Planning Department on 7.7.2020
- (2) * 土地用途跟1991年12月勘測的土地用途一致
Indicates that the use is the same as that revealed by the land use survey conducted by the Planning Department in Dec 1991
- (3) ^ 土地用途跟1991年12月勘測的土地用途有別
Indicates that the use is different from that revealed by the land use survey conducted by the Planning Department in Dec 1991

平面圖 SITE PLAN

本摘要圖於2020年8月17日擬備，
 所根據的資料為測量圖編號6-NE-18D
 EXTRACT PLAN PREPARED ON 17.8.2020
 BASED ON SURVEY SHEET No. 6-NE-18D

擬議臨時康體文娛場所（休閒農場）（為期5年）及填土工程
 元朗石崗水蓋田丈量約份第112約地段第1644號C分段
 PROPOSED TEMPORARY PLACE OF RECREATION, SPORTS OR
 CULTURE (HOBBY FARM) FOR A PERIOD OF 5 YEARS AND FILLING OF LAND
 LOT 1644 S.C IN D.D. 112, SHUI TSAN TIN, SHEK KONG, YUEN LONG

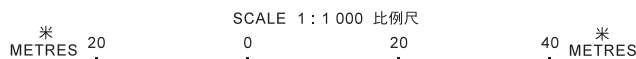

規劃署
PLANNING
DEPARTMENT



參考編號
 REFERENCE No.
A/YL-SK/283

圖 PLAN
A-2

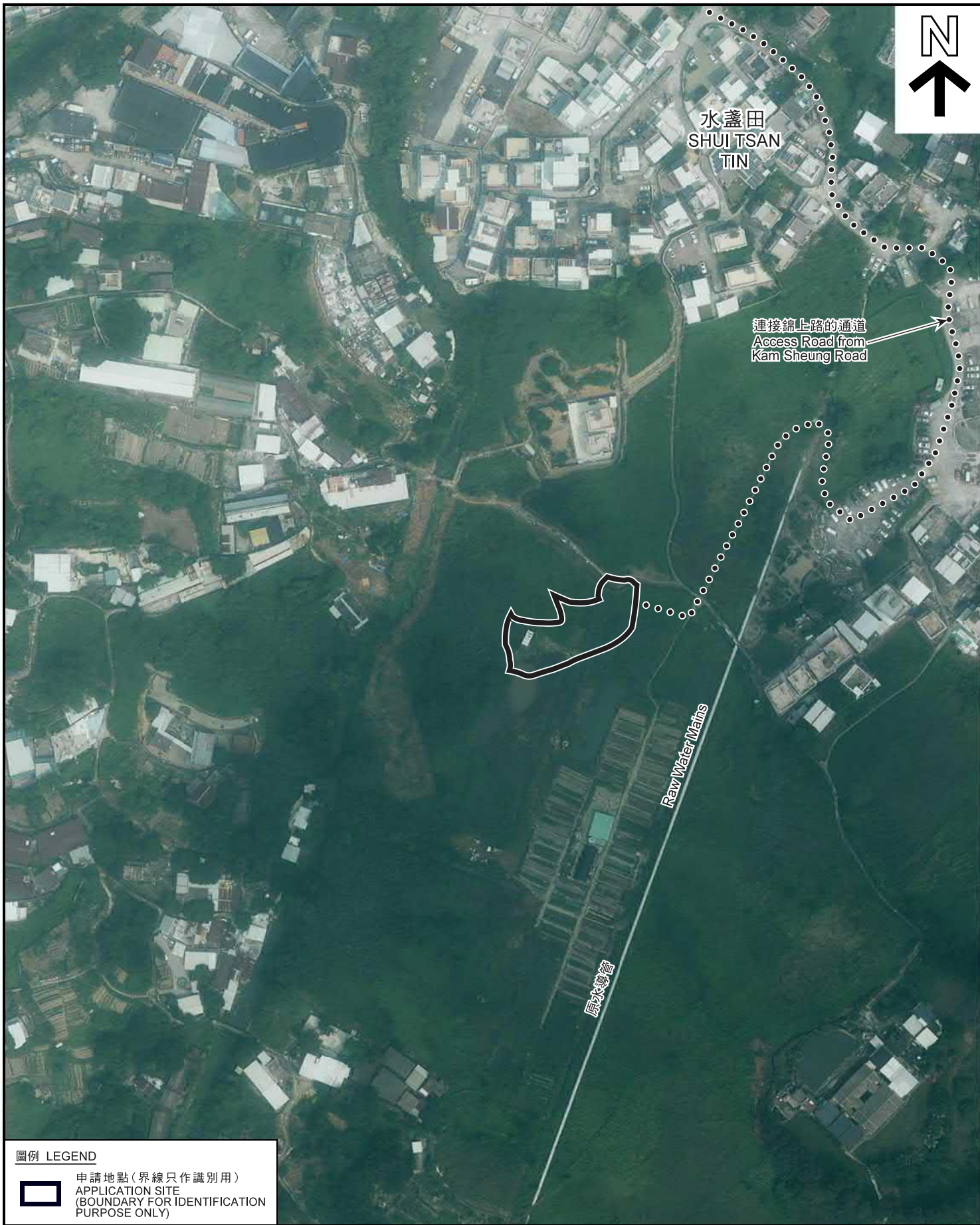

圖例 LEGEND



申請地點 (界線只作識別用)
APPLICATION SITE
(BOUNDARY FOR IDENTIFICATION
PURPOSE ONLY)

航攝照片 AERIAL PHOTO

本摘要圖於2020年7月13日擬備，所根據的資料為地政總署於2019年9月29日拍得的航攝照片編號 E066699C
EXTRACT PLAN PREPARED ON 13.7.2020
BASED ON AERIAL PHOTO No.
E066699C TAKEN ON 29.9.2019
BY LANDS DEPARTMENT

擬議臨時康體文娛場所 (休閒農場) (為期5年) 及填土工程
元朗石崗水盞田丈量約份第112約地段第1644號C分段
PROPOSED TEMPORARY PLACE OF RECREATION, SPORTS OR
CULTURE (HOBBY FARM) FOR A PERIOD OF 5 YEARS AND FILLING OF LAND
LOT 1644 S.C IN D.D. 112, SHUI TSAN TIN, SHEK KONG, YUEN LONG

規劃署
PLANNING
DEPARTMENT



參考編號
REFERENCE No.
AYL-SK/283

圖 PLAN
A-3



申請地點界線只作識別用
APPLICATION SITE BOUNDARY FOR IDENTIFICATION PURPOSE ONLY

實地照片 SITE PHOTO

本摘要圖於2020年8月5日擬備，
所根據的資料為攝於
2020年7月7日的實地照片
PLAN PREPARED ON 5.8.2020
BASED ON SITE PHOTOS
TAKEN ON 7.7.2020

擬議臨時康體文娛場所（休閒農場）（為期5年）及填土工程
元朗石崗水盞田丈量約份第112約地段第1644號C分段
PROPOSED TEMPORARY PLACE OF RECREATION, SPORTS OR
CULTURE (HOBBY FARM) FOR A PERIOD OF 5 YEARS AND FILLING OF LAND
LOT 1644 S.C IN D.D. 112, SHUI TSAN TIN, SHEK KONG, YUEN LONG

規劃署
PLANNING
DEPARTMENT



參考編號
REFERENCE No.
A/YL-SK/283

圖 PLAN
A-4