

A/SK-HC/293

地段索引圖 LOT INDEX PLAN

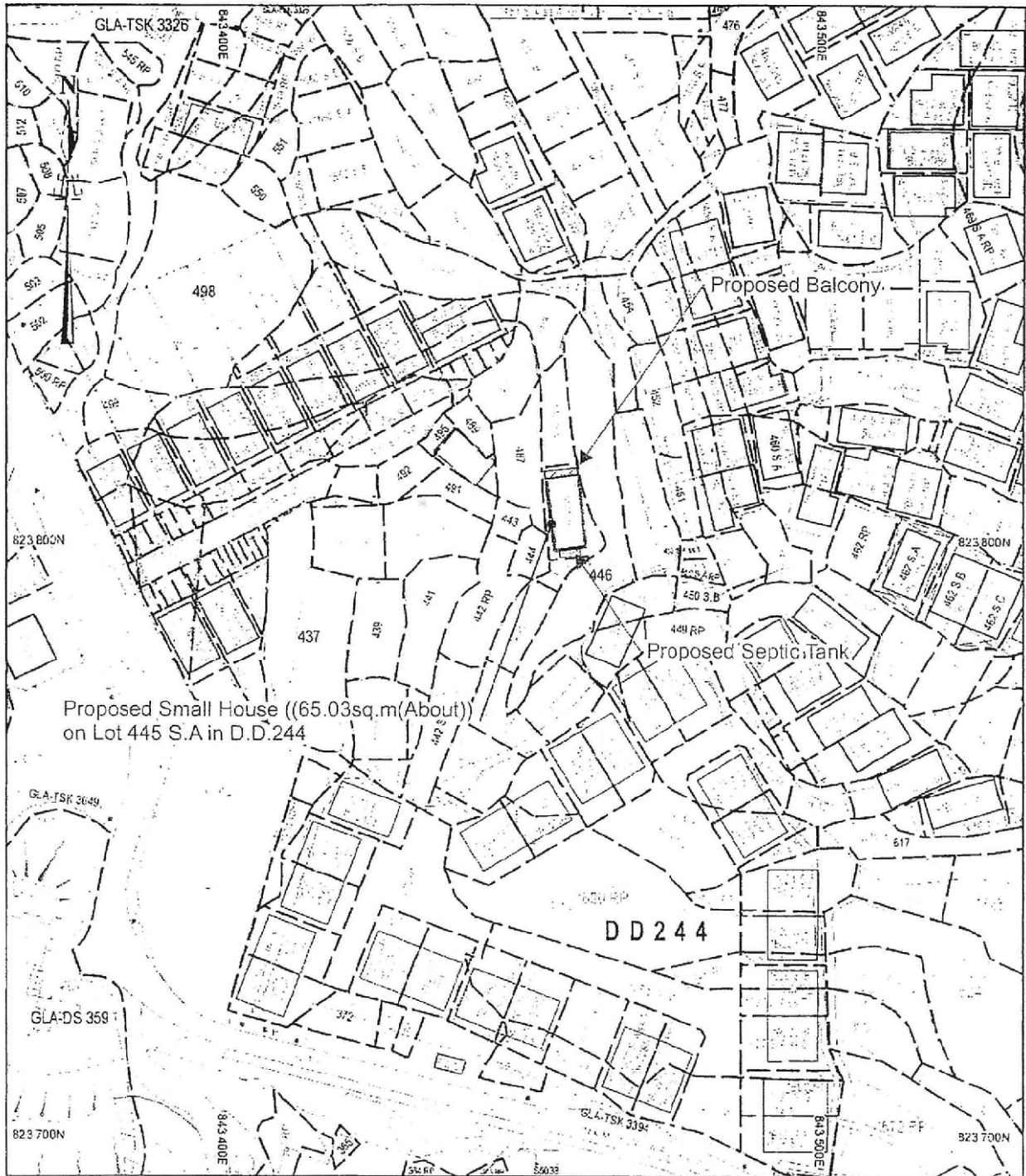

地政總署測繪處 Survey and Mapping Office, Lands Department

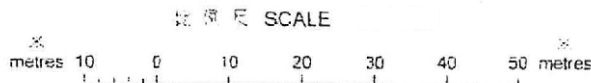

Locality :
 Lot Index Plan No. : SK0145032018
 District Survey Office : Sai Kung
 Date : 21-Mar-2018
 Reference No. : 11-NE-4B,11-NE-5A

香港特別行政區政府 一 版權所有

免責聲明

本圖則為地段索引圖的副本，顯示地盤界線的大概位置，包括被撥作政府地、臨時政府地、短期租約及政府土地租用牌照而臨時佔用上地的位置。臨時佔用上地的非臨時用途可能會被終止，因此所有有關的分區地政專員核實。本圖所顯示的資料必須與地政專員核實。如有任何更改或新的地盤資料時，地段索引圖可能會被修訂而無須另行通知。

Disclaimer

This plan is a copy of the lot index plan showing the approximate location of lot boundaries, including the temporary occupation of land under Government Land Allocations, Temporary Government Land Allocations, Short Term Tenancies and Government Land Licences. The temporary occupation of land may be created or terminated at short notice and should be confirmed with the District Lands Officer.

(資料來源：由申請人提供的平面圖)
 (Source : Site Plan supplied by the Applicant)

參考編號
 REFERENCE No.
 A/SK-HC/293

繪圖
 DRAWING
 A-1a

地段索引圖 LOT INDEX PLAN

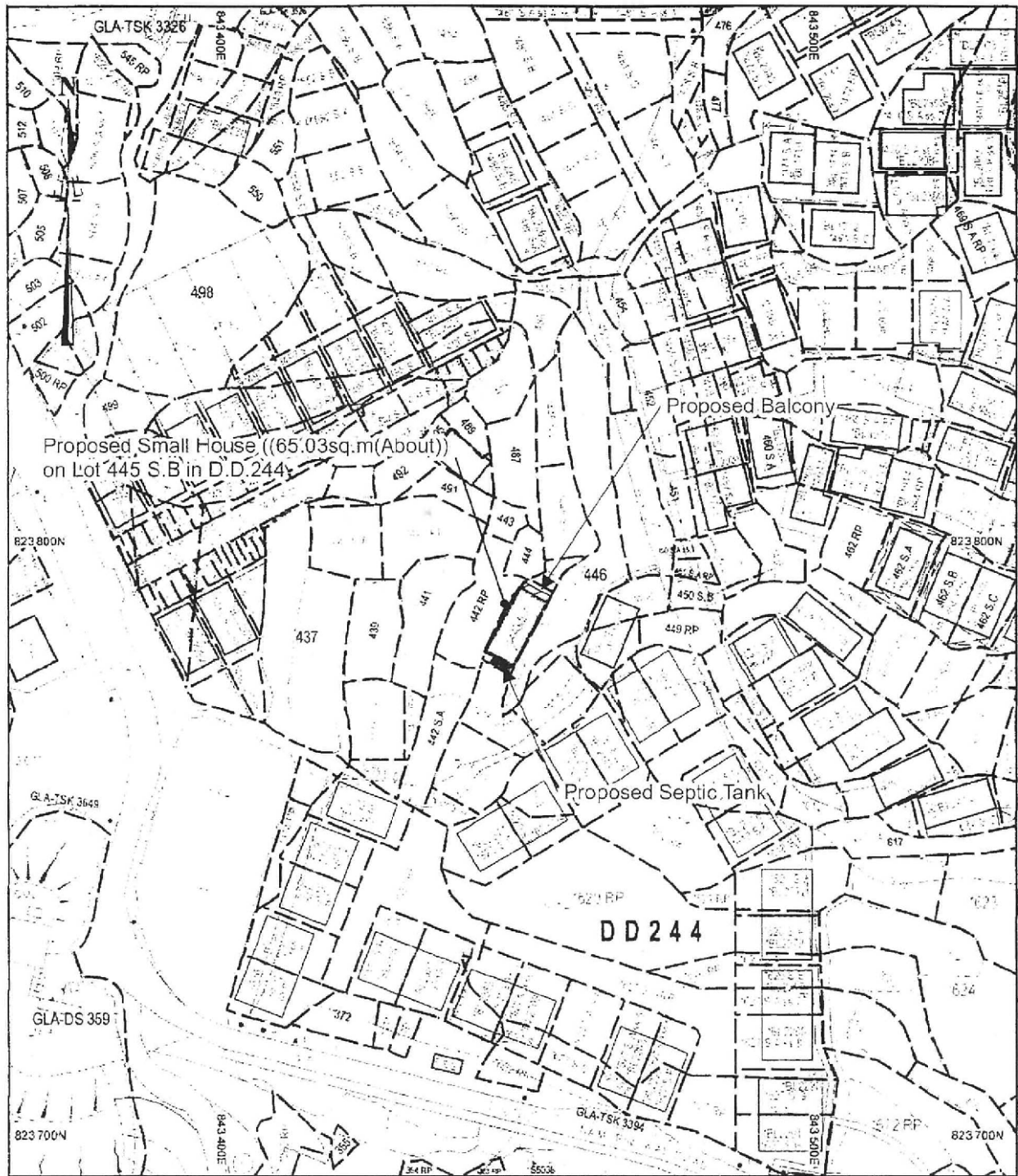

地政總署測繪處 Survey and Mapping Office, Lands Department

比例尺 SCALE

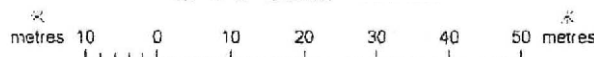

Locality :
 Lot Index Plan No. : SK0145032018
 District Survey Office : Sai Kung
 Date : 21-Mar-2018
 Reference No. : 11-NE-4B,11-NE-5A

香港特別行政區政府 一 版權所有

© Copyright reserved. Hong Kong SAR Government

免責聲明

本圖則乃地段索引圖的複本，顯示地段界線的大概位置，包括根據政府撥地、臨時政府撥地、短期租約及政府土地租約牌照而臨時佔用土地的地區。臨時佔用土地的情況可隨時通知出現或終止，因此應向有關分區地政專員核證。本圖則所示的資料必須與最新測繪圖予以核對，倘有更佳或新的地界證據時，地段索引圖可能會被修訂而無須再先通知。

Disclaimer

This plan is a copy of the lot index plan showing the approximate location of lot boundaries, including the temporary occupation of land under Government Land Allocations, Temporary Government Land Allocations, Short Term Tenancies and Government Land Licences. The temporary occupation of land may be created or terminated at short notice and should be confirmed with the District Lands Officer. The information shown on this plan may be updated by field survey. The lot index

(資料來源：由申請人提供的平面圖)
 (Source : Site Plan supplied by the Applicant)

參考編號
 REFERENCE No.
 A/SK-HC/294

繪圖
 DRAWING
 A-1b

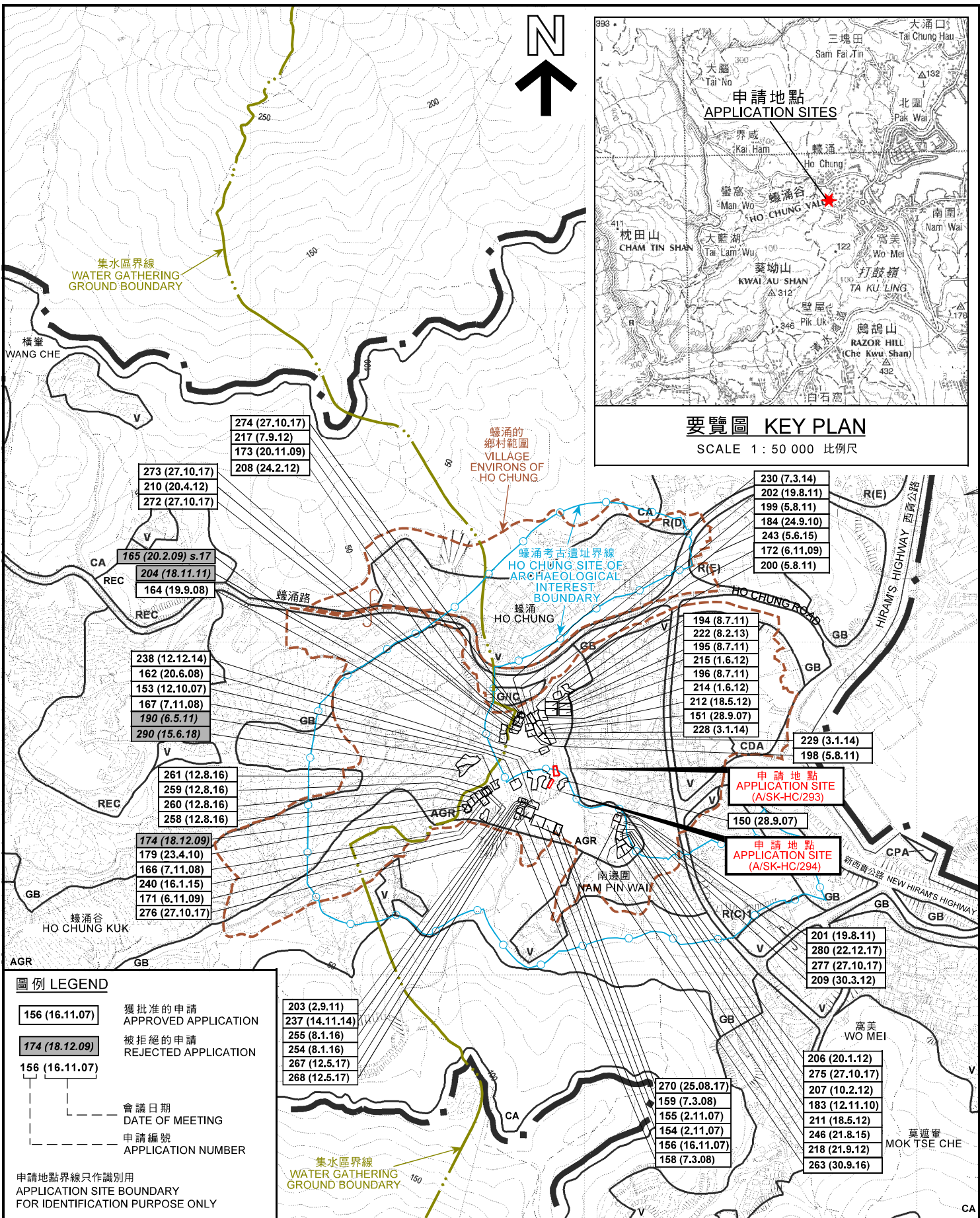

位置圖 LOCATION PLAN

擬議屋宇 (新界豁免管制屋宇 - 小型屋宇)
PROPOSED HOUSES
(NEW TERRITORIES EXEMPTED HOUSES - SMALL HOUSES)
LOTS 445 S.A AND 445 S.B IN D.D. 244,
HO CHUNG, SAI KUNG

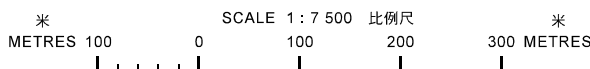

規劃署
PLANNING
DEPARTMENT



參考編號
REFERENCE No.
A/SK-HC/293&294

圖 PLAN
A-1

本摘要圖於2018年6月20日擬備，
所根據的資料為
於2014年3月11日核准的分區計劃大綱圖
編號S/SK-HC/11
EXTRACT PLAN PREPARED ON 20.6.2018
BASED ON OUTLINE ZONING PLAN No.
S/SK-HC/11 APPROVED ON 11.3.2014

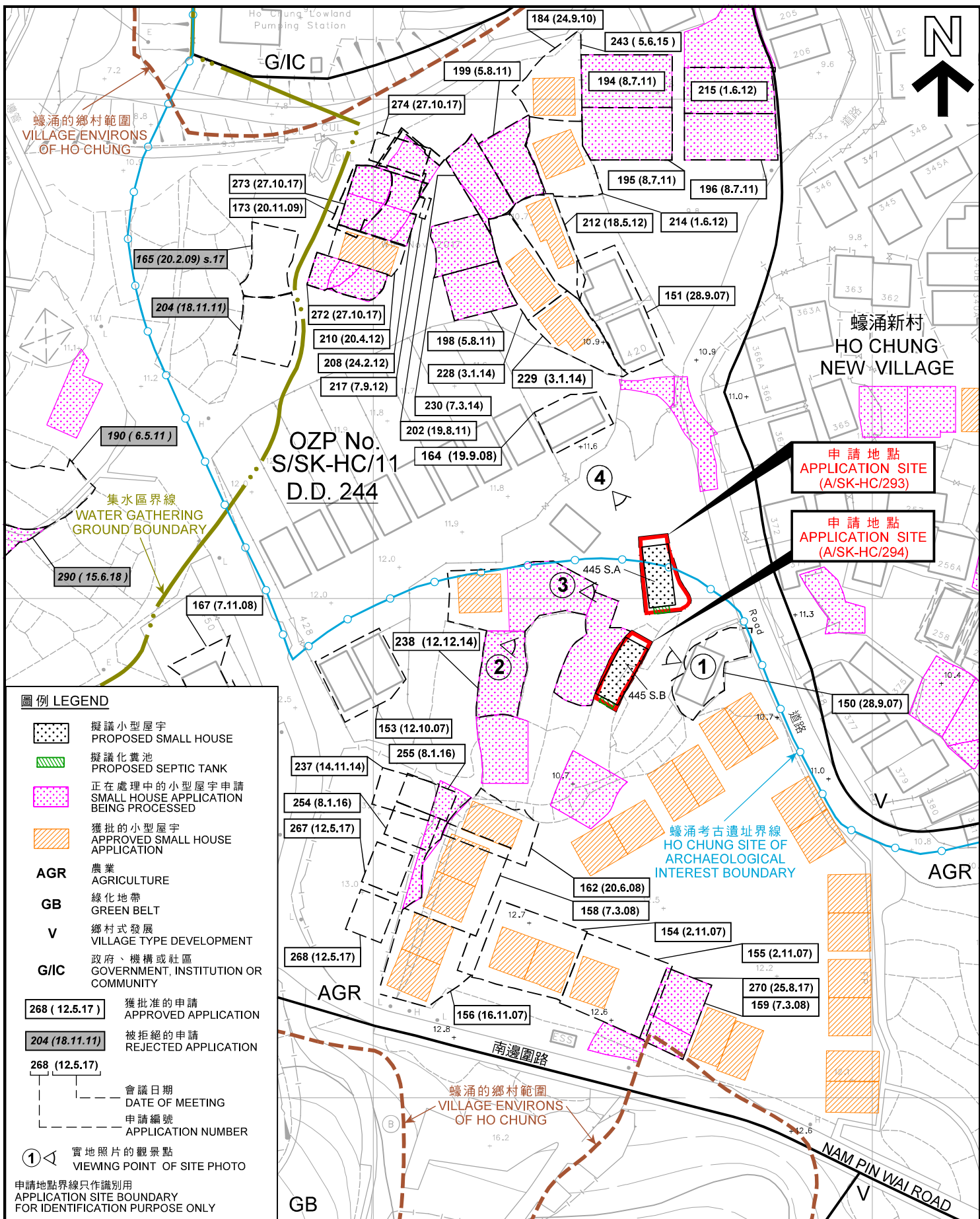

圖例 LEGEND

- 擬議小型屋宇
PROPOSED SMALL HOUSE
 - 擬議化糞池
PROPOSED SEPTIC TANK
 - 正在處理中的小型屋宇申請
SMALL HOUSE APPLICATION BEING PROCESSED
 - 獲批的小型屋宇
APPROVED SMALL HOUSE APPLICATION
 - AGR** 農業
AGRICULTURE
 - GB** 綠化地帶
GREEN BELT
 - V** 鄉村式發展
VILLAGE TYPE DEVELOPMENT
 - G/IC** 政府、機構或社區
GOVERNMENT, INSTITUTION OR COMMUNITY
 - 獲批准的申請
APPROVED APPLICATION
 - 被拒絕的申請
REJECTED APPLICATION
 - 會議日期
DATE OF MEETING
 - 申請編號
APPLICATION NUMBER
 - 實地照片的觀景點
VIEWING POINT OF SITE PHOTO
- 申請地點界線只作識別用
APPLICATION SITE BOUNDARY FOR IDENTIFICATION PURPOSE ONLY

平面圖 SITE PLAN

擬議屋宇 (新界豁免管制屋宇 - 小型屋宇)
 西貢蠔涌丈量約份第 2 4 4 約地段第 4 4 5 號 A 分段及第 4 4 5 號 B 分段
 PROPOSED HOUSES
 (NEW TERRITORIES EXEMPTED HOUSES - SMALL HOUSES)
 LOTS 445 S.A AND 445 S.B IN D.D. 244,
 HO CHUNG, SAI KUNG

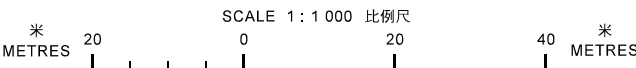

規劃署
PLANNING DEPARTMENT

參考編號
 REFERENCE No. A/SK-HC/293&294

圖 PLAN
 A-2a

本摘要圖於 2018 年 6 月 20 日擬備，
 所根據的資料為測量圖編號
 11-NE-4B 和 5A
 EXTRACT PLAN PREPARED ON 20.6.2018
 BASED ON SURVEY SHEETS No.
 11-NE-4B & 5A

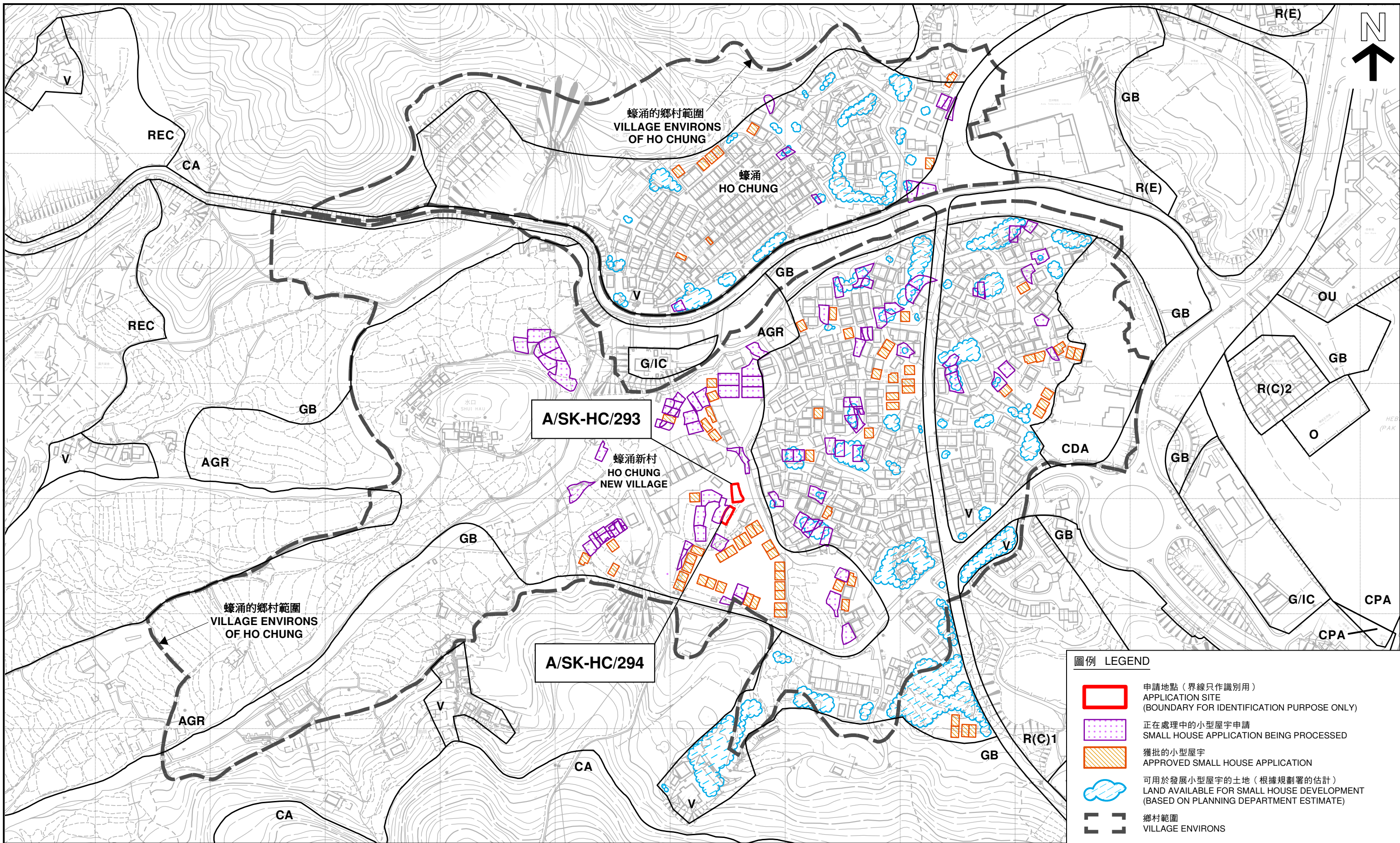

圖例 LEGEND

-  申請地點 (界線只作識別用)
APPLICATION SITE
(BOUNDARY FOR IDENTIFICATION PURPOSE ONLY)
-  正在處理中的小型屋宇申請
SMALL HOUSE APPLICATION BEING PROCESSED
-  獲批的小型屋宇
APPROVED SMALL HOUSE APPLICATION
-  可用於發展小型屋宇的土地 (根據規劃署的估計)
LAND AVAILABLE FOR SMALL HOUSE DEVELOPMENT
(BASED ON PLANNING DEPARTMENT ESTIMATE)
-  鄉村範圍
VILLAGE ENVIRONS

本摘要圖於2018年6月20日擬備，所根據的資料為測量圖編號 7-SE-24D、25C、11-NE-4B和5A
EXTRACT PLAN PREPARED ON 20.6.2018
BASED ON SURVEY SHEETS No. 7-SE-24D, 25C, 11-NE-4B & 5A

平面圖 SITE PLAN

擬議屋宇 (新界豁免管制屋宇 - 小型屋宇)
PROPOSED HOUSES
(NEW TERRITORIES EXEMPTED HOUSES - SMALL HOUSES)
西貢蠔涌丈量約份第244約地段第445號A分段及第445號B分段
LOTS 445 S.A AND 445 S.B IN D.D. 244,
HO CHUNG, SAI KUNG

SCALE 1:3 000 比例尺

米 METRES 100 0 100 200 300

**規劃署
PLANNING DEPARTMENT**



參考編號 REFERENCE No. **A/SK-HC/293&294**

圖 PLAN **A-2b**



申請地點界線只作識別用
APPLICATION SITE BOUNDARY
FOR IDENTIFICATION PURPOSE ONLY

本摘要圖於2018年6月20日擬備，
所根據的資料為地政總署
於2017年5月29日拍得的
航攝照片編號E027535C
EXTRACT PLAN PREPARED ON 20.6.2018
BASED ON AERIAL PHOTO No. E027535C
TAKEN ON 29.5.2017
BY LANDS DEPARTMENT

航攝照片 AERIAL PHOTO

擬議屋宇 (新界豁免管制屋宇 - 小型屋宇)
西貢蠔涌丈量約份第244約地段第445號A分段及第445號B分段
PROPOSED HOUSES
(NEW TERRITORIES EXEMPTED HOUSES - SMALL HOUSES)
LOTS 445 S.A AND 445 S.B IN D.D. 244,
HO CHUNG, SAI KUNG

規劃署
PLANNING
DEPARTMENT



參考編號
REFERENCE No.
A/SK-HC/293&294

圖 PLAN
A-3

1

申請地點
APPLICATION SITE
(A/SK-HC/294)

申請地點
APPLICATION SITE
(A/SK-HC/293)

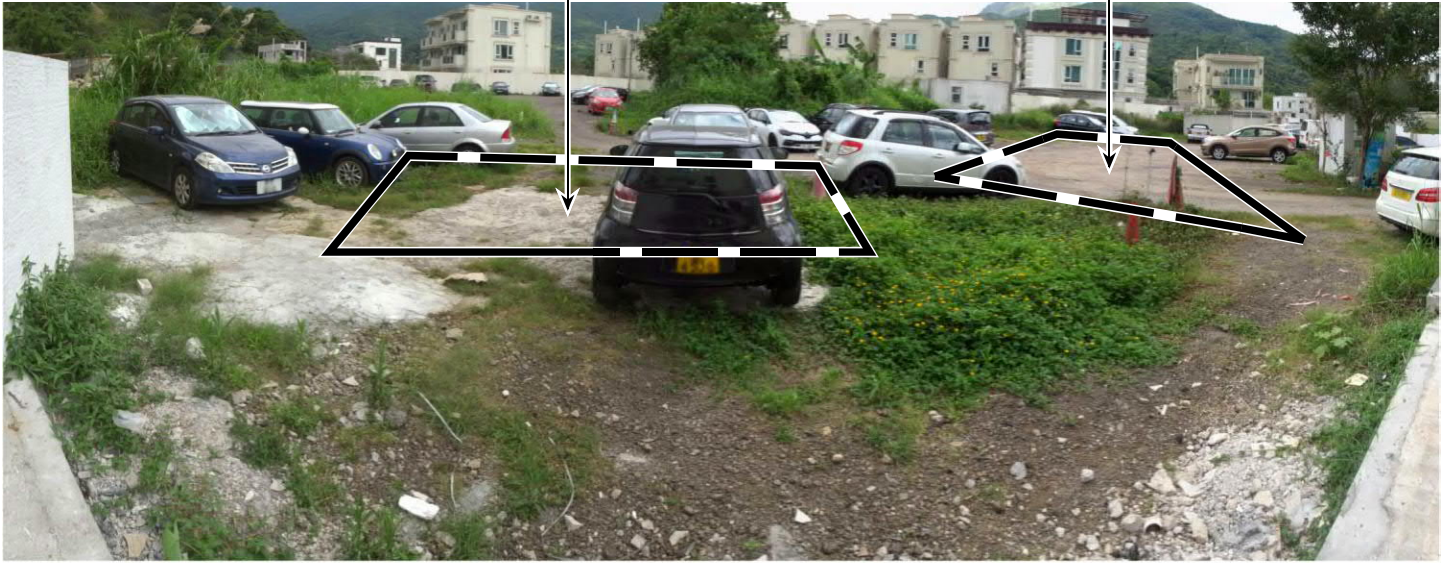

2

申請地點
APPLICATION SITE
(A/SK-HC/293)

申請地點
APPLICATION SITE
(A/SK-HC/294)

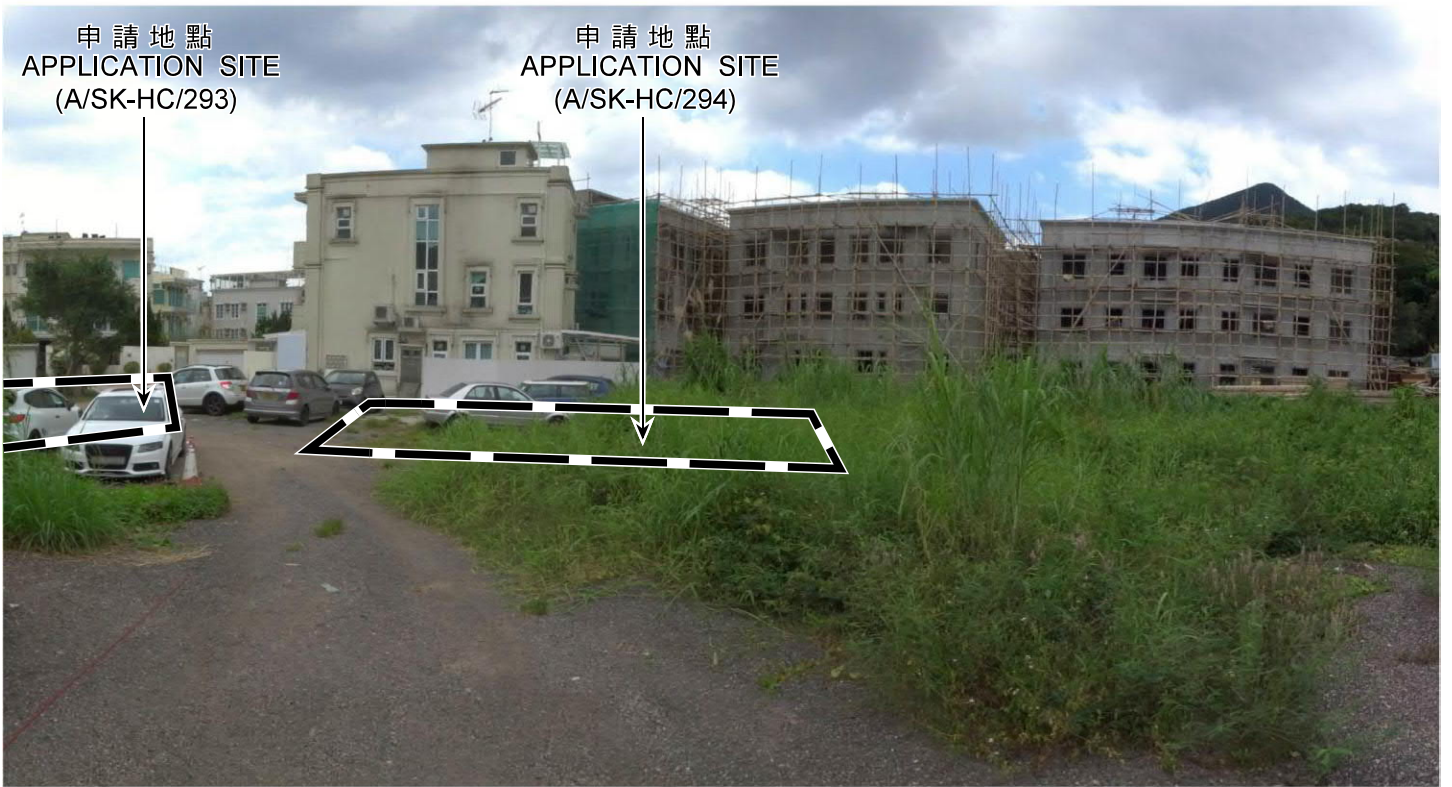

申請地點界線只作識別用
APPLICATION SITE BOUNDARY
FOR IDENTIFICATION PURPOSE ONLY

實地照片 SITE PHOTO

本圖於2018年6月20日擬備，所根據的資料為攝於2018年5月25日的實地照片
PLAN PREPARED ON 20.6.2018 BASED ON SITE PHOTOS TAKEN ON 25.5.2018

擬議屋宇 (新界豁免管制屋宇 - 小型屋宇)
西貢蠔涌丈量約份第244約地段第445號A分段及第445號B分段
PROPOSED HOUSES
(NEW TERRITORIES EXEMPTED HOUSES - SMALL HOUSES)
LOTS 445 S.A AND 445 S.B IN D.D. 244,
HO CHUNG, SAI KUNG

規劃署
PLANNING
DEPARTMENT



參考編號
REFERENCE No.
A/SK-HC/293&294

圖 PLAN
A-4a

3

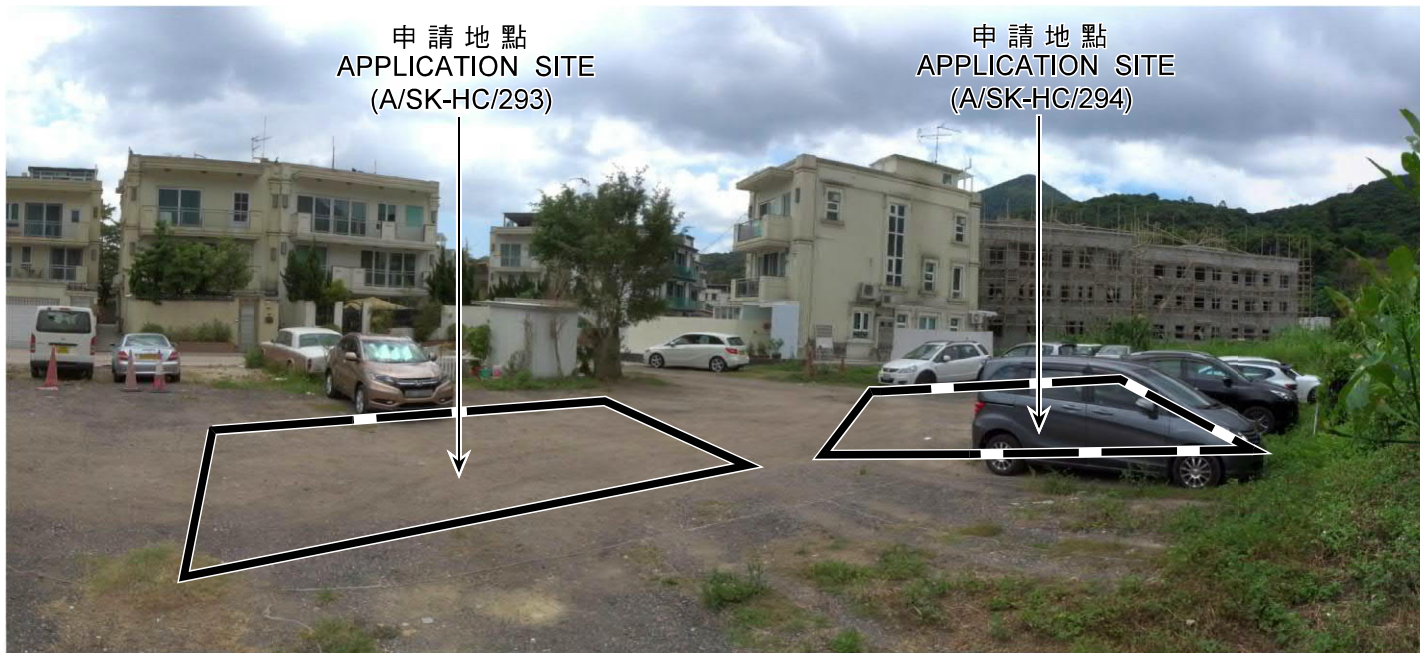

4

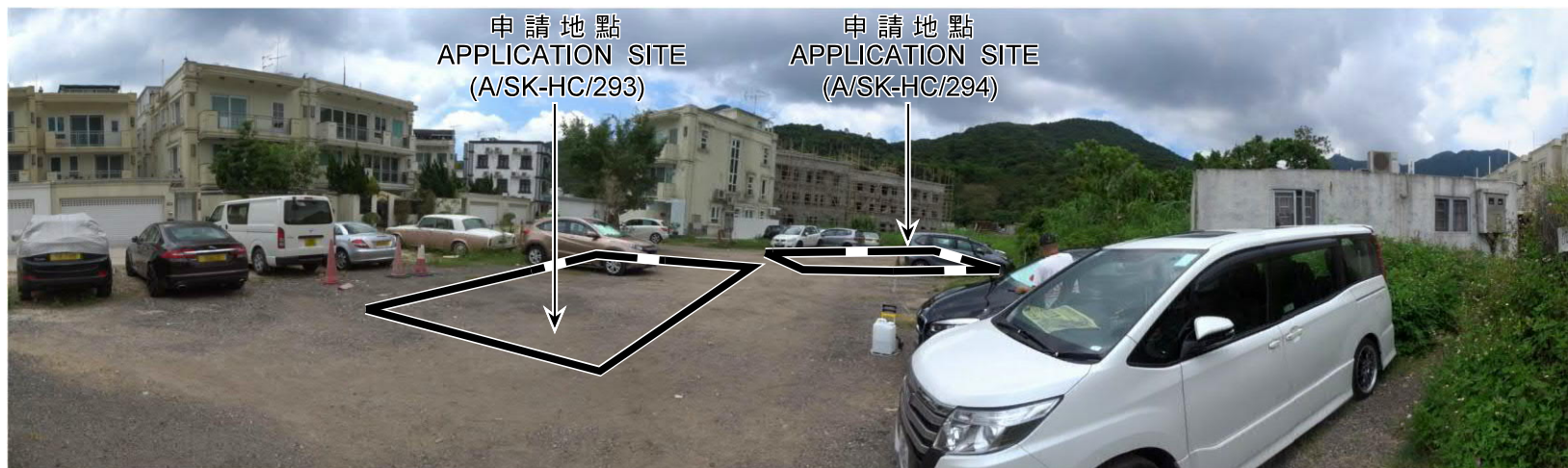

申請地點界線只作識別用
APPLICATION SITE BOUNDARY FOR IDENTIFICATION PURPOSE ONLY

實地照片 SITE PHOTO

擬議屋宇 (新界豁免管制屋宇 - 小型屋宇)
西貢蠔涌丈量約份第 2 4 4 約地段第 4 4 5 號 A 分段及第 4 4 5 號 B 分段
PROPOSED HOUSES
(NEW TERRITORIES EXEMPTED HOUSES - SMALL HOUSES)
LOTS 445 S.A AND 445 S.B IN D.D. 244,
HO CHUNG, SAI KUNG

本圖於 2018 年 6 月 20 日擬備，所根據的資料為攝於 2018 年 5 月 25 日的實地照片
PLAN PREPARED ON 20.6.2018 BASED ON SITE PHOTOS TAKEN ON 25.5.2018

規劃署
PLANNING
DEPARTMENT



參考編號
REFERENCE No.
A/SK-HC/293&294

圖 PLAN
A-4b