



LEGEND	LOCATION	DRAWING NO.	DRAWING TITLE
 PROPOSED BUILDING FOOTPRINT (65.03M ²)	LOT 470 S.B ss.2 in D.D.222, PAK KONG, SAI KUNG, N.T.	FIGURE 5	VEHICULAR ACCESS PLAN
 PROPOSED SITE AREA BOUNDARY		DATE 17 MAR 2017	
 EXISTING VEHICULAR ACCESS			

(資料來源：由申請人提供的行車通道圖)
 (Source : Vehicular Access Plan supplied by the Applicant)

參考編號 REFERENCE No. A/SK-PK/239	繪圖 DRAWING A-1
--------------------------------------	----------------------

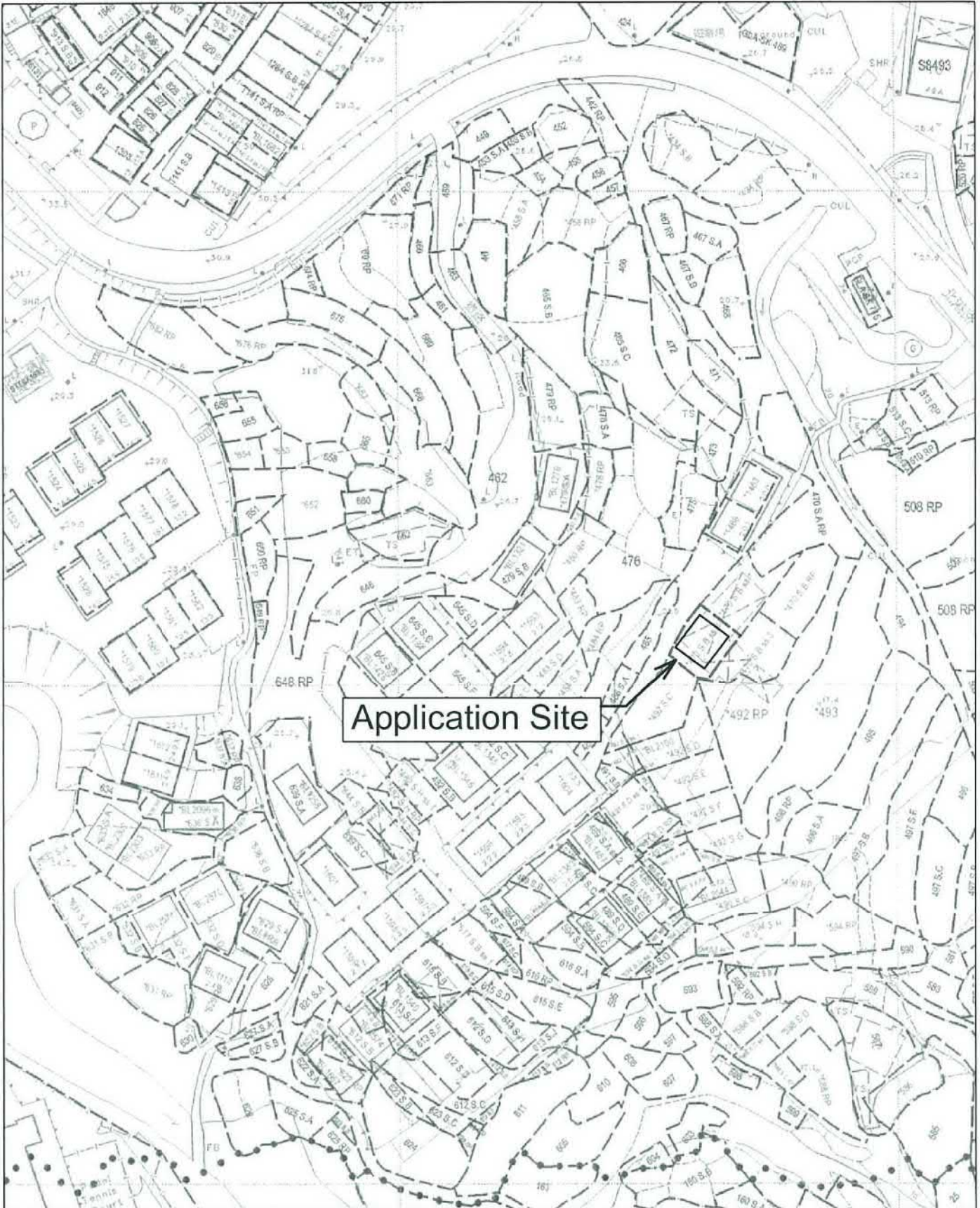

LEGEND	LOCATION	DRAWING NO.	DRAWING TITLE
 PROPOSED BUILDING FOOTPRINT (65.03M ²)	LOT 470 S.B ss.2 in D.D.222, PAK KONG, SAI KUNG, N.T.	FIGURE 1	SITE PLAN
 PROPOSED SITE AREA BOUNDARY		DATE 25 FEB 2017	PREPARED BY  DeSPACE (International) Limited

(資料來源：由申請人提供的平面圖)
 (Source : Site Plan supplied by the Applicant)

參考編號 REFERENCE No. A/SK-PK/239	繪圖 DRAWING A-2
--------------------------------------	----------------------

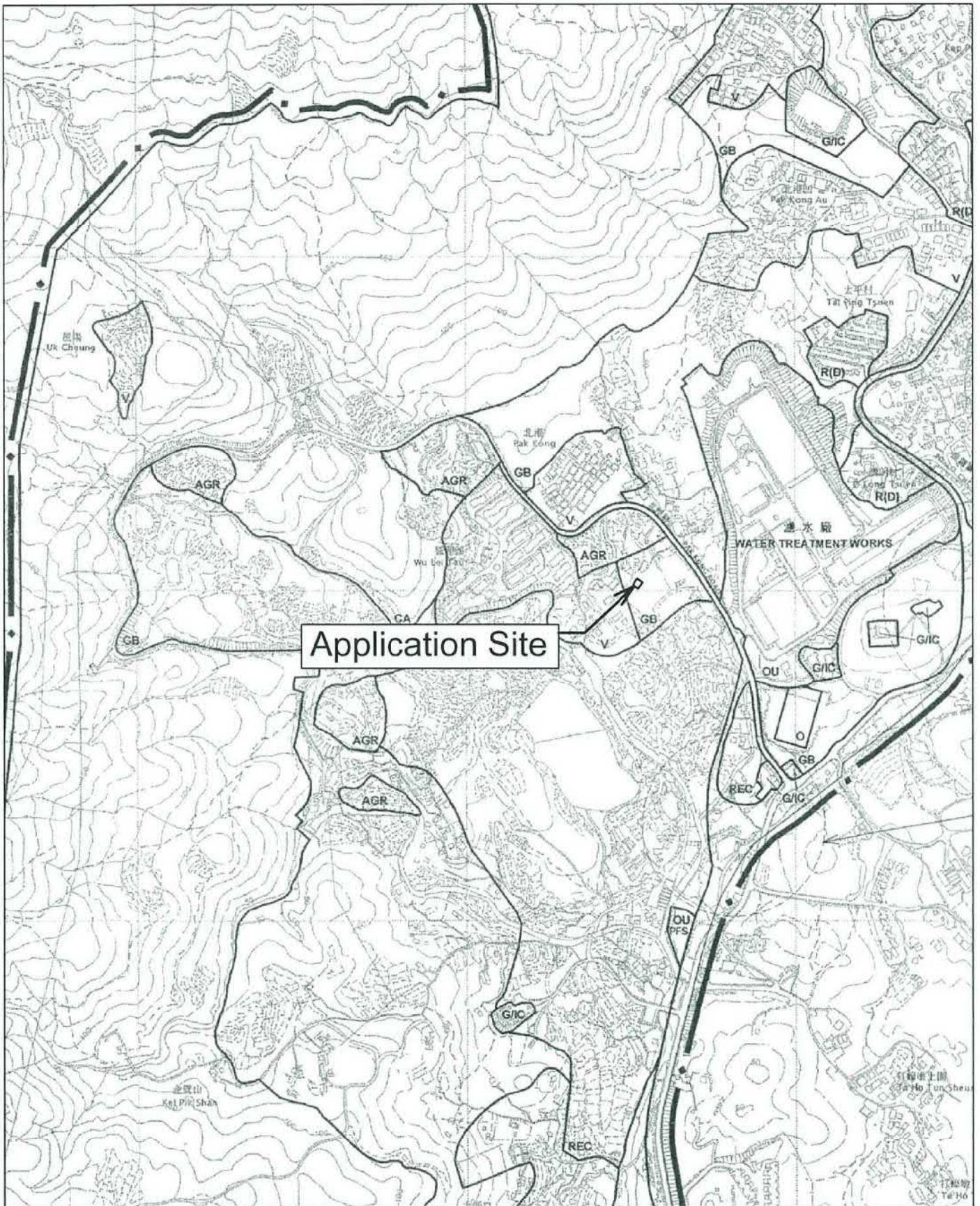

LEGEND	LOCATION	DRAWING NO.	DRAWING TITLE
 <p>PROPOSED SITE AREA BOUNDARY</p>	<p>LOT 470 S.B ss.2 in D.D.222, PAK KONG, SAI KUNG, N.T.</p>	<p>FIGURE 2</p>	<p>LOCATION PLAN</p>
	<p>EXTRACT PLAN PREPARED ON 25.02.2017 BASED ON OUTLINE ZONING PLAN No. S/SK-PK/11 APPROVED ON 27.10.2006</p>	<p>DATE 25 FEB 2017</p>	<p>PREPARED BY  DeSPACE (International) Limited</p>

(資料來源：由申請人提供的位置圖)
(Source : Location Plan supplied by the Applicant)

<p>參考編號 REFERENCE No. A/SK-PK/239</p>	<p>繪圖 DRAWING A-3</p>
---	-------------------------------

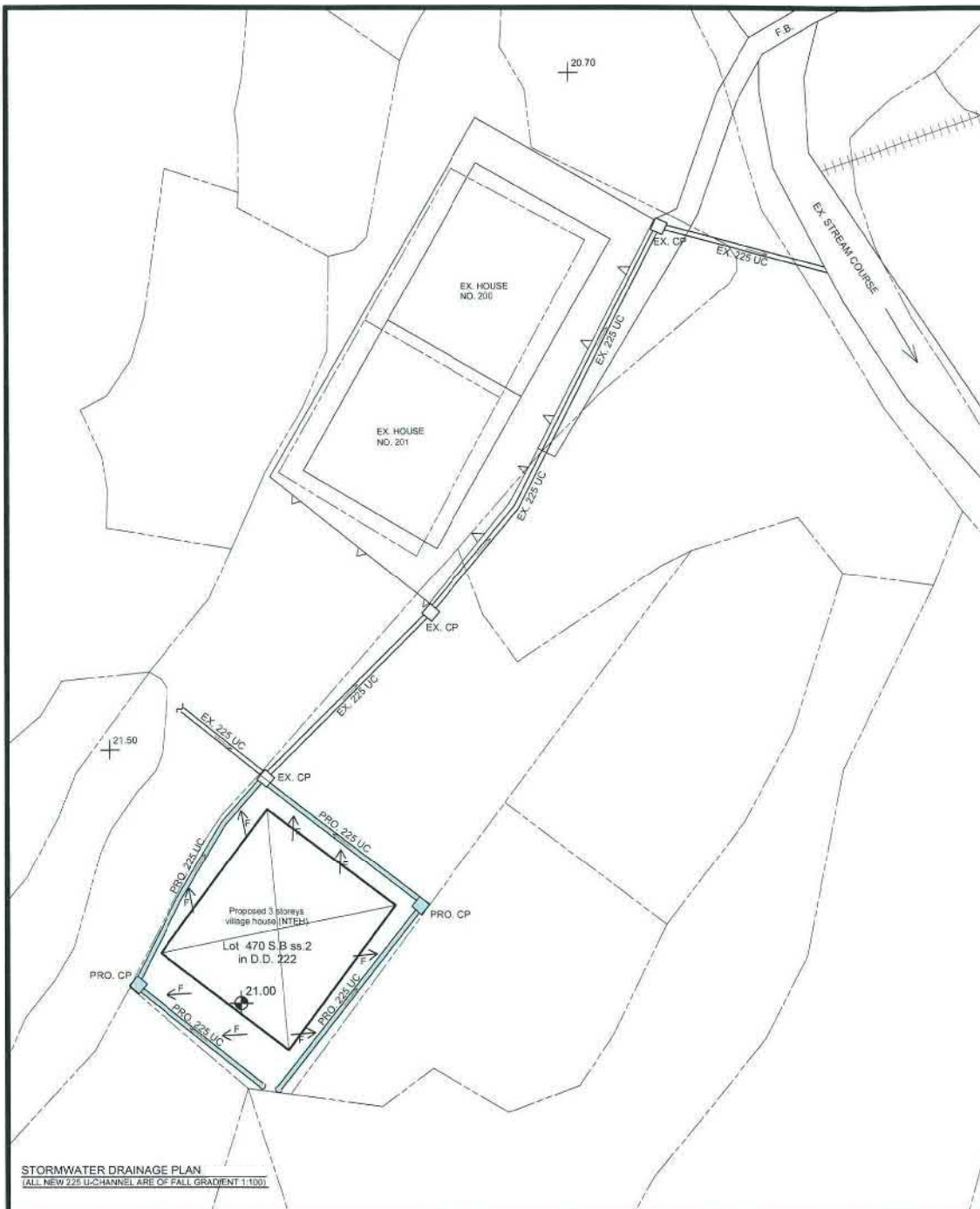

STORMWATER DRAINAGE PLAN
 (ALL NEW 225 U-C-HANNEL ARE OF FALL GRADIENT 1:100)

COLOUR INDICATION

- PROPOSED STORMWATER WORKS
- PROPOSED SEWERAGE PIPELINE
- CONCRETE WORKS
- STEEL WORKS

LEGEND

- FLOW DIRECTION
- SUBJECT LOT BOUNDARY
- SUBJECT BUILDING LINE
- 225mm (360mm U-CHANNEL with CONCRETE COVER
- PROPOSED 150mm (150mm) U-CHANNEL WITH CONCRETE COVER
- EXISTING STORMWATER MANHOLE
- PROPOSED STORMWATER CATCHPI
- PROPOSED SEWERAGE MANHOLE
- EXISTING GOVERNMENT SEWERAGE MANHOLE
- PROPOSED SEWERAGE TERMINAL MANHOLE
- COVER LEVEL
- INVERT LEVEL
- D.T.L. DISCONNECTING TRAP LEVEL



BLOCK PLAN

NOTES FOR DRAINAGE WORKS

1. Concrete mix to be grade 30D/20 design mix and comply with CSI:1990.
2. Blinding layer to be grade 15P mix.
3. Concrete cover to main steel bar to be 50mm.
4. Reinforcement marked "R" denote mild steel bar (fy=250 MPa) and marked "Y" denote high tensile steel bar (fy=460 MPa) in compliance with B.S.4449: 1988 and CS2: 1995.

REVISION	
NO.	DATE
THIS SET OF DRAWING INCLUDES:	
PROJECT	
PROPOSED STORMWATER DRAINAGE WORKS on LOT 470 S.B. ss.2, in D.D. 222, PAK KONG VILLAGE, SAI KUNG, N.T.	
DRAWING TITLE	
BLOCK PLAN, STORMWATER DRAINAGE PLAN, DETAILS AND NOTES.	
DRAWING NO.	SCALE
D-1	AS SHOWN
WINLI 永利建設 CONSULTING ENGINEERS	

(資料來源：由申請人提供的雨水排放設施圖)
 (Source: Stormwater Drainage Plan supplied by the Applicant)

參考編號 REFERENCE No. A/SK-PK/239	繪圖 A-4
---	------------------

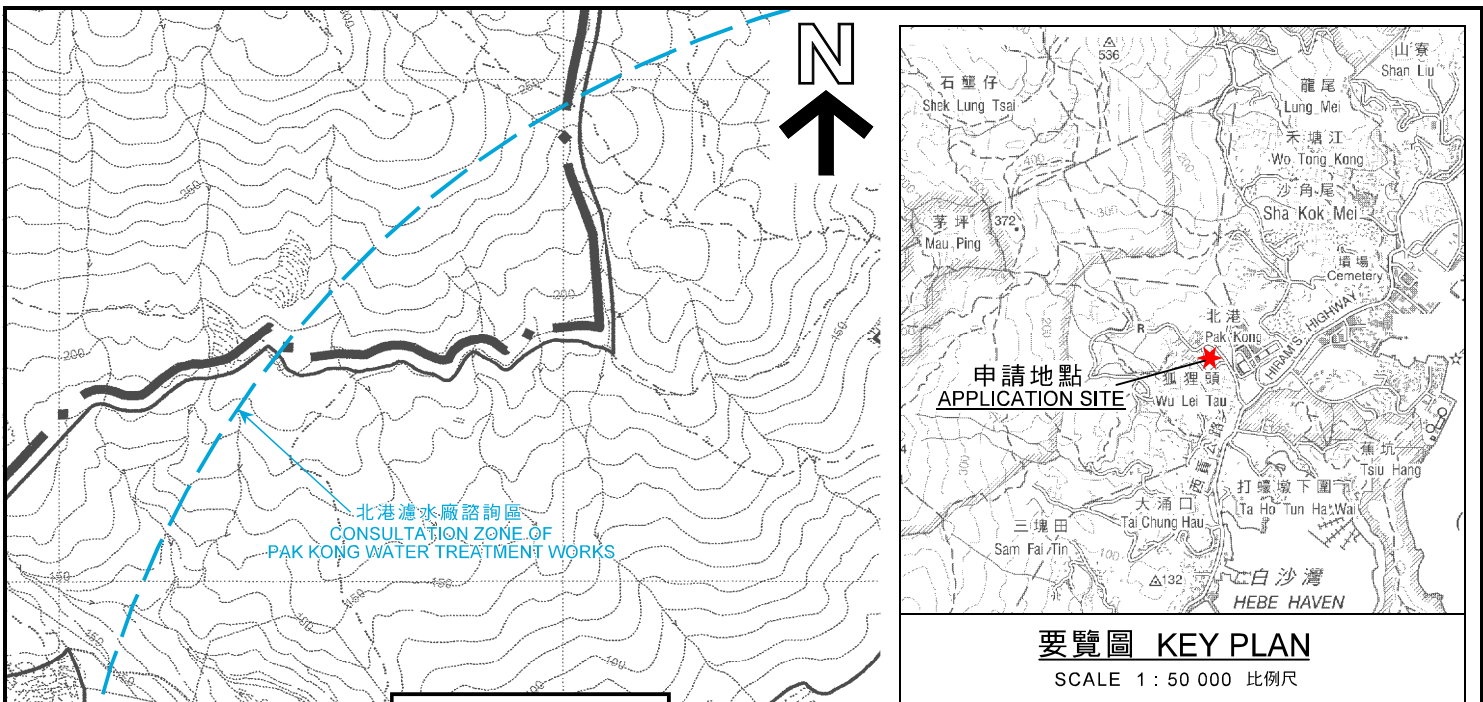

要覽圖 KEY PLAN
SCALE 1 : 50 000 比例尺

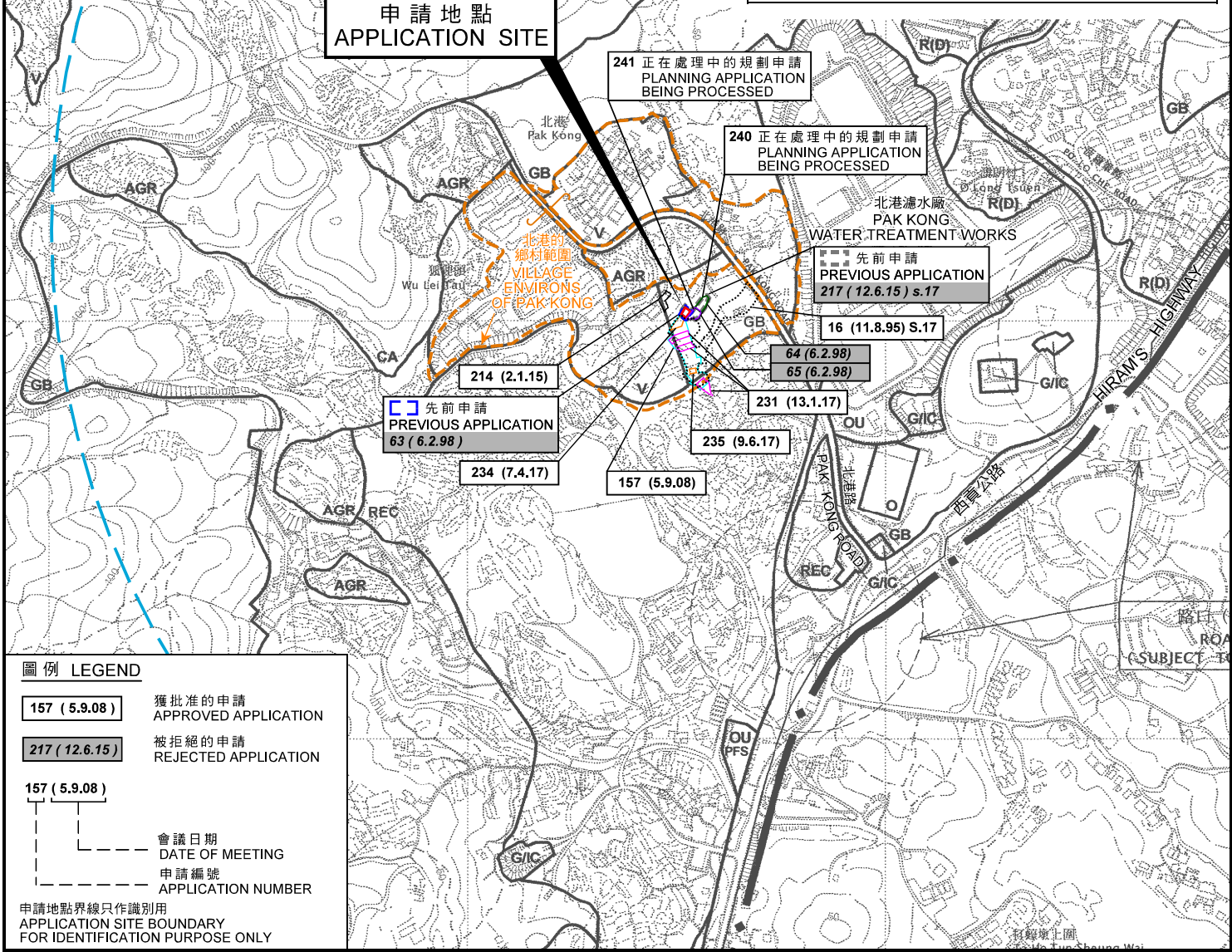

圖例 LEGEND

157 (5.9.08) 獲批准的申請
APPROVED APPLICATION

217 (12.6.15) 被拒絕的申請
REJECTED APPLICATION

157 (5.9.08) 會議日期
DATE OF MEETING

申請編號
APPLICATION NUMBER

申請地點界線只作識別用
APPLICATION SITE BOUNDARY
FOR IDENTIFICATION PURPOSE ONLY

位置圖 LOCATION PLAN

擬議屋宇 (新界豁免管制屋宇 - 小型屋宇)
西貢北港丈量約份第 2 2 2 約地段第 4 7 0 號 B 分段第 2 小分段
PROPOSED HOUSE
(NEW TERRITORIES EXEMPTED HOUSE - SMALL HOUSE)
LOT 470 S.B ss.2 IN D.D. 222,
PAK KONG, SAI KUNG

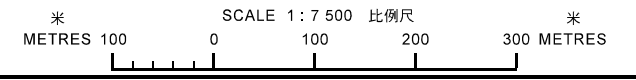

規劃署
PLANNING DEPARTMENT



參考編號
REFERENCE No.
A/SK-PK/239

圖 PLAN
A-1

本摘要圖於 2017 年 12 月 29 日擬備，
所根據的資料為
於 2006 年 10 月 17 日核准的分區計劃大綱圖
編號 S/SK-PK/11
EXTRACT PLAN PREPARED ON 29.12.2017
BASED ON OUTLINE ZONING PLAN No.
S/SK-PK/11 APPROVED ON 17.10.2006

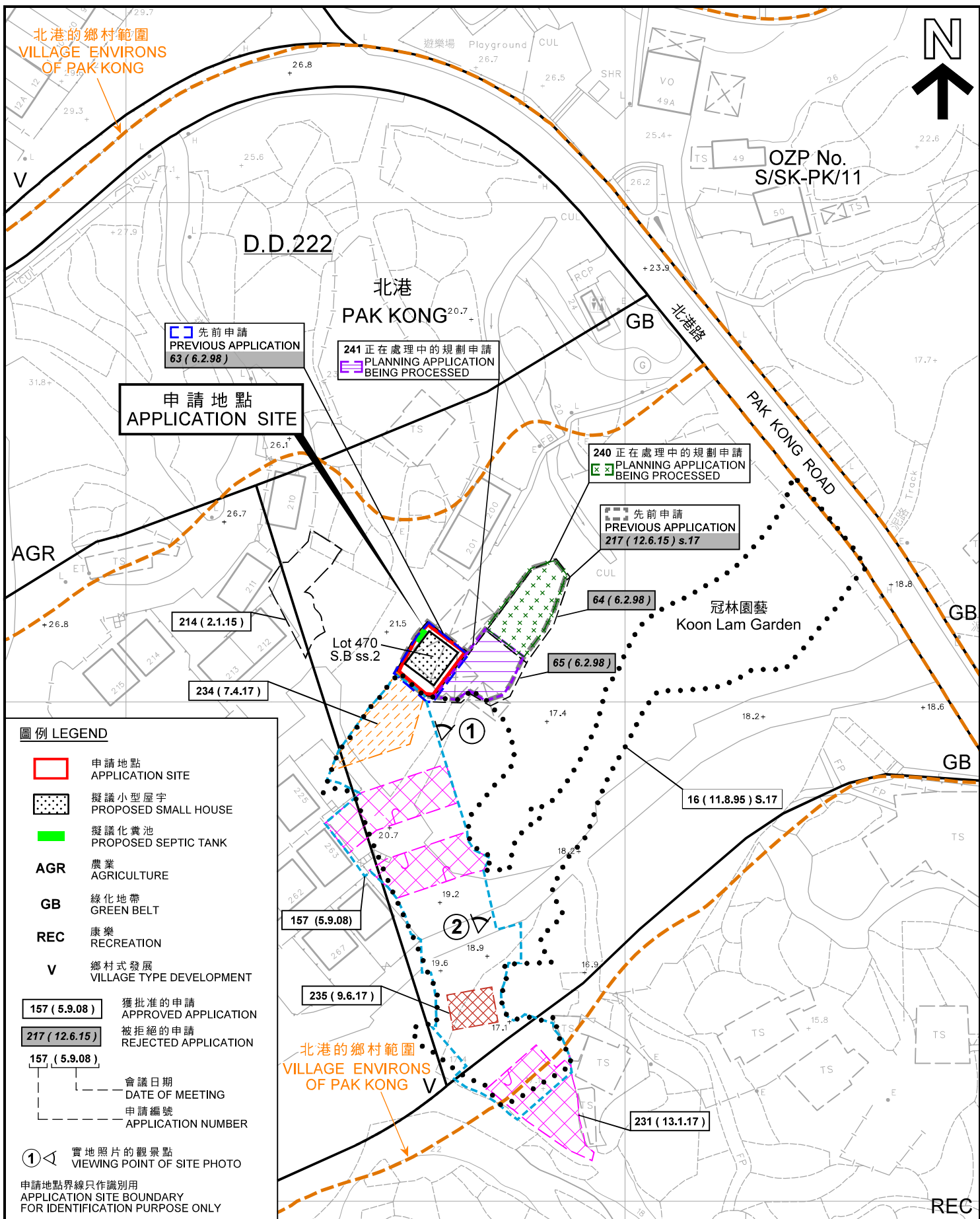

平面圖 SITE PLAN

擬議屋宇 (新界豁免管制屋宇 - 小型屋宇)
西貢北港丈量約份第 2 2 2 約地段第 4 7 0 號 B 分段第 2 小分段
PROPOSED HOUSE
(NEW TERRITORIES EXEMPTED HOUSE - SMALL HOUSE)
LOT 470 S.B ss.2 IN D.D. 222,
PAK KONG, SAI KUNG

SCALE 1 : 1 000 比例尺

米 20 0 20 40 米
METRES

規劃署
PLANNING
DEPARTMENT





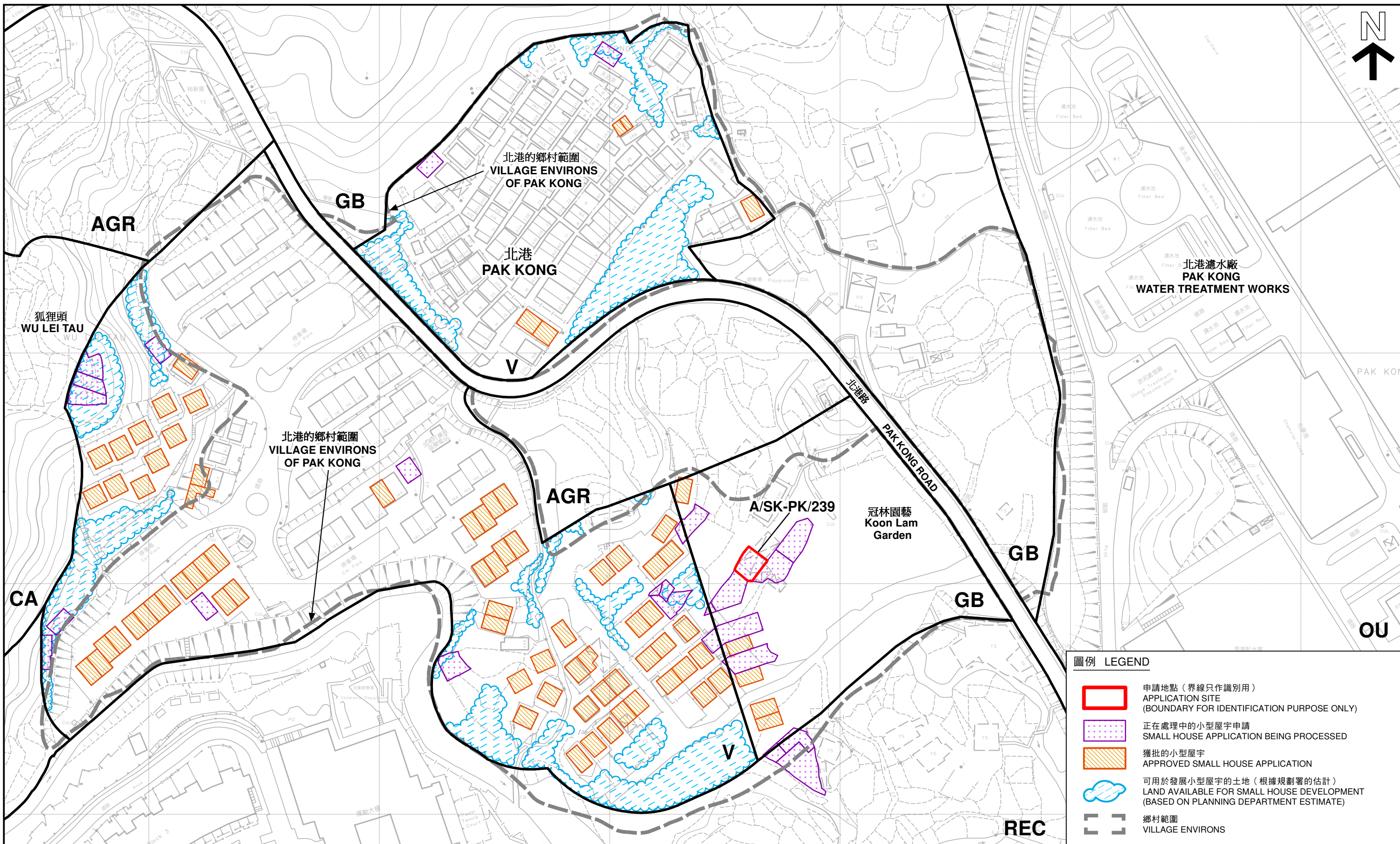

參考編號
REFERENCE No.
A/SK-PK/239

圖 PLAN
A-2a

本摘要圖於 2017 年 12 月 29 日擬備，
所根據的資料為測量圖編號
7-SE-15D 和 20B
EXTRACT PLAN PREPARED ON 29.12.2017
BASED ON SURVEY SHEETS No.
7-SE-15D & 20B



圖例 LEGEND

-  申請地點 (界線只作識別用)
APPLICATION SITE
(BOUNDARY FOR IDENTIFICATION PURPOSE ONLY)
-  正在處理中的小型屋宇申請
SMALL HOUSE APPLICATION BEING PROCESSED
-  獲批的小型屋宇
APPROVED SMALL HOUSE APPLICATION
-  可用於發展小型屋宇的土地 (根據規劃署的估計)
LAND AVAILABLE FOR SMALL HOUSE DEVELOPMENT
(BASED ON PLANNING DEPARTMENT ESTIMATE)
-  鄉村範圍
VILLAGE ENVIRONS

本摘要圖於2017年12月29日擬備，所根據的資料為測量圖編號 7-SE-15D、20B和8-SW-11C
EXTRACT PLAN PREPARED ON 29.12.2017
BASED ON SURVEY SHEETS No. 7-SE-15D, 20B & 8-SW-11C

平面圖 SITE PLAN
擬議屋宇 (新界豁免管制屋宇 - 小型屋宇)
西貢北港丈量約份第 2 2 2 約地段第 4 7 0 號 B 分段第 2 小分段
PROPOSED HOUSE
(NEW TERRITORIES EXEMPTED HOUSE - SMALL HOUSE)
LOT 470 S.B ss.2 IN D.D. 222,
PAK KONG, SAI KUNG

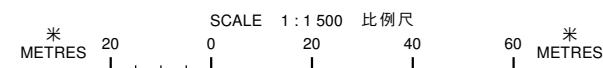

規劃署
PLANNING DEPARTMENT



參考編號 REFERENCE No.
A/SK-PK/239

圖 PLAN
A-2b



北港濾水廠
PAK KONG
WATER
TREATMENT
WORKS

北港路
PAK KONG ROAD

北港
PAK KONG

冠林園藝
Koon Lam Garden

申請地點
APPLICATION SITE

HONG KONG
GOLF & TENNIS ACADEMY

申請地點界線只作識別用
APPLICATION SITE BOUNDARY
FOR IDENTIFICATION PURPOSE ONLY

航攝照片 AERIAL PHOTO

擬議屋宇 (新界豁免管制屋宇 - 小型屋宇)
西貢北港丈量約份第 2 2 2 約地段第 4 7 0 號 B 分段第 2 小分段
PROPOSED HOUSE
(NEW TERRITORIES EXEMPTED HOUSE - SMALL HOUSE)
LOT 470 S.B ss.2 IN D.D. 222,
PAK KONG, SAI KUNG

規 劃 署
PLANNING
DEPARTMENT



本摘要圖於 2017 年 12 月 29 日擬備，
所根據的資料為地政總署
於 2017 年 3 月 27 日拍得的
航攝照片編號 E015468C
EXTRACT PLAN PREPARED ON 29.12.2017
BASED ON AERIAL PHOTO No. E015468C
TAKEN ON 27.3.2017
BY LANDS DEPARTMENT

參考編號
REFERENCE No.
A/SK-PK/239

圖 PLAN
A-3

1



2



申請地點界線只作識別用
APPLICATION SITE BOUNDARY FOR IDENTIFICATION PURPOSE ONLY

連接申請地點的通道
Access Leading to the Application Site

實地照片 SITE PHOTO

擬議屋宇 (新界豁免管制屋宇 - 小型屋宇)
西貢北港丈量約份第 2 2 2 約地段第 4 7 0 號 B 分段第 2 小分段
PROPOSED HOUSE
(NEW TERRITORIES EXEMPTED HOUSE - SMALL HOUSE)
LOT 470 S.B ss.2 IN D.D. 222,
PAK KONG, SAI KUNG

規 劃 署
PLANNING
DEPARTMENT



參考編號
REFERENCE No.
A/SK-PK/239

圖 PLAN
A-4

本圖於 2017 年 12 月 29 日擬備，所根據的資料為攝於 2017 年 12 月 28 日的實地照片
PLAN PREPARED ON 29.12.2017
BASED ON SITE PHOTOS TAKEN ON 28.12.2017