

(來源：申請人於2019年3月15日提交)
(SOURCE : SUBMITTED BY APPLICANT ON 15.3.2019)

參考編號
REFERENCE No.
A/SLC/154

繪圖
DRAWING
A - 2a

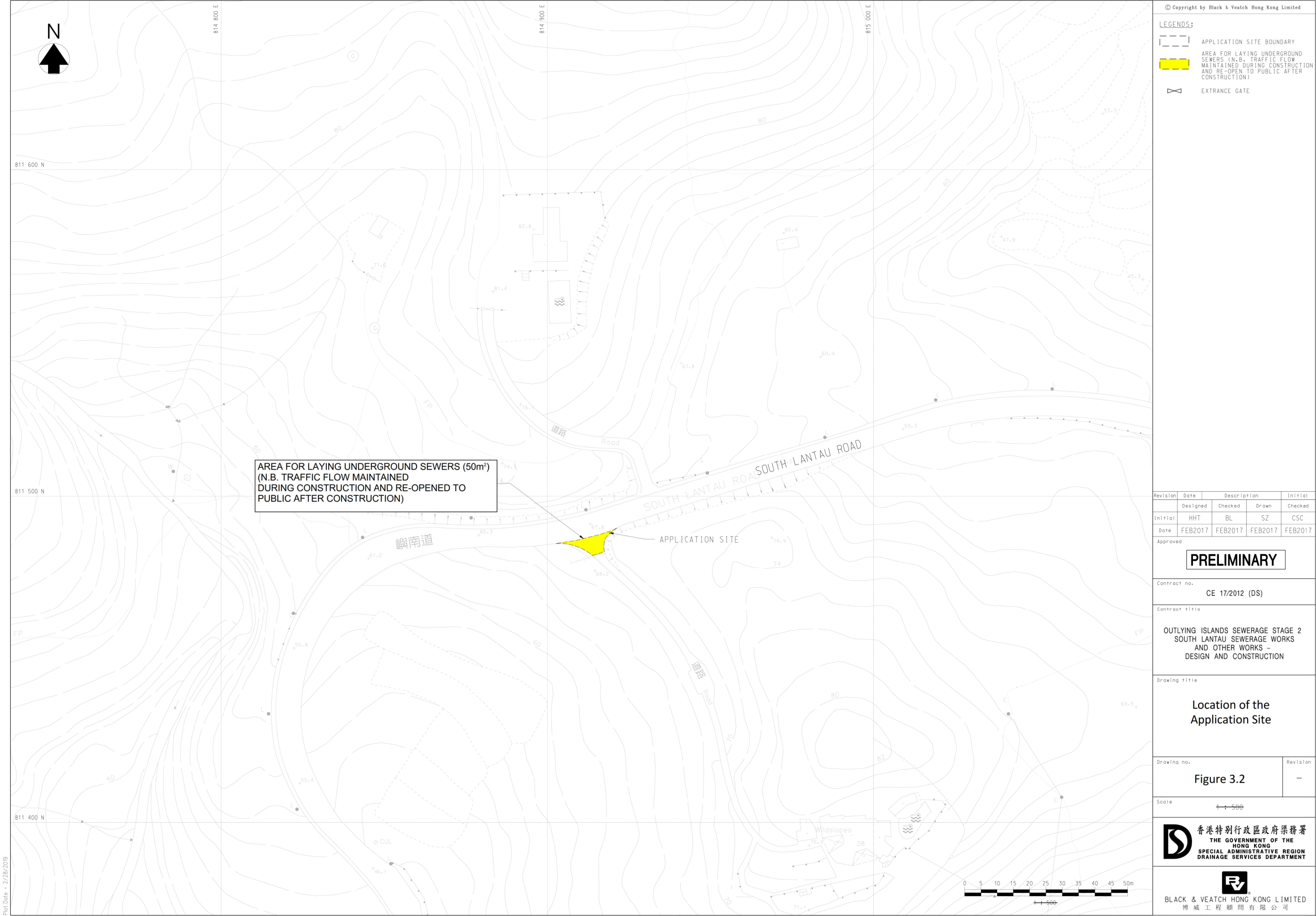

Plot Date = 2/28/2019

CAD Filename = y:\daily work\20190226d\Figure 6.8.dgn

(來源：申請人於2019年3月15日提交)
(SOURCE : SUBMITTED BY APPLICANT ON 15.3.2019)

參考編號
REFERENCE No.
A/SLC/154

繪圖
**DRAWING
A - 2b**

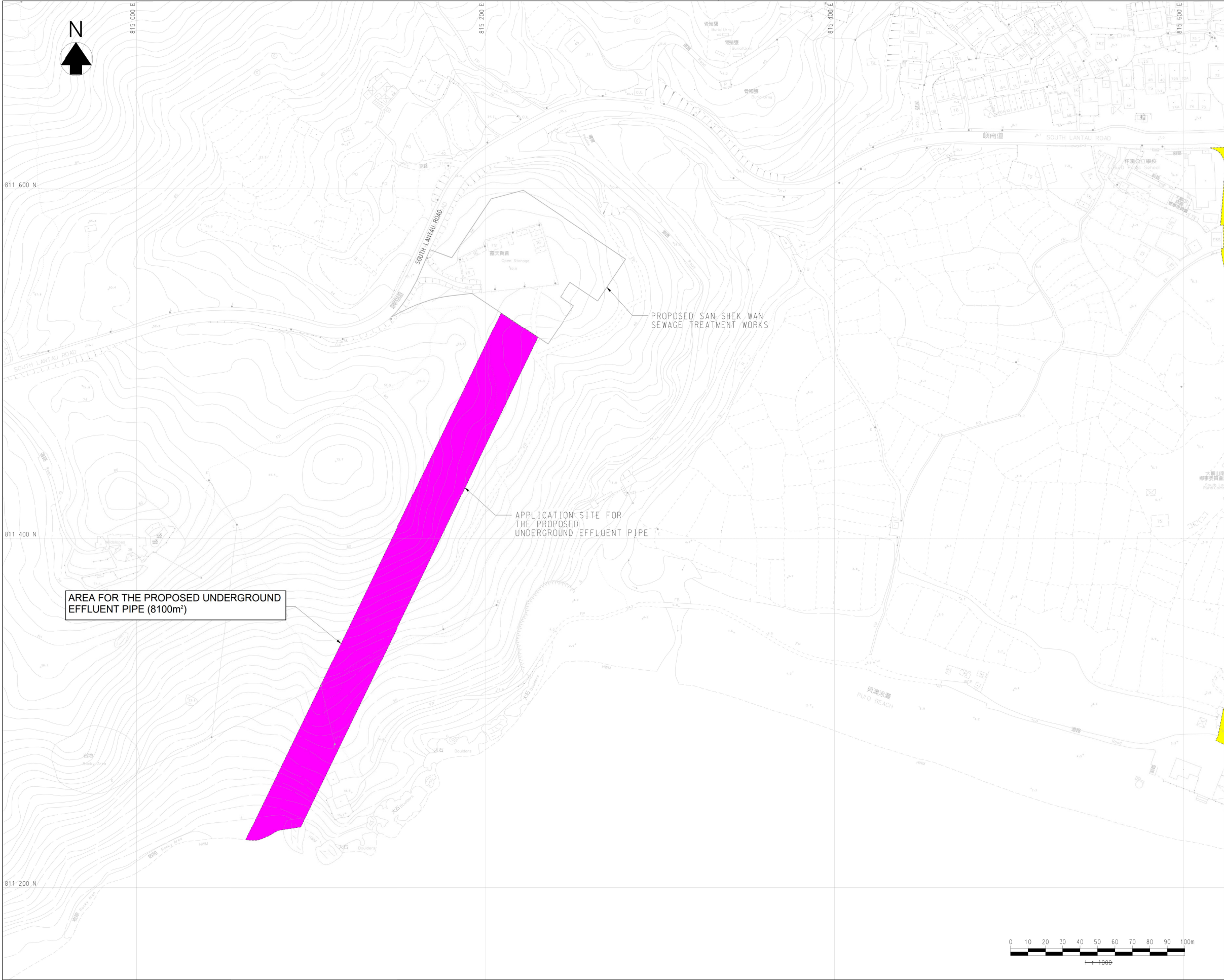

AREA FOR THE PROPOSED UNDERGROUND
EFFLUENT PIPE (8100m²)

APPLICATION SITE FOR
THE PROPOSED
UNDERGROUND EFFLUENT PIPE

PROPOSED SAN SHEK WAN
SEWAGE TREATMENT WORKS

© Copyright by Black & Veatch Hong Kong Limited

LEGENDS:

- APPLICATION SITE BOUNDARY
- THE PROPOSED UNDERGROUND EFFLUENT PIPE

Revision	Date	Description		Initial
	Designed	Checked	Drawn	Checked
Initial	HHT	BL	SZ	CSC
Date	FEB2017	FEB2017	FEB2017	FEB2017
Approved				
PRELIMINARY				
Contract no. CE 17/2012 (DS)				
Contract title OUTLYING ISLANDS SEWERAGE STAGE 2 SOUTH LANTAU SEWERAGE WORKS AND OTHER WORKS – DESIGN AND CONSTRUCTION				
Drawing title Location of the Application Site				
Drawing no. Figure 3.3		Revision —		
Scale 1:1000				
香港特別行政區政府渠務署 THE GOVERNMENT OF THE HONG KONG SPECIAL ADMINISTRATIVE REGION DRAINAGE SERVICES DEPARTMENT				
BLACK & VEATCH HONG KONG LIMITED 博威工程顧問有限公司				

(來源：申請人於2019年3月15日提交)
(SOURCE : SUBMITTED BY APPLICANT ON 15.3.2019)

參考編號
REFERENCE No.
A/SLC/154

繪圖
DRAWING
A - 2c

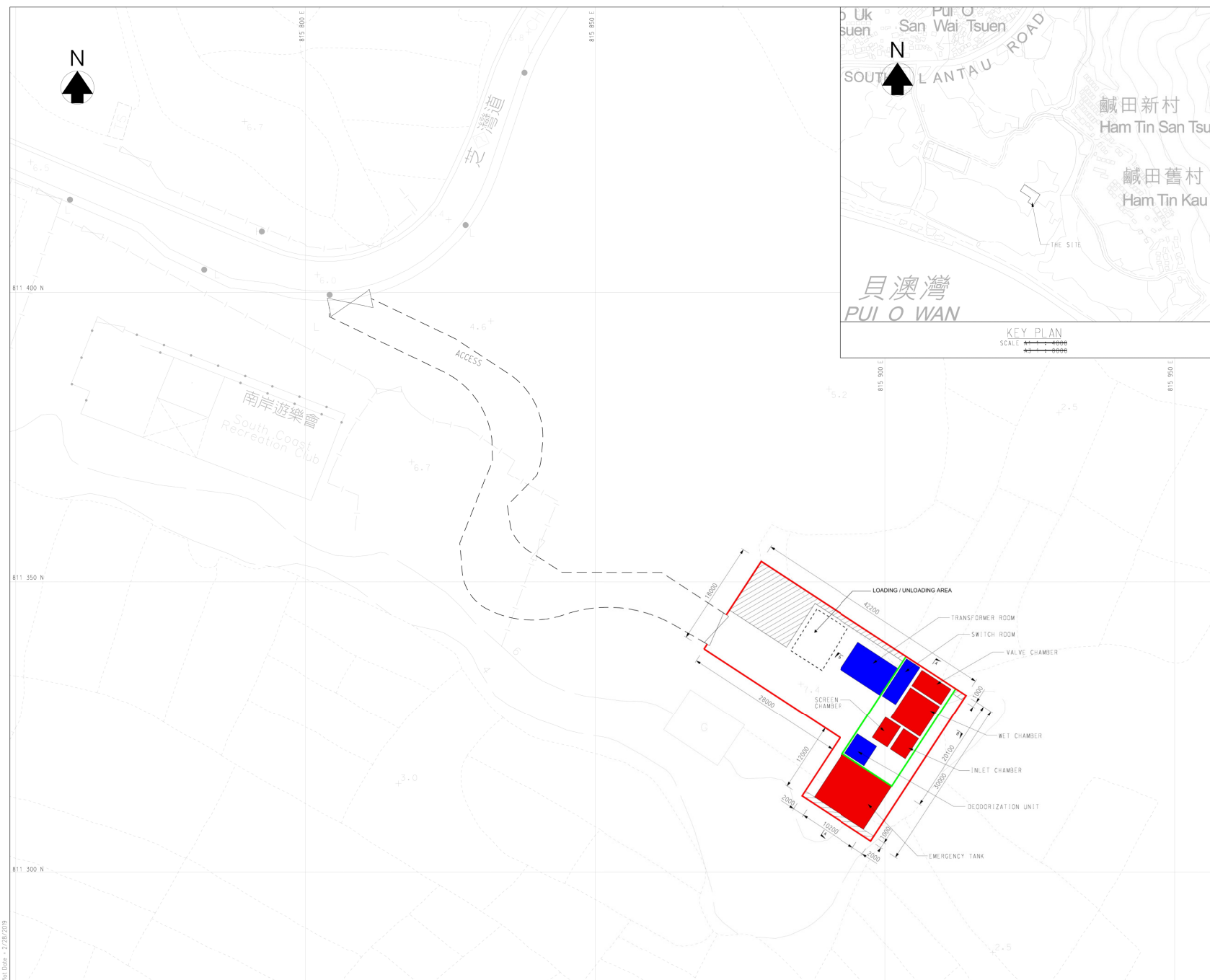

© Copyright by Black & Veatch Hong Kong Limited

NOTES:

1. ALL DIMENSIONS ARE IN MILLIMETRES UNLESS OTHERWISE SPECIFIED.
2. ALL LEVELS ARE IN METRES ABOVE P.D.M.K.

LEGEND:

- LANDSCAPE AREA
- ENTRANCE GATE
- PROPOSED LEVELS
- BOUNDARY WALL
- PUI O SEWAGE PUMPING STATION (BELOW GROUND FACILITIES)
- PUI O SEWAGE PUMPING STATION (ABOVE GROUND FACILITIES)
- BOUNDARY OF PUMP HOUSE
- FENCE

Revision	Date	Description	Initial
Designed	Checked	Drawn	Checked
Initial	KN	CSC	SZ CSC
Date	FEB2019	FEB2019	FEB2019
Approved			

PRELIMINARY

Contract no. CE 17/2012 (DS)

Contract title
OUTLYING ISLANDS SEWERAGE STAGE 2
SOUTH LANTAU SEWERAGE WORKS
AND OTHER WORKS -
DESIGN AND CONSTRUCTION

Drawing title
Pui O
Sewage Pumping Station -
General Layout Plan

Drawing no. Figure 6.1

Scale
AS SHOWN
AS SHOWN

THE GOVERNMENT OF THE HONG KONG SPECIAL ADMINISTRATIVE REGION
DRAINAGE SERVICES DEPARTMENT

BLACK & VEATCH HONG KONG LIMITED
博威工程顧問有限公司

(來源：申請人於2019年3月15日提交)
(SOURCE : SUBMITTED BY APPLICANT ON 15.3.2019)

參考編號
REFERENCE No.
A/SLC/154

繪圖
DRAWING
A - 3

NOTES:

1. PLEASE REFER TO DRAWING NO.
178711/ZB/GEN/01039 FOR NOTES
AND LEGENDS.

Revision	Date	Description		Initial
	Designed	Checked	Drawn	Checked
Initial	KN	CSC	SZ	CSC
Date	FEB2019	FEB2019	FEB2019	FEB2019

Approved

PRELIMINARYContract no.
CE 17/2012 (DS)

Contract title
OUTLYING ISLANDS SEWERAGE STAGE 2
SOUTH LANTAU SEWERAGE WORKS
AND OTHER WORKS -
DESIGN AND CONSTRUCTION

Drawing title
Pui O
Sewage Pumping Station -
Section A - A

Drawing no.
Figure 6.2

Scale
A1 1:150
A3 1:100

THE GOVERNMENT OF THE
HONG KONG
SPECIAL ADMINISTRATIVE REGION
DRAINAGE SERVICES DEPARTMENT

BLACK & VEATCH HONG KONG LIMITED
博威工程顧問有限公司

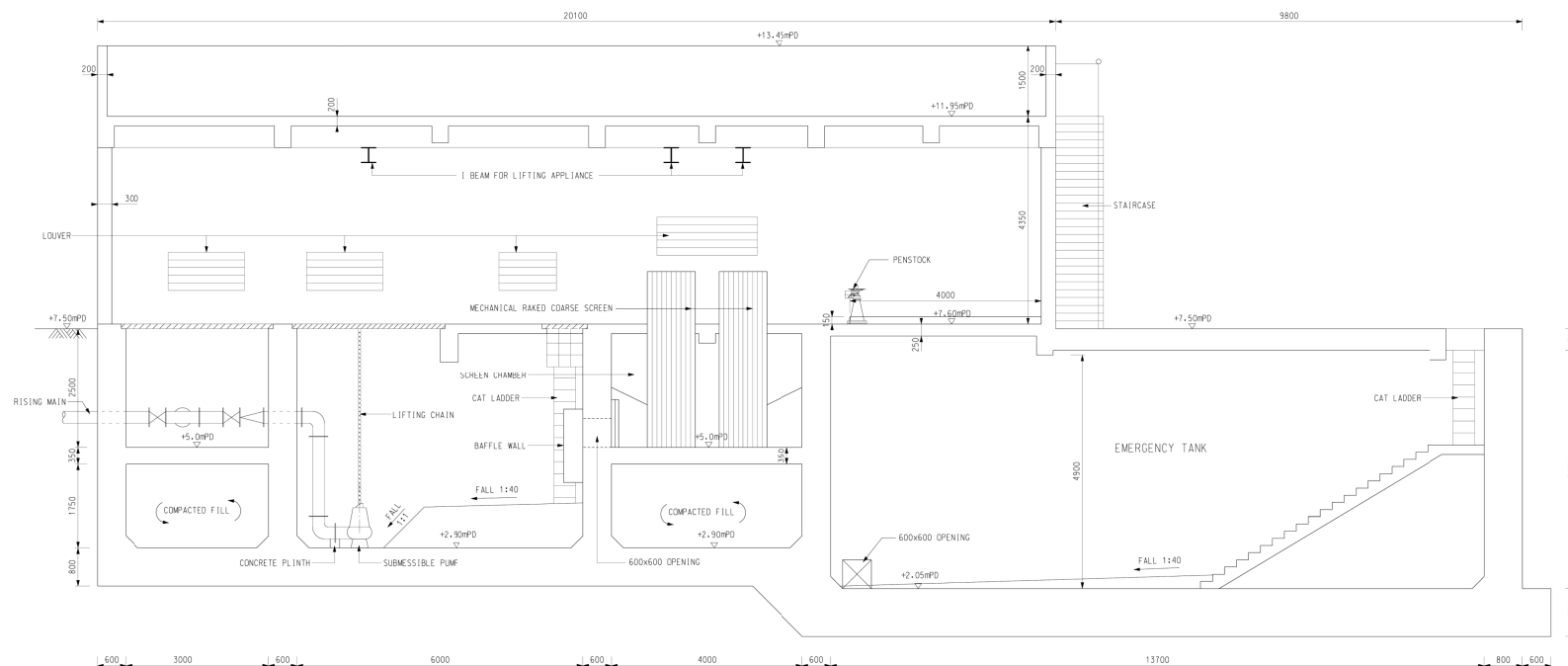

SECTION A-A

(來源：申請人於2019年3月15日提交)
(SOURCE : SUBMITTED BY APPLICANT ON 15.3.2019)

參考編號
REFERENCE No.
A/SLC/154

繪圖
DRAWING
A - 4

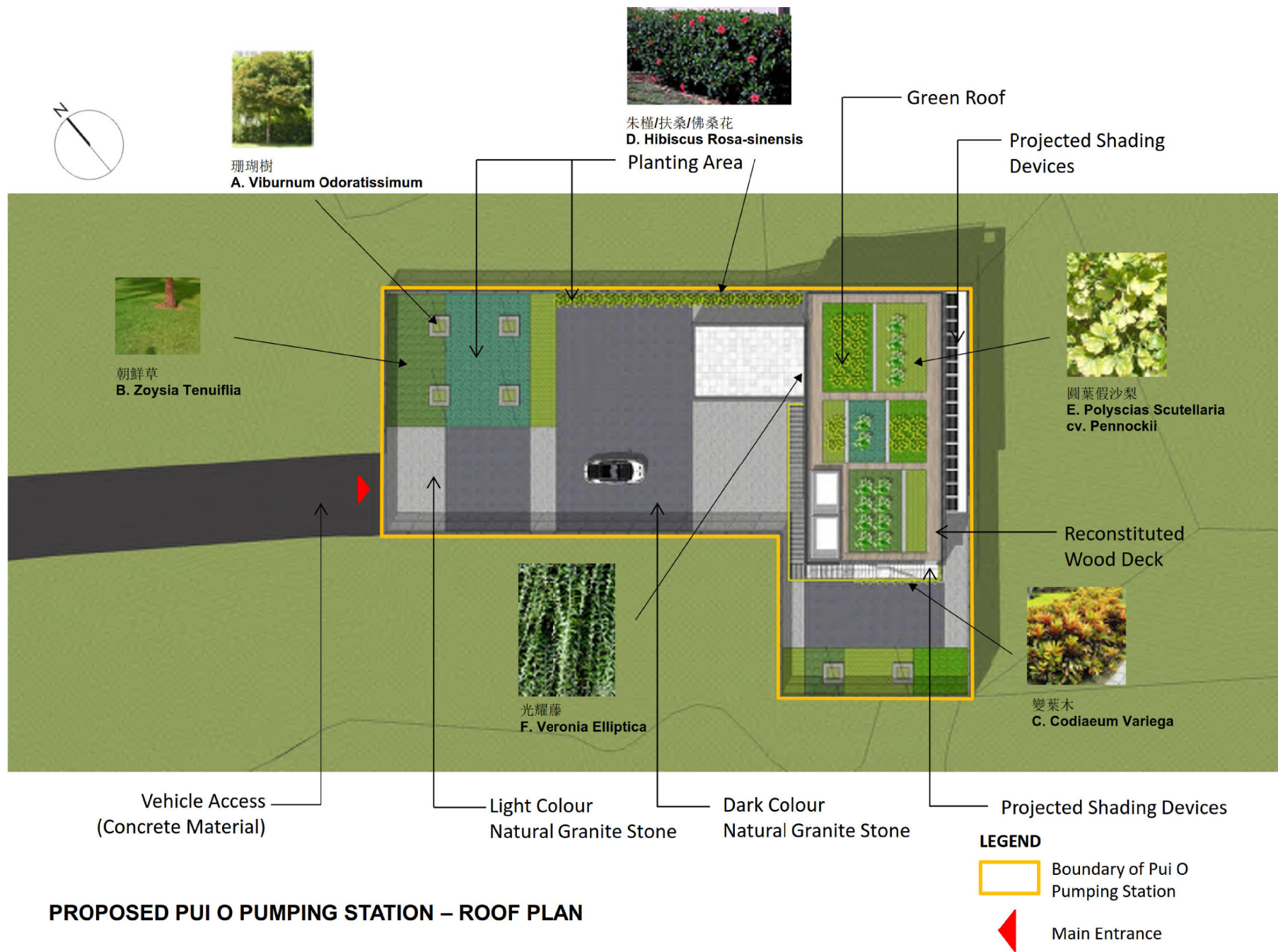

PROPOSED PUI O PUMPING STATION – ROOF PLAN

(來源：申請人於2019年3月15日提交)
(SOURCE : SUBMITTED BY APPLICANT ON 15.3.2019)

參考編號
REFERENCE No.
A/SLC/154

繪圖
DRAWING
A - 5

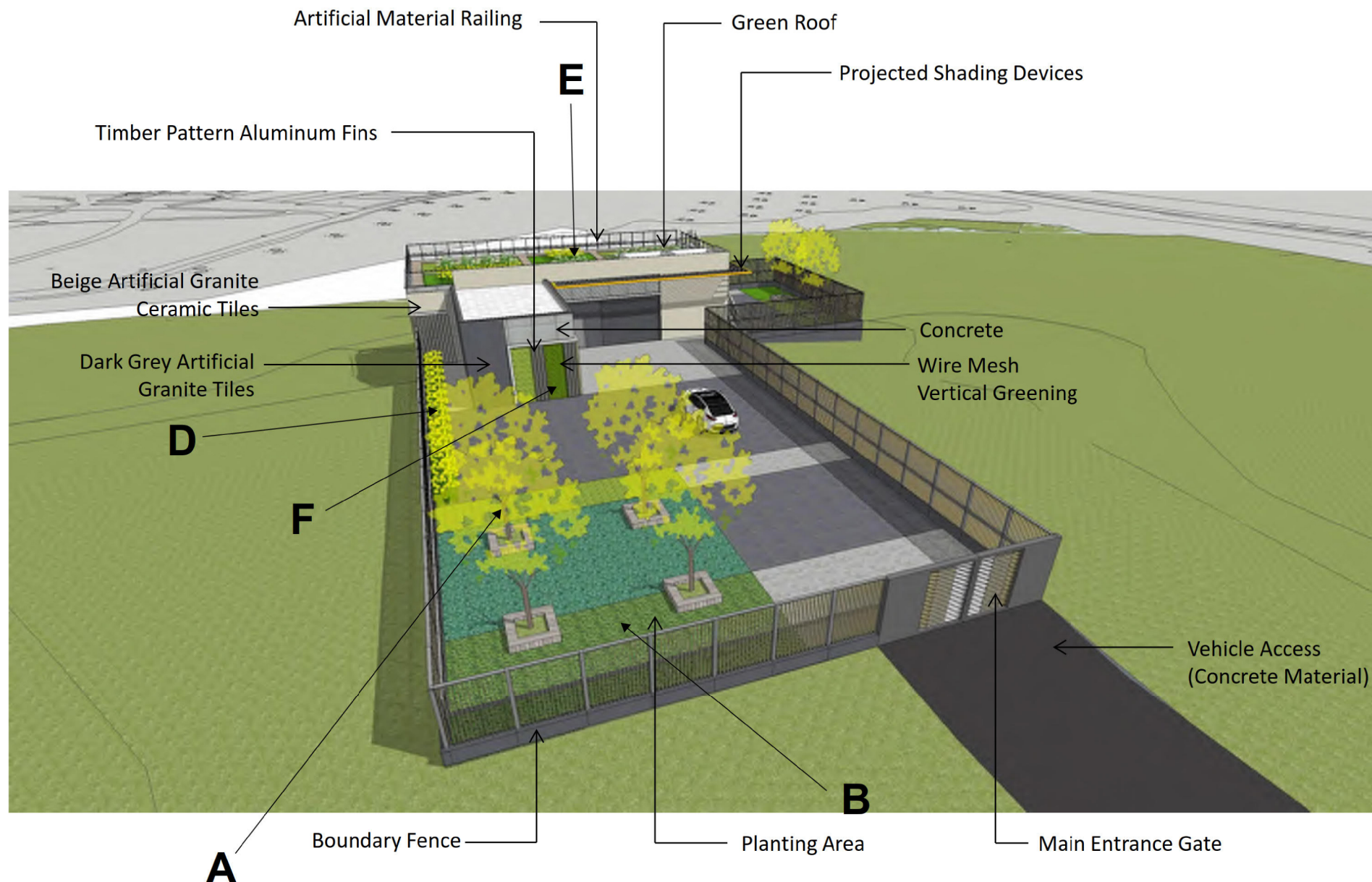

PROPOSED PUI O PUMPING STATION – NORTH ELEVATION VIEW AT HIGH LEVEL

(來源：申請人於2019年3月15日提交)
(SOURCE : SUBMITTED BY APPLICANT ON 15.3.2019)

參考編號
REFERENCE No.
A/SLC/154

繪圖
DRAWING
A - 6



VP5 - Existing View

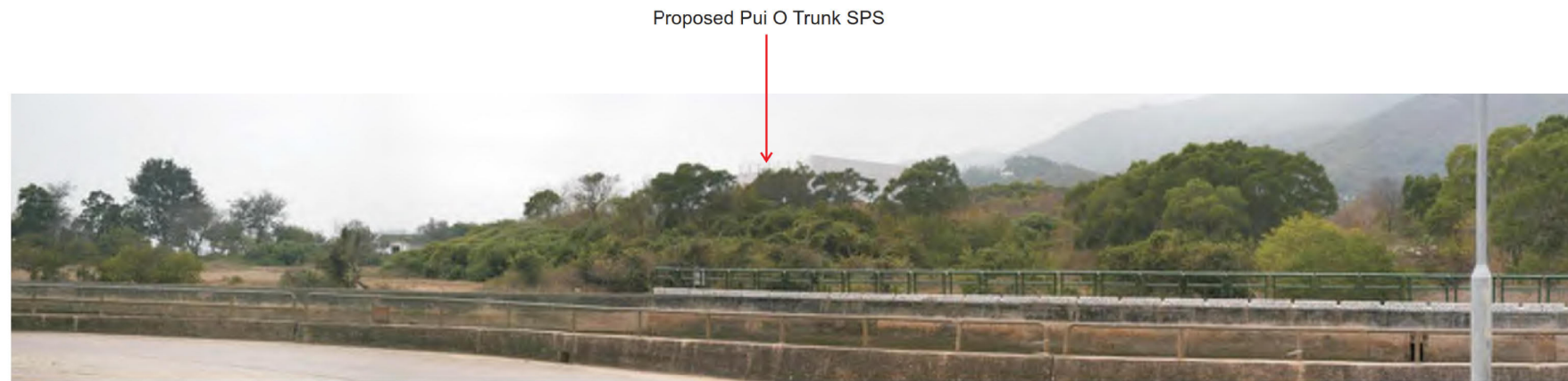

VP5 - Photomontage with no mitigation

View from VP5 (1 of 2)	OUTLYING ISLANDS SEWERAGE STAGE 2 SOUTH LANTAU SEWERAGE WORKS - INVESTIGATION		Figure no. Figure 10.7.9a	
	 香港特別行政區政府渠務署 THE GOVERNMENT OF THE HONG KONG SPECIAL ADMINISTRATIVE REGION DRAINAGE SERVICES DEPARTMENT		Prepared KK	Checked FEZ
	 BLACK & VEATCH HONG KONG LIMITED 博威工程顧問有限公司		Date 14/05/2012	Scale N/A

0115164a5

(來源：申請人於2019年3月15日提交)
(SOURCE : SUBMITTED BY APPLICANT ON 15.3.2019)

參考編號
REFERENCE No.
A/SLC/154

繪圖
DRAWING
A - 7

Proposed Pui O Trunk SPS



VP5 - Photomontage with mitigation at Day 1

Proposed Pui O Trunk SPS



VP5 - Photomontage with mitigation at Year 10

Title View from VP5 (2 of 2)	OUTLYING ISLANDS SEWERAGE STAGE 2 SOUTH LANTAU SEWERAGE WORKS - INVESTIGATION		Figure no. Figure 10.7.9b	
	 香港特別行政區政府渠務署 THE GOVERNMENT OF THE HONG KONG SPECIAL ADMINISTRATIVE REGION DRAINAGE SERVICES DEPARTMENT	Prepared KK	Checked FEZ	
			Date 14/05/2012	Scale N/A

0115164a5b

(來源：申請人於2019年3月15日提交)
(SOURCE : SUBMITTED BY APPLICANT ON 15.3.2019)

參考編號
REFERENCE No.
A/SLC/154

繪圖
DRAWING
A - 8

Plot Date = 8/27/2014

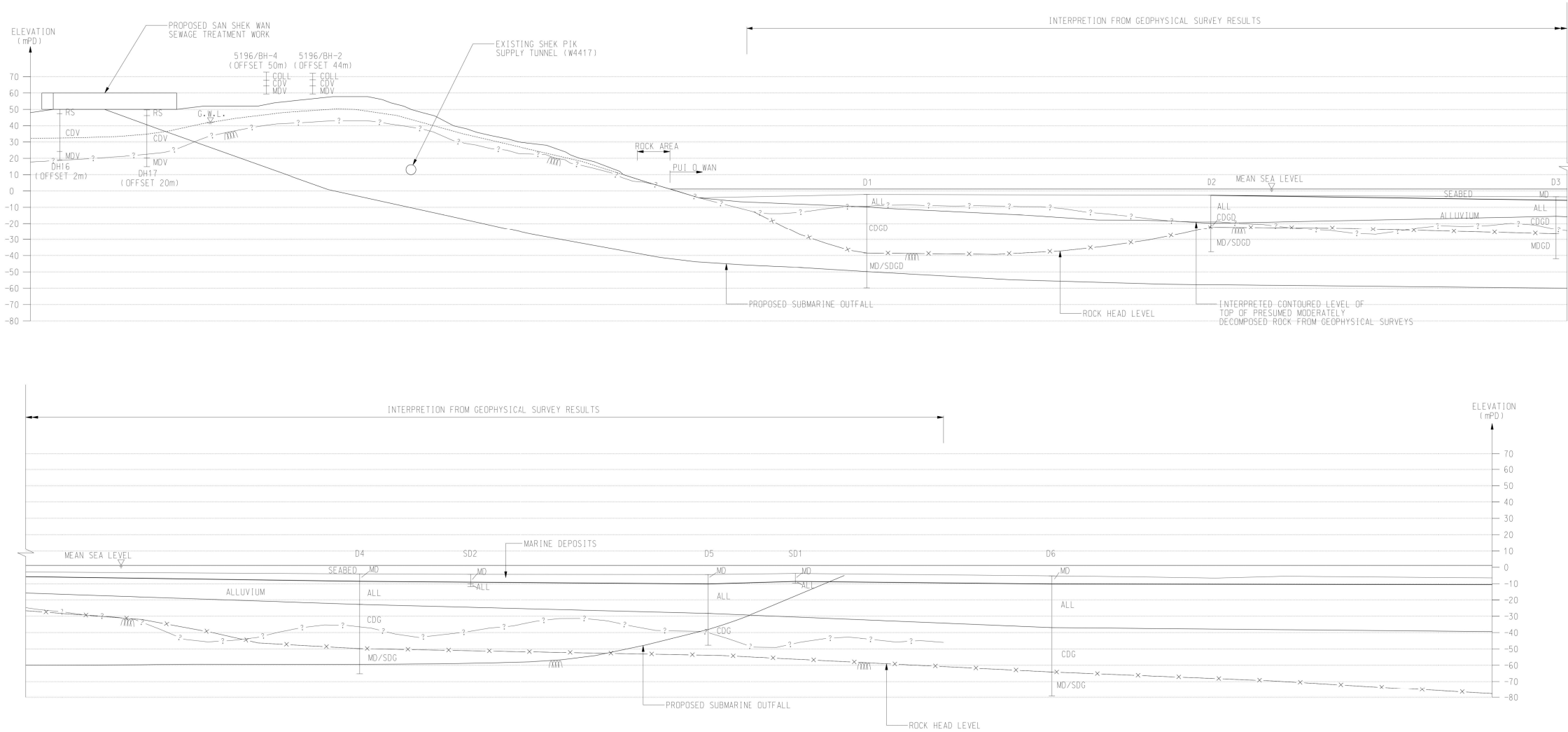

© Copyright by Black & Veatch Hong Kong Limited

NOTE:

1. THIS FIGURE SHOULD BE READ WITH FIGURE NO. 178711B/GAR/03109.

LEGEND:

- ?--- INFERRED GEOLOGICAL BOUNDARY
- x--- ROCK HEAD LEVEL
- ||||| ROCK HEAD (GRADE 1:1 OR BETTER ROCK)
- G.W.L. ASSUMED GROUNDWATER TABLE/SEA LEVEL

GEOLOGICAL KEY :

- RS - RESIDUAL SOIL
- ALL - ALLUVIUM
- MD - MARINE DEPOSIT
- CDV - COMPLETELY DECOMPOSED TUFF
- HDV - HIGHLY DECOMPOSED TUFF
- MDV - MODERATELY DECOMPOSED TUFF
- SDV - SLIGHTLY DECOMPOSED TUFF
- CDG - COMPLETELY DECOMPOSED GRANITE
- HDG - HIGHLY DECOMPOSED GRANITE
- MDG - MODERATELY DECOMPOSED GRANITE
- SDG - SLIGHTLY DECOMPOSED GRANITE
- CDGD - COMPLETELY DECOMPOSED GRANODIORITE
- HDGD - HIGHLY DECOMPOSED GRANODIORITE
- MDGD - MODERATELY DECOMPOSED GRANODIORITE
- SDGD - SLIGHTLY DECOMPOSED GRANODIORITE

Revision	Date	Description	Initial
	Designed	Checked	Drawn
Initial	MYL	KHL	SZ
Date	JUN2014	JUN2014	JUN2014

Approved

PRELIMINARY

Contract no.
CE 17/2012 (DS)

Contract title
OUTLYING ISLANDS SEWERAGE STAGE 2
SOUTH LANTAU SEWERAGE WORKS
AND OTHER WORKS -
DESIGN AND CONSTRUCTION

Drawing title
GEOLOGICAL PROFILE OF
THE SUBMARINE OUTFALL
- LONGITUDINAL

Drawing no.	Revision
178711/B/GAR/03110	-

Scale
1:1500

香港特別行政區政府渠務署
THE GOVERNMENT OF THE
HONG KONG
SPECIAL ADMINISTRATIVE REGION
DRAINAGE SERVICES DEPARTMENT

BLACK & VEATCH HONG KONG LIMITED
博威工程顧問有限公司

(來源：申請人於2019年5月7日提交)
(SOURCE : SUBMITTED BY APPLICANT ON 7.5.2019)

參考編號
REFERENCE No.
A/SLC/154

繪圖
DRAWING
A - 9

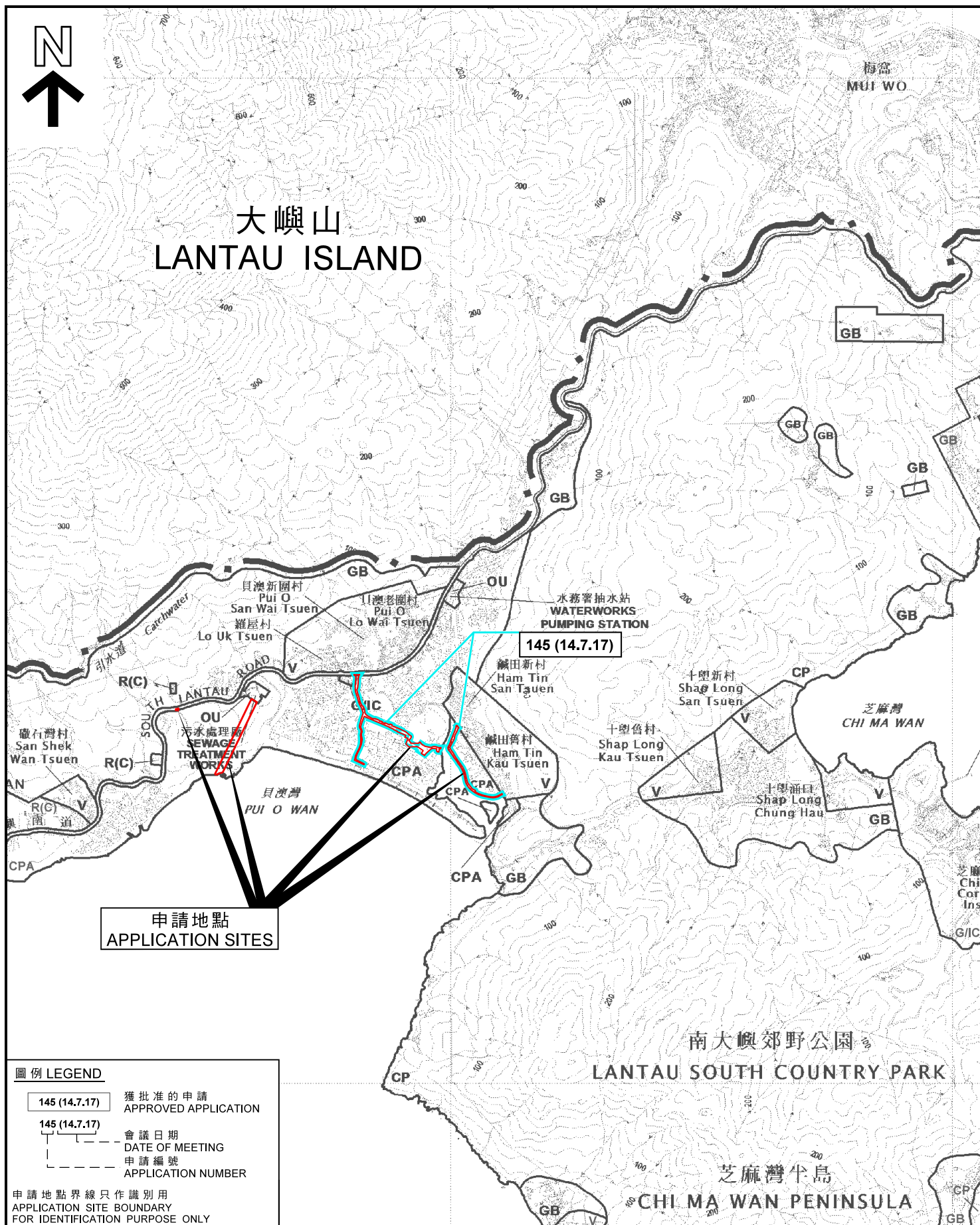

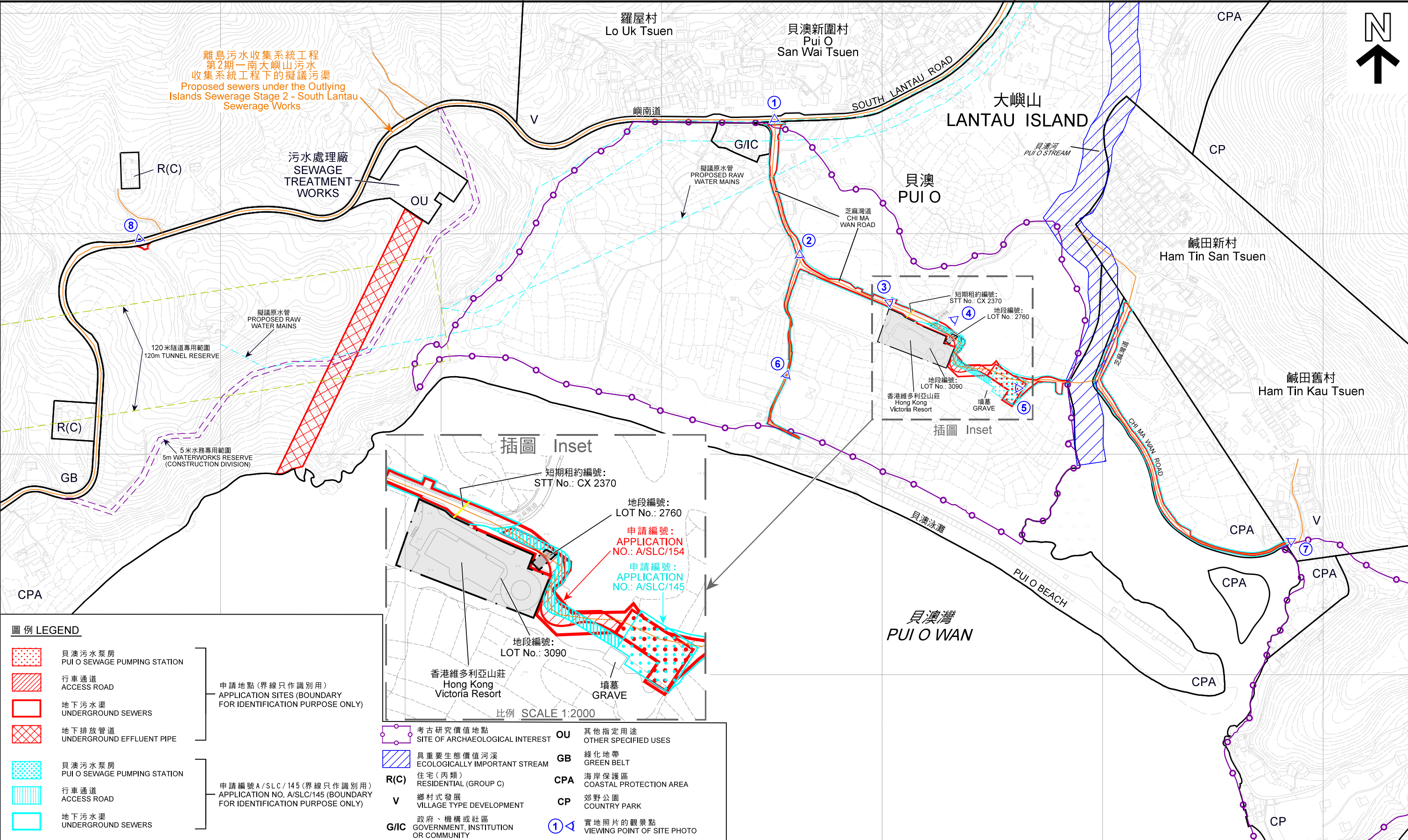

圖例 LEGEND

	貝澳污水泵房 PUI O SEWAGE PUMPING STATION
	行車通道 ACCESS ROAD
	地下污水渠 UNDERGROUND SEWERS
	地下排放管道 UNDERGROUND EFFLUENT PIPE
	貝澳污水泵房 PUI O SEWAGE PUMPING STATION
	行車通道 ACCESS ROAD
	地下污水渠 UNDERGROUND SEWERS

申請地點(界線只作識別用)
APPLICATION SITES (BOUNDARY FOR IDENTIFICATION PURPOSE ONLY)

申請編號A/SLC/145(界線只作識別用)
APPLICATION NO. A/SLC/145 (BOUNDARY FOR IDENTIFICATION PURPOSE ONLY)

插圖 Inset

短期租約編號:
STT No.: CX 2370

地段編號:
LOT No.: 2760

申請編號:
APPLICATION NO.: A/SLC/154

申請編號:
APPLICATION NO.: A/SLC/145

地段編號:
LOT No.: 3090

香港維多利亞山莊
Hong Kong Victoria Resort

墳墓
GRAVE

比例 SCALE 1:2000

OU 其他指定用途
OTHER SPECIFIED USES

GB 綠化地帶
GREEN BELT

CPA 海岸保護區
COASTAL PROTECTION AREA

CP 郊野公園
COUNTRY PARK

R(C) 住宅(丙類)
RESIDENTIAL (GROUP C)

V 鄉村式發展
VILLAGE TYPE DEVELOPMENT

G/IC 政府、機構或社區
GOVERNMENT, INSTITUTION OR COMMUNITY

1 實地照片的觀景點
VIEWING POINT OF SITE PHOTO

平面圖 SITE PLAN

擬議公用事業設施裝置(污水泵房、地下污水渠及地下排放管道)及挖土工程以作地下污水渠(約1.5米至4米深)
大嶼山貝澳丈量約份第316約地段第2760號及沿芝麻灣道(貝澳及鹹田)和位於磁石灣近嶼南道的政府土地
PROPOSED PUBLIC UTILITY INSTALLATION (SEWAGE PUMPING STATION, UNDERGROUND SEWERS AND UNDERGROUND EFFLUENT PIPE) AND EXCAVATION OF LAND FOR UNDERGROUND SEWERS (ABOUT 1.5M TO 4M IN DEPTH) LOT 2760 IN D.D. 316L, PUI O AND GOVERNMENT LAND ALONG CHI MA WAN ROAD (PUI O AND HAM TIN) AND NEAR SOUTH LANTAU ROAD AT SAN SHEK WAN, LANTAU ISLAND

SCALE 1:4 000 比例尺

米 METRES 80 0 80 160 240 320

**規劃署
PLANNING DEPARTMENT**

參考編號
REFERENCE No.
A/SLC/154

**圖 PLAN
A - 2**



貝澳污水泵房
PUI O SEWAGE PUMPING STATION

行車通道
ACCESS ROAD

地下污水渠
UNDERGROUND SEWERS

地下排放管道
UNDERGROUND EFFLUENT PIPE

申請地點(界線只作識別用)
APPLICATION SITE (BOUNDARY
FOR IDENTIFICATION PURPOSE ONLY)

本摘要圖於2019年4月10日擬備，
所根據的資料為地政總署
於2018年5月30日拍得的
航攝照片編號E042805C
EXTRACT PLAN PREPARED ON 10.4.2019
BASED ON AERIAL PHOTO No. E042805C
TAKEN ON 30.5.2018
BY LANDS DEPARTMENT

航攝照片 AERIAL PHOTO

擬議公用事業設施裝置（污水泵房、地下污水渠及
地下排放管道）及挖土工程以作地下污水渠（約1.5米至4米深）
大嶼山貝澳丈量約份第316約地段第2760號及
沿芝麻灣道（貝澳及鹹田）和位於磧石灣近嶼南道的政府土地
PROPOSED PUBLIC UTILITY INSTALLATION (SEWAGE PUMPING STATION, UNDERGROUND SEWERS AND
UNDERGROUND EFFLUENT PIPE) AND EXCAVATION OF LAND FOR UNDERGROUND SEWERS (ABOUT 1.5M TO 4M IN DEPTH)
LOT 2760 IN D.D. 316L, PUI O AND GOVERNMENT LAND ALONG CHI MA WAN ROAD
(PUI O AND HAM TIN) AND NEAR SOUTH LANTAU ROAD AT SAN SHEK WAN, LANTAU ISLAND

規劃署
PLANNING DEPARTMENT

參考編號
REFERENCE No.
A/SLC/154

圖 PLAN
A - 3

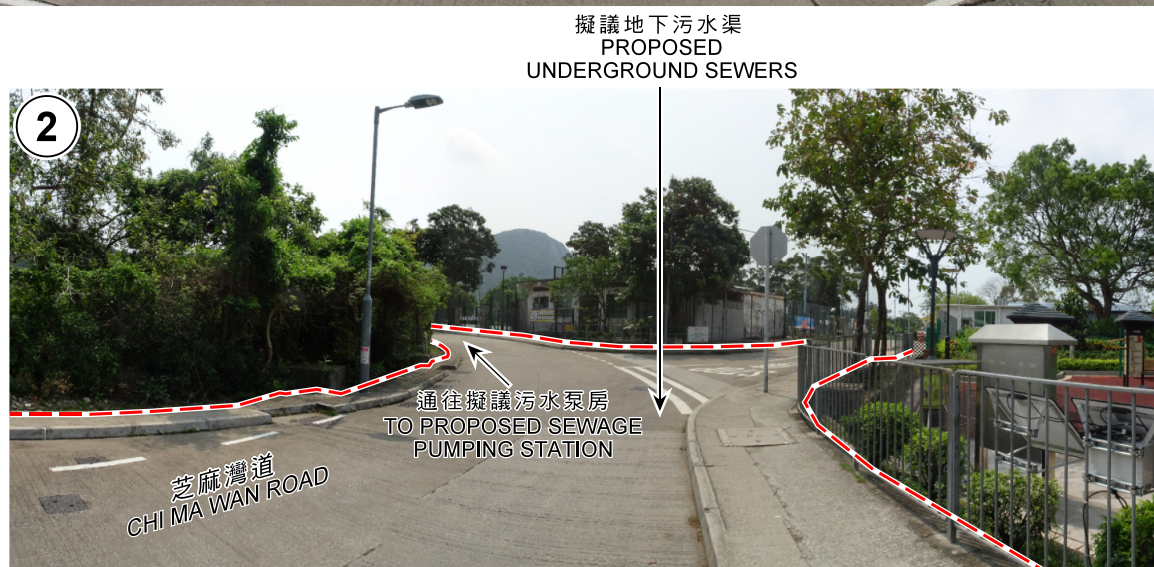

界線只作識別用
BOUNDARY FOR IDENTIFICATION PURPOSE ONLY

實地照片 SITE PHOTOS

擬議公用事業設施裝置（污水泵房、地下污水渠及地下排放管道）及挖土工程以作地下污水渠（約1.5米至4米深）大嶼山貝澳丈量約份第316約地段第2760號及沿芝麻灣道（貝澳及鹹田）和位於礮石灣近嶼南道的政府土地
PROPOSED PUBLIC UTILITY INSTALLATION (SEWAGE PUMPING STATION, UNDERGROUND SEWERS AND UNDERGROUND EFFLUENT PIPE) AND EXCAVATION OF LAND FOR UNDERGROUND SEWERS (ABOUT 1.5M TO 4M IN DEPTH) LOT 2760 IN D.D. 316L, PUI O AND GOVERNMENT LAND ALONG CHI MA WAN ROAD (PUI O AND HAM TIN) AND NEAR SOUTH LANTAU ROAD AT SAN SHEK WAN, LANTAU ISLAND

規劃署
PLANNING
DEPARTMENT



參考編號
REFERENCE No.
A/SLC/154

圖 PLAN
A - 4

本摘要圖於2019年4月8日擬備，
所根據的資料為攝於
2019年3月26日的實地照片
PLAN PREPARED ON 8.4.2019
BASED ON SITE PHOTOS
TAKEN ON 26.3.2019

擬議行車通道
PROPOSED
ACCESS ROAD VICTORIA RESORT



墳墓
GRAVE

擬議污水泵房
PROPOSED SEWAGE
PUMPING STATION

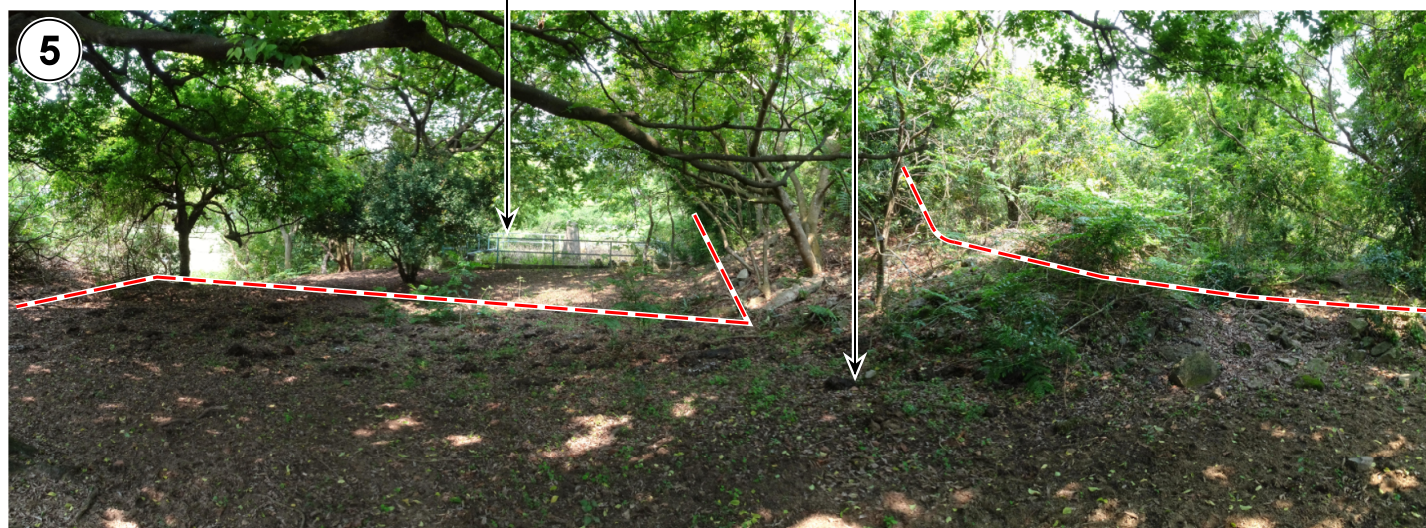

界線只作識別用
BOUNDARY FOR IDENTIFICATION PURPOSE ONLY

本摘要圖於2019年4月18日擬備，
所根據的資料為攝於
2019年3月26日的實地照片
PLAN PREPARED ON 18.4.2019
BASED ON SITE PHOTOS
TAKEN ON 26.3.2019

實地照片 SITE PHOTOS

擬議公用事業設施裝置（污水泵房、地下污水渠及
地下排放管道）及挖土工程以作地下污水渠（約1.5米至4米深）
大嶼山貝澳丈量約份第316約地段第2760號及
沿芝麻灣道（貝澳及鹹田）和位於礮石灣近嶼南道的政府土地
PROPOSED PUBLIC UTILITY INSTALLATION (SEWAGE PUMPING STATION,
UNDERGROUND SEWERS AND UNDERGROUND EFFLUENT PIPE) AND
EXCAVATION OF LAND FOR UNDERGROUND SEWERS (ABOUT 1.5M TO 4M IN DEPTH)
LOT 2760 IN D.D. 316L, PUI O AND GOVERNMENT LAND ALONG CHI MA WAN ROAD
(PUI O AND HAM TIN) AND NEAR SOUTH LANTAU ROAD AT
SAN SHEK WAN, LANTAU ISLAND

規劃署
PLANNING
DEPARTMENT



參考編號
REFERENCE No.
A/SLC/154

圖 PLAN
A - 5

擬議地下污水渠
PROPOSED
UNDERGROUND SEWERS



擬議地下污水渠
PROPOSED
UNDERGROUND SEWERS



芝麻灣道
CHI MA WAN ROAD

擬議地下污水渠
PROPOSED
UNDERGROUND SEWERS

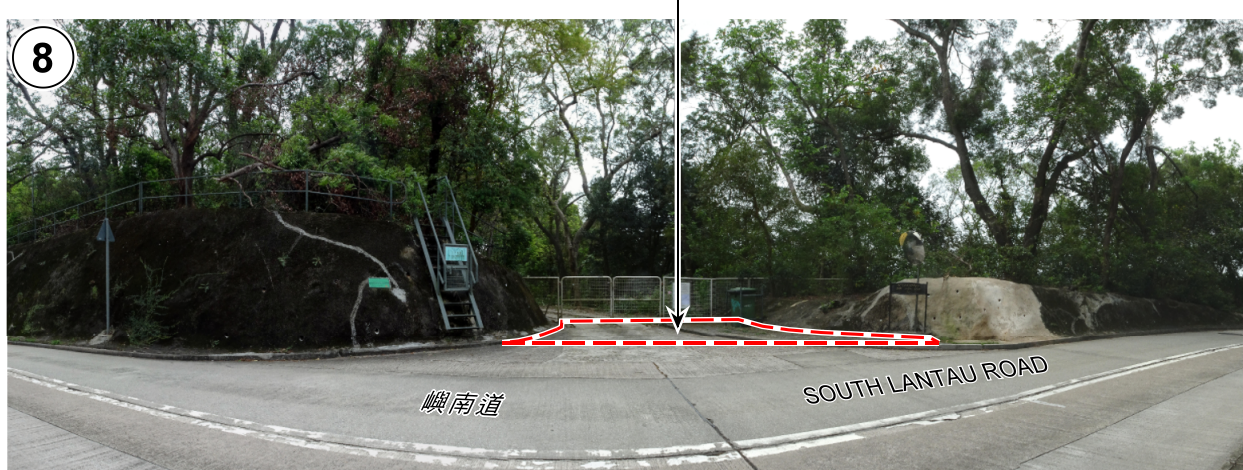

嶼南道

SOUTH LANTAU ROAD

界線只作識別用
BOUNDARY FOR IDENTIFICATION PURPOSE ONLY

實地照片 SITE PHOTOS

擬議公用事業設施裝置（污水泵房、地下污水渠及地下排放管道）及挖土工程以作地下污水渠（約1.5米至4米深）
大嶼山貝澳丈量約份第316約地段第2760號及
沿芝麻灣道（貝澳及鹹田）和位於礮石灣近嶼南道的政府土地
PROPOSED PUBLIC UTILITY INSTALLATION (SEWAGE PUMPING STATION, UNDERGROUND SEWERS AND UNDERGROUND EFFLUENT PIPE) AND EXCAVATION OF LAND FOR UNDERGROUND SEWERS (ABOUT 1.5M TO 4M IN DEPTH) LOT 2760 IN D.D. 316L, PUI O AND GOVERNMENT LAND ALONG CHI MA WAN ROAD (PUI O AND HAM TIN) AND NEAR SOUTH LANTAU ROAD AT SAN SHEK WAN, LANTAU ISLAND

規劃署
PLANNING
DEPARTMENT



參考編號
REFERENCE No.
A/SLC/154

圖 PLAN
A - 6

本摘要圖於2019年4月18日擬備，
所根據的資料為攝於
2019年3月26日的實地照片
PLAN PREPARED ON 18.4.2019
BASED ON SITE PHOTOS
TAKEN ON 26.3.2019