

# LOCATION PLAN

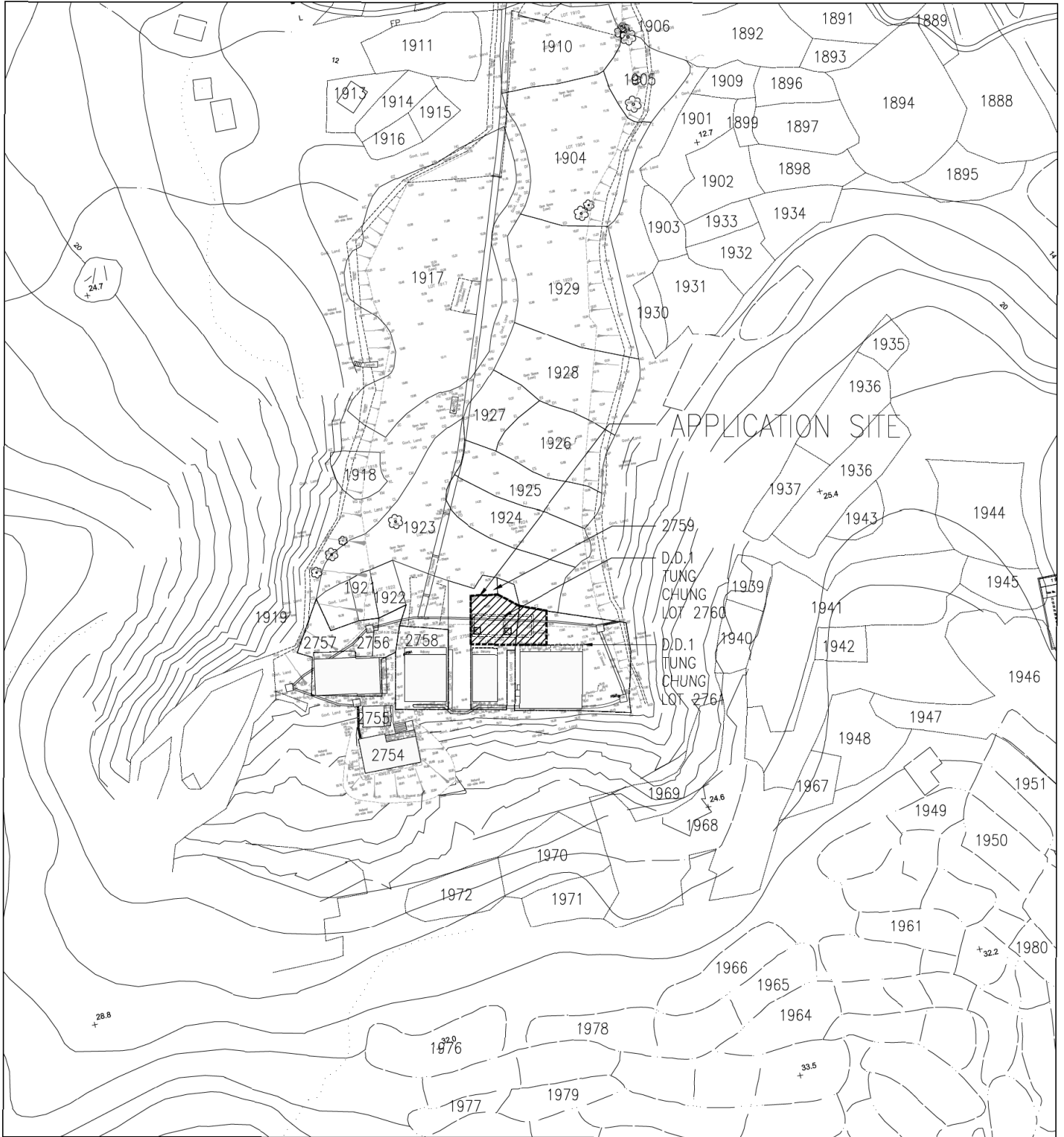

1:1000 @ A4

(來源：申請人於2020年10月12日提交)  
(SOURCE : SUBMITTED BY APPLICANT ON 12.10.2020)

參考編號  
REFERENCE No.

A/I-TCV/16

繪圖

DRAWING  
A - 1

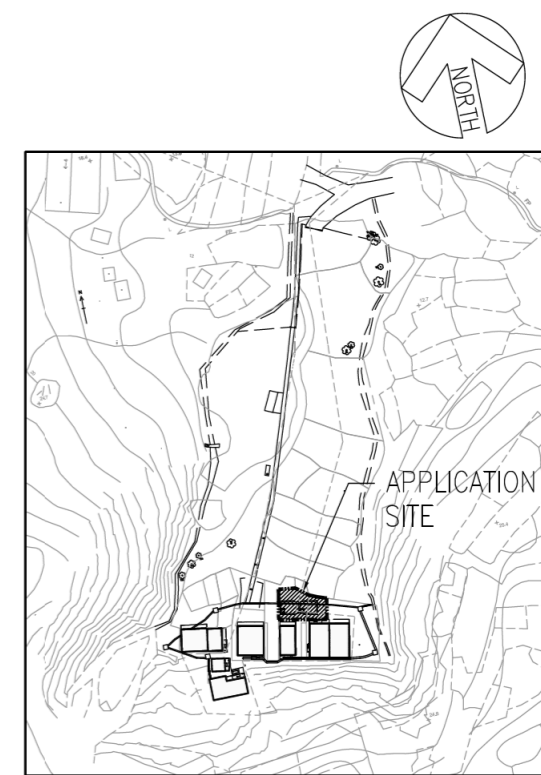
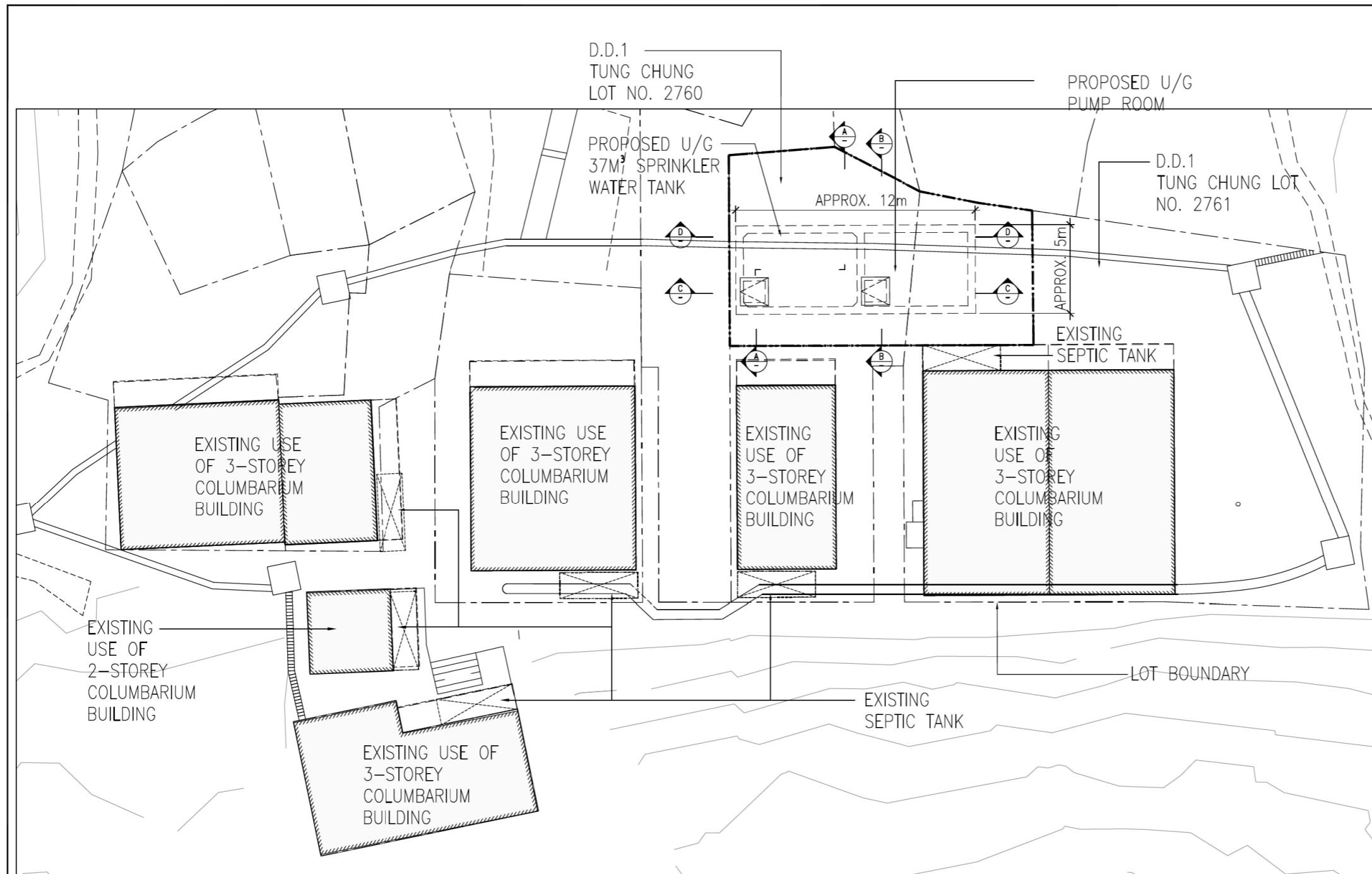

**BLOCK PLAN**  
1:2000@A3

LEGEND:  
 - - - - - LOT BOUNDARY  
 - · - · - · APPLICATION BOUNDARY (FOR INDICATIVE ONLY)

**LAYOUT PLAN**  
1:200@A3

**PROPOSED UNDERGROUND WATER TANK AND PUMP ROOM FOR FIRE SERVICES INSTALLATION AT 1 NIM YUEN VILLAGE, TUNG CHUNG, LANTAU ISLAND, D.D.1, TUNG CHUNG LOT NOS. 2760 & 2761**



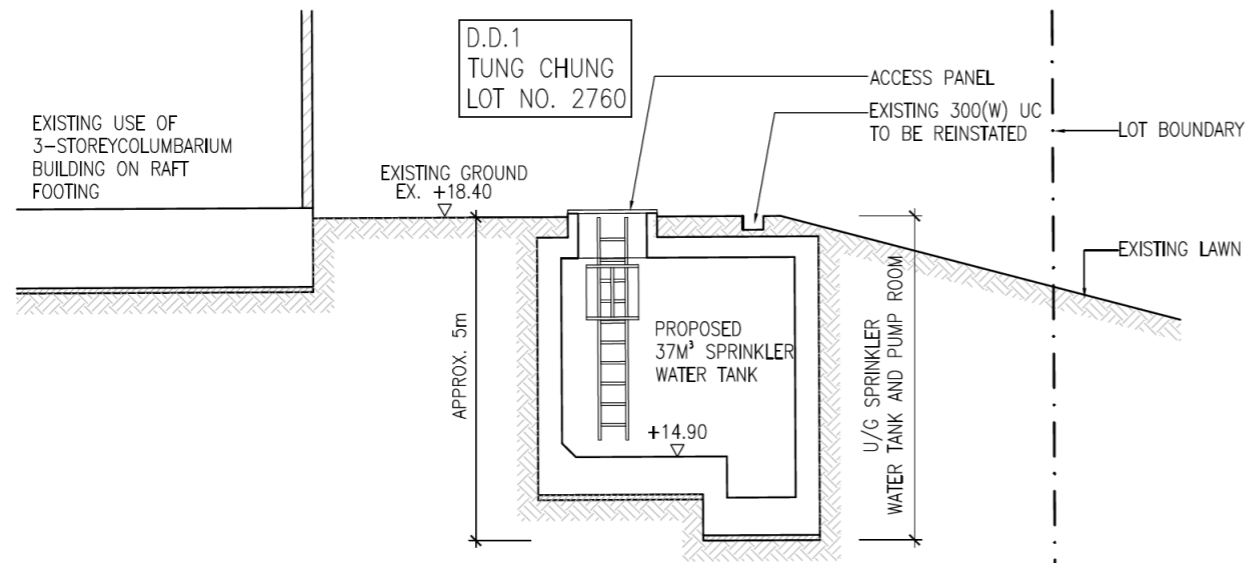

**SECTION A-A**  
1:100@A3

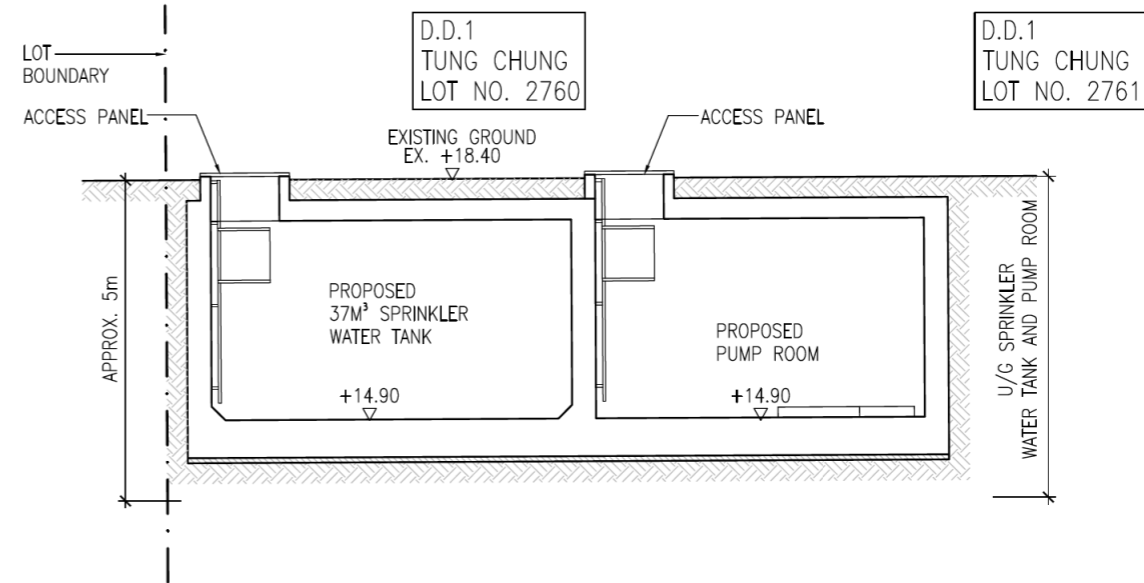

**SECTION C-C**  
1:100@A3

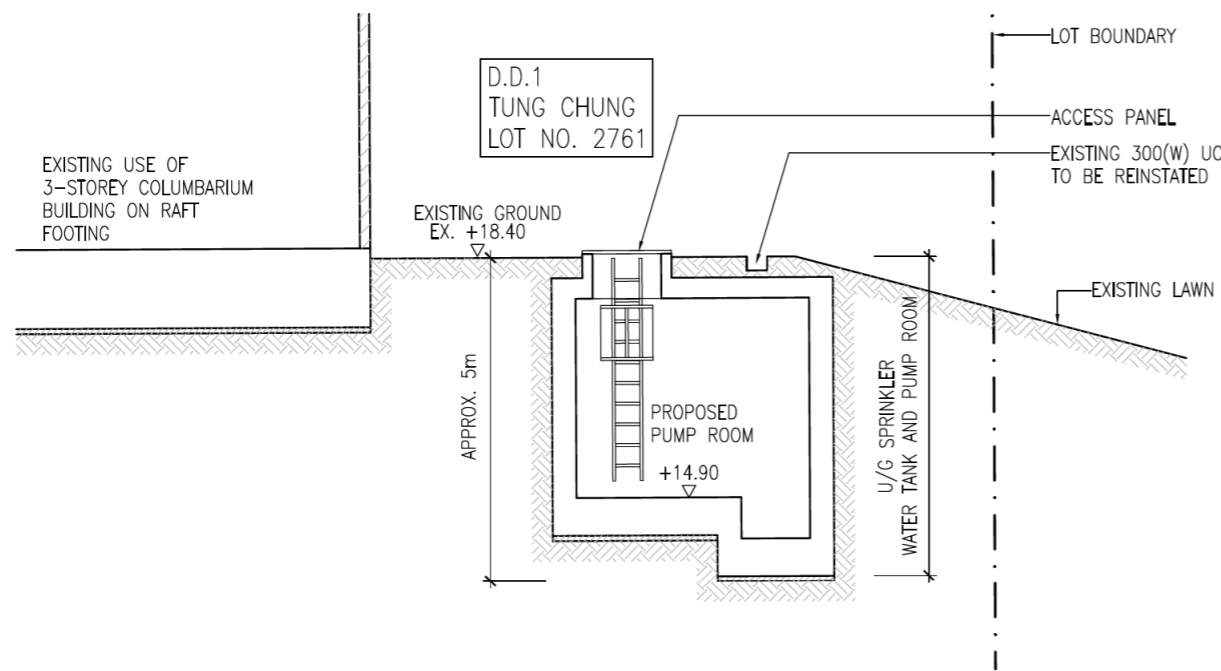

**SECTION B-B**  
1:100@A3

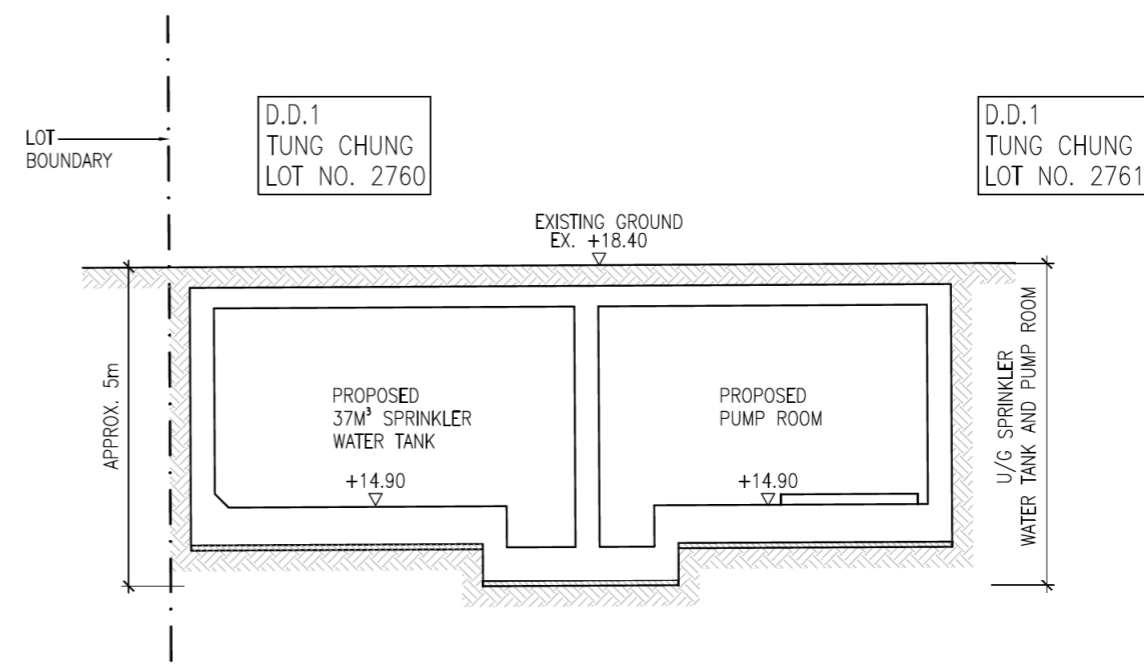

**SECTION D-D**  
1:100@A3

LEGEND:  
- - - - - LOT BOUNDARY

**PROPOSED UNDERGROUND WATER TANK AND PUMP ROOM FOR FIRE SERVICES INSTALLATION AT 1 NIM YUEN VILLAGE, TUNG CHUNG, LANTAU ISLAND, D.D.1, TUNG CHUNG LOT NOS. 2760 & 2761**



**Spence Robinson Ltd.**  
Architects Project Managers Interior Designers

參考編號  
REFERENCE No.  
**A/I-TCV/16**

繪圖  
**DRAWING**  
**A - 3**

(來源：申請人於2020年10月12日提交)  
(SOURCE : SUBMITTED BY APPLICANT ON 12.10.2020)



UNTRY PARK

藍峯的鄉村範圍  
VILLAGE ENVIRONS  
OF LAM CHE

稔園的鄉村範圍  
VILLAGE ENVIRONS  
OF NIM YUEN

申請地點  
APPLICATION SITE

8 (31.5.19)

圖例 LEGEND

8 (31.5.19) 被拒絕的申請  
REJECTED APPLICATION

8 (31.5.19) 會議日期  
DATE OF MEETING

申請編號  
APPLICATION NUMBER

界線只作識別用  
BOUNDARY FOR IDENTIFICATION PURPOSE ONLY

位置圖 LOCATION PLAN

擬議私人發展計劃的公用設施裝置（地下花灑水缸及泵房）  
大嶼山東涌谷東涌丈量約份第1約  
地段第2760號（部分）及第2761號（部分）  
PROPOSED UTILITY INSTALLATION FOR PRIVATE PROJECT  
(UNDERGROUND SPRINKLER WATER TANK AND PUMP ROOM)  
LOTS 2760 (PART) AND 2761 (PART) IN D.D.1 TC,  
TUNG CHUNG VALLEY, LANTAU ISLAND

本摘要圖於2020年11月27日擬備，  
所根據的資料為於2017年2月7日  
核准的分區計劃大綱圖編號S/I-TCV/2  
EXTRACT PLAN PREPARED ON 27.11.2020  
BASED ON OUTLINE ZONING PLAN No.  
S/I-TCV/2 APPROVED ON 7.2.2017

規劃署  
PLANNING  
DEPARTMENT



參考編號  
REFERENCE No.  
A/I-TCV/16

圖 PLAN  
A - 1

SCALE 1:5 000 比例尺  
METRES 100 0 100 200 METRES

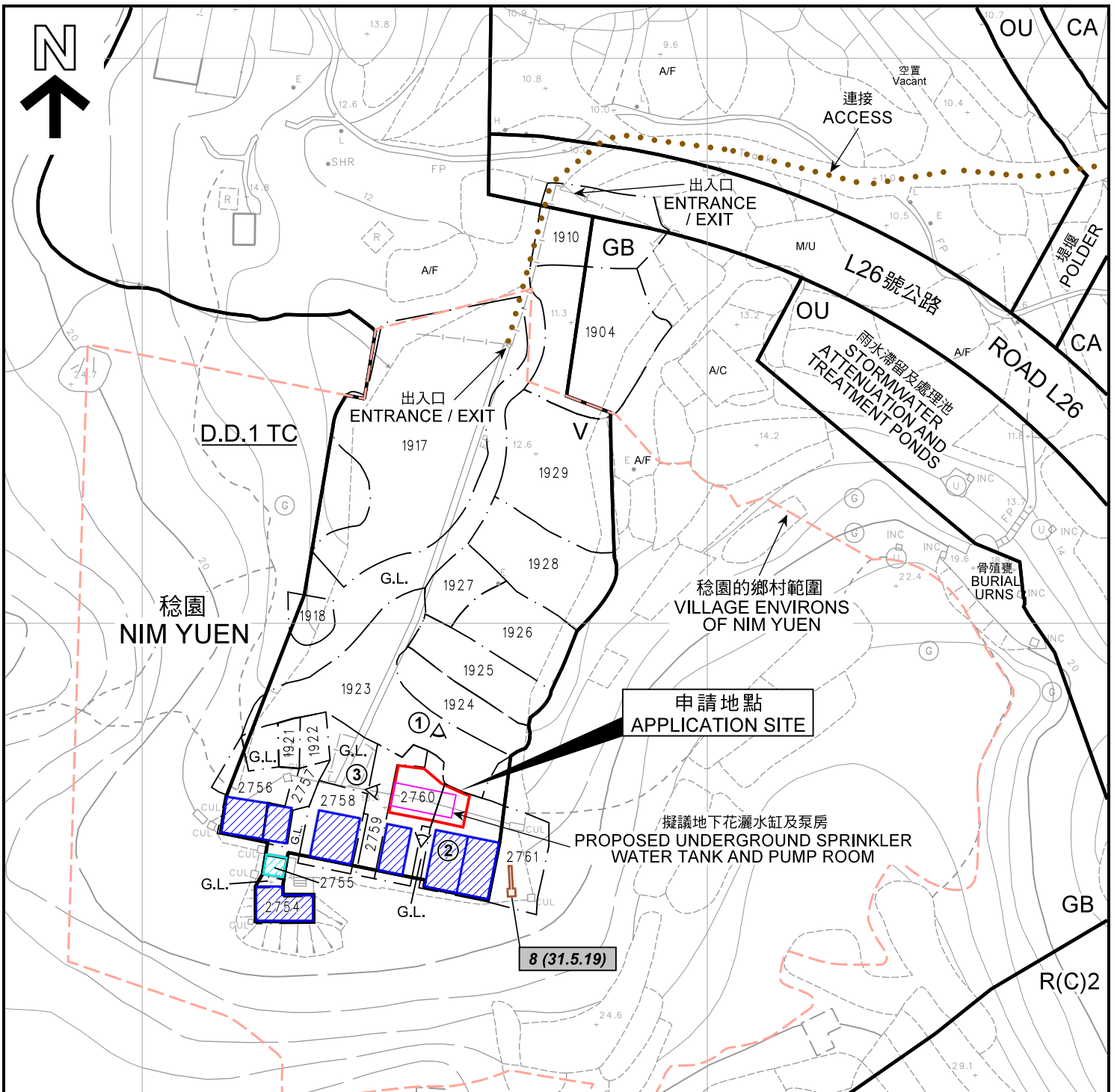

註釋 Notes :

- (1) 2020年10月28日勘測的土地用途  
Land uses shown on this plan are in accordance with land use survey conducted by the Planning Department on 28.10.2020

圖例 LEGEND

8 (31.5.19) 被拒絕的申請  
REJECTED APPLICATION

8 (31.5.19) 會議日期  
DATE OF MEETING  
申請編號  
APPLICATION NUMBER

[ ] 地段界線  
LOT BOUNDARY

① 實地照片的觀景點  
VIEWING POINT OF SITE PHOTO

R(C) 住宅(丙類)  
RESIDENTIAL (GROUP C)

V 鄉村式發展  
VILLAGE TYPE DEVELOPMENT

OU 其他指定用途  
OTHER SPECIFIED USES

GB 綠化地帶  
GREEN BELT

CA 自然保育區  
CONSERVATION AREA

G.L. 政府土地  
GOVERNMENT LAND

A/C 常耕農地  
ACTIVE AGRICULTURAL LAND

A/F 休耕農地  
FALLOW AGRICULTURAL LAND

M/U 荒地  
UNUSED LAND

[Blue hatched] 七幢三層高屬現有用途的構築物  
SEVEN 3-STOREY EU STRUCTURES

[Green hatched] 一幢兩層高屬現有用途的構築物  
ONE 2-STOREY EU STRUCTURE

界線只作識別用  
BOUNDARY FOR IDENTIFICATION PURPOSE ONLY

平面圖 SITE PLAN

擬議私人發展計劃的公用設施裝置(地下花灑水缸及泵房)  
大嶼山東涌谷東涌丈量約份第1約  
地段第2760號(部分)及第2761號(部分)  
PROPOSED UTILITY INSTALLATION FOR PRIVATE PROJECT  
(UNDERGROUND SPRINKLER WATER TANK AND PUMP ROOM)  
LOTS 2760 (PART) AND 2761 (PART) IN D.D.1 TC,  
TUNG CHUNG VALLEY, LANTAU ISLAND

SCALE 1:1 000 比例尺

米 20 0 20 40 米  
METRES

規劃署  
PLANNING  
DEPARTMENT



參考編號  
REFERENCE No.

A/I-TCV/16

圖 PLAN

A - 2

本摘要圖於2020年11月27日擬備，  
所根據的資料為測量圖編號  
9-SE-12B, 12D, 13A和13C  
EXTRACT PLAN PREPARED ON 27.11.2020  
BASED ON SURVEY SHEETS No.  
9-SE-12B, 12D, 13A AND 13C



藍輦  
LAM CHE

L26號公路

R(C)2

ROAD L26

GB

OU

雨水滯留及處理池  
STORMWATER  
ATTENUATION AND  
TREATMENT PONDS

V

骨殖龕  
BURIAL  
URNS

申請地點  
APPLICATION SITE

稔園  
NIM YUEN

R(C)2

界線只作識別用  
BOUNDARY FOR IDENTIFICATION PURPOSE ONLY

### 航攝照片 AERIAL PHOTO

本摘要圖於2020年10月21日擬備，  
所根據的資料為地政總署於2019年11月5日  
拍得的航攝照片編號E075541C

EXTRACT PLAN PREPARED ON 22.5.2019  
BASED ON AERIAL PHOTO No. E075541C  
TAKEN ON 5.11.2019  
BY LANDS DEPARTMENT

擬議私人發展計劃的公用設施裝置（地下花灑水缸及泵房）  
大嶼山東涌谷東涌丈量約份第1約  
地段第2760號（部分）及第2761號（部分）  
PROPOSED UTILITY INSTALLATION FOR PRIVATE PROJECT  
(UNDERGROUND SPRINKLER WATER TANK AND PUMP ROOM)  
LOTS 2760 (PART) AND 2761 (PART) IN D.D.1 TC,  
TUNG CHUNG VALLEY, LANTAU ISLAND

規劃署  
PLANNING  
DEPARTMENT



參考編號  
REFERENCE No.

A/I-TCV/16

圖 PLAN

A - 3

1

靈灰安置所 (現有用途)  
Columbarium (Existing Use)

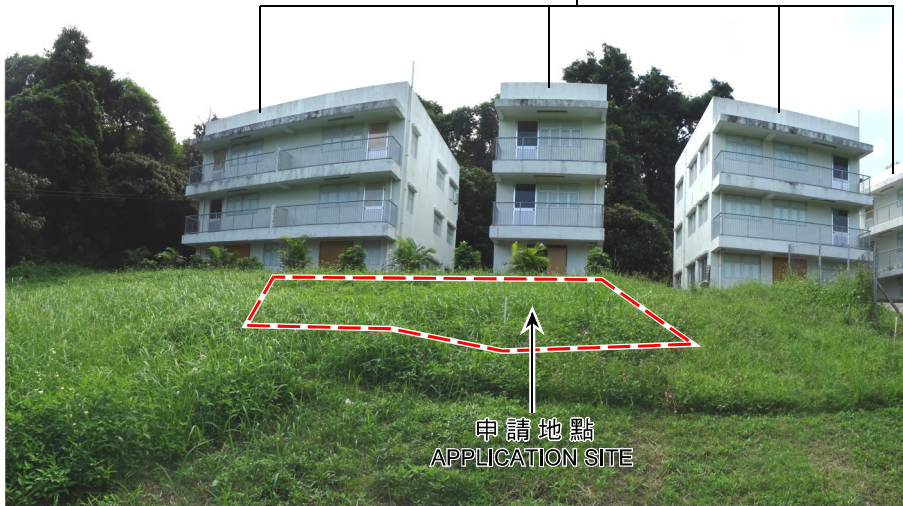

2

申請地點  
APPLICATION SITE

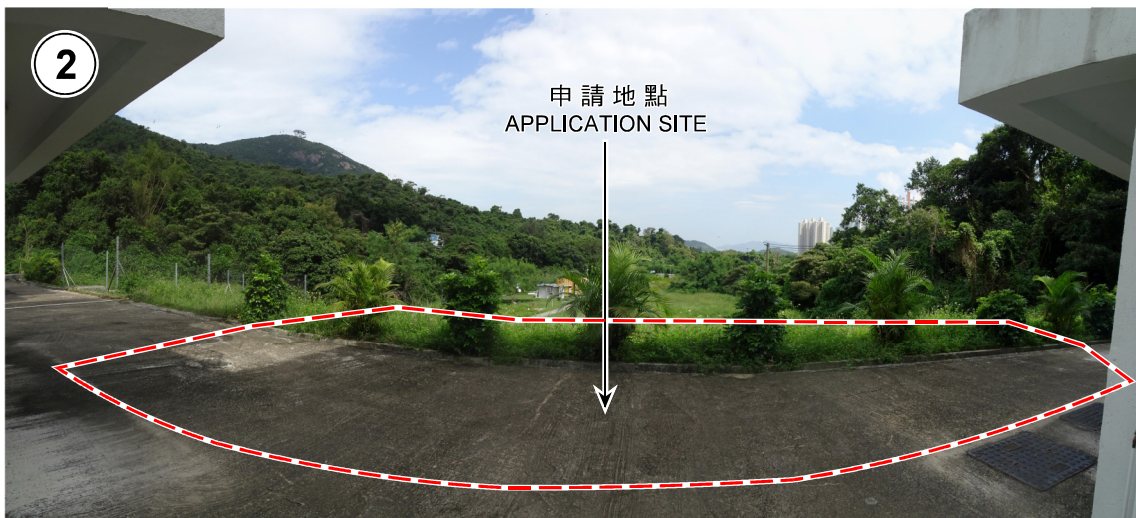

3

申請地點  
APPLICATION SITE



界線只作識別用  
BOUNDARY FOR IDENTIFICATION PURPOSE ONLY

本摘要圖於2020年11月17日擬備，  
所根據的資料為攝於  
2020年10月16日的實地照片  
PLAN PREPARED ON 17.11.2020  
BASED ON SITE PHOTOS  
TAKEN ON 16.10.2020

### 實地照片 SITE PHOTOS

擬議私人發展計劃的公用設施裝置 (地下花灑水缸及泵房)  
大嶼山東涌谷東涌丈量約份第1約  
地段第2760號(部分)及第2761號(部分)  
PROPOSED UTILITY INSTALLATION FOR PRIVATE PROJECT  
(UNDERGROUND SPRINKLER WATER TANK AND PUMP ROOM)  
LOTS 2760 (PART) AND 2761 (PART) IN D.D.1 TC,  
TUNG CHUNG VALLEY, LANTAU ISLAND

規劃署  
PLANNING  
DEPARTMENT



參考編號  
REFERENCE No.  
A/I-TCV/16

圖 PLAN  
A - 4