

**PROPOSED SMALL HOUSE**  
**LOT No. 1533 S.A IN D.D. 76**

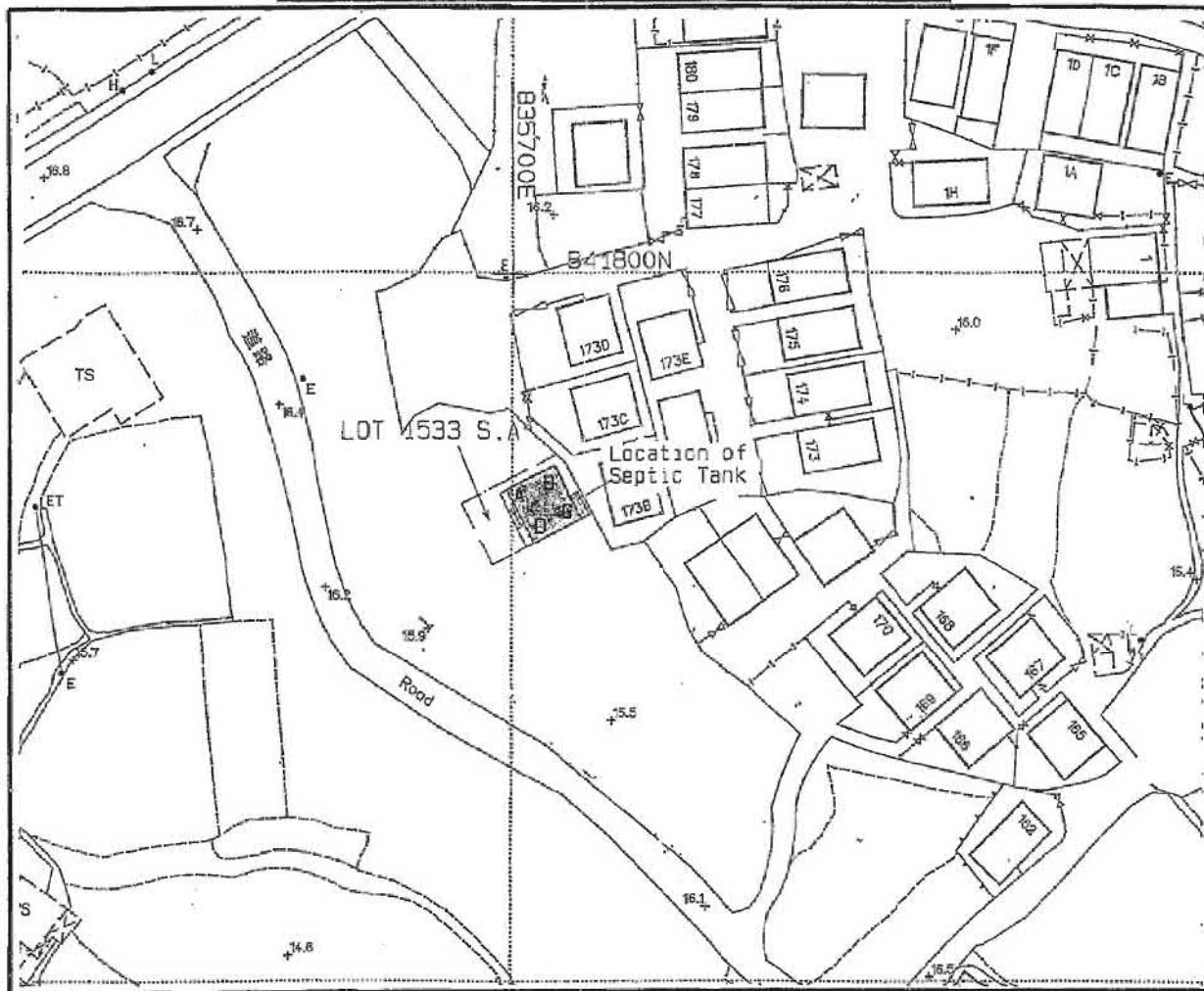

LOCATION PLAN



SCALE 1 : 20 000

- Balcony
- Position of Septic Tank

Coloured Pink Area = 65.03 sq.m. (About)

SIDE	DISTANCE	BEARING	NORTHING	EASTING	PT.
A-B	7.620	62° 40' 11"	841769.451	835699.105	A
B-C	8.534	152° 40' 11"	841772.950	835705.874	B
C-D	7.620	242° 40' 11"	841765.368	835709.793	C
D-A	8.534	332° 40' 11"	841761.870	835703.023	D



I, .....TANG SZE KIN..... an Authorized Land Surveyor registered under the Land Survey Ordinance (Cap.473), hereby certify that this land boundary plan has been prepared from land boundary surveys that were carried out by me, or under my direct supervision, in conformity with the Code of Practice approved by the Land Survey Authority under the above Ordinance, and that this plan correctly represents that survey completed on the ..3rd.. day of ..February.. 2012..

Dated this ..2nd.. day of ..April.. 2012..

Authorized Land Surveyor

Survey District : North	Survey Sheet No. : 3-SW-4B
Ref SRP's : SRP/DN/047/8933/D1	Scale 1 : 1000
Plan No. : DN/047/8933A/76/1533A-SH	
<b>TANG &amp; ASSOCIATES SURVEYORS LTD</b>	



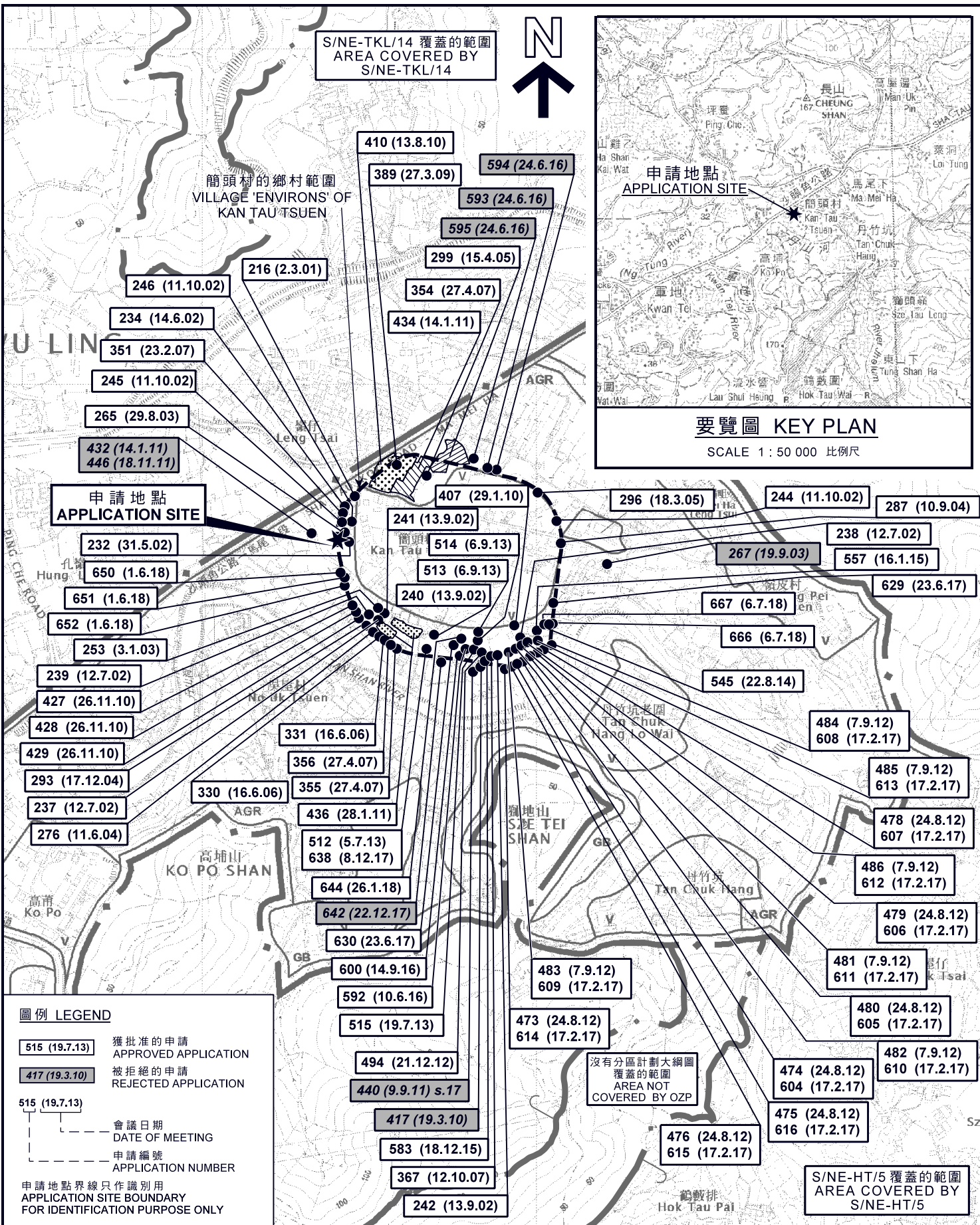

位置圖 LOCATION PLAN

擬議屋宇 (新界豁免管制屋宇-小型屋宇)  
新界粉嶺簡頭村丈量約份第76約地段第1533號A分段  
PROPOSED HOUSE  
(NEW TERRITORIES EXEMPTED HOUSE - SMALL HOUSE)  
LOT 1533 S.A IN D.D. 76, KAN TAU TSUEN,  
FANLING, N.T.

SCALE 1 : 7 500 比例尺  
米 100 0 100 200 300 米  
METRES

規劃署  
PLANNING  
DEPARTMENT







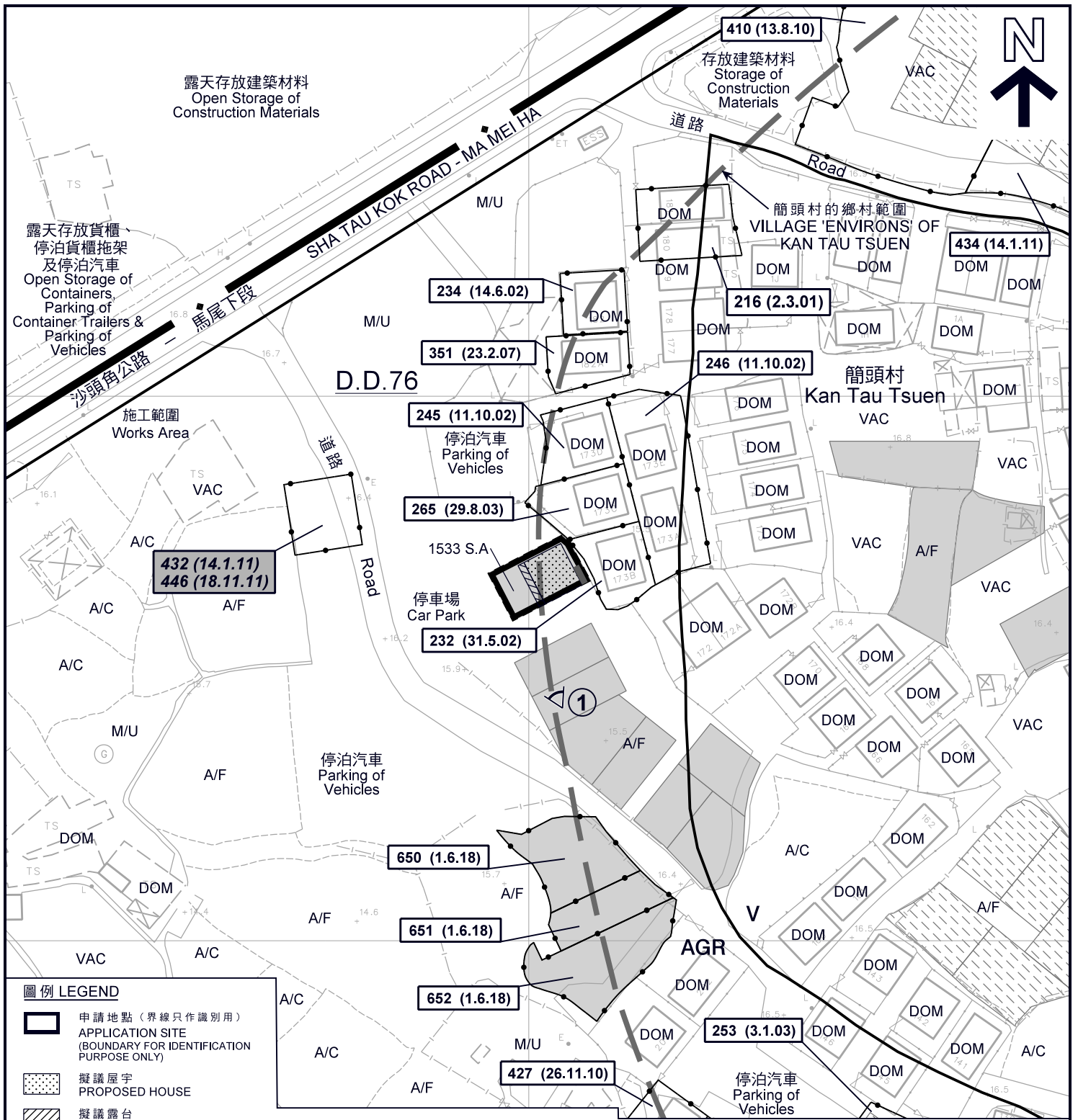

參考編號  
REFERENCE No.  
A/NE-LYT/670

圖 PLAN  
A-1





本摘要圖於2018年7月4日擬備，  
所根據的資料為於2016年2月2日核准的  
分區計劃大綱圖編號S/NE-LYT/17  
EXTRACT PLAN PREPARED ON 4.7.2018  
BASED ON OUTLINE ZONING PLAN  
No. S/NE-LYT/17 APPROVED ON 2.2.2016

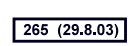

**圖例 LEGEND**

-  申請地點 (界線只作識別用)  
APPLICATION SITE (BOUNDARY FOR IDENTIFICATION PURPOSE ONLY)
-  擬議屋宇  
PROPOSED HOUSE
-  擬議露台  
PROPOSED BALCONY
-  正在處理中的小型屋宇批地申請 (私人土地)  
SMALL HOUSE GRANT APPLICATION BEING PROCESSED (PRIVATE LAND)
-  獲批的小型屋宇批地申請  
APPROVED SMALL HOUSE GRANT APPLICATION
- AGR** 農業  
AGRICULTURE
- V** 鄉村式發展  
VILLAGE TYPE DEVELOPMENT
-  實地照片的觀景點  
VIEWING POINT OF SITE PHOTO

- A/C 常耕農地  
ACTIVE AGRICULTURAL LAND
- A/F 休耕農地  
FALLOW AGRICULTURAL LAND
- DOM 住用構築物  
DOMESTIC STRUCTURE
- M/U 荒地  
UNUSED LAND
- VAC 空置  
VACANT
-  化糞池  
SEPTIC TANK

-  265 (29.8.03) 獲批准的申請  
APPROVED APPLICATION
-  432 (14.1.11) 被拒絕的申請  
REJECTED APPLICATION
-  265 (29.8.03) 會議日期  
DATE OF MEETING
-  申請編號  
APPLICATION NUMBER

**註釋 Notes:**  
(1) 2018年6月22日勘測的土地用途  
Land uses shown on this plan are in accordance with the land use survey conducted by the Planning Department on 22.6.2018

**平面圖 SITE PLAN**

擬議屋宇 (新界豁免管制屋宇 - 小型屋宇)  
新界粉嶺簡頭村丈量約份第76約地段第1533號A分段  
PROPOSED HOUSE  
(NEW TERRITORIES EXEMPTED HOUSE - SMALL HOUSE)  
LOT 1533 S.A IN D.D. 76, KAN TAU TSUEN,  
FANLING, N.T.

本摘要圖於2018年7月9日擬備，  
所根據的資料為測量圖編號  
3-SW-4B  
EXTRACT PLAN PREPARED ON 9.7.2018  
BASED ON SURVEY SHEET No.  
3-SW-4B



**規劃署**  
**PLANNING**  
**DEPARTMENT**



參考編號  
REFERENCE No.  
**A/NE-LYT/670**

**圖 PLAN**  
**A-2a**





S/NE-TKL/14 覆蓋的範圍  
AREA COVERED BY  
S/NE-TKL/14

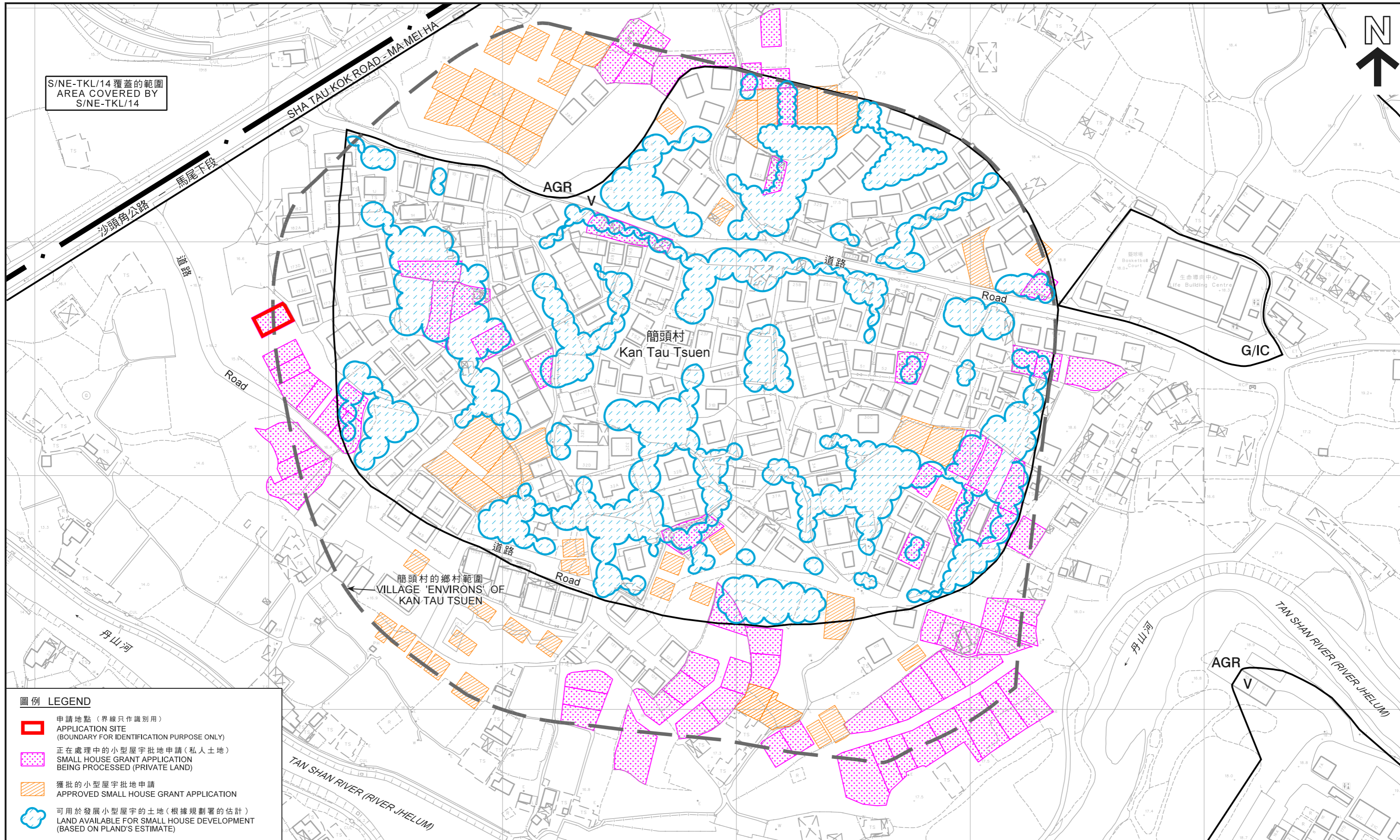

圖例 LEGEND

-  申請地點 (界線只作識別用)  
APPLICATION SITE  
(BOUNDARY FOR IDENTIFICATION PURPOSE ONLY)
-  正在處理中的小型屋宇批地申請 (私人土地)  
SMALL HOUSE GRANT APPLICATION  
BEING PROCESSED (PRIVATE LAND)
-  獲批的小型屋宇批地申請  
APPROVED SMALL HOUSE GRANT APPLICATION
-  可用於發展小型屋宇的土地 (根據規劃署的估計)  
LAND AVAILABLE FOR SMALL HOUSE DEVELOPMENT  
(BASED ON PLAND'S ESTIMATE)

在「鄉村式發展」地帶內預計可供發展小型屋宇的土地數量  
ESTIMATED AMOUNT OF LAND AVAILABLE FOR  
SMALL HOUSE DEVELOPMENT WITHIN THE "V" ZONE

擬議屋宇 (新界豁免管制屋宇 - 小型屋宇)  
新界粉嶺簡頭村丈量約份第76約地段第1533號A分段  
PROPOSED HOUSE  
(NEW TERRORIES EXEMPTED HOUSE - SMALL HOUSE)  
LOT 1533 S.A IN D.D. 76, KAN TAU TSUEN, FANLING, N.T.

本摘要圖於2018年7月9日擬備，  
所根據的資料為測量圖編號  
3-SW-4B 及 5A  
EXTRACT PLAN PREPARED ON 9.7.2018  
BASED ON SURVEY SHEETS No. 3-SW-4B & 5A

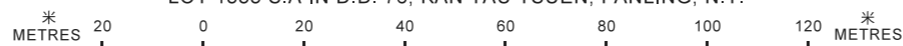

規劃署  
PLANNING  
DEPARTMENT



參考編號  
REFERENCE No.  
A/NE-LYT/670

圖 PLAN  
A-2b



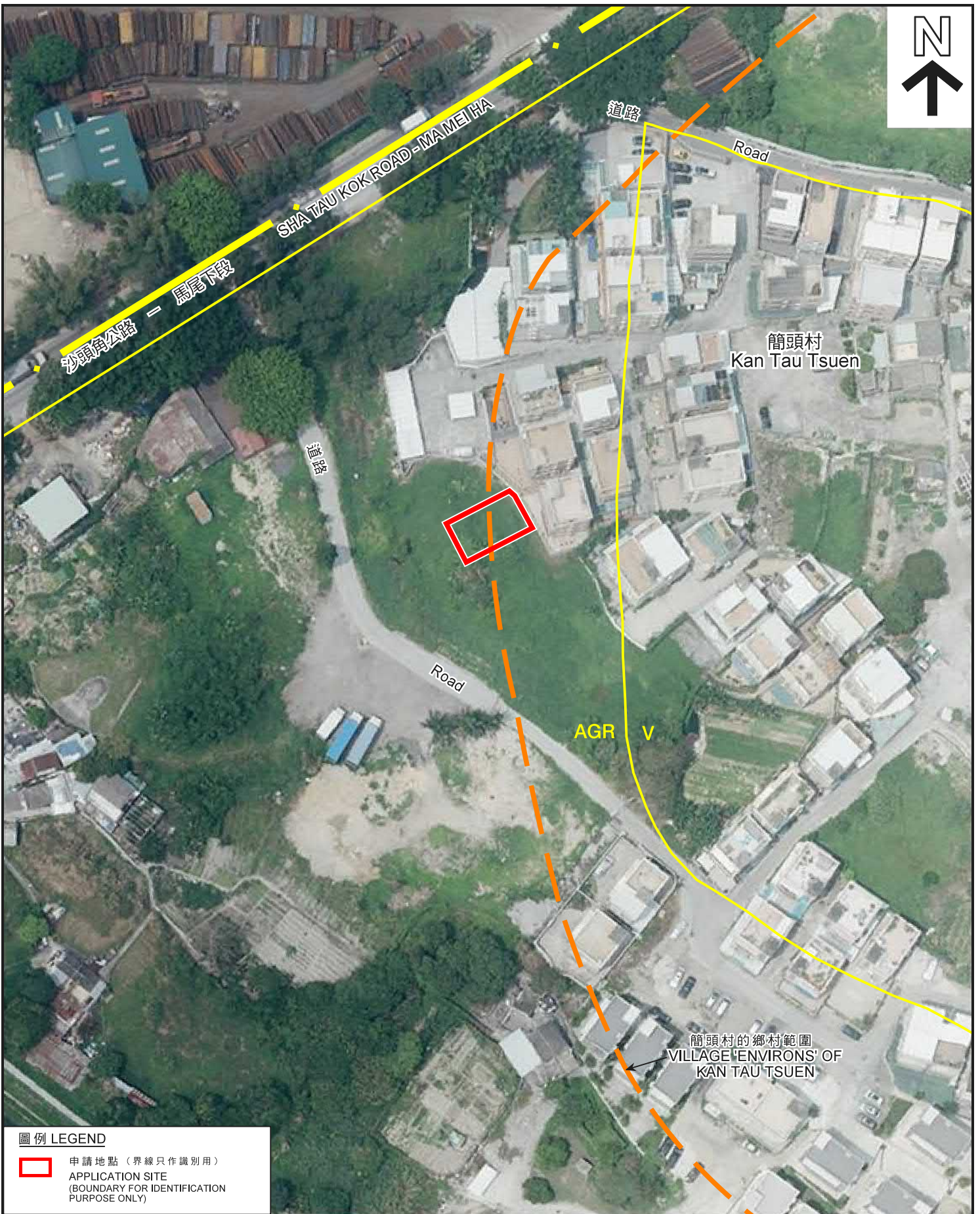

圖例 LEGEND

-  申請地點 (界線只作識別用)  
APPLICATION SITE  
(BOUNDARY FOR IDENTIFICATION  
PURPOSE ONLY)

本摘要圖於2018年7月4日擬備，  
所根據的資料為地政總署  
於2017年4月18日拍得的航攝照片  
編號E022599C  
EXTRACT PLAN PREPARED ON 4.7.2018  
BASED ON AERIAL PHOTO No. E022599C  
TAKEN ON 18.4.2017 BY  
LANDS DEPARTMENT

航攝照片 AERIAL PHOTO

擬議屋宇 (新界豁免管制屋宇 - 小型屋宇)  
新界粉嶺簡頭村丈量約份第76約地段第1533號A分段  
PROPOSED HOUSE  
(NEW TERRITORIES EXEMPTED HOUSE - SMALL HOUSE)  
LOT 1533 S.A IN D.D. 76, KAN TAU TSUEN,  
FANLING, N.T.

規劃署  
PLANNING  
DEPARTMENT



參考編號  
REFERENCE No.  
A/NE-LYT/670

圖 PLAN  
A-3





申請地點界線只作識別用  
APPLICATION SITE BOUNDARY FOR IDENTIFICATION PURPOSE ONLY

實地照片 SITE PHOTO

擬議屋宇 (新界豁免管制屋宇 - 小型屋宇)  
新界粉嶺簡頭村丈量約份第76約地段第1533號A分段  
PROPOSED HOUSE  
(NEW TERRITORIES EXEMPTED HOUSE - SMALL HOUSE)  
LOT 1533 S.A IN D.D. 76, KAN TAU TSUEN,  
FANLING, N.T.

規劃署  
PLANNING  
DEPARTMENT



本圖於2018年7月4日擬備，所根據  
的資料為攝於2018年6月11日  
的實地照片  
PLAN PREPARED ON 4.7.2018 BASED ON  
SITE PHOTO TAKEN ON 11.6.2018

參考編號  
REFERENCE No.  
A/NE-LYT/670

圖 PLAN  
A-4