

PROPOSED SMALL HOUSE
GOVERNMENT LAND ON D.D. 177

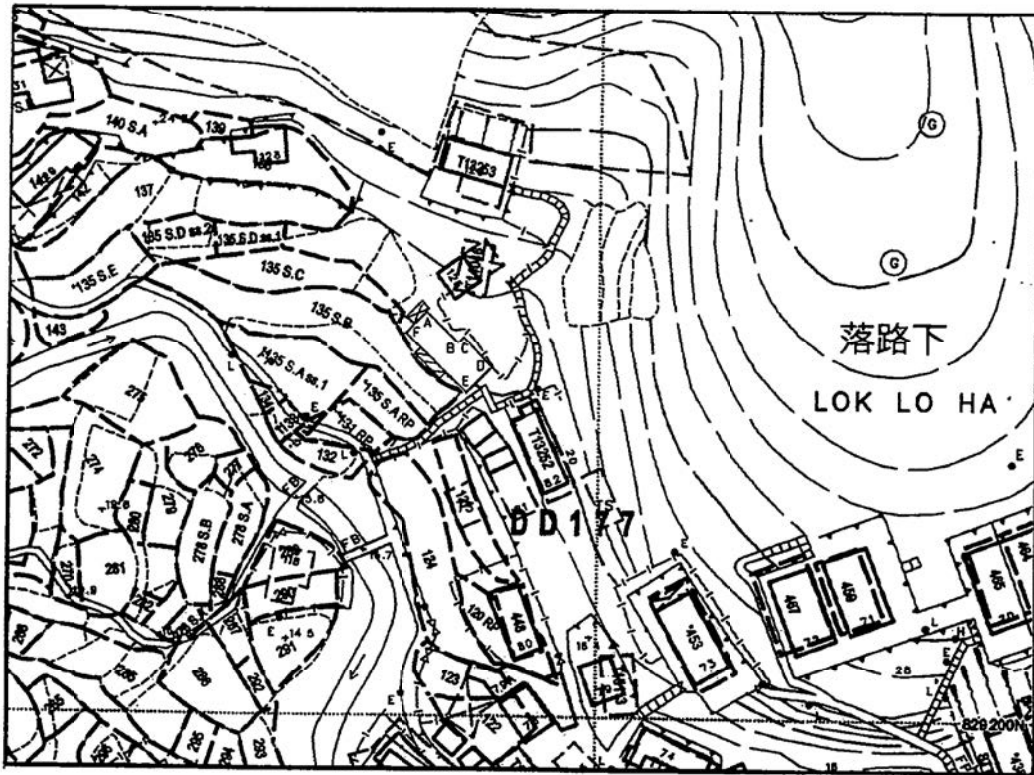

SCALE 1 : 1000

Height of 3-storey small house : 8.230m

- Proposed balcony (dimension: 5.000 X 1.220)
- Proposed location of septic tank & soakage pit
- Area of proposed small house : 56.8 sq.m. (about)

Side	Bearing	Distance	Northing	Easting	Point
A-B	135° 24' 50"	6.200	829256.704	838675.667	A
B-C	45° 24' 50"	1.100	829252.288	838680.019	B
C-D	135° 24' 50"	5.800	829253.061	838680.803	C
D-E	225° 24' 50"	5.300	829248.930	838684.874	D
E-F	315° 24' 50"	12.000	829245.209	838681.100	E
F-A	45° 24' 50"	4.000	829253.756	838672.676	F

Survey District: Sha Tin	Survey Sheet No.: 7-SE-10	Rocky Fung Surveying Company P.O.Box 406, Fanling Post Office, N.T. Tel.: 67570416 Fax.: 26463803
Ref. Plan: ---	Plan No.: ST/177/GL-PSH1	Plan Approved by: LAU CHI KWONG AUTHORIZED LAND SURVEYOR
Ref. SRP No.: ---	Date: 4 Dec 2013	

參考編號 REFERENCE No. A/ST/956 繪圖 DRAWING A-1

(來源: 申請人於2018年4月27日呈交的規劃申請表內的繪圖)
(SOURCE: DRAWING IN THE APPLICANT'S SUBMITTED APPLICATION FORM ON 27.4.2018)

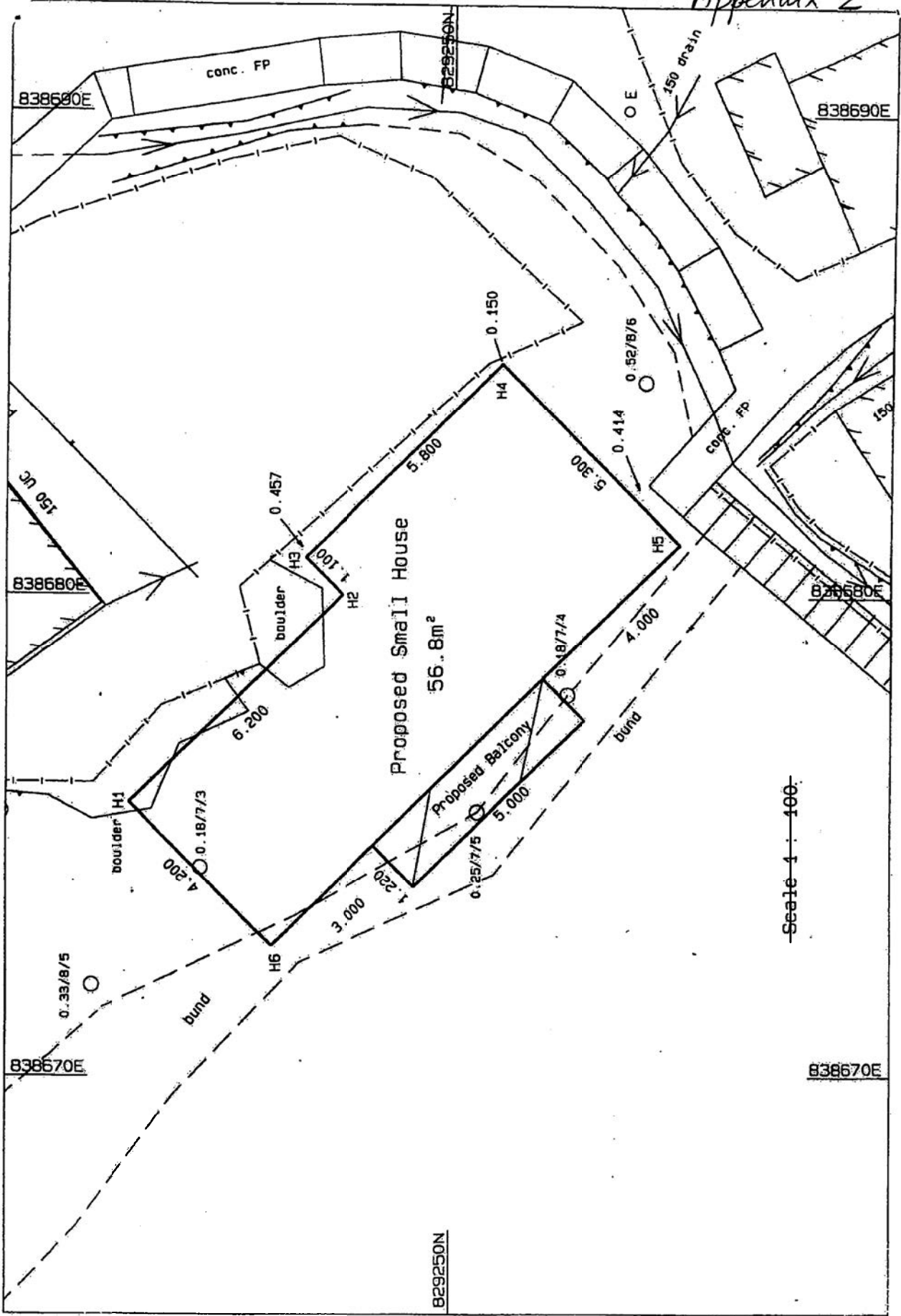

參考編號 REFERENCE No.	A/ST/956	繪圖 DRAWING A-2
-----------------------	----------	----------------

(來源：申請人於2018年4月27日呈交的規劃申請表內的繪圖)
(SOURCE : DRAWING IN THE APPLICANT'S SUBMITTED APPLICATION FORM ON 27.4.2018)

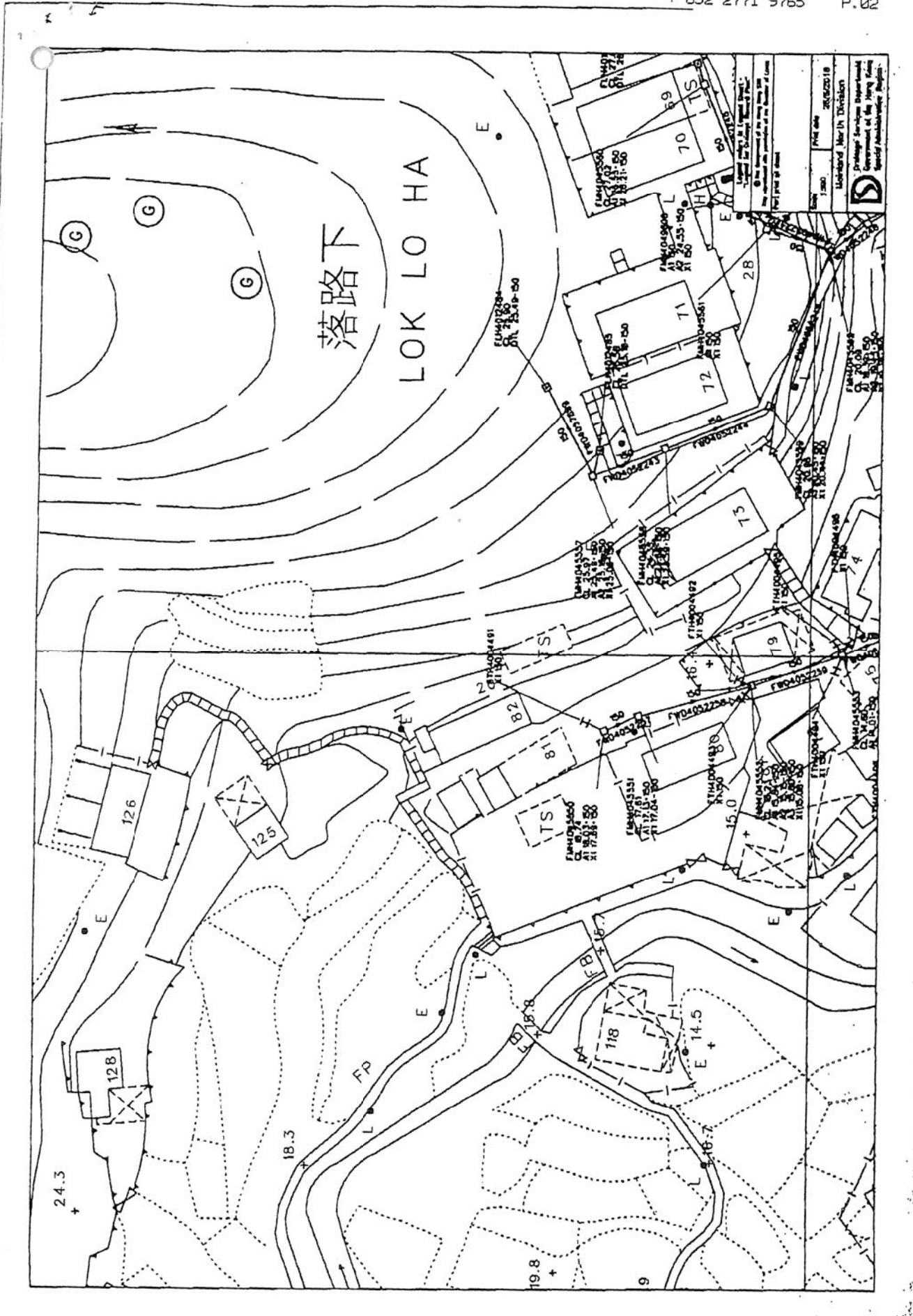

參考編號

REFERENCE No.

A/ST/956

繪圖 DRAWING A-3

(來源: 申請人於2018年4月27日呈交的規劃申請表內的繪圖)
(SOURCE: DRAWING IN THE APPLICANT'S SUBMITTED APPLICATION FORM ON 27.4.2018)

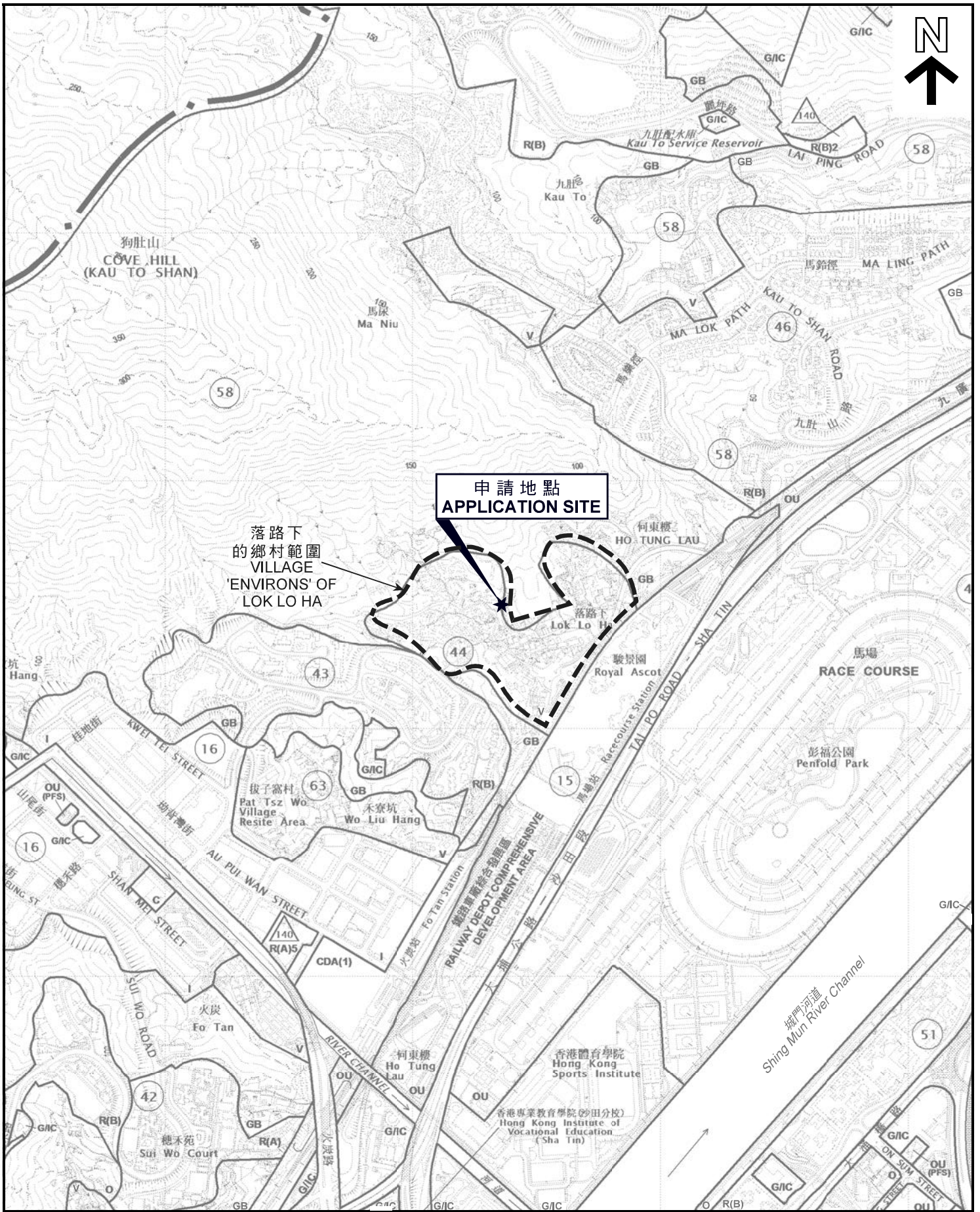

申請地點
APPLICATION SITE

落路下的
鄉村範圍
VILLAGE
'ENVIRONS' OF
LOK LO HA

位置圖 LOCATION PLAN

擬議屋宇(新界豁免管制屋宇-小型屋宇)
新界沙田落路下丈量約份第177約政府土地
PROPOSED HOUSE
(NEW TERRORIES EXEMPTED HOUSE - SMALL HOUSE)
GOVERNMENT LAND IN D.D.177, LOK LO HA, SHA TIN, N.T.

規劃署
PLANNING
DEPARTMENT



參考編號
REFERENCE No.
A/ST/956





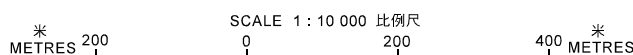

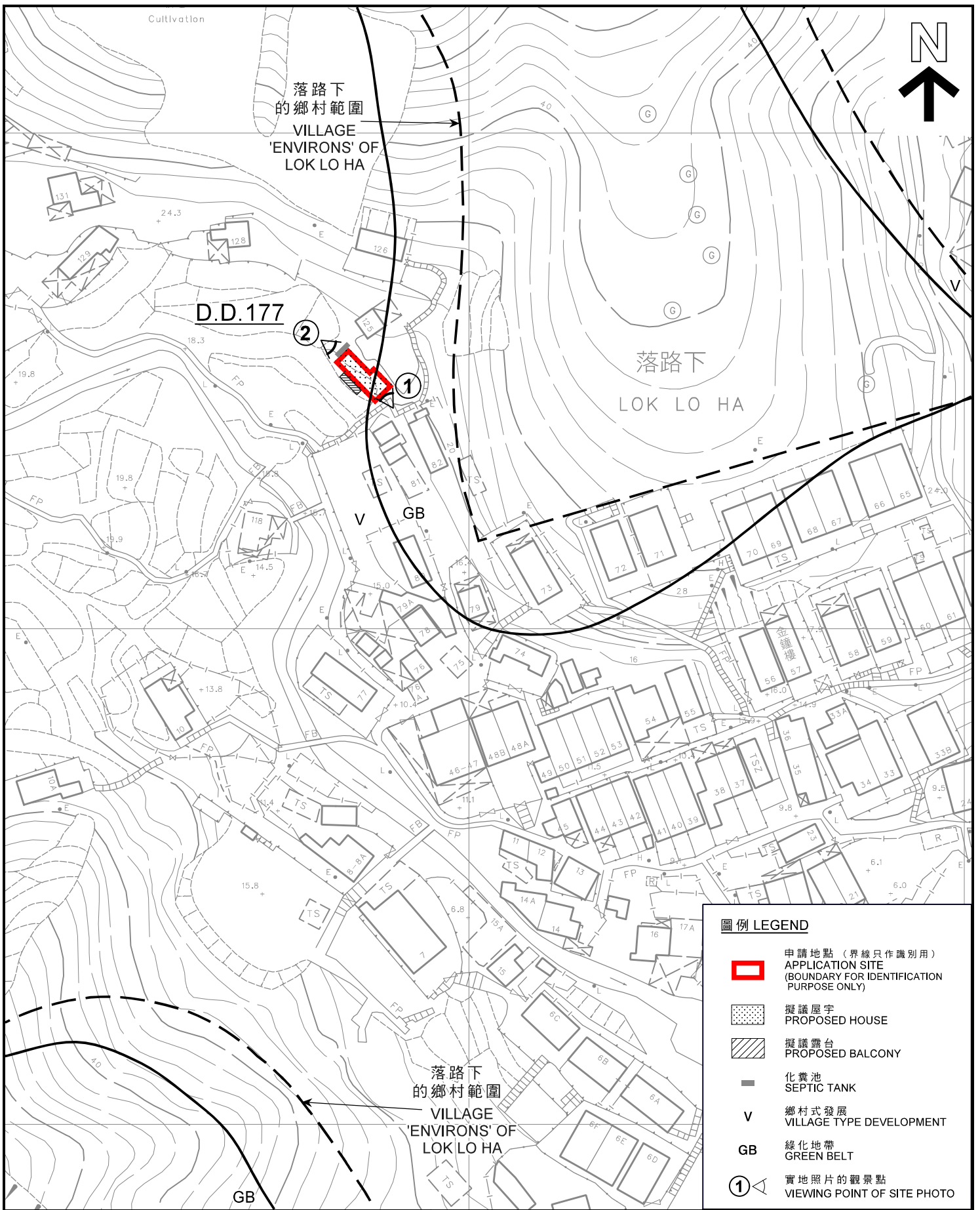
圖 PLAN
A-1

本摘要圖於2018年6月8日擬備，
所根據的資料為於2018年5月29日
核准的分區計劃大綱圖編號S/ST/34
EXTRACT PLAN PREPARED ON 8.6.2018
BASED ON OUTLINE ZONING PLAN No.
S/ST/34 APPROVED ON 29.5.2018





圖例 LEGEND

-  申請地點 (界線只作識別用)
APPLICATION SITE (BOUNDARY FOR IDENTIFICATION PURPOSE ONLY)
-  擬議屋宇
PROPOSED HOUSE
-  擬議露台
PROPOSED BALCONY
-  化糞池
SEPTIC TANK
-  鄉村式發展
VILLAGE TYPE DEVELOPMENT
-  綠化地帶
GREEN BELT
-  實地照片的觀景點
VIEWING POINT OF SITE PHOTO

平面圖 SITE PLAN

擬議屋宇 (新界豁免管制屋宇-小型屋宇)
 新界沙田落路下丈量約份第177約政府土地
 PROPOSED HOUSE
 (NEW TERRITORIES EXEMPTED HOUSE - SMALL HOUSE)
 GOVERNMENT LAND IN D.D.177, LOK LO HA, SHA TIN, N.T.

SCALE 1:1 000 比例尺

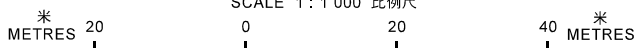

本圖於2018年5月9日擬備，
 所根據的資料為測量圖編號
 7-SE-1D
 PLAN PREPARED ON 9.5.2018
 BASED ON SURVEY SHEET No.
 7-NE-1D

規劃署
 PLANNING
 DEPARTMENT





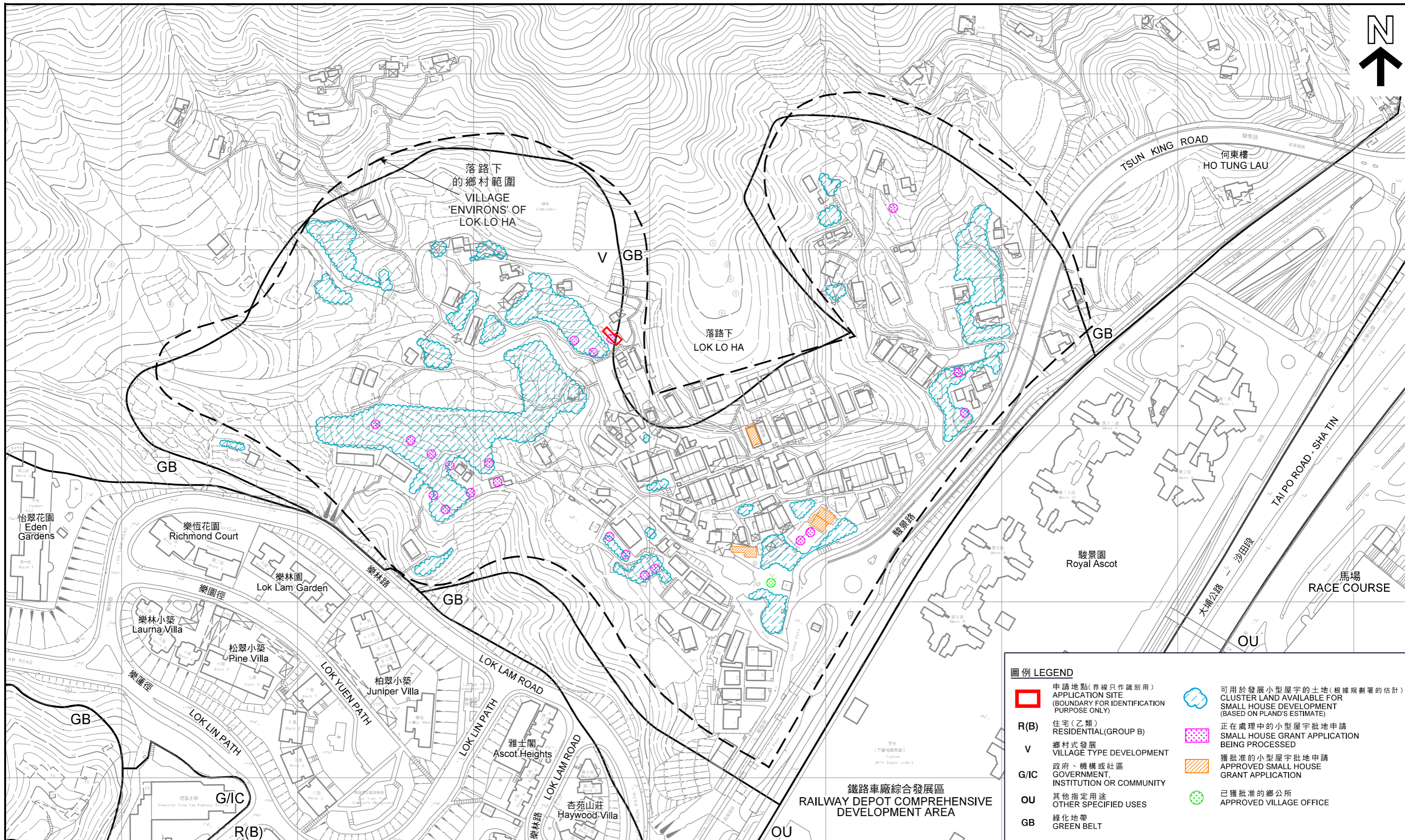

參考編號
 REFERENCE No.
 A/ST/956

圖 PLAN
 A-2a



圖例 LEGEND

- | | | | |
|---|--|---|--|
|  | 申請地點(界線只作識別用)
APPLICATION SITE
(BOUNDARY FOR IDENTIFICATION
PURPOSE ONLY) |  | 可用於發展小型屋宇的土地(根據規劃署的估計)
CLUSTER LAND AVAILABLE FOR
SMALL HOUSE DEVELOPMENT
(BASED ON PLAND'S ESTIMATE) |
| R(B) | 住宅(乙類)
RESIDENTIAL(GROUP B) |  | 正在處理中的小型屋宇批地申請
SMALL HOUSE GRANT APPLICATION
BEING PROCESSED |
| V | 鄉村式發展
VILLAGE TYPE DEVELOPMENT |  | 獲批准的小型屋宇批地申請
APPROVED SMALL HOUSE
GRANT APPLICATION |
| G/IC | 政府、機構或社區
GOVERNMENT,
INSTITUTION OR COMMUNITY |  | 已獲批准的鄉公所
APPROVED VILLAGE OFFICE |
| OU | 其他指定用途
OTHER SPECIFIED USES | | |
| GB | 綠化地帶
GREEN BELT | | |

平面圖 SITE PLAN

擬議屋宇(新界豁免管制屋宇-小型屋宇)
新界沙田落路下丈量約份第177約政府土地
PROPOSED HOUSE
(NEW TERRITORIES EXEMPTED HOUSE - SMALL HOUSE)
GOVERNMENT LAND IN D.D.177, LOK LO HA, SHA TIN, N.T.

本摘要圖於2018年6月8日擬備，
所根據的資料為測量圖編號
7-SE-1B、7-SE-1D、7-SE-2A及7-SE-2C。
EXTRACT PLAN PREPARED ON 8.6.2018
BASED ON SURVEY SHEETS No.
7-SE-1B, 7-SE-1D, 7-SE-2A AND 7-SE-2C.

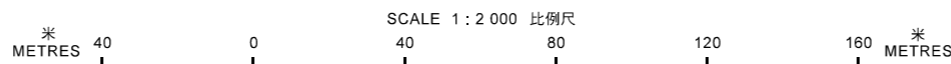

規劃署
PLANNING DEPARTMENT



參考編號
REFERENCE No.
A/ST/956

圖 PLAN
A - 2b

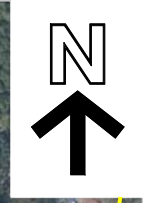

落路下的
鄉村範圍
VILLAGE
'ENVIRONS' OF
LOK LO HA

落路下
LOK LO HA

圖例 LEGEND	
	申請地點(界線只作識別用) APPLICATION SITE (BOUNDARY FOR IDENTIFICATION PURPOSE ONLY)
R(B)	住宅(乙類) RESIDENTIAL(GROUP B)
V	鄉村式發展 VILLAGE TYPE DEVELOPMENT
G/IC	政府、機構或社區 GOVERNMENT, INSTITUTION OR COMMUNITY
OU	其他指定用途 OTHER SPECIFIED USES
GB	綠化地帶 GREEN BELT

航攝照片 AERIAL PHOTO

擬議屋宇(新界豁免管制屋宇-小型屋宇)
新界沙田落路下丈量約份第177約政府土地
PROPOSED HOUSE
(NEW TERRITORIES EXEMPTED HOUSE - SMALL HOUSE)
GOVERNMENT LAND IN D.D.177, LOK LO HA, SHA TIN, N.T.

本圖於2018年6月8日擬備，
所根據的資料為地政總署
於2017年2月17日拍得的航攝照片
編號E014630C及E014727C
PLAN PREPARED ON 8.6.2017
BASED ON AERIAL PHOTOS No.
E014630C AND E014727C TAKEN ON 17.2.2017 BY
LANDS DEPARTMENT

規劃署
PLANNING DEPARTMENT



參考編號
REFERENCE No.
A/ST/956

圖 PLAN
A - 3



申請地點界線只作識別用
APPLICATION SITE BOUNDARY FOR IDENTIFICATION PURPOSE ONLY

本圖於2018年6月8日擬備，所根據的資料為攝於2018年5月4日的實地照片
PLAN PREPARED ON 98.6.2018 BASED ON SITE PHOTOS TAKEN ON 4.5.2018

實地照片 SITE PHOTO
擬議屋宇(新界豁免管制屋宇-小型屋宇)
新界沙田落路下丈量約份第177約政府土地
PROPOSED HOUSE
(NEW TERRITORIES EXEMPTED HOUSE - SMALL HOUSE)
GOVERNMENT LAND IN D.D.177, LOK LO HA, SHA TIN, N.T.

規劃署
PLANNING
DEPARTMENT



參考編號
REFERENCE No.
A/ST/956

圖 PLAN
A-4