

NOTES:

COPYRIGHT RESERVED
This print may not be copied, traced, or exhibited without permission of the Water Authority.

- ALL DIMENSIONS ARE IN MILLIMETRES UNLESS OTHERWISE SPECIFIED.
- ALL LEVELS ARE IN METRES ABOVE PRINCIPAL DATUM.
- THIS BASE PLAN IS EXTRACTED FROM SK28549 OF SURVEY SECTION, WSD.
- FOR DETAILS OF CONCRETE FOOTWAY REFER TO DRAWING NO. WSD 5.8.
- FOR DETAILS OF HIGH STRENGTH SECURITY FENCE AND 3 METRES WIDE MAIN GATE REFER TO DRAWING NO. WSD 6.10 TO WSD 6.11 RESPECTIVELY.
- FOR DETAILS OF POWER SUPPLY KIOSK REFER TO DRAWING NO. WSD 3.17.

LEGEND :

- SITE BOUNDARY
- FRESH WATER MAIN
- HIGH STRENGTH SECURITY FENCE
- ⊕ EARTHING PIE FOR LIGHTNING
- ⊕ CP1 CATCHPT NO. 1
- ⊕ 77.10 LEVEL
- ⊕ A SETTING OUT POINT 'A'
- ▭ CONCRETE FOOTWAY

ABBREVIATIONS :

- S.R.L. STRUCTURAL ROOF LEVEL
- F.G.L. FINISHED GROUND LEVEL
- SQ. SQUARE
- CUC COVERED U-CHANNEL
- CSC COVERED STEPPED CHANNEL

SETTING OUT COORDINATES		
POINT	NORTHING (m)	EASTING (m)
A	827 950.779	842 253.600
B	827 953.761	842 247.824

編號 no.	日期 date	描述 description	簽署 initial
REVISION			
修訂 designed			
繪圖 drawn		Y. H. U	
核對 checked			
批准 endorsed			
批准 approved			W. M. KWOK E/Design(1)

合約編號
contract no. —

程序編號
file no. WSD 7504/0/10/14

工程編號
PWP no. —

合約 contract

WATER SUPPLY TO REMOTE VILLAGES — MUI TSZ LAM VILLAGE, SHA TIN

圖則名稱 drawing title

SITE LAYOUT PLAN

圖則編號
drawing no. SK 20688/18

比例
scale 1:50 OR AS SHOWN

PROVISIONAL COPY ONLY
08/08/2019

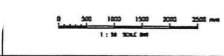
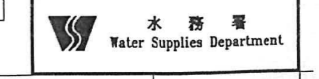

B1 1000 x 707

PC REV. NO. H

CAD REF. SK20688_18.DWG

PLOTTING SCALE 1 = 0.05

參考編號 REFERENCE No. AMOS/124 繪圖 DRAWING A-2

(來源: 申請人於2019年8月22日提交的規劃申請表內的繪圖)
(SOURCE: DRAWING IN THE APPLICANT'S SUBMITTED APPLICATION FORM ON 22.8.2019)

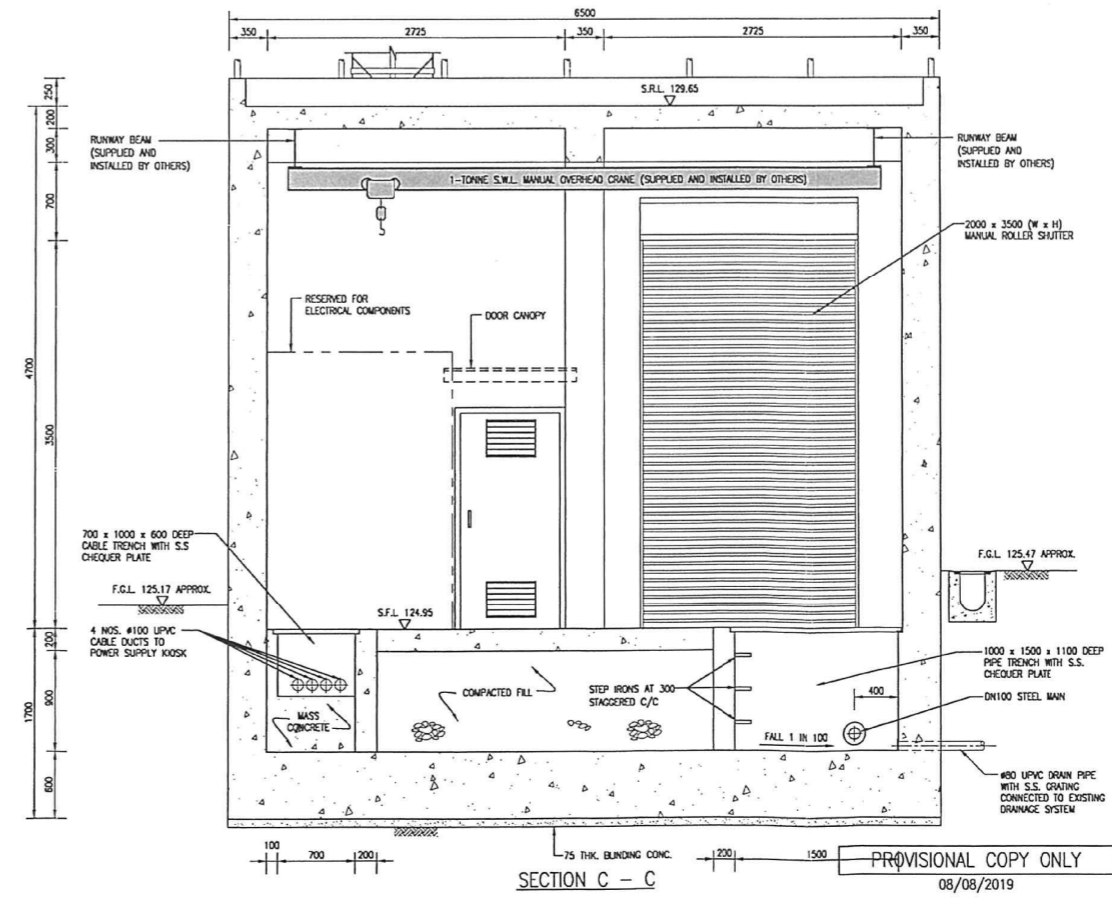
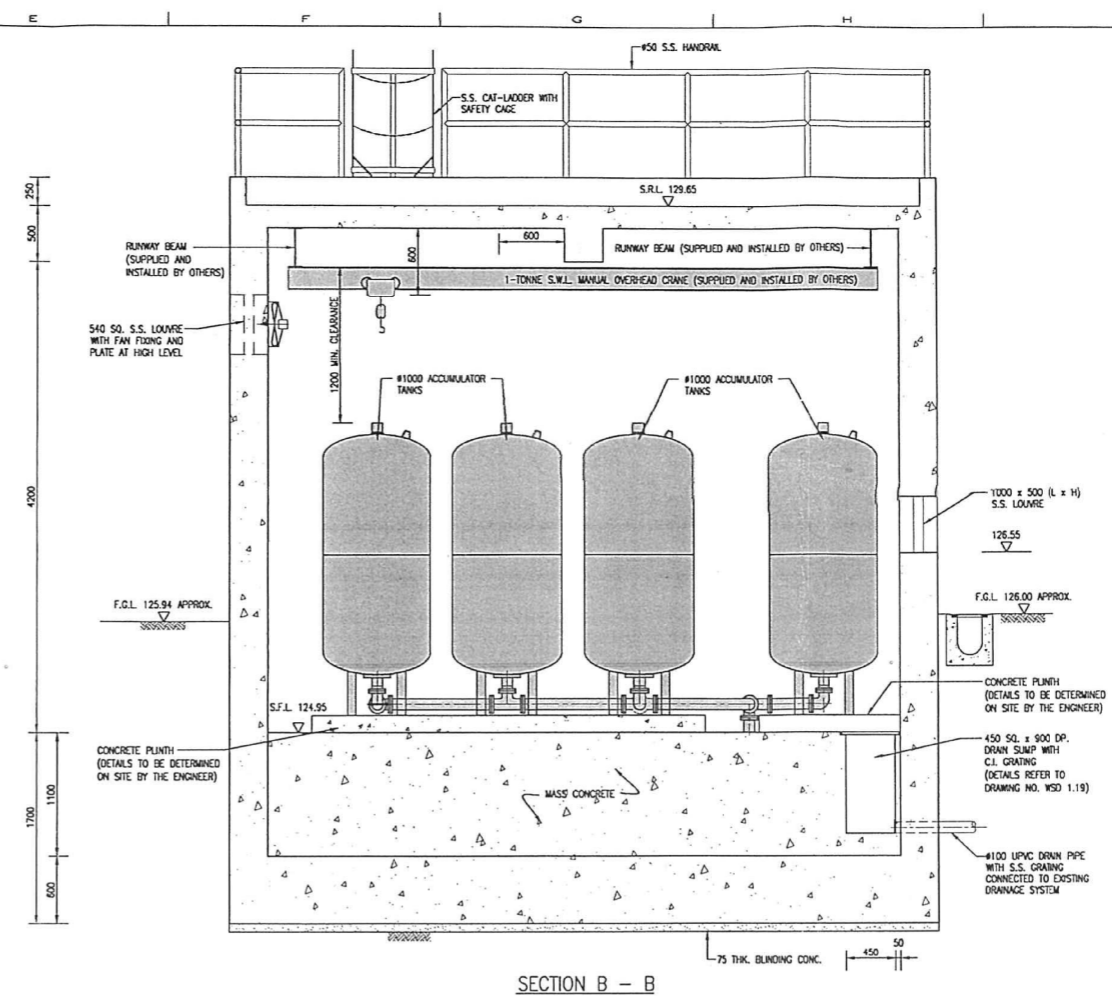
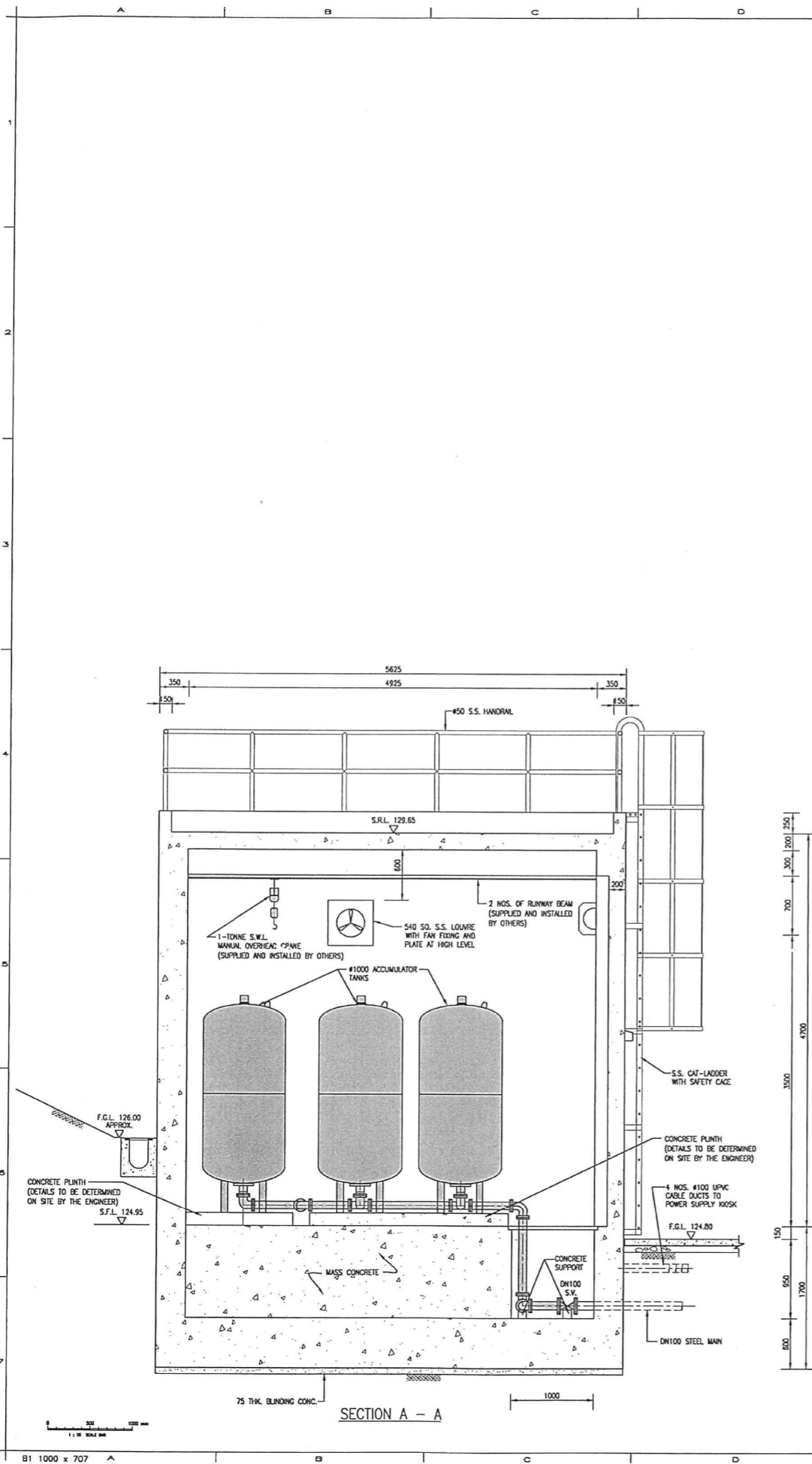

NOTES:
 COPYRIGHT RESERVED
 This print may not be copied, traced, or exhibited without permission of the Water Authority.
 1. FOR GENERAL NOTES AND ABBREVIATIONS, REFER TO DRAWING NO. SK20688/20.

編號	日期	編者	描述	簽署	日期
設計	-	-	-	-	-
繪圖	-	-	-	-	-
校核	-	-	-	-	-
加蓋	-	-	-	-	-
核准	-	-	-	-	-

W. M. KWOK
 E/Design(1)
 合約編號
 contract no. -
 檔案編號
 file no. WSD 7504/0/10/14
 工程編號
 PWP no. -
 合約內容
 contract -

WATER SUPPLY TO REMOTE VILLAGES - MUI TSZ LAM VILLAGE, SHA TIN

圖名
 drawing title
 GENERAL ARRANGEMENT (SHEET 2 OF 2)

圖號
 drawing no. SK 20688/21
 比例
 scale 1:25

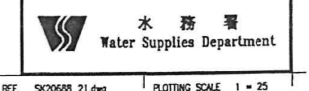

參考編號 REFERENCE No. A/MOS/124 繪圖 DRAWING A-3

(來源: 申請人於2019年8月22日提交的規劃申請表內的繪圖)
 (SOURCE: DRAWING IN THE APPLICANT'S SUBMITTED APPLICATION FORM ON 22.8.2019)

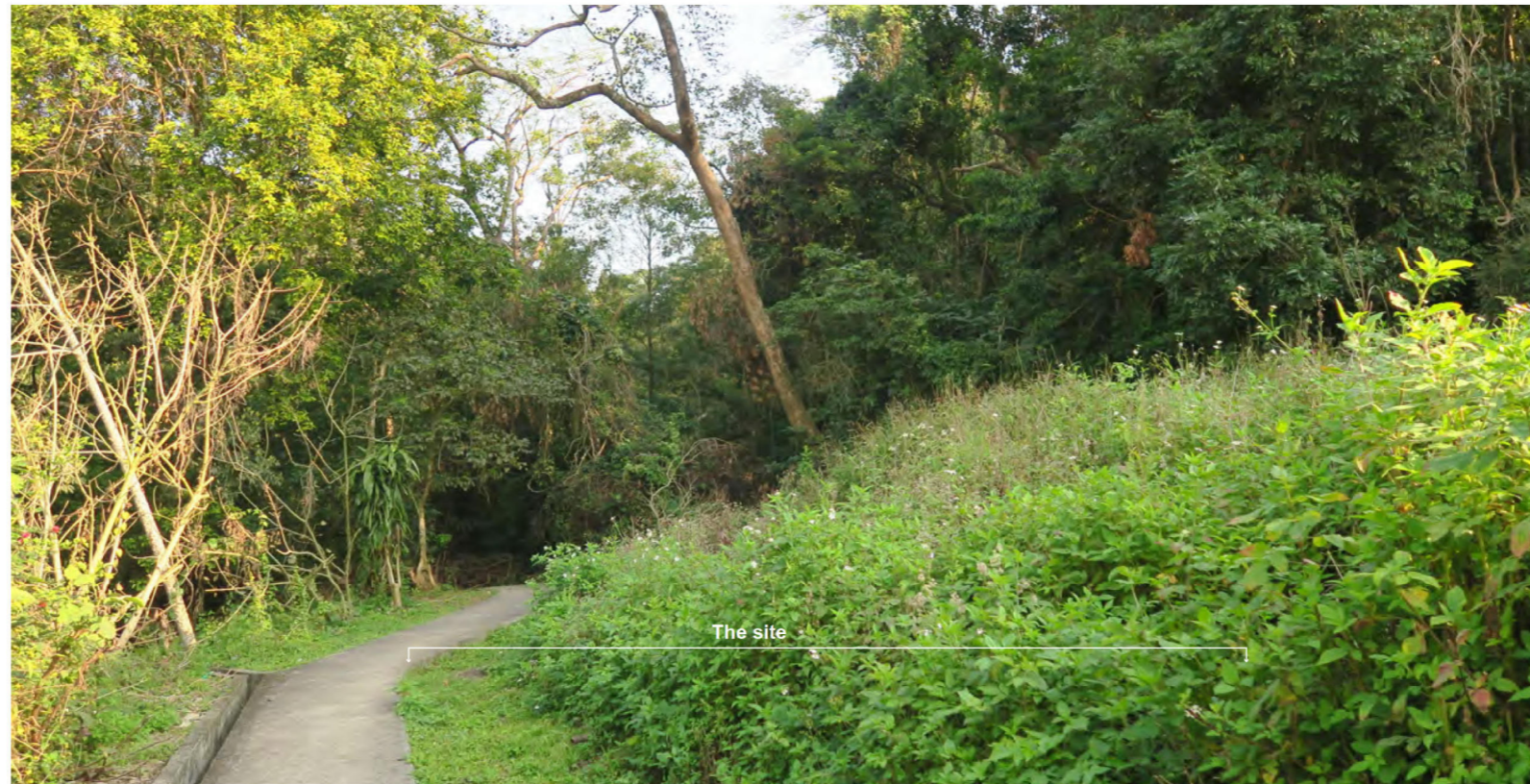

VP3 - Existing view from Mui Fa Ancient Trail from west (124mPD)



VP3 - View from Mui Fa Ancient Trail from west after development (124mPD)



**Aesthetic and Landscape Design for the Project 354WF -
Water Supply to Five Remote Villages - Mui Tsz Lam,
Sha Tin Scheme**



Title

VP3 - View from Mui Fa Ancient Trail from West

Figure No.

A8

Scale

N/A

Date

Aug2019

參考編號

REFERENCE No.

A/MOS/124

繪圖 DRAWING A-4

(來源: 申請人於2019年8月22日提交的規劃申請表內的繪圖)
(SOURCE: DRAWING IN THE APPLICANT'S SUBMITTED
APPLICATION FORM ON 22.8.2019)



VP4 - Existing view from Mui Fa Ancient Trail from east (123mPD)



VP4 - View from Mui Fa Ancient Trail from east after development (123mPD)



354WF - Water Supply to Five Remote Villages - Mui Tsz Lam, Sha Tin Scheme



Title

VP4 - View from Mui Fa Ancient Trail from East

Figure No.

A9

Scale

N/A

Date

Aug2019

參考編號

REFERENCE No.

A/MOS/124

繪圖 DRAWING A-5

(來源: 申請人於2019年8月22日提交的規劃申請表內的繪圖)
(SOURCE: DRAWING IN THE APPLICANT'S SUBMITTED APPLICATION FORM ON 22.8.2019)



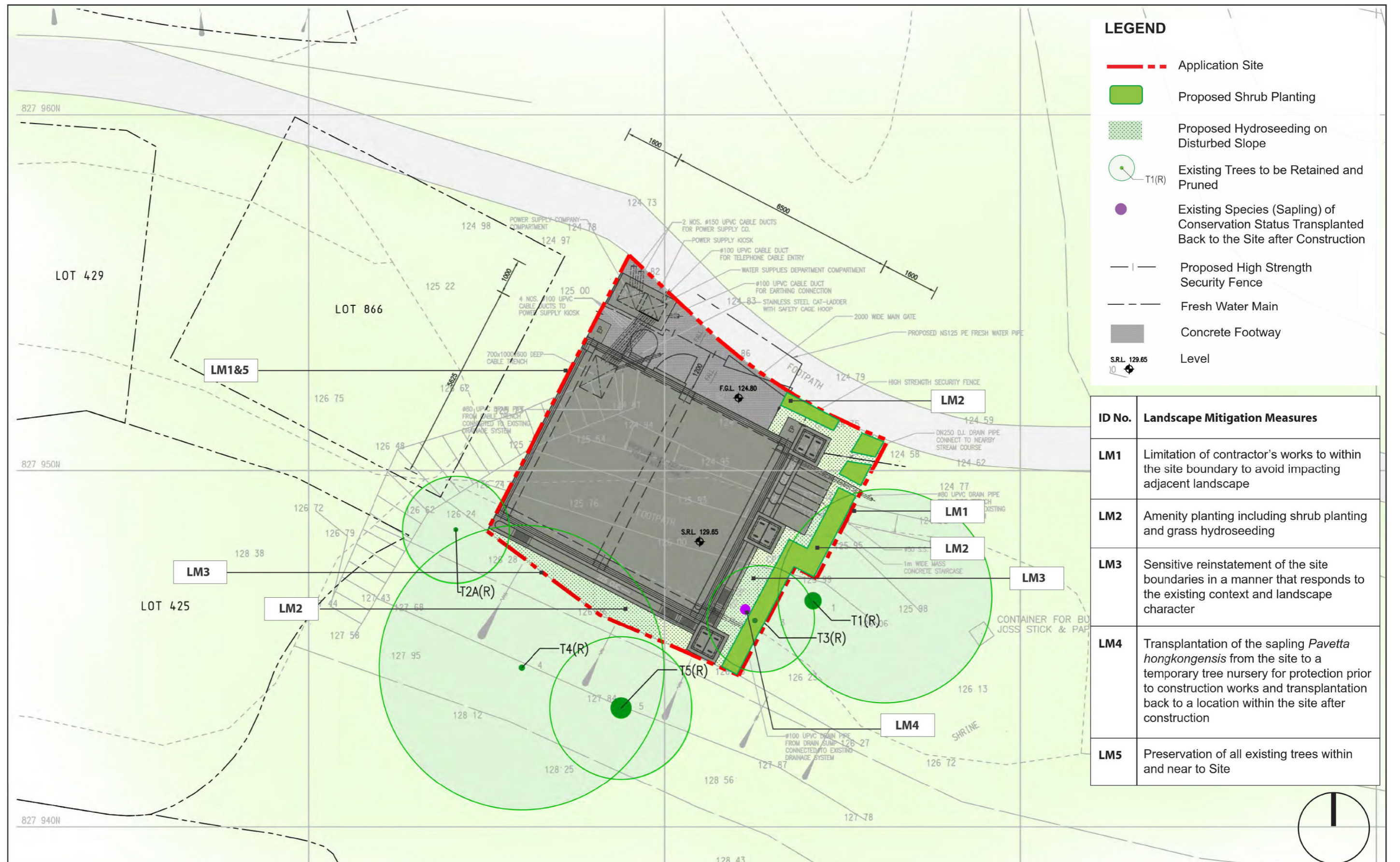

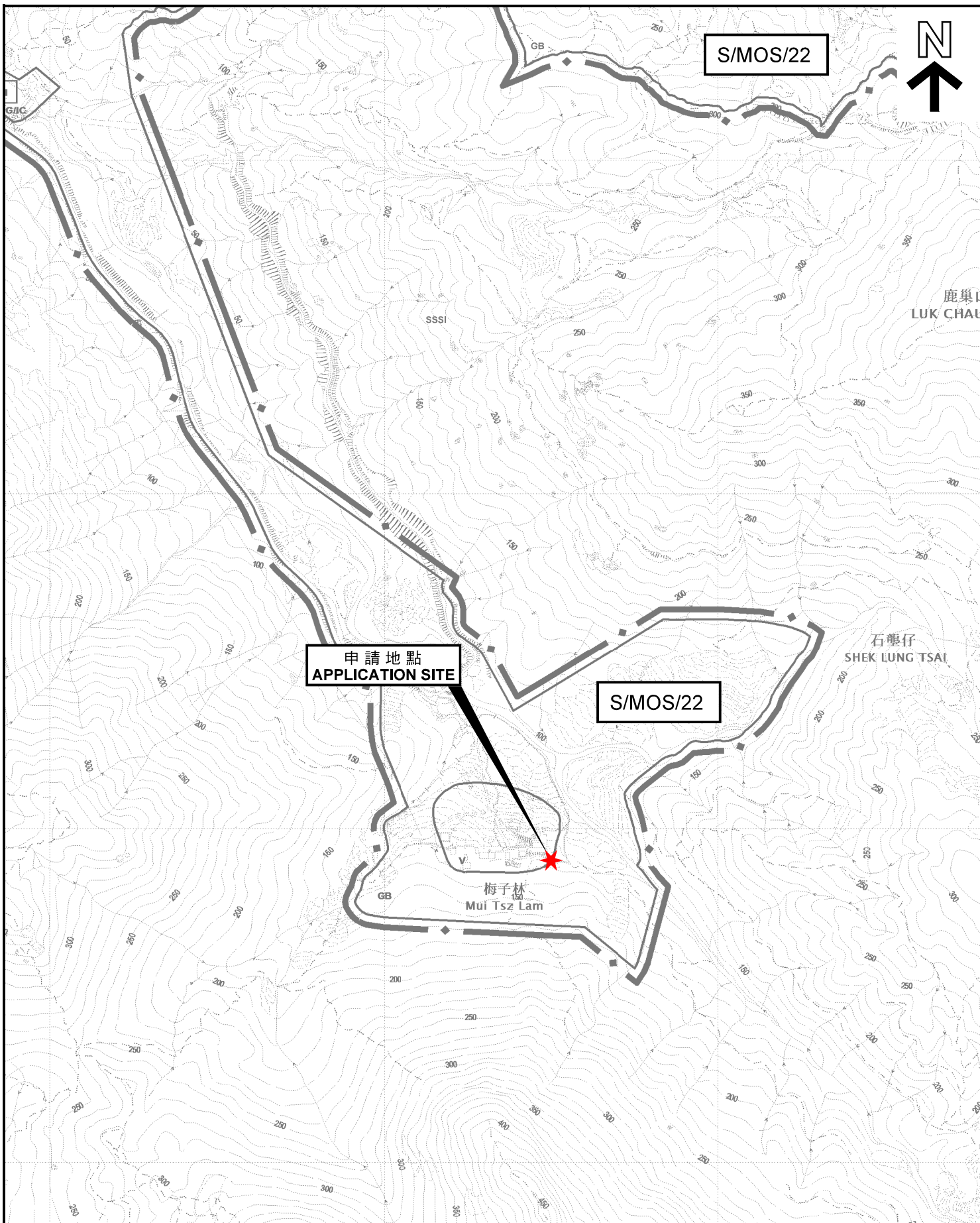

位置圖 LOCATION PLAN

公用事業設施裝置 (食水水缸)
 新界馬鞍山梅子林村丈量約份第188約政府土地
 PUBLIC UTILITY INSTALLATION (FRESH WATER TANK)
 GOVERNMENT LAND IN D.D. 188, MUI TSZ LAM VILLAGE,
 MA ON SHAN, NEW TERRITORIES

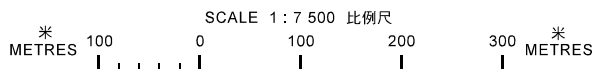

規劃署
 PLANNING
 DEPARTMENT



參考編號
 REFERENCE No.
 A/MOS/124

圖 PLAN
 A-1

本摘要圖於2019年9月5日擬備，
 所根據的資料為於2016年1月5日
 核准的分區計劃大綱圖編號S/MOS/22
 EXTRACT PLAN PREPARED ON 5.9.2019
 BASED ON OUTLINE ZONING PLAN No.
 S/MOS/22 APPROVED ON 5.1.2016

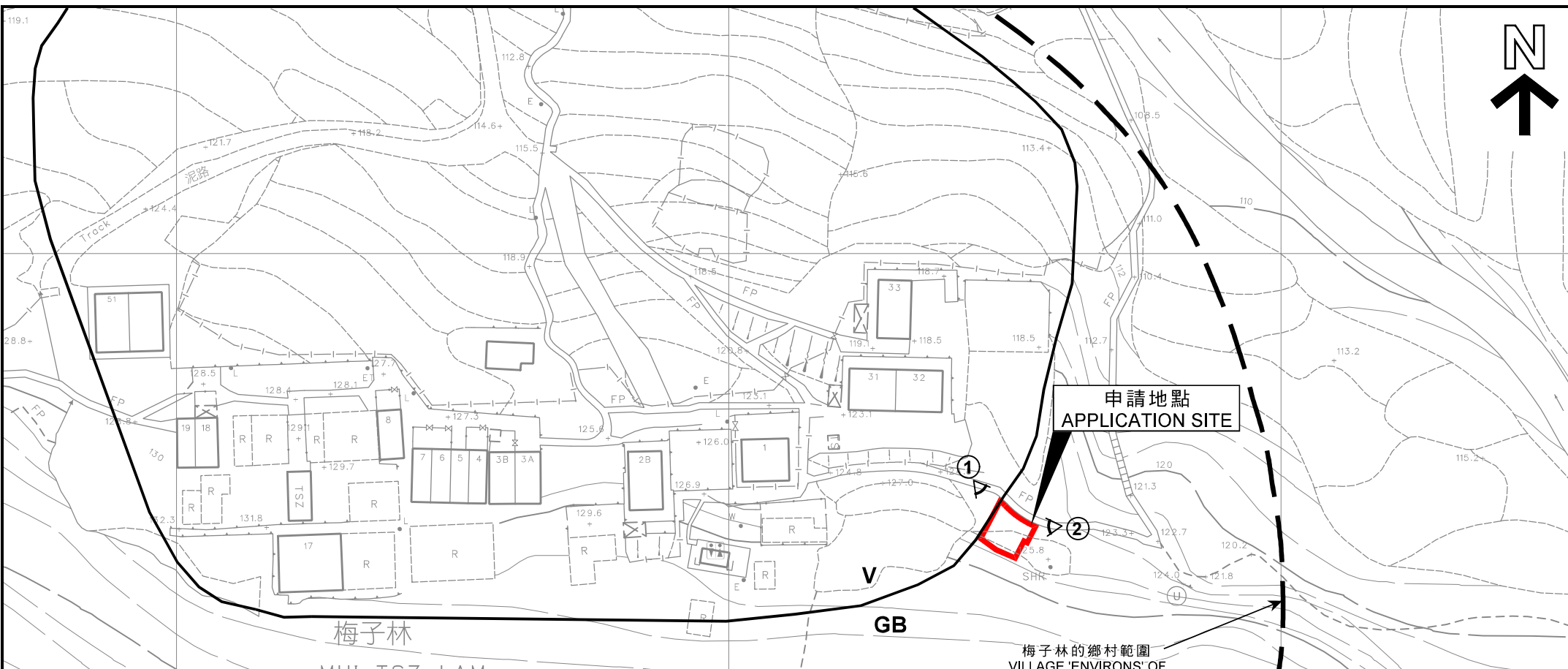

申請地點
APPLICATION SITE

梅子林
MUI TSZ LAM

梅子林的鄉村範圍
VILLAGE 'ENVIRONS' OF
MUI TSZ LAM

- 圖例 LEGEND
-  申請地點 (界線只作識別用)
APPLICATION SITE (BOUNDARY FOR IDENTIFICATION PURPOSE ONLY)
 -  鄉村式發展
VILLAGE TYPE DEVELOPMENT
 -  綠化地帶
GREEN BELT
 -  實地照片的觀景點
VIEWING POINT OF SITE PHOTO

平面圖 SITE PLAN

公用事業設施裝置 (食水水缸)
 新界馬鞍山梅子林村丈量約份第188約政府土地
 PUBLIC UTILITY INSTALLATION (FRESH WATER TANK)
 GOVERNMENT LAND IN D.D. 188, MUI TSZ LAM VILLAGE,
 MA ON SHAN, NEW TERRITORIES

SCALE 1:1 000 比例尺

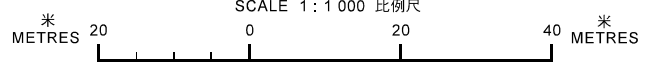

本摘要圖於2019年10月2日擬備，
 所根據的資料為測量圖編號
 7-SE-9C
 EXTRACT PLAN PREPARED ON 2.10.2019
 BASED ON SURVEY SHEET No.
 7-SE-9C

規劃署
 PLANNING
 DEPARTMENT



參考編號
 REFERENCE No.
 A/MOS/124

圖 PLAN
 A-2



梅子林
MUI TSZ LAM

圖例 LEGEND

 申請地點（界線只作識別用）
APPLICATION SITE
(BOUNDARY FOR IDENTIFICATION PURPOSE ONLY)

航攝照片 AERIAL PHOTO

公用事業設施裝置（食水水缸）
新界馬鞍山梅子林村丈量約份第188約政府土地
PUBLIC UTILITY INSTALLATION (FRESH WATER TANK)
GOVERNMENT LAND IN D.D. 188, MUI TSZ LAM VILLAGE,
MA ON SHAN, NEW TERRITORIES

本摘要圖於2019年9月5日擬備，
所根據的資料為地政總署於
2018年3月23日拍得的航攝照片
編號E039826C

EXTRACT PLAN PREPARED ON 5.9.2019
BASED ON AERIAL PHOTO No.
E039826C TAKEN ON 23.3.2018
BY LANDS DEPARTMENT

規劃署
PLANNING
DEPARTMENT



參考編號
REFERENCE No.
A/MOS/124

圖 PLAN
A-3



申請地點只作識別用
APPLICATION SITE BOUNDARY FOR IDENTIFICATION PURPOSE ONLY

實地照片 SITE PHOTO

公用事業設施裝置（食水水缸）
新界馬鞍山梅子林村丈量約份第188約政府土地
PUBLIC UTILITY INSTALLATION (FRESH WATER TANK)
GOVERNMENT LAND IN D.D. 188, MUI TSZ LAM VILLAGE,
MA ON SHAN, NEW TERRITORIES

**規劃署
PLANNING
DEPARTMENT**



本圖於2019年9月27日擬備，所根據的資料為攝於2019年8月26日的實地照片
PLAN PREPARED ON 27.9.2019
BASED ON SITE PHOTOS TAKEN ON 26.8.2019

參考編號
REFERENCE No.
A/MOS/124

**圖 PLAN
A-4**