

LOT INDEX PLAN

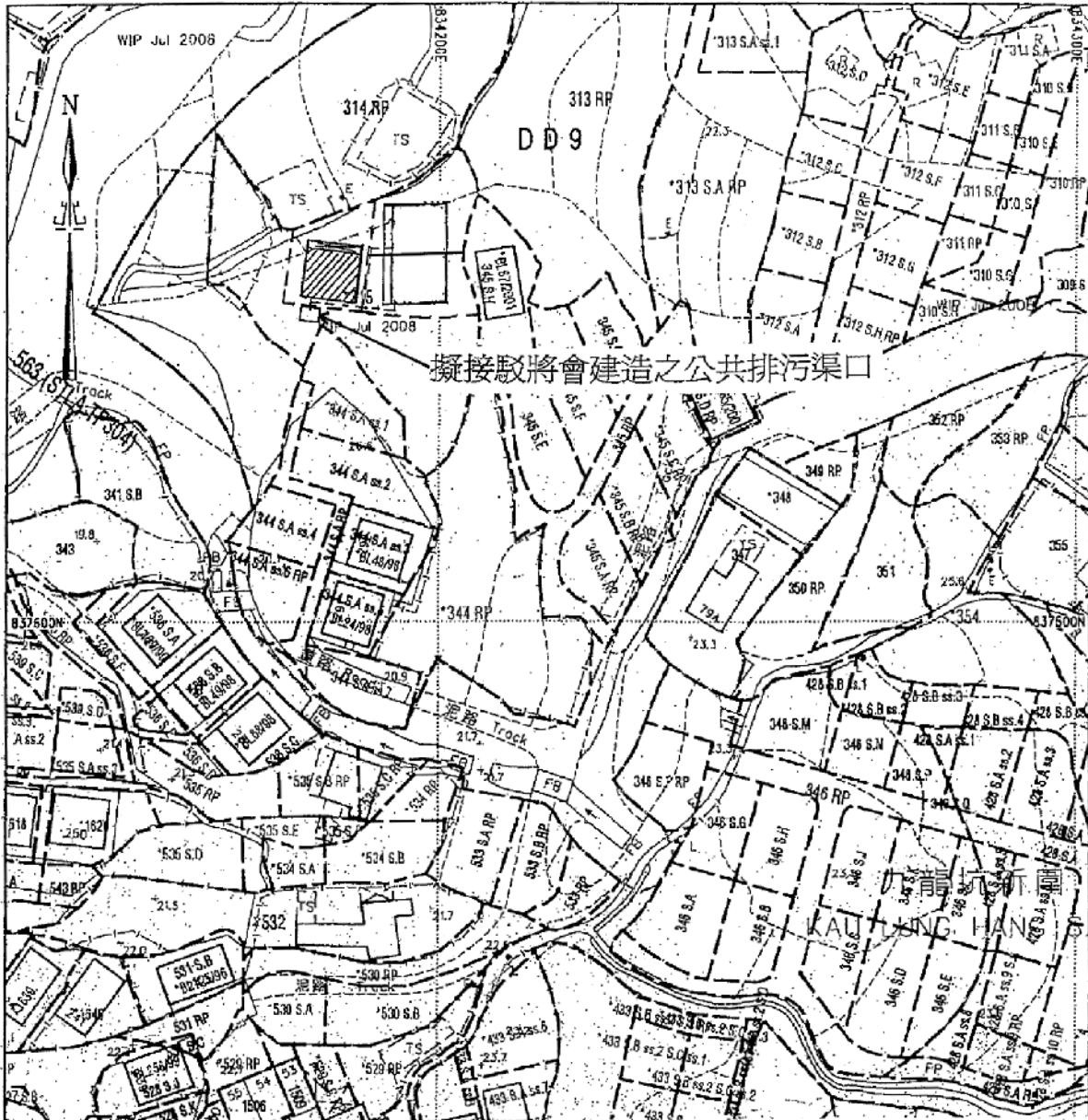

擬接駁將會建造之公共排污渠口



Proposed small house

Area: $7.62\text{m} \times 8.534\text{m} = 65.03\text{m}^2$

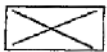

Balconies & canopy: $1.22\text{m} \times 8.534\text{m}$

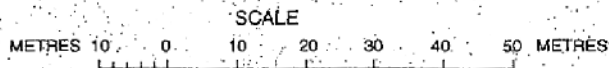

Locality : D.D.9
 Lot Index Plan No. : 3-SW-18D
 District Survey Office : Tai Po
 Date : 09 Sep 08
 Reference No. : ---

© Copyright reserved - Hong Kong Government
 SMO-P01 20080909141137 11

This plan is a copy of the lot index plan showing the approximate location of lot boundaries, including the temporary occupation of land under Government Land Allocations, Temporary Government Land Allocations, Short Term Tenancies and Government Land Licences. The temporary occupation of land may be created or terminated at short notice and should be confirmed with the District Lands Officer. The information shown on this plan **MUST** be verified by field survey. The lot index plan may be revised without prior notification as better or new boundary evidence becomes available.

本圖則乃地盤索引圖的複本，顯示地段界線的大概位置，包括根據政府撥地、臨時政府撥地、短期租約及政府土地租用牌照而臨時佔用土地的位置。臨時佔用土地的情況可隨時通知出讓或終止，因此應向有關的分區地政專員核對。本圖則所示的資料必須透過實地測量予以核實。當有更佳或新的地盤數據時，地盤索引圖可能會被修訂而其更新亦須通知。

Application No. : A/NE-KLH/553

參考編號
 REFERENCE No. A/NE-KLH/553to555

繪圖 DRAWING A-1

(來源 : 申請人建議書)
 (SOURCE : APPLICANT'S SUBMISSION PLAN)

LOT INDEX PLAN

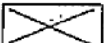

擬接駁將會建造之公共排污渠口

-  Proposed small house
Area: 8.534m x 7.62m=65.03m²
-  Balconies & canopy: 1.22m x 7.62m

Locality : D.D.9
 Lot Index Plan No. : 3-SW-18D
 District Survey Office : Tai Po
 Date : 09 Sep 08
 Reference No. : ---

© Copyright reserved - Hong Kong Government
 SMO-P01 20080909141137 11

boundaries, including the temporary occupation of land under Government Land Allocations, Temporary Government Land Allocations, Short Term Tenancies and Government Land Licences. The temporary occupation of land may be created or terminated at short notice and should be confirmed with the District Lands Officer. The information shown on this plan **MUST** be verified by field survey. The lot index plan may be revised without prior notification as better or new boundary evidence becomes available.

本圖則乃地段索引圖的複本，顯示地段界線的大概位置，包括根據政府撥地、臨時政府撥地、短期租約及政府土地租用牌照而臨時佔用土地的位置。臨時佔用土地的情況可憑通知出現或終止，因此應向有關的分區地政專員核實。本圖則所示的資料必須透過實地測量予以核實。當有更佳或新的地界證據時，地段索引圖可能會被修訂而無須事先通知。

Application No. : A/NE-KLH/554

參考編號 REFERENCE No. A/NE-KLH/553to555	繪圖 DRAWING A-2
-----------------------------------------	----------------

(來源 : 申請人建議書)
 (SOURCE : APPLICANT'S SUBMISSION PLAN)

LOT INDEX PLAN

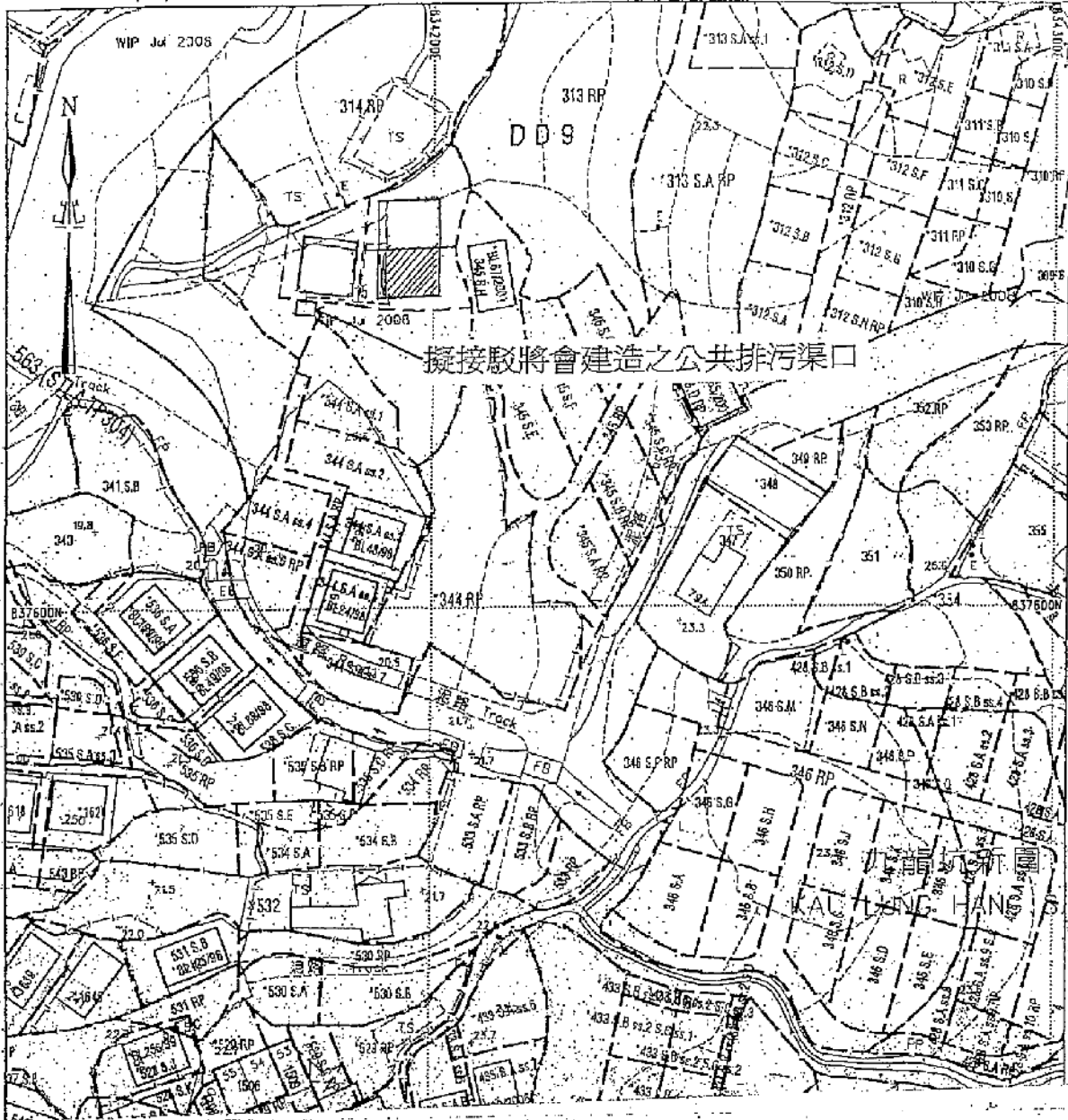

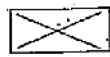
-  Proposed small house
Area: 8.534m x 7.62m=65.03m²
-  Balconies & canopy: 1.22m x 7.62m

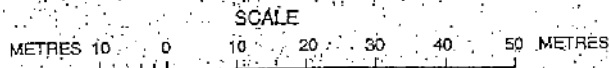

Locality : D.D.9
 Lot Index Plan No. : 3-SW-18D
 District Survey Office : Tai Po
 Date : 09 Sep 08
 Reference No. : ---

© Copyright reserved - Hong Kong Government
 SMO-P01 20080909141137 11

This plan is a copy of the lot index plan showing the approximate location of lot boundaries, including the temporary occupation of land under Government Land Allocations, Temporary Government Land Allocations, Short Term Tenancies and Government Land Licences. The temporary occupation of land may be created or terminated at short notice and should be confirmed with the District Lands Officer. The information shown on this plan MUST be verified by field survey. The lot index plan may be revised without prior notification as better or new boundary evidence becomes available.

本圖則乃地盤索引圖的複本，顯示地盤界線的大概位置，包括根據政府撥地、臨時政府撥地、短期租約及政府土地租用牌照而臨時佔用土地的情況。臨時佔用土地的情況可隨時通知出現或終止，因此意向有關的分區地政專員核實。本圖則所示的資料必須透過實地調查予以核實。如有更確或新的地界證據時，地盤索引圖可能會被修訂而蓋項事先通知。

Application No. : A/NE-KLH/555

參考編號
 REFERENCE No. A/NE-KLH/553to555

繪圖 DRAWING A-3

(來源 : 申請人建議書)
 (SOURCE : APPLICANT'S SUBMISSION PLAN)



要覽圖 KEY PLAN

SCALE 1 : 50 000 比例尺

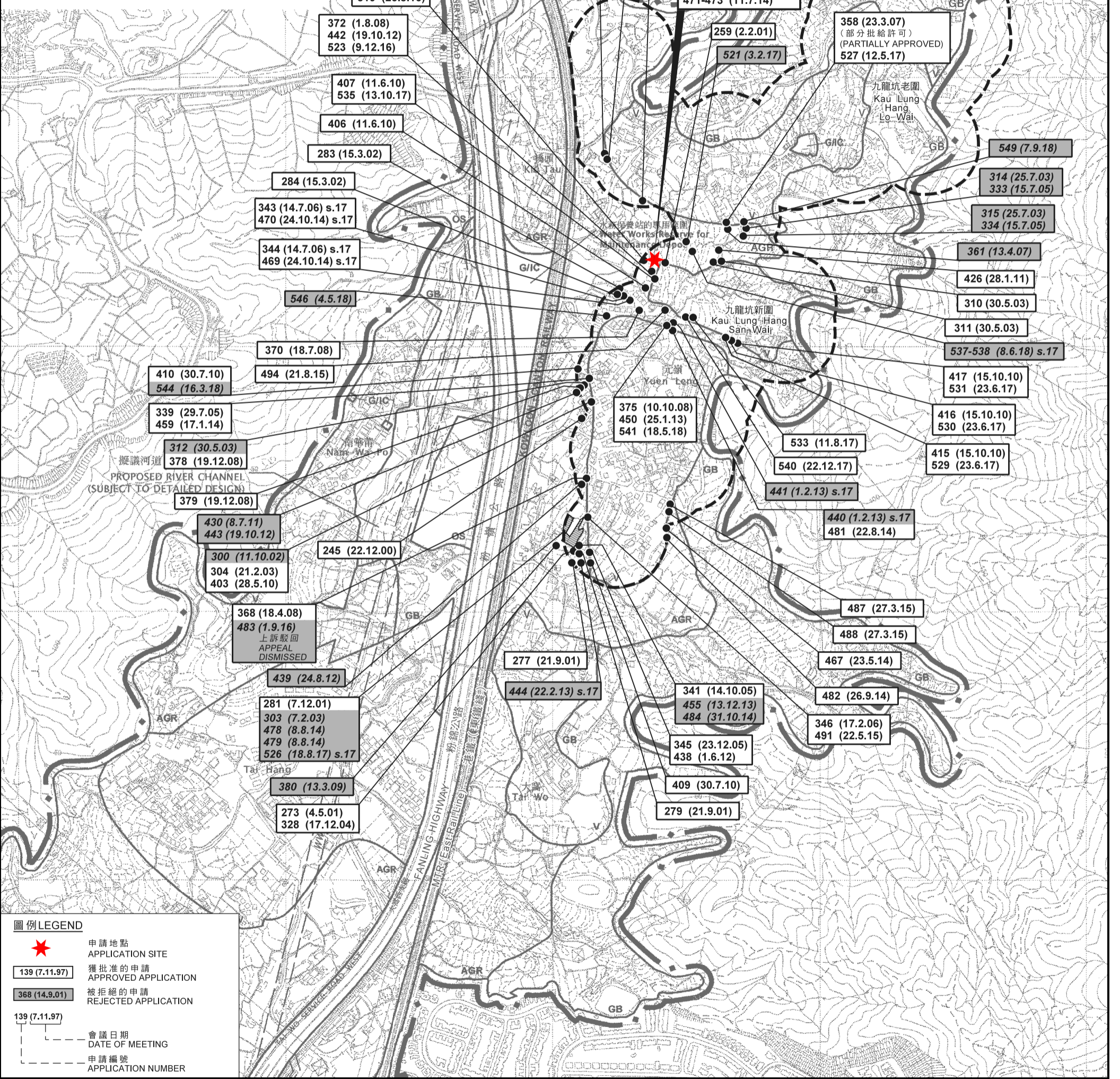

圖例 LEGEND

- 申請地點 APPLICATION SITE
- 獲批准的申請 APPROVED APPLICATION
- 被拒絕的申請 REJECTED APPLICATION
- 會議日期 DATE OF MEETING
- 申請編號 APPLICATION NUMBER

位置圖 LOCATION PLAN

擬議屋宇 (新界豁免管制屋宇 - 小型屋宇)
 新界大埔九龍坑丈量約份第9約
 地段第315號E分段、第315號F分段及第315號G分段
 PROPOSED HOUSE
 (NEW TERRITORIES EXEMPTED HOUSE - SMALL HOUSE)
 LOTS 315 S.E., 315 S.F AND 315 S.G IN D.D. 9,
 KAU LUNG HANG, TAI PO, N.T.
 SCALE 1 : 7 500 比例尺

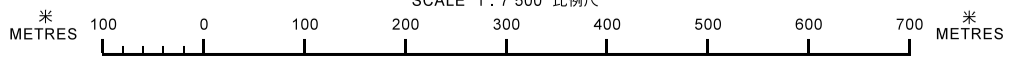

規劃署
 PLANNING
 DEPARTMENT



參考編號
 REFERENCE No.
 A/NE-KLH/53to555

圖 PLAN
 A-1

本摘要圖於2018年9月11日擬備，
 所根據的資料為於2006年10月17日核准的
 分區計劃大綱圖編號S/NE-KLH/11
 EXTRACT PLAN PREPARED ON 11.9.2018
 BASED ON OUTLINE ZONING PLAN
 No. S/NE-KLH/11 APPROVED ON 17.10.2006

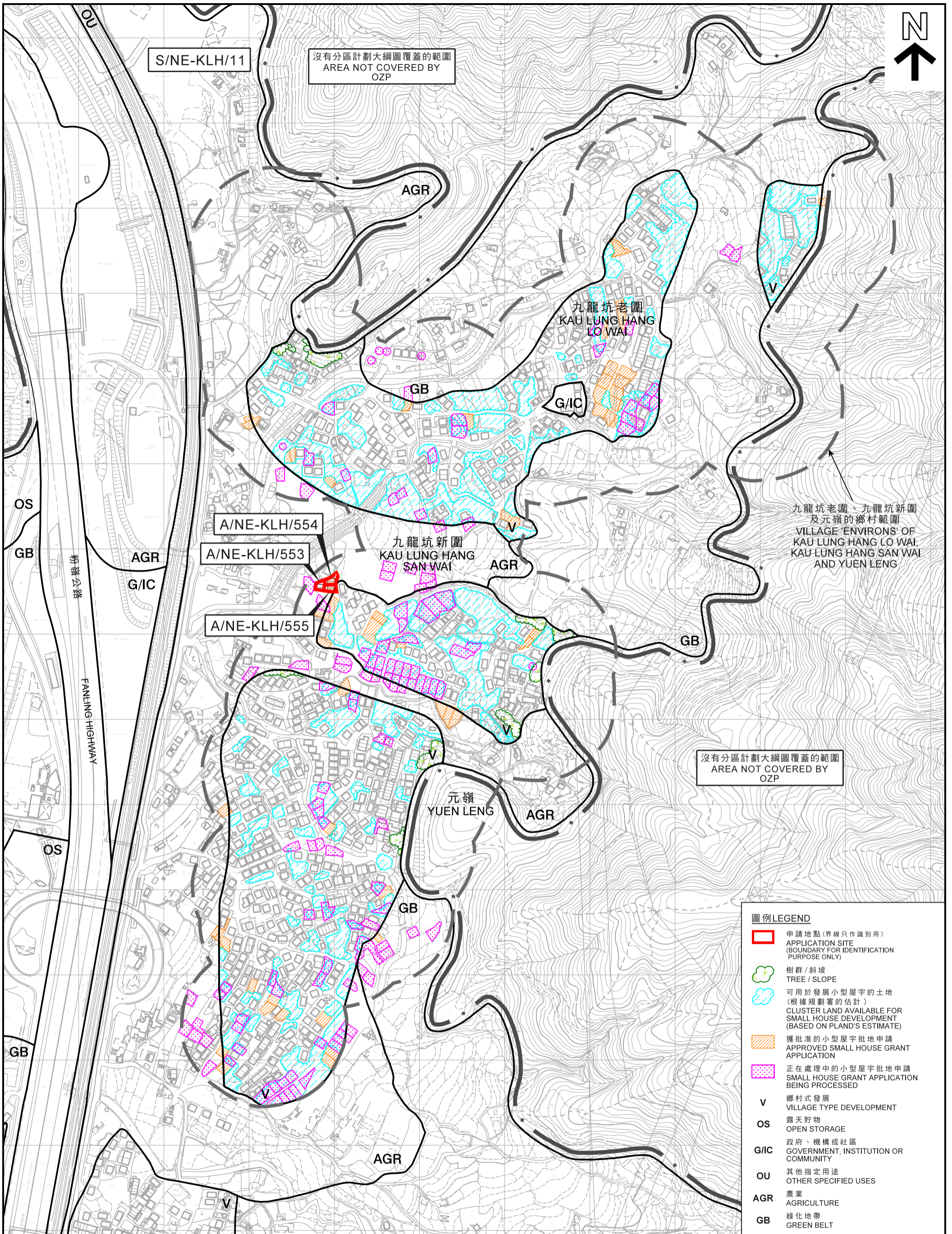

S/NE-KLH/11

沒有分區計劃大綱圖覆蓋的範圍
AREA NOT COVERED BY OZP



九龍坑老圍、九龍坑新圍
及元嶺的鄉村範圍
VILLAGE 'ENVIRONS' OF
KAU LUNG HANG LO WAI,
KAU LUNG HANG SAN WAI
AND YUEN LENG

沒有分區計劃大綱圖覆蓋的範圍
AREA NOT COVERED BY OZP

- 圖例 LEGEND**
- 申請地點(界線只作識別用)
APPLICATION SITE (BOUNDARY FOR IDENTIFICATION PURPOSE ONLY)
 - 🌳 樹群 / 斜坡
TREE / SLOPE
 - 可用於發展小型屋宇的土地
(根據規劃署的估計)
LAND AVAILABLE FOR SMALL HOUSE DEVELOPMENT
(BASED ON PLAND'S ESTIMATE)
 - 獲批准的小型屋宇批地申請
APPROVED SMALL HOUSE GRANT APPLICATION
 - 正在處理中的小型屋宇批地申請
SMALL HOUSE GRANT APPLICATION BEING PROCESSED
 - V** 鄉村式發展
VILLAGE TYPE DEVELOPMENT
 - OS** 露天貯物
OPEN STORAGE
 - G/IC** 政府、機構或社區
GOVERNMENT, INSTITUTION OR COMMUNITY
 - OU** 其他指定用途
OTHER SPECIFIED USES
 - AGR** 農業
AGRICULTURE
 - GB** 綠化地帶
GREEN BELT

在「鄉村式發展」地帶內預計可供發展小型屋宇的土地數量
ESTIMATED AMOUNT OF LAND AVAILABLE FOR
SMALL HOUSE DEVELOPMENT WITHIN THE "V" ZONE

擬議屋宇(新界豁免管制屋宇 - 小型屋宇)
PROPOSED HOUSE (NEW TERRITORIES EXEMPTED HOUSE - SMALL HOUSE)
LOTS 315 S.E, 315 S.F AND 315 S.G IN D.D. 9,
KAU LUNG HANG, TAI PO, N.T.

規劃署
PLANNING
DEPARTMENT



參考編號
REFERENCE No.
A/NE-KLH/553to555

圖 PLAN
A-2b

本摘要圖於2018年9月14日擬備，所根據的資料為測量圖編號6-NE-9A、B及D
EXTRACT PLAN PREPARED ON 14.9.2018
BASED ON SURVEY SHEETS No. 6-NE-9A, B & D

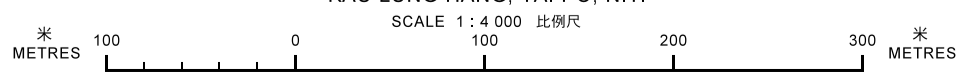

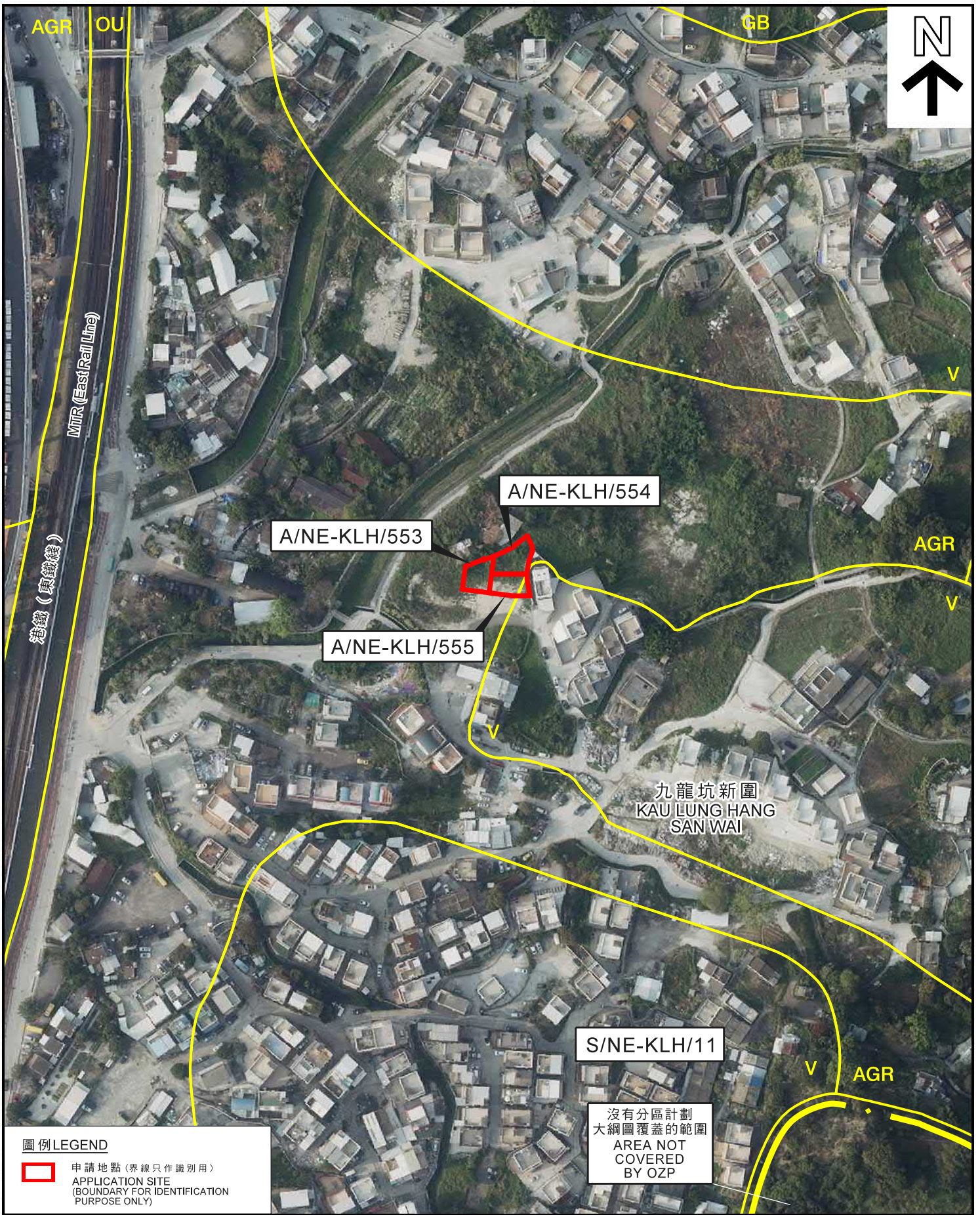

圖例 LEGEND

 申請地點 (界線只作識別用)
APPLICATION SITE
(BOUNDARY FOR IDENTIFICATION
PURPOSE ONLY)

沒有分區計劃
大綱圖覆蓋的範圍
AREA NOT
COVERED
BY OZP

本摘要圖於2018年9月3日擬備，
所根據的資料為地政總署
於2018年3月12日拍得的航攝照片
編號E034593C
EXTRACT PLAN PREPARED ON 3.9.2018
BASED ON AERIAL PHOTO No. E034593C
TAKEN ON 12.3.2018 BY
LANDS DEPARTMENT

航攝照片 AERIAL PHOTO

擬議屋宇 (新界豁免管制屋宇 - 小型屋宇)
新界大埔九龍坑丈量約份第9約
地段第315號E分段、第315號F分段及第315號G分段
PROPOSED HOUSE
(NEW TERRITORIES EXEMPTED HOUSE - SMALL HOUSE)
LOTS 315 S.E., 315 S.F AND 315 S.G IN D.D. 9,
KAU LUNG HANG, TAI PO, N.T.

規畫署
PLANNING
DEPARTMENT



參考編號
REFERENCE No.
A/NE-KLH/553to555

圖 PLAN
A-3

1



實地照片 SITE PHOTO

擬議屋宇(新界豁免管制屋宇－小型屋宇)
新界大埔九龍坑丈量約份第9約
地段第315號E分段、第315號F分段及第315號G分段
PROPOSED HOUSE
(NEW TERRITORIES EXEMPTED HOUSE - SMALL HOUSE)
LOTS 315 S.E, 315 S.F AND 315 S.G IN D.D. 9,
KAU LUNG HANG, TAI PO, N.T.

本圖於2018年9月3日擬備，所根據
的資料為攝於2018年8月21日的實地照片
PLAN PREPARED ON 3.9.2018 BASED ON
SITE PHOTO TAKEN ON 21.8.2018

規劃署
PLANNING
DEPARTMENT



參考編號
REFERENCE No.
A/NE-KLH/553to555

圖 PLAN
A-4