

Proposed Layout Plan Lot 1526B in D.D.76

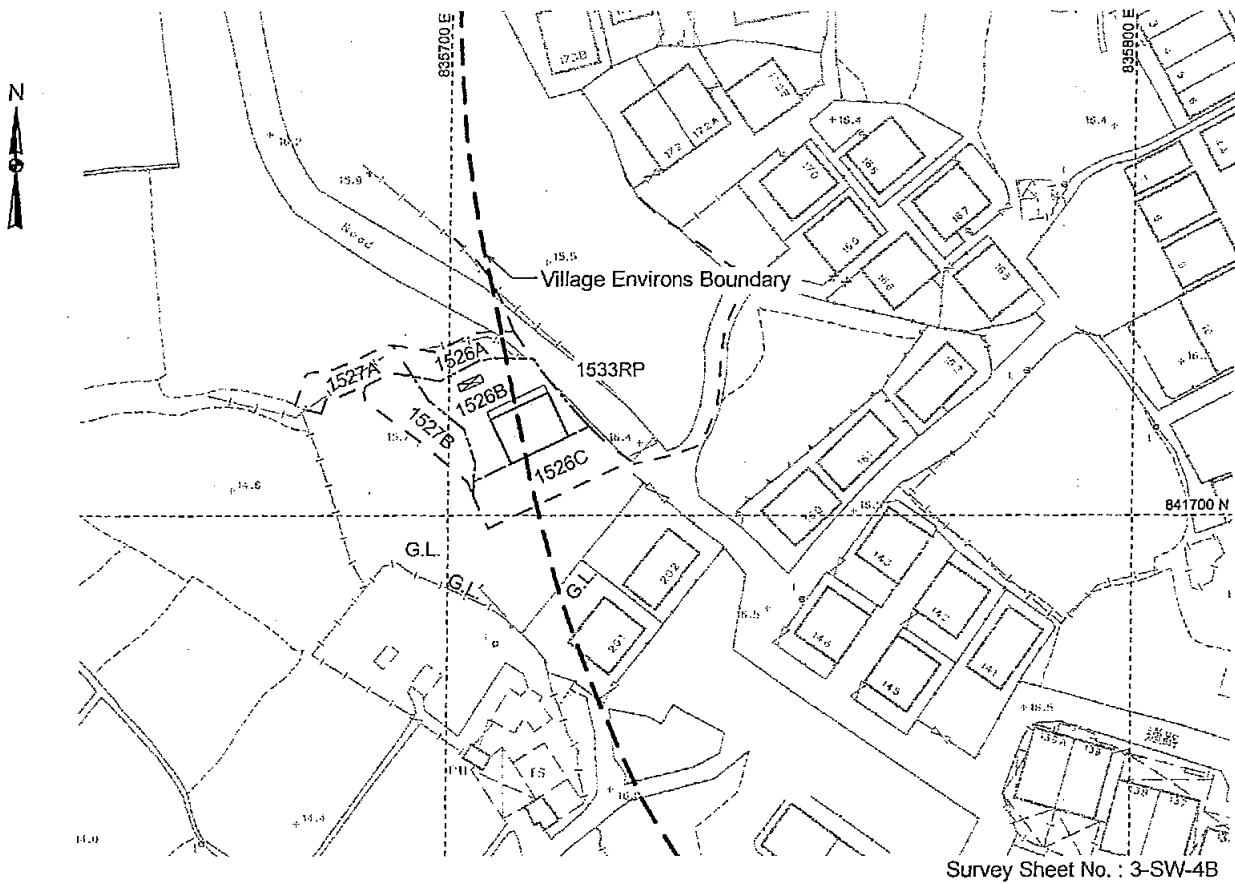

Scale 1:1000

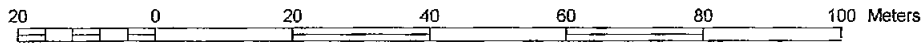



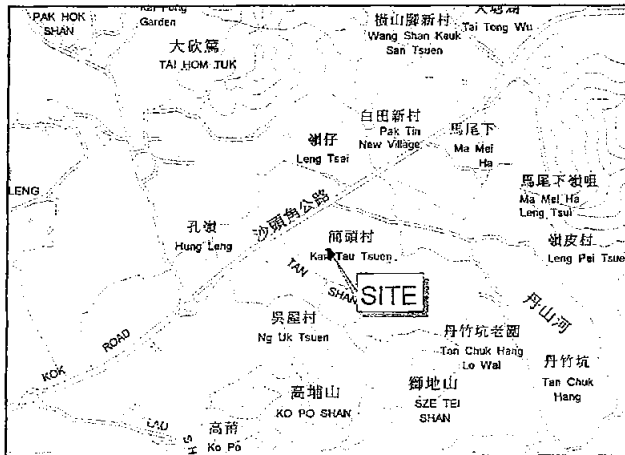

Location



Scale 1:20000

Legend

-  Proposed NTEH
-  Proposed balcony
-  Proposed septic tank
-  G.L. Government Land

Date : 15/11/217





參考編號
REFERENCE No. A/NE-LYT/650,
651 & 652

繪圖 DRAWING A-1

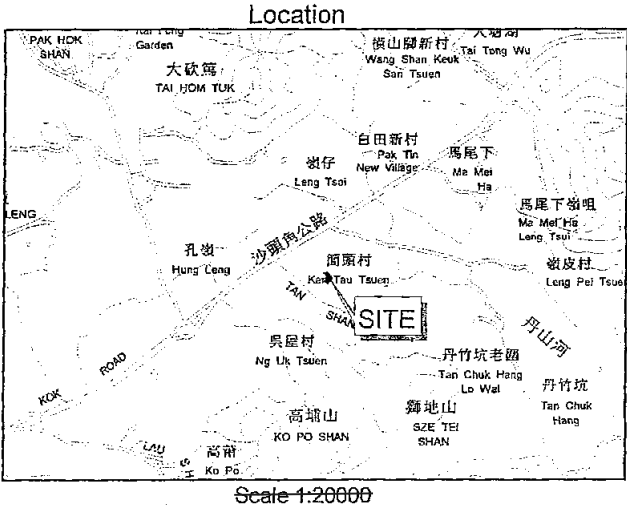
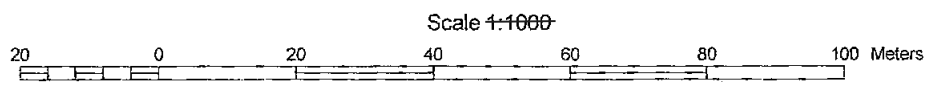
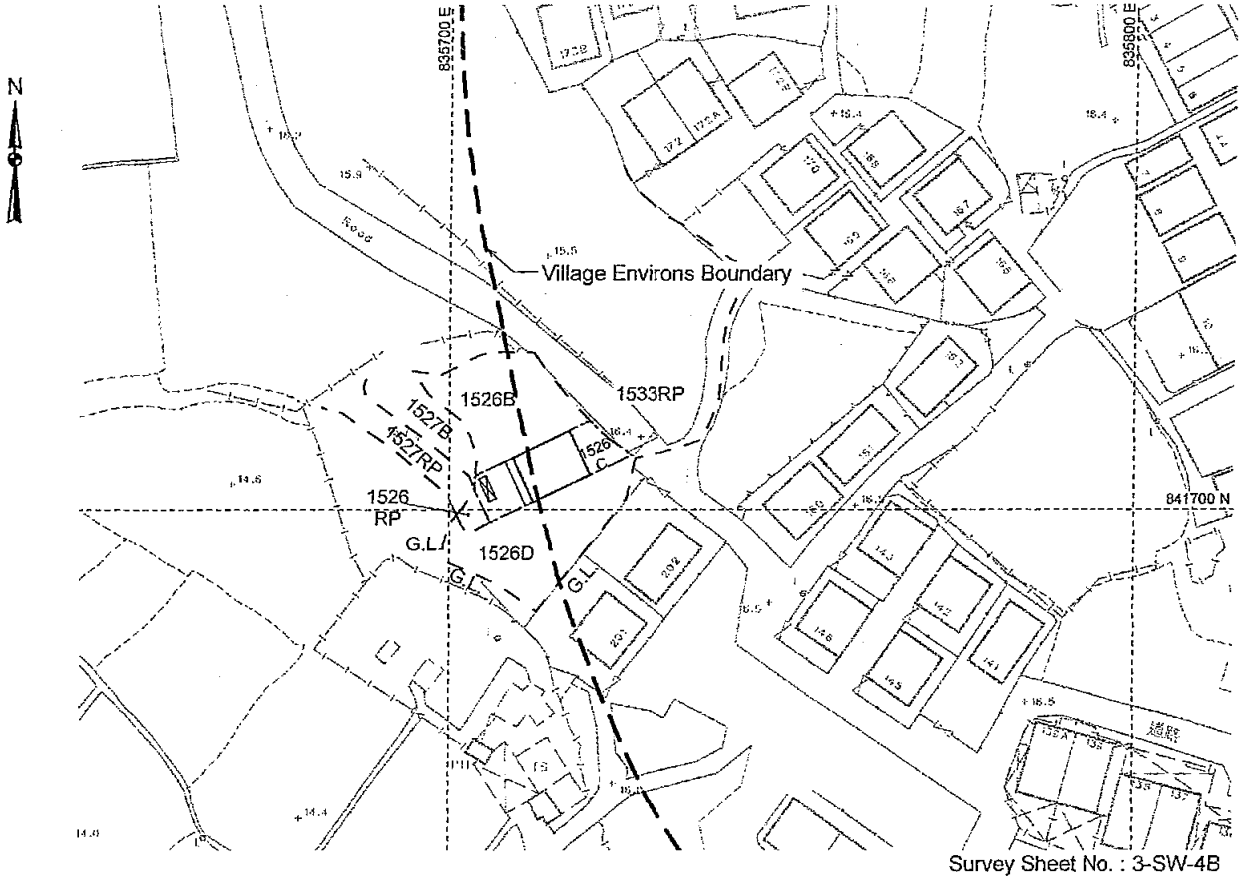
(來源 附件 1a)
(Source : Appendix 1a)

Proposed Layout Plan Lot 1526C in D.D.76



- Legend**
-  Proposed NTEH
 -  Proposed balcony
 -  Proposed septic tank
 -  G.L. Government Land



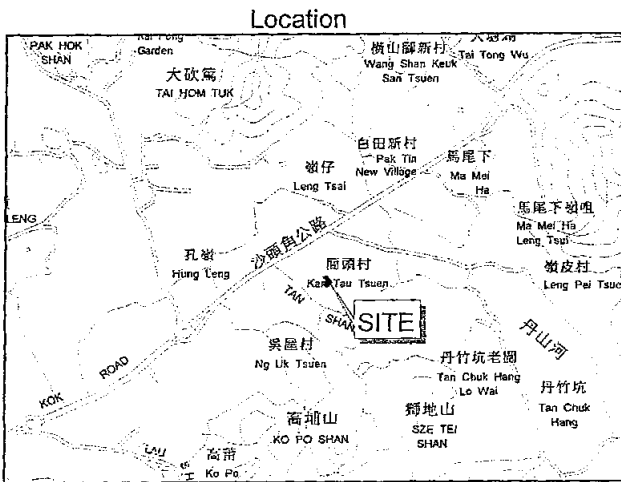
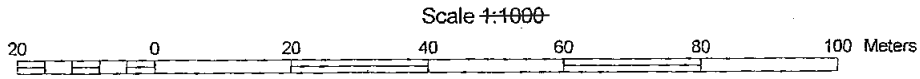
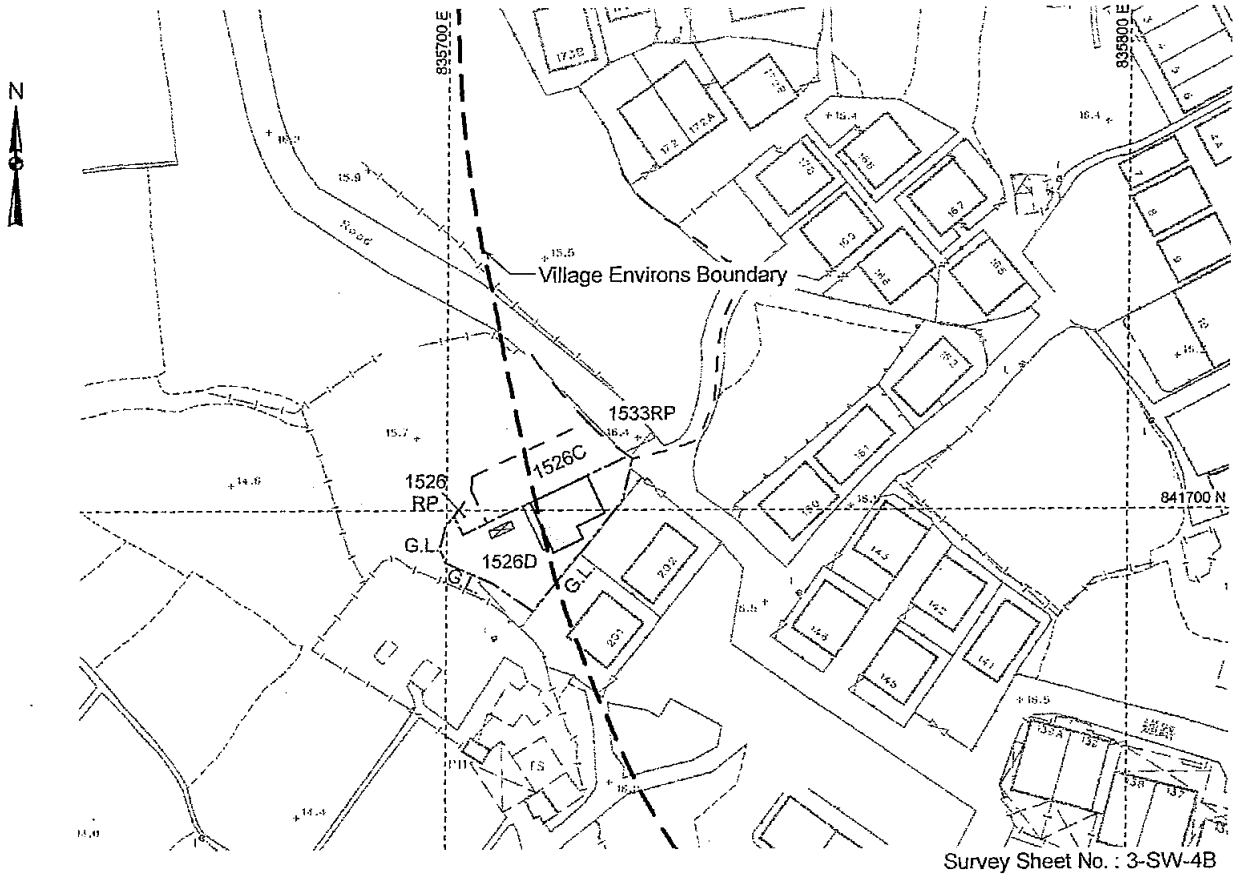

Date : 15/11/217

(來源 附件 Ib)
(Source : Appendix Ib)

Proposed Layout Plan Lot 1526D in D.D.76



Legend

-  Proposed NTEH
-  Proposed balcony
-  Proposed septic tank
-  G.L. Government Land

Date : 15/11/217

參考編號
REFERENCE No. A/NE-LYT/650,
651 & 652

繪圖 DRAWING A-3

(來源 附件 1c)
(Source : Appendix 1c)

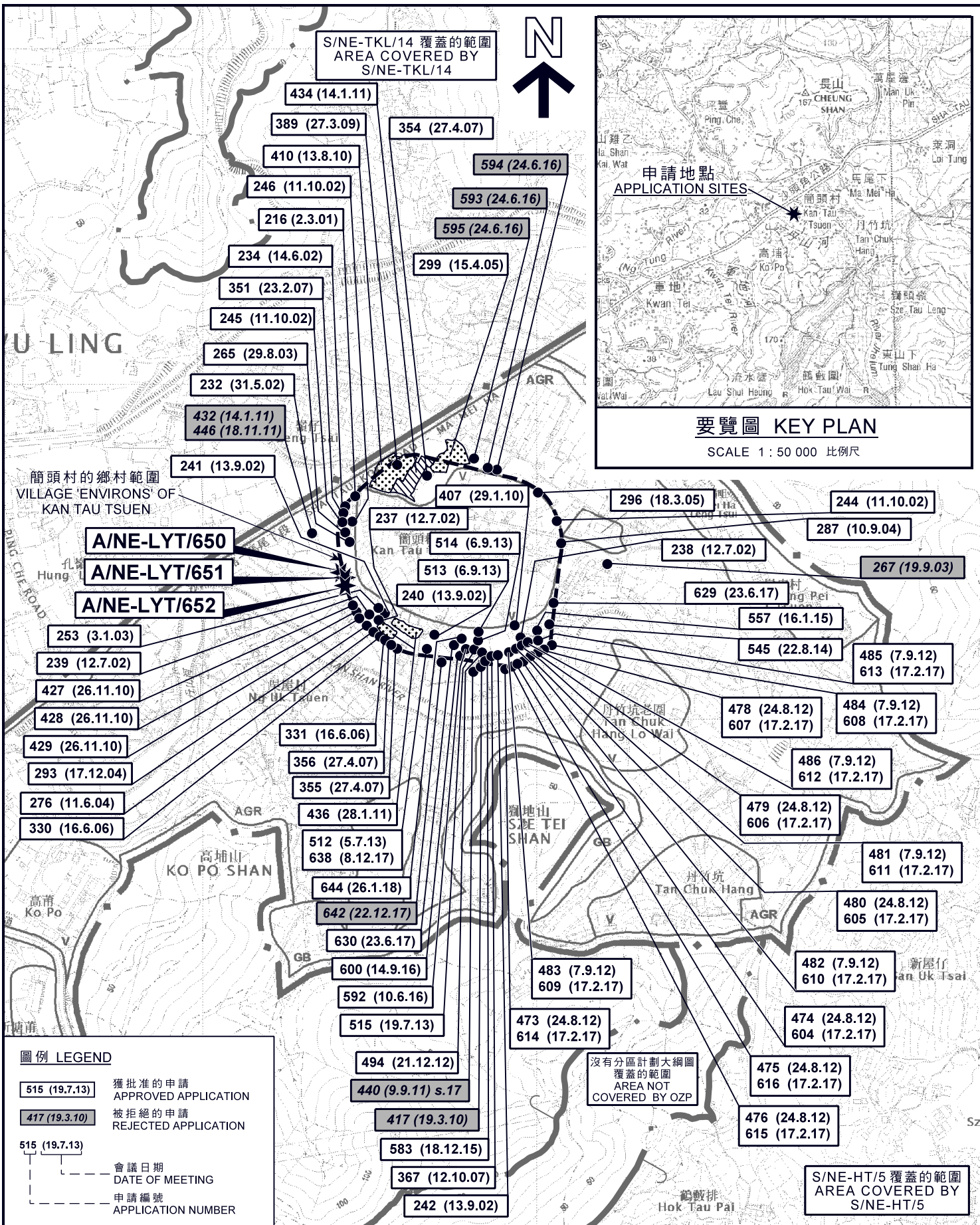

位置圖 LOCATION PLAN

三幢擬議屋宇 (新界豁免管制屋宇-小型屋宇)
新界粉嶺簡頭村丈量約份第76約地段第1526號B分段、
第1526號C分段及第1526號D分段
THREE PROPOSED HOUSES
(NEW TERRITORIES EXEMPTED HOUSES - SMALL HOUSES)
LOTS 1526 S.B, 1526 S.C AND 1526 S.D IN D.D. 76,
KAN TAU TSUEN, FANLING, N.T.

SCALE 1 : 7 500 比例尺

米 100 0 100 200 300 米
METRES

本摘要圖於2018年5月14日擬備，
所根據的資料為於2016年2月2日核准的
分區計劃大綱圖編號S/NE-LYT/17
EXTRACT PLAN PREPARED ON 14.5.2018
BASED ON OUTLINE ZONING PLAN
No. S/NE-LYT/17 APPROVED ON 2.2.2016

規劃署
PLANNING DEPARTMENT

參考編號
REFERENCE No.
A/NE-LYT/650,
651 & 652

圖 PLAN
A-1

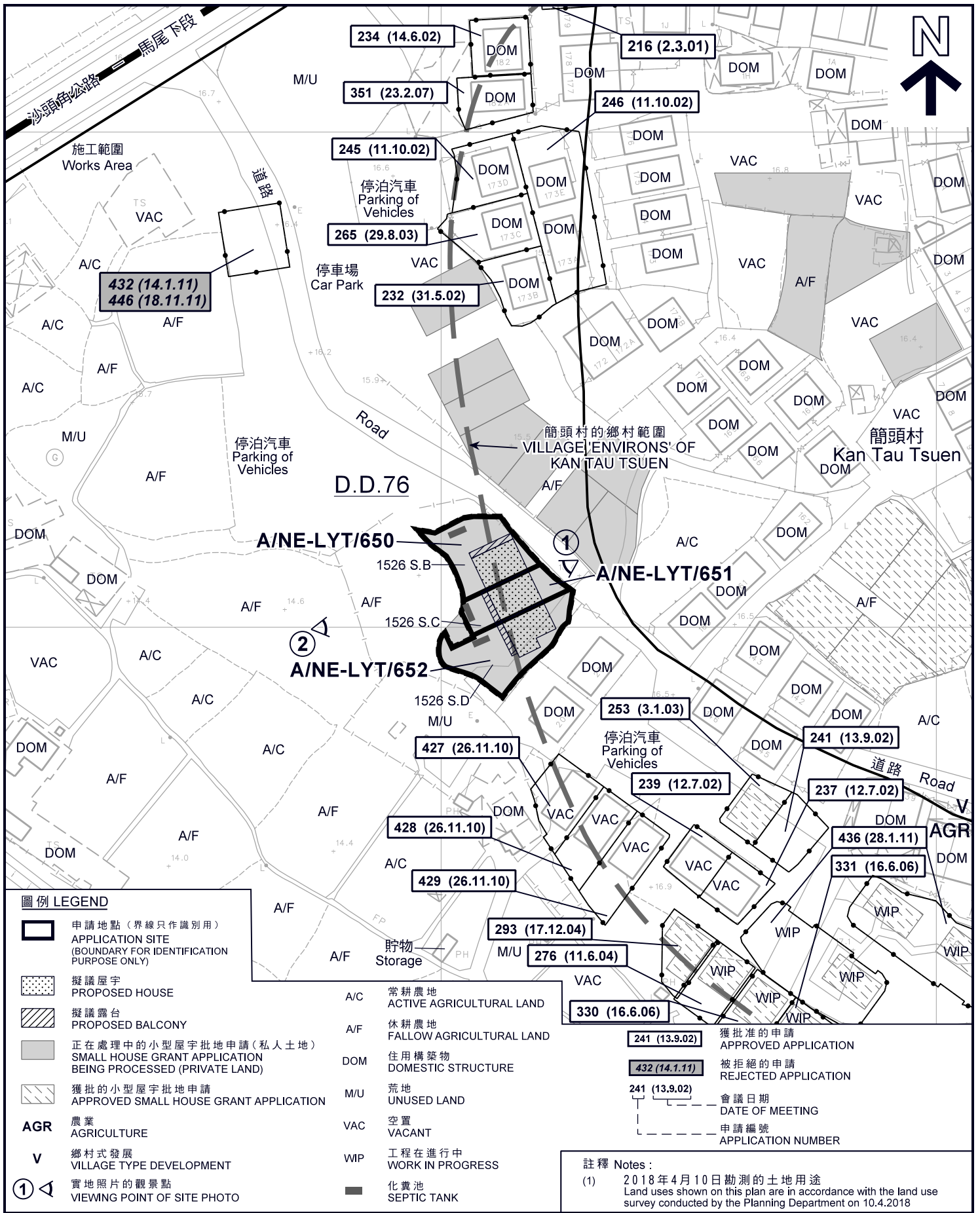

圖例 LEGEND

- 申請地點 (界線只作識別用)
APPLICATION SITE (BOUNDARY FOR IDENTIFICATION PURPOSE ONLY)
- 擬議屋宇
PROPOSED HOUSE
- 擬議露台
PROPOSED BALCONY
- 正在處理中的小型屋宇批地申請 (私人土地)
SMALL HOUSE GRANT APPLICATION BEING PROCESSED (PRIVATE LAND)
- 獲批的小型屋宇批地申請
APPROVED SMALL HOUSE GRANT APPLICATION
- AGR** 農業
AGRICULTURE
- V** 鄉村式發展
VILLAGE TYPE DEVELOPMENT
- 實地照片的觀景點
VIEWING POINT OF SITE PHOTO

- A/C** 常耕地
ACTIVE AGRICULTURAL LAND
- A/F** 休耕地
FALLOW AGRICULTURAL LAND
- DOM** 住用構築物
DOMESTIC STRUCTURE
- M/U** 荒地
UNUSED LAND
- VAC** 空置
VACANT
- WIP** 工程在進行中
WORK IN PROGRESS
- 化糞池
SEPTIC TANK

- 241 (13.9.02) 獲批准的申請
APPROVED APPLICATION
- 432 (14.1.11) 被拒絕的申請
REJECTED APPLICATION
- 241 (13.9.02) 會議日期
DATE OF MEETING
- 申請編號
APPLICATION NUMBER

註釋 Notes:

(1) 2018年4月10日勘測的土地用途
Land uses shown on this plan are in accordance with the land use survey conducted by the Planning Department on 10.4.2018

平面圖 SITE PLAN

三幢擬議屋宇 (新界豁免管制屋宇-小型屋宇)
新界粉嶺簡頭村丈量約份第76約地段第1526號B分段、
第1526號C分段及第1526號D分段
THREE PROPOSED HOUSES
(NEW TERRITORIES EXEMPTED HOUSES - SMALL HOUSES)
LOTS 1526 S.B, 1526 S.C AND 1526 S.D IN D.D. 76,
KAN TAU TSUEN, FANLING, N.T.

SCALE 1 : 1 000 比例尺



規劃署
PLANNING
DEPARTMENT



參考編號
REFERENCE No.
A/NE-LYT/650,
651 & 652

圖 PLAN
A-2a

本摘要圖於2018年5月21日擬備，
所根據的資料為測量圖編號
3-SW-4B
EXTRACT PLAN PREPARED ON 21.5.2018
BASED ON SURVEY SHEET No.
3-SW-4B



S/NE-TKL/14 覆蓋的範圍
AREA COVERED BY
S/NE-TKL/14

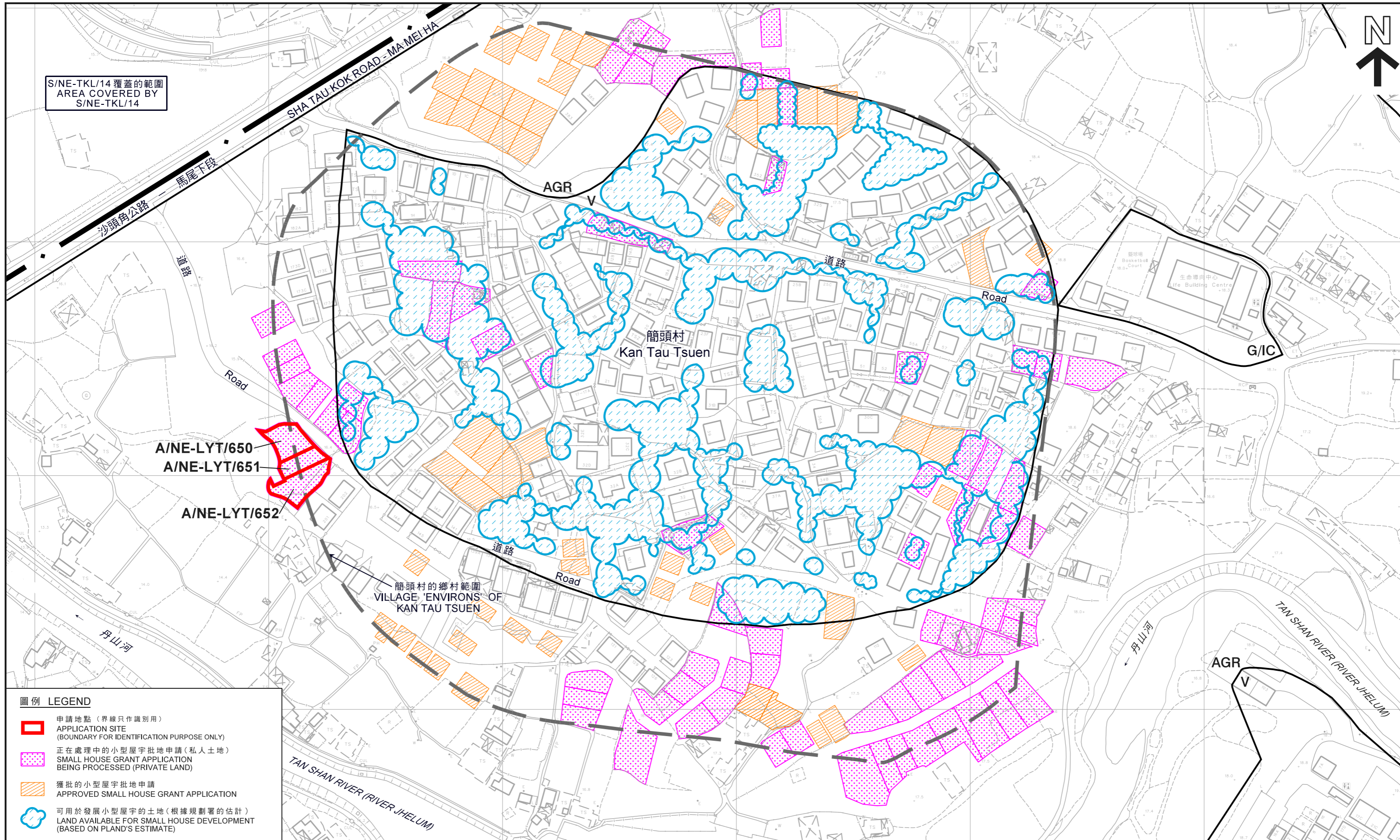

A/NE-LYT/650
A/NE-LYT/651

A/NE-LYT/652

簡頭村的鄉村範圍
VILLAGE 'ENVIRONS' OF
KAN TAU TSUEN

圖例 LEGEND

-  申請地點 (界線只作識別用)
APPLICATION SITE
(BOUNDARY FOR IDENTIFICATION PURPOSE ONLY)
-  正在處理中的小型屋宇批地申請 (私人土地)
SMALL HOUSE GRANT APPLICATION
BEING PROCESSED (PRIVATE LAND)
-  獲批的小型屋宇批地申請
APPROVED SMALL HOUSE GRANT APPLICATION
-  可用於發展小型屋宇的土地 (根據規劃署的估計)
LAND AVAILABLE FOR SMALL HOUSE DEVELOPMENT
(BASED ON PLAND'S ESTIMATE)

本摘要圖於2018年5月21日擬備，
所根據的資料為測量圖編號
3-SW-4B 及 5A
EXTRACT PLAN PREPARED ON 21.5.2018
BASED ON SURVEY SHEETS No. 3-SW-4B & 5A

在「鄉村式發展」地帶內預計可供發展小型屋宇的土地數量
ESTIMATED AMOUNT OF LAND AVAILABLE FOR
SMALL HOUSE DEVELOPMENT WITHIN THE "V" ZONE

三幢擬議屋宇 (新界豁免管制屋宇-小型屋宇)
NEW TERRITORIES EXEMPTED HOUSES - SMALL HOUSES
新界粉嶺簡頭村丈量約份第76約地段第1526號B分段、第1526號C分段及第1526號D分段
LOTS 1526 S.B, 1526 S.C AND 1526 S.D IN D.D. 76, KAN TAU TSUEN, FANLING, N.T.



規劃署
PLANNING
DEPARTMENT



參考編號
REFERENCE No.
A/NE-LYT/650,
651 & 652

圖 PLAN
A-2b

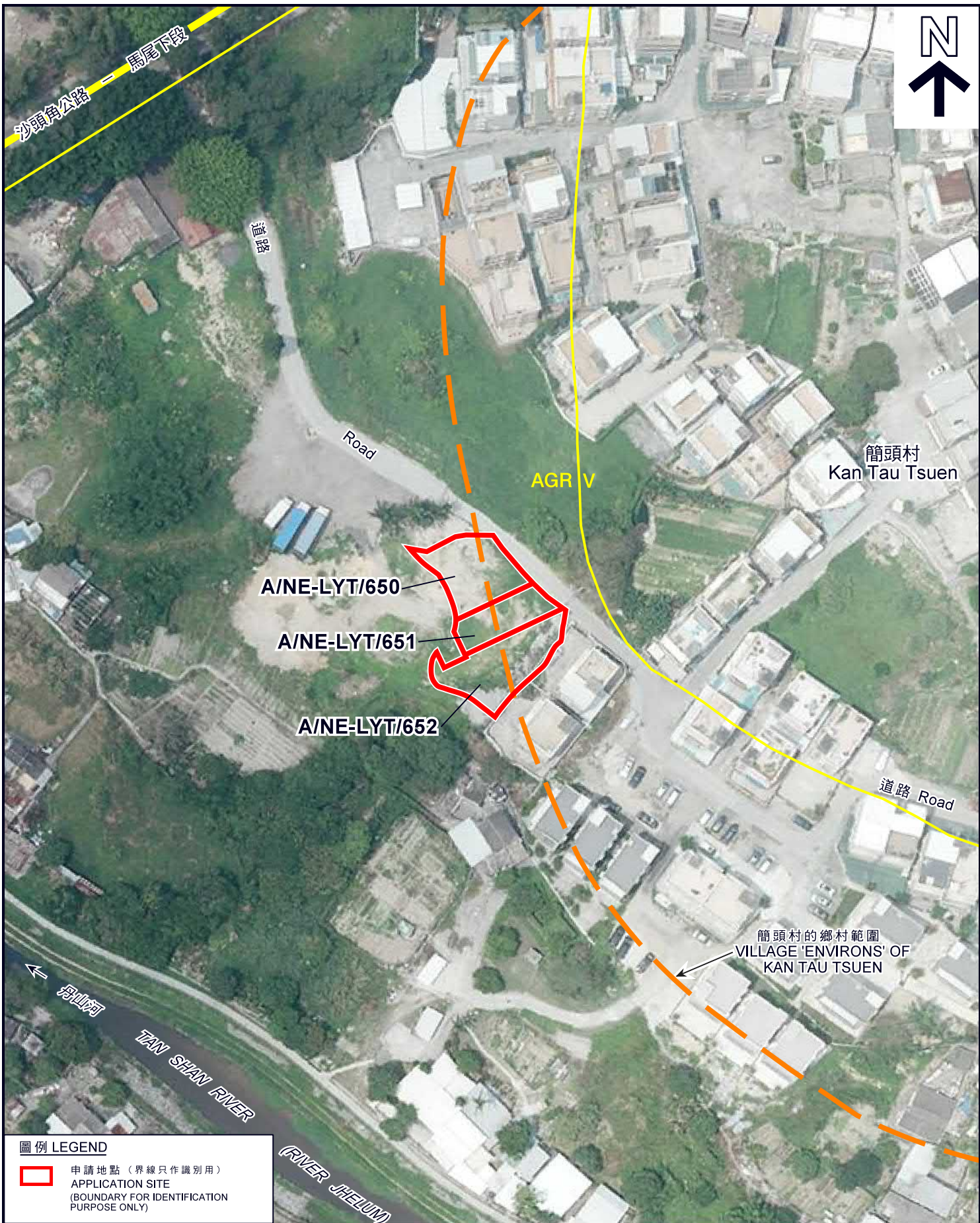

圖例 LEGEND

- 申請地點 (界線只作識別用)
APPLICATION SITE
(BOUNDARY FOR IDENTIFICATION
PURPOSE ONLY)

本摘要圖於2018年5月15日擬備，
所根據的資料為地政總署
於2017年4月18日拍得的航攝照片
編號E022599C
EXTRACT PLAN PREPARED ON 15.5.2018
BASED ON AERIAL PHOTO No. E022599C
TAKEN ON 18.4.2017 BY
LANDS DEPARTMENT

航攝照片 AERIAL PHOTO

三幢擬議屋宇 (新界豁免管制屋宇-小型屋宇)
新界粉嶺簡頭村丈量約份第76約地段第1526號B分段、
第1526號C分段及第1526號D分段
THREE PROPOSED HOUSES
(NEW TERRITORIES EXEMPTED HOUSES - SMALL HOUSES)
LOTS 1526 S.B, 1526 S.C AND 1526 S.D IN D.D. 76,
KAN TAU TSUEN, FANLING, N.T.

**規劃署
PLANNING
DEPARTMENT**



參考編號
REFERENCE No.
A/NE-LYT/650,
651 & 652

**圖 PLAN
A-3**

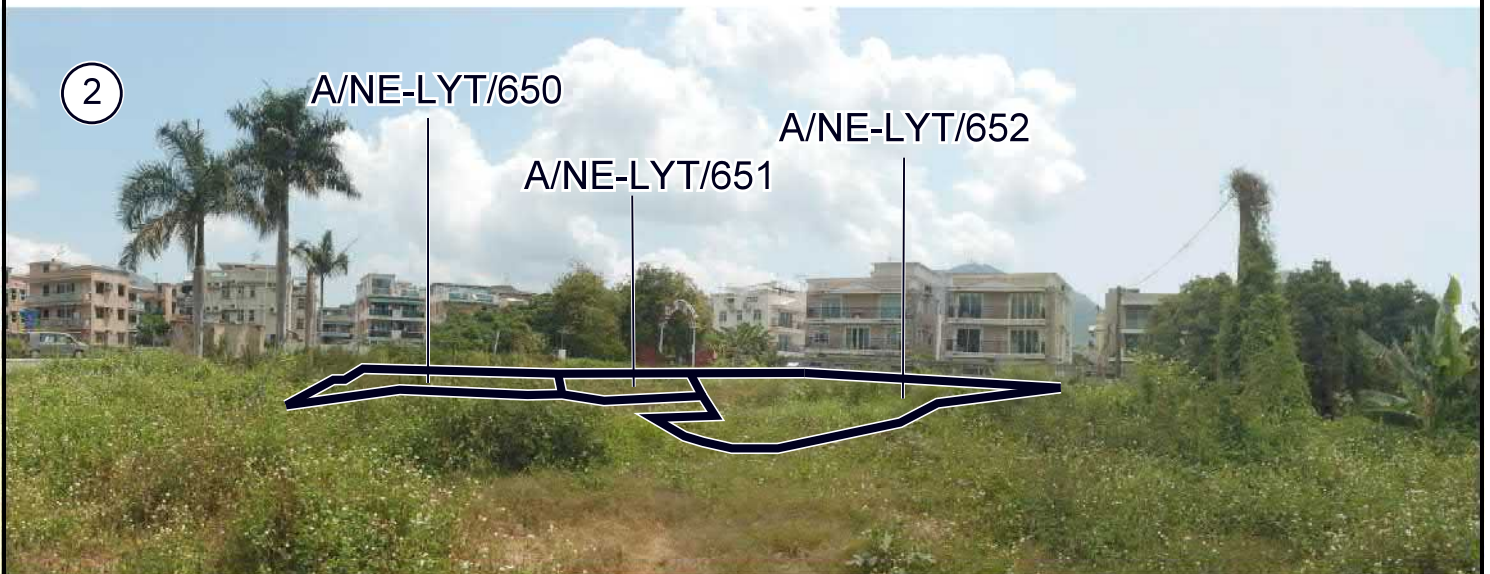

申請地點界線只作識別用
APPLICATION SITE BOUNDARY FOR IDENTIFICATION PURPOSE ONLY

實地照片 SITE PHOTOS

三幢擬議屋宇 (新界豁免管制屋宇-小型屋宇)
新界粉嶺簡頭村丈量約份第76約地段第1526號B分段、
第1526號C分段及第1526號D分段
THREE PROPOSED HOUSES
(NEW TERRITORIES EXEMPTED HOUSES - SMALL HOUSES)
LOTS 1526 S.B, 1526 S.C AND 1526 S.D IN D.D. 76,
KAN TAU TSUEN, FANLING, N.T.

規 劃 署
PLANNING
DEPARTMENT



參考編號
REFERENCE No.
A/NE-LYT/650,
651 & 652

圖 **PLAN**
A-4

本圖於2018年5月14日擬備，所根據的資料為攝於2018年4月10日的實地照片
PLAN PREPARED ON 14.5.2018 BASED ON SITE PHOTOS TAKEN ON 10.4.2018