

地段索引圖 LOT INDEX PLAN

擬議地盤平面圖 (附件B)



消防設施位置(滅火筒)	A
停泊車輛位	B
動物休息區	C
犬隻室內訓練區	D
犬隻室外訓練區	E
招待會員室	F
員工休息室	G
圍板加高至4m A1-A2	

政府原有排污渠

地政總署測繪處 Survey and Mapping

比例尺 SCALE 1:1000

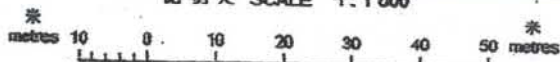

Locality : DD 83

Lot Index Plan No. : ND0312122013

District Survey Office : North

Date : 16-Dec-2013

Reference No. : 3-SW-4A, 3-SW-8B

香港特別行政區政府 版權所有

© Copyright reserved - Hong Kong SAR Government

SMO-P01

20131216093763 10

免責聲明

本圖則乃地段索引圖的副本，顯示地段界線的大概位置，包括根據政府土地、臨時政府土地、臨時租約及政府土地租用牌照而臨時佔用土地的位置。臨時佔用土地的情況可隨時增加或終止，因此圖內可劃分的區地段專員核實。本圖則所示的資料必須經過實地測量予以核實。當有更改或新的地界證據時，地段索引圖可能會被修訂而無須事先通知。

Disclaimer

This plan is a copy of the lot index plan showing the approximate location of lot boundaries, including the temporary occupation of land under Government Land Allocations, Temporary Government Land Allocations, Short-Term Tenancies and Government Land Licences. The temporary occupation of land may be created or terminated at short notice and should be confirmed with the District Lands Officer. The information shown on this plan **MUST** be verified by field survey. The lot index plan may be revised without prior notification as better or new boundary evidence

參考編號

REFERENCE No. A/NE-LYT/683

繪圖 DRAWING A-1

(來源： 附件 Id)
(Source : Appendix Id)

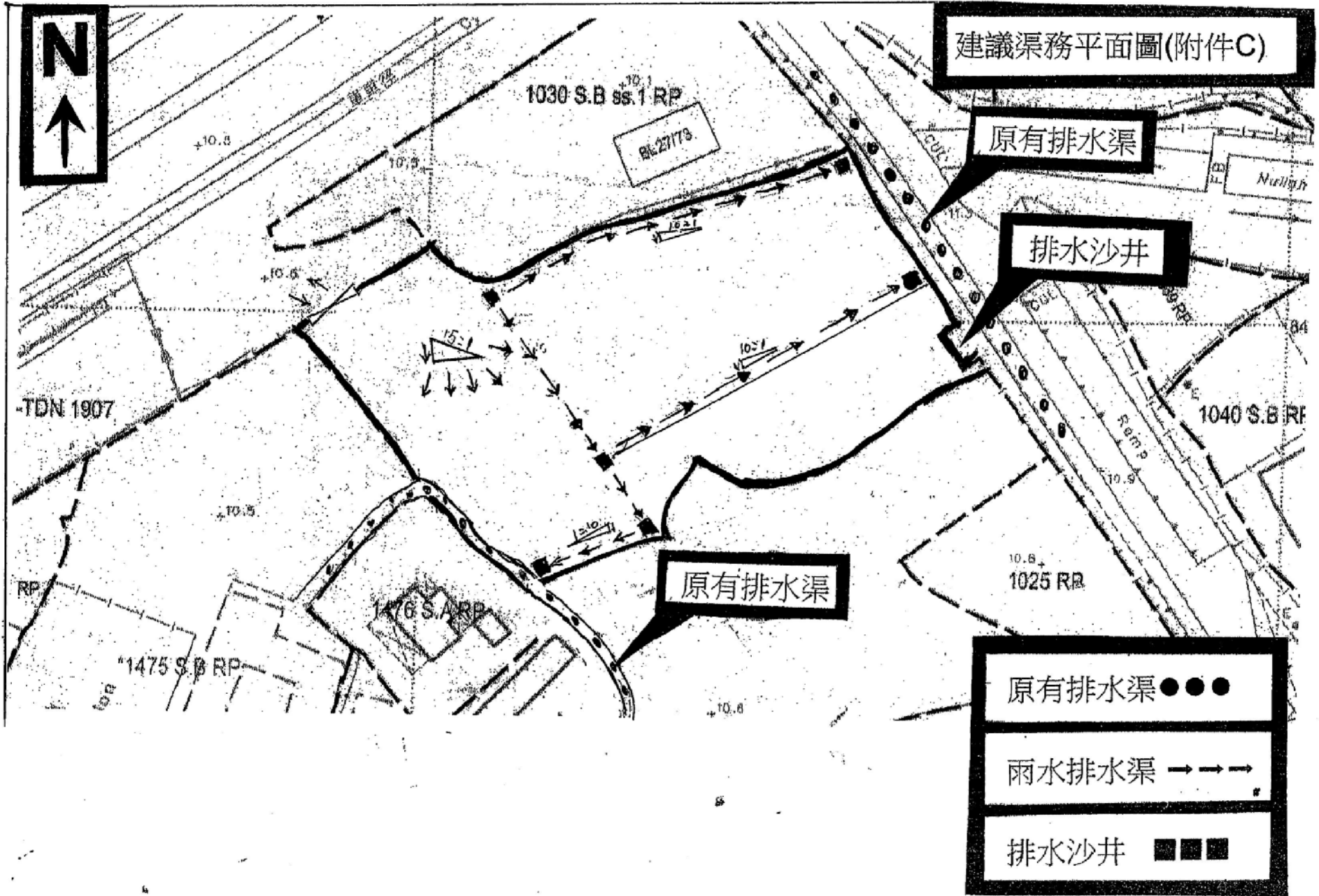

參考編號
REFERENCE No. A/NE-LYT/683

繪圖 DRAWING A-2

(來源 : 附件 I)
(Source : Appendix I)

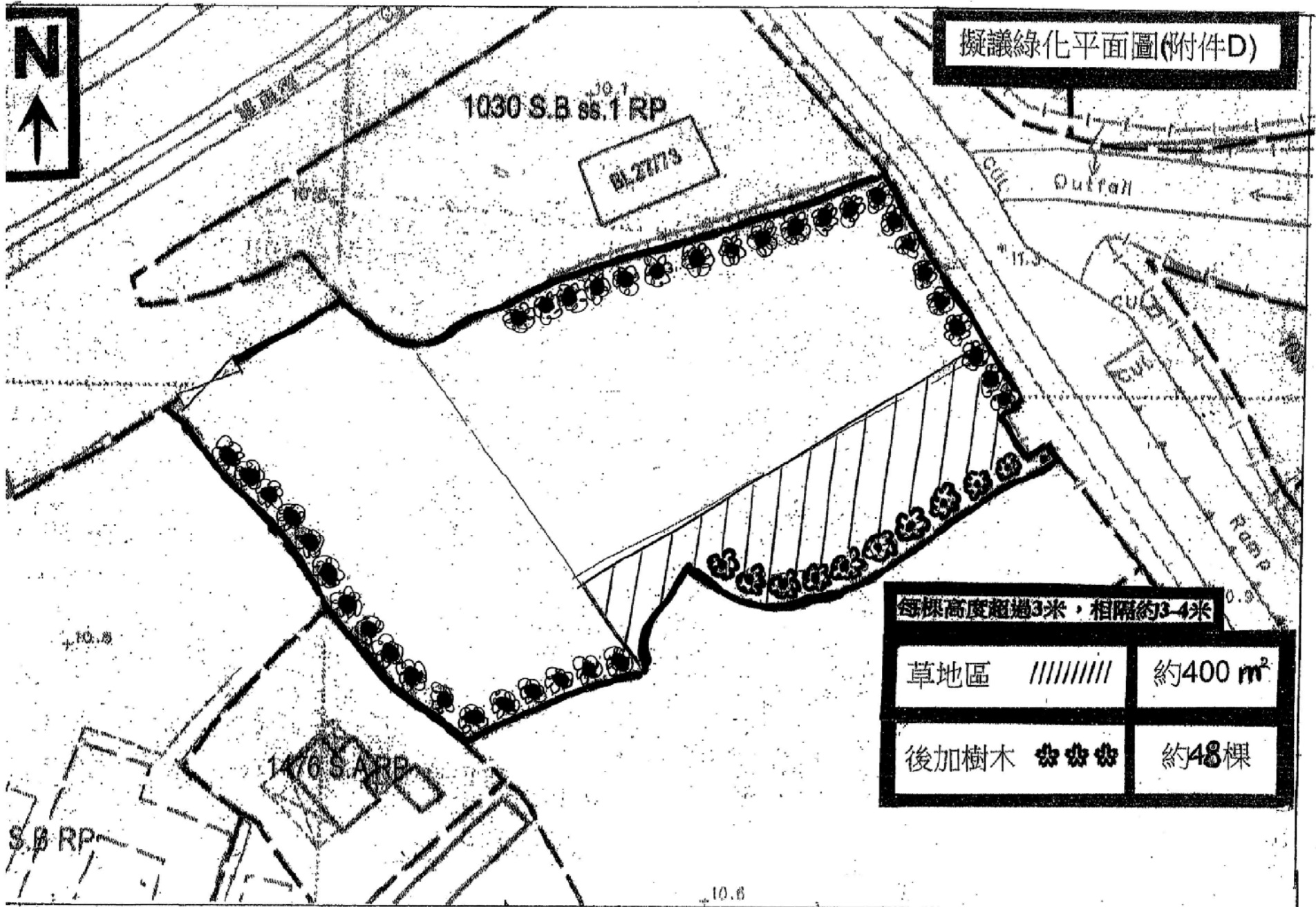

參考編號 REFERENCE No. A/NE-LYT/683 繪圖 DRAWING A-3

(來源： 附件 I)
(Source : Appendix I)

地段索引圖 LOT INDEX PLAN

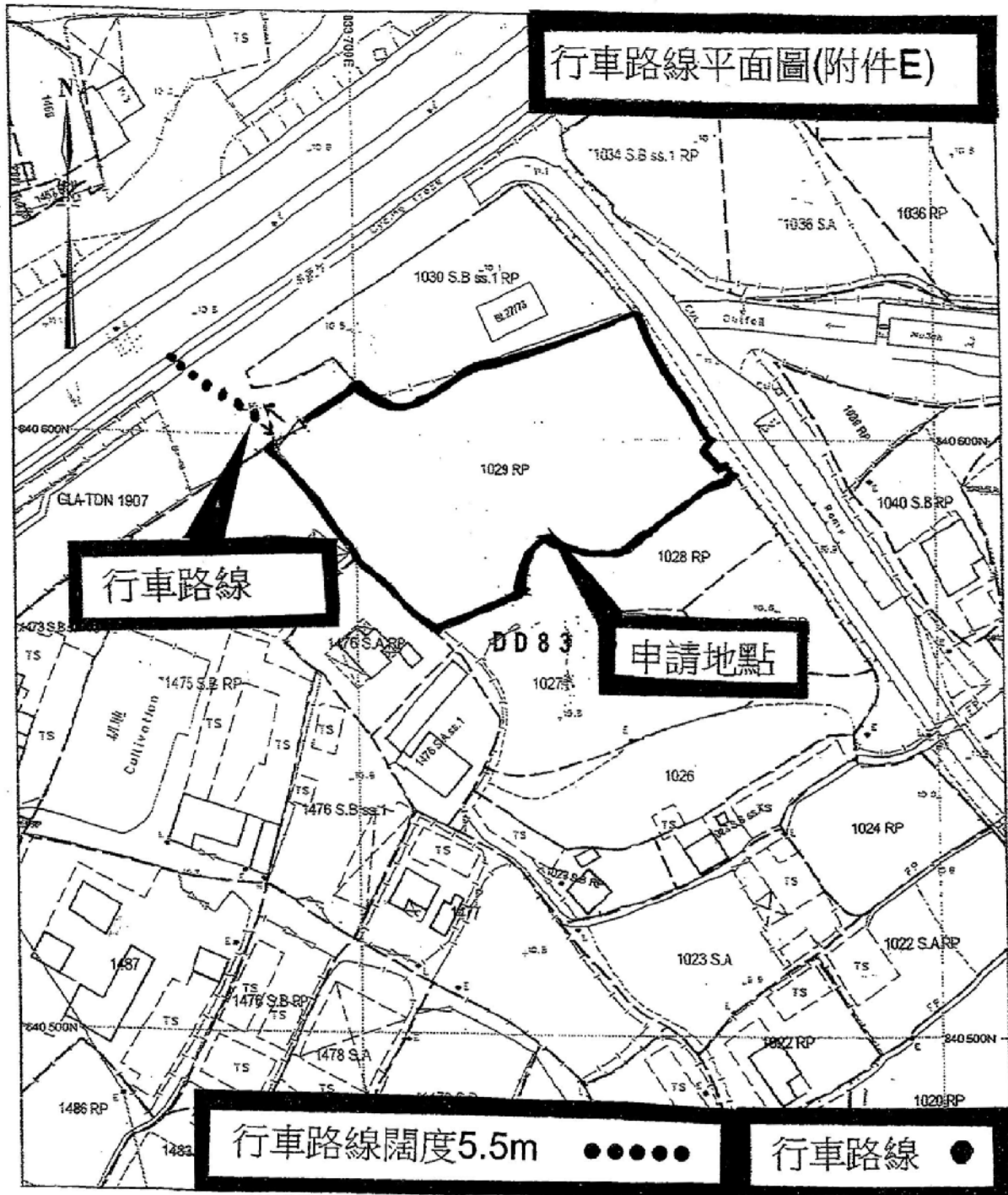

地政總署測繪處 Survey and Mapping Office, Lands Department

比例尺 SCALE 1:1,000

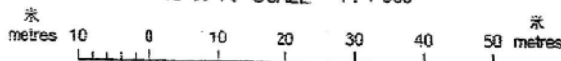

Locality : DD 83
 Lot Index Plan No. : ND0312122013
 District Survey Office : North
 Date : 16-Dec-2013
 Reference No. : 3-SW-3A,3-SW-8B

香港特別行政區政府 一 版權所有
 © Copyright reserved - Hong Kong SAR Government
 SMO-P01 20131216092753 10

免費聲明

本圖則乃地段索引圖的副本，顯示地段界線的大概位置，包括被業政府撥地、臨時政府撥地、短期租約及政府土地租用牌照而臨時佔用土地的位置。臨時佔用土地的情況可參照地政處通知出現或終止，因此應向有關的分區地政專員查詢。本圖則所顯示的資料必須透過實地測量予以核實。當有更佳或新的地界測量時，地段索引圖可能會被修訂而無須事先通知。

Disclaimer

This plan is a copy of the lot index plan showing the approximate location of lot boundaries, including the temporary occupation of land under Government Land Allocations, Temporary Government Land Allocations, Short Term Tenancies and Government Land Licences. The temporary occupation of land may be created or terminated at short notice and should be confirmed with the District Lands Officer. The information shown on this plan **MUST** be verified by field survey. The lot index plan may be revised without prior notification as better or more accurate information becomes available.

參考編號 REFERENCE No. A/NE-LYT/683

繪圖 DRAWING A-4

(來源： 附件 I)
 (Source : Appendix I)

地段索引圖 LOT INDEX PLAN

建議消防設施位置圖 (附件F)

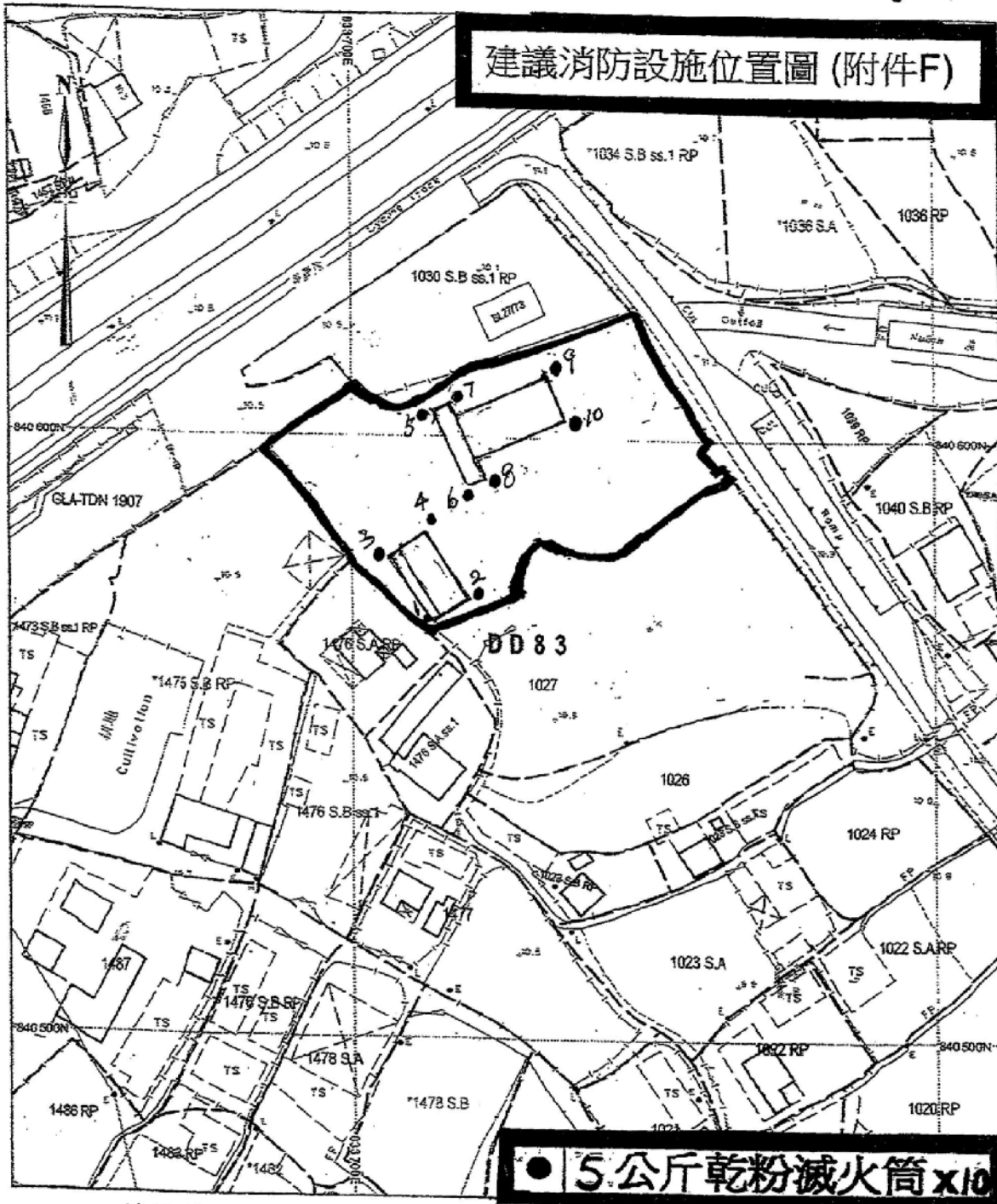

地政總署測繪處 Survey and Mapping Office, Lands Department

比例尺 SCALE 1:1000

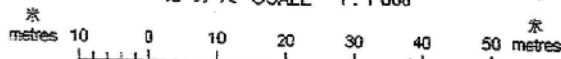

Locality : DD 83
 Lot Index Plan No. : ND0312122013
 District Survey Office : North
 Date : 16-Dec-2013
 Reference No. : 3-SW-SA,2-SW-SB
 香港特別行政區政府 版權所有
 © Copyright reserved - Hong Kong SAR Government
 SMO-P01 20131216092763 10

查閱聲明

本圖則乃地段索引圖的副本，顯示地段界線的大概位置，包括獲發政府地段、臨時政府地段、短期租約及政府土地用途牌照而臨時佔用土地的位置。臨時佔用土地的情況可藉短程通知出現或禁止，因此應向有關的分區地政專員核實。本圖則所示的資料必須經過實地測量予以核實。當有更改或新的地界審核時，地段索引圖可能會被修訂而無須事先通知。

Disclaimer

This plan is a copy of the lot index plan showing the approximate location of lot boundaries, including the temporary occupation of land under Government Land Allocations, Temporary Government Land Allocations, Short Term Tenancies and Government Land Licences. The temporary occupation of land may be created or terminated at short notice and should be confirmed with the District Lands Officer. The information shown on this plan **MUST** be verified by field survey. The lot index plan may be revised without prior notification.

參考編號 REFERENCE No. A/NE-LYT/683

繪圖 DRAWING A-5

(來源： 附件 I)
 (Source : Appendix I)

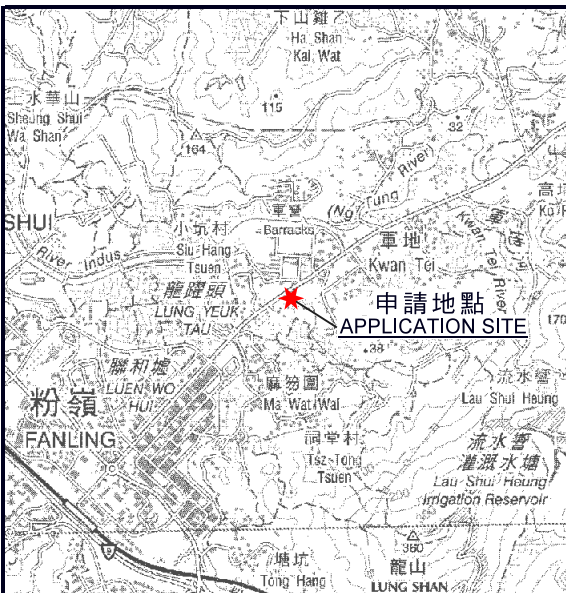
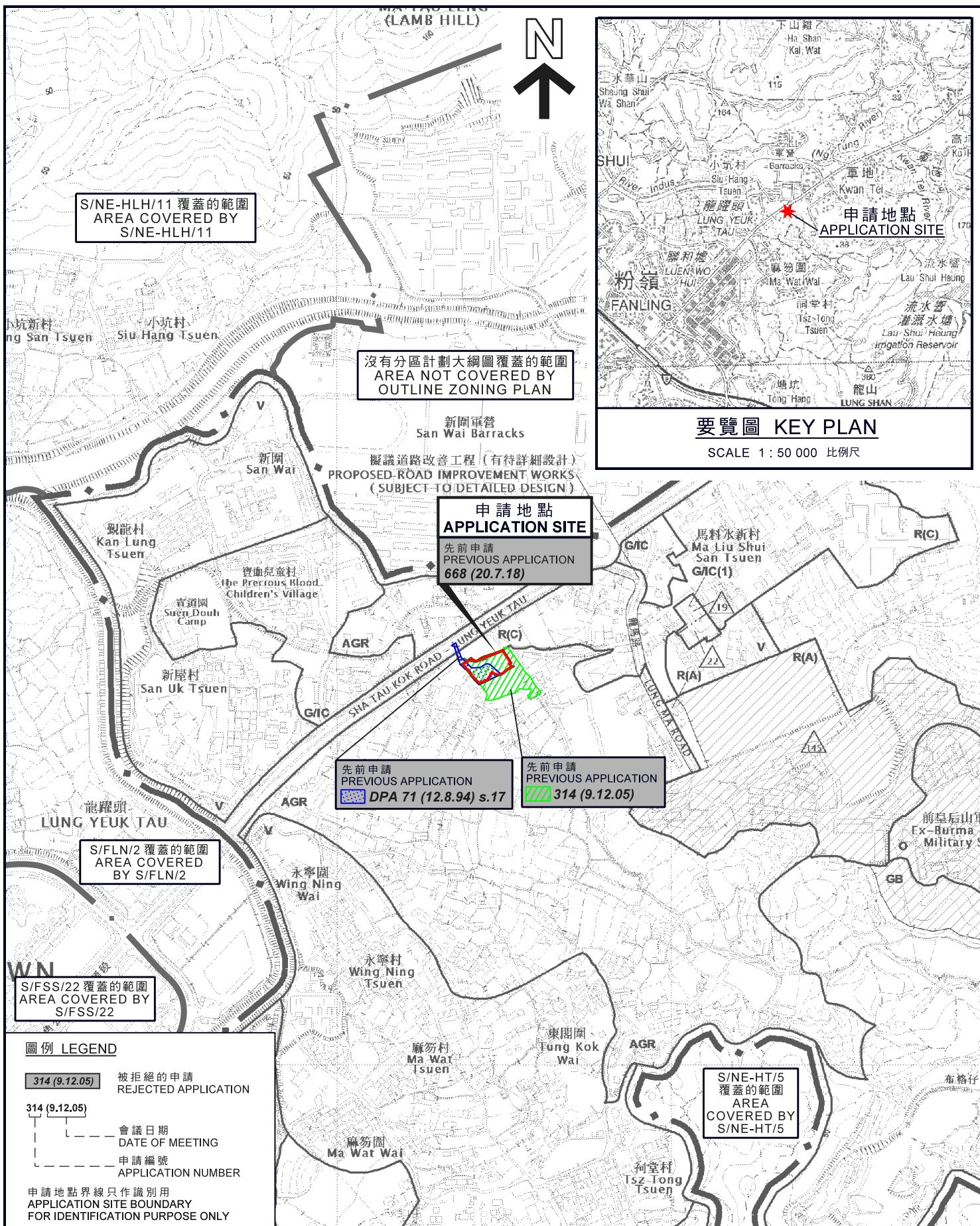

要覽圖 KEY PLAN

SCALE 1 : 50 000 比例尺

S/NE-HLH/11 覆蓋的範圍
AREA COVERED BY
S/NE-HLH/11

沒有分區計劃大綱圖覆蓋的範圍
AREA NOT COVERED BY
OUTLINE ZONING PLAN

擬議道路改善工程 (有待詳細設計)
PROPOSED ROAD IMPROVEMENT WORKS
(SUBJECT TO DETAILED DESIGN)

申請地點
APPLICATION SITE

先前申請
PREVIOUS APPLICATION
668 (20.7.18)

先前申請
PREVIOUS APPLICATION
DPA 71 (12.8.94) s.17

先前申請
PREVIOUS APPLICATION
314 (9.12.05)

S/FLN/2 覆蓋的範圍
AREA COVERED BY
S/FLN/2

S/FSS/22 覆蓋的範圍
AREA COVERED BY
S/FSS/22

圖例 LEGEND

- 314 (9.12.05) 被拒絕的申請
REJECTED APPLICATION
- 314 (9.12.05)
會議日期
DATE OF MEETING
- 314 (9.12.05)
申請編號
APPLICATION NUMBER
- 申請地點界線只作識別用
APPLICATION SITE BOUNDARY
FOR IDENTIFICATION PURPOSE ONLY

位置圖 LOCATION PLAN

擬議臨時動物寄養所及犬隻訓練中心 (為期3年)
新界粉嶺龍躍頭丈量約份第83約地段第1029號餘段
PROPOSED TEMPORARY ANIMAL BOARDING ESTABLISHMENT
AND DOG TRAINING CENTRE FOR A PERIOD OF 3 YEARS
LOT 1029 RP IN D.D. 83, LUNG YEUK TAU, FANLING, N.T.

規劃署
PLANNING
DEPARTMENT



參考編號
REFERENCE No.
A/NE-LYT/683

圖 PLAN
A-1

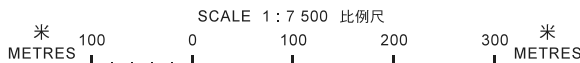

本摘要圖於2019年4月8日擬備，
所根據的資料為於2016年2月2日核准的
分區計劃大綱圖編號S/NE-LYT/17
EXTRACT PLAN PREPARED ON 8.4.2019
BASED ON OUTLINE ZONING PLAN
No. S/NE-LYT/17 APPROVED ON 2.2.2016

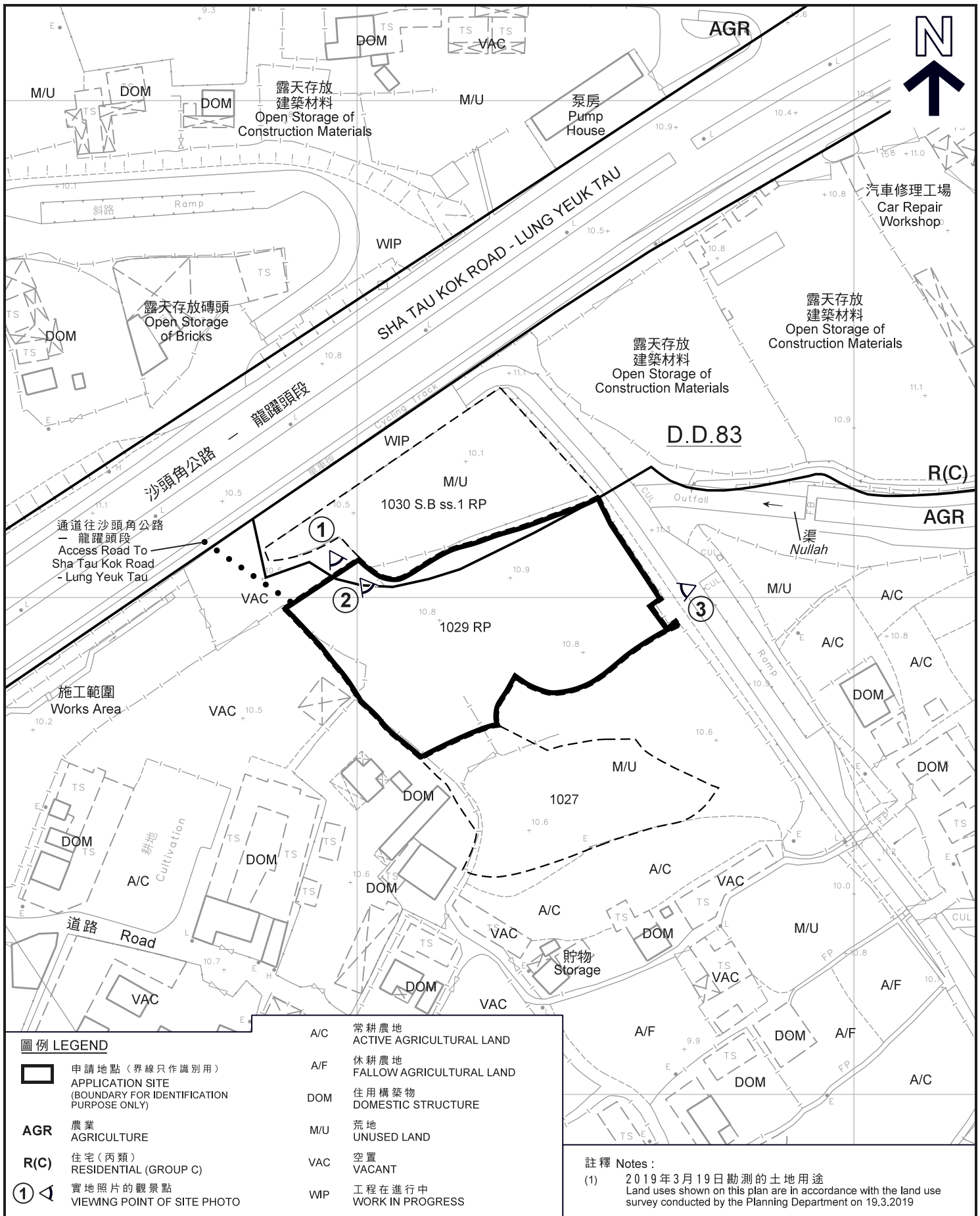

圖例 LEGEND

- 申請地點 (界線只作識別用)
APPLICATION SITE
(BOUNDARY FOR IDENTIFICATION
PURPOSE ONLY)
- AGR** 農業
AGRICULTURE
- R(C)** 住宅(丙類)
RESIDENTIAL (GROUP C)
- 實地照片的觀景點
VIEWING POINT OF SITE PHOTO

- A/C 常耕農地
ACTIVE AGRICULTURAL LAND
- A/F 休耕農地
FALLOW AGRICULTURAL LAND
- DOM 住用構築物
DOMESTIC STRUCTURE
- M/U 荒地
UNUSED LAND
- VAC 空置
VACANT
- WIP 工程在進行中
WORK IN PROGRESS

註釋 Notes:

- (1) 2019年3月19日勘测的土地用途
Land uses shown on this plan are in accordance with the land use
survey conducted by the Planning Department on 19.3.2019

平面圖 SITE PLAN

本摘要圖於2019年4月2日擬備，
所根據的資料為測量圖編號
3-SW-8A及8B
EXTRACT PLAN PREPARED ON 2.4.2019
BASED ON SURVEY SHEETS No.
3-SW-8A & 8B

擬議臨時動物寄養所及犬隻訓練中心 (為期3年)
新界粉嶺龍躍頭丈量約份第83約地段第1029號餘段
PROPOSED TEMPORARY ANIMAL BOARDING ESTABLISHMENT
AND DOG TRAINING CENTRE FOR A PERIOD OF 3 YEARS
LOT 1029 RP IN D.D. 83, LUNG YEUK TAU, FANLING, N.T.

**規劃署
PLANNING
DEPARTMENT**



參考編號
REFERENCE No.
A/NE-LYT/683

**圖 PLAN
A-2**

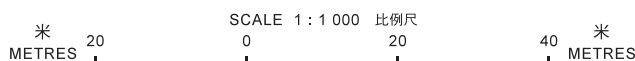



SHA TAU KOK ROAD - LUNG YEUK TAU

沙頭角公路 — 龍躍頭段



道路 Road

圖例 LEGEND

 申請地點 (界線只作識別用)
APPLICATION SITE
(BOUNDARY FOR IDENTIFICATION
PURPOSE ONLY)

本摘要圖於2019年3月21日擬備，
所根據的資料為地政總署
於2018年4月10日拍得的航攝照片
編號E040463C
EXTRACT PLAN PREPARED ON 21.3.2019
BASED ON AERIAL PHOTO No. E040463C
TAKEN ON 10.4.2018 BY
LANDS DEPARTMENT

航攝照片 AERIAL PHOTO

擬議臨時動物寄養所及犬隻訓練中心 (為期3年)
新界粉嶺龍躍頭丈量約份第83約地段第1029號餘段
PROPOSED TEMPORARY ANIMAL BOARDING ESTABLISHMENT
AND DOG TRAINING CENTRE FOR A PERIOD OF 3 YEARS
LOT 1029 RP IN D.D. 83, LUNG YEUK TAU, FANLING, N.T.

規劃署
PLANNING
DEPARTMENT



參考編號
REFERENCE No.
A/NE-LYT/683

圖 PLAN
A-3



實地照片 SITE PHOTOS

本圖於2019年3月22日擬備，所根據的資料為攝於2019年3月19日的實地照片
PLAN PREPARED ON 22.3.2019 BASED ON SITE PHOTOS TAKEN ON 19.3.2019

擬議臨時動物寄養所及犬隻訓練中心（為期3年）
新界粉嶺龍躍頭丈量約份第83約地段第1029號餘段
PROPOSED TEMPORARY ANIMAL BOARDING ESTABLISHMENT AND DOG TRAINING CENTRE FOR A PERIOD OF 3 YEARS
LOT 1029 RP IN D.D. 83, LUNG YEUK TAU, FANLING, N.T.

規劃署
PLANNING
DEPARTMENT



參考編號
REFERENCE No.
A/NE-LYT/683

圖 PLAN
A-4