

# Proposed Small House Location Plan – D.D. 218

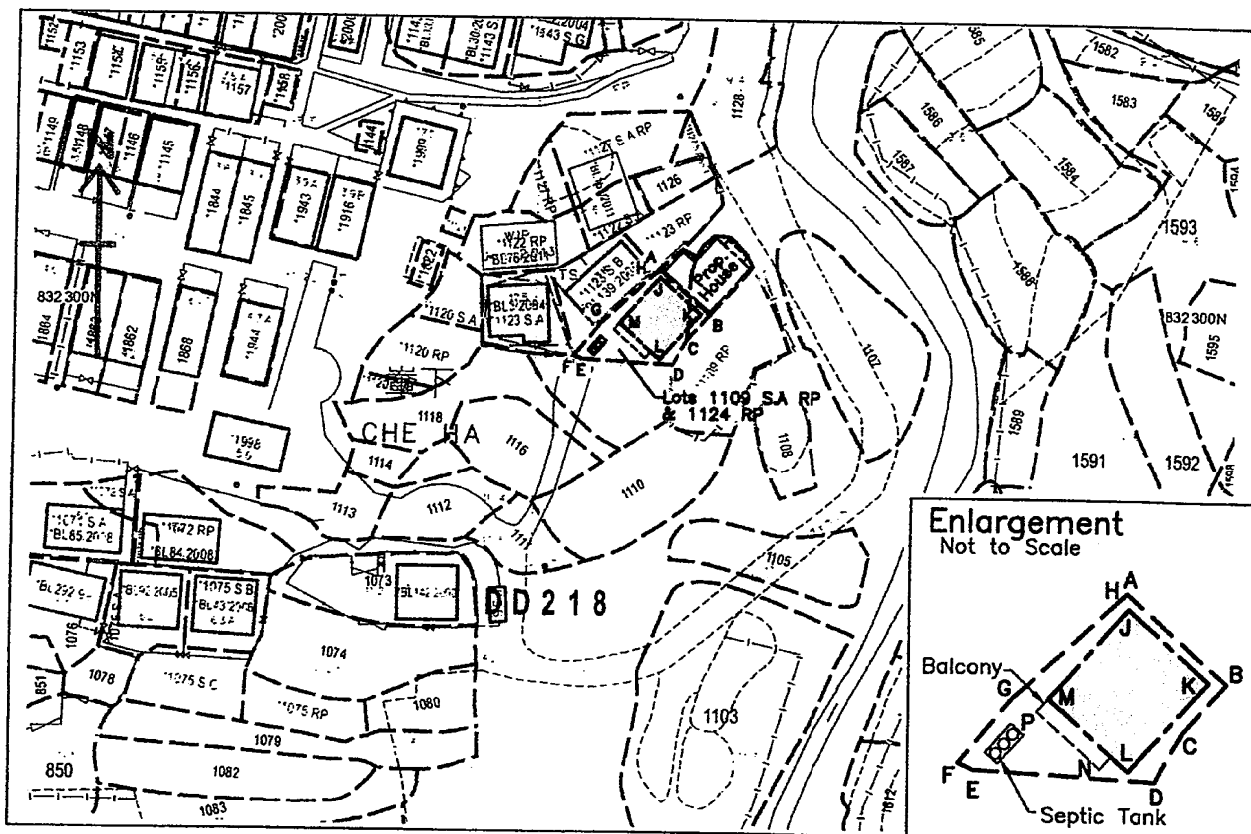

Survey Sheet No.: 8-NW-16A

Scale 1 : 1,000

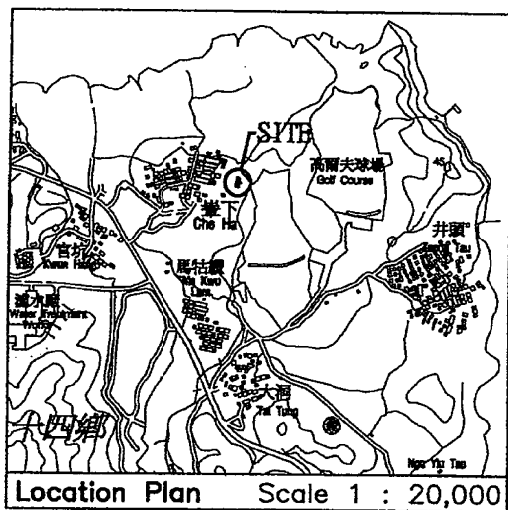

Location Plan Scale 1 : 20,000

## CHE HA

Lot Nos. 1109 S.A RP & 1124 RP

Boundary Dimensions: (Area = 136.5 sqm)

From To	Bearing (d-m-s)	Distance (m)	Pt.	N	E
A B	131°31'18"	9.444	A	832 305.030	845 217.322
B C	221°31'18"	4.650	B	832 298.769	845 224.393
C D	209°18'21"	4.027	C	832 295.288	845 221.311
D E	273°13'31"	12.828	D	832 291.776	845 219.340
E F	294°33'59"	1.191	E	832 292.498	845 206.532
F G	39°37'40"	5.898	F	832 292.993	845 205.449
G H	47°15'55"	10.681	G	832 297.536	845 209.211
H A	47°16'47"	0.363	H	832 304.784	845 217.056

Proposed Small House Dimensions: (Area = 65.03 sqm)

From To	Bearing (d-m-s)	Distance (m)	Pt.	N	E
J K	131°31'18"	7.620	J	832 303.922	845 217.442
K L	221°31'18"	8.534	K	832 298.871	845 223.147
L M	34°13'18"	7.620	L	832 292.481	845 217.490
M J	41°31'18"	8.534	M	832 297.533	845 211.785

Proposed Balcony Dimensions: (Area = 7.32 sqm)

From To	Bearing (d-m-s)	Distance (m)	Pt.	N	E
M L	131°31'18"	6.000	M	832 297.533	845 211.785
N P	221°31'18"	1.220	N	832 293.555	845 216.277
P M	311°31'18"	6.000	P	832 292.642	845 215.469
P M	41°31'18"	1.220	P	832 296.619	845 210.976

Plan prepared by:  
Henry Chan Surveyors Limited

Henry H K Chan  
BSc MRICS FHKIS RPS(LSD)  
Authorized Land Surveyor

G/F, No. 2 Yan Wo Lane, Tai Po, New Territories

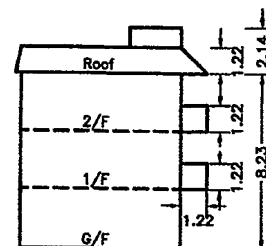

Plan No. : HC-10670/H02 Date: 22 Mar. 2017

Tel: 2638-1313 Fax: 2638-1328

參考編號  
REFERENCE No. A/NE-SSH/128

繪圖 DRAWING A-1

# 地段索引圖 LOT INDEX PLAN 附件 II

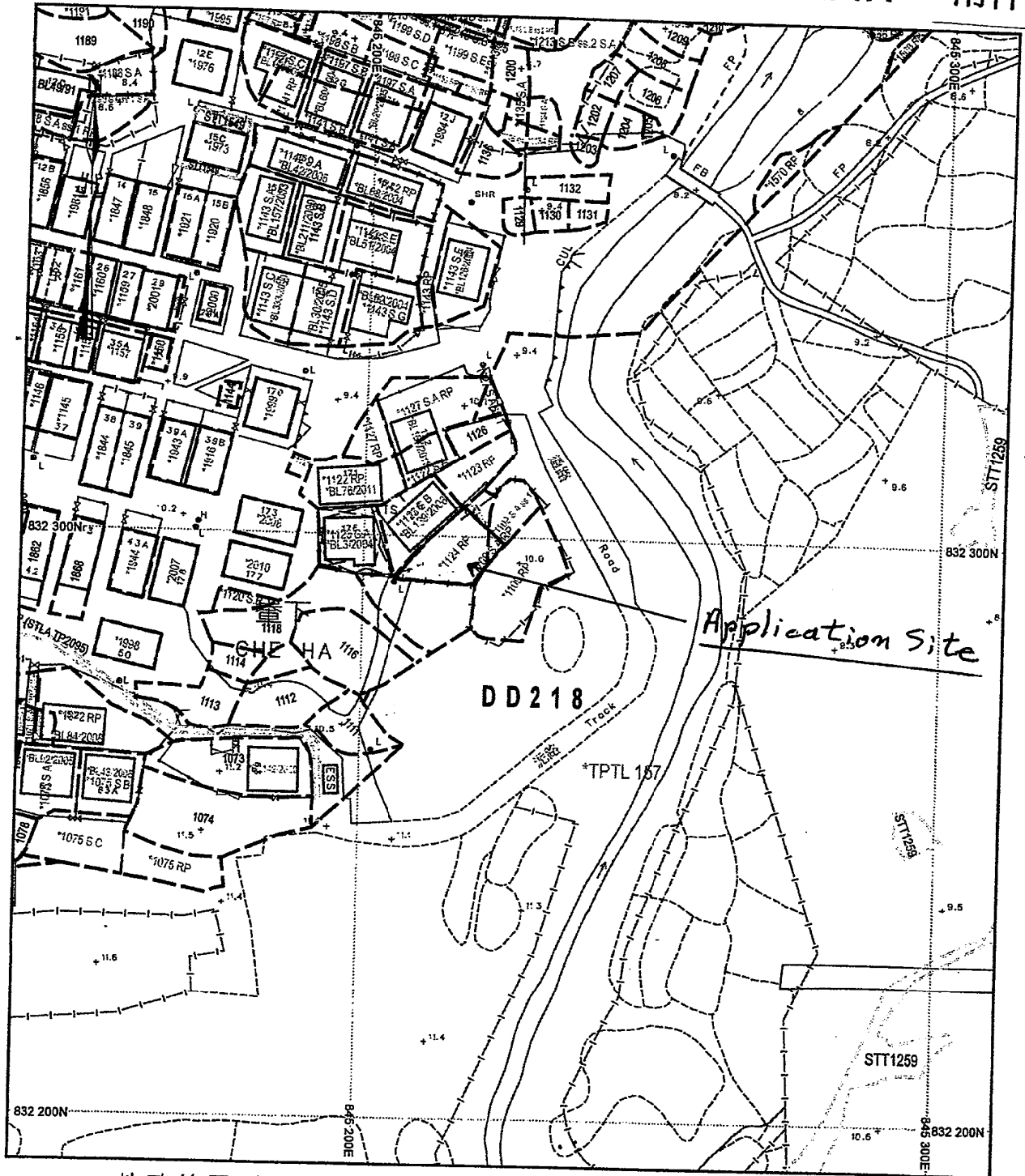

地政總署測繪處 Survey and Mapping Office, Lands Department

比例尺 SCALE 1:1 000

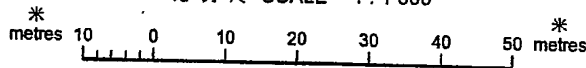

Locality : \_\_\_\_\_  
 Lot Index Plan No. : TP0246012019  
 District Survey Office : Tai Po  
 Date : 22-Jan-2019  
 Reference No. : 8-NW-16A

香港特別行政區政府 一 版權所有  
 © Copyright reserved - Hong Kong SAR Government  
 SMO-P01 20190122101450 10

**免責聲明**

本圖則乃地段索引圖的複本，顯示地段界線的大概位置，包括根據政府撥地、臨時政府撥地、短期租約及政府管業牌照而臨時佔用土地的位置。臨時佔用土地的情況可憑藉短期租約或牌照證明，因此應向有關的分區地政專員核證。本圖則所示的資料必須透過實地查量予以核實。當有更佳或新的地界證據時，地段索引圖可能會經修訂而無須事先通知。

**Disclaimer**

This plan is a copy of the lot index plan showing the approximate location of lot boundaries, including the temporary occupation of land under Government Land Allocations, Temporary Government Licences, Government Grants, Short Term Tenancies and Government Land Licences. The temporary occupation of land may be created or terminated at short notice and should be confirmed with the District Lands Officer. The information shown on this plan **MUST** be verified by field survey. The lot index plan may be revised without prior notification as better or new boundary evidence becomes available.

參考編號 REFERENCE No. A/NE-SSH/128

繪圖 DRAWING A-2







這是1990年9月7日在憲報公布的中期發展審批地區圖編號  
IDPA/NE-SSH/1 沒有涵蓋的範圍，但已包括在首次公布  
的十四鄉分區計劃大綱草圖編號 S/NE-SSH/6 的規劃區內。  
AREA NOT FALLING WITHIN THE BOUNDARIES OF THE IDPA  
PLAN No. IDPA / NE-SSH / 1 PUBLISHED IN THE GAZETTE ON  
7.9.1990 BUT INCLUDED IN THE PLANNING SCHEME AREA ON  
THE FIRST PUBLICATION OF THE DRAFT SHAP SZ HEUNG  
OUTLINE ZONING PLAN No. S / NE-SSH / 6.

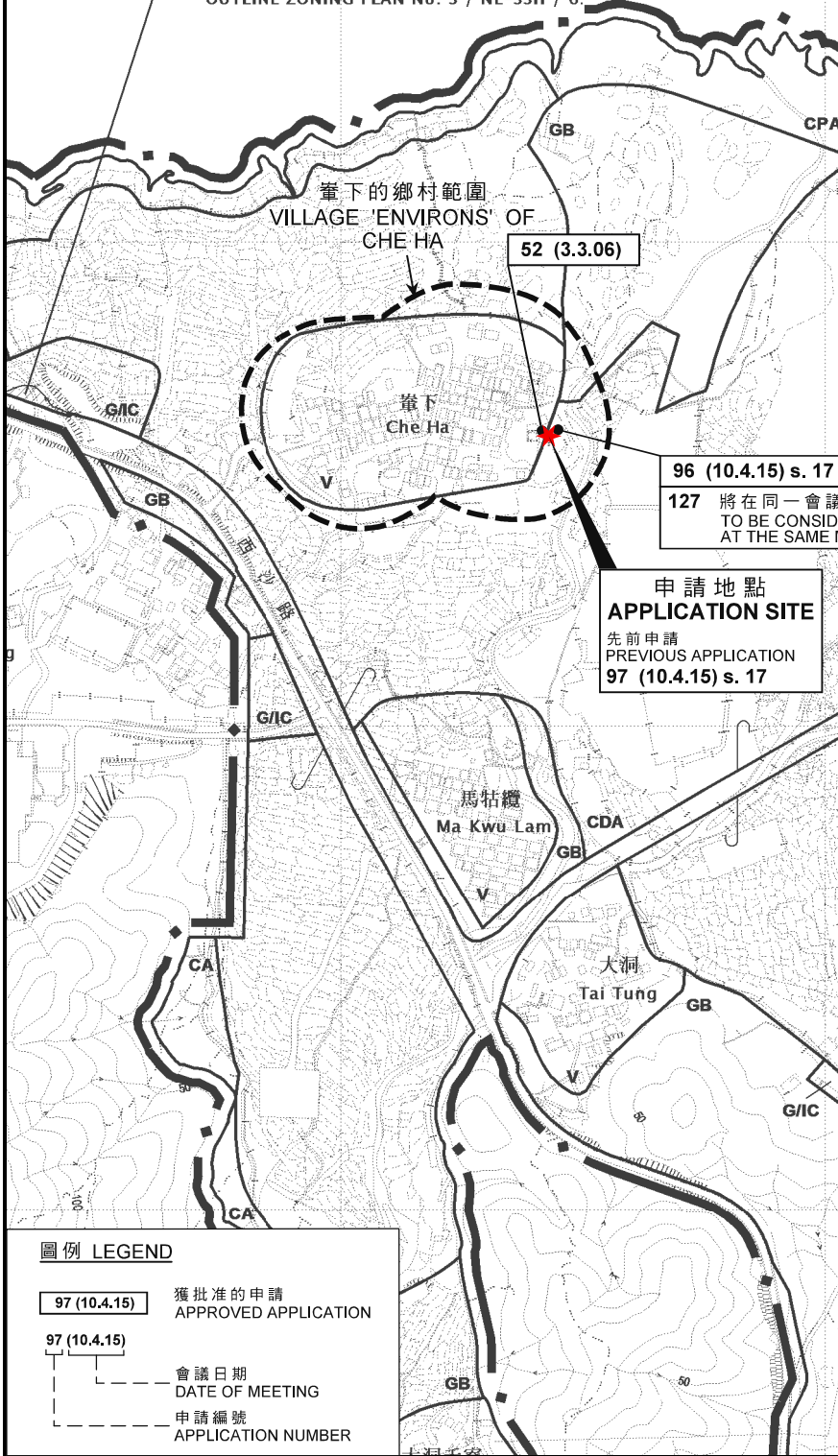

**要覽圖 KEY PLAN**

SCALE 1 : 50 000 比例尺

96 (10.4.15) s. 17  
127 將在同一會議中考慮  
TO BE CONSIDERED  
AT THE SAME MEETING

**申請地點 APPLICATION SITE**  
先前申請  
PREVIOUS APPLICATION  
97 (10.4.15) s. 17

**圖例 LEGEND**

- 97 (10.4.15) 獲批准的申請  
APPROVED APPLICATION
- 97 (10.4.15) 會議日期  
DATE OF MEETING
- 97 (10.4.15) 申請編號  
APPLICATION NUMBER

**位置圖 LOCATION PLAN**

擬議屋宇 (新界豁免管制屋宇—小型屋宇) 及略為放寬總樓面面積限制  
新界西貢北十四鄉峇下村丈量約份第218約地段  
第1109號A分段餘段及第1124號餘段  
PROPOSED HOUSE (NEW TERRITORIES EXEMPTED HOUSE - SMALL HOUSE)  
AND MINOR RELAXATION OF GROSS FLOOR AREA RESTRICTIONS  
LOTS 1109 S.A RP AND 1124 RP IN D.D.218, CHE HA VILLAGE,  
SHAP SZ HEUNG, SAI KUNG NORTH, NEW TERRITORIES

SCALE 1 : 7 500 比例尺  
米 100 0 100 200 300 米  
METRES

**規劃署  
PLANNING  
DEPARTMENT**



參考編號  
REFERENCE No.  
**A/NE-SSH/128**

**圖 PLAN  
A-1**

本摘要圖於2019年4月9日擬備，  
所根據的資料為於2015年10月6日核准的  
分區計劃大綱圖編號S/NE-SSH/11  
EXTRACT PLAN PREPARED ON 9.4.2019  
BASED ON OUTLINE ZONING PLAN  
No. S/NE-SSH/11 APPROVED ON 6.10.2015



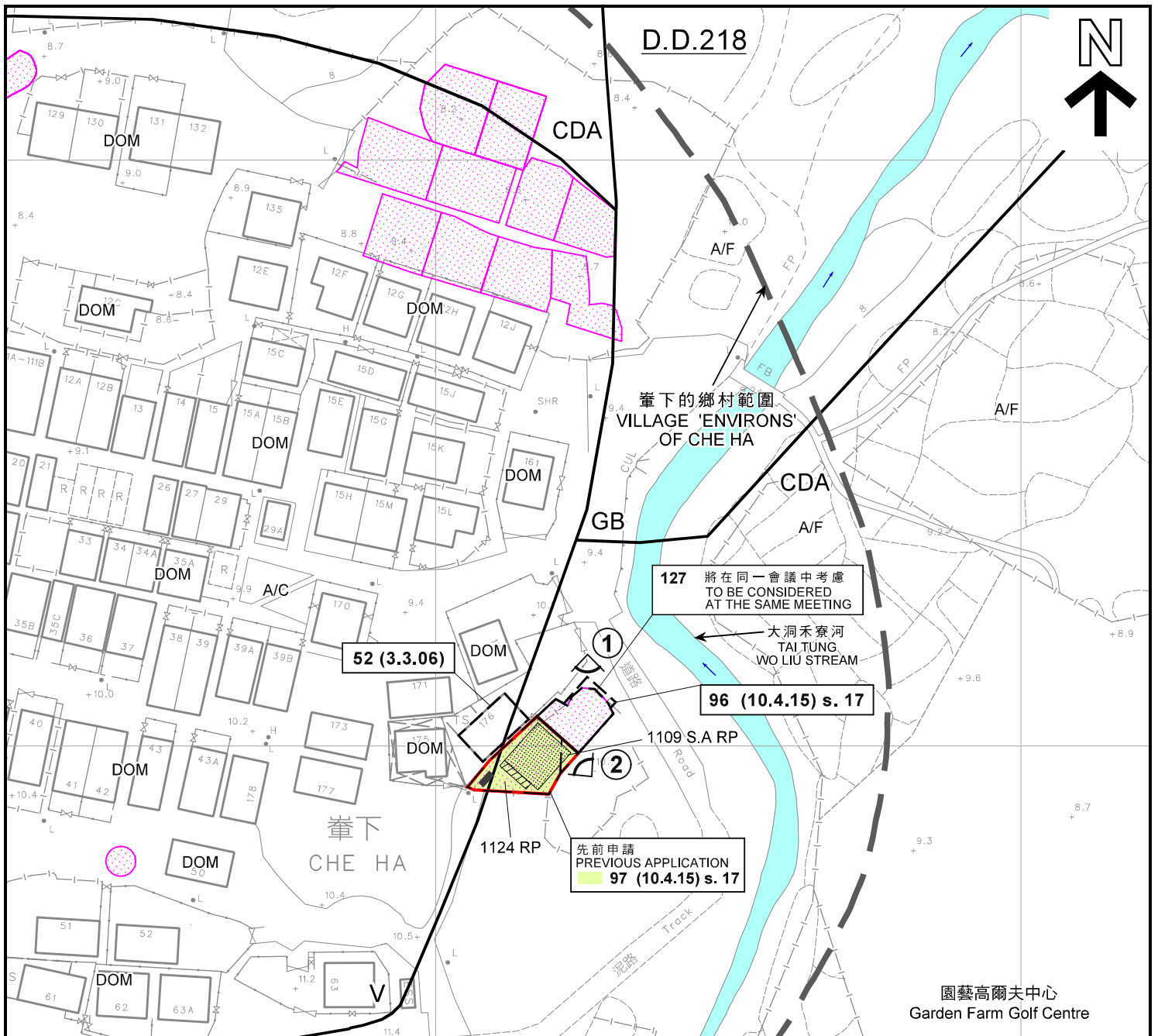

**圖例 LEGEND**

- |            |   |                     |   |
|------------|---|---------------------|---|
|            | 申請地點 (界線只作識別用)<br>APPLICATION SITE<br>(BOUNDARY FOR IDENTIFICATION<br>PURPOSE ONLY) | <b>GB</b>           | 綠化地帶<br>GREEN BELT                      |
|            | 擬議小型屋宇<br>PROPOSED SMALL HOUSE  | <b>A/C</b>          | 常耕農地<br>ACTIVE AGRICULTURAL LAND        |
|            | 擬議露台<br>PROPOSED BALCONY  | <b>A/F</b>          | 休耕農地<br>FALLOW AGRICULTURAL LAND        |
|            | 正在處理中的小型屋宇批地申請<br>SMALL HOUSE GRANT APPLICATION<br>BEING PROCESSED                  | <b>DOM</b>          | 住用構築物<br>DOMESTIC STRUCTURE             |
|            | 化糞池<br>SEPTIC TANK  | <b>96 (10.4.15)</b> | 獲批准的申請<br>APPROVED APPLICATION          |
| <b>V</b>   | 鄉村式發展<br>VILLAGE TYPE DEVELOPMENT   | <b>96 (10.4.15)</b> | 會議日期<br>DATE OF MEETING                 |
| <b>CDA</b> | 綜合發展區<br>COMPREHENSIVE<br>DEVELOPMENT AREA  |                     | 申請編號<br>APPLICATION NUMBER              |
|            |   | <b>①</b>            | 實地照片的觀景點<br>VIEWING POINT OF SITE PHOTO |

**註釋 Note :**

- (1) 2019年3月18日勘測的土地用途  
Land uses shown on this plan are in accordance with the land use survey conducted by the Planning Department on 18.3.2019

**平面圖 SITE PLAN**

本摘要圖於2019年4月29日擬備，  
所根據的資料為測量圖編號  
8-NW-11C及16A  
EXTRACT PLAN PREPARED ON 29.4.2019  
BASED ON SURVEY SHEETS No.  
8-NW-11C & 16A

擬議屋宇 (新界豁免管制屋宇 - 小型屋宇) 及略為放寬總樓面面積限制  
新界西貢北十四鄉峇下村丈量約份第218約地段  
第1109號A分段餘段及第1124號餘段  
PROPOSED HOUSE (NEW TERRITORIES EXEMPTED HOUSE - SMALL HOUSE)  
AND MINOR RELAXATION OF GROSS FLOOR AREA RESTRICTIONS  
LOTS 1109 S.A RP AND 1124 RP IN D.D.218, CHE HA VILLAGE,  
SHAP SZ HEUNG, SAI KUNG NORTH, NEW TERRITORIES

SCALE 1 : 1 000 比例尺  
米 20 0 20 40 米  
METRES

**規劃署**  
**PLANNING**  
**DEPARTMENT**



參考編號  
REFERENCE No.  
**A/NE-SSH/128**

**圖 PLAN**  
**A-2a**

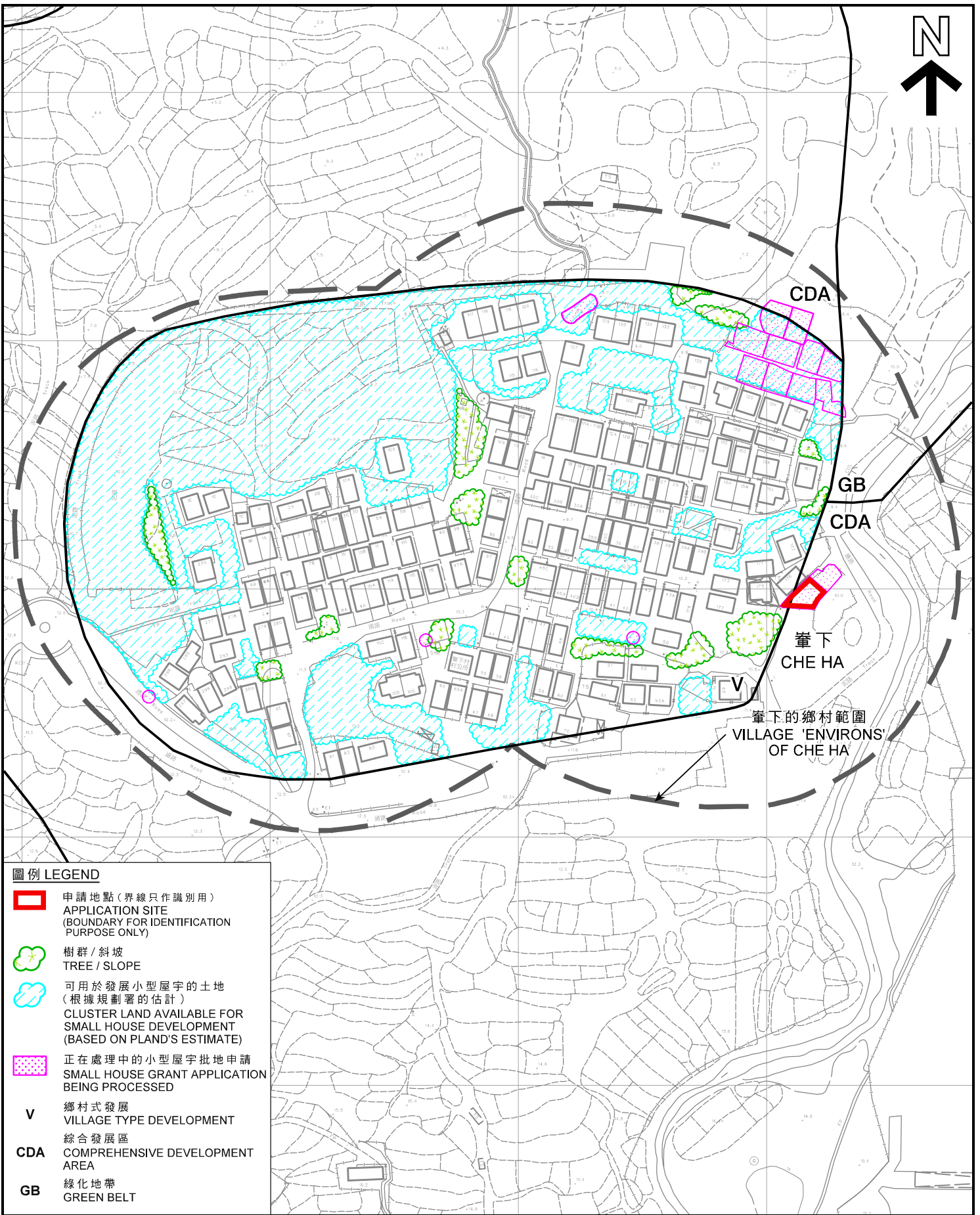

**圖例 LEGEND**

-  申請地點 (界線只作識別用)  
APPLICATION SITE  
(BOUNDARY FOR IDENTIFICATION  
PURPOSE ONLY)
-  樹群 / 斜坡  
TREE / SLOPE
-  可用於發展小型屋宇的土地  
(根據規劃署的估計)  
CLUSTER LAND AVAILABLE FOR  
SMALL HOUSE DEVELOPMENT  
(BASED ON PLAND'S ESTIMATE)
-  正在處理中的小型屋宇批地申請  
SMALL HOUSE GRANT APPLICATION  
BEING PROCESSED
- V** 鄉村式發展  
VILLAGE TYPE DEVELOPMENT
- CDA** 綜合發展區  
COMPREHENSIVE DEVELOPMENT  
AREA
- GB** 綠化地帶  
GREEN BELT

**在「鄉村式發展」地帶內預計可供發展小型屋宇的土地數量  
ESTIMATED AMOUNT OF LAND AVAILABLE FOR  
SMALL HOUSE DEVELOPMENT WITHIN THE "V" ZONE**

擬議屋宇 (新界豁免管制屋宇 - 小型屋宇) 及略為放寬總樓面面積限制  
新界西貢北十四鄉峴下村丈量約份第218約地段  
第1109號A分段餘段及第1124號餘段  
PROPOSED HOUSE (NEW TERRITORIES EXEMPTED HOUSE - SMALL HOUSE)  
AND MINOR RELAXATION OF GROSS FLOOR AREA RESTRICTIONS  
LOTS 1109 S.A RP AND 1124 RP IN D.D.218, CHE HA VILLAGE,  
SHAP SZ HEUNG, SAI KUNG NORTH, NEW TERRITORIES

SCALE 1 : 2 000 比例尺

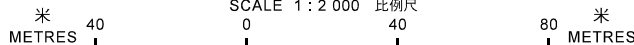

本摘要圖於2019年4月29日擬備，  
所根據的資料為測量圖編號  
7-NE-15D、20B、8-NW-11C及16A  
EXTRACT PLAN PREPARED ON 29.4.2019  
BASED ON SURVEY SHEETS No.  
7-NE-15D, 20B, 8-NW-11C & 16A

**規劃署  
PLANNING  
DEPARTMENT**



參考編號  
REFERENCE No.  
**A/NE-SSH/128**

圖 **PLAN  
A-2b**





圖例 LEGEND

-  申請地點 (界線只作識別用)  
APPLICATION SITE  
(BOUNDARY FOR IDENTIFICATION PURPOSE ONLY)

航攝照片 AERIAL PHOTO

本圖於2019年4月3日擬備，  
所根據的資料為地政總署  
於2018年3月13日拍得的航攝照片  
編號E035497C  
PLAN PREPARED ON 3.4.2019  
BASED ON AERIAL PHOTO No. E035497C  
TAKEN ON 13.3.2018 BY  
LANDS DEPARTMENT

擬議屋宇 (新界豁免管制屋宇 - 小型屋宇) 及略為放寬總樓面面積限制  
新界西貢北十四鄉簗下村丈量約份第218約地段  
第1109號A分段餘段及第1124號餘段  
PROPOSED HOUSE (NEW TERRITORIES EXEMPTED HOUSE - SMALL HOUSE)  
AND MINOR RELAXATION OF GROSS FLOOR AREA RESTRICTIONS  
LOTS 1109 S.A RP AND 1124 RP IN D.D.218, CHE HA VILLAGE,  
SHAP SZ HEUNG, SAI KUNG NORTH, NEW TERRITORIES

規劃署  
PLANNING  
DEPARTMENT



參考編號  
REFERENCE No.  
A/NE-SSH/128

圖 PLAN  
A-3



1



2



申請地點界線只作識別用  
APPLICATION SITE BOUNDARY FOR IDENTIFICATION PURPOSE ONLY

實地照片 SITE PHOTOS

本圖於2019年4月9日擬備，所根據的資料為攝於2019年3月15日的實地照片

PLAN PREPARED ON 9.4.2018  
BASED ON SITE PHOTOS  
TAKEN ON 15.3.2019

擬議屋宇（新界豁免管制屋宇－小型屋宇）及略為放寬總樓面面積限制  
新界西貢北十四鄉峯下村丈量約份第218約地段  
第1109號A分段餘段及第1124號餘段

PROPOSED HOUSE (NEW TERRITORIES EXEMPTED HOUSE - SMALL HOUSE)  
AND MINOR RELAXATION OF GROSS FLOOR AREA RESTRICTIONS  
LOTS 1109 S.A RP AND 1124 RP IN D.D.218, CHE HA VILLAGE,  
SHAP SZ HEUNG, SAI KUNG NORTH, NEW TERRITORIES

規 劃 署  
PLANNING  
DEPARTMENT



參考編號  
REFERENCE No.  
A/NE-SSH/128

圖 PLAN  
A-4



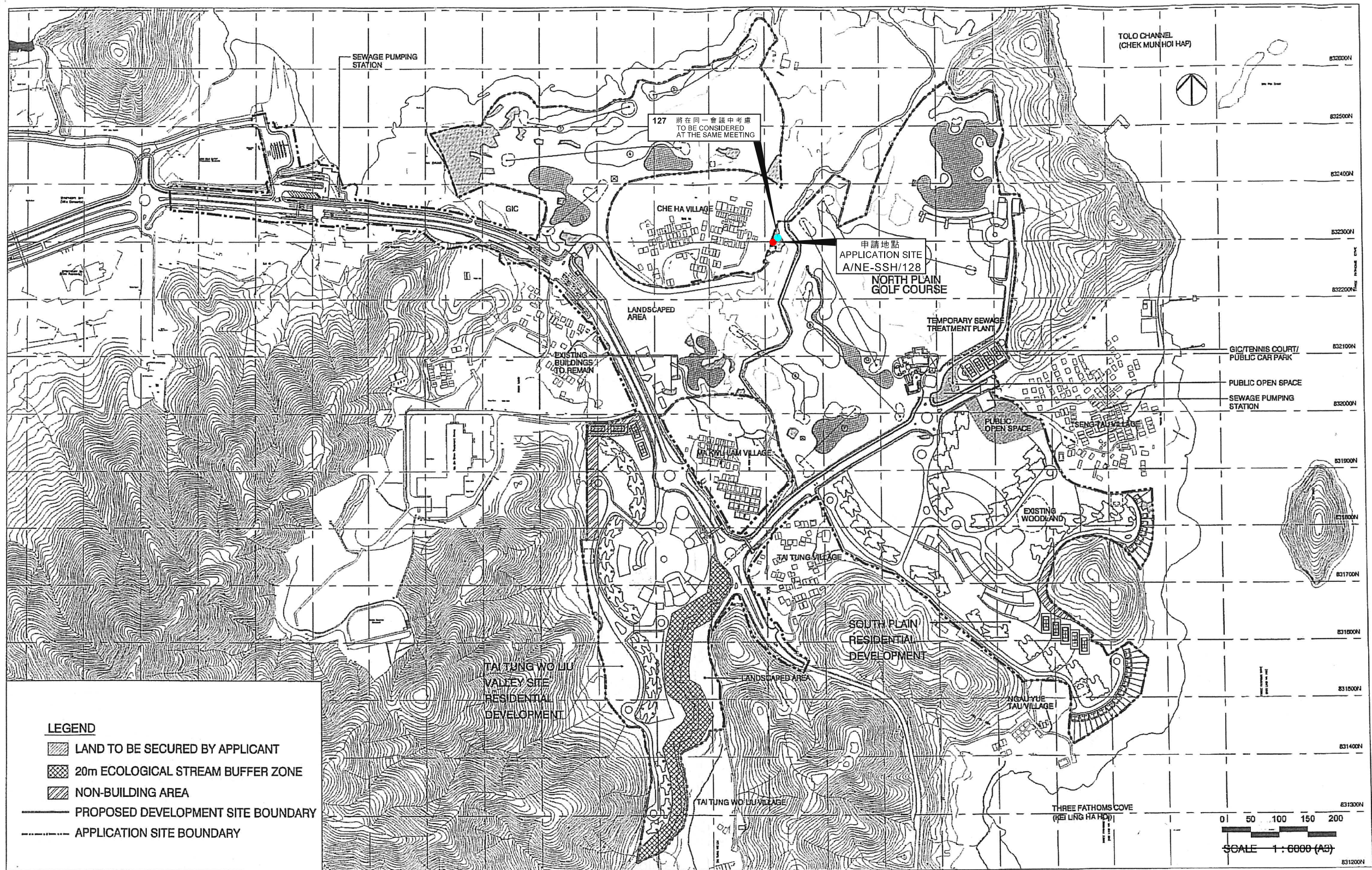

Figure 1c - Proposed MLP (Overall) (Application No. A/NE-SSH/61-1)

Drawing No.: Sai Sha MLP 01-3

17 Sept 2009

本摘要圖於2019年4月12日擬備，  
 所根據的資料為圖則編號  
 Sai Sha MLP 01-3  
 EXTRACT PLAN PREPARED ON 12.4.2019  
 BASED ON DRAWING No.  
 Sai Sha MPL 01-3

擬議屋宇（新界豁免管制屋宇—小型屋宇）及略為放寬總樓面面積限制  
 新界西貢北十四鄉峯下村丈量約份第218約地段  
 第1109號A分段餘段及第1124號餘段  
 PROPOSED HOUSE (NEW TERRITORIES EXEMPTED HOUSE - SMALL HOUSE)  
 AND MINOR RELAXATION OF GROSS FLOOR AREA RESTRICTIONS  
 LOTS 1109 S.A RP AND 1124 RP IN D.D.218, CHE HA VILLAGE,  
 SHAP SZ HEUNG, SAI KUNG NORTH, NEW TERRITORIES

規劃署  
 PLANNING  
 DEPARTMENT



參考編號  
 REFERENCE No.  
 A/NE-SSH/128

圖 PLAN  
 A-5a



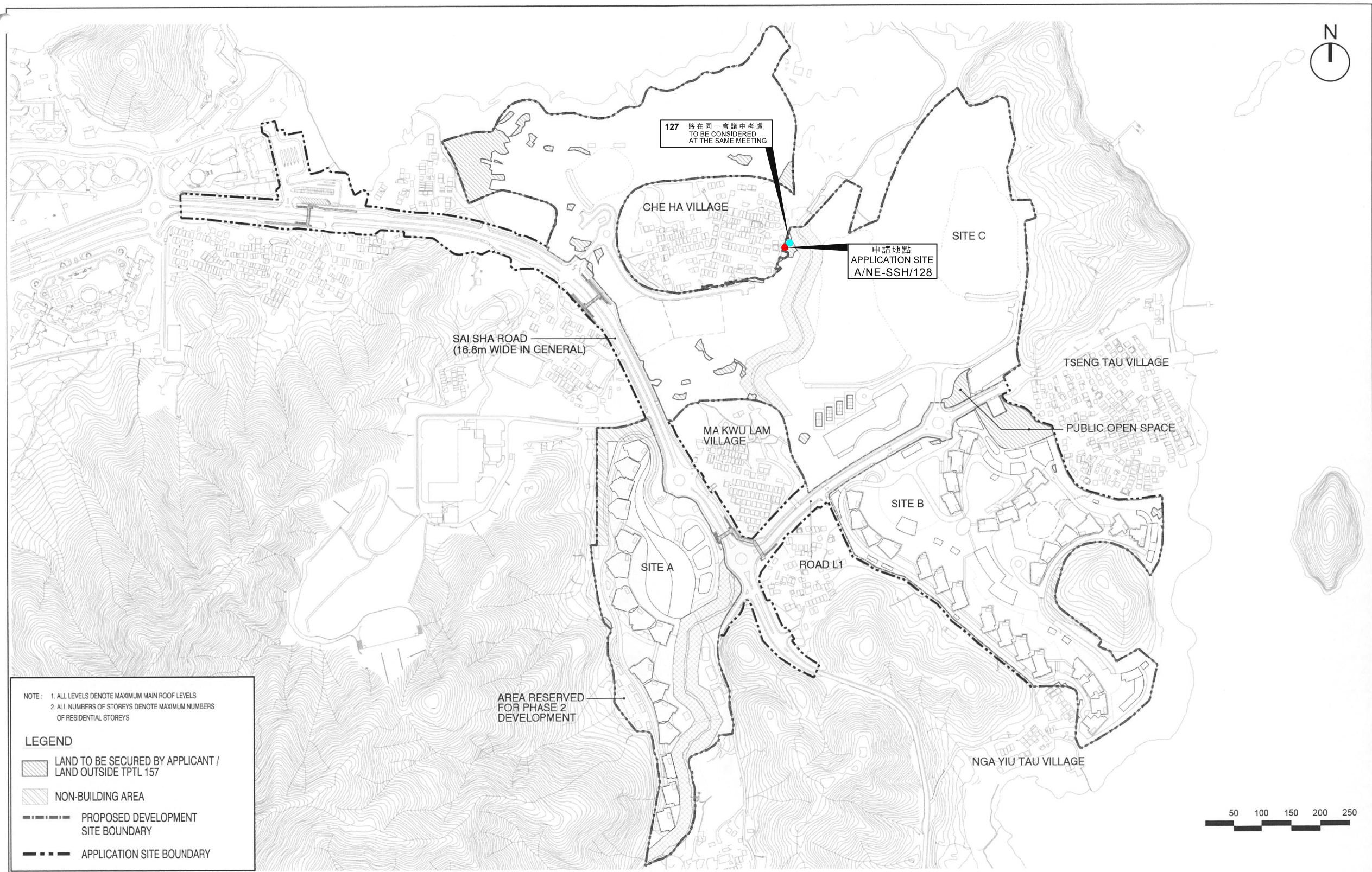

NOTE: 1. ALL LEVELS DENOTE MAXIMUM MAIN ROOF LEVELS  
 2. ALL NUMBERS OF STOREYS DENOTE MAXIMUM NUMBERS OF RESIDENTIAL STOREYS

LEGEND

- LAND TO BE SECURED BY APPLICANT / LAND OUTSIDE TPTL 157
- NON-BUILDING AREA
- PROPOSED DEVELOPMENT SITE BOUNDARY
- APPLICATION SITE BOUNDARY

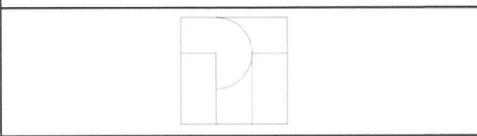

Title

**Indicative Master Layout Plan - Overall**  
 (Application No. A/NE-SSH/120)

Checked	DH	Drawn	PW
Rev	0	Date	Mar 2019
Scale	Figure 3.1		

本摘要圖於2019年4月10日擬備，  
 所根據的資料為圖則編號3.1  
 EXTRACT PLAN PREPARED ON 10.4.2019  
 BASED ON DRAWING No. 3.1

擬議屋宇（新界豁免管制屋宇—小型屋宇）及略為放寬總樓面面積限制  
 新界西貢北十四鄉嶺下村丈量約份第218約地段  
 第1109號A分段餘段及第1124號餘段

PROPOSED HOUSE (NEW TERRITORIES EXEMPTED HOUSE - SMALL HOUSE)  
 AND MINOR RELAXATION OF GROSS FLOOR AREA RESTRICTIONS  
 LOTS 1109 S.A RP AND 1124 RP IN D.D.218, CHE HA VILLAGE,  
 SHAP SZ HEUNG, SAI KUNG NORTH, NEW TERRITORIES

**規劃署**  
**PLANNING DEPARTMENT**

參考編號 REFERENCE No. <b>A/NE-SSH/128</b>	<b>圖 PLAN</b> <b>A-5b</b>
--	------------------------------