

參考編號  
REFERENCE No. A/NE-TKL/634

繪圖 DRAWING A-1

( 來源 : 附件 I )  
( Source : Appendix I )

STRUCTURE	USE	COVERED AREA	GFA	BUILDING HEIGHT
B1*	WHOLESALE TRADE WITH ANCILLARY STORAGE OF GOODS	2,195m <sup>2</sup> (ABOUT)	3,862m <sup>2</sup> (ABOUT)	11m (ABOUT)(2-STOREY)
B2*	WHOLESALE TRADE ANCILLARY STORAGE OF GOODS	1,541m <sup>2</sup> (ABOUT)	2,975m <sup>2</sup> (ABOUT)	11m (ABOUT)(2-STOREY)
B3	METER ROOM	9m <sup>2</sup> (ABOUT)	9m <sup>2</sup> (ABOUT)	3m (ABOUT)(1-STOREY)
<b>TOTAL</b>		<b>3,745m<sup>2</sup> (ABOUT)</b>	<b>6,846m<sup>2</sup> (ABOUT)</b>	

\*STRUCTURE B1 - 2-STOREY STRUCTURE, DETAILED BREAKDOWN OF GFA OF B1:  
1,667m<sup>2</sup> (ABOUT)(G/F) + 2,195m<sup>2</sup> (ABOUT)(1/F) = 3,862m<sup>2</sup> (ABOUT)

\*STRUCTURE B2 - 2-STOREY STRUCTURE, DETAILED BREAKDOWN OF GFA OF B2:  
1,434m<sup>2</sup> (ABOUT)(G/F) + 1,541m<sup>2</sup> (ABOUT)(1/F) = 2,975m<sup>2</sup> (ABOUT)

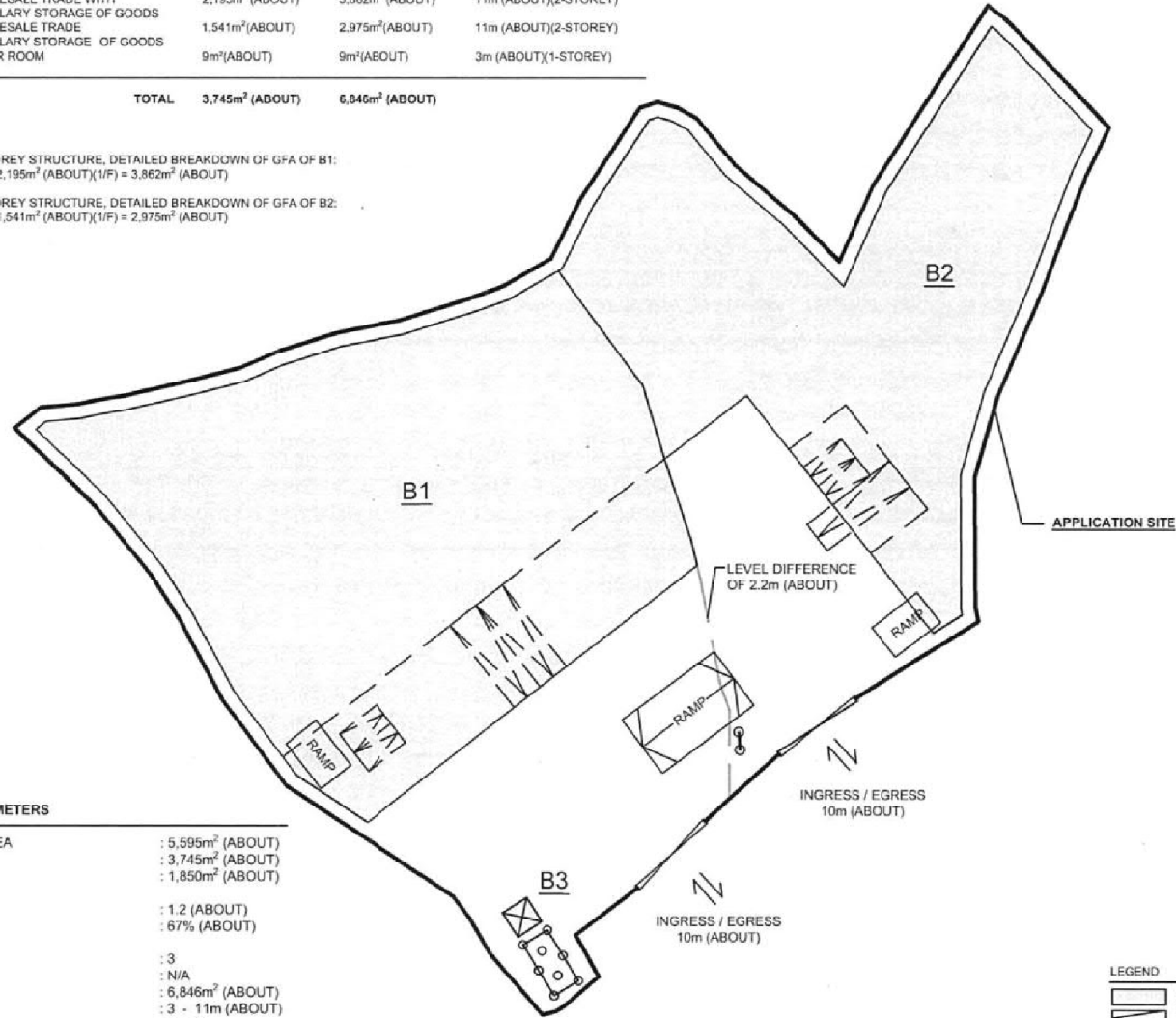

#### DEVELOPMENT PARAMETERS

APPLICATION SITE AREA	: 5,595m <sup>2</sup> (ABOUT)
COVERED AREA	: 3,745m <sup>2</sup> (ABOUT)
UNCOVERED AREA	: 1,850m <sup>2</sup> (ABOUT)
PLOT RATIO	: 1.2 (ABOUT)
SITE COVERAGE	: 67% (ABOUT)
NO. OF STRUCTURE	: 3
DOMESTIC GFA	: N/A
NON-DOMESTIC GFA	: 6,846m <sup>2</sup> (ABOUT)
BUILDING HEIGHT	: 3 - 11m (ABOUT)
NO. OF STOREY	: 1 - 2
PARKING SPACE	
PRIVATE CAR PARKING SPACE (2.5m X 5m)	: 4
LUL SPACE FOR MG V (3.5m X 11m)	: 3

#### LEGEND

	STRUCTURE
	PARKING / LUL SPACE
	PROPOSED H-POLE
	EXISTING H-POLE
	INGRESS / EGRESS
	PROPOSED RAMP

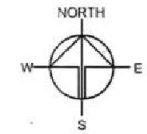

Drawing No.	Ver.
P02	01
Project	
PROPOSED WHOLESALE TRADE WITH ANCILLARY STORAGE FOR A PERIOD OF 5 YEARS	
LOTS 1224 (Part) IN D.D. 79, PING CHE, NEW TERRITORIES	
Drawing Title	
LAYOUT PLAN	
Scale of A4	
4 : 650	
Drawn	Date
	18.12.2019
Revised	Date

參考編號

REFERENCE No. A/NE-TKL/634

繪圖 DRAWING A-2

( 來源 : 附件 I )  
( Source : Appendix I )

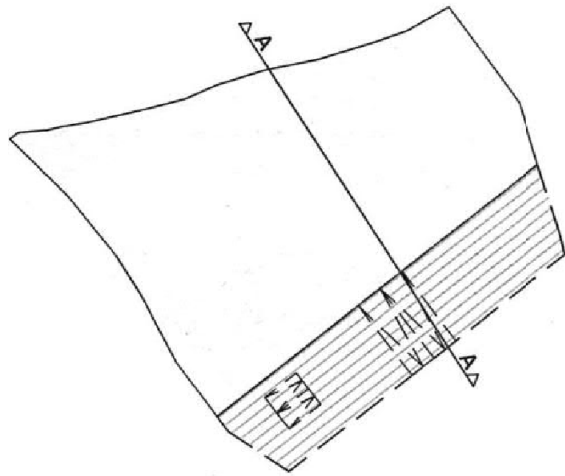

**STRUCTURE B1**

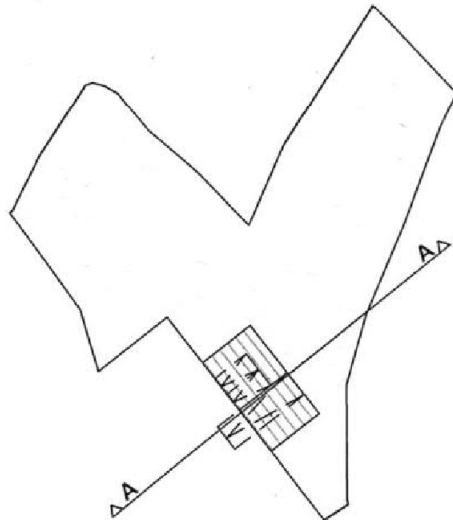

**STRUCTURE B2**

**DEVELOPMENT PARAMETERS**

APPLICATION SITE AREA : 5,595m<sup>2</sup> (ABOUT)  
 COVERED AREA : 3,745m<sup>2</sup> (ABOUT)  
 UNCOVERED AREA : 1,850m<sup>2</sup> (ABOUT)

NO. OF STRUCTURE : 3  
 DOMESTIC GFA : N/A  
 NON-DOMESTIC GFA : 6,846m<sup>2</sup> (ABOUT)  
 BUILDING HEIGHT : 3 - 11m (ABOUT)  
 NO. OF STOREY : 1 - 2

STRUCTURE B1 - 2-STOREY STRUCTURE, DETAILED BREAKDOWN OF GFA OF B1:  
 1,667m<sup>2</sup> (ABOUT)(G/F) + 2,195m<sup>2</sup> (ABOUT)(1/F) = 3,862m<sup>2</sup> (ABOUT)

STRUCTURE B2 - 2-STOREY STRUCTURE, DETAILED BREAKDOWN OF GFA OF B2:  
 1,434m<sup>2</sup> (ABOUT)(G/F) + 1,541m<sup>2</sup> (ABOUT)(1/F) = 2,975m<sup>2</sup> (ABOUT)

STRUCTURE B3 - 1-STOREY STRUCTURE = 9m<sup>2</sup> (ABOUT)

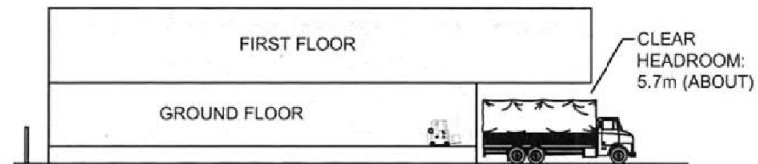

**SECTION A-A**

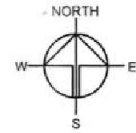

Drawing No. P03	Ver. 01
Project PROPOSED WHOLESALE TRADE WITH ANCILLARY STORAGE FOR A PERIOD OF 5 YEARS	
LOTS 1224 (Part) IN D.D. 79, PING CHE, NEW TERRITORIES	
Drawing Title SECTION PLAN	
Scale of A4 INDICATIVE ONLY	
Drawn	Date 18.12.2019
Revised	Date

參考編號  
 REFERENCE No. A/NE-TKL/634

繪圖 DRAWING A-3

( 來源 : 附件 I )  
 ( Source : Appendix I )



**要覽圖 KEY PLAN**

SCALE 1 : 50 000 比例尺

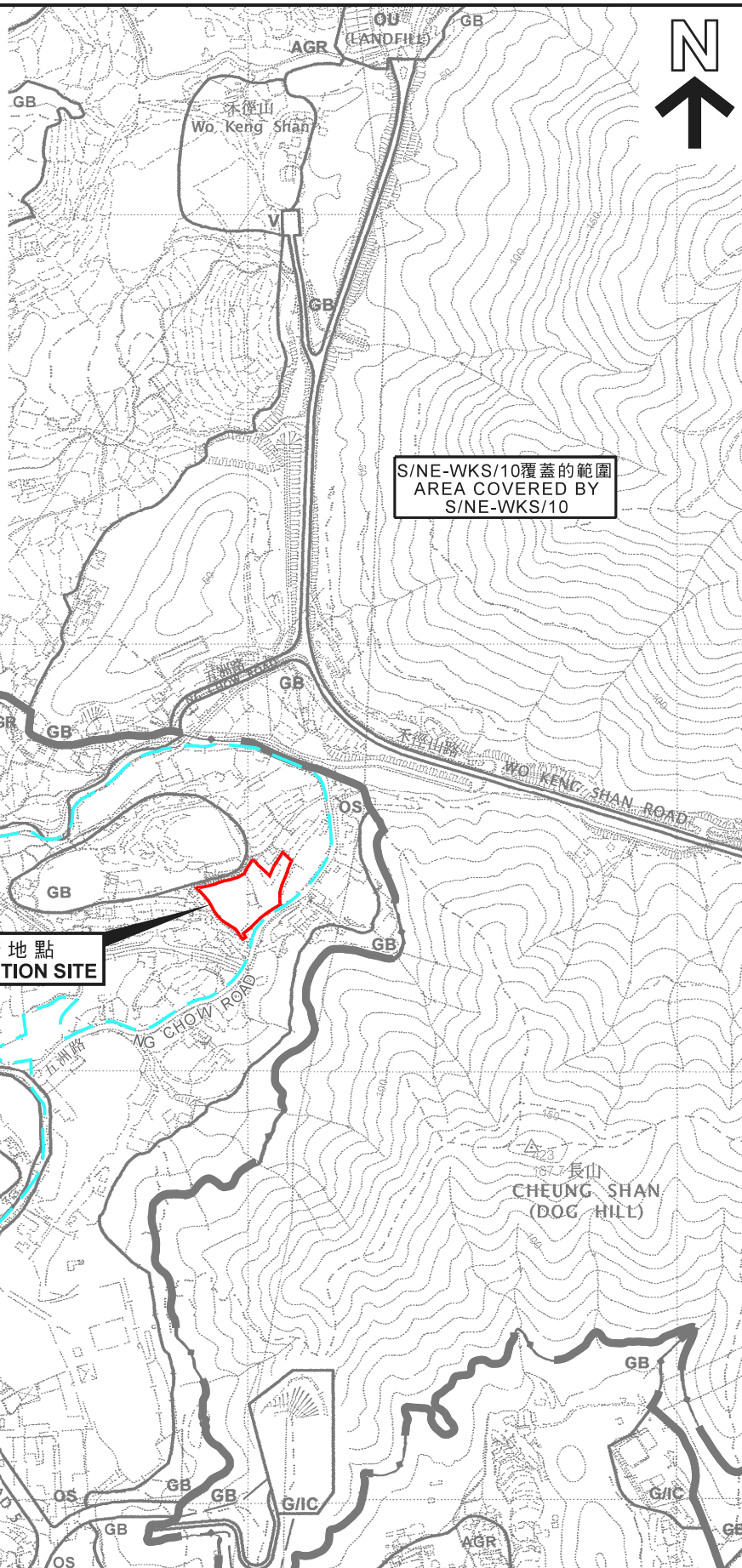

**申請地點 APPLICATION SITE**

S/NE-WKS/10 覆蓋的範圍  
AREA COVERED BY  
S/NE-WKS/10

**圖例 LEGEND**

 具考古研究價值的地點  
SITE OF  
ARCHAEOLOGICAL INTEREST

 申請地點界線只作識別用  
APPLICATION SITE BOUNDARY  
FOR IDENTIFICATION PURPOSE ONLY

**位置圖 LOCATION PLAN**

擬議臨時批發行業連附屬倉庫（為期5年）  
PROPOSED TEMPORARY WHOLESALE TRADE WITH  
ANCILLARY STORAGE FOR A PERIOD OF 5 YEARS  
LOT 1224 (PART) IN D.D. 79,  
NG CHOW ROAD, PING CHE, N.T.

SCALE 1 : 7 500 比例尺  
米 100 0 100 200 300 米  
METRES

**規劃署  
PLANNING  
DEPARTMENT**



參考編號  
REFERENCE No.  
**A/NE-TKL/634**

**圖 PLAN  
A-1**

本摘要圖於2020年12月4日擬備，  
所根據的資料為於2010年2月2日核准的  
分區計劃大綱圖編號S/NE-TKL/14及  
2009年10月6日核准的  
分區計劃大綱圖編號S/NE-WKS/10  
EXTRACT PLAN PREPARED ON 4.12.2020  
BASED ON OUTLINE ZONING PLAN  
No. S/NE-TKL/14 APPROVED ON 2.2.2010  
AND OUTLINE ZONING PLAN  
No. S/NE-WKS/10 APPROVED ON 6.10.2009



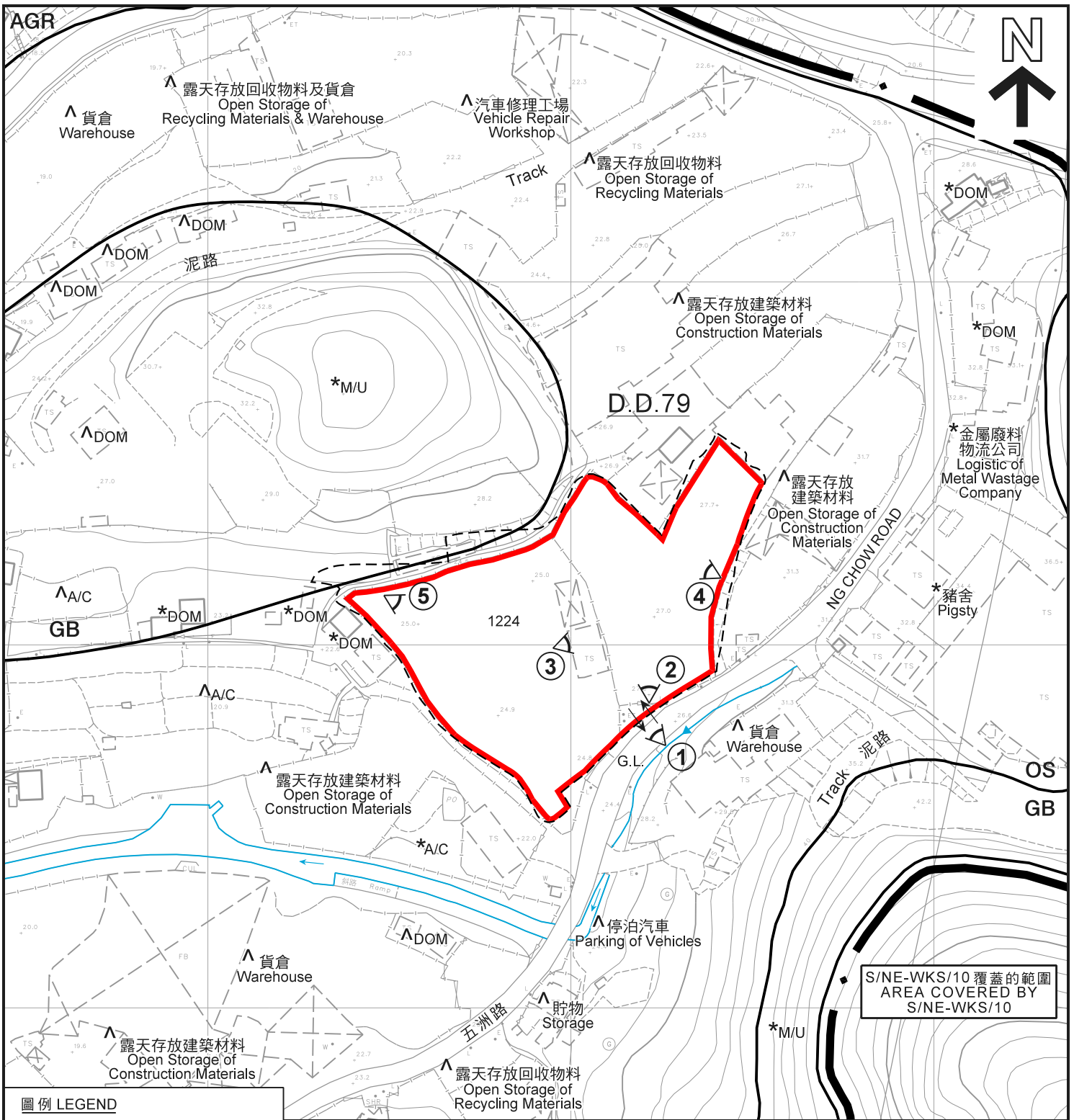

S/NE-WKS/10 覆蓋的範圍  
AREA COVERED BY  
S/NE-WKS/10

圖例 LEGEND

- 申請地點 (界線只作識別用)  
APPLICATION SITE  
(BOUNDARY FOR IDENTIFICATION  
PURPOSE ONLY)
- AGR** 農業  
AGRICULTURE
- GB** 綠化地帶  
GREEN BELT
- OS** 露天貯物  
OPEN STORAGE
- 1  實地照片的觀景點  
VIEWING POINT OF SITE PHOTO

- G.L. 政府土地  
GOVERNMENT LAND
- 入口 / 出口  
INGRESS / EGRESS
- A/C 常耕農地  
ACTIVE AGRICULTURAL LAND
- DOM 住用構築物  
DOMESTIC STRUCTURE
- M/U 荒地  
UNUSED LAND
- VAC 空置  
VACANT

- ↗ 河道  
STREAM COURSE

註釋 Notes:

- (1) 2020年11月9日勘测的土地用途  
Land uses shown on this plan are in accordance with the land use survey conducted by the Planning Department on 9.11.2020
- (2) \* 土地用途跟1990年11月27日勘测的土地用途一致  
Indicates that the use is the same as that revealed by the land use survey conducted by the Planning Department on 27.11.1990
- (3) ^ 土地用途跟1990年11月27日勘测的土地用途有別  
Indicates that the use is different from that revealed by the land use survey conducted by the Planning Department on 27.11.1990

平面圖 SITE PLAN

擬議臨時批發行業連附屬倉庫 (為期5年)  
新界坪壘五洲路丈量約份第79約地段第1224號 (部分)  
PROPOSED TEMPORARY WHOLESALE TRADE WITH  
ANCILLARY STORAGE FOR A PERIOD OF 5 YEARS  
LOT 1224 (PART) IN D.D. 79,  
NG CHOW ROAD, PING CHE, N.T.

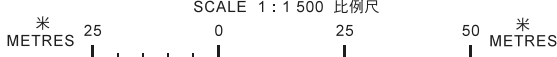

本摘要圖於2020年12月2日擬備，  
所根據的資料為測量圖編號  
3-NW-19D及24B  
EXTRACT PLAN PREPARED ON 2.12.2020  
BASED ON SURVEY SHEETS No.  
3-NW-19D & 24B

規劃署  
PLANNING  
DEPARTMENT



參考編號  
REFERENCE No.  
A/NE-TKL/634

圖 PLAN  
A-2





圖例 LEGEND

-  申請地點 (界線只作識別用)  
APPLICATION SITE  
(BOUNDARY FOR IDENTIFICATION  
PURPOSE ONLY)

本摘要圖於2020年11月23日擬備，  
所根據的資料為地政總署  
於2019年12月27日拍得的航攝照片  
編號E085155C  
EXTRACT PLAN PREPARED ON 23.11.2020  
BASED ON AERIAL PHOTO No. E085155C  
TAKEN ON 27.12.2019 BY  
LANDS DEPARTMENT

航攝照片 AERIAL PHOTO

擬議臨時批發行業連附屬倉庫 (為期5年)  
新界坪輦五洲路丈量約份第79約地段第1224號 (部分)  
PROPOSED TEMPORARY WHOLESALE TRADE WITH  
ANCILLARY STORAGE FOR A PERIOD OF 5 YEARS  
LOT 1224 (PART) IN D.D. 79,  
NG CHOW ROAD, PING CHE, N.T.

規劃署  
PLANNING  
DEPARTMENT



參考編號  
REFERENCE No.  
A/NE-TKL/634

圖 PLAN  
A-3





五洲路  
NG CHOW ROAD



實地照片 SITE PHOTOS

本圖於2020年11月23日擬備，所根據的資料為攝於2020年11月9日的實地照片  
PLAN PREPARED ON 23.11.2020 BASED ON SITE PHOTOS TAKEN ON 9.11.2020

擬議臨時批發行業連附屬倉庫（為期5年）  
新界坪輦五洲路丈量約份第79約地段第1224號（部分）  
PROPOSED TEMPORARY WHOLESALE TRADE WITH ANCILLARY STORAGE FOR A PERIOD OF 5 YEARS  
LOT 1224 (PART) IN D.D. 79  
NG CHOW ROAD, PING CHE, N.T.

規劃署  
PLANNING  
DEPARTMENT



參考編號  
REFERENCE No.  
A/NE-TKL/634

圖 PLAN  
A-4a



實地照片 SITE PHOTOS

本圖於2020年11月23日擬備，所根據的資料為攝於2020年11月9日的實地照片  
 PLAN PREPARED ON 23.11.2020 BASED ON SITE PHOTOS TAKEN ON 9.11.2020

擬議臨時批發行業連附屬倉庫（為期5年）  
 新界坪輦五洲路丈量約份第79約地段第1224號（部分）  
 PROPOSED TEMPORARY WHOLESALE TRADE WITH ANCILLARY STORAGE FOR A PERIOD OF 5 YEARS  
 LOT 1224 (PART) IN D.D. 79,  
 NG CHOW ROAD, PING CHE, N.T.

規劃署  
 PLANNING  
 DEPARTMENT



參考編號  
 REFERENCE No.  
 A/NE-TKL/634

圖 PLAN  
 A-4b