

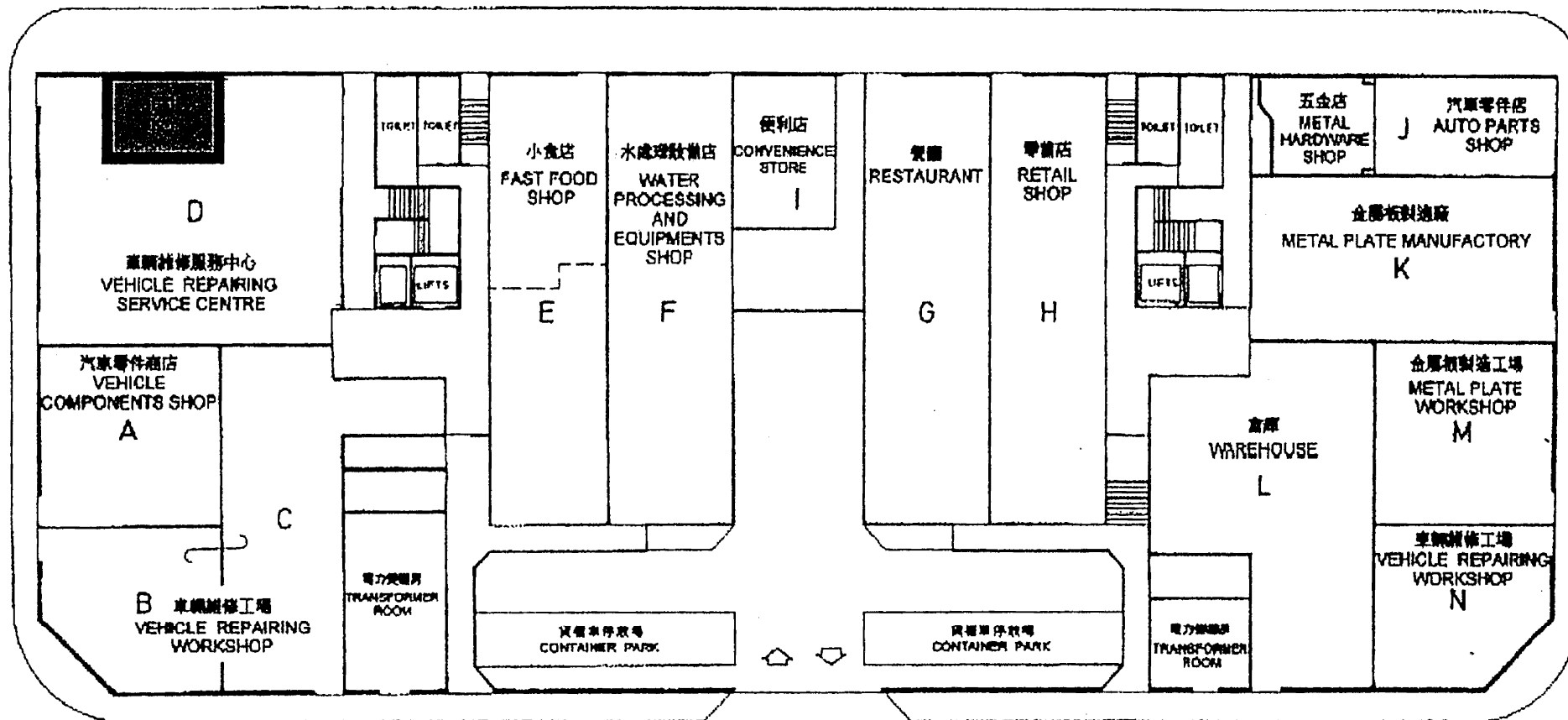

山尾街 SHAN MEI STREET



河邊背街 HO LEK PUI STREET

新界沙田山尾街19-25號宇宙工業中心地下D1舖
地下平面圖 GROUND FLOOR PLAN

參考編號 REFERENCE No.	A/ST/965	繪圖 DRAWING A-1
-----------------------	----------	----------------

(來源：申請人於2018年10月22日呈交的規劃申請表內的繪圖)
(SOURCE: DRAWING IN THE APPLICANT'S SUBMITTED APPLICATION FORM ON 22.10.2018)

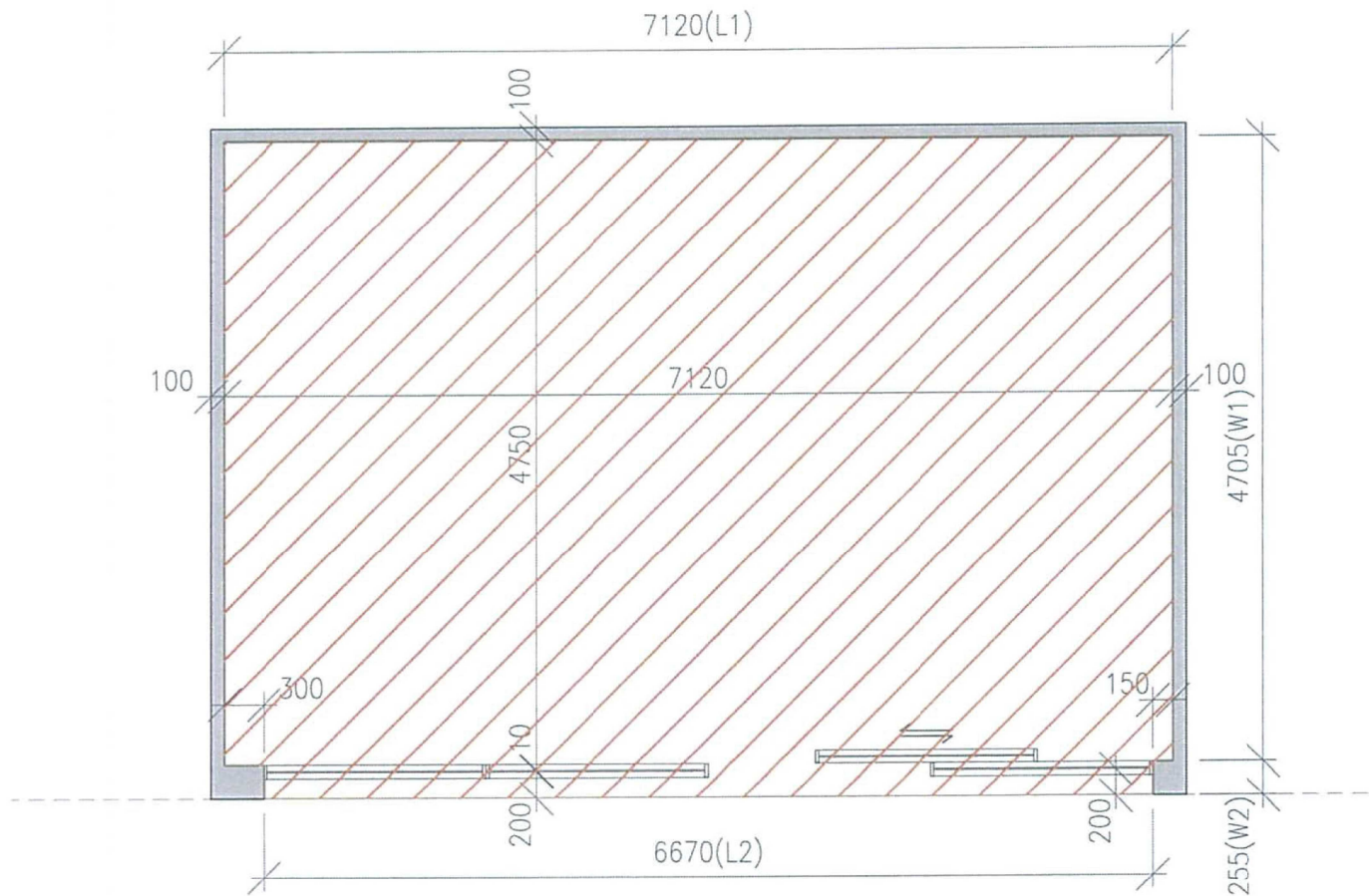

Cheung Tat Hung
 Authorized Person (44/08)

SHOP AND SERVICES (RETAIL AND REPAIR SHOP OF
ELECTRONIC APPLIANCES AND COMPUTER PRODUCTS)
PART PLAN AND INTERNAL SIZE OF WORKSHOP D2 ON G/F,
UNIVERSAL INDUSTRIAL CENTRE, Nos. 19-25 SHAN MEI STREET,
SHATIN, NEW TERRITORIES

FLOOR TO CEILING HEIGHT: 4890mm

TOTAL INTERNAL AREA : 4.705m (W1) x 7.12m (L1) + 0.255m (W2) x 6.67m (L2) = 35.20045m²

參考編號 REFERENCE No.	A/ST/965	繪圖 DRAWING A-2
-----------------------	----------	----------------

(來源: 申請人於2018年10月22日呈交的規劃申請表內的繪圖)
 (SOURCE: DRAWING IN THE APPLICANT'S SUBMITTED
 APPLICATION FORM ON 22.10.2018)

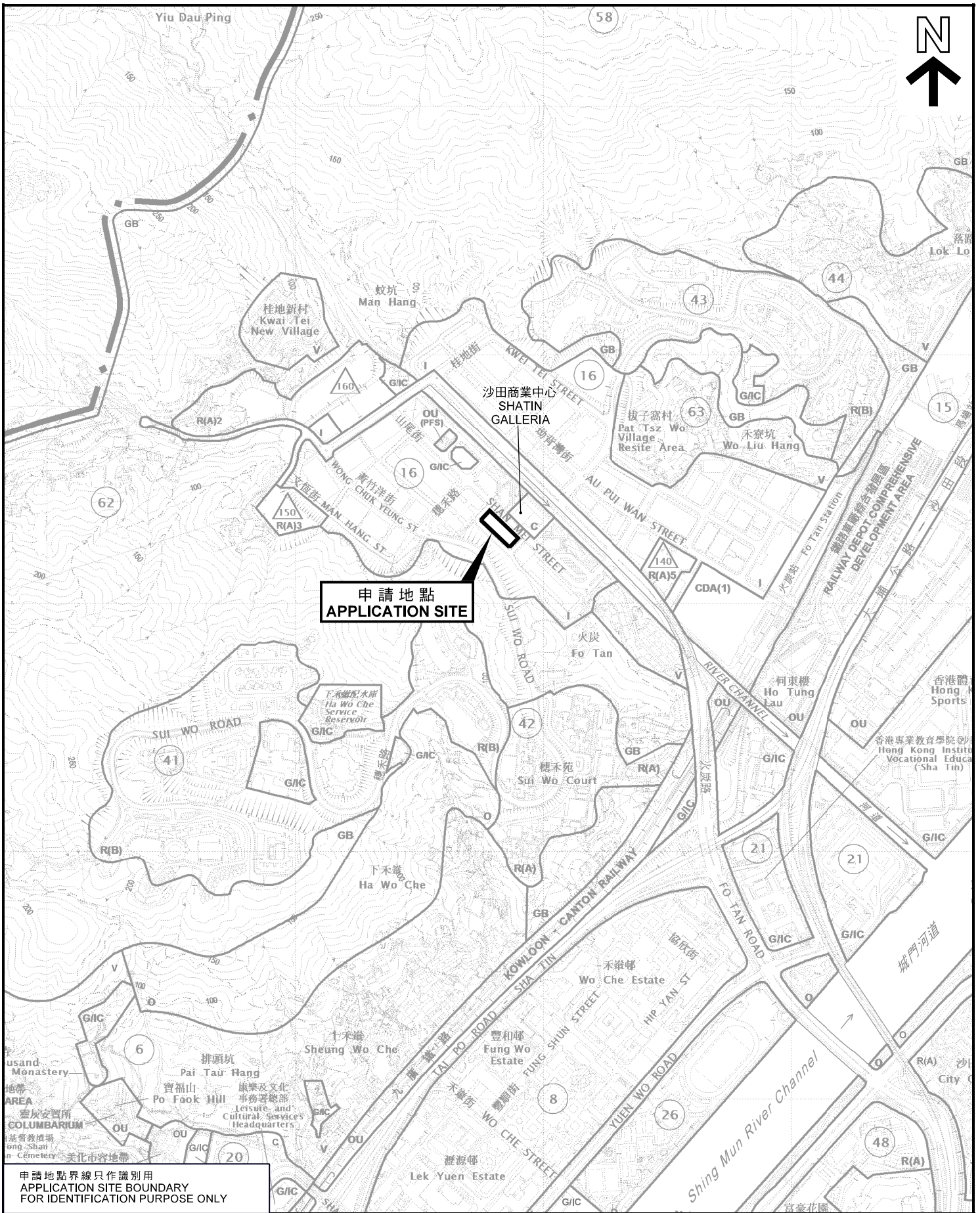

申請地點
APPLICATION SITE

申請地點界線只作識別用
APPLICATION SITE BOUNDARY
FOR IDENTIFICATION PURPOSE ONLY

位置圖 LOCATION PLAN

商店及服務行業（零售及電器與電腦維修商店）
新界沙田火炭山尾街19-25號宇宙工業中心地下D2舖
SHOP AND SERVICES (RETAIL AND REPAIR SHOP
OF ELECTRONIC APPLIANCES AND COMPUTER PRODUCTS)
WORKSHOP D2, G/F, UNIVERSAL INDUSTRIAL CENTRE,
19-25 SHAN MEI STREET, FO TAN, SHA TIN, NEW TERRITORIES

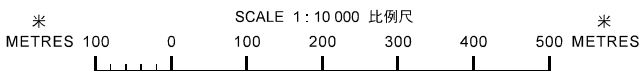

規劃署
PLANNING
DEPARTMENT



參考編號
REFERENCE No.
A/ST/965

圖 PLAN
A-1

本摘要圖於2018年10月31日擬備，
所根據的資料為於2018年5月29日
核准的分區計劃大綱圖編號S/ST/34
EXTRACT PLAN PREPARED ON 31.10.2018
BASED ON OUTLINE ZONING PLAN No.
S/ST/34 APPROVED ON 29.5.2018

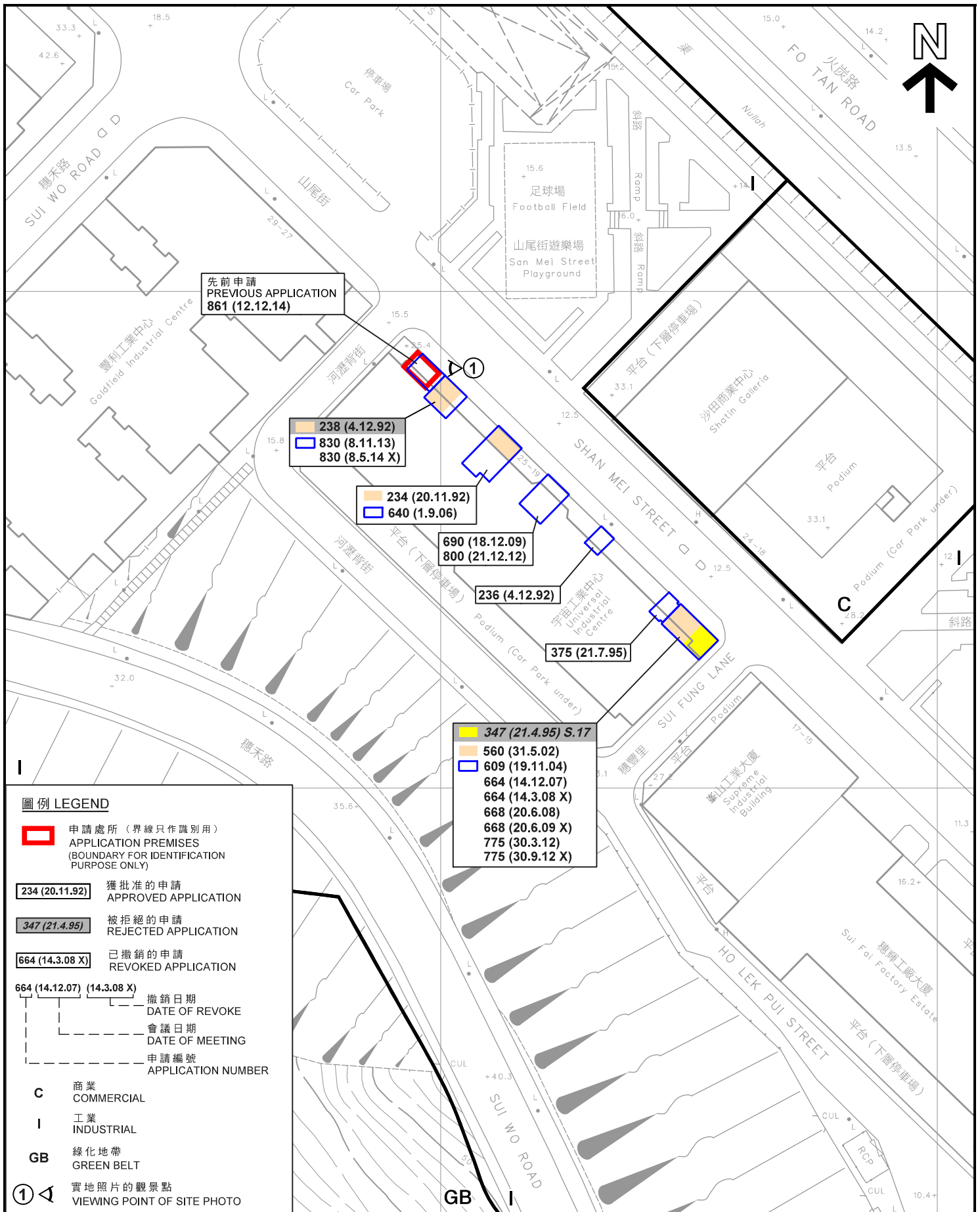

平面圖 SITE PLAN

商店及服務行業 (零售及電器與電腦維修商店)
 新界沙田火炭山尾街19-25號宇宙工業中心地下D2舖
 SHOP AND SERVICES (RETAIL AND REPAIR SHOP
 OF ELECTRONIC APPLIANCES AND COMPUTER PRODUCTS)
 WORKSHOP D2, G/F, UNIVERSAL INDUSTRIAL CENTRE,
 19-25 SHAN MEI STREET, FO TAN, SHA TIN, NEW TERRITORIES

**規劃署
 PLANNING
 DEPARTMENT**



參考編號
 REFERENCE No.
A/ST/965

**圖 PLAN
 A-2**

本摘要圖於2018年11月8日擬備，
 所根據的資料為測量圖編號
 7-SE-6A
 EXTRACT PLAN PREPARED ON 8.11.2018
 BASED ON SURVEY SHEETS No.
 7-SE-6A

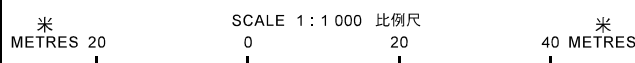



山尾街 SHAN MEI STREET

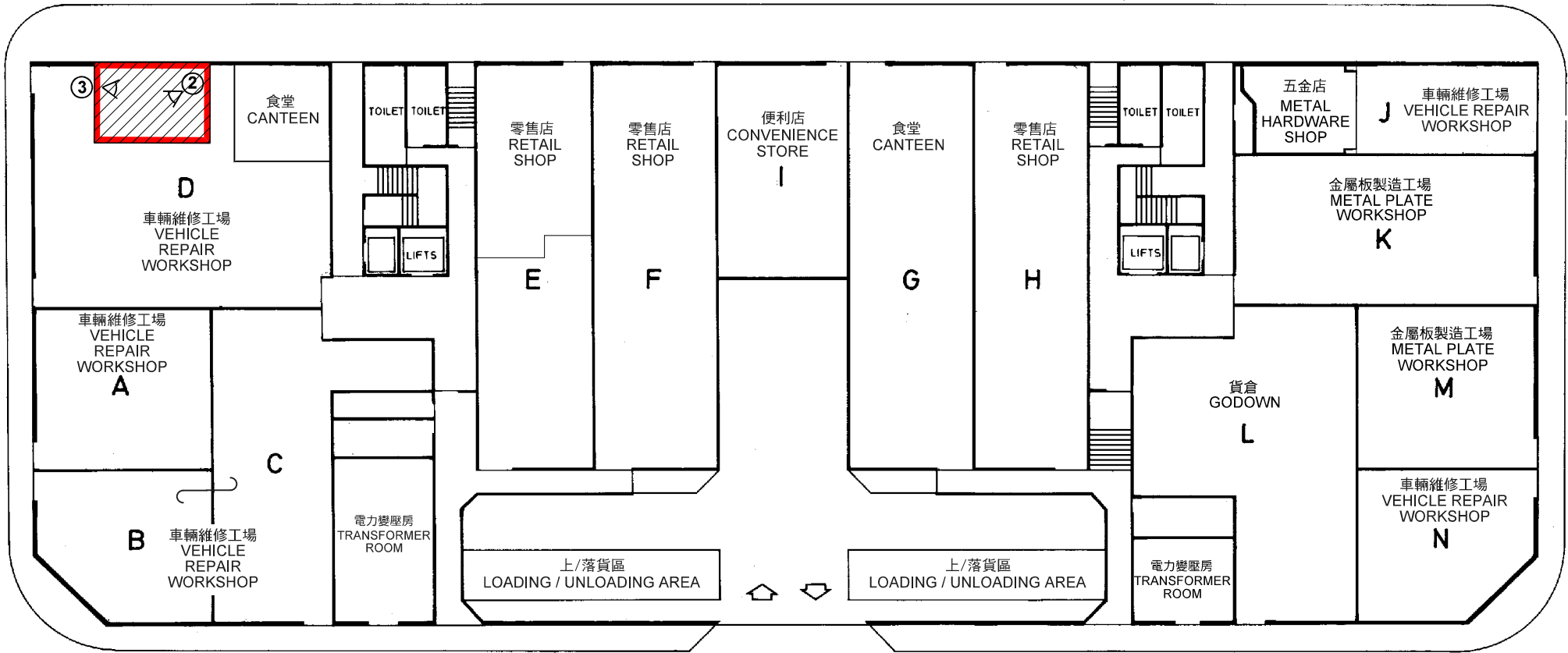

禧豐里 SUI FUNG LANE

河瀝背街 HO LEK PUI STREET

圖例 LEGEND

 申請處所 (界線只作識別用)
APPLICATION PREMISES
(BOUNDARY FOR IDENTIFICATION PURPOSE ONLY)

 實地照片的觀景點
VIEWING POINT OF SITE PHOTO

地下平面圖 GROUND FLOOR PLAN

調查日期 DATE OF SURVEY : 30.10.2018

本圖於2018年12月7日擬備，
所根據的資料為樓宇平面圖
PLAN PREPARED ON 7.12.2018
BASED ON BUILDING FLOOR PLAN

樓面平面圖 FLOOR PLAN

商店及服務行業 (零售及電器與電腦維修商店)
新界沙田火炭山尾街19-25號宇宙工業中心地下D2舖
SHOP AND SERVICES (RETAIL AND REPAIR SHOP
OF ELECTRONIC APPLIANCES AND COMPUTER PRODUCTS)
WORKSHOP D2, G/F, UNIVERSAL INDUSTRIAL CENTRE,
19-25 SHAN MEI STREET, FO TAN, SHA TIN, NEW TERRITORIES

規劃署
PLANNING
DEPARTMENT



參考編號
REFERENCE No.
A/ST/965

圖 PLAN
A-3



申請處所只作識別用
APPLICATION PREMISES BOUNDARY FOR IDENTIFICATION PURPOSE ONLY

本圖於2018年11月8日擬備，所根據的資料為攝於2018年10月30日的實地照片
PLAN PREPARED ON 8.11.2018
BASED ON SITE PHOTO TAKEN ON 30.10.2018

實地照片 SITE PHOTO

商店及服務行業（零售及電器與電腦維修商店）
新界沙田火炭山尾街19-25號宇宙工業中心地下D2舖
SHOP AND SERVICES (RETAIL AND REPAIR SHOP
OF ELECTRONIC APPLIANCES AND COMPUTER PRODUCTS)
WORKSHOP D2, G/F, UNIVERSAL INDUSTRIAL CENTRE,
19-25 SHAN MEI STREET, FO TAN, SHA TIN, NEW TERRITORIES

規劃署
PLANNING
DEPARTMENT



參考編號
REFERENCE No.
A/ST/965

圖 PLAN
A-4a



申請處所的內部情景 INSIDE OF APPLICATION PREMISES

實地照片 SITE PHOTOS

商店及服務行業（零售及電器與電腦維修商店）
 新界沙田火炭山尾街19-25號宇宙工業中心地下D2舖
 SHOP AND SERVICES (RETAIL AND REPAIR SHOP
 OF ELECTRONIC APPLIANCES AND COMPUTER PRODUCTS)
 WORKSHOP D2, G/F, UNIVERSAL INDUSTRIAL CENTRE,
 19-25 SHAN MEI STREET, FO TAN, SHA TIN, NEW TERRITORIES

規劃署
**PLANNING
 DEPARTMENT**



參考編號
 REFERENCE No.
A/ST/965

圖 **PLAN
 A-4b**

本圖於2018年11月20日擬備，所根據的資料為攝於2018年10月30日的實地照片
 PLAN PREPARED ON 20.11.2018
 BASED ON SITE PHOTOS TAKEN ON 30.10.2018