

<p>Project 項目名稱: Proposed Temporary Public Vehicle Park for Private Car for a Period of 3 Years at Lots 357 (Part) &amp; 360 (Part) in D.D. 122 and Adjoining Government Land, Ping Shan, Yuen Long, N.T.</p>	<p>Drawing Title 圖目: Site Plan</p>	<p>Remarks 備註:</p>
	<p>Drawing No. 圖號: Figure 1</p>	<p>Scale 比例: 1:1000</p>

參考編號 REFERENCE No. A/YL-PS/561	繪圖 DRAWING A-1
-----------------------------------	-------------------

(摘錄自申請人於10.5.2018呈交的申請書)  
(Extract from Applicant's Submission Dated 10.5.2018)

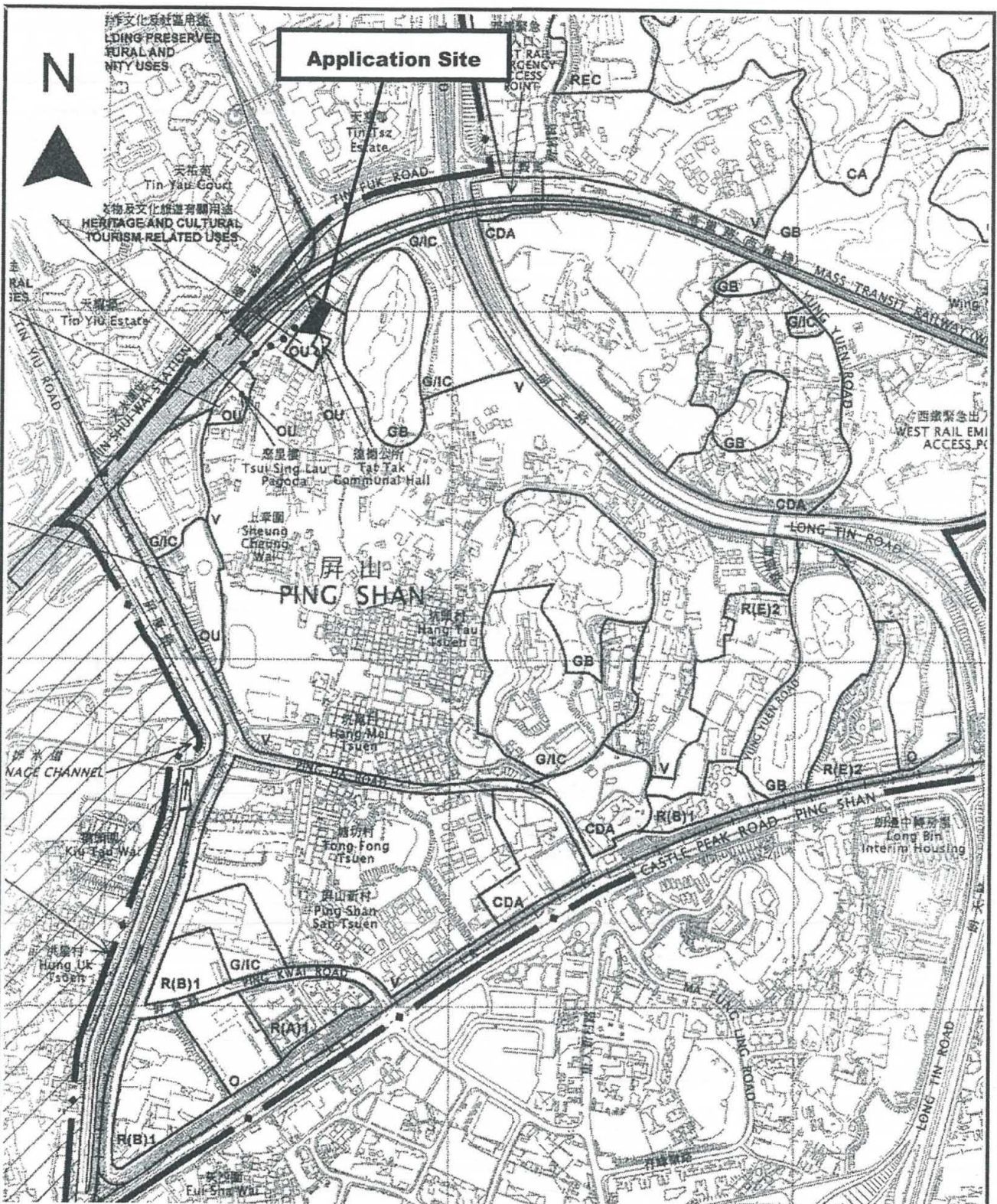



<p>Project 項目名稱:          Proposed Temporary Public Vehicle Park for Private Car for a Period of 3 Years at Lots 357 (Part) &amp; 360 (Part) in D.D. 122 and Adjoining Government Land, Ping Shan, Yuen Long, N.T.</p>	<p>Drawing Title 圖目:          Extract from OZP No. S/YL-PS/17</p>	<p>Remarks 備註:          ●●● Vehicular access leading from Tsui Sing Road</p>
<p>Drawing No. 圖號:          Figure 2</p>		<p>Scale 比例:          1:7500</p>

參考編號 REFERENCE No. 繪圖 DRAWING  
 A/YL-PS/561 A-2

(摘錄自申請人於10.5.2018呈交的申請書)  
 (Extract from Applicant's Submission Dated 10.5.2018)

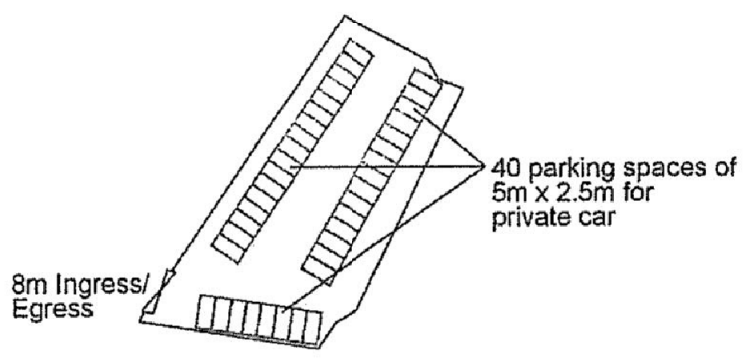

Project 項目名稱: Proposed Temporary Public Vehicle Park for Private Car for a Period of 3 Years at Lots 357 (Part) & 360 (Part) in D.D. 122 and Adjoining Government Land, Ping Shan, Yuen Long, N.T.	Drawing Title 圖目: Proposed Layout Plan	Remarks 備註:
	Drawing No. 圖號: Figure 3	Scale 比例: 1:1000

參考編號 REFERENCE No. A/YL-PS/561	繪圖 DRAWING A-3
-----------------------------------	-------------------

(摘錄自申請人於10. 5. 2018呈交的申請書)  
 (Extract from Applicant's Submission Dated 10.5.2018)



N



Proposed Tree	Approximate Height	Spacing
○ Proposed <i>Bauhinia blakeana</i>	2.75m	4m

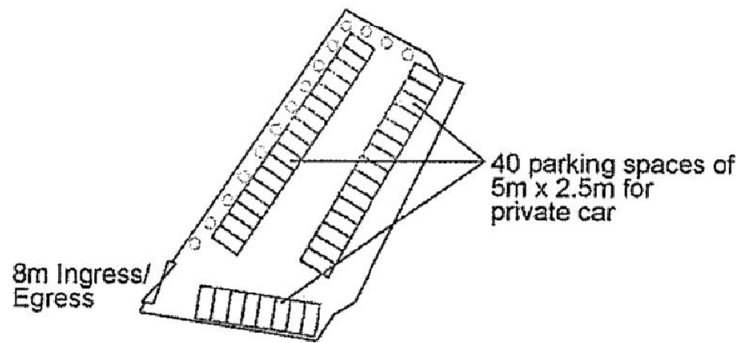

Project 項目名稱: Proposed Temporary Public Vehicle Park for Private Car for a Period of 3 Years at Lots 357 (Part) & 360 (Part) in D.D. 122 and Adjoining Government Land, Ping Shan, Yuen Long, N.T.	Drawing Title 圖目: Proposed Landscape Plan	Remarks 備註:
	Drawing No. 圖號: Figure 4	Scale 比例: 1:1000

參考編號 REFERENCE No. A/YL-PS/561	繪圖 DRAWING A-4
-----------------------------------	-------------------

(摘錄自申請人於10. 5. 2018呈交的申請書)  
(Extract from Applicant's Submission Dated 10.5.2018)

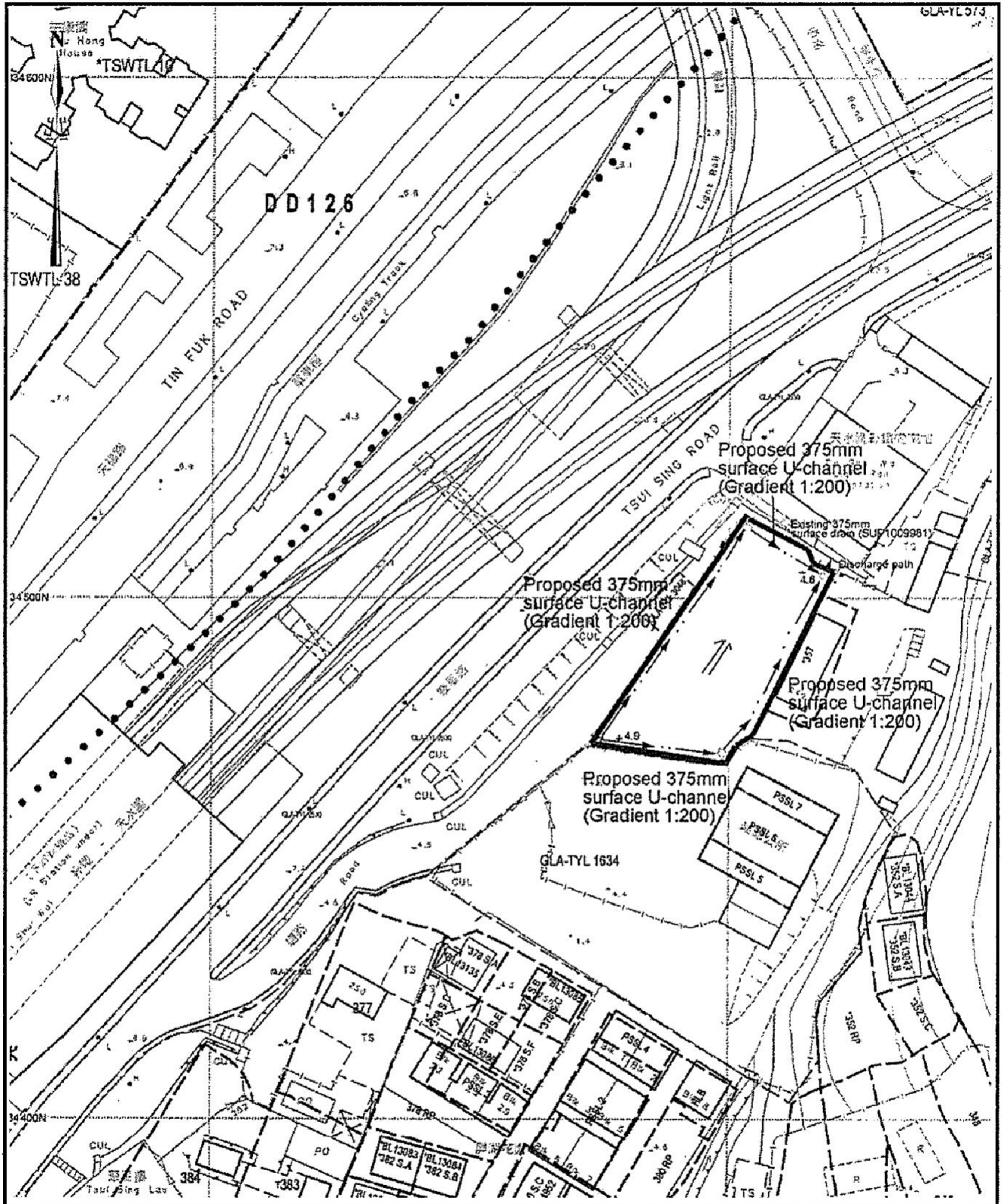

<p>Project 項目名稱:  <b>Proposed Temporary Public Vehicle Park for Private Car for a Period of 3 Years at Lots 357 (Part) &amp; 360 (Part) in D.D. 122 and Adjoining Government Land, Ping Shan, Yuen Long, N.T.</b></p>	<p>Drawing Title 圖目:  <b>Proposed Drainage Plan</b></p>	<p>Remarks 備註:  <input type="checkbox"/> Proposed catchpit   Flow of surface runoff          +4.6 Level (in mPD)</p>
	<p>Drawing No. 圖號:  <b>Figure 5</b></p>	<p>Scale 比例:  <b>1:1000</b></p>

參考編號 REFERENCE No. <b>A/YL-PS/561</b>	繪圖 DRAWING <b>A-5</b>
--	--------------------------

(摘錄自申請人於10.5.2018呈交的申請書)  
 (Extract from Applicant's Submission Dated 10.5.2018)

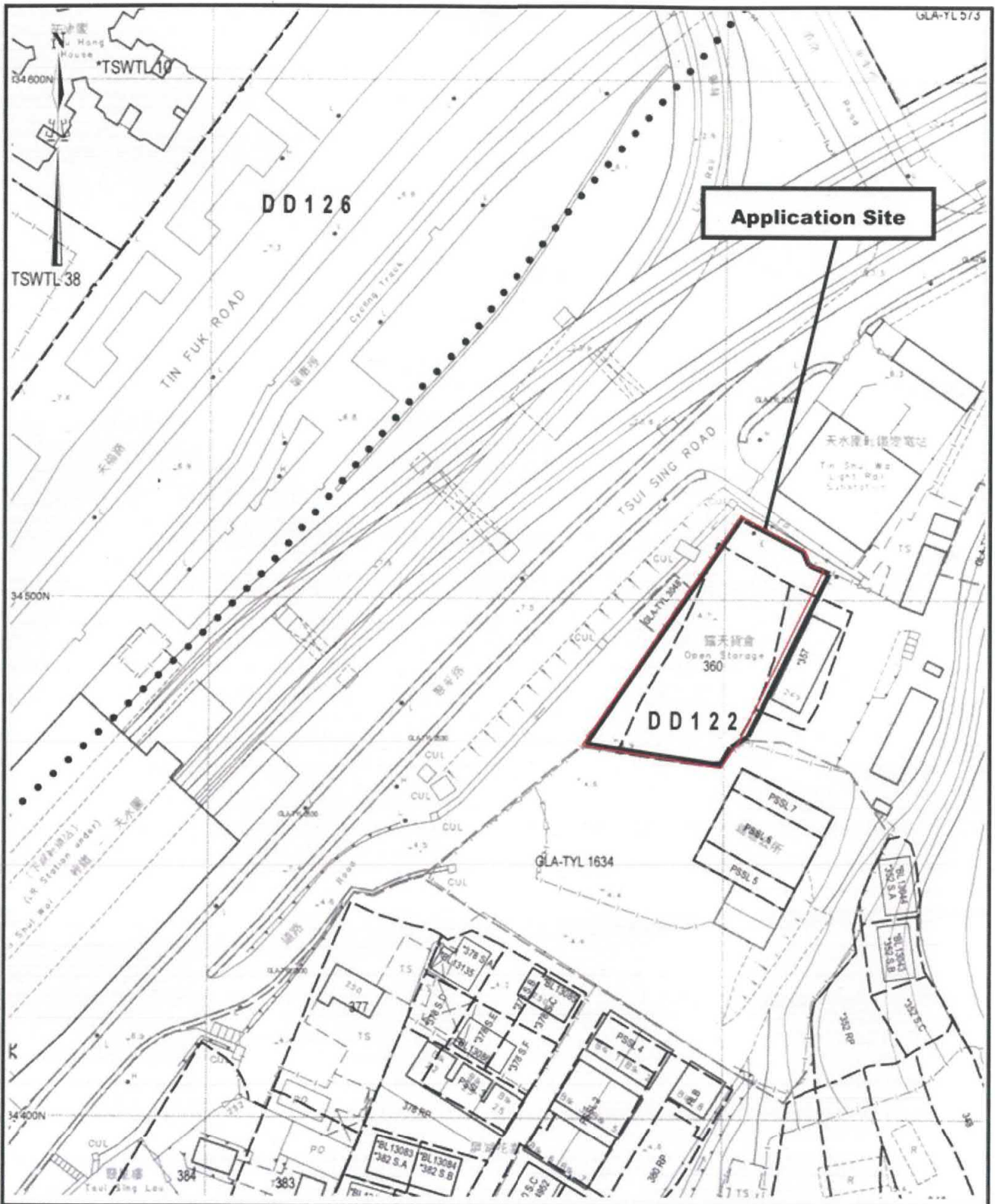

<p>Project 項目名稱:  <b>Proposed Temporary Public Vehicle Park for Private Car for a Period of 3 Years at Lots 357 (Part) &amp; 360 (Part) in D.D. 122 and Adjoining Government Land, Ping Shan, Yuen Long, N.T.</b></p>	<p>Drawing Title 圖目:  <b>Fencing Proposal</b></p>	<p>Remarks 備註:   Proposed site fencing</p>
	<p>Drawing No. 圖號:  <b>Figure 7</b></p>	<p>Scale 比例:  <b>1:1000</b></p>

參考編號 REFERENCE No. <b>A/YL-PS/561</b>	繪圖 DRAWING <b>A-6</b>
--	--------------------------

(摘錄自申請人於26. 6. 2018呈交的申請書)  
 (Extract from Applicant's Submission Dated 26.6.2018)



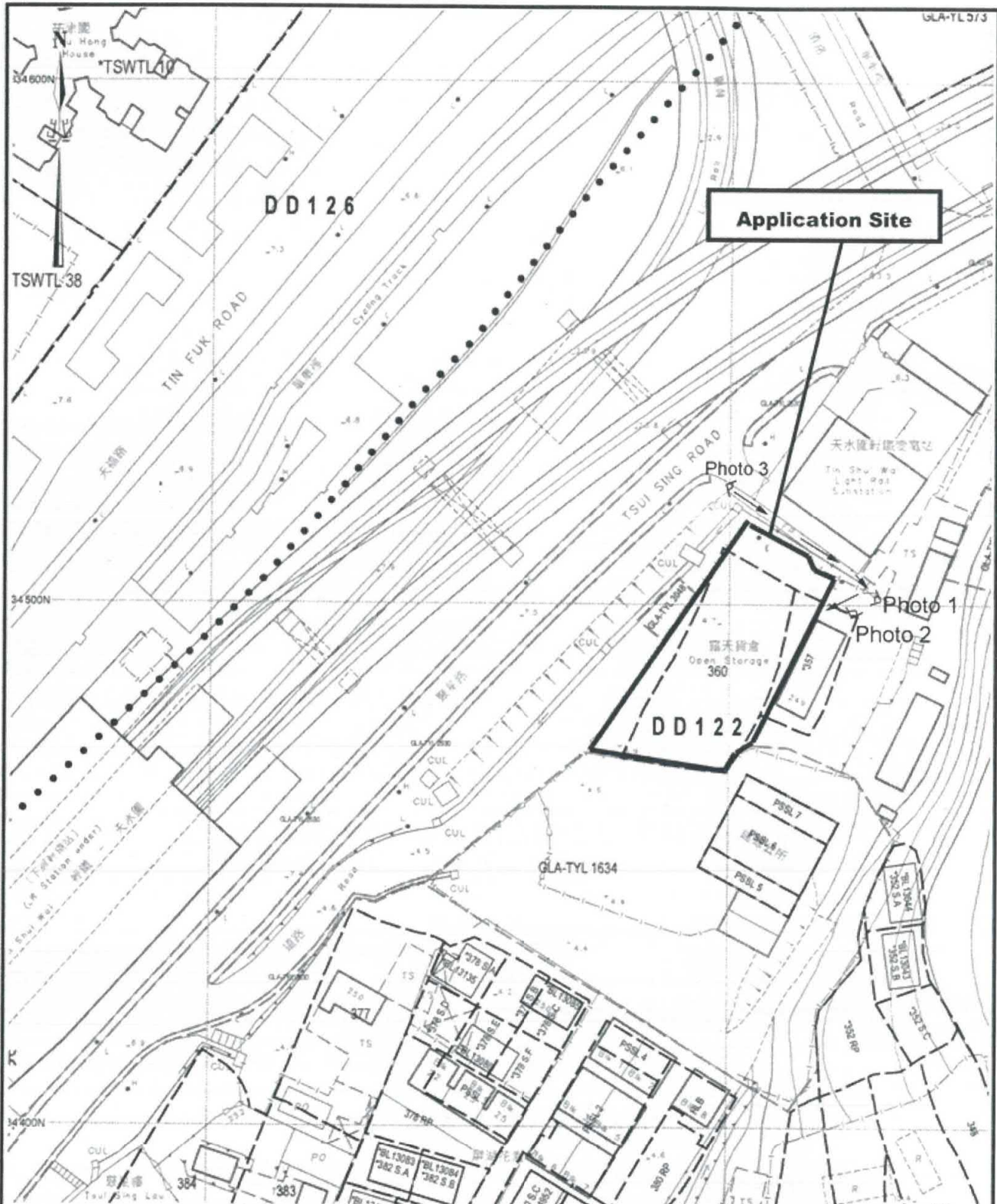

<p>Project 項目名稱: Proposed Temporary Public Vehicle Park for Private Car for a Period of 3 Years at Lots 357 (Part) &amp; 360 (Part) in D.D. 122 and Adjoining Government Land, Ping Shan, Yuen Long, N.T.</p>	<p>Drawing Title 圖目: Proposed Pedestrian Path to Adjacent Shops</p>	<p>Remarks 備註: → Proposed pedestrian path to adjacent shops ◁ Photo viewpoint</p>
	<p>Drawing No. 圖號: Figure 6</p>	<p>Scale 比例: 1:1000</p>

<p>參考編號 REFERENCE No. AYL-PS/561</p>	<p>繪圖 DRAWING A-7</p>
--	---------------------------

(摘錄自申請人於26.6.2018呈交的申請書)  
(Extract from Applicant's Submission Dated 26.6.2018)

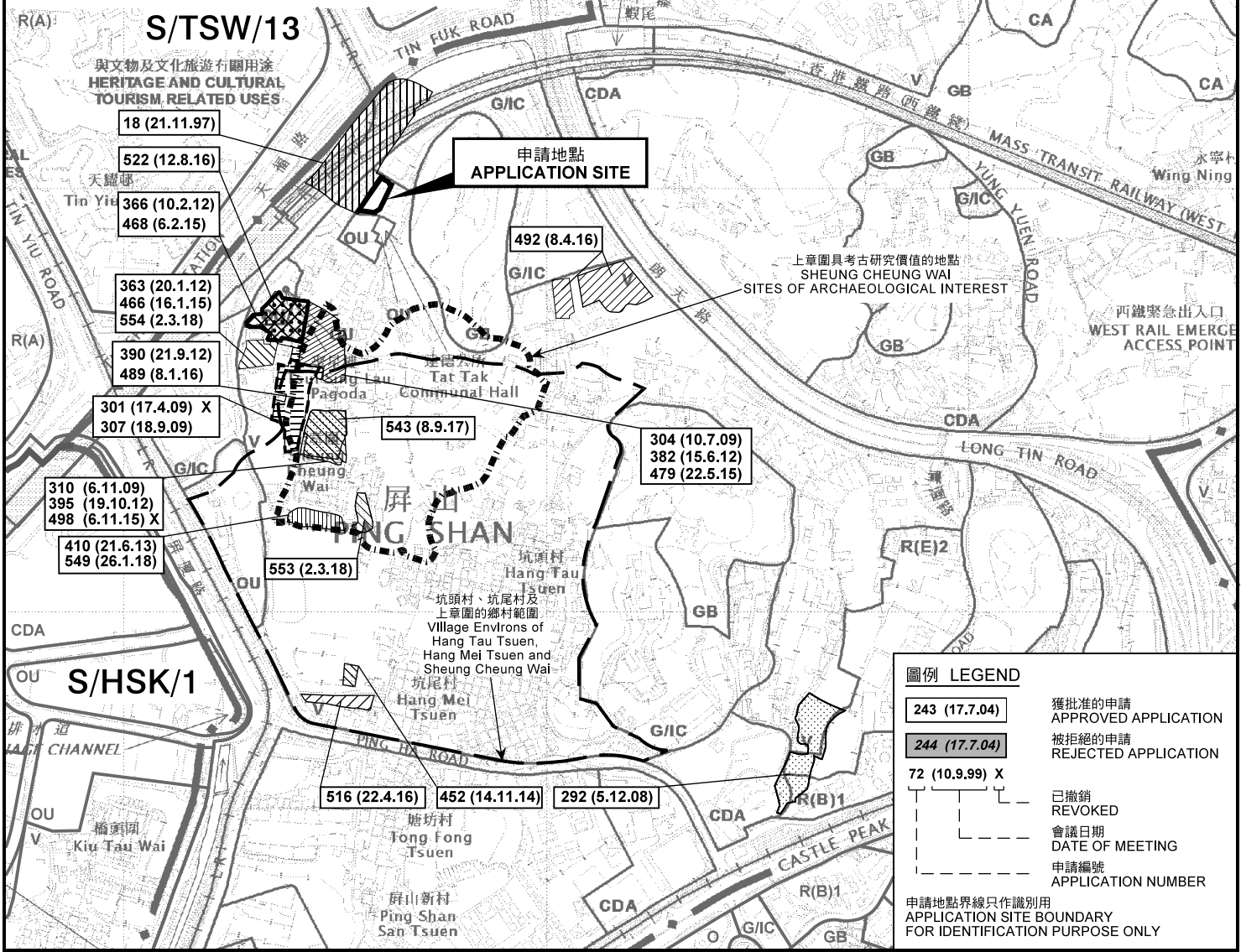
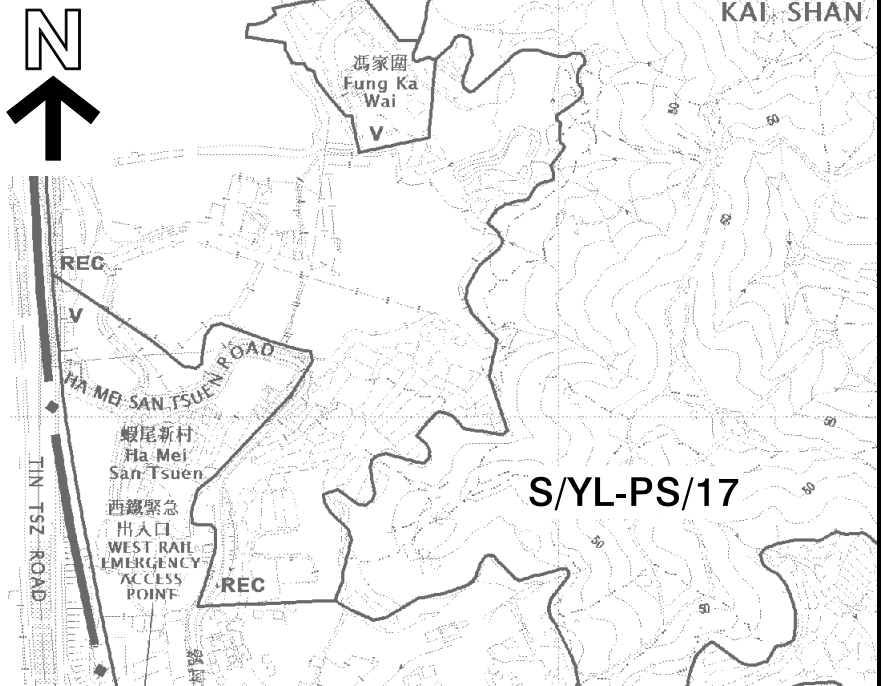

本摘要圖於2018年6月27日擬備，所根據的資料為於2017年5月26日展示的分區計劃大綱圖編號 S/YL-PS/17 EXTRACT PLAN PREPARED ON 27.6.2018 BASED ON OUTLINE ZONING PLAN No. S/YL-PS/17 EXHIBITED ON 26.5.2017

**位置圖 LOCATION PLAN**  
臨時公眾私家車停車場(為期3年)  
新界元朗屏山丈量約份第122約地段第357號(部分)及第360號(部分)和毗連政府土地  
TEMPORARY PUBLIC VEHICLE PARK FOR PRIVATE CARS FOR A PERIOD OF 3 YEARS LOTS 357 (PART) AND 360 (PART) IN D.D. 122 AND ADJOINING GOVERNMENT LAND, PING SHAN, YUEN LONG, NEW TERRITORIES  
SCALE 1 : 7 500 比例尺

米 100 0 100 200 300 米  
METRES

**規劃署 PLANNING DEPARTMENT**

參考編號 REFERENCE No. **AYL-PS/561**

圖 PLAN **A-1**



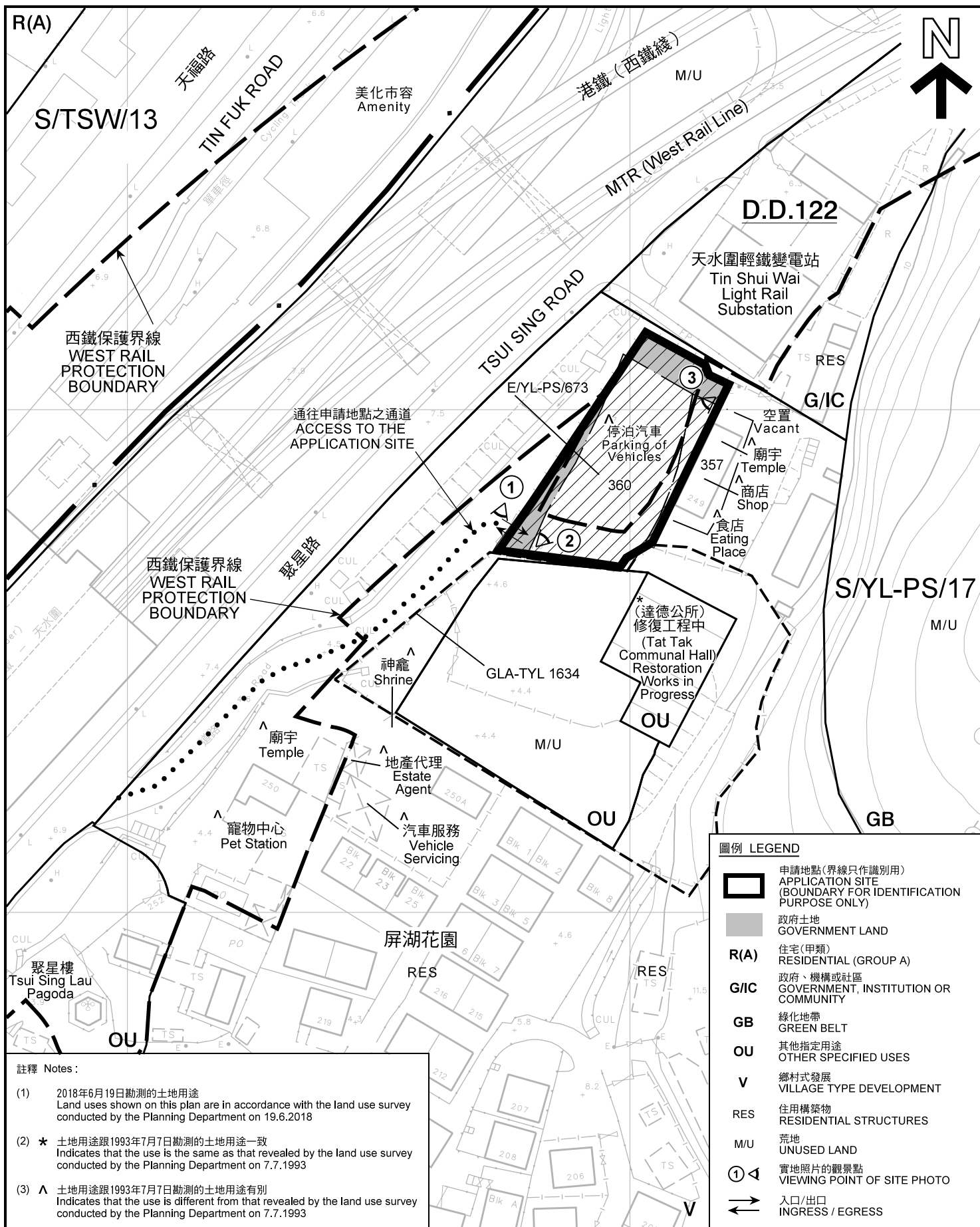

註釋 Notes:

- (1) 2018年6月19日勘測的土地用途  
Land uses shown on this plan are in accordance with the land use survey conducted by the Planning Department on 19.6.2018
- (2) \* 土地用途跟1993年7月7日勘測的土地用途一致  
Indicates that the use is the same as that revealed by the land use survey conducted by the Planning Department on 7.7.1993
- (3) ^ 土地用途跟1993年7月7日勘測的土地用途有別  
Indicates that the use is different from that revealed by the land use survey conducted by the Planning Department on 7.7.1993

圖例 LEGEND

- 申請地點(界線只作識別用)  
APPLICATION SITE (BOUNDARY FOR IDENTIFICATION PURPOSE ONLY)
- 政府土地  
GOVERNMENT LAND
- R(A)** 住宅(甲類)  
RESIDENTIAL (GROUP A)
- G/IC** 政府、機構或社區  
GOVERNMENT, INSTITUTION OR COMMUNITY
- GB** 綠化地帶  
GREEN BELT
- OU** 其他指定用途  
OTHER SPECIFIED USES
- V** 鄉村式發展  
VILLAGE TYPE DEVELOPMENT
- RES** 住用構築物  
RESIDENTIAL STRUCTURES
- M/U** 荒地  
UNUSED LAND
- 實地照片的觀景點  
VIEWING POINT OF SITE PHOTO
- 入口/出口  
INGRESS / EGRESS

平面圖 SITE PLAN

臨時公眾私家車停車場(為期3年)  
新界元朗屏山丈量約份第122約地段第357號(部分)  
及第360號(部分)和毗連政府土地  
TEMPORARY PUBLIC VEHICLE PARK FOR  
PRIVATE CARS FOR A PERIOD OF 3 YEARS  
LOTS 357 (PART) AND 360 (PART) IN D.D. 122  
AND ADJOINING GOVERNMENT LAND, PING SHAN,  
YUEN LONG, NEW TERRITORIES  
SCALE 1 : 1 000 比例尺

米 METRES 20 0 20 40 米 METRES

本摘要圖於2018年6月21日擬備，所根據的資料為測量圖編號6-NW-8A 和 6-NW-8B  
EXTRACT PLAN PREPARED ON 21.6.2018  
BASED ON SURVEY SHEET No. 6-NW-8A AND 6-NW-8B

規劃署  
PLANNING  
DEPARTMENT



參考編號  
REFERENCE No.  
AYL-PS/561

圖 PLAN  
A-2





**圖例 LEGEND**



申請地點 (界線只作識別用)  
APPLICATION SITE  
(BOUNDARY FOR IDENTIFICATION  
PURPOSE ONLY)

本摘要圖於2018年6月7日擬備，所根據的資料為地政總署於2018年1月3日拍得的航攝照片編號 E032755C  
EXTRACT PLAN PREPARED ON 7.6.2018  
BASED ON AERIAL PHOTO No.  
E032755C TAKEN ON 3.1.2018  
BY LANDS DEPARTMENT

**航攝照片 AERIAL PHOTO**

臨時公眾私家車停車場 (為期3年)  
新界元朗屏山丈量約份第122約地段第357號 (部分)  
及第360號 (部分) 和毗連政府土地  
TEMPORARY PUBLIC VEHICLE PARK FOR  
PRIVATE CARS FOR A PERIOD OF 3 YEARS  
LOTS 357 (PART) AND 360 (PART) IN D.D. 122  
AND ADJOINING GOVERNMENT LAND, PING SHAN,  
YUEN LONG, NEW TERRITORIES

規劃署  
**PLANNING  
DEPARTMENT**



參考編號  
REFERENCE No.  
**AYL-PS/561**

圖 **PLAN**  
**A-3**



1

申請地點  
APPLICATION SITE



2

天祐苑  
TIN YAU COURT

申請地點  
APPLICATION SITE



3

天耀邨  
TIN YIU ESTATE

申請地點  
APPLICATION SITE



本圖於2018年6月7日擬備，所根據的資料為攝於2018年5月18日的實地照片  
PLAN PREPARED ON 7.6.2018  
BASED ON SITE PHOTOS  
TAKEN ON 18.5.2018

實地照片 SITE PHOTO

臨時公眾私家車停車場(為期3年)  
新界元朗屏山丈量約份第122約地段第357號(部分)  
及第360號(部分)和毗連政府土地  
TEMPORARY PUBLIC VEHICLE PARK FOR  
PRIVATE CARS FOR A PERIOD OF 3 YEARS  
LOTS 357 (PART) AND 360 (PART) IN D.D. 122  
AND ADJOINING GOVERNMENT LAND, PING SHAN,  
YUEN LONG, NEW TERRITORIES

規劃署  
PLANNING  
DEPARTMENT



參考編號  
REFERENCE No.  
AYL-PS/561

圖 PLAN  
A-4