

<p>Project 項目名稱:          Proposed Temporary Logistics Centre for a Period of 3 Years at Lots 2427 (Part), 2430 (Part), 2431 (Part), 2432 (Part), 2433 (Part), 2434, 2435, 2436 (Part), 2437 (Part), 2438 S.A RP (Part), 2438 S.B (Part), 2439 (Part), 2447 (Part), 2455 S.B ss.1 S.A (Part), 2455 S.B ss.1 S.C (Part), 2455 S.B ss.1 RP (Part), 2958 (Part), 2961 S.A ss.1 (Part), 2961 S.A RP (Part), 2961 RP (Part), 2962 (Part), 2976 (Part), 2977 S.A (Part), 2977 S.B (Part), 2978, 2979 (Part) &amp; 2980 (Part) in D.D. 129, Ha Tsuen, Yuen Long, N.T.</p>	<p>Drawing Title 圖目:  <b>Location Plan</b></p>	<p>Remarks 備註:          ●●● Vehicular access leading from Ping Ha Road</p>
	<p>Drawing No. 圖號:  <b>Figure 2</b></p>	<p>Scale 比例:          1:7500</p>

(摘錄自申請人於 31.3.2020 呈交的申請書)  
 (Extract from Applicant's Submission of 31.3.2020)

<p>參考編號          REFERENCE No.  <b>A/HSK/216</b></p>	<p>繪圖 DRAWING  <b>A-1</b></p>
--	-----------------------------------

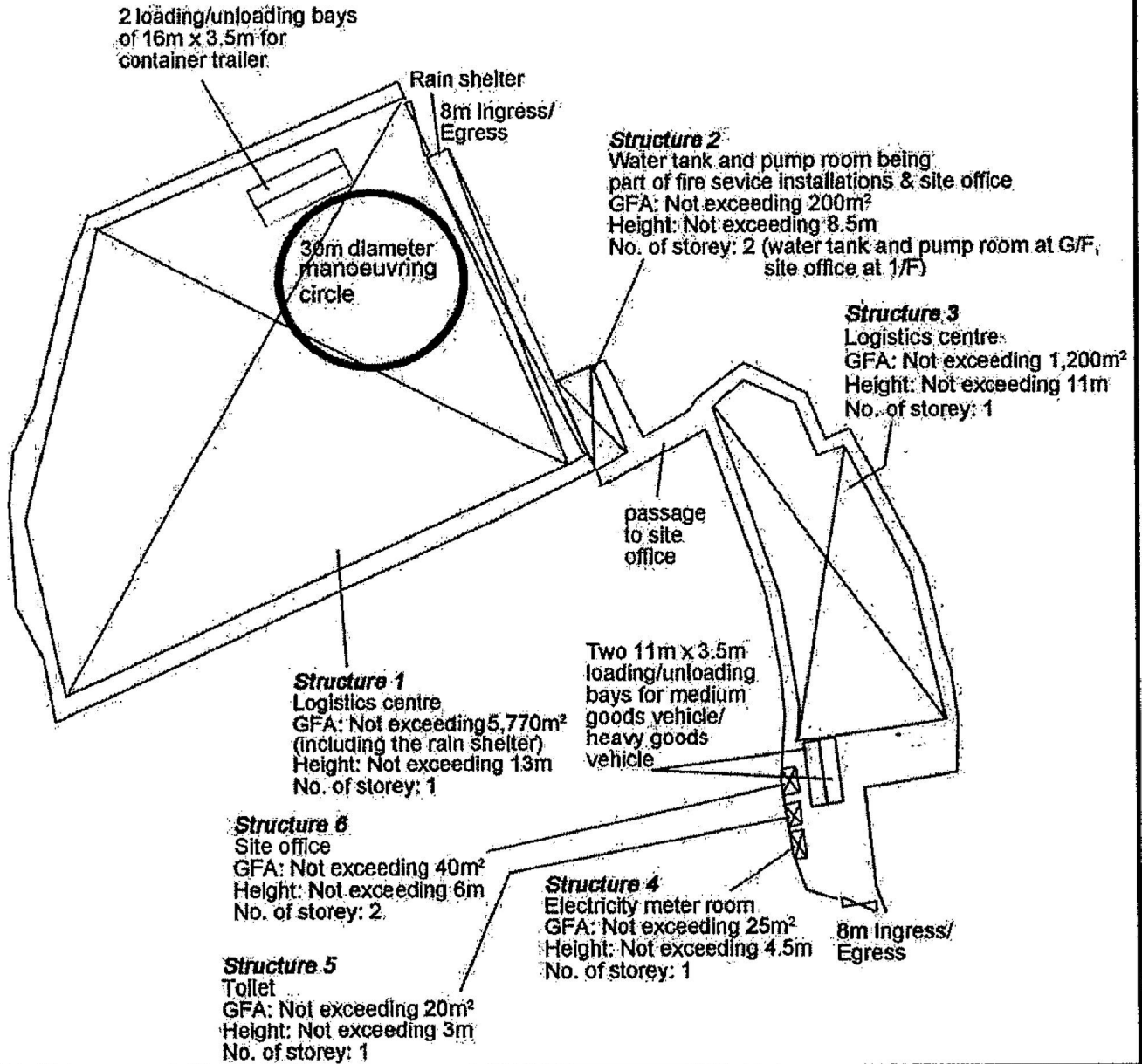

<p>Project 項目名稱:</p> <p>Proposed Temporary Logistics Centre for a Period of 3 Years at Lots 2427 (Part), 2430 (Part), 2431 (Part), 2432 (Part), 2433 (Part), 2434, 2435, 2436 (Part), 2437 (Part), 2438 S.A RP (Part), 2438 S.B (Part), 2439 (Part), 2447 (Part), 2455 S.B ss.1 S.A (Part), 2455 S.B ss.1 S.C (Part), 2455 S.B ss.1 RP (Part), 2958 (Part), 2961 S.A ss.1 (Part), 2961 S.A RP (Part), 2961 RP (Part), 2962 (Part), 2976 (Part), 2977 S.A (Part), 2977 S.B (Part), 2978, 2979 (Part) &amp; 2980 (Part) in D.D. 129, Ha Tsuen, Yuen Long, N.T.</p>	<p>Drawing Title 圖目:</p> <p>Proposed Layout Plan</p>	<p>Remarks 備註:</p>
	<p>Drawing No. 圖號:</p> <p>Figure 3</p>	<p>Scale 比例:</p> <p>1:1000</p>

(摘錄自申請人於 31.3.2020 提交的申請書)  
 (Extract from Applicant's Submission of 31.3.2020)

<p>參考編號 REFERENCE No. A/HSK/216</p>	<p>繪圖 DRAWING A-2</p>
---	---------------------------



Tree	Approximate Height	Spacing
○ Existing Trees to be preserved	About 4m to 4.5m	4m

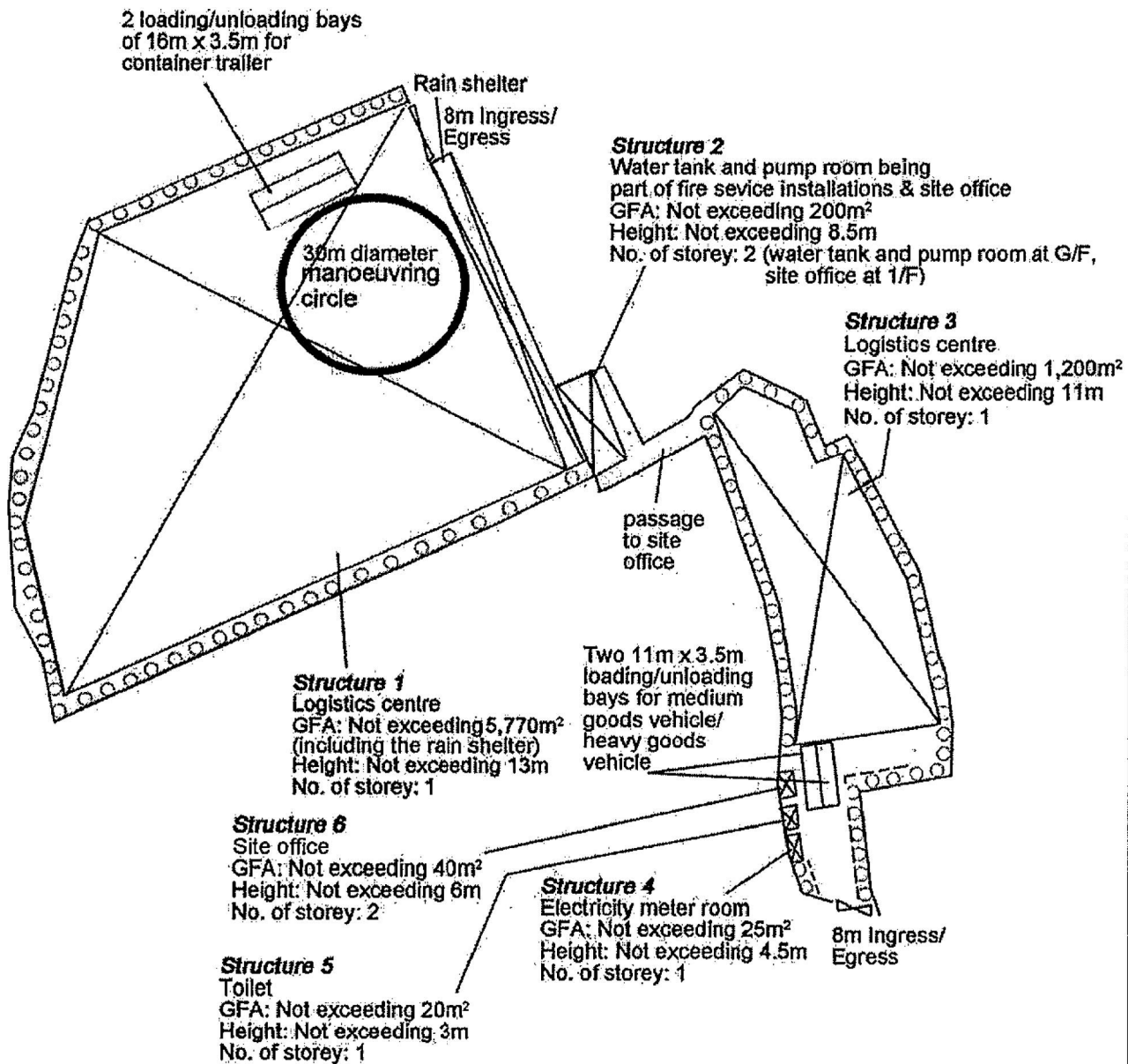

Project 項目名稱: Proposed Temporary Logistics Centre for a Period of 3 Years at Lots 2427 (Part), 2430 (Part), 2431 (Part), 2432 (Part), 2433 (Part), 2434, 2435, 2436 (Part), 2437 (Part), 2438 S.A RP (Part), 2438 S.B (Part), 2439 (Part), 2447 (Part), 2455 S.B ss.1 S.A (Part), 2455 S.B ss.1 S.C (Part), 2455 S.B ss.1 RP (Part), 2958 (Part), 2961 S.A ss.1 (Part), 2961 S.A RP (Part), 2961 RP (Part), 2962 (Part), 2976 (Part), 2977 S.A (Part), 2977 S.B (Part), 2978, 2979 (Part) & 2980 (Part) in D.D. 129, Ha Tsuen, Yuen Long, N.T.	Drawing Title 圖目: <b>Proposed Tree Preservation Plan</b>	Remarks 備註: --- Existing kerb for protecting the trees
	Drawing No. 圖號: <b>Figure 4</b>	

(摘錄自申請人於 31.3.2020 提交的申請書)  
 (Extract from Applicant's Submission of 31.3.2020)

參考編號 REFERENCE No. <b>A/HSK/216</b>	繪圖 DRAWING <b>A-3</b>
---	--------------------------

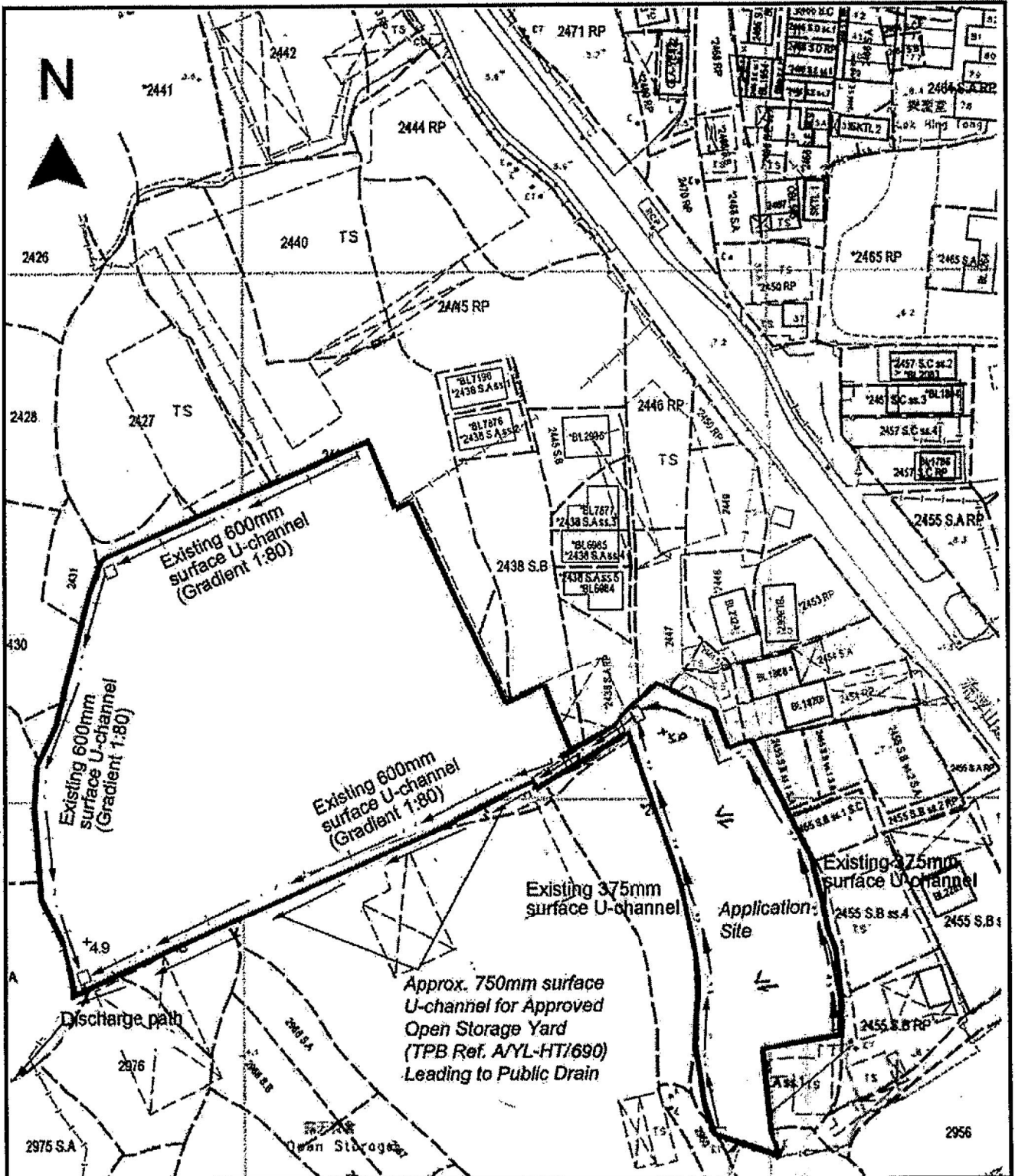

<p>Project 項目名稱:</p> <p>Proposed Temporary Logistics Centre for a Period of 3 Years at Lots 2427 (Part), 2430 (Part), 2431 (Part), 2432 (Part), 2433 (Part), 2434, 2435, 2436 (Part), 2437 (Part), 2438 S.A RP (Part), 2438 S.B (Part), 2439 (Part), 2447 (Part), 2455 S.B ss.1 S.A (Part), 2455 S.B ss.1 S.C (Part), 2455 S.B ss.1 RP (Part), 2958 (Part), 2961 S.A ss.1 (Part), 2961 S.A RP (Part), 2961 RP (Part), 2962 (Part), 2976 (Part), 2977 S.A (Part), 2977 S.B (Part), 2978, 2979 (Part) &amp; 2980 (Part) in D.D. 129, Ha Tsuen, Yuen Long, N.T.</p>	<p>Drawing Title 圖目:</p> <p>As-built Drainage Plan</p>	<p>Remarks 備註:</p>
	<p>Drawing No. 圖號:</p> <p>Figure 5</p>	
		<p>Scale 比例:</p> <p>1:1000</p>

(摘錄自申請人於 31.3.2020 呈交的申請書)  
 (Extract from Applicant's Submission of 31.3.2020)

<p>參考編號 REFERENCE No. A/HSK/216</p>	<p>繪圖 DRAWING A-4</p>
---	---------------------------

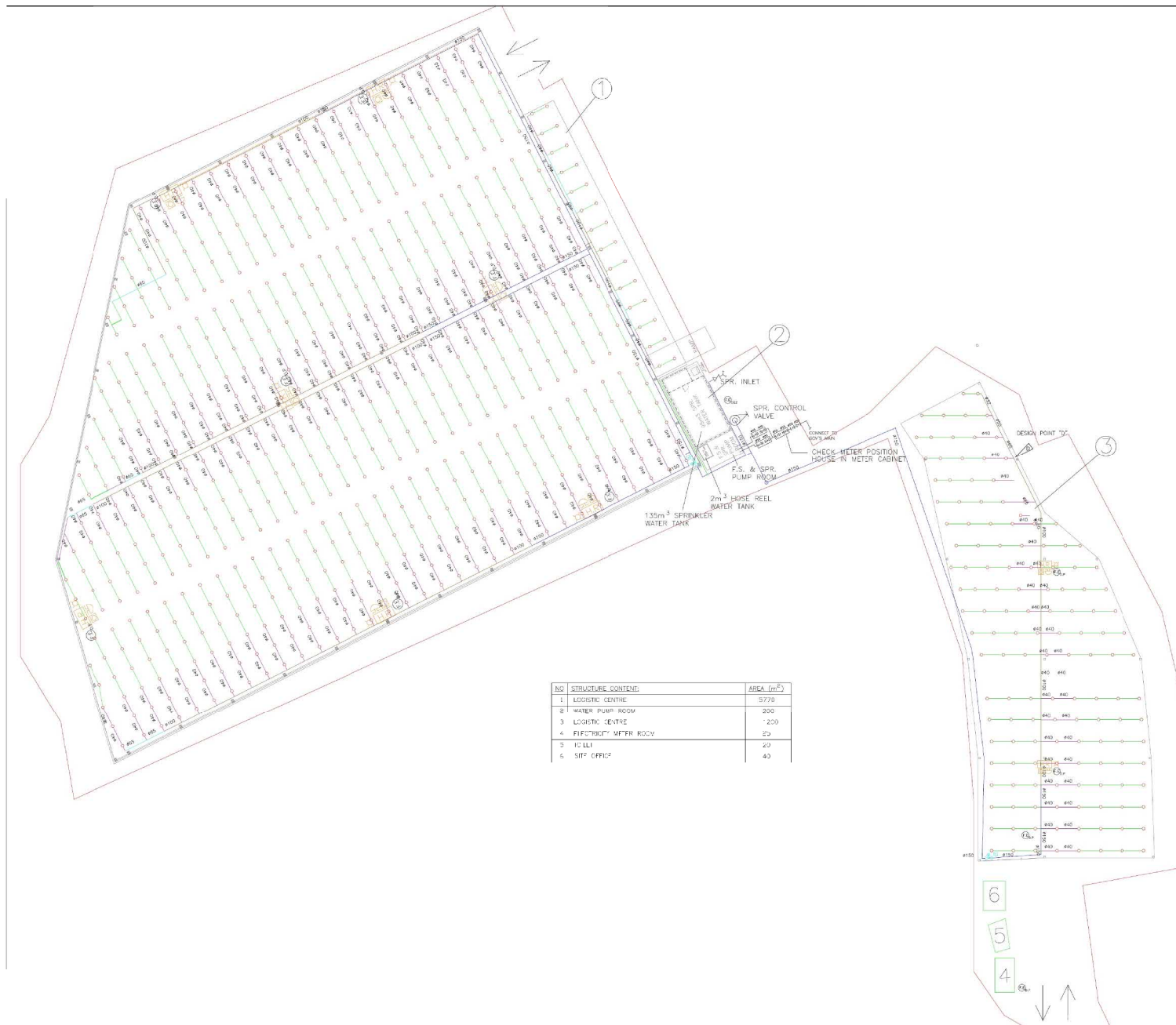

NO	STRUCTURE CONTENT	AREA (m <sup>2</sup> )
1	LOGISTIC CENTRE	5770
2	WATER PUMP ROOM	200
3	LOGISTIC CENTRE	~200
4	ELECTRICITY MFR ROOM	20
5	TOILET	20
6	SHF OFFICE	40

REV	DESCRIPTION	DATE	BY
B	PLAND SUBMISSION	18-05-2020	JN
A	FSD SUBMISSION	13-09-2016	4Y

FSI CONTRACTOR  
**East Power Engineering Limited**  
 Flat A, 7/F., Hop Sing Commercial Building  
 41 Chi Kiang Street, Tseukwan, Kowloon  
 Fax: 2394-3772 Tel: 2397-5236

PROJECT  
 PROPOSED TEMPORARY LOGISTICS CENTRE FOR A PERIOD OF 3 YEARS AT VARIOUS LOTS IN C.D. 129, HA TSUEN, YUEN LONG.

DRAWING TITLE  
**SPRINKLER SYSTEM LAYOUT PLAN**

	INITIAL	DESIGNATION	DATE
DRAWN BY	JN	S Eng	12-05-2020
DESIGNED BY	JN	S Eng	12-05-2020
CHECKED BY	CM	PM	16-05-2020
APPROVED BY	-	-	-
PROJECT NO.	20325		
PAPER SIZE	A1	PLOT SCALE	1 : 1
DRAWING NO.	EP 20325 FSI02		
SCALE	1:1	REVISION	A

(摘錄自申請人於 19.5.2020 呈交的進一步資料)  
 (Extract from Applicant's Further Information Submitted on 19.5.2020)

參考編號 REFERENCE No. <b>A/HSK/216</b>	繪圖 DRAWING <b>A-5</b>
---	--------------------------

后海灣  
(深圳灣)  
DEEP BAY  
(SHENZHEN WAN)

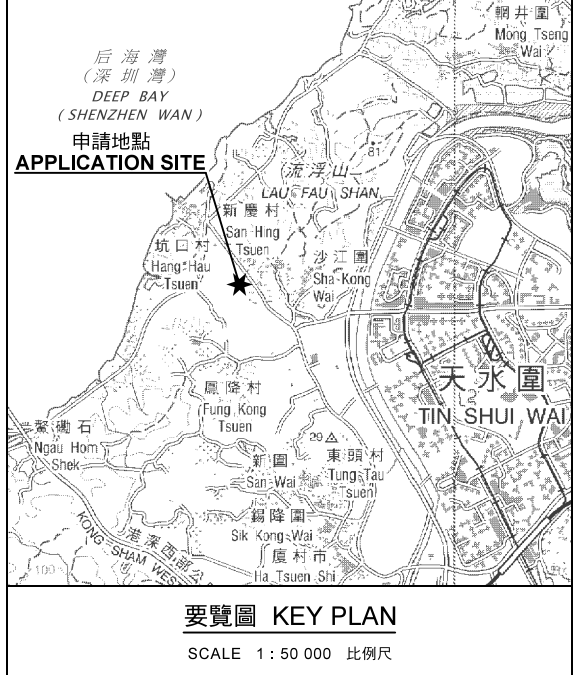
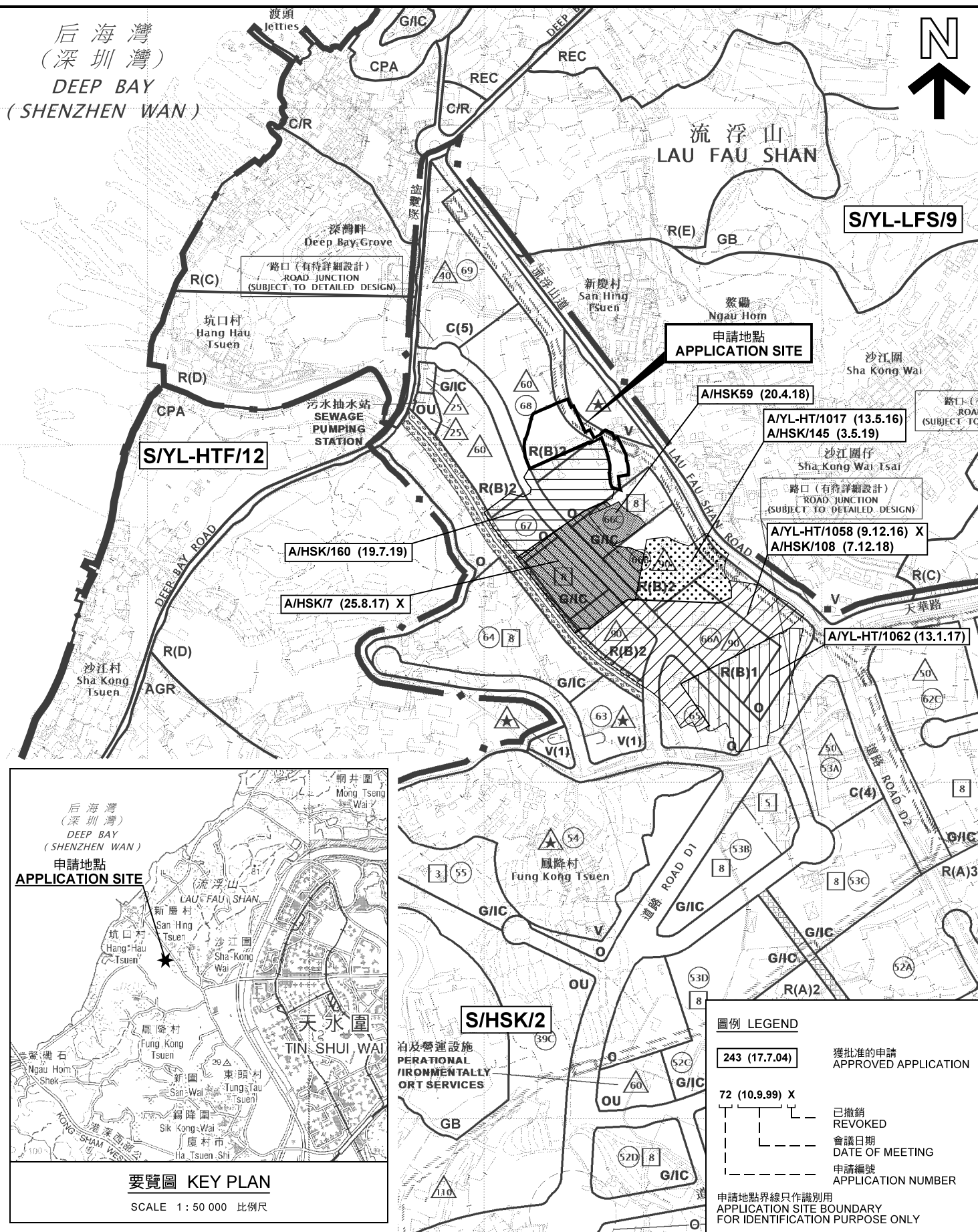

**圖例 LEGEND**

243 (17.7.04)	獲批准的申請 APPROVED APPLICATION
72 (10.9.99) X	已撤銷 REVOKED
	會議日期 DATE OF MEETING
	申請編號 APPLICATION NUMBER

申請地點界線只作識別用  
APPLICATION SITE BOUNDARY  
FOR IDENTIFICATION PURPOSE ONLY

本摘要圖於2020年5月18日擬備，  
所根據的資料為於2018年10月16日  
核准的分區計劃大綱圖編號 S/HSK/2  
EXTRACT PLAN PREPARED ON 18.5.2020  
BASED ON OUTLINE ZONING PLAN No.  
S/HSK/2 APPROVED ON 16.10.2018

位置圖及同類申請 LOCATION PLAN WITH SIMILAR APPLICATIONS

臨時物流中心 (為期3年)  
元朗厦村丈量約份第129約內多個地段  
TEMPORARY LOGISTICS CENTRE  
FOR A PERIOD OF 3 YEARS  
VARIOUS LOTS IN D.D.129,  
HA TSUEN, YUEN LONG

SCALE 1 : 7 500 比例尺

米 100 0 100 200 300 米  
METRES

規劃署  
PLANNING  
DEPARTMENT

參考編號  
REFERENCE No.  
A/HSK/216

圖 PLAN  
A-1a

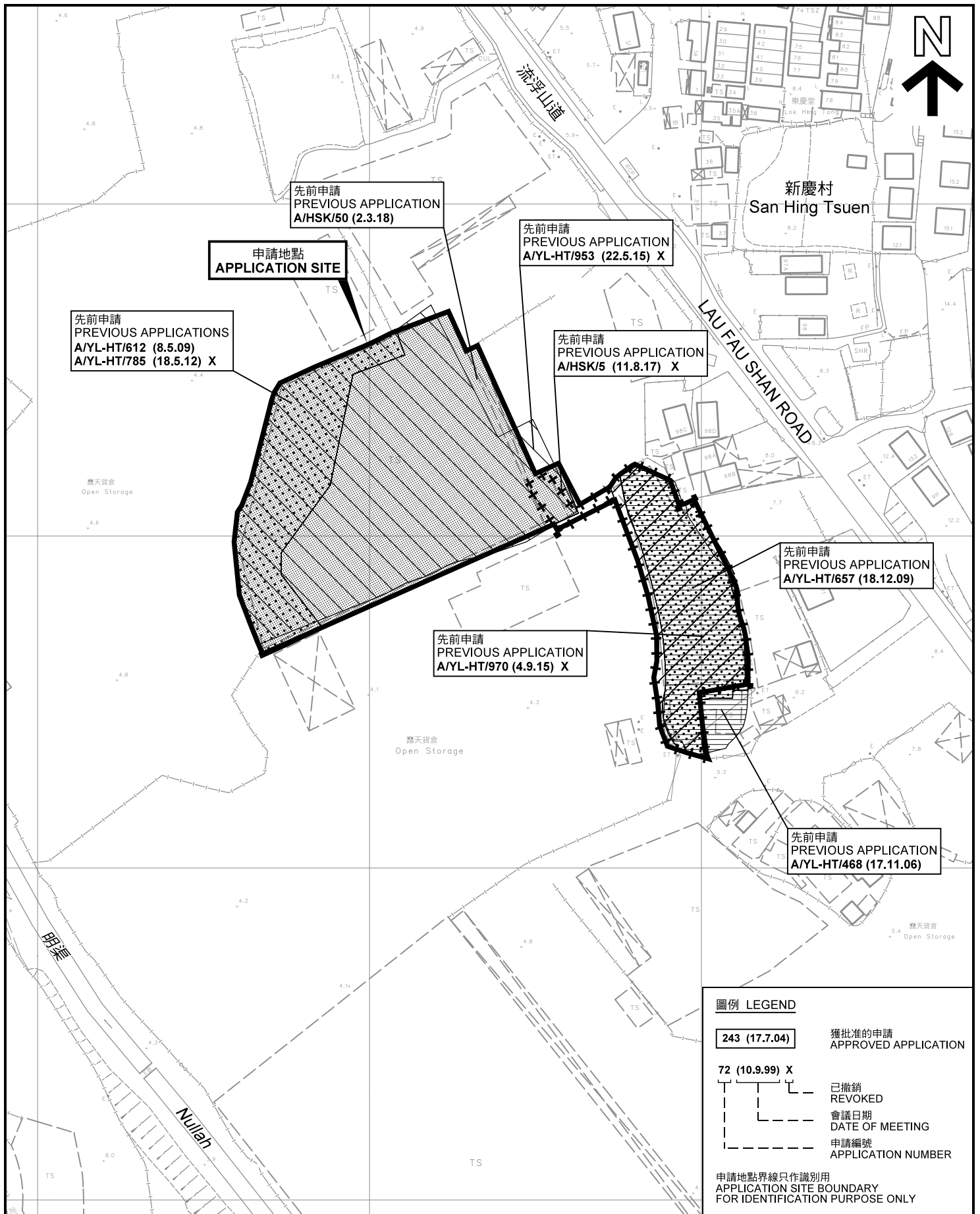

圖例 LEGEND

243 (17.7.04)

獲批准的申請  
APPROVED APPLICATION

72 (10.9.99) X

已撤銷  
REVOKED

會議日期  
DATE OF MEETING

申請編號  
APPLICATION NUMBER

申請地點界線只作識別用  
APPLICATION SITE BOUNDARY  
FOR IDENTIFICATION PURPOSE ONLY

先前申請圖 PREVIOUS APPLICATIONS PLAN

臨時物流中心 (為期3年)  
元朗廈村丈量約份第129約內多個地段  
TEMPORARY LOGISTICS CENTRE  
FOR A PERIOD OF 3 YEARS  
VARIOUS LOTS IN D.D. 129,  
HA TSUEN, YUEN LONG

SCALE 1 : 1 500 比例尺  
米 METRES 20 0 20 40 60 米 METRES

本摘要圖於2020年5月18日擬備，所根據的資料為測量圖編號 2-SW-21D、2-SW-22C 6-NW-1B 及 6-NW-2A  
EXTRACT PLAN PREPARED ON 18.5.2020 BASED ON SURVEY SHEETS No. 2-SW-21D, 2-SW-22C, 6-NW-1B & 6-NW-2A

規劃署  
PLANNING  
DEPARTMENT



參考編號  
REFERENCE No.  
A/HSK/216

圖 PLAN  
A-1b

(申請編號 A/HSK/161  
臨時露天存放貨櫃  
於 19.7.2019 獲得批准直至 19.7.2022)  
(Application No. A/HSK/161  
Temporary Open Storage of Containers  
Approved on 19.7.2019 up to 19.7.2022)

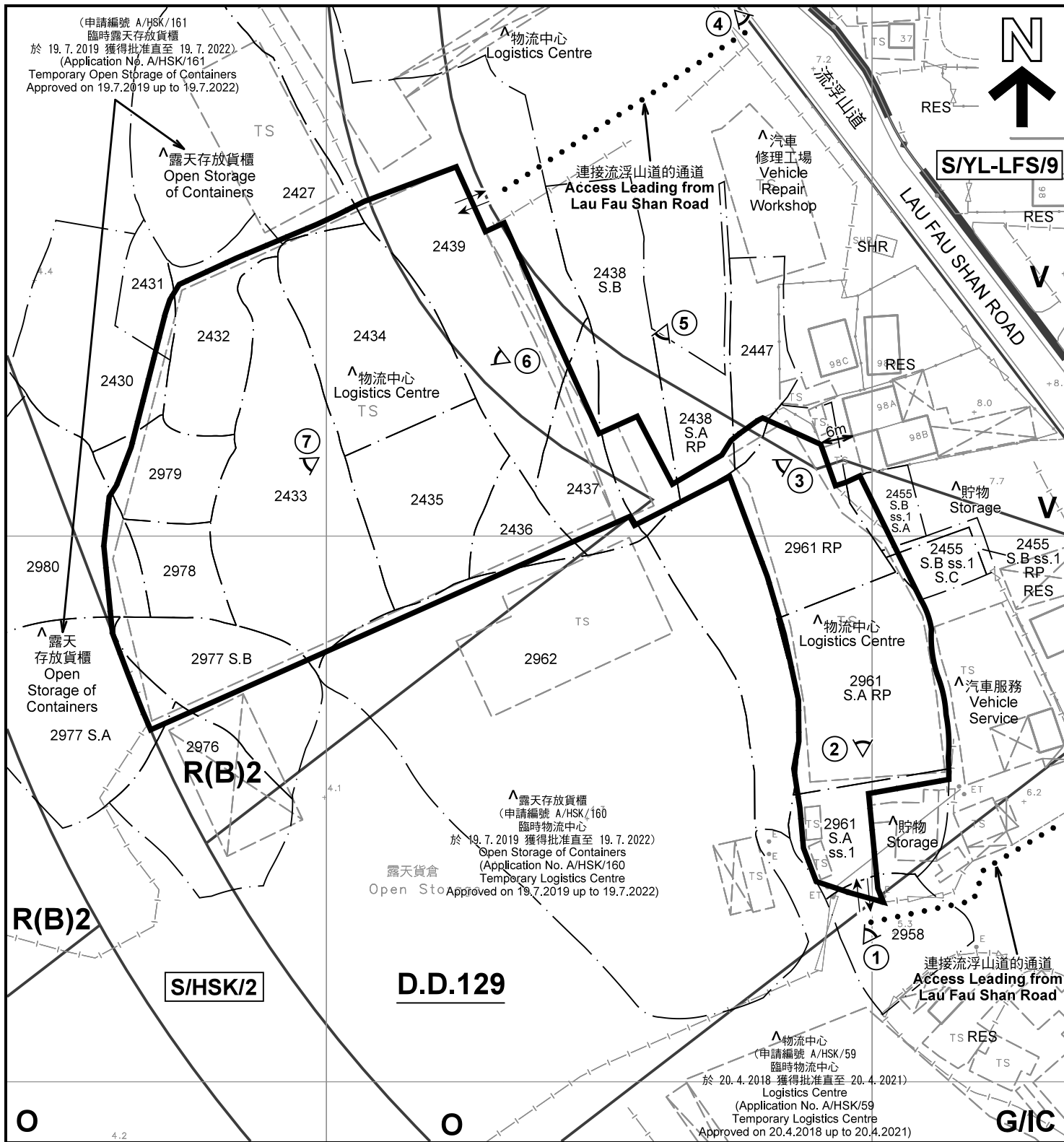

註釋 Notes :

- (1) 2020年5月5日勘測的土地用途  
Land uses shown on this plan are in accordance with the land use survey conducted by the Planning Department on 5.5.2020
- (2) \* 土地用途跟1992年3月勘測的土地用途一致  
Indicates that the use is the same as that revealed by the land use survey conducted by the Planning Department in Mar 1992
- (3) ^ 土地用途跟1992年3月勘測的土地用途有別  
Indicates that the use is different from that revealed by the land use survey conducted by the Planning Department in Mar 1992

圖例 LEGEND

- 申請地點(界線只作識別用)  
APPLICATION SITE  
(BOUNDARY FOR IDENTIFICATION  
PURPOSE ONLY)
- R(B)** 住宅(乙類)  
RESIDENTIAL (GROUP B)
- V** 鄉村式發展  
VILLAGE TYPE DEVELOPMENT
- G/I/C** 政府、機構或社區  
GOVERNMENT, INSTITUTION OR  
COMMUNITY
- 休憩用地  
OPEN SPACE
- RES** 住用構築物  
RESIDENTIAL STRUCTURES
- SHR** 神龕  
SHRINE
- 實地照片的觀景點  
VIEWING POINT OF SITE PHOTO
- 入口/出口  
INGRESS / EGRESS

平面圖 SITE PLAN

臨時物流中心 (為期3年)  
元朗廈村丈量約份第129約內多個地段  
TEMPORARY LOGISTICS CENTRE  
FOR A PERIOD OF 3 YEARS  
VARIOUS LOTS IN D. D. 129,  
HA TSUEN, YUEN LONG

本摘要圖於2020年5月18日擬備, 所根據的資料為測量圖編號 2-SW-22C 及 6-NW-2A  
EXTRACT PLAN PREPARED ON 18.5.2020  
BASED ON SURVEY SHEETS No.  
2-SW-22C & 6-NW-2A

SCALE 1 : 1 000 比例尺  
米 METRES 20 0 20 40 米 METRES

規劃署  
PLANNING  
DEPARTMENT



參考編號  
REFERENCE No.  
A/HSK/216

圖 PLAN  
A-2





圖例 LEGEND



申請地點(界線只作識別用)  
APPLICATION SITE  
(BOUNDARY FOR IDENTIFICATION  
PURPOSE ONLY)

本摘要圖於2020年5月18日擬備，所根據的資料為地政總署於2018年1月3日拍得的航攝照片編號 E033182C  
EXTRACT PLAN PREPARED ON 18.5.2020  
BASED ON AERIAL PHOTO No.  
E033182C TAKEN ON 3.1.2018  
BY LANDS DEPARTMENT

航攝照片 AERIAL PHOTO

臨時物流中心 (為期3年)  
元朗廈村丈量約份第129約內多個地段  
TEMPORARY LOGISTICS CENTRE  
FOR A PERIOD OF 3 YEARS  
VARIOUS LOTS IN D.D.129,  
HA TSUEN, YUEN LONG

規劃署  
PLANNING  
DEPARTMENT



參考編號  
REFERENCE No.  
A/HSK/216

圖 PLAN  
A-3

申請地點  
APPLICATION SITE



連接流浮山道的通道  
Access Leading from  
Lau Fau Shan Road

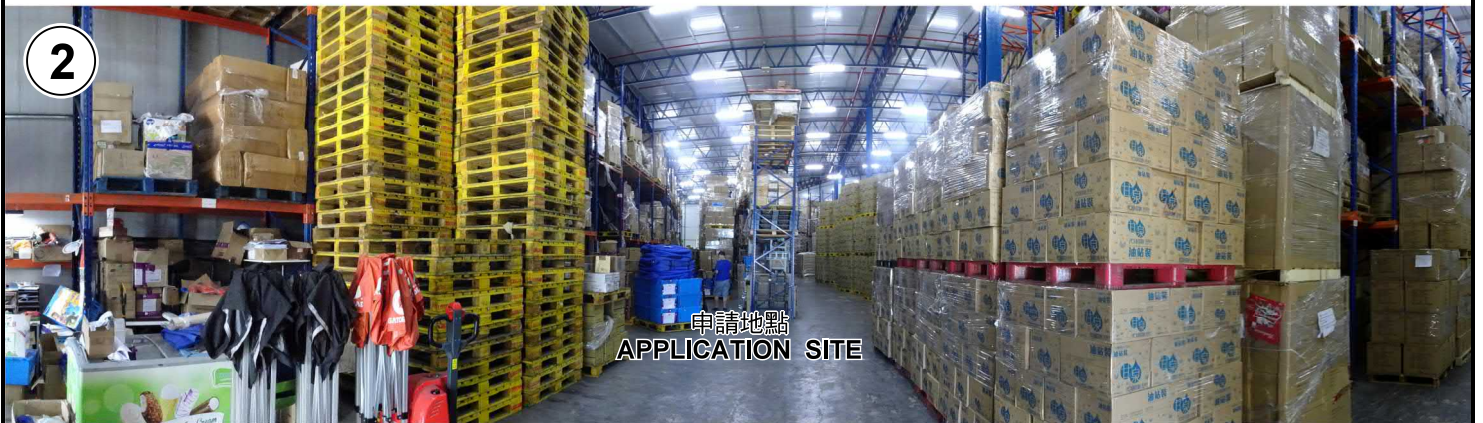

申請地點  
APPLICATION SITE



申請地點  
APPLICATION SITE

本圖於2020年5月18日擬備，所根據的資料為攝於2020年5月5日的實地照片  
PLAN PREPARED ON 18.5.2020  
BASED ON SITE PHOTOS  
TAKEN ON 5.5.2020

實地照片 SITE PHOTOS

臨時物流中心（為期3年）  
元朗厦村丈量約份第129約內多個地段  
TEMPORARY LOGISTICS CENTRE  
FOR A PERIOD OF 3 YEARS  
VARIOUS LOTS IN D.D.129,  
HA TSUEN, YUEN LONG

規劃署  
PLANNING  
DEPARTMENT



參考編號  
REFERENCE No.  
A/HSK/216

圖 PLAN  
A-4a



本圖於2020年5月18日擬備，所根據的資料為攝於2020年5月15日的實地照片  
 PLAN PREPARED ON 18.5.2020  
 BASED ON SITE PHOTOS  
 TAKEN ON 15.5.2020

**實地照片 SITE PHOTOS**

臨時物流中心（為期3年）  
 元朗廈村丈量約份第129約內多個地段  
 TEMPORARY LOGISTICS CENTRE  
 FOR A PERIOD OF 3 YEARS  
 VARIOUS LOTS IN D.D.129,  
 HA TSUEN, YUEN LONG

規劃署  
 PLANNING  
 DEPARTMENT



參考編號  
 REFERENCE No.  
 A/HSK/216

圖 PLAN  
 A-4b

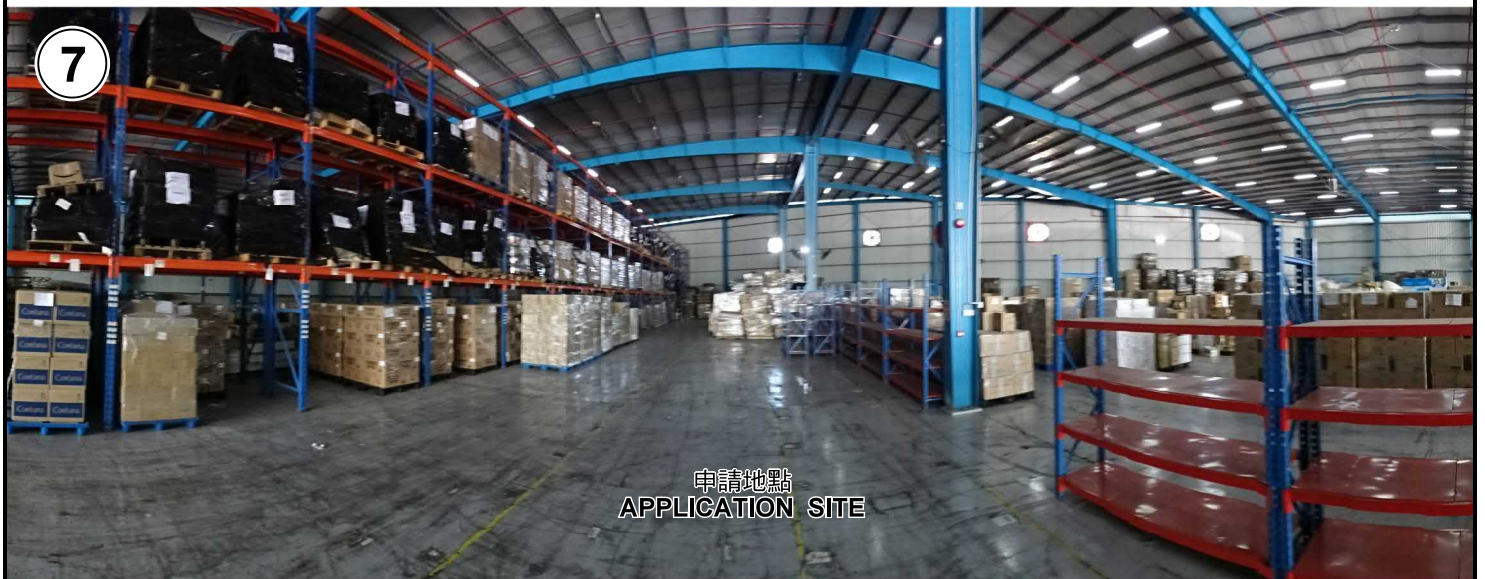

本圖於2020年5月18日擬備，所根據的資料為攝於2020年5月15日的實地照片  
 PLAN PREPARED ON 18.5.2020  
 BASED ON SITE PHOTOS  
 TAKEN ON 15.5.2020

**實地照片 SITE PHOTOS**

臨時物流中心（為期3年）  
 元朗厦村丈量約份第129約內多個地段  
 TEMPORARY LOGISTICS CENTRE  
 FOR A PERIOD OF 3 YEARS  
 VARIOUS LOTS IN D.D.129,  
 HA TSUEN, YUEN LONG

規 劃 署  
**PLANNING  
 DEPARTMENT**



參考編號  
 REFERENCE No.  
 A/HSK/216

圖 PLAN  
 A-4c