

<p>Legend</p> <ul style="list-style-type: none"> The Application Site The Development Site Lots to be surrendered Access to the Application Site <p>Base Plan Extracted from Survey Sheet No.6-NW-12B and 6-NW-13A updated on 2.5.2017 and 18.1.2017 Respectively</p>	<p>Existing Access to Hung Chi Road</p> <p>S16 Application for Proposed Private Elderly Home cum Senior Citizen Housing Various Lots in DD127, Hung Tin Road, Ping Shan, Yuen Long</p> <p>0 10 20 30 40 50 METRES</p>	<p>Plan 2.3</p> <p>PlanArch Consultants Ltd.</p> <p>Revision: Date: 27.2.2018</p>
----------------------------------------------------------------------------------------------------------------------------------------------------------------------------------------------------------------------------------------------------------------------------------------------------------------------------	------------------------------------------------------------------------------------------------------------------------------------------------------------------------------------------------------------------------------	---------------------------------------------------------------------------------------------------------------

(摘錄自申請人於 11. 4. 2018 呈交的申請書)
 (Extract from Applicant's Submission of 11.4.2018)

<p>參考編號 REFERENCE No. A/HSK/67</p>	<p>繪圖 DRAWING A-1</p>
-------------------------------------------------------------	------------------------------------------

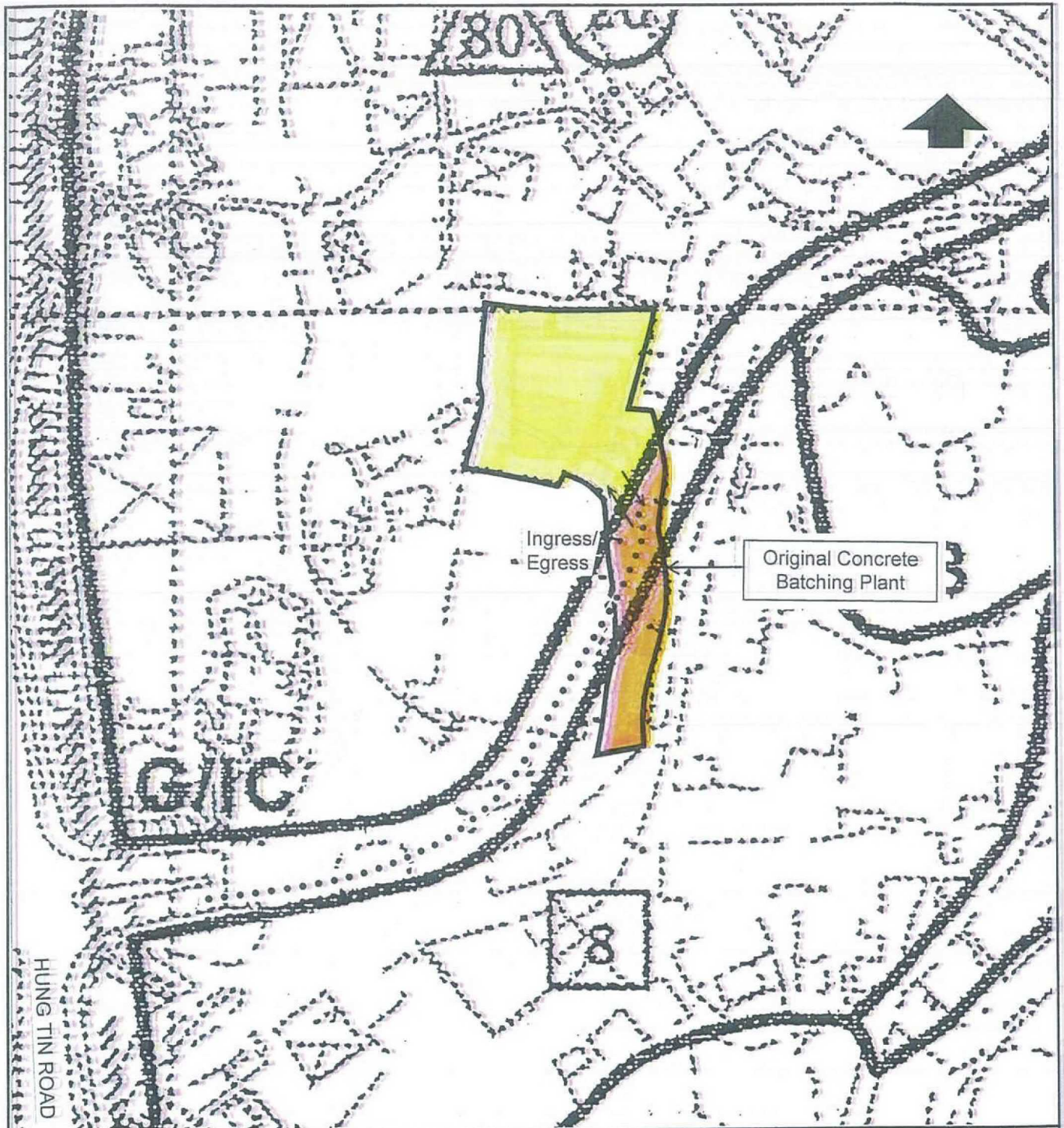

Legend

- The Application Site
- The Development Site
- Lots to be surrendered
- Access to the Application Site

Plan Extracted from
Hung Shui Kiu and
Ha Tsuen Outline Zoning Plan
No. S/HSK/1 Exhibited on
26.5.2017

Future Access

S16 Application for
Proposed Private Elderly Home
cum Senior Citizen Housing
Various Lots in DD127, Hung Tin Road,
Ping Shan, Yuen Long

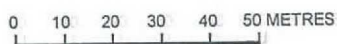

Plan 2.4

PlanArch Consultants Ltd.

Revision: Date: 5.3.2018

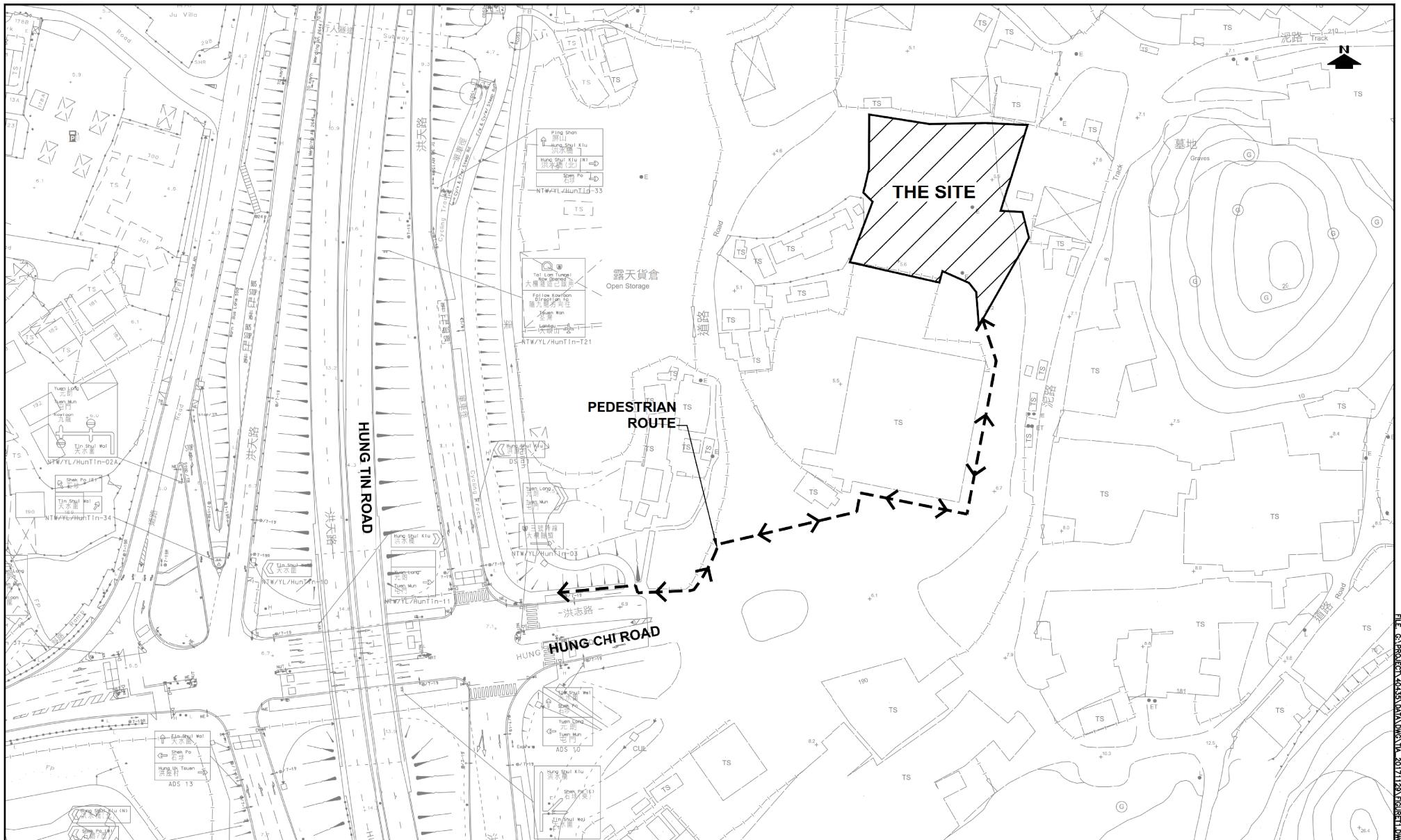

PROJECT NO. 40435		PROJECT TITLE PROPOSED ELDERLY HOME CUM SENIOR CITIZEN HOUSING AT PING SHAN, NEW TERRITORIES		DRAWING NO. FIGURE T1		REV. .	
DESIGNED GWL	DATE NOV 2018	DRAWING TITLE PEDESTRIAN ROUTE TO/FROM THE SITE		LLA 顧問有限公司 Consultancy Limited			
DRAWN CLL	SCALE 4:1500						
CHECKED SLN							

FILE: G:\PROJECT\40435\DATA\DWG\TA_20171129\FIGURE1.DWG PLOT SCALE: 1 = 1

(摘錄自申請人於 26. 11. 2018 提交的進一步資料)
 (Extract from Applicant's Further Information Submitted on 26.11.2018)

參考編號 REFERENCE No. A/HSK/67	繪圖 DRAWING A-3
-----------------------------------	-------------------



Plan 4.1 G/F Plan and Landscape Plan
(Revision A)
N.T.S

參考編號 REFERENCE No. A/HSK/67	繪圖 DRAWING A-4
-----------------------------------	-------------------



Plan 4.2 Private Elderly Home (1/F to 5/F)
 (Revision A)
 N.T.S

參考編號 REFERENCE No. A/HSK/67	繪圖 DRAWING A-5
-----------------------------------	-------------------



Plan 4.3 Senior Citizen Housing (6/F to 9/F)

N.T.S

參考編號 REFERENCE No. A/HSK/67	繪圖 DRAWING A-6
-----------------------------------	-------------------

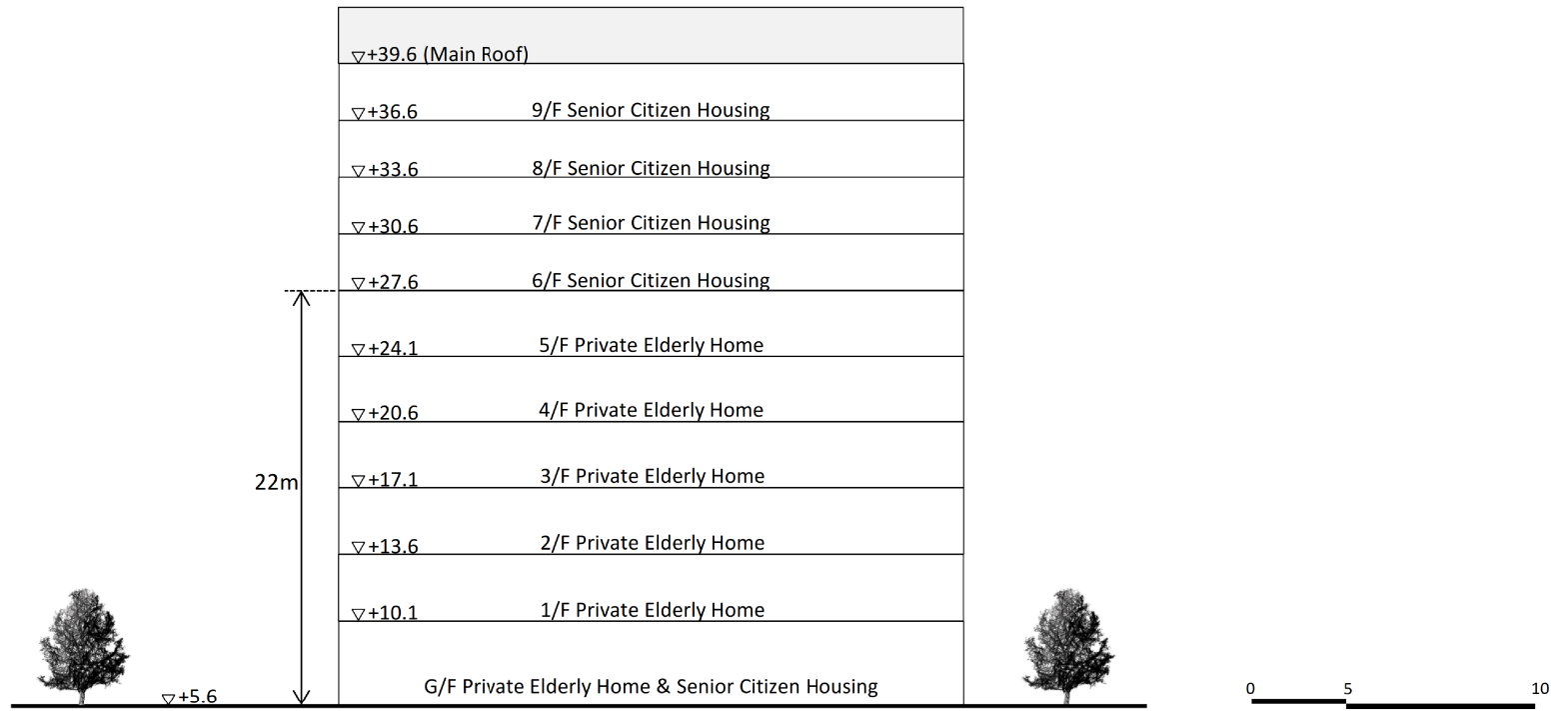

Plan 4.4 Section (Revision A)

參考編號 REFERENCE No. A/HSK/67	繪圖 DRAWING A-7
-----------------------------------	-------------------

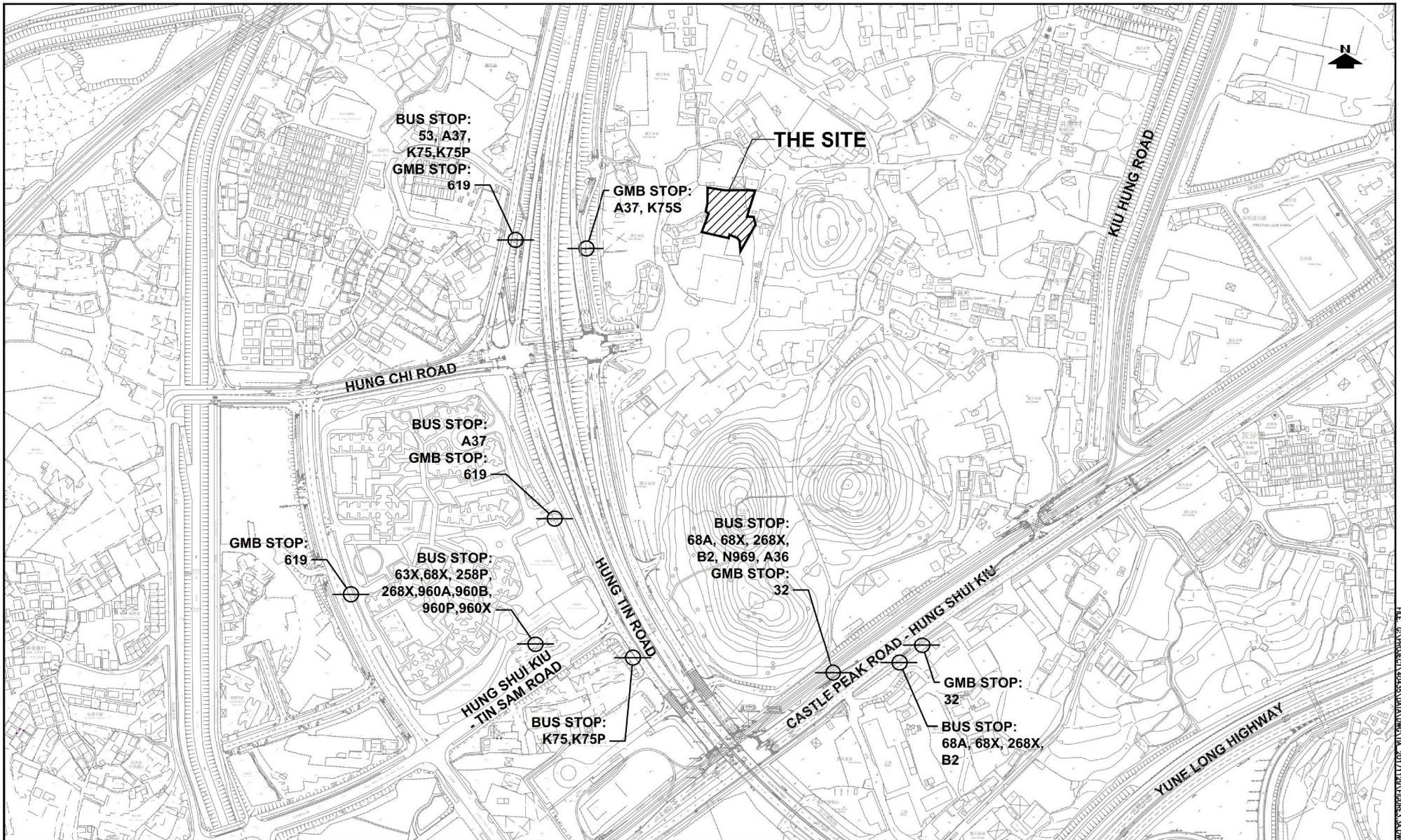

PROJECT NO. 40435		PROJECT TITLE PROPOSED ELDERLY HOME CUM SENIOR CITIZEN HOUSING AT PING SHAN, NEW TERRITORIES		DRAWING NO. FIGURE 3.3	REV. A
DESIGNED GWL	DATE NOV 2018	DRAWING TITLE			
DRAWN CLL	SCALE 1:5000	EXISTING PUBLIC TRANSPORT SERVICES			
CHECKED SLN		LLA 顧問有限公司 Consultancy Limited			

FILE: G:\PROJECT\40435\DATA\DWG\TA_20171129\FIGURE3.3A.DWG PLOT SCALE: 1:1

(摘錄自申請人於 26. 11. 2018 提交的進一步資料)
(Extract from Applicant's Further Information Submitted on 26.11.2018)

參考編號 REFERENCE No. A/HSK/67	繪圖 DRAWING A-8
-----------------------------------	-------------------

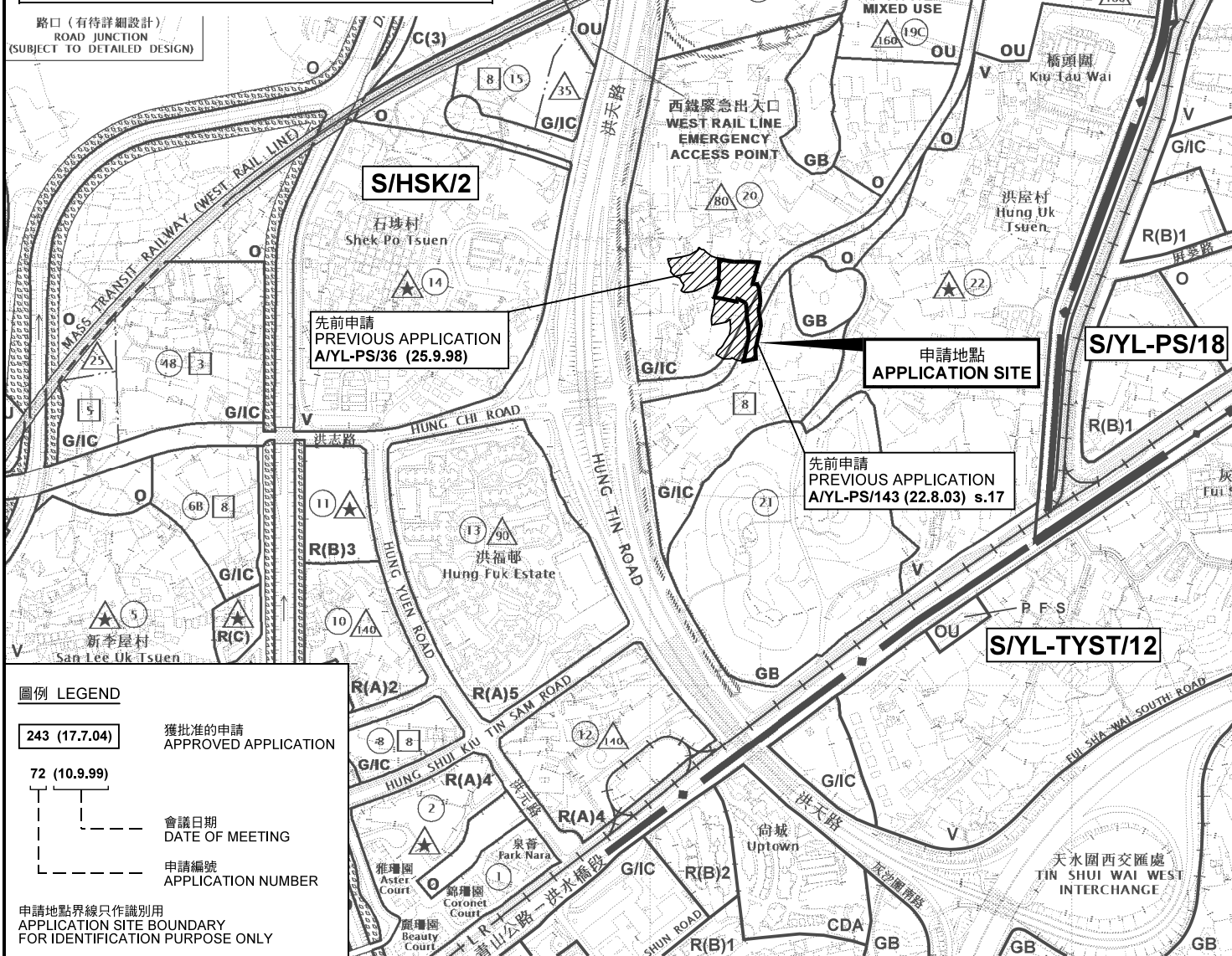
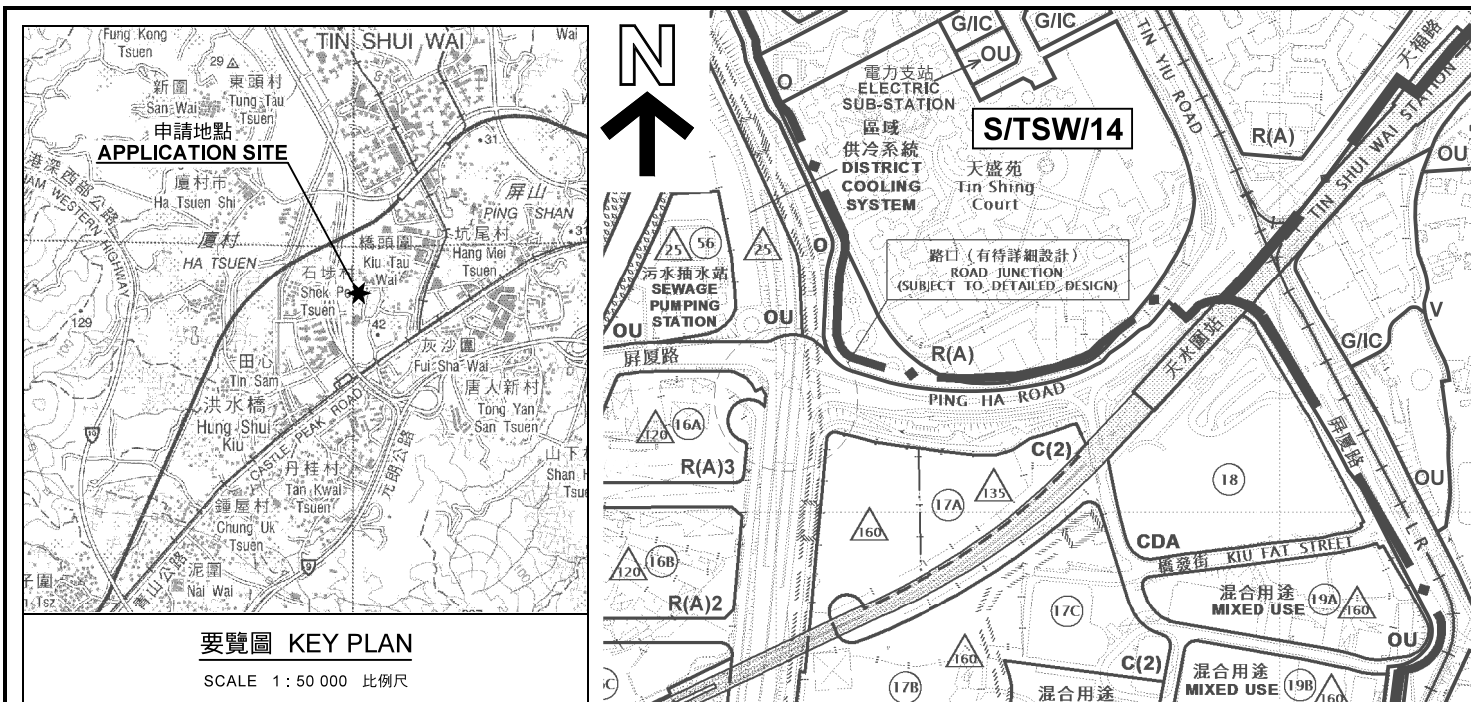

圖例 LEGEND

243 (17.7.04)	獲批准的申請 APPROVED APPLICATION
72 (10.9.99)	會議日期 DATE OF MEETING
	申請編號 APPLICATION NUMBER

申請地點界線只作識別用
APPLICATION SITE BOUNDARY
FOR IDENTIFICATION PURPOSE ONLY

本摘要圖於2019年4月2日擬備，
所根據的資料為於2018年10月16日
核准的分區計劃大綱圖編號 S/HSK/2
EXTRACT PLAN PREPARED ON 2.4.2019
BASED ON OUTLINE ZONING PLAN No.
S/HSK/2 APPROVED ON 16.10.2018

位置圖 LOCATION PLAN

擬議社會福利設施（私營安老院）及住宿機構（長者住屋）
元朗屏山丈量約份第124約地段第793號、丈量約份第127約地段第70號、第71號、
第72號、第73號、第74號、第75號、第76號、第77號、第215號餘段及第216號
PROPOSED SOCIAL WELFARE FACILITY (PRIVATE ELDERLY HOME) AND
RESIDENTIAL INSTITUTION (SENIOR CITIZEN HOUSING)
LOT 793 IN D.D.124, LOTS 70, 71, 72, 73, 74, 75, 76, 77,
215 RP AND 216 IN D.D.127, PING SHAN, YUEN LONG

SCALE 1:7 500 比例尺

米 100 0 100 200 300 米
METRES

**規劃署
PLANNING
DEPARTMENT**



參考編號
REFERENCE No.
A/HSK/67

**圖 PLAN
A-1a**

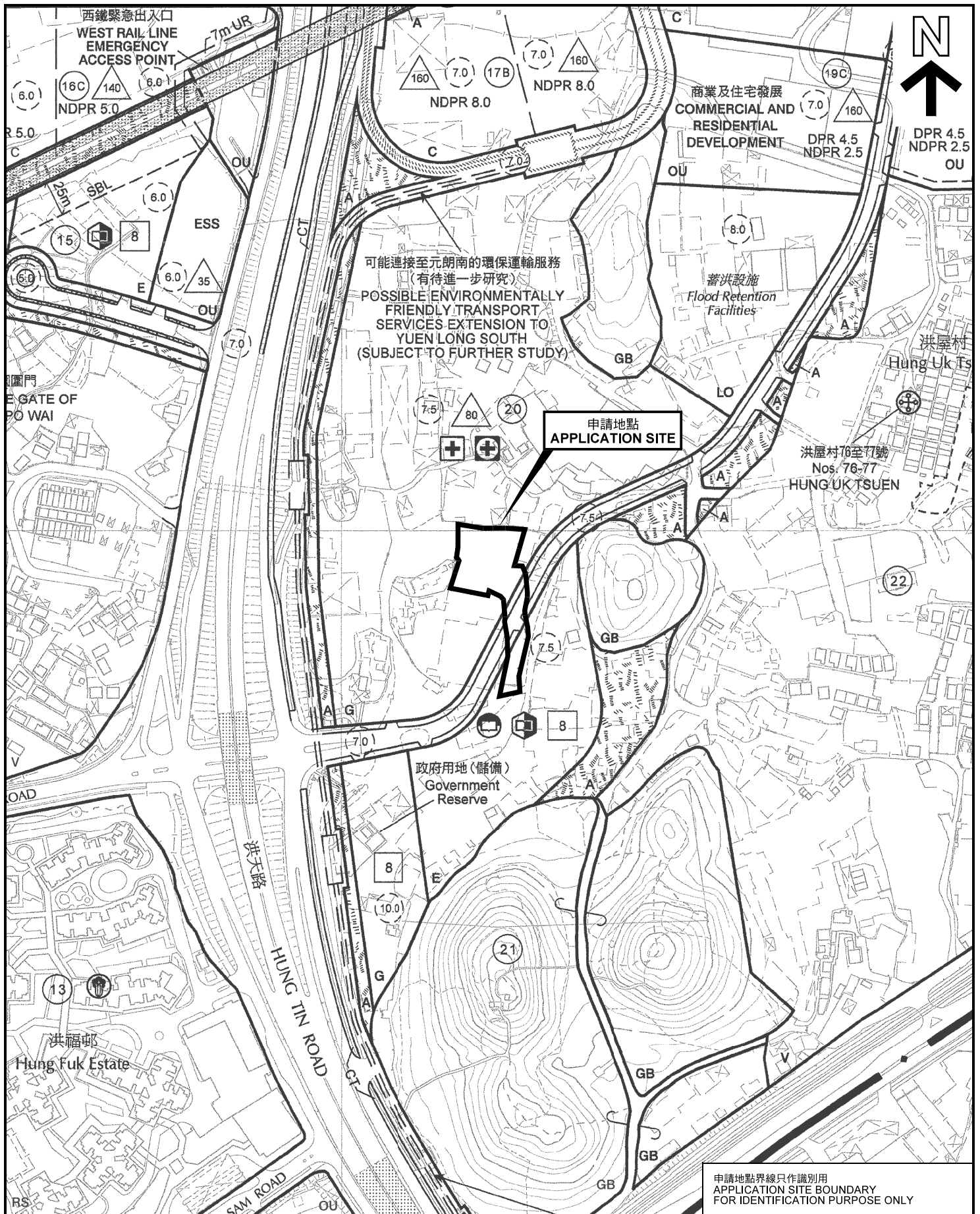

位置圖 LOCATION PLAN

本摘要圖於2019年4月2日擬備，
所根據的資料為於2017年4月13日
已採納的發展大綱圖編號 D/HSK/1 (SHEET 1)
EXTRACT PLAN PREPARED ON 2.4.2019
BASED ON OUTLINE DEVELOPMENT
PLAN No. D/HSK/1 (SHEET 1) ADOPTED
ON 13.4.2017

擬議社會福利設施（私營安老院）及住宿機構（長者住屋）
元朗屏山丈量約份第124約地段第793號、丈量約份第127約地段第70號、第71號、
第72號、第73號、第74號、第75號、第76號、第77號、第215號餘段及第216號
PROPOSED SOCIAL WELFARE FACILITY (PRIVATE ELDERLY HOME) AND
RESIDENTIAL INSTITUTION (SENIOR CITIZEN HOUSING)
LOT 793 IN D.D.124, LOTS 70, 71, 72, 73, 74, 75, 76, 77,
215 RP AND 216 IN D.D.127, PING SHAN, YUEN LONG

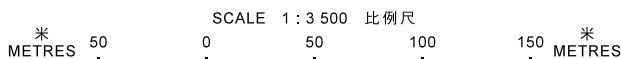

申請地點界線只作識別用
APPLICATION SITE BOUNDARY
FOR IDENTIFICATION PURPOSE ONLY

規劃署
PLANNING
DEPARTMENT



參考編號
REFERENCE No.
A/HSK/67

圖 PLAN
A-1b

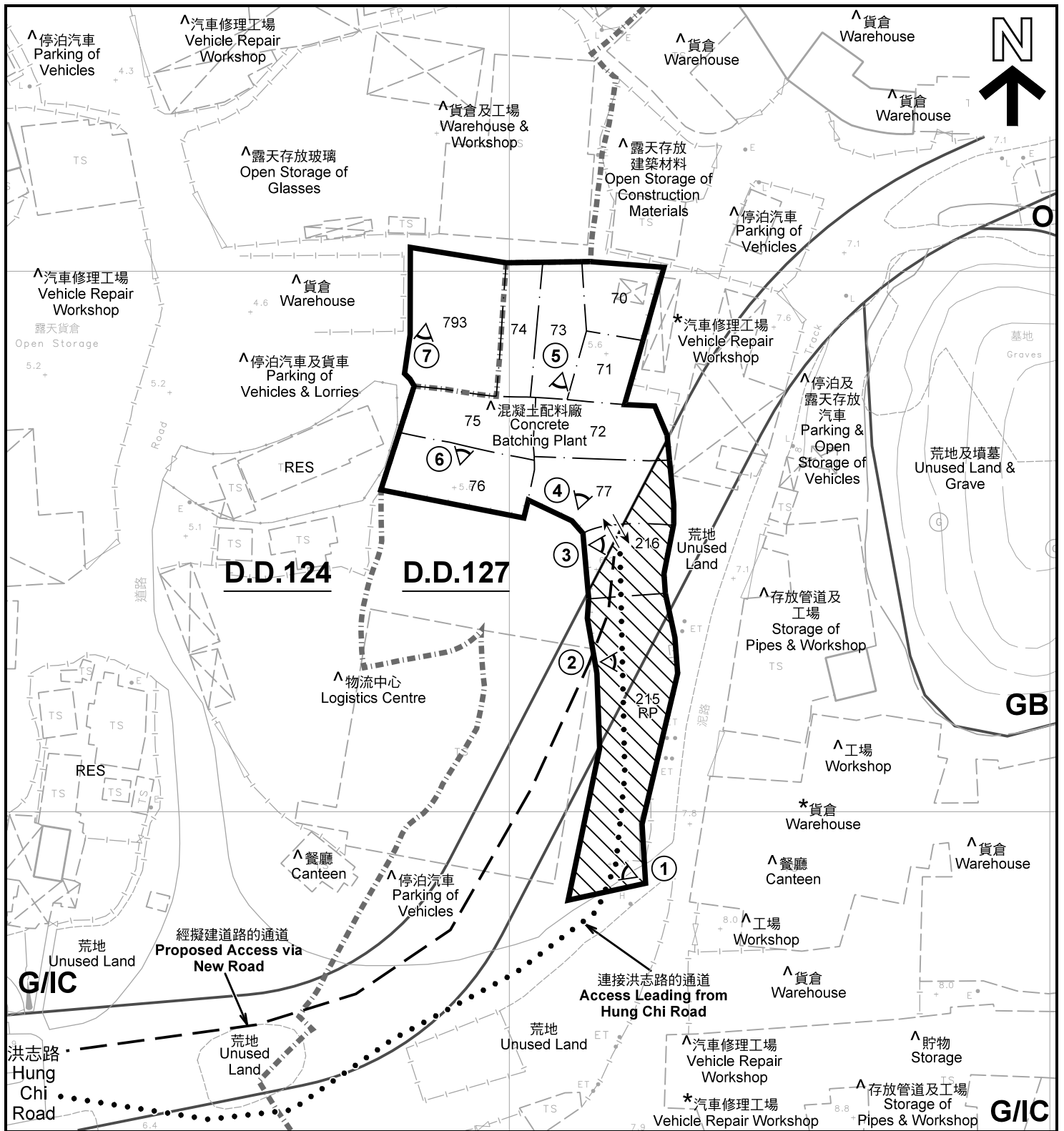

註釋 Notes :

- (1) 2019年3月26日勘測的土地用途
Land uses shown on this plan are in accordance with the land use survey conducted by the Planning Department on 26.3.2019
- (2) * 土地用途跟1993年7月2日及7月5日勘測的土地用途一致
Indicates that the use is the same as that revealed by the land use survey conducted by the Planning Department on 2.7.1993 & 5.7.1993
- (3) ^ 土地用途跟1993年7月2日及7月5日勘測的土地用途有別
Indicates that the use is different from that revealed by the land use survey conducted by the Planning Department on 2.7.1993 & 5.7.1993

圖例 LEGEND

- 申請地點(界線只作識別用)
APPLICATION SITE (BOUNDARY FOR IDENTIFICATION PURPOSE ONLY)
- 擬議交出地段
AREA TO BE SURRENDERED
- 政府、機構或社區
GOVERNMENT, INSTITUTION OR COMMUNITY
- 休憩用地
OPEN SPACE
- GB 綠化地帶
GREEN BELT
- RES 住用構築物
RESIDENTIAL STRUCTURES
- 丈量約份界線
D.D. BOUNDARY
- ① 實地照片的觀景點
VIEWING POINT OF SITE PHOTO
- 入口/出口
INGRESS / EGRESS

平面圖 SITE PLAN

擬議社會福利設施(私營安老院)及住宿機構(長者住屋)
元朗屏山丈量約份第124約地段第793號、丈量約份第127約地段第70號、第71號、第72號、第73號、第74號、第75號、第76號、第77號、第215號餘段及第216號
PROPOSED SOCIAL WELFARE FACILITY (PRIVATE ELDERLY HOME) AND RESIDENTIAL INSTITUTION (SENIOR CITIZEN HOUSING)
LOT 793 IN D.D.124, LOTS 70, 71, 72, 73, 74, 75, 76, 77, 215 RP AND 216 IN D.D.127, PING SHAN, YUEN LONG

SCALE 1 : 1 000 比例尺

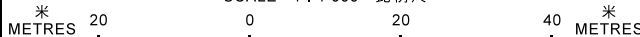

規劃署
PLANNING
DEPARTMENT



參考編號
REFERENCE No.
A/HSK/67

圖 PLAN
A-2

本摘要圖於2019年3月27日擬備, 所根據的資料為測量圖編號 6-NW-13A
EXTRACT PLAN PREPARED ON 27.3.2019
BASED ON SURVEY SHEET No. 6-NW-13A



圖例 LEGEND



申請地點 (界線只作識別用)
APPLICATION SITE
(BOUNDARY FOR IDENTIFICATION
PURPOSE ONLY)

本摘要圖於2019年3月27日擬備，所根據的資料為地政總署於2018年3月13日拍得的航攝照片編號 E035272C
EXTRACT PLAN PREPARED ON 27.3.2019
BASED ON AERIAL PHOTO No.
E035272C TAKEN ON 13.3.2018
BY LANDS DEPARTMENT

航攝照片 AERIAL PHOTO

擬議社會福利設施 (私營安老院) 及住宿機構 (長者住屋)
元朗屏山丈量約份第124約地段第793號、丈量約份第127約地段第70號、第71號、
第72號、第73號、第74號、第75號、第76號、第77號、第215號餘段及第216號
PROPOSED SOCIAL WELFARE FACILITY (PRIVATE ELDERLY HOME) AND
RESIDENTIAL INSTITUTION (SENIOR CITIZEN HOUSING)
LOT 793 IN D.D.124, LOTS 70, 71, 72, 73, 74, 75, 76, 77,
215 RP AND 216 IN D.D.127, PING SHAN, YUEN LONG

規劃署
PLANNING
DEPARTMENT



參考編號
REFERENCE No.
A/HSK/67

圖 PLAN
A-3



申請地點界線只作識別用 APPLICATION SITE BOUNDARY FOR IDENTIFICATION PURPOSE ONLY

實地照片 SITE PHOTOS

擬議社會福利設施（私營安老院）及住宿機構（長者住屋）
 元朗屏山丈量約份第124約地段第793號、丈量約份第127約地段第70號、第71號、
 第72號、第73號、第74號、第75號、第76號、第77號、第215號餘段及第216號
 PROPOSED SOCIAL WELFARE FACILITY (PRIVATE ELDERLY HOME) AND
 RESIDENTIAL INSTITUTION (SENIOR CITIZEN HOUSING)
 LOT 793 IN D.D.124, LOTS 70, 71, 72, 73, 74, 75, 76, 77,
 215 RP AND 216 IN D.D.127, PING SHAN, YUEN LONG

規劃署
 PLANNING
 DEPARTMENT



參考編號
 REFERENCE No.
 A/HSK/67

圖 PLAN
 A-4a

本圖於2019年3月27日擬備，所根據的資料為攝於2019年3月26日的實地照片
 PLAN PREPARED ON 27.3.2019
 BASED ON SITE PHOTOS
 TAKEN ON 26.3.2019



申請地點界線只作識別用 APPLICATION SITE BOUNDARY FOR IDENTIFICATION PURPOSE ONLY

實地照片 SITE PHOTOS

擬議社會福利設施（私營安老院）及住宿機構（長者住屋）
元朗屏山丈量約份第124約地段第793號、丈量約份第127約地段第70號、第71號、
第72號、第73號、第74號、第75號、第76號、第77號、第215號餘段及第216號
PROPOSED SOCIAL WELFARE FACILITY (PRIVATE ELDERLY HOME) AND
RESIDENTIAL INSTITUTION (SENIOR CITIZEN HOUSING)
LOT 793 IN D.D.124, LOTS 70, 71, 72, 73, 74, 75, 76, 77,
215 RP AND 216 IN D.D.127, PING SHAN, YUEN LONG

規劃署
PLANNING
DEPARTMENT



參考編號
REFERENCE No.
A/HSK/67

圖 PLAN
A-4b

本圖於2019年3月27日擬備，所根據的
資料為攝於2019年3月26日的實地照片
PLAN PREPARED ON 27.3.2019
BASED ON SITE PHOTOS
TAKEN ON 26.3.2019