

# 地段索引圖 LOT INDEX PLAN

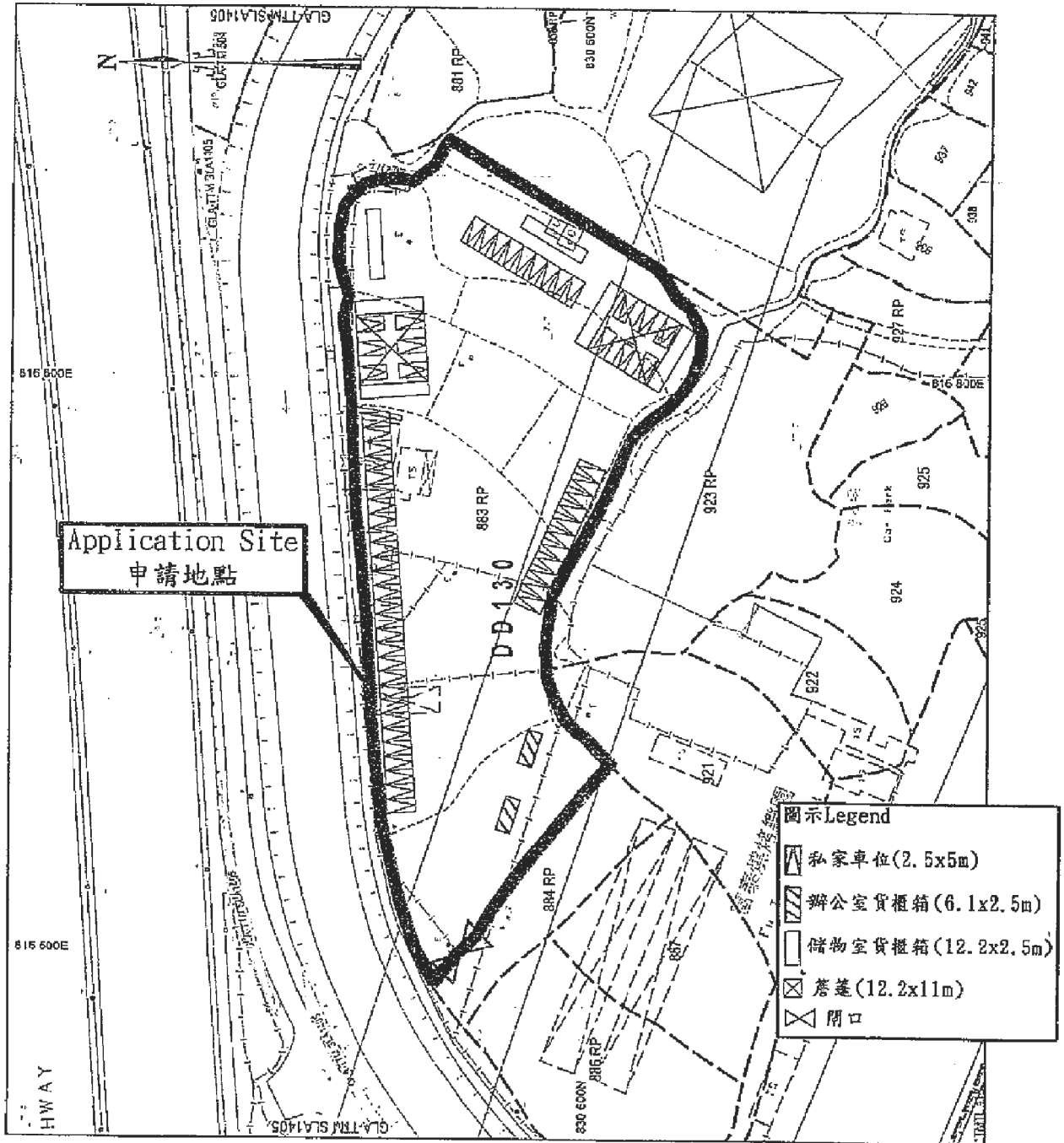

Application Site  
申請地點

- 圖示 Legend
- 私家車位 (2.5x5m)
  - 辦公室貨櫃箱 (6.1x2.5m)
  - 儲物室貨櫃箱 (12.2x2.5m)
  - 蓬 (12.2x11m)
  - 開口

地政總署測繪處 Survey and Mapping Office, Lands Department

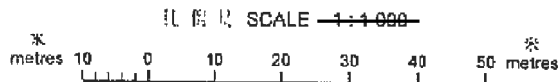

Locality :  
 Lot Index Plan No. : ags S00000018958\_0001  
 District Survey Office : Lands Information Center  
 Date : 26-Apr-2019  
 Reference No. : 6-NW-21B,6-NW-22A,6-NW-21D,6-NW-22C  
 香港特別行政區政府 版權所有  
 © Copyright reserved - Hong Kong SAR Government  
 SMO-PD1 20190426185442 10

免費使用  
 本圖則乃地政總署的副本，顯示地界線的大概位置，包括假設政府撥款、或於政府撥款、短期租約及政府土地租用牌照而臨時佔用土地的情況。倘有佔用土地的情況可應早通知出現現況，因此意向有關的分區地政專員接洽。本圖則所示的資料必須經過地政總署予以核實。倘有更佳或新的地界證據時，地政索引圖可能會按需要訂而此須事先通知。  
 Disclaimer  
 This plan is a copy of the lot index plan showing the approximate location of lot boundaries, including the temporary occupation of land under Government Land Allocations, Temporary Government Land Allocations, Short Term Tenancies and Government Land Licences. The temporary occupation of land may be created or terminated at short notice and should be confirmed with the District Lands Officer. The information shown on this plan **MUST** be verified by field survey. The lot index plan may be revised without prior notification as better or new boundary evidence becomes available

參考編號 REFERENCE No.	繪圖 DRAWING
A/TM-LTY/386	A-1

(摘錄自申請人於13.1.2020呈交申請書)  
 (Extract from Applicant's Submission Dated 13.1.2020)



# 地段索引圖 LOT INDEX PLAN Proposed UC & EX UC

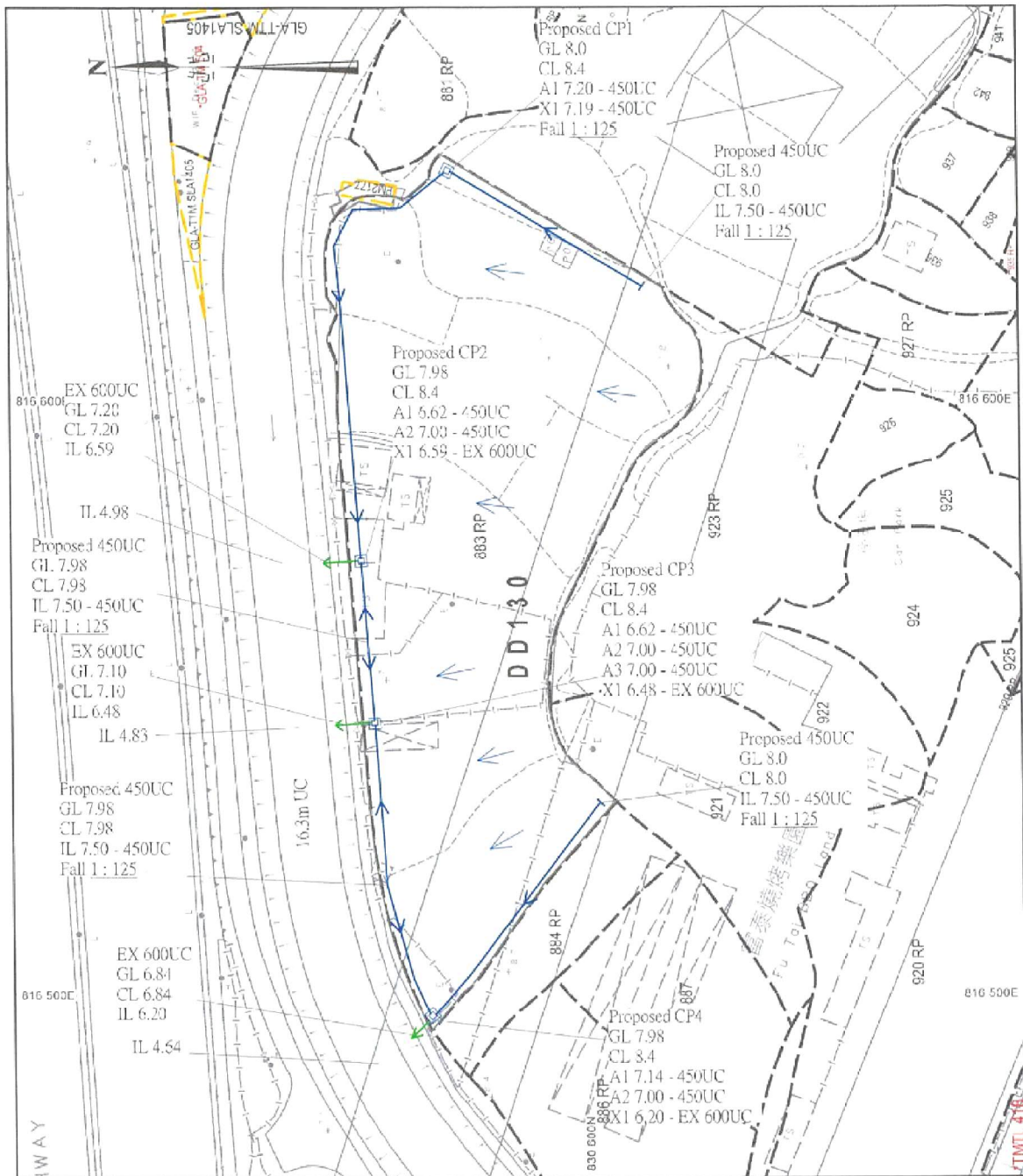

地政總署測繪處 Survey and Mapping Office, Lands Department



Locality :  
 Lot Index Plan No. : **ags\_S00000050473\_0002**  
 District Survey Office : Lands Information Center  
 Date : 19-Jul-2020  
 Reference No. : 6-NW-21B,6-NW-22A,6-NW-21D,6-NW-22C

香港特別行政區政府 — 版權所有  
 © Copyright reserved - Hong Kong SAR Government  
 SMO-P01 20200720034659 10

**摘要說明：**本地地段索引圖在其背景的地形圖上標示了各種永久和短期持有的土地的關係界線。這與土地包括私人地段、政府撥地、短期租約地、以及其他作特殊用途的土地。請注意：(1)本索引圖上的資料會視不時更新而不作事先通知；(2)索引圖的更新或延後於有關資料的實際變更，以及(3)本索引圖中顯示的界線僅供識別之用，資料是否準確可靠，應諮詢專業土地測量師的意見。  
**免費說明：**如因使用本地地段索引圖，或因所依據的本索引圖資料出錯、遺漏、過時或有誤差而引致任何損失或損害，政府概不承擔任何法律責任。

**Explanatory notes :** This plan shows the graphical boundaries of different kinds of permanent and temporary land holdings with the topographic map in the backdrop. The land holdings as shown may include private lots, government land allocations, short term tenancies and other permitted uses of land. It must be noted that: (1) the information shown on this plan is subject to update without prior notification; (2) there may be time lag between an update and the related changes taken place; and (3) the graphical boundaries as shown are for identification purpose only and interpretation of their accuracy and reliability requires the advice from professional land surveyor.  
**Disclaimer:** The Government shall not be responsible for any loss or damage howsoever arising from the use of this plan or in reliance upon its correctness, completeness, timeliness or accuracy.

參考編號 REFERENCE No.	繪圖 DRAWING
A/TM-LTY/386	A-3

(摘錄自申請人於6. 8. 2020呈交的申請書)  
 (Extract from Applicant's Submission Dated 6.8.2020)

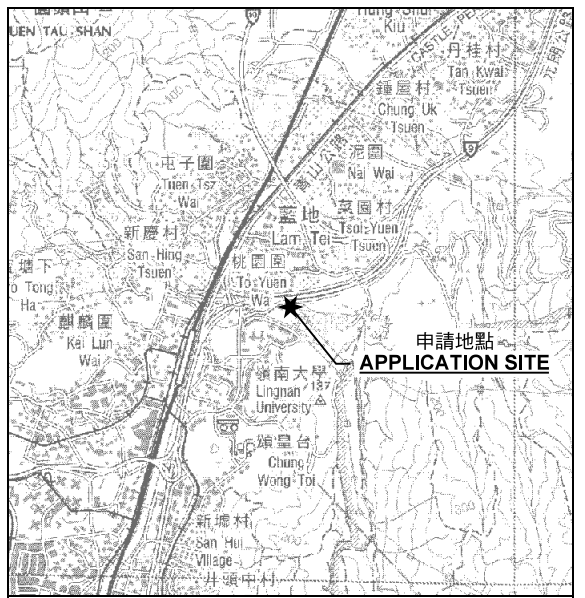
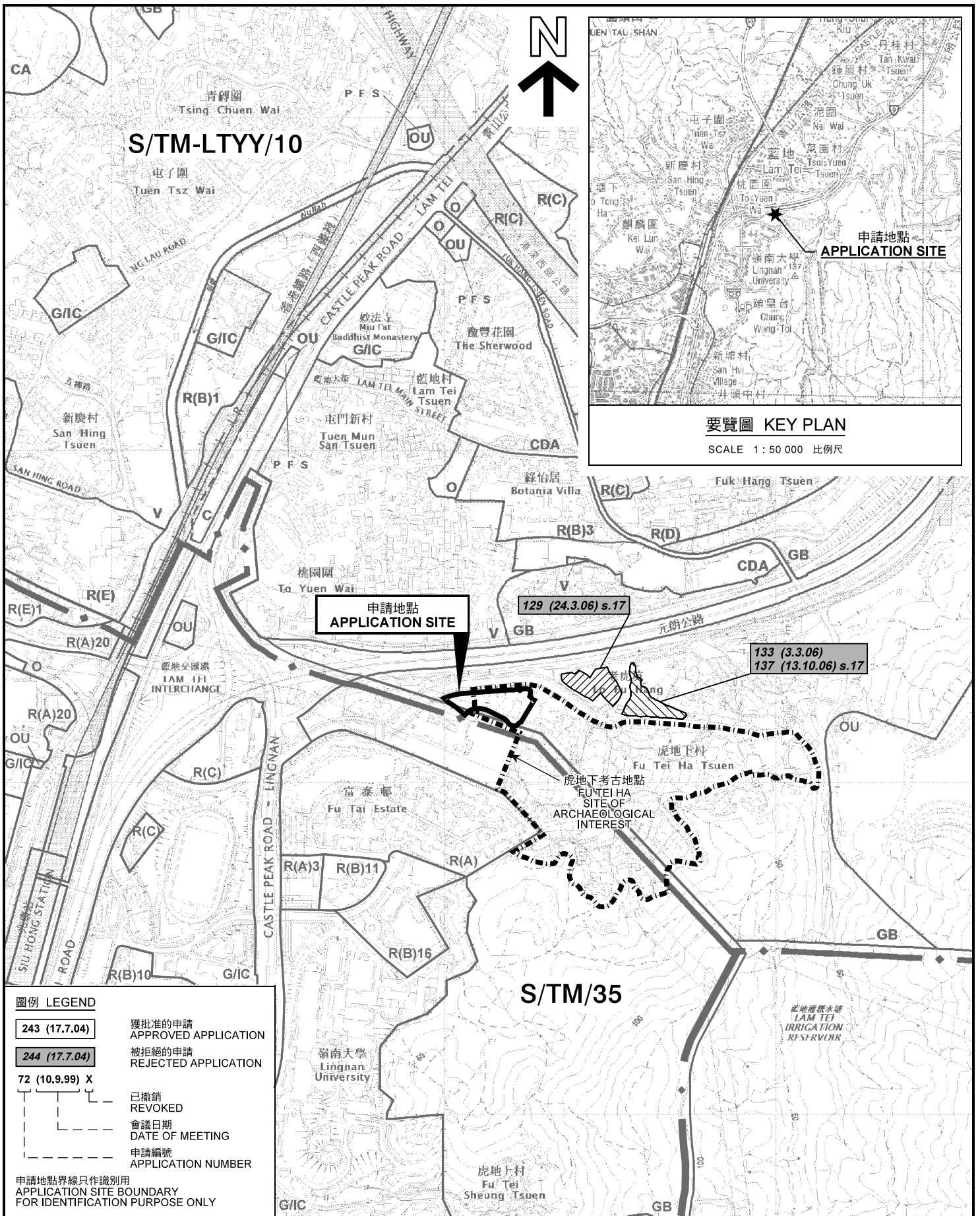

要覽圖 KEY PLAN

SCALE 1 : 50 000 比例尺

圖例 LEGEND

- 243 (17.7.04) 獲批准的申請  
APPROVED APPLICATION
- 244 (17.7.04) 被拒絕的申請  
REJECTED APPLICATION
- 72 (10.9.99) X 已撤銷  
REVOKED
- - - 會議日期  
DATE OF MEETING
- - - 申請編號  
APPLICATION NUMBER

申請地點界線只作識別用  
APPLICATION SITE BOUNDARY  
FOR IDENTIFICATION PURPOSE ONLY

位置圖 LOCATION PLAN

擬議公眾停車場(貨櫃車除外)(為期5年)  
新界屯門藍地丈量約份第130約地段第883號餘段  
PROPOSED TEMPORARY PUBLIC VEHICLE PARK  
(EXCLUDING CONTAINER VEHICLE)  
FOR A PERIOD OF 5 YEARS  
LOT 883 RP IN D.D. 130, LAM TEI,  
TUEN MUN, NEW TERRITORIES

SCALE 1 : 7 500 比例尺

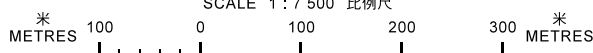

規劃署  
PLANNING  
DEPARTMENT



參考編號  
REFERENCE No.  
A/TM-LTYYY/386

圖 PLAN  
A-1

本摘要圖於2020年12月2日擬備，  
所根據的資料為於2018年10月16日  
核准的分區計劃大綱圖編號 S/TM-LTYYY/10  
EXTRACT PLAN PREPARED ON 2.12.2020  
BASED ON OUTLINE ZONING PLAN No.  
S/TM-LTYYY/10 APPROVED ON 16.10.2018

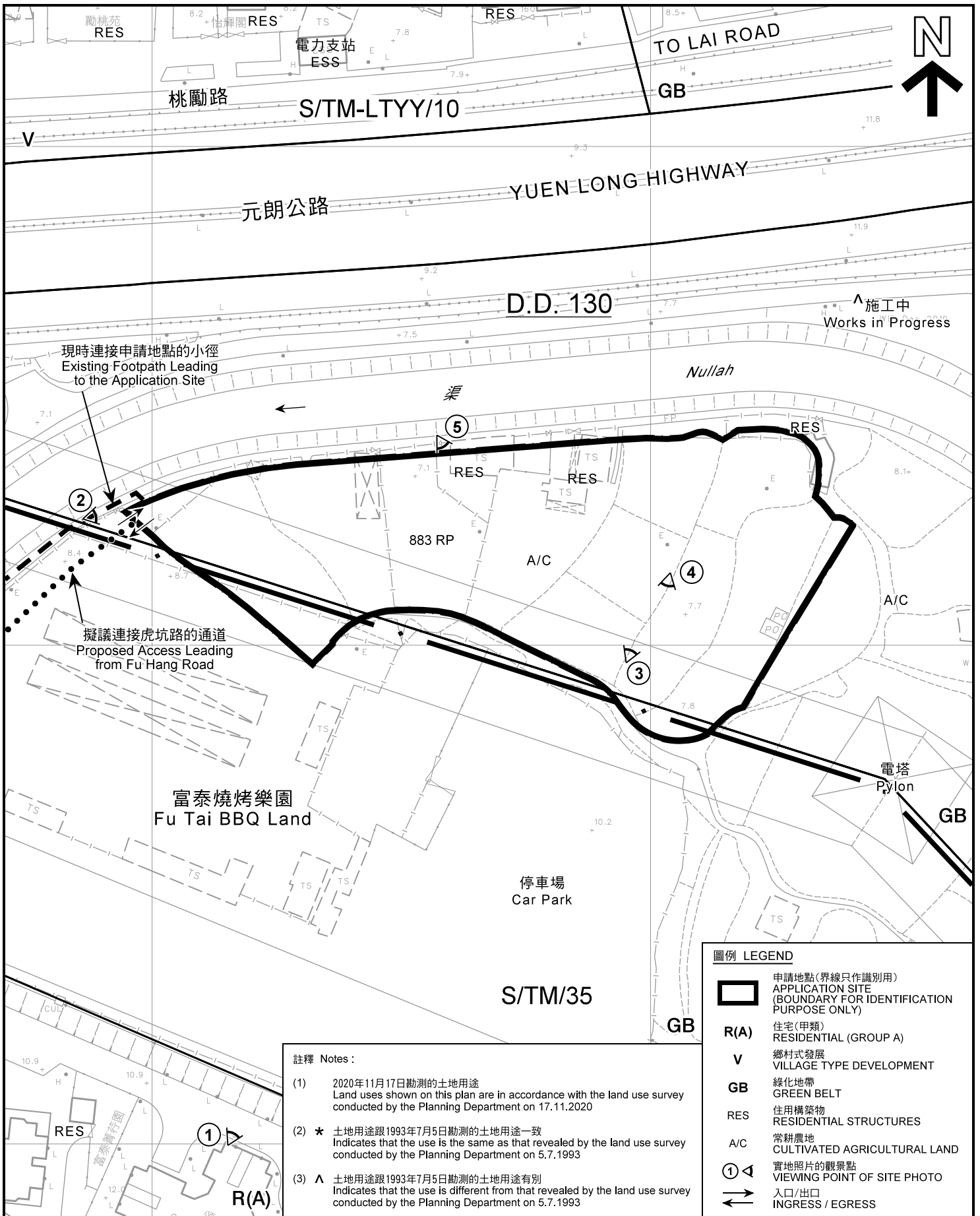

現時連接申請地點的小徑  
Existing Footpath Leading  
to the Application Site

擬議連接虎坑路的通道  
Proposed Access Leading  
from Fu Hang Road

富泰燒烤樂園  
Fu Tai BBQ Land

停車場  
Car Park

▲ 施工中  
Works in Progress

註釋 Notes :

- (1) 2020年11月17日勘測的土地用途  
Land uses shown on this plan are in accordance with the land use survey conducted by the Planning Department on 17.11.2020
- (2) \* 土地用途跟1993年7月5日勘測的土地用途一致  
Indicates that the use is the same as that revealed by the land use survey conducted by the Planning Department on 5.7.1993
- (3) ▲ 土地用途跟1993年7月5日勘測的土地用途有別  
Indicates that the use is different from that revealed by the land use survey conducted by the Planning Department on 5.7.1993

圖例 LEGEND

- 申請地點(界線只作識別用)  
APPLICATION SITE  
(BOUNDARY FOR IDENTIFICATION  
PURPOSE ONLY)
- R(A) 住宅(甲類)  
RESIDENTIAL (GROUP A)
- V 鄉村式發展  
VILLAGE TYPE DEVELOPMENT
- GB 綠化地帶  
GREEN BELT
- RES 住用構築物  
RESIDENTIAL STRUCTURES
- A/C 常耕農地  
CULTIVATED AGRICULTURAL LAND
- ① ▲ 實地照片的觀景點  
VIEWING POINT OF SITE PHOTO
- ↔ 入口/出口  
INGRESS / EGRESS

平面圖 SITE PLAN

擬議公眾停車場(貨櫃車除外)(為期5年)  
新界屯門藍地丈量約份第130約地段第883號餘段  
PROPOSED TEMPORARY PUBLIC VEHICLE PARK  
(EXCLUDING CONTAINER VEHICLE)  
FOR A PERIOD OF 5 YEARS  
LOT 883 RP IN D.D. 130, LAM TEI,  
TUEN MUN, NEW TERRITORIES

SCALE 1 : 1 000 比例尺

米 METRES 20 0 20 40 米 METRES

本摘要圖於2020年12月3日擬備，所根據的資料為測量圖編號 6-NW-21B、21D、22A 及 22C  
EXTRACT PLAN PREPARED ON 3.12.2020  
BASED ON SURVEY SHEETS No.  
6-NW-21B, 21D, 22A & 22C

規劃署  
PLANNING  
DEPARTMENT



參考編號  
REFERENCE No.  
A/TM-LTYYY/386

圖 PLAN  
A-2



**航攝照片 AERIAL PHOTO**  
 擬議公眾停車場(貨櫃車除外)(為期5年)  
 新界屯門藍地丈量約份第130約地段第883號餘段  
 PROPOSED TEMPORARY PUBLIC VEHICLE PARK  
 (EXCLUDING CONTAINER VEHICLE)  
 FOR A PERIOD OF 5 YEARS  
 LOT 883 RP IN D.D. 130, LAM TEI,  
 TUEN MUN, NEW TERRITORIES

**圖例 LEGEND**

 申請地點(界線只作識別用)  
 APPLICATION SITE  
 (BOUNDARY FOR IDENTIFICATION  
 PURPOSE ONLY)

**規劃署**  
**PLANNING**  
**DEPARTMENT**



參考編號  
 REFERENCE No.  
 A/TM-LTTY/386

圖 PLAN  
 A-3



申請地點界線只作識別用  
APPLICATION SITE BOUNDARY FOR IDENTIFICATION PURPOSE ONLY

本圖於2020年12月3日擬備，所根據的資料為攝於2020年11月17日的實地照片  
PLAN PREPARED ON 3.12.2020  
BASED ON SITE PHOTOS  
TAKEN ON 17.11.2020

**實地照片 SITE PHOTO**  
擬議公眾停車場(貨櫃車除外)(為期5年)  
PROPOSED TEMPORARY PUBLIC VEHICLE PARK  
(EXCLUDING CONTAINER VEHICLE)  
FOR A PERIOD OF 5 YEARS  
LOT 883 RP IN D.D. 130, LAM TEI,  
TUEN MUN, NEW TERRITORIES

規劃署  
**PLANNING  
DEPARTMENT**



參考編號  
REFERENCE No.  
A/TM-LTTY/386

圖 PLAN  
A-4a



申請地點界線只作識別用  
APPLICATION SITE BOUNDARY FOR IDENTIFICATION PURPOSE ONLY

本圖於2020年12月3日擬備，所根據的資料為攝於2020年11月17日的實地照片  
PLAN PREPARED ON 3.12.2020  
BASED ON SITE PHOTOS  
TAKEN ON 17.11.2020

**實地照片 SITE PHOTO**  
擬議公眾停車場(貨櫃車除外)(為期5年)  
新界屯門藍地丈量約份第130約地段第883號餘段  
PROPOSED TEMPORARY PUBLIC VEHICLE PARK  
(EXCLUDING CONTAINER VEHICLE)  
FOR A PERIOD OF 5 YEARS  
LOT 883 RP IN D.D. 130, LAM TEI,  
TUEN MUN, NEW TERRITORIES

規劃署  
**PLANNING  
DEPARTMENT**



參考編號  
REFERENCE No.  
A/TM-LTTY/386

圖 PLAN  
A-4b