

Approved Lam Tei and Yick Yuen Outline Zoning Plan No. S/TM-LTY/10

<p>Not to Scale</p>	<p>Location Plan</p>	<p>Goldrich Planners & Surveyors Ltd.</p>
<p>January 2020</p>	<p>Lots 1211C (Part), 1248 (Part) and 1249 (Part) in D. D. 130 Fuk Hang Tsuen, Tuen Mun, New Territories</p>	<p>Plan 1 (P 16043)</p>

<p>參考編號 REFERENCE No. A/TM-LTY/396</p>	<p>繪圖 DRAWING A-1</p>
--	---------------------------

(摘錄自申請人於5.3.2020呈交的申請書)
(Extract from Applicant's
Submission Dated 5.3.2020)

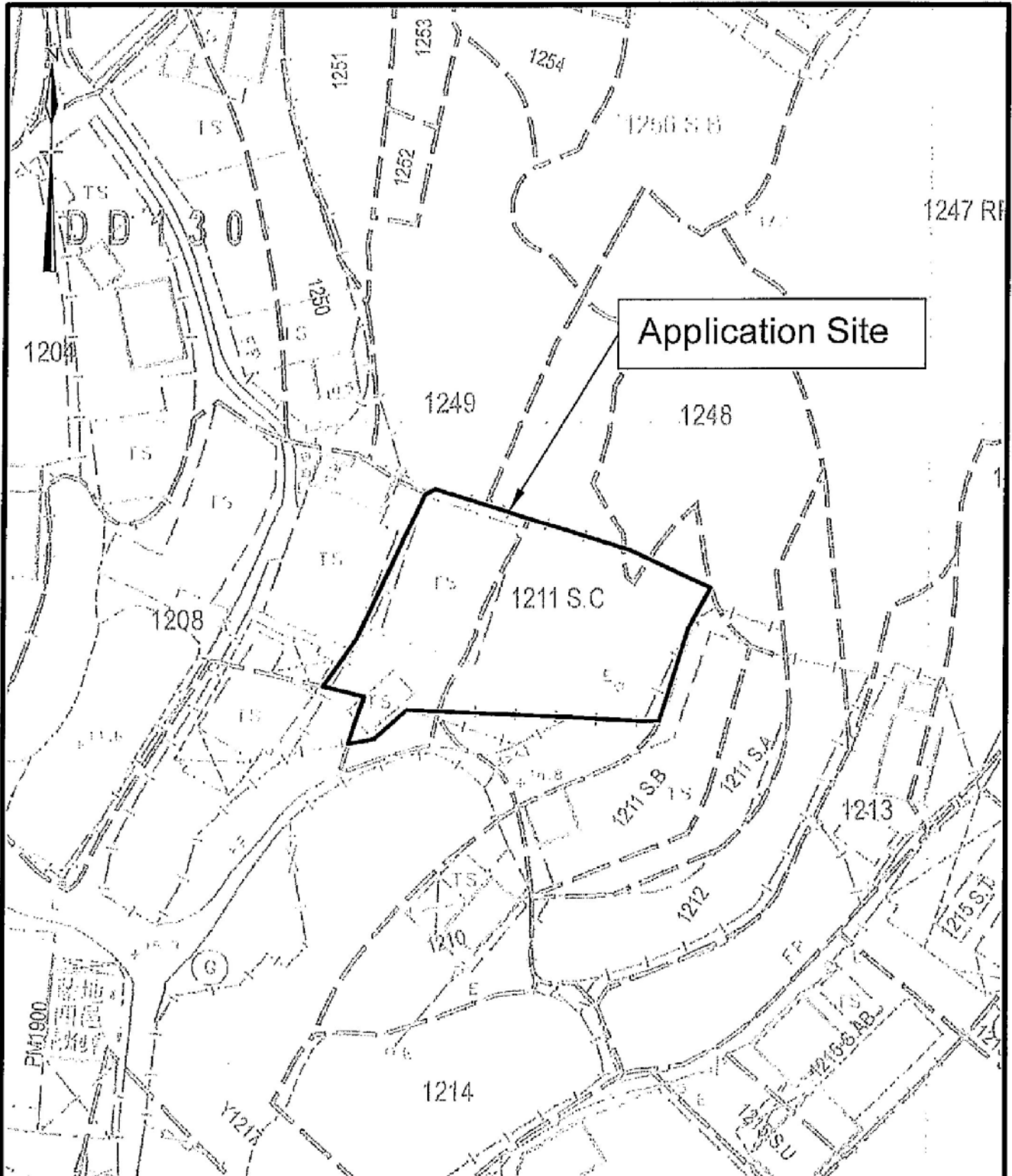

 Total Site Area : 580.8 m²

±:500-	Lot Index Plan	Goldrich Planners & Surveyors Ltd.
October 2019	Lots 1211C (Part), 1248 (Part) and 1249 (Part) in D. D. 130 Fuk Hang Tsuen, Tuen Mun, New Territories	Plan 2 (P 16043)

參考編號 REFERENCE No. A/TM-LTY/396	繪圖 DRAWING A-2
---	--------------------------

(摘錄自申請人於5.3.2020呈交的申請書)
(Extract from Applicant's
Submission Dated 5.3.2020)

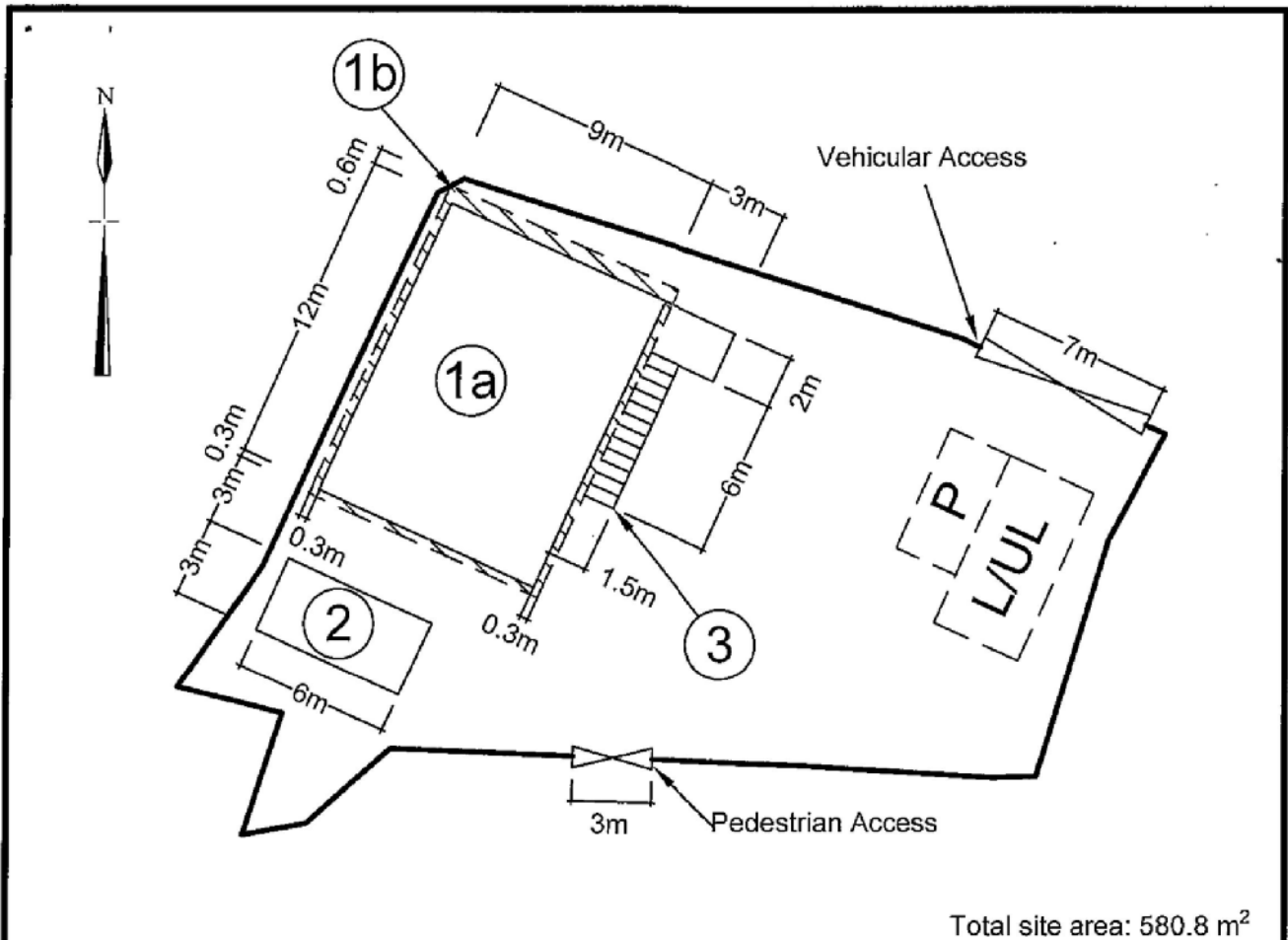

Legend:

[P] Parking Space for Private Car: 5m x 2.5m

[L/UL] Loading/Unloading area for
Light Goods Vehicle: 7m x 3.5m

Structure	Uses	Covered Area	Floor Area	No of Storey	Height (m)
1a	Local Provisions Store (G/F) Real Estate Agency (1/F)	12m x 9m = 108m ²	108m ² x 2 = 216m ²	2	7
1b	Shed Projection	15.8m ²	15.8m ²	-	7.5
2	Container-Converted Toilet (G/F) and Storage (1/F)	6m x 3m = 18m ²	18m ² x 2 = 36m ²	2	7
3	Open Staircase and Platform*	12m ²	12m ²	1	3
	Total	153.8m ²	279.8m ²		

* Exclude the overlapping area with the shed projection (Structure 1b)

1:250	Site Plan	Goldrich Planners & Surveyors Ltd.
January 2020	Lots 1211C (Part), 1248 (Part) and 1249 (Part) in D. D. 130 Fuk Hang Tsuen, Tuen Mun, New Territories	Plan 3 (P 16043)

參考編號 REFERENCE No. A/TM-LTYT/396	繪圖 DRAWING A-3
-------------------------------------	-------------------

(摘錄自申請人於5.3.2020呈交的申請書)
(Extract from Applicant's
Submission Dated 5.3.2020)

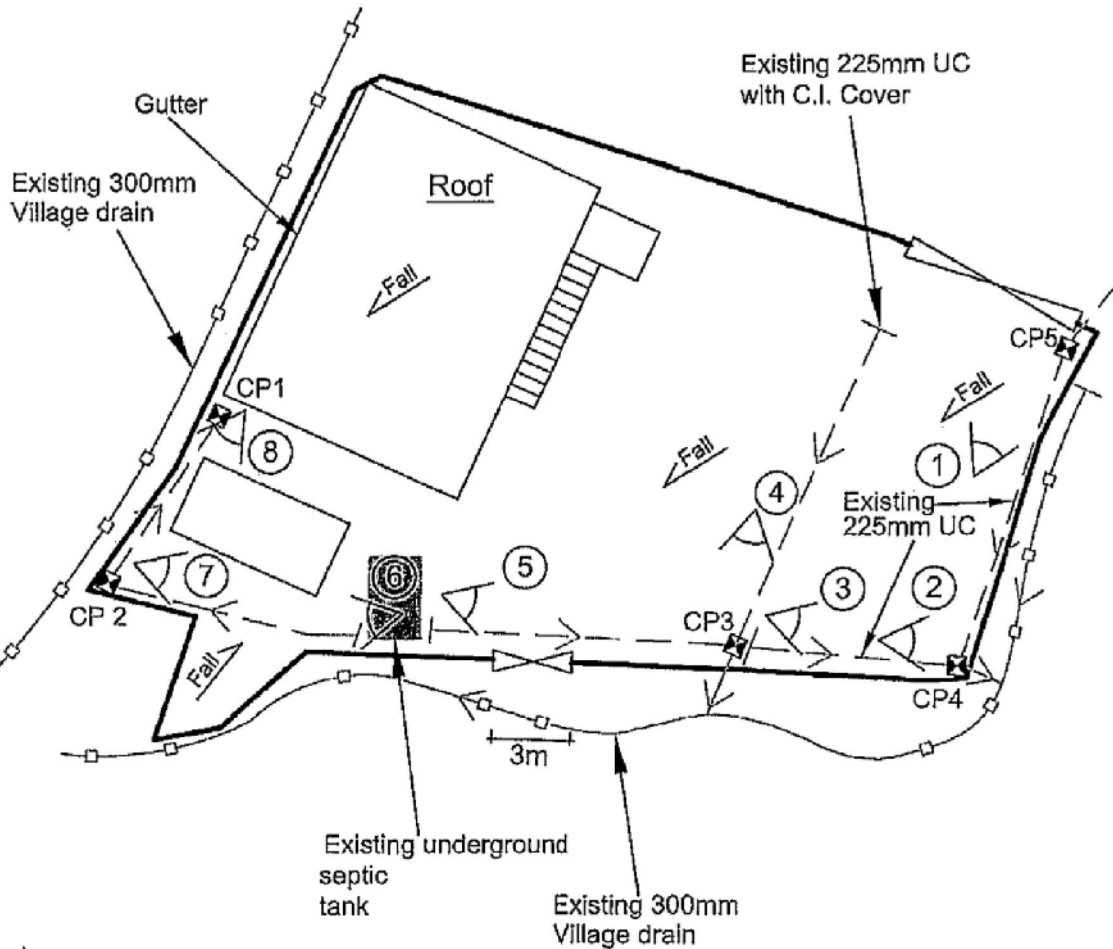

Legend:



Viewpoints of site photos



Existing Catchpit



Existing 225mm U-Channel with C.I. Cover

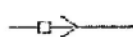

Existing 300mm Village Drain

Catchpit No.	G.L.(mP.D.)	I.L.(mP.D.)
CP 1 (existing)	16.80	16.53
CP 2 (propose)	16.80	16.57
CP 3 (existing)	16.80	16.56
CP 4 (existing)	16.80	16.57
CP 5 (existing)	16.85	16.52

~~1:250~~

Drainage Proposal

Goldrich Planners & Surveyors Ltd.

October 2019

Lots 1211C (Part), 1248 (Part)
and 1249 (Part) in D. D. 130
Fuk Hang Tsuen, Tuen Mun, New Territories

Plan 4.1
(P 16043)

參考編號 REFERENCE No. A/TM-LTYT/396	繪圖 DRAWING A-4
-------------------------------------	-------------------

(摘錄自申請人於5.3.2020呈交的申請書)
(Extract from Applicant's
Submission Dated 5.3.2020)

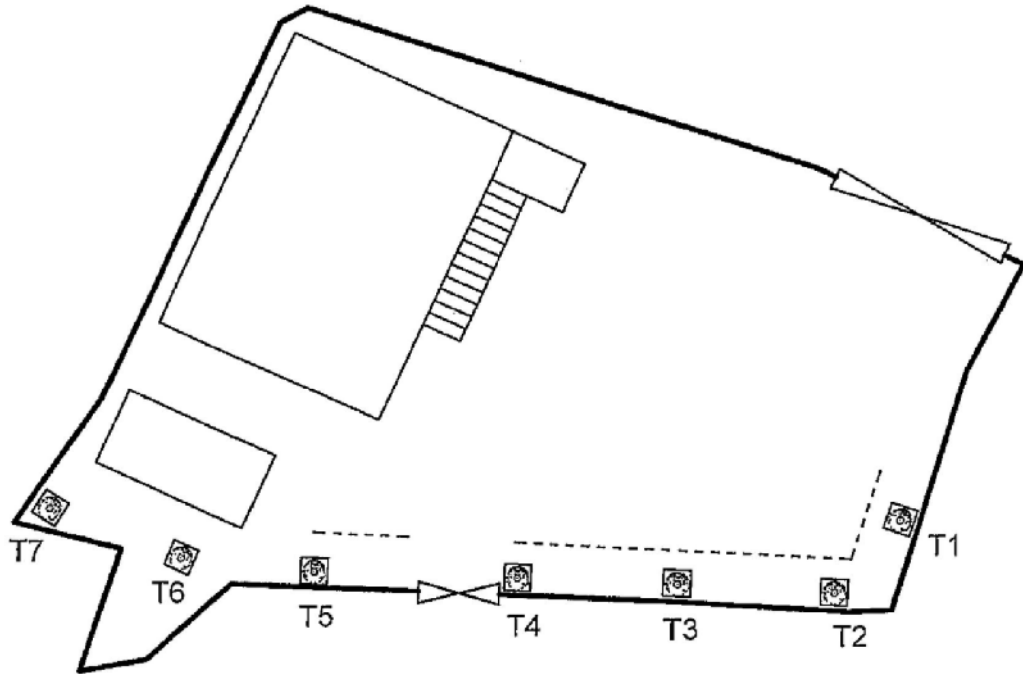

Legend:

----- Kerb (1m away from planting area)

 Open-bottom fixed planter x7
(1m (L) x 1m (W) x 1m (H))

	Spacing (Centre to Centre)	Min. Size (Height)	Quantity
 Proposed Ficus Microcarpa (細葉榕)	4m	2.75m	7

1:250	Tree Preservation and Landscape Proposal Lots 1211C (Part), 1248 (Part) and 1249 (Part) in D. D. 130 Fuk Hang Tsuen, Tuen Mun, New Territories	Goldrich Planners & Surveyors Ltd.
October 2019		Plan 5 (P 16043)

參考編號 REFERENCE No. A/TM-LTYT/396	繪圖 DRAWING A-5
-------------------------------------	-------------------

(摘錄自申請人於5. 3. 2020呈交的申請書)
(Extract from Applicant's
Submission Dated 5.3.2020)

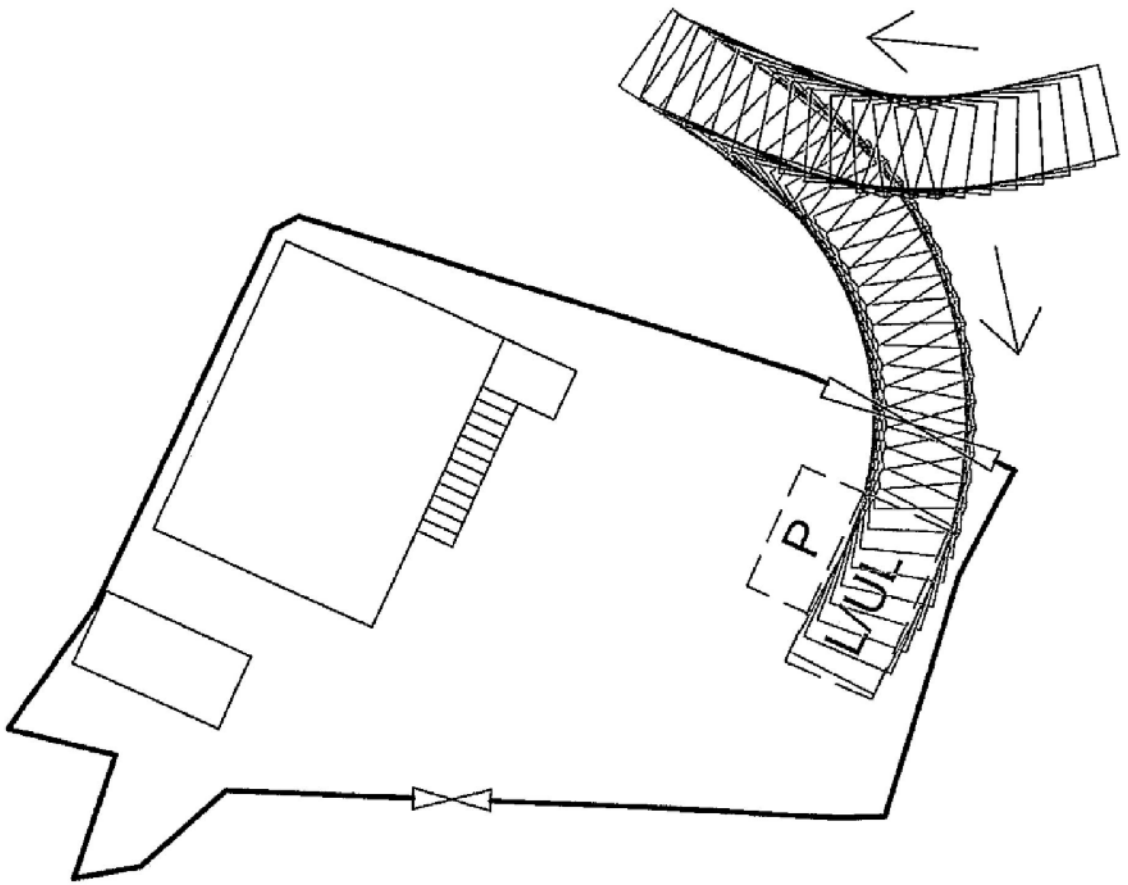

Legend:

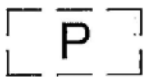

Parking Space for Private Car: 5m x 2.5m

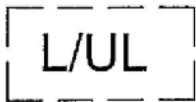

Loading/Unloading area for Light Goods Vehicle: 7m x 3.5m

1:250	Swept Path Analysis	Goldrich Planners & Surveyors Ltd.
October 2019	Lots 1211C (Part), 1248 (Part) and 1249 (Part) in D. D. 130 Fuk Hang Tsuen, Tuen Mun, New Territories	Plan 7 (P 16043)

參考編號 REFERENCE No. A/TM-LTYT/396	繪圖 DRAWING A-6
-------------------------------------	-------------------

(摘錄自申請人於5.3.2020呈交的申請書)
(Extract from Applicant's
Submission Dated 5.3.2020)

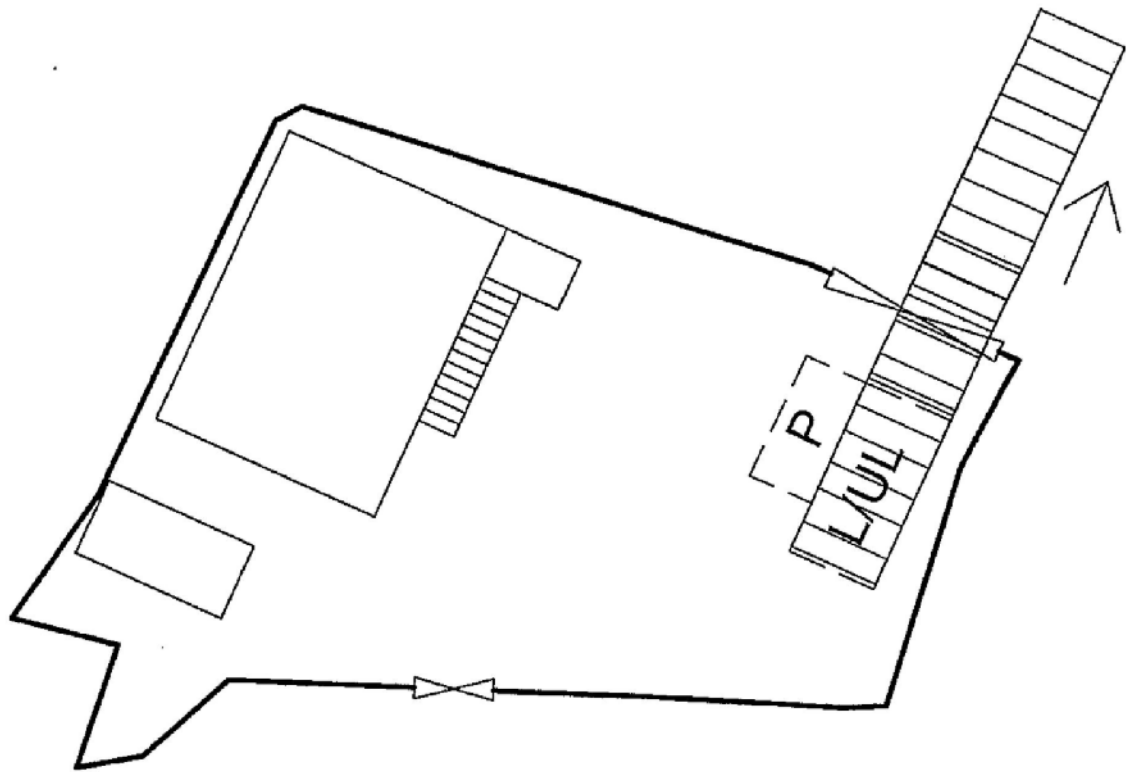

Legend:

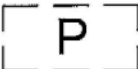
 Parking Space for Private Car: 5m x 2.5m

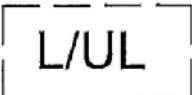
 Loading/Unloading area for Light Goods Vehicle: 7m x 3.5m

1:250	Swept Path Analysis	Goldrich Planners & Surveyors Ltd.
October 2019	Lots 1211C (Part), 1248 (Part) and 1249 (Part) in D. D. 130 Fuk Hang Tsuen, Tuen Mun, New Territories	Plan 8 (P 16043)

參考編號 REFERENCE No. A/TM-LTYT/396	繪圖 DRAWING A-7
-------------------------------------	-------------------

(摘錄自申請人於5.3.2020呈交的申請書)
(Extract from Applicant's
Submission Dated 5.3.2020)

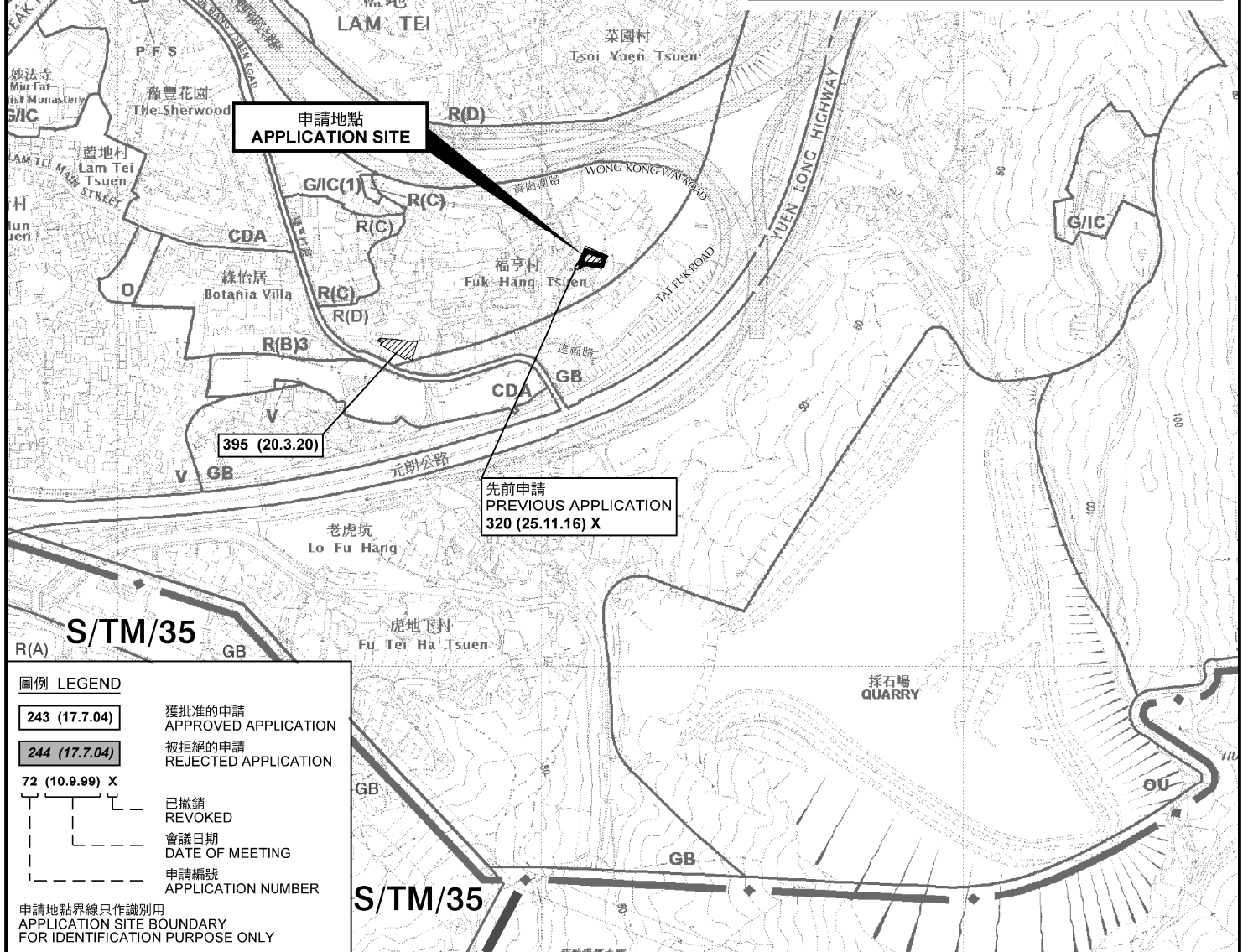
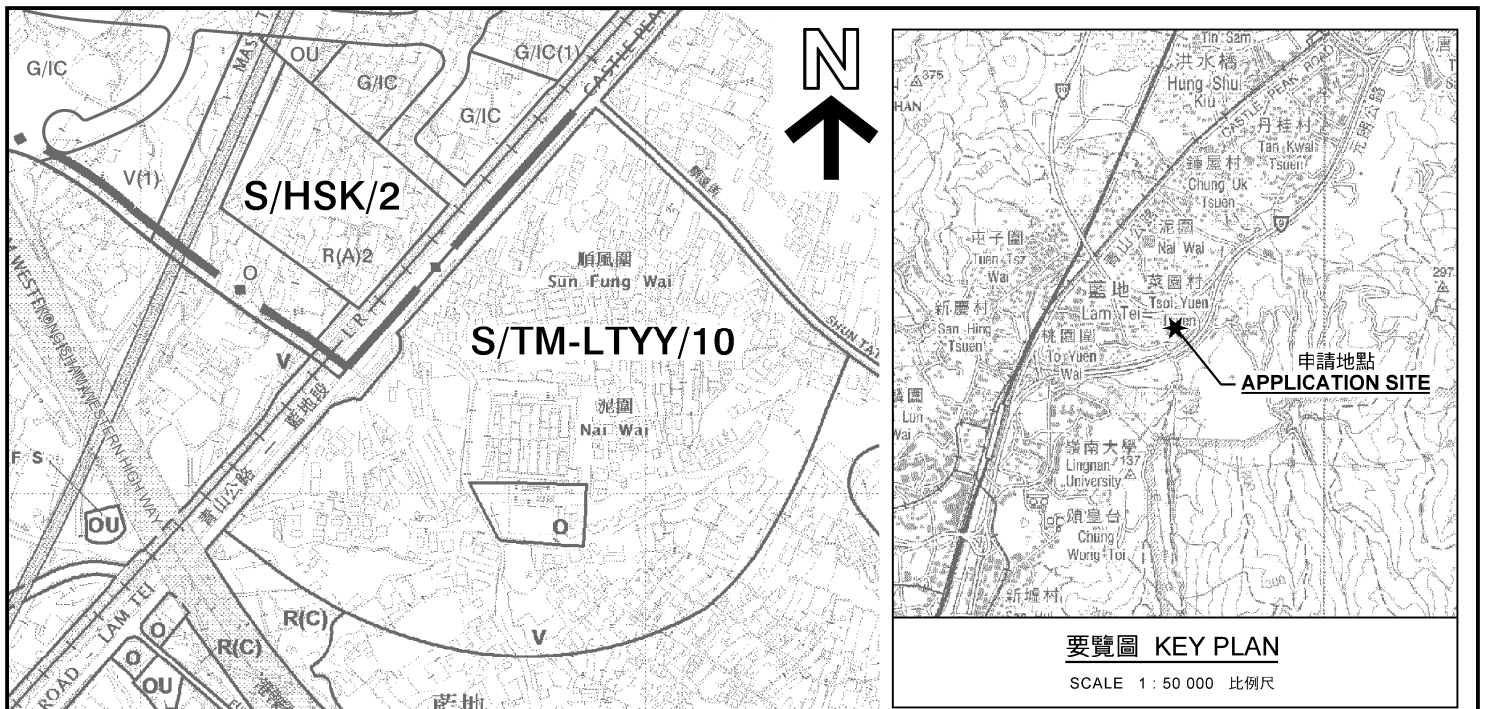

本摘要圖於2020年4月14日擬備，
所根據的資料為於2018年10月16日
核准的分區計劃大綱圖編號 S/TM-LTTY/10
EXTRACT PLAN PREPARED ON 14.4.2020
BASED ON OUTLINE ZONING PLAN No.
S/TM-LTTY/10 APPROVED ON 16.10.2018

位置圖 LOCATION PLAN

臨時商店及服務行業連附屬儲物室及辦公室(為期3年)
新界屯門福亨村丈量約份第130約地段第1211號C分段(部分)、
第1248號(部分)及第1249號(部分)
TEMPORARY SHOP AND SERVICES WITH ANCILLARY STORAGE AREA
AND OFFICE FOR A PERIOD OF 3 YEARS
LOTS 1211 S.C (PART), 1248 (PART) AND 1249 (PART) IN D.D 130,
FUK HANG TSUEN, TUEN MUN, NEW TERRITORIES

SCALE 1 : 7 500 比例尺

米 METRES 100 0 100 200 300 米 METRES

規劃署
PLANNING DEPARTMENT



參考編號
REFERENCE No. **A/TM-LTTY/396**

圖 PLAN **A-1**

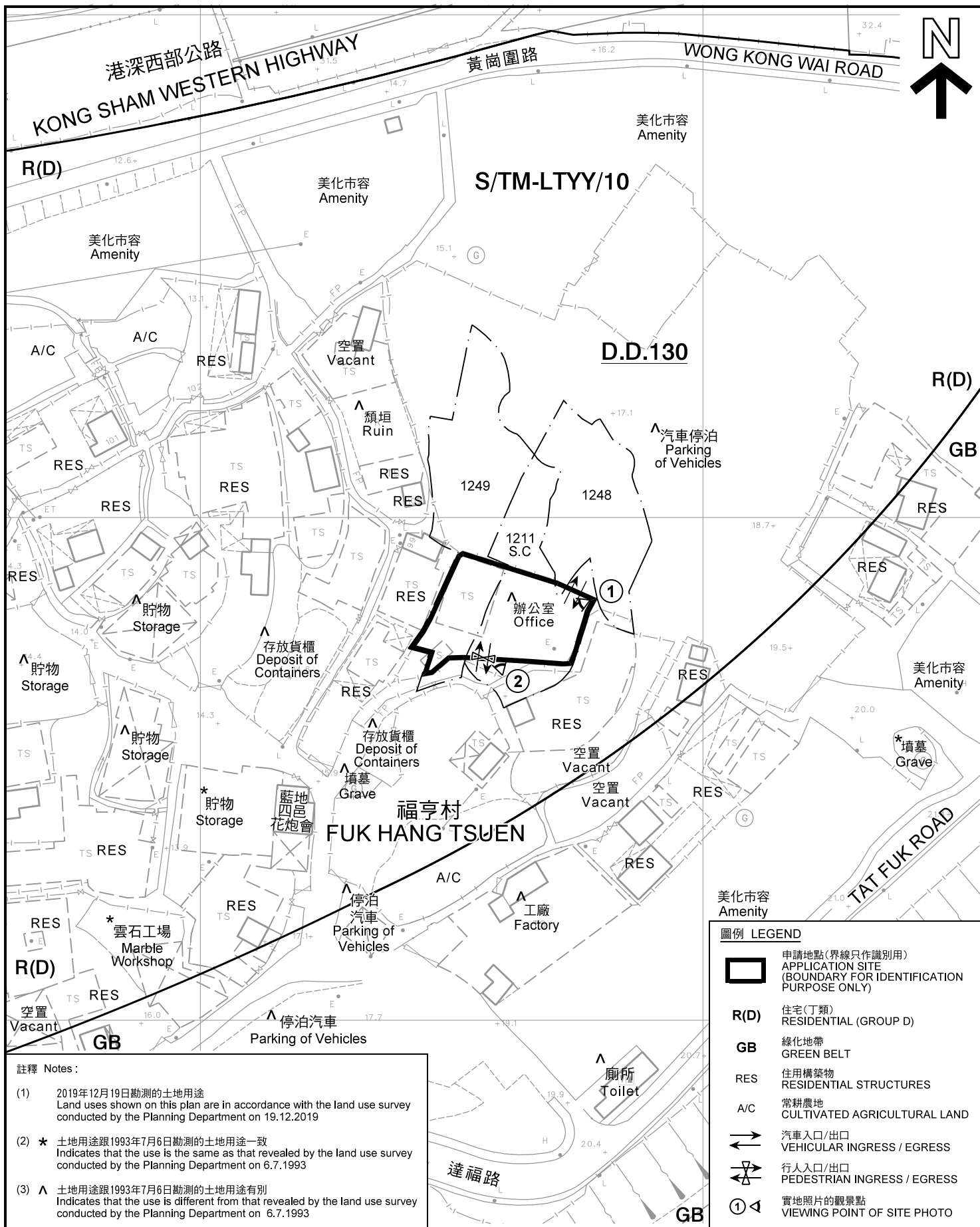

註釋 Notes:

- (1) 2019年12月19日勘測的土地用途
Land uses shown on this plan are in accordance with the land use survey conducted by the Planning Department on 19.12.2019
- (2) * 土地用途跟1993年7月6日勘測的土地用途一致
Indicates that the use is the same as that revealed by the land use survey conducted by the Planning Department on 6.7.1993
- (3) ^ 土地用途跟1993年7月6日勘測的土地用途有別
Indicates that the use is different from that revealed by the land use survey conducted by the Planning Department on 6.7.1993

圖例 LEGEND

- 申請地點(界線只作識別用)
APPLICATION SITE
(BOUNDARY FOR IDENTIFICATION
PURPOSE ONLY)
- R(D)** 住宅(丁類)
RESIDENTIAL (GROUP D)
- GB** 綠化地帶
GREEN BELT
- RES** 住用構築物
RESIDENTIAL STRUCTURES
- A/C** 常耕農地
CULTIVATED AGRICULTURAL LAND
- 汽車入口/出口
VEHICULAR INGRESS / EGRESS
- 行人入口/出口
PEDESTRIAN INGRESS / EGRESS
- 實地照片的觀景點
VIEWING POINT OF SITE PHOTO

平面圖 SITE PLAN

臨時商店及服務行業連附屬儲物室及辦公室(為期3年)
新界屯門福亨村丈量約份第130約地段第1211號C分段(部分)、
第1248號(部分)及第1249號(部分)
TEMPORARY SHOP AND SERVICES WITH ANCILLARY STORAGE AREA
AND OFFICE FOR A PERIOD OF 3 YEARS
LOTS 1211 S.C (PART), 1248 (PART) AND 1249 (PART) IN D.D 130,
FUK HANG TSUEN, TUEN MUN, NEW TERRITORIES

SCALE 1 : 1 000 比例尺

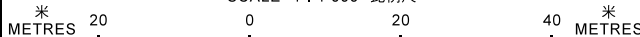

本摘要圖於2020年4月2日擬備，所根據的資料為測量圖編號 6-NW-22A
EXTRACT PLAN PREPARED ON 2.4.2020
BASED ON SURVEY SHEET No.
6-NW-22A

**規劃署
PLANNING
DEPARTMENT**



參考編號
REFERENCE No.
A/TM-LTYYY/396

**圖 PLAN
A-2**



菜園村
TSOI YUEN TSUEN

港深西部公路

港深西部公路

寶崗圍路

WONG KOW WAI ROAD

通往申請地點之行車通道
VEHICULAR ACCESS TO
THE APPLICATION SITE

福亨村
FUK HANG TSUEN

TAT FUK ROAD

KONG SHAM WESTERN HIGHWAY

元朗公路

KONG SHAM WESTERN HIGHWAY

YUEN LONG HIGHWAY

港深西部公路

圖例 LEGEND



申請地點(界線只作識別用)
APPLICATION SITE
(BOUNDARY FOR IDENTIFICATION
PURPOSE ONLY)

本摘要圖於2020年4月2日擬備，所根據
的資料為地政總署於2019年9月29日拍得
的航攝照片編號 E067414C
EXTRACT PLAN PREPARED ON 2.4.2020
BASED ON AERIAL PHOTO No.
E067414C TAKEN ON 29.9.2019
BY LANDS DEPARTMENT

航攝照片 AERIAL PHOTO

臨時商店及服務行業連附屬儲物室及辦公室(為期3年)
新界屯門福亨村丈量約份第130約地段第1211號C分段(部分)、
第1248號(部分)及第1249號(部分)
TEMPORARY SHOP AND SERVICES WITH ANCILLARY STORAGE AREA
AND OFFICE FOR A PERIOD OF 3 YEARS
LOTS 1211 S.C (PART), 1248 (PART) AND 1249 (PART) IN D.D 130,
FUK HANG TSUEN, TUEN MUN, NEW TERRITORIES

規劃署
PLANNING
DEPARTMENT



參考編號
REFERENCE No.
A/TM-LTTY/396

圖 PLAN
A-3



申請地點界線只作識別用 APPLICATION SITE BOUNDARY FOR IDENTIFICATION PURPOSE ONLY

實地照片 SITE PHOTO

本圖於2020年4月2日擬備，所根據的資料為攝於2019年12月13日的實地照片
 PLAN PREPARED ON 2.4.2020
 BASED ON SITE PHOTOS
 TAKEN ON 13.12.2019

臨時商店及服務行業連附屬儲物室及辦公室(為期3年)
 新界屯門福亨村丈量約份第130約地段第1211號C分段(部分)、
 第1248號(部分)及第1249號(部分)
 TEMPORARY SHOP AND SERVICES WITH ANCILLARY STORAGE AREA
 AND OFFICE FOR A PERIOD OF 3 YEARS
 LOTS 1211 S.C (PART), 1248 (PART) AND 1249 (PART) IN D.D 130,
 FUK HANG TSUEN, TUEN MUN, NEW TERRITORIES

規劃署
**PLANNING
 DEPARTMENT**



參考編號
 REFERENCE No.
A/TM-LTTY/396

圖 PLAN
A-4