

<p>Project 項目名稱: Proposed Temporary Warehouse for Storage of Construction Materials for a Period of 3 Years at Lots 1679 (Part), 1684 (Part) 1685 (Part) & 1690 (Part) in D.D. 129 & Adjoining Government Land, Lau Fau Shan, Yuen Long, N.T.</p>	<p>Drawing Title 圖目: Location Plan</p> <p>Drawing No. 圖號: Figure 2</p>	<p>Remarks 備註: ●●● Vehicular access leading from Deep Bay Road</p> <p>Scale 比例: 1:7500</p>
---	--	--

參考編號 REFERENCE No. A/YL-LFS/368	繪圖 DRAWING A-1
---	--------------------------

(摘錄自申請人於13. 7. 2020呈交的申請書)
 (Extract from Applicant's Submission Dated 13.7.2020)

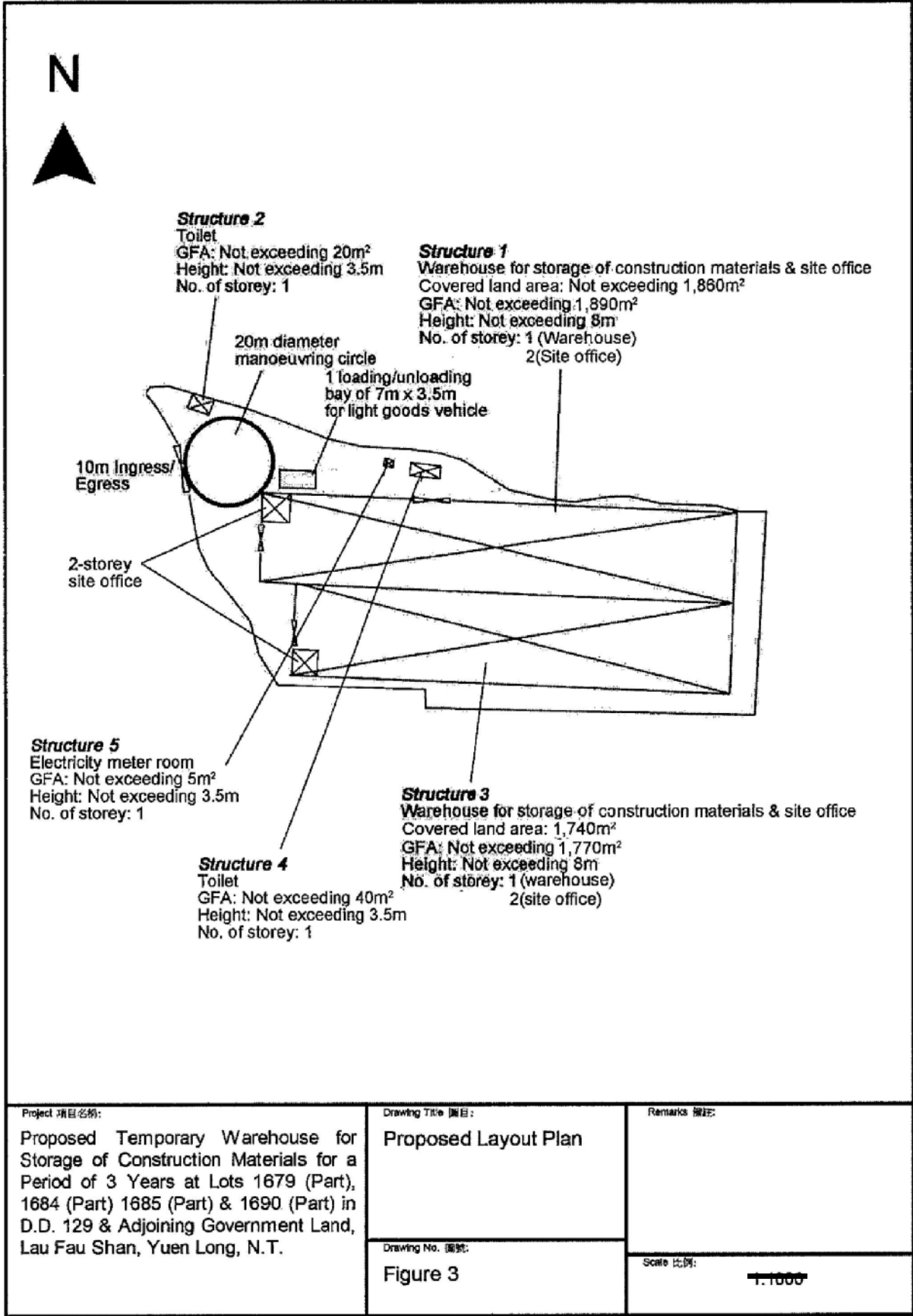

Project 項目名稱: Proposed Temporary Warehouse for Storage of Construction Materials for a Period of 3 Years at Lots 1679 (Part), 1684 (Part) 1685 (Part) & 1690 (Part) in D.D. 129 & Adjoining Government Land, Lau Fau Shan, Yuen Long, N.T.	Drawing Title 圖目: Proposed Layout Plan	Remarks 備註:
	Drawing No. 圖號: Figure 3	Scale 比例: 1:1000

參考編號 REFERENCE No. A/YL-LFS/368	繪圖 DRAWING A-2
---	--------------------------

(摘錄自申請人於13. 7. 2020呈交的申請書)
 (Extract from Applicant's Submission Dated 13.7.2020)



Proposed Tree	Approximate Height	Spacing
○ Proposed <i>Melaleuca leucadendron</i>	2.75m	4m
⊗ Existing tree mainly <i>Melaleuca leucadendron</i>	5m	NA

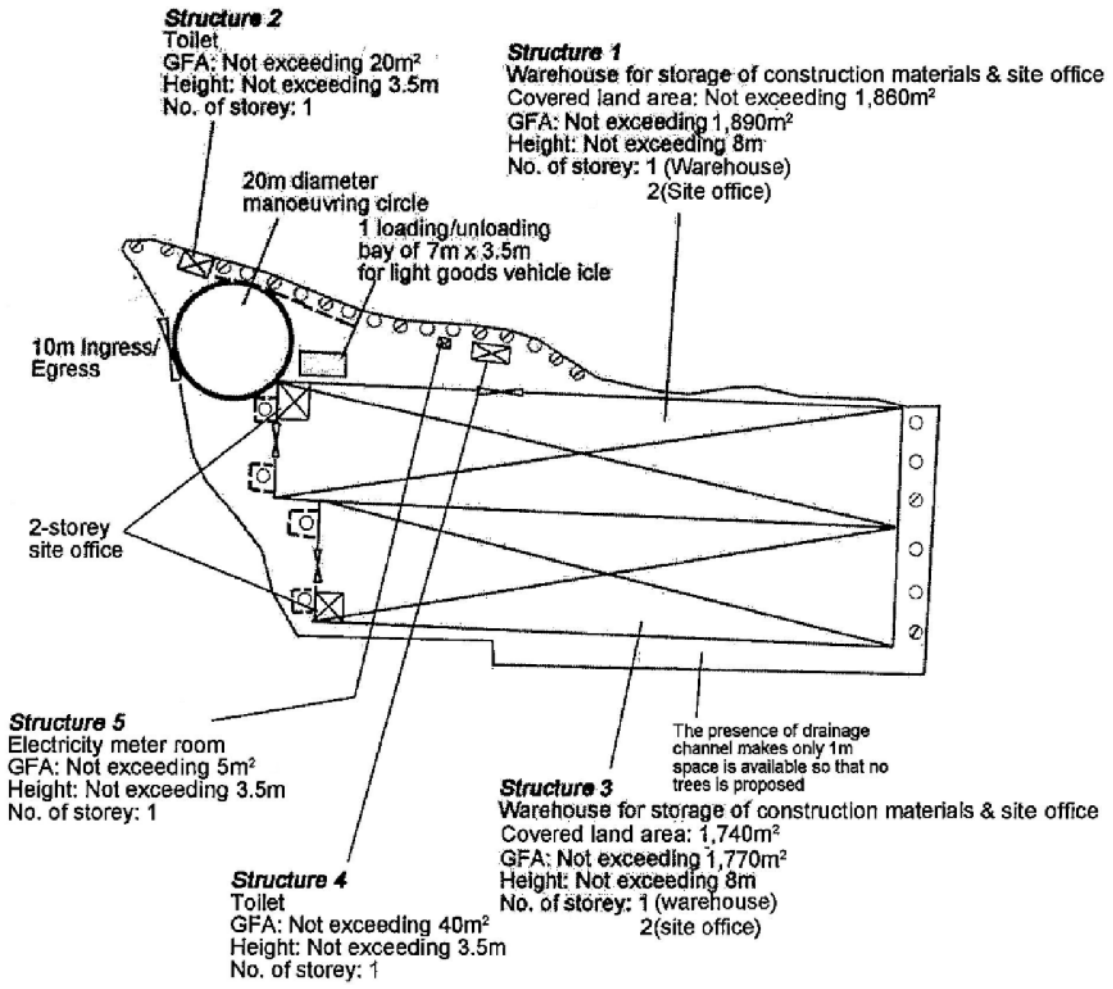

Project 項目名稱: Proposed Temporary Warehouse for Storage of Construction Materials for a Period of 3 Years at Lots 1679 (Part), 1684 (Part) 1685 (Part) & 1690 (Part) in D.D. 129 & Adjoining Government Land, Lau Fau Shan, Yuen Long, N.T.	Drawing Title 圖目: Proposed Landscape & Tree Preservation Plan	Remarks 備註: -- Kerb at a minimum 1m distance away from the proposed trees
	Drawing No. 圖號: Figure 4	Scale 比例: 1:1000

參考編號 REFERENCE No. A/YL-LFS/368	繪圖 DRAWING A-3
------------------------------------	-------------------

(摘錄自申請人於13. 7. 2020呈交的申請書)
 (Extract from Applicant's Submission Dated 13.7.2020)

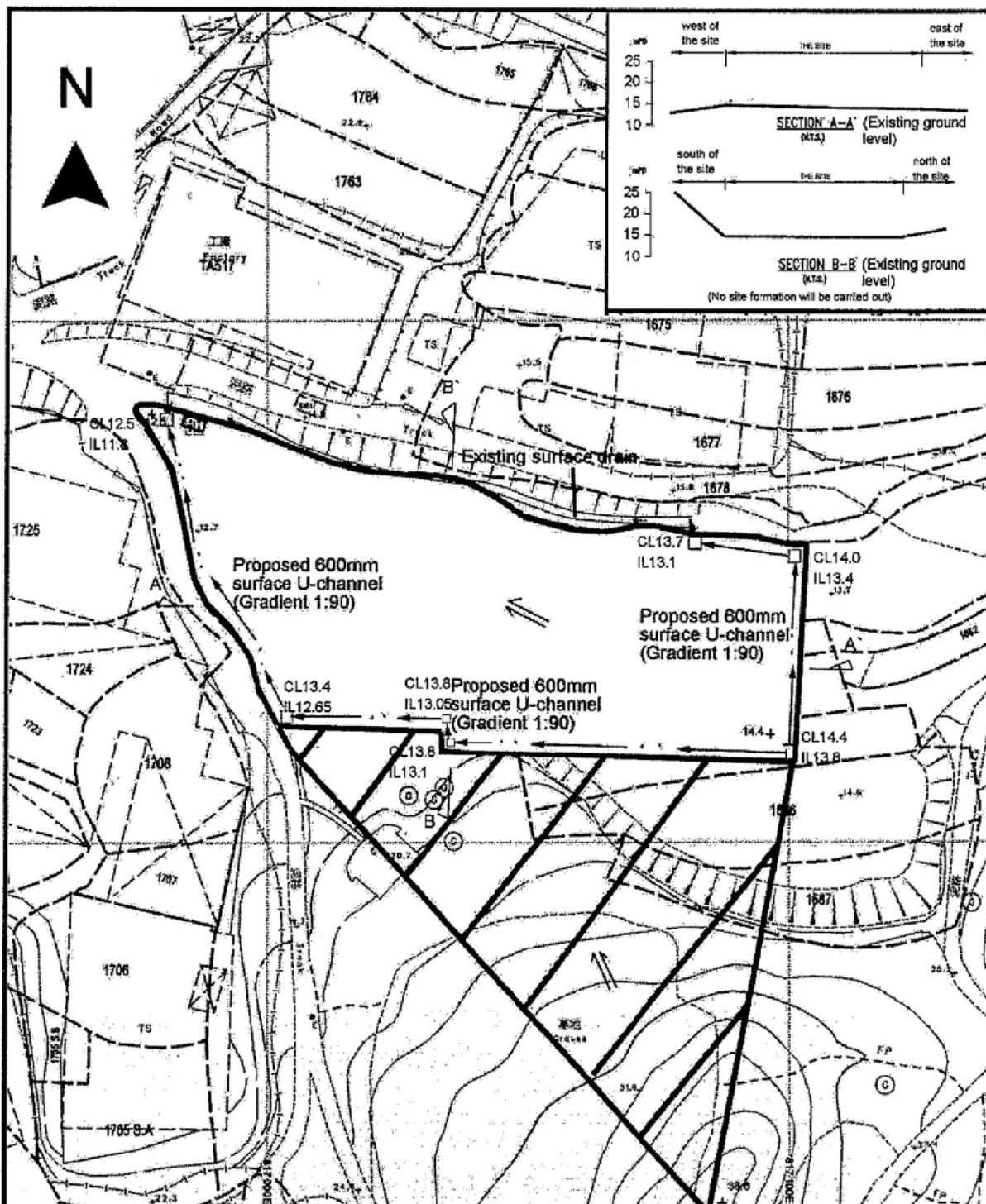

Project 項目名稱:
Proposed Temporary Warehouse for Storage of Construction Materials for a Period of 3 Years at Lots 1679 (Part), 1684 (Part) 1685 (Part) & 1690 (Part) in D.D. 129 & Adjoining Government Land, Lau Fau Shan, Yuen Long, N.T.

Drawing Title 圖目:
Proposed Drainage Plan

Remarks 備註:
 Proposed catchpit
 + 14.4 Level (mPD)
 Flow of Surface Runoff
 External catchment

Drawing No. 圖號:
Figure 5

Scale 比例:
1:1000

參考編號 REFERENCE No. A/YL-LFS/368	繪圖 DRAWING A-4
---	--------------------------

(摘錄自申請人於13. 7. 2020呈交的申請書)
 (Extract from Applicant's Submission Dated 13.7.2020)

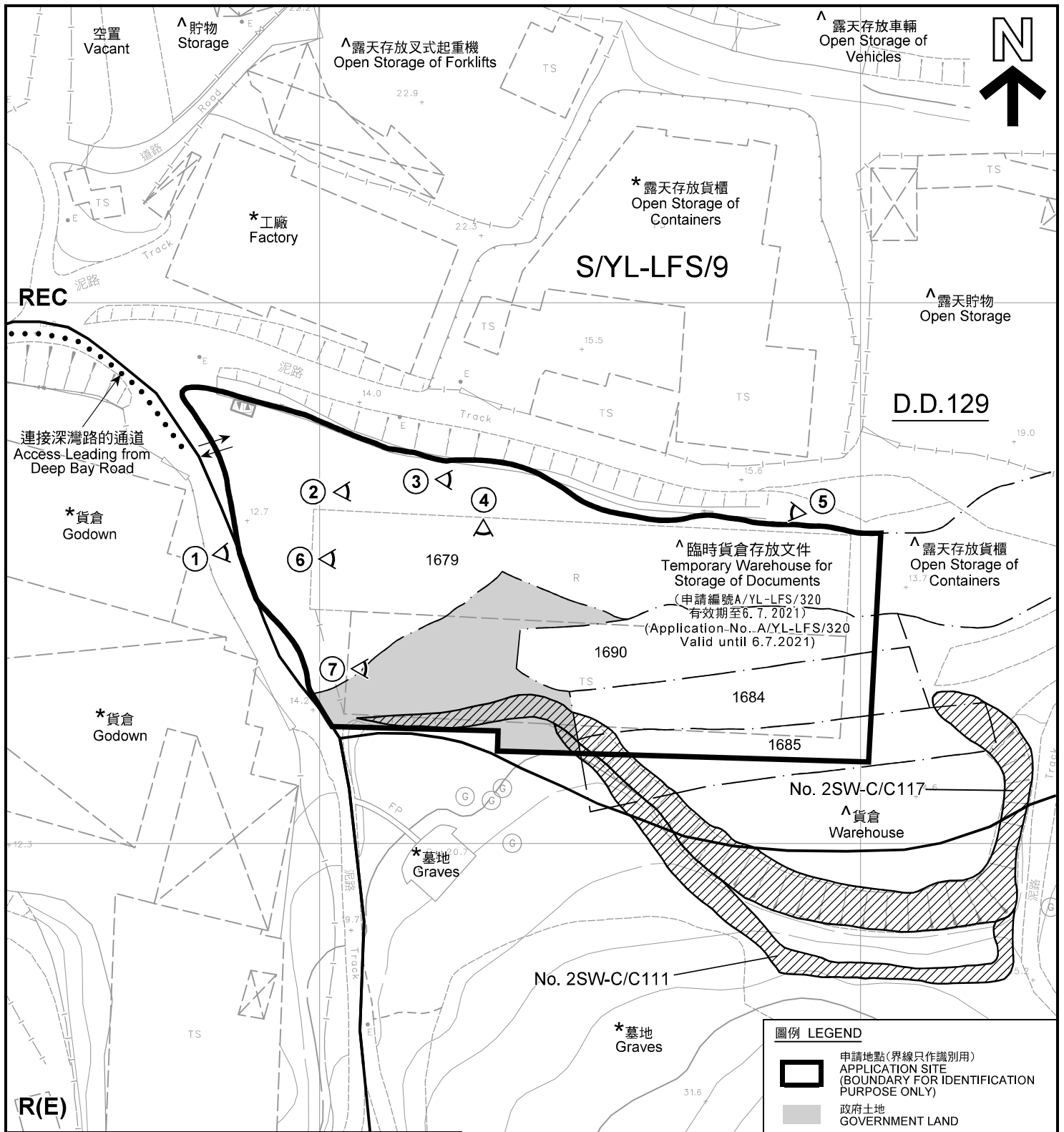

註釋 Notes:

- (1) 2020年8月27日勘測的土地用途
Land uses shown on this plan are in accordance with the land use survey conducted by the Planning Department on 27.8.2020
- (2) * 土地用途跟1992年3月勘測的土地用途一致
Indicates that the use is the same as that revealed by the land use survey conducted by the Planning Department on Mar 1992
- (3) ^ 土地用途跟1992年3月勘測的土地用途有別
Indicates that the use is different from that revealed by the land use survey conducted by the Planning Department on Mar 1992

圖例 LEGEND

- 申請地點(界線只作識別用)
APPLICATION SITE
(BOUNDARY FOR IDENTIFICATION PURPOSE ONLY)
- 政府土地
GOVERNMENT LAND
- 斜坡及擋土牆
SLOPE FEATURES
- R(E)** 住宅(戊類)
RESIDENTIAL (GROUP E)
- REC** 康樂
RECREATION
- GB** 綠化地帶
GREEN BELT
- 實地照片的觀景點
VIEWING POINT OF SITE PHOTO
- 入口/出口
INGRESS / EGRESS

平面圖 SITE PLAN

臨時貨倉存放建築材料(為期3年)
新界元朗流浮山丈量約份第129約地段第1679號(部分)、第1684號(部分)、
第1685號(部分)及第1690號(部分)和毗連政府土地
TEMPORARY WAREHOUSE FOR STORAGE OF
CONSTRUCTION MATERIALS FOR A PERIOD OF 3 YEARS
LOTS 1679 (PART), 1684 (PART), 1685 (PART) AND 1690 (PART)
IN D.D.129 AND ADJOINING GOVERNMENT LAND,
LAU FAU SHAN, YUEN LONG, NEW TERRITORIES
SCALE 1 : 1 000 比例尺

米 METRES 20 0 20 40 米 METRES

規劃署
PLANNING
DEPARTMENT



參考編號
REFERENCE No.
A/YL-LFS/368

圖 PLAN
A-2

本摘要圖於2020年8月28日擬備, 所根據的資料為測量圖編號 2-SW-22A 及 2-SW-22C
EXTRACT PLAN PREPARED ON 28.8.2020
BASED ON SURVEY SHEETS No. 2-SW-22A & 2-SW-22C



連接深灣路的通道
Access Leading from
Deep Bay Road

圖例 LEGEND

 申請地點(界線只作識別用)
APPLICATION SITE
(BOUNDARY FOR IDENTIFICATION
PURPOSE ONLY)

本摘要圖於2020年8月13日擬備，所根據的資料為地政總署於2019年10月2日拍得的航攝照片編號 E070097C
EXTRACT PLAN PREPARED ON 13.8.2020
BASED ON AERIAL PHOTO No.
E070097C TAKEN ON 2.10.2019
BY LANDS DEPARTMENT

航攝照片 AERIAL PHOTO

臨時貨倉存放建築材料(為期3年)
新界元朗流浮山丈量約份第129約地段第1679號(部分)、第1684號(部分)、
第1685號(部分)及第1690號(部分)和毗連政府土地
TEMPORARY WAREHOUSE FOR STORAGE OF
CONSTRUCTION MATERIALS FOR A PERIOD OF 3 YEARS
LOTS 1679 (PART), 1684 (PART), 1685 (PART) AND 1690 (PART)
IN D.D.129 AND ADJOINING GOVERNMENT LAND,
LAU FAU SHAN, YUEN LONG, NEW TERRITORIES

規劃署
PLANNING
DEPARTMENT



參考編號
REFERENCE No.
A/YL-LFS/368

圖 PLAN
A-3



申請地點界線只作識別用 APPLICATION SITE BOUNDARY FOR IDENTIFICATION PURPOSE ONLY

本圖於2020年8月28日擬備，所根據的資料為攝於2020年8月27日的實地照片
PLAN PREPARED ON 28.8.2020
BASED ON SITE PHOTOS
TAKEN ON 27.8.2020

實地照片 SITE PHOTOS

臨時貨倉存放建築材料(為期3年)
新界元朗流浮山丈量約份第129約地段第1679號(部分)、第1684號(部分)、
第1685號(部分)及第1690號(部分)和毗連政府土地
TEMPORARY WAREHOUSE FOR STORAGE OF
CONSTRUCTION MATERIALS FOR A PERIOD OF 3 YEARS
LOTS 1679 (PART), 1684 (PART), 1685 (PART) AND 1690 (PART)
IN D.D. 129 AND ADJOINING GOVERNMENT LAND,
LAU FAU SHAN, YUEN LONG, NEW TERRITORIES

規劃署
PLANNING
DEPARTMENT



參考編號
REFERENCE No.
A/YL-LFS/368

圖 PLAN
A-4a



申請地點界線只作識別用 APPLICATION SITE BOUNDARY FOR IDENTIFICATION PURPOSE ONLY

實地照片 SITE PHOTOS

臨時貨倉存放建築材料(為期3年)
 新界元朗流浮山丈量約份第129約地段第1679號(部分)、第1684號(部分)、
 第1685號(部分)及第1690號(部分)和毗連政府土地
 TEMPORARY WAREHOUSE FOR STORAGE OF
 CONSTRUCTION MATERIALS FOR A PERIOD OF 3 YEARS
 LOTS 1679 (PART), 1684 (PART), 1685 (PART) AND 1690 (PART)
 IN D.D.129 AND ADJOINING GOVERNMENT LAND,
 LAU FAU SHAN, YUEN LONG, NEW TERRITORIES

規劃署
**PLANNING
 DEPARTMENT**



參考編號
 REFERENCE No.
A/YL-LFS/368

圖 PLAN
A-4b

本圖於2020年8月28日擬備，所根據的資料為攝於2020年8月27日的實地照片
 PLAN PREPARED ON 28.8.2020
 BASED ON SITE PHOTOS
 TAKEN ON 27.8.2020