

Extracted from Approved Tai Tong Outline Zoning Plan (OZP) No. SYL-TT/16

Legend

--- Access Road

Not to Scale	Location Plan Lots 1397 (Part), 1398 A&B (Part), 1404 (Part), 1405 (Part) and 1410 in D. D.118 Tai Tong, Yuen Long, New Territories	Goldrich Planners & Surveyors Ltd.
December 2017		Plan 1 (P17136)

(摘錄自申請人於 8.1.2018 呈交的申請書)
(Extract from Applicant's
Submission of 8.1.2018)

參考編號 REFERENCE No. A/YL-TT/424	繪圖 DRAWING A-1
---	---------------------------------

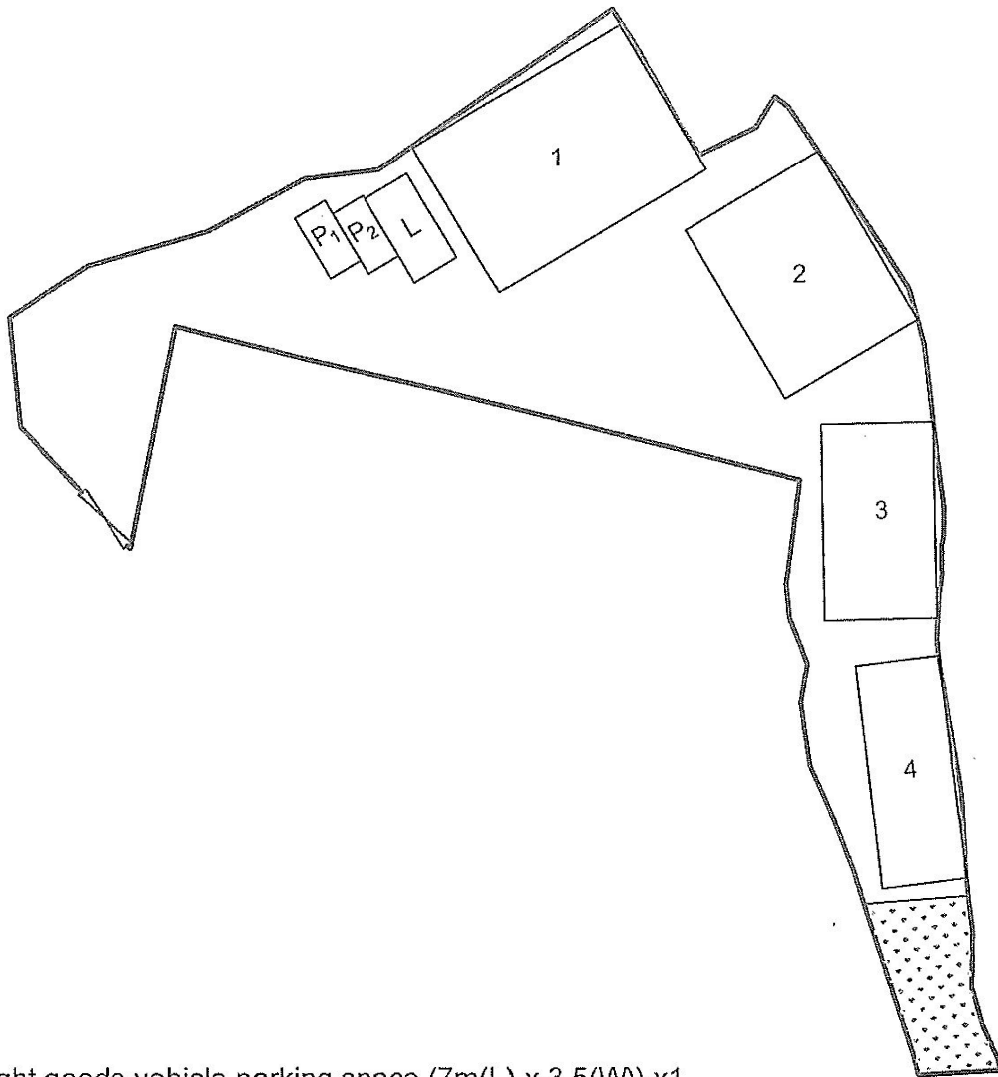

Legend

- L Light goods vehicle parking space (7m(L) x 3.5(W)) x1
- P Private car parking space (5m(L) x 2.5(W)) x2
- 5m Vehicular ingress/egress
- Grassland

No	Use	Covered Area	Floor Area	No of storey	Height
1	Reception & Multi-Function Room	204m ²	204m ²	1	4m
2	Kennel	154m ²	154m ²	1	4m
3	Staff Room & Storeroom	112m ²	112m ²	1	4m
4	Kennel	96m ²	96m ²	1	4m
Total :		566m ²	566m ²		

1:500	Site Plan Lots 1397 (Part), 1398 A&B (Part), 1404 (Part), 1405 (Part) and 1410 in D. D.118 Tai Tong, Yuen Long, New Territories	Goldrich Planners & Surveyors Ltd.
December 2017		Plan 3 (P17136)

(摘錄自申請人於 8. 1. 2018 呈交的申請書)
 (Extract from Applicant's
 Submission of 8.1.2018)

參考編號 REFERENCE No. A/YL-TT/424	繪圖 DRAWING A-2
---	--------------------------

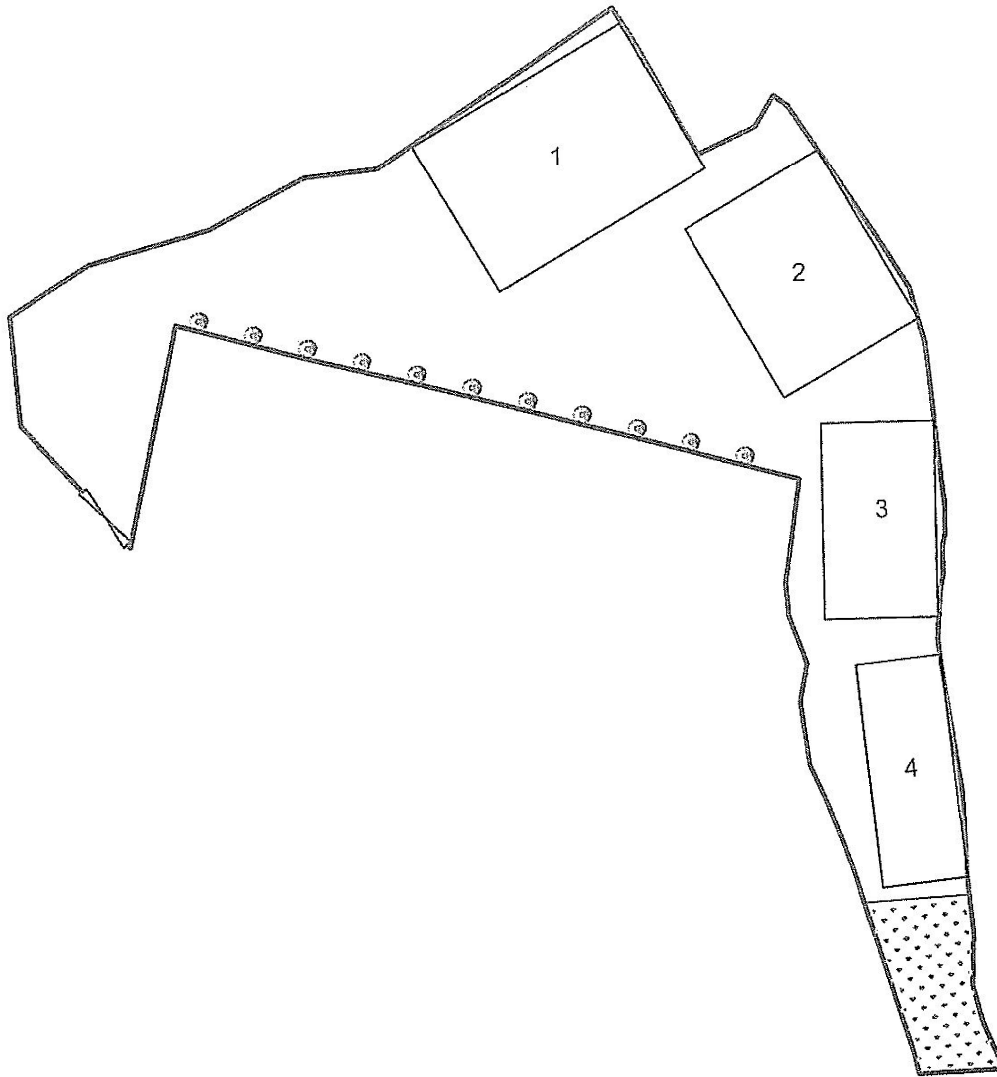

Legend



5m Vehicular ingress/egress



Grassland

Proposed Tree Species	Spacing (Center to Center)	Min. Size (Height)	Quantity
⊗ Lagerstroemia speciosa (大花紫薇)	4m	2.75m	11



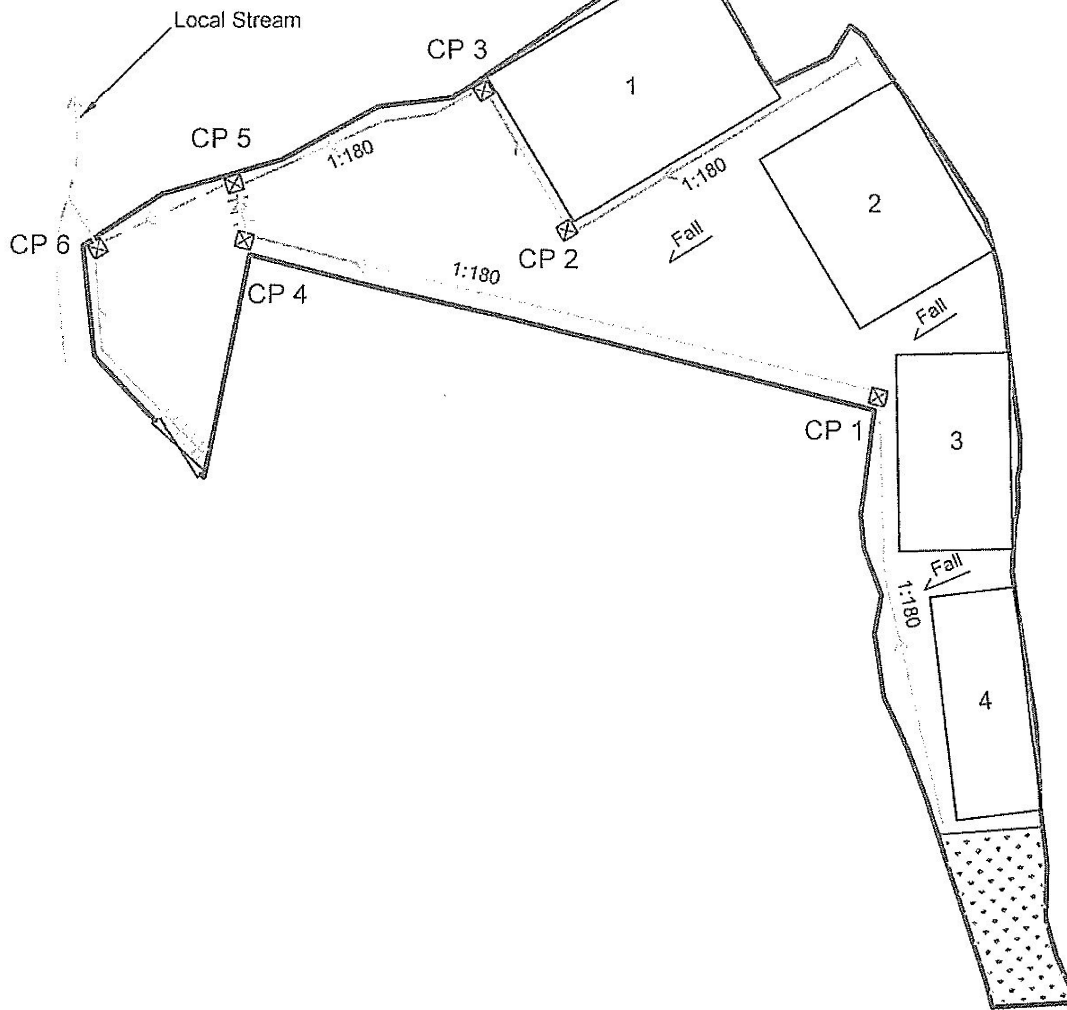
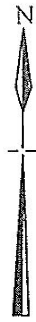

±: 500	Landscape Proposal	Goldrich Planners & Surveyors Ltd.
December 2017	Lots 1397 (Part), 1398 A&B (Part), 1404 (Part), 1405 (Part) and 1410 in D. D.118 Tai Tong, Yuen Long, New Territories	Plan 4 (P17136)

(摘錄自申請人於 8. 1. 2018 呈交的申請書)
(Extract from Applicant's
Submission of 8.1.2018)

參考編號 REFERENCE No. AYL-TT/424	繪圖 DRAWING A-3
-------------------------------------	-------------------

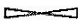

Legend

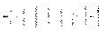
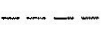
-  5m Vehicular ingress/egress
-  Grassland
-  Proposed Catchpit
-  Proposed 225mm UC
-  Proposed 225mm UC with C.I. cover
-  Proposed 225mm PVC pipe

Catchpit	G.L. (mPD)	I.L. (mPD)
1	22.40	21.99
2	22.40	22.04
3	22.40	21.99
4	22.00	21.74
5	22.00	21.70
6	18.50	18.30

1:500	Drainage Proposal	Goldrich Planners & Surveyors Ltd.
December 2017	Lots 1397 (Part), 1398 A&B (Part), 1404 (Part), 1405 (Part) and 1410 in D. D.118 Tai Tong, Yuen Long, New Territories	Plan 5 (P17136)

(摘錄自申請人於 8.1.2018 呈交的申請書)
(Extract from Applicant's
Submission of 8.1.2018)

參考編號 REFERENCE No. A/YL-TT/424	繪圖 DRAWING A-4
---	--------------------------

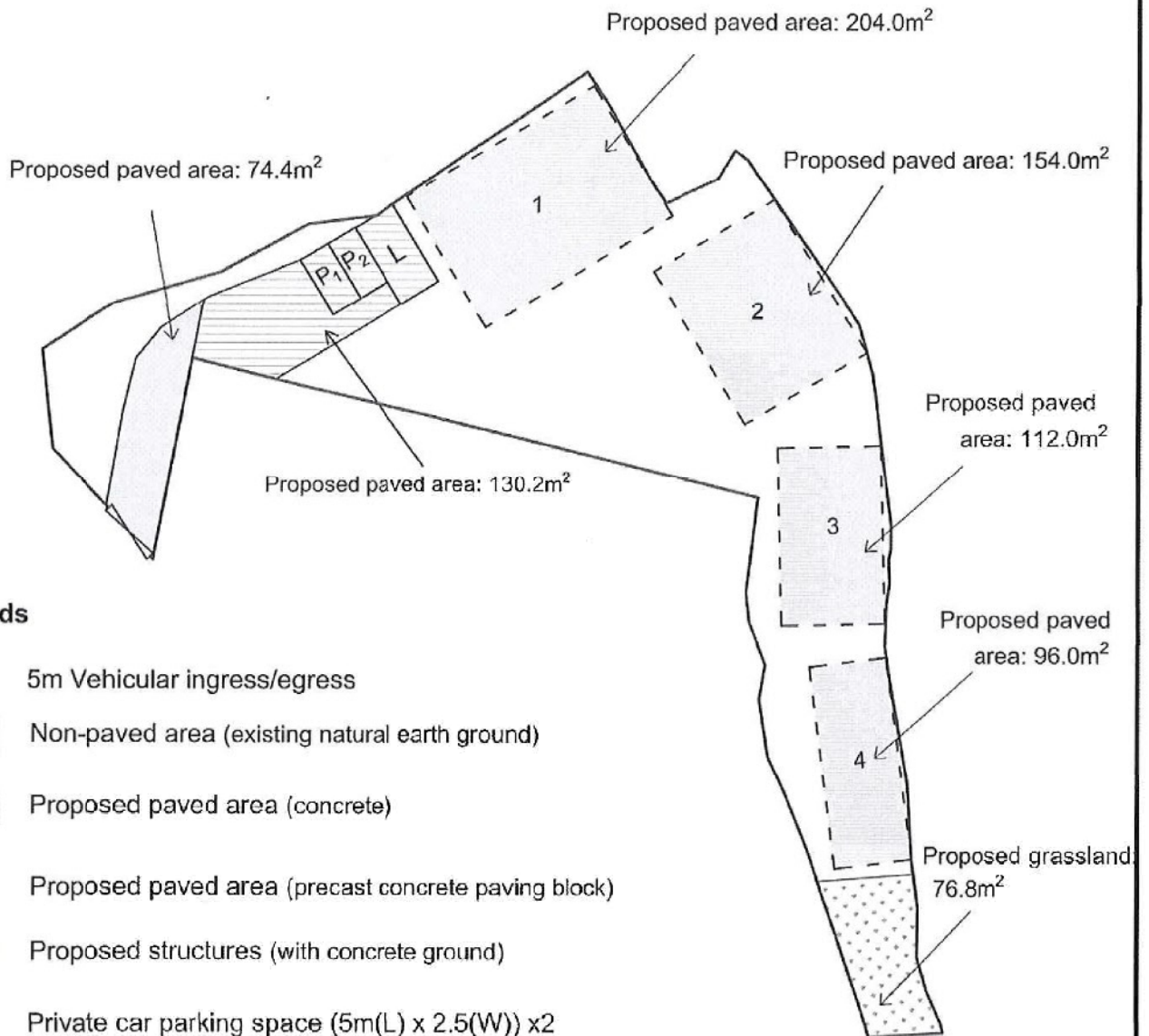

Legends

- 5m Vehicular ingress/egress
- Non-paved area (existing natural earth ground)
- Proposed paved area (concrete)
- Proposed paved area (precast concrete paving block)
- Proposed structures (with concrete ground)
- Private car parking space (5m(L) x 2.5(W)) x2
- Light goods vehicle parking space (7m(L) x 3.5(W)) x1
- Proposed Grassland

	Proposed Materials	Area (m ²)	Ratio
Paved Area	Concrete (for structures)	566.0	0.49
	Concrete (for driveways)	74.4	
	Precast concrete paving block	130.2	
Non-paved Area	Existing natural earth ground	724	0.51
	Existing Grassland	76.8	
Total		1571.4	

1:500	Proposal of paved area (Application No.TT/424) Lots 1397 (Part), 1398 A&B (Part), 1404 (Part), 1405 (Part) and 1410 in D. D.118 Tai Tong, Yuen Long, New Territories	Goldrich Planners & Surveyors Ltd.
February 2018		Plan 8a (P17136)

(摘錄自申請人於 22.2.2018 呈交的進一步資料)
(Extract from Applicant's Further
Information Submitted on 22.2.2018)

參考編號
REFERENCE No.
A/YL-TT/424

繪圖 DRAWING
A-5

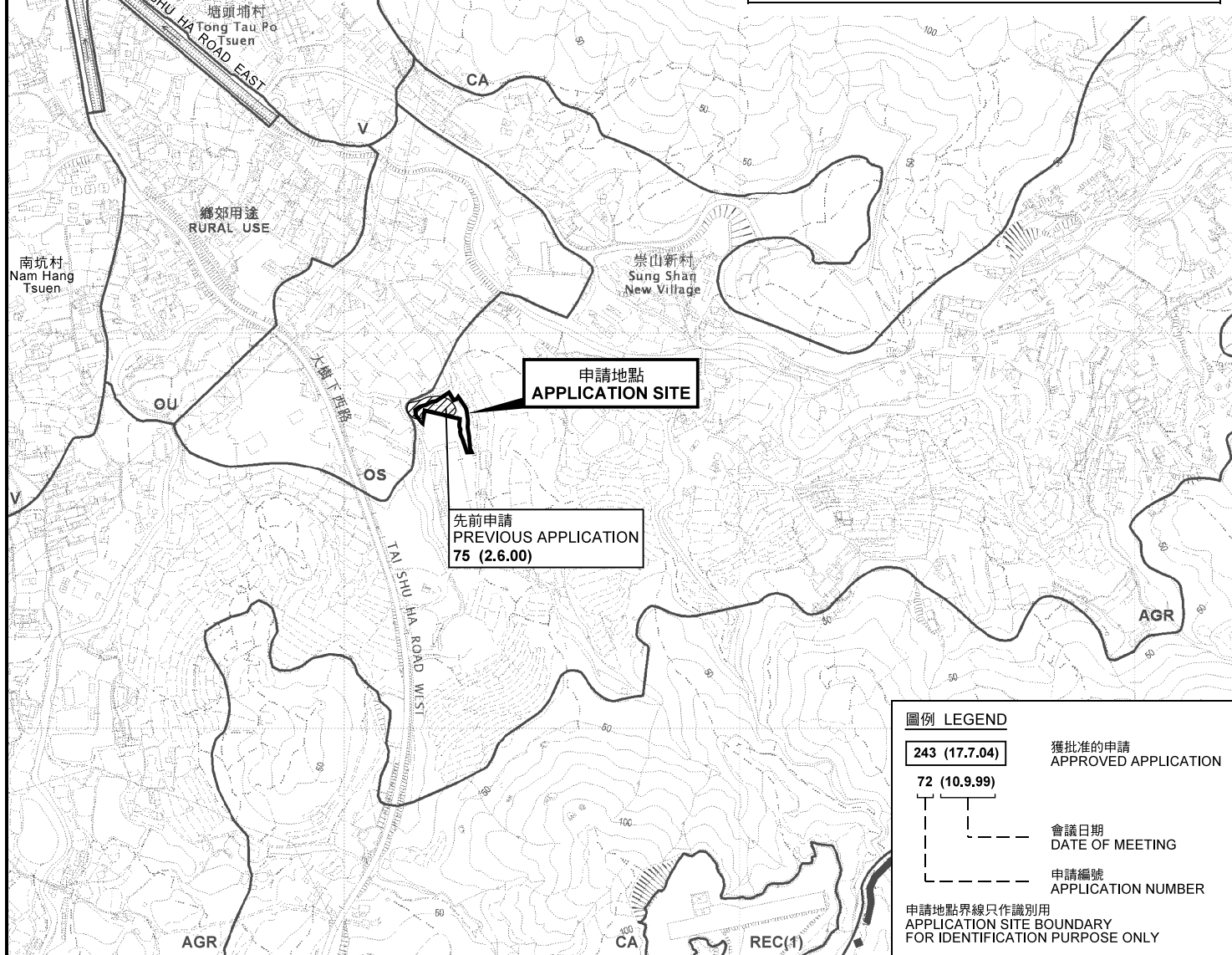
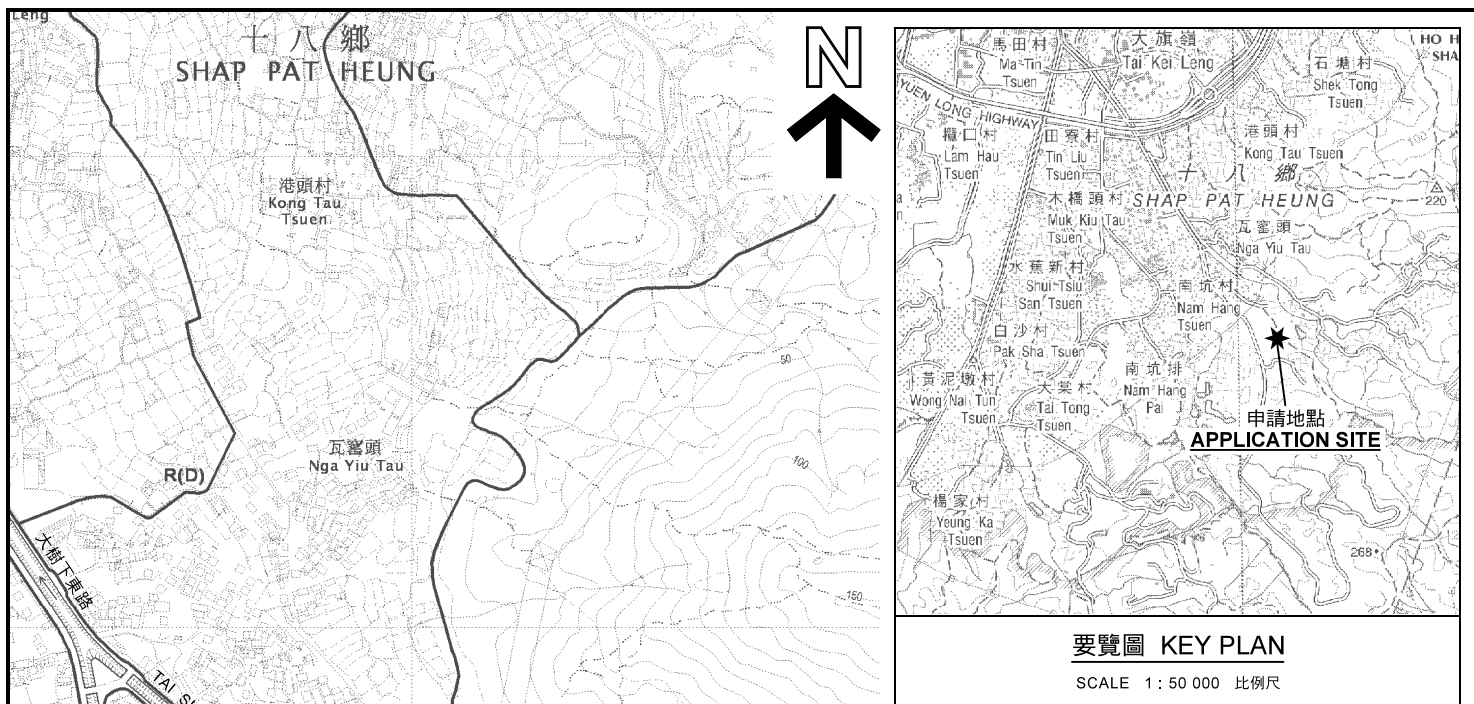

圖例 LEGEND

243 (17.7.04)	獲批准的申請 APPROVED APPLICATION
72 (10.9.99)	會議日期 DATE OF MEETING
	申請編號 APPLICATION NUMBER

申請地點界線只作識別用
APPLICATION SITE BOUNDARY
FOR IDENTIFICATION PURPOSE ONLY

本摘要圖於2018年2月12日擬備，
所根據的資料為於2012年3月13日
核准的分區計劃大綱圖編號 S/YL-TT/16
EXTRACT PLAN PREPARED ON 12.2.2018
BASED ON OUTLINE ZONING PLAN No.
S/YL-TT/16 APPROVED ON 13.3.2012

位置圖 LOCATION PLAN

擬議臨時動物復康中心（為期3年）
元朗大棠丈量約份第118約地段第1397號（部分）、第1398號A&B分段（部分）、
第1404號（部分）、第1405號（部分）及第1410號
PROPOSED TEMPORARY ANIMAL REHABILITATION CENTRE
FOR A PERIOD OF 3 YEARS
LOTS 1397 (PART), 1398 S.A&B (PART), 1404 (PART),
1405 (PART) AND 1410 IN D.D.118, TAI TONG, YUEN LONG

SCALE 1 : 8 000 比例尺

米 100 0 100 200 300 米
METRES

**規劃署
PLANNING
DEPARTMENT**



參考編號
REFERENCE No.
A/YL-TT/424

圖 PLAN
A-1

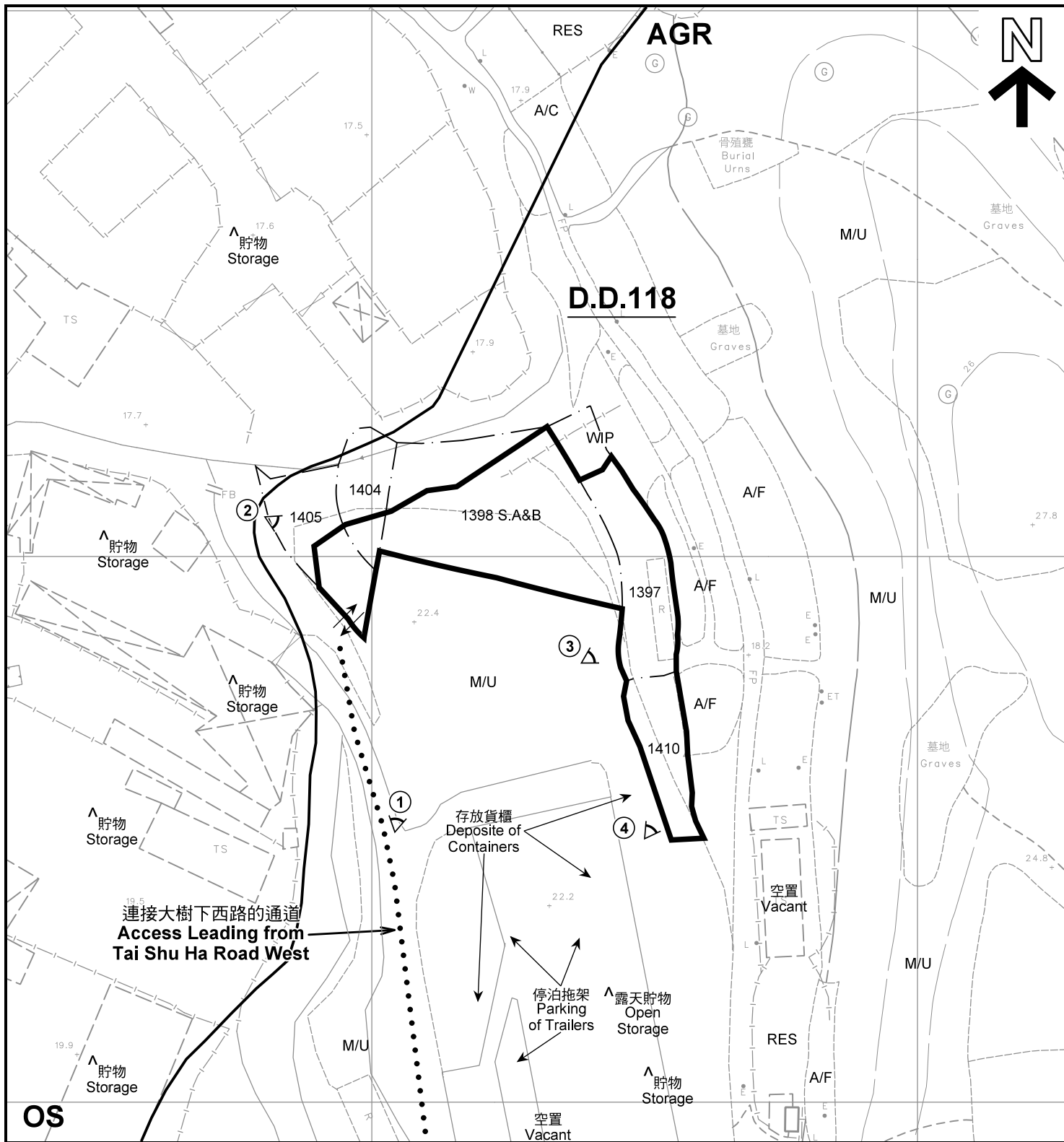

註釋 Notes :

- (1) 2018年1月25日勘測的土地用途
Land uses shown on this plan are in accordance with the land use survey conducted by the Planning Department on 25.1.2018
- (2) * 土地用途跟1991年11月勘測的土地用途一致
Indicates that the use is the same as that revealed by the land use survey conducted by the Planning Department in Nov 1991
- (3) ^ 土地用途跟1991年11月勘測的土地用途有別
Indicates that the use is different from that revealed by the land use survey conducted by the Planning Department in Nov 1991

圖例 LEGEND

- 申請地點(界線只作識別用)
APPLICATION SITE
(BOUNDARY FOR IDENTIFICATION
PURPOSE ONLY)
- OS** 露天貯物
OPEN STORAGE
- AGR** 農業
AGRICULTURE
- RES** 住用構築物
RESIDENTIAL STRUCTURES

- A/F 休耕農地
FALLOW AGRICULTURAL LAND
- M/U 荒地
UNUSED LAND
- A/C 常耕農地
CULTIVATED AGRICULTURAL LAND
- WIP 施工中
WORKS IN PROGRESS
- 實地照片的觀景點
VIEWING POINT OF SITE PHOTO
- 入口/出口
INGRESS / EGRESS

平面圖 SITE PLAN

本摘要圖於2018年2月9日擬備，所根據的資料為測量圖編號 6-NW-20D
EXTRACT PLAN PREPARED ON 9.2.2018
BASED ON SURVEY SHEET No. 6-NW-20D

擬議臨時動物復康中心(為期3年)
元朗大棠丈量約份第118約地段第1397號(部分)、第1398號A&B分段(部分)、第1404號(部分)、第1405號(部分)及第1410號
PROPOSED TEMPORARY ANIMAL REHABILITATION CENTRE
FOR A PERIOD OF 3 YEARS
LOTS 1397 (PART), 1398 S.A&B (PART), 1404 (PART),
1405 (PART) AND 1410 IN D.D.118, TAI TONG, YUEN LONG

規劃署
PLANNING
DEPARTMENT



SCALE 1 : 1 000 比例尺
米 METRES 20 0 20 40 米 METRES

參考編號
REFERENCE No.
A/YL-TT/424

圖 PLAN
A-2



崇山新村
Sung Shan
New Village

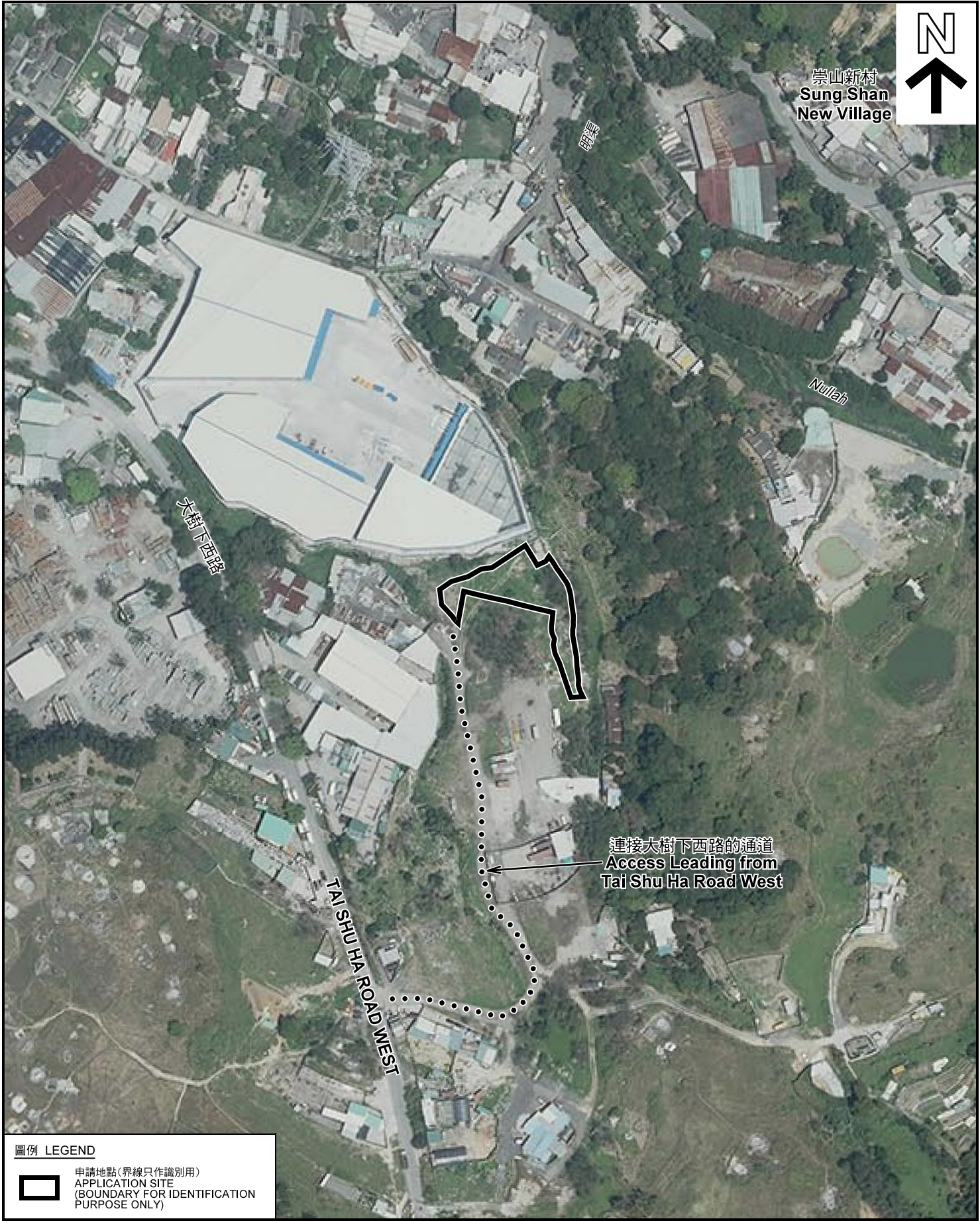

圖例 LEGEND

 申請地點(界線只作識別用)
APPLICATION SITE
(BOUNDARY FOR IDENTIFICATION
PURPOSE ONLY)

本摘要圖於2018年2月9日擬備，所根據的資料為地政總署於2017年4月2日拍得的航攝照片編號 E017056C
EXTRACT PLAN PREPARED ON 9.2.2018
BASED ON AERIAL PHOTO No.
E017056C TAKEN ON 2.4.2017
BY LANDS DEPARTMENT

航攝照片 AERIAL PHOTO

擬議臨時動物復康中心(為期3年)
元朗大堂丈量約份第118約地段第1397號(部分)、第1398號A&B分段(部分)、
第1404號(部分)、第1405號(部分)及第1410號
PROPOSED TEMPORARY ANIMAL REHABILITATION CENTRE
FOR A PERIOD OF 3 YEARS
LOTS 1397 (PART), 1398 S.A&B (PART), 1404 (PART),
1405 (PART) AND 1410 IN D.D.118, TAI TONG, YUEN LONG

規劃署
PLANNING
DEPARTMENT



參考編號
REFERENCE No.
A/YL-TT/424

圖 PLAN
A-3

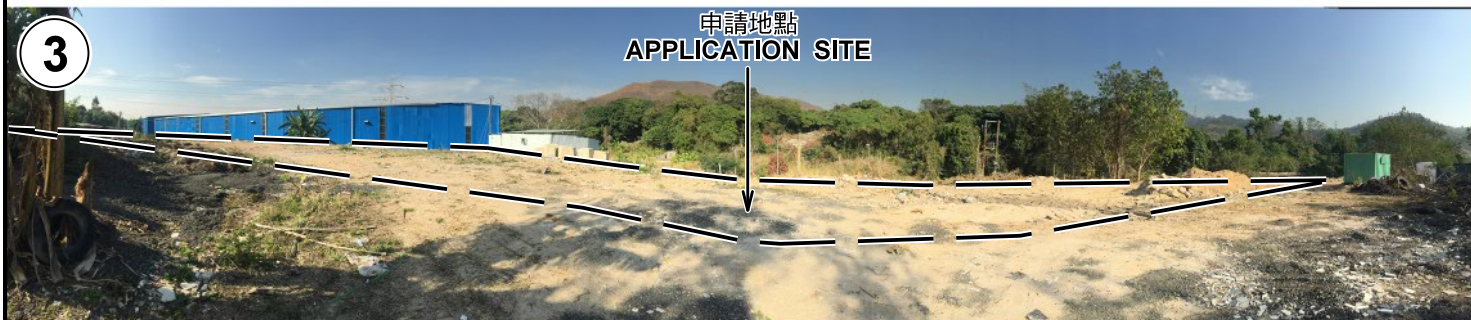

申請地點界線只作識別用 APPLICATION SITE BOUNDARY FOR IDENTIFICATION PURPOSE ONLY

實地照片 SITE PHOTOS

本圖於2018年2月9日擬備，所根據的資料為攝於2018年1月16日的實地照片
 PLAN PREPARED ON 9.2.2018
 BASED ON SITE PHOTOS
 TAKEN ON 16.1.2018

擬議臨時動物復康中心（為期3年）
 元朗大棠丈量約份第118約地段第1397號（部分）、第1398號A&B分段（部分）、
 第1404號（部分）、第1405號（部分）及第1410號
 PROPOSED TEMPORARY ANIMAL REHABILITATION CENTRE
 FOR A PERIOD OF 3 YEARS
 LOTS 1397 (PART), 1398 S.A&B (PART), 1404 (PART),
 1405 (PART) AND 1410 IN D.D.118, TAI TONG, YUEN LONG

規劃署
 PLANNING
 DEPARTMENT



參考編號
 REFERENCE No.
 A/YL-TT/424

圖 PLAN
 A-4