

Extracted Plan Based on Map
Series HP5C of Sheet No.
6-NW-D

Plan Showing the General Area

Scale 1:5 000

FIGURE 3

For Identification Purpose

Date: 22.7.2019



(摘錄自申請人於 22.8.2019 呈交的申請書)
(Extract from Applicant's
Submission of 22.8.2019)

參考編號
REFERENCE No.
AYL-TT/482

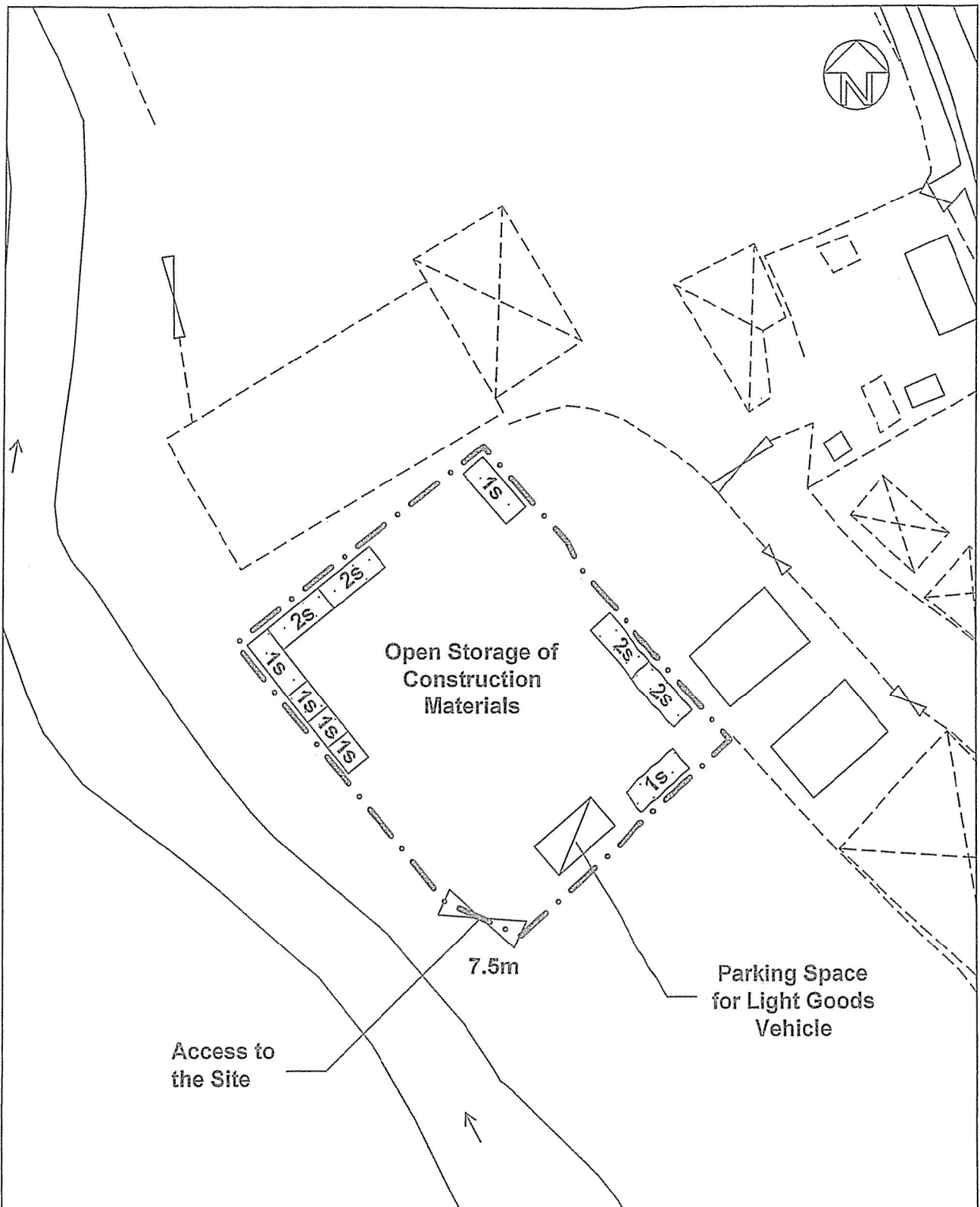
繪圖 DRAWING
A-1



LEGEND:

-  Application Site (Area = 1,084 sq.m.)
-  Converted Containers for Storage
(Covered Area: 125m²; Floor Area: 184m²)
-  Parking Space for Light Goods Vehicle (3.5m x 7m)

2s - 2-Storey (Height: 5m)
1s - 1-Storey (Height: 2.5m)

Layout Plan

Lot 1584B-G(Part) and Adjoining Government Land in DD117, Tai Tong, Yuen Long, N.T.

FIGURE 5

FOR IDENTIFICATION PURPOSE

Date: 22.7.2019

Scale: 1:500 (A4)

(摘錄自申請人於 22.8.2019 呈交的申請書)
(Extract from Applicant's
Submission of 22.8.2019)

參考編號
REFERENCE No.
A/YL-TT/482

繪圖 DRAWING
A-2

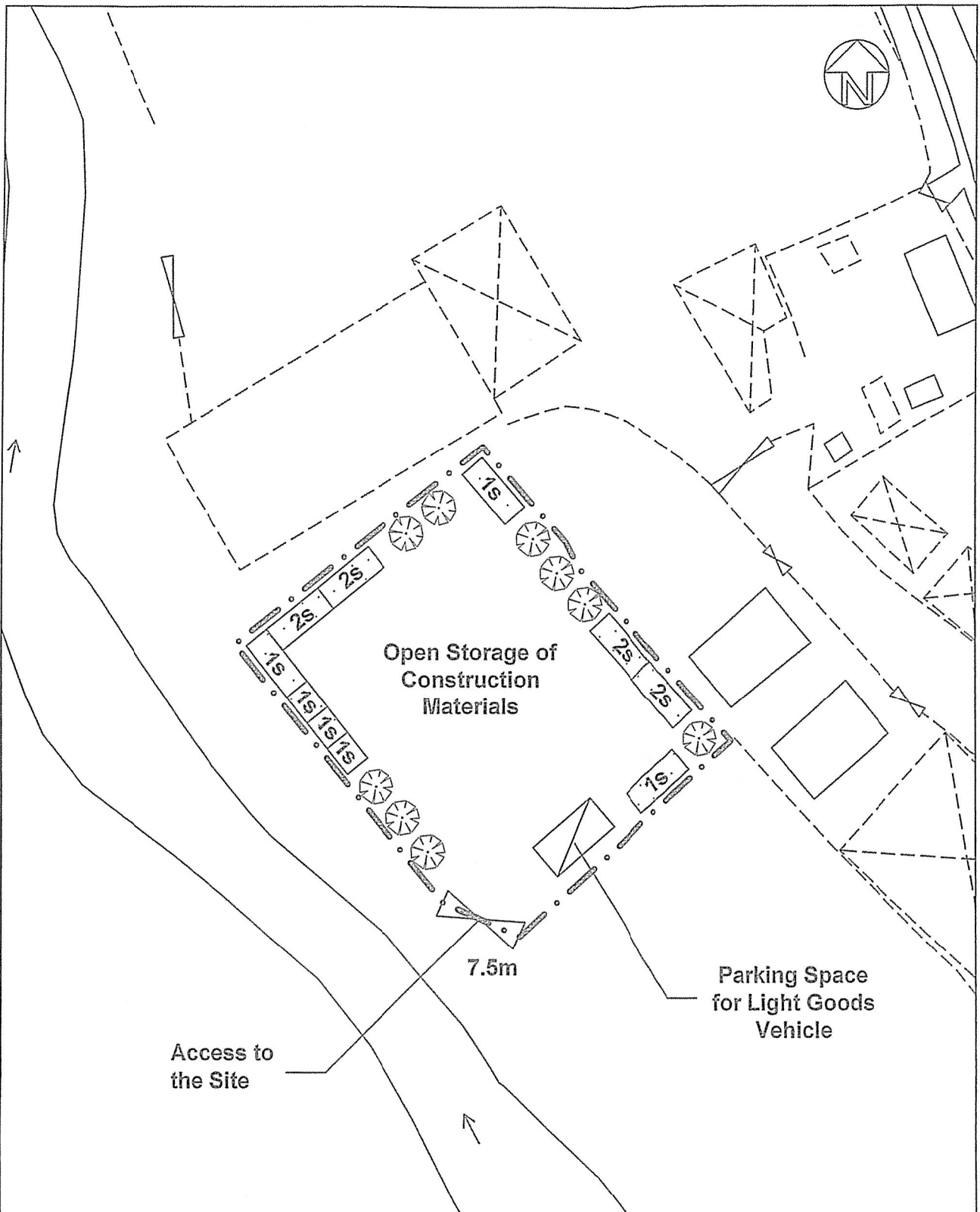

Plant Schedule:

Recommended Species	Spacing (centre to centre)	Size (height / span)	Quantity
Proposed Trees: Ficus Microcarpa (細葉榕) 	3000-4000mm	2750-3750mm	9

Landscape Plan

Lot 1584B-G(Part) and Adjoining Government Land in DD117, Tai Tong, Yuen Long, N.T.

FIGURE 6

FOR IDENTIFICATION PURPOSE
Date: 22.7.2019
Scale: 1: 500 (A4)

(摘錄自申請人於 22.8.2019 提交的申請書)
**(Extract from Applicant's
Submission of 22.8.2019)**

參考編號
REFERENCE No.
A/YL-TT/482

繪圖 **DRAWING**
A-3

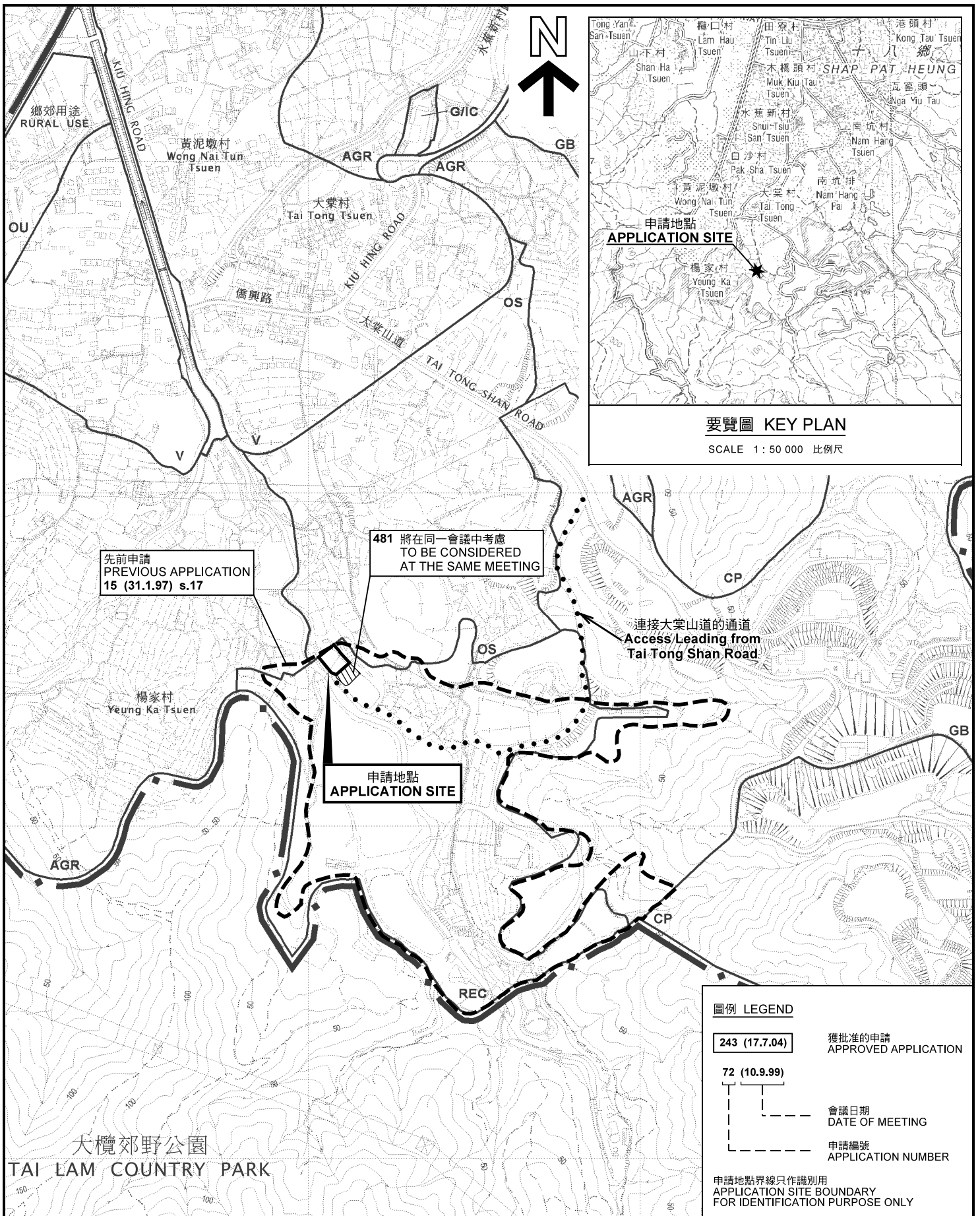

先前申請
PREVIOUS APPLICATION
15 (31.1.97) s.17

481 將在同一會議中考慮
TO BE CONSIDERED
AT THE SAME MEETING

申請地點
APPLICATION SITE

連接大棠山道的通道
Access/Leading from
Tai Tong Shan Road

圖例 LEGEND

- 243 (17.7.04)** 獲批准的申請
APPROVED APPLICATION
- 72 (10.9.99)**
- 會議日期
DATE OF MEETING
- 申請編號
APPLICATION NUMBER

申請地點界線只作識別用
APPLICATION SITE BOUNDARY
FOR IDENTIFICATION PURPOSE ONLY

位置圖 LOCATION PLAN

臨時露天存放建築材料連附屬貨倉（為期3年）
元朗大棠丈量約份第117約
地段第1584號B-G(部分)和毗連政府土地
TEMPORARY OPEN STORAGE OF
CONSTRUCTION MATERIALS WITH ANCILLARY
WAREHOUSE FOR A PERIOD OF 3 YEARS
LOT 1584 B-G (PART) IN D.D.117 AND ADJOINING
GOVERNMENT LAND, TAI TONG, YUEN LONG
SCALE 1 : 7 500 比例尺

米 100 0 100 200 300 米
METRES

規劃署
PLANNING
DEPARTMENT



參考編號
REFERENCE No.
A/YL-TT/482

圖 PLAN
A-1

本摘要圖於2019年9月27日擬備，
所根據的資料為於2012年3月13日
核准的分區計劃大綱圖編號 S/YL-TT/16
EXTRACT PLAN PREPARED ON 27.9.2019
BASED ON OUTLINE ZONING PLAN No.
S/YL-TT/16 APPROVED ON 13.3.2012

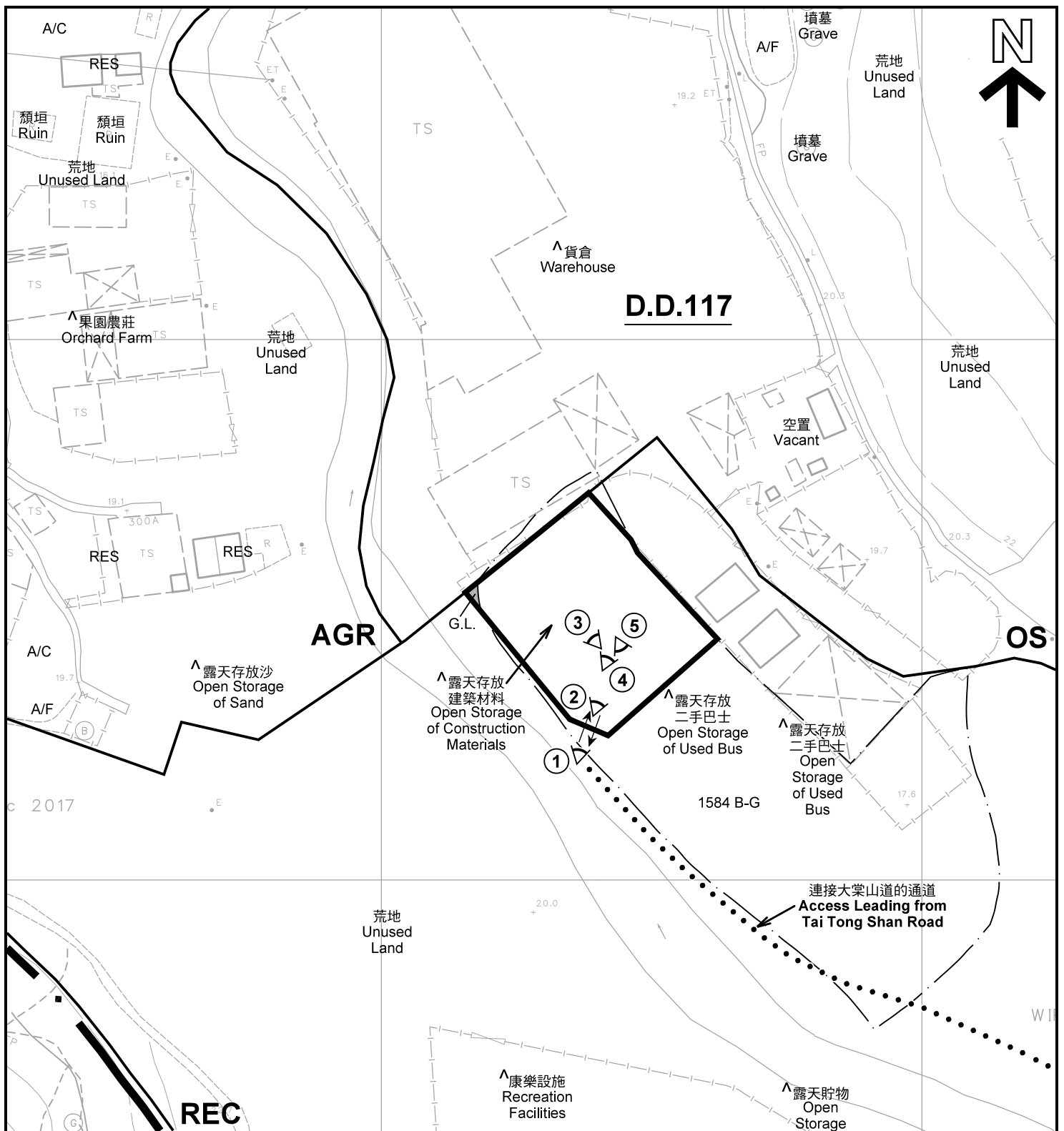

註釋 Notes:

- (1) 2019年9月19日勘測的土地用途
Land uses shown on this plan are in accordance with the land use survey conducted by the Planning Department on 19.9.2019
- (2) * 土地用途跟1991年11月勘測的土地用途一致
Indicates that the use is the same as that revealed by the land use survey conducted by the Planning Department in Nov 1991
- (3) ^ 土地用途跟1991年11月勘測的土地用途有別
Indicates that the use is different from that revealed by the land use survey conducted by the Planning Department in Nov 1991

圖例 LEGEND

- 申請地點(界線只作識別用)
APPLICATION SITE (BOUNDARY FOR IDENTIFICATION PURPOSE ONLY)
- OS** 露天貯物
OPEN STORAGE
- REC** 康樂
RECREATION
- AGR** 農業
AGRICULTURE
- G.L.** 政府土地
GOVERNMENT LAND
- RES** 住用構築物
RESIDENTIAL STRUCTURES
- A/F** 休耕農地
FALLOW AGRICULTURAL LAND
- A/C** 常耕農地
CULTIVATED AGRICULTURAL LAND
- 實地照片的觀景點
VIEWING POINT OF SITE PHOTO
- 入口/出口
INGRESS / EGRESS

平面圖 SITE PLAN

臨時露天存放建築材料連附屬貨倉 (為期3年)
元朗大棠丈量約份第117約
地段第1584號B-G(部分)和毗連政府土地
TEMPORARY OPEN STORAGE OF
CONSTRUCTION MATERIALS WITH ANCILLARY
WAREHOUSE FOR A PERIOD OF 3 YEARS
LOT 1584 B-G (PART) IN D.D.117 AND ADJOINING
GOVERNMENT LAND, TAI TONG, YUEN LONG
SCALE 1 : 1 000 比例尺

本摘要圖於2019年9月27日擬備, 所根據的資料為測量圖編號 6-NW-24D
EXTRACT PLAN PREPARED ON 27.9.2019
BASED ON SURVEY SHEET No. 6-NW-24D

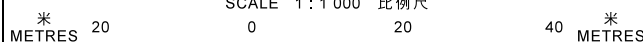

規劃署
PLANNING
DEPARTMENT



參考編號
REFERENCE No.
A/YL-TT/482

圖 PLAN
A-2



楊家村
Yeung Ka
Tsuen

連接大棠山道的通道
Access Leading from
Tai Tong Shan Road

大棠
荔枝山莊
Tai Tong
Lychee
Valley

大棠
有機生態園
Tai Tong
Organic
EcoPark

圖例 LEGEND



申請地點(界線只作識別用)
APPLICATION SITE
(BOUNDARY FOR IDENTIFICATION
PURPOSE ONLY)

本摘要圖於2019年10月8日擬備，所根據的資料為地政總署於2018年3月22日拍得的航攝照片編號 E036794C
EXTRACT PLAN PREPARED ON 8.10.2019
BASED ON AERIAL PHOTO No.
E036794C TAKEN ON 22.3.2018
BY LANDS DEPARTMENT

航攝照片 AERIAL PHOTO

臨時露天存放建築材料連附屬貨倉(為期3年)
元朗大棠丈量約份第117約
地段第1584號B-G(部分)和毗連政府土地
CONSTRUCTION MATERIALS WITH ANCILLARY
WAREHOUSE FOR A PERIOD OF 3 YEARS
LOT 1584 B-G (PART) IN D.D.117 AND ADJOINING
GOVERNMENT LAND, TAI TONG, YUEN LONG

規劃署
PLANNING
DEPARTMENT



參考編號
REFERENCE No.
A/YL-TT/482

圖 PLAN
A-3

1

申請地點
APPLICATION SITE



連接大棠山道的通道
Access Leading from
Tai Tong Shan Road

2

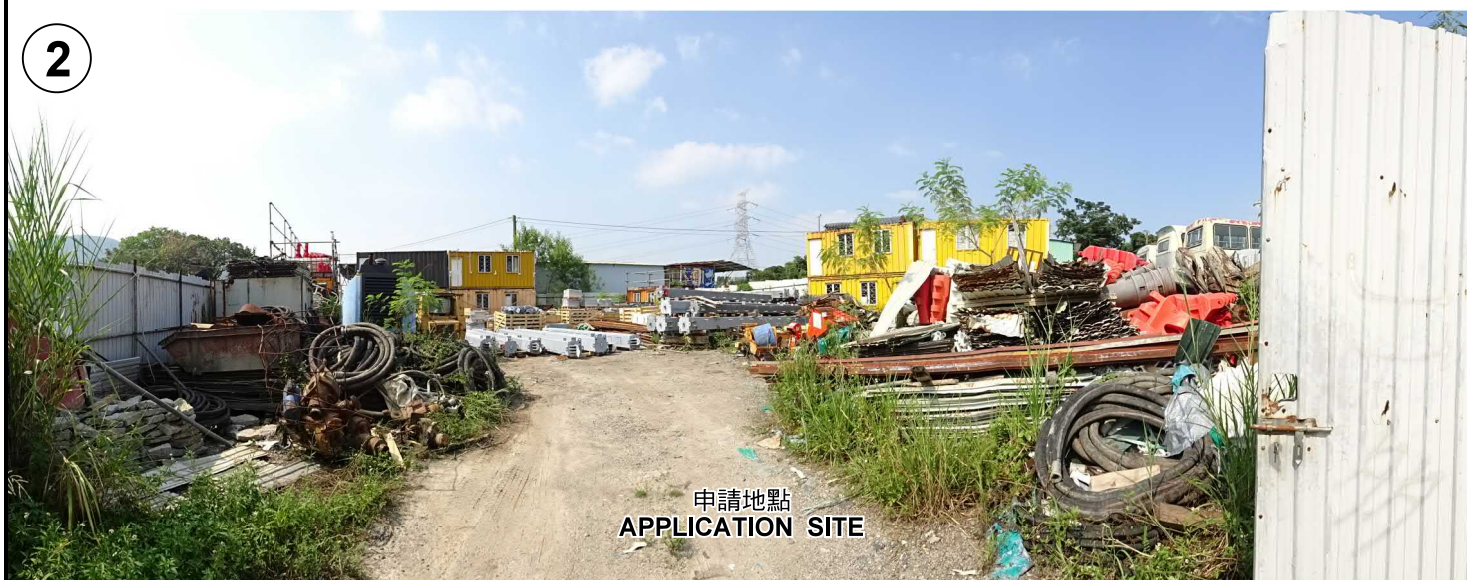

申請地點
APPLICATION SITE

實地照片 SITE PHOTOS

臨時露天存放建築材料連附屬貨倉（為期3年）
元朗大棠丈量約份第117約
地段第1584號B-G（部分）和毗連政府土地
CONSTRUCTION MATERIALS WITH ANCILLARY
WAREHOUSE FOR A PERIOD OF 3 YEARS
LOT 1584 B-G (PART) IN D.D.117 AND ADJOINING
GOVERNMENT LAND, TAI TONG, YUEN LONG

規劃署
PLANNING
DEPARTMENT



參考編號
REFERENCE No.
A/YL-TT/482

圖 PLAN
A-4a

本圖於2019年9月27日擬備，所根據的資料為攝於2019年9月19日的實地照片
PLAN PREPARED ON 27.9.2019
BASED ON SITE PHOTOS TAKEN ON 19.9.2019

3



4



5



實地照片 SITE PHOTOS

臨時露天存放建築材料連附屬貨倉（為期3年）
 元朗大堂丈量約份第117約
 地段第1584號B-G(部分)和毗連政府土地
 TEMPORARY OPEN STORAGE OF
 CONSTRUCTION MATERIALS WITH ANCILLARY
 WAREHOUSE FOR A PERIOD OF 3 YEARS
 LOT 1584 B-G (PART) IN D.D.117 AND ADJOINING
 GOVERNMENT LAND, TAI TONG, YUEN LONG

規劃署
 PLANNING
 DEPARTMENT



參考編號
 REFERENCE No.
 A/YL-TT/482

圖 PLAN
 A-4b

本圖於2019年9月27日擬備，所根據的資料為攝於2019年9月19日的實地照片
 PLAN PREPARED ON 27.9.2019
 BASED ON SITE PHOTOS TAKEN
 ON 19.9.2019