

Drawing No.	Ver.
P01	01
Project	
PROPOSED TEMPORARY SHOP AND SERVICES (GROCERY SHOP) FOR A PERIOD OF 5 YEARS	
LOT 4219 (PART) IN D.D. 116, TAI TONG, YUEN LONG	
Drawing Title	
LOCATION PLAN	
Scale of A4	
1 : 1000	
Drawn	Date
	8.8.2019
Revised	Date

(摘錄自申請人於 22.8.2019 呈交的申請書)
 (Extract from Applicant's Submission of 22.8.2019)

參考編號 REFERENCE No.	繪圖 DRAWING
A/YL-TT/483	A-1

STRUCTURE	USE	COVERED AREA	NON-DOM. GFA	BUILDING HEIGHT
B1	(G/F) (1/F) GROCERY SHOP & SoG SITE OFFICE	122.8m ² (ABOUT)	155.8m ² (ABOUT)	5.8m(ABOUT)(2-STOREY)
B2	SoG	52.3m ² (ABOUT)	52.3m ² (ABOUT)	5.8m (ABOUT)(1-STOREY)
TOTAL		175.1m² (ABOUT)	208.1m² (ABOUT)	

* S&S = SHOP AND SERVICES
SoG = STORAGE OF GOODS

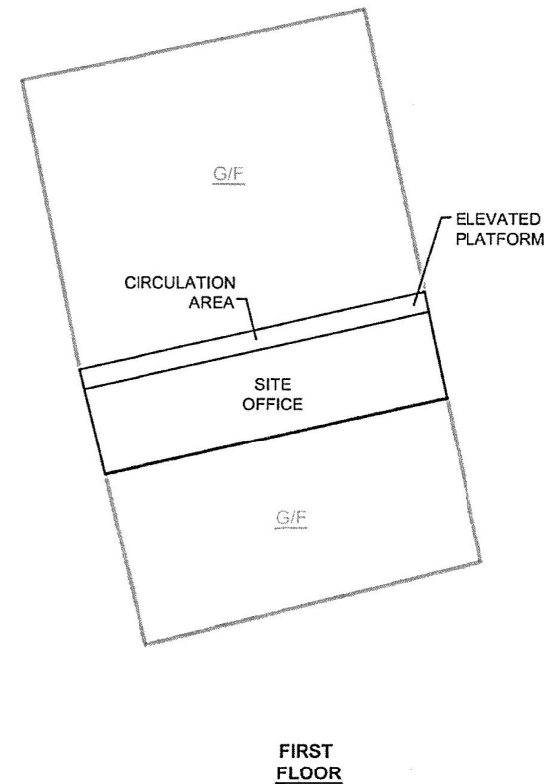
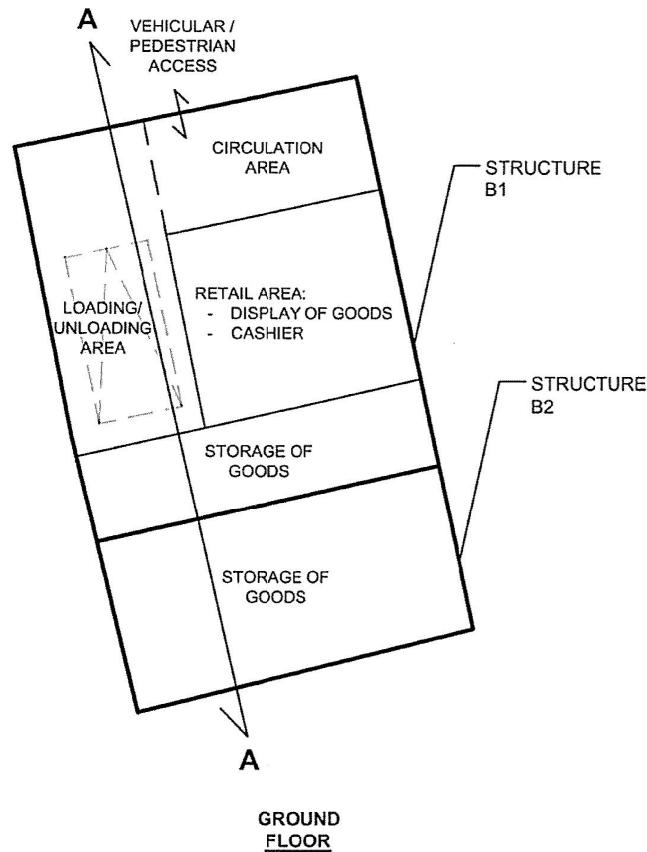
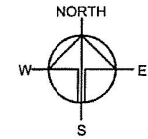
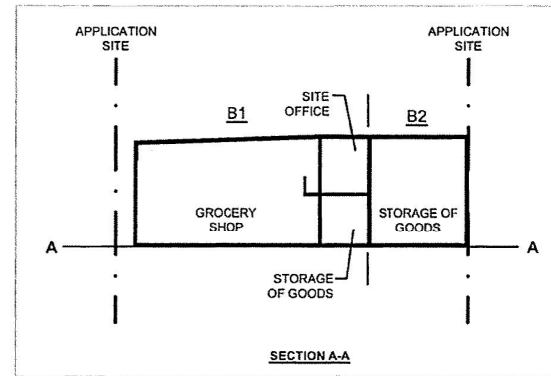

Drawing No.	Ver.
P04	01
Project	
PROPOSED TEMPORARY SHOP AND SERVICES (GROCERY SHOP) FOR A PERIOD OF 5 YEARS	
LOT 4219 (PART) IN D.D. 116, TAI TONG, YUEN LONG	
Drawing Title	
FLOOR PLAN	
Scale of A1	
1 : 200	
Drawn	Date
	26.8.2019
Revised	Date

(摘錄自申請人於 26. 8. 2019 呈交的補充資料)
(Extract from Applicant's Supplementary Information Submitted on 26.8.2019)

參考編號 REFERENCE No.	繪圖 DRAWING
A/YL-TT/483	A-2

SWEPT PATH ANALYSIS

TYPE OF VEHICLE: PRIVATE CAR
 DIMENSION OF VEHICLE: 4.3m X 1.8m (ABOUT)

NO. OF PRIVATE CAR PARKING SPACE (2.5m X 5m): 1
 MINIMUM HEADROOM: 3m (ABOUT)

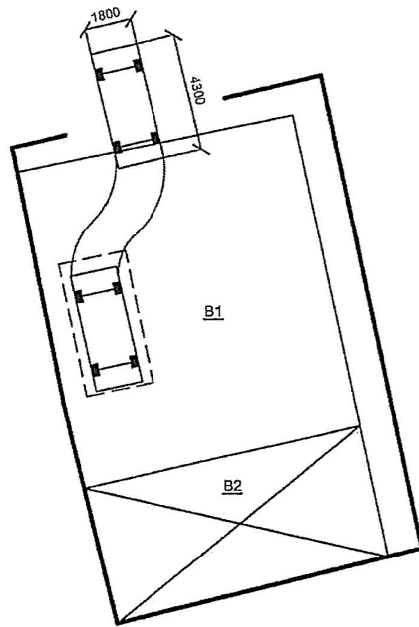
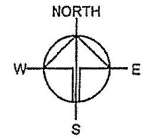

IN

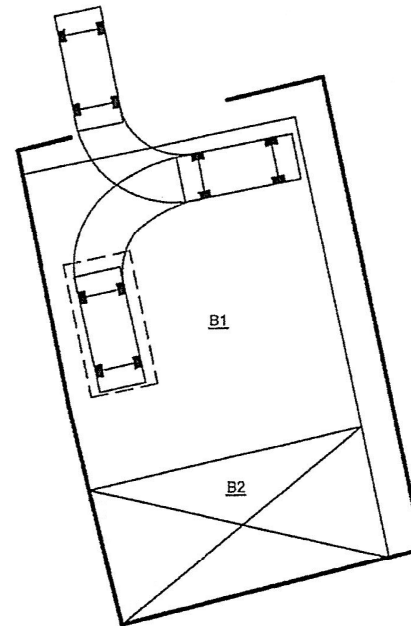

OUT

LEGEND

- STRUCTURE
- PARKING SPACE
- PRIVATE CAR
- SWEPT PATH

Drawing No. P03	Ver. 01
Project PROPOSED TEMPORARY SHOP AND SERVICES (GROCERY SHOP) FOR A PERIOD OF 5 YEARS LOT 4219 (PART) IN D.D. 116, TAI TONG, YUEN LONG	
Drawing Title SWEPT PATH ANALYSIS	
Scale of A4 1 : 250	
Drawn	Date 8.8.2019
Revised	Date

(摘錄自申請人於 22.8.2019 呈交的申請書)
 (Extract from Applicant's Submission of 22.8.2019)

參考編號
 REFERENCE No.
 A/YL-TT/483

繪圖 DRAWING
 A-3

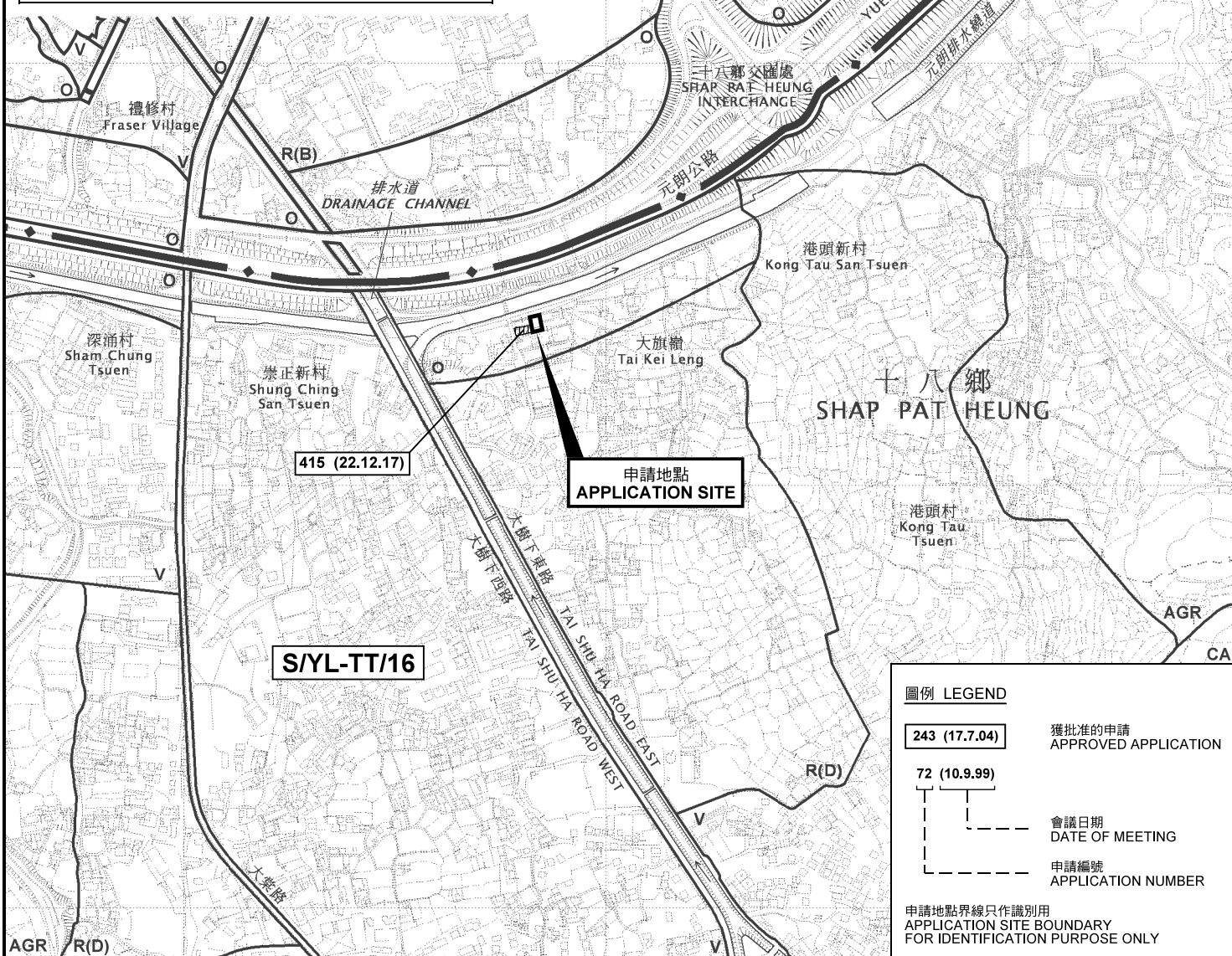
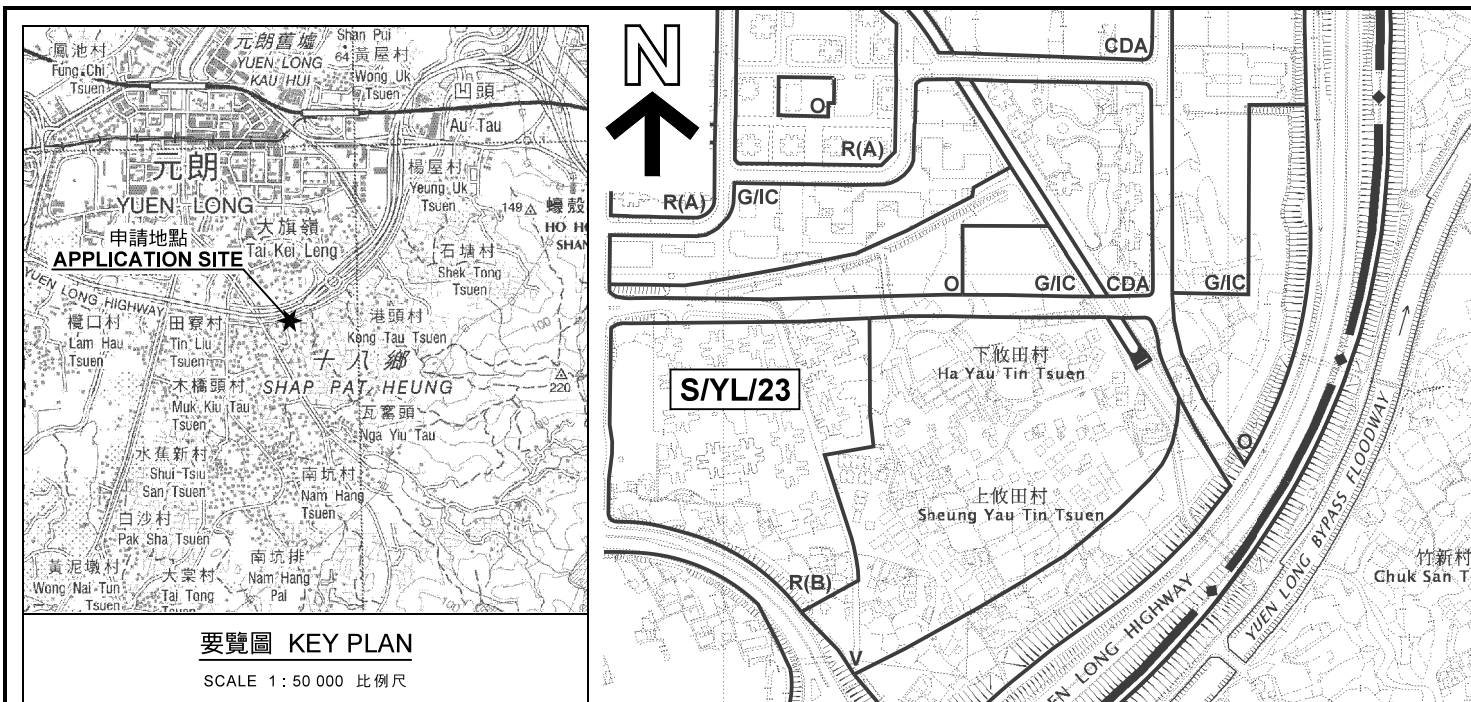

位置圖及同類申請 LOCATION PLAN WITH SIMILAR APPLICATION

本摘要圖於2019年10月8日擬備，
所根據的資料為於2012年3月13日
核准的分區計劃大綱圖編號 S/YL-TT/16
EXTRACT PLAN PREPARED ON 8.10.2019
BASED ON OUTLINE ZONING PLAN No.
S/YL-TT/16 APPROVED ON 13.3.2012

擬議臨時商店及服務行業(雜貨店)(為期5年)
元朗大棠丈量約份第116約地段第4219號(部分)
PROPOSED TEMPORARY SHOP AND SERVICES
(GROCERY STORE) FOR A PERIOD OF 5 YEARS
LOT 4219 (PART) IN D.D.116, TAI TONG, YUEN LONG

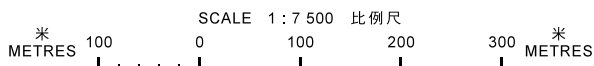

規劃署
PLANNING
DEPARTMENT



參考編號
REFERENCE No.
A/YL-TT/483

圖 PLAN
A-1

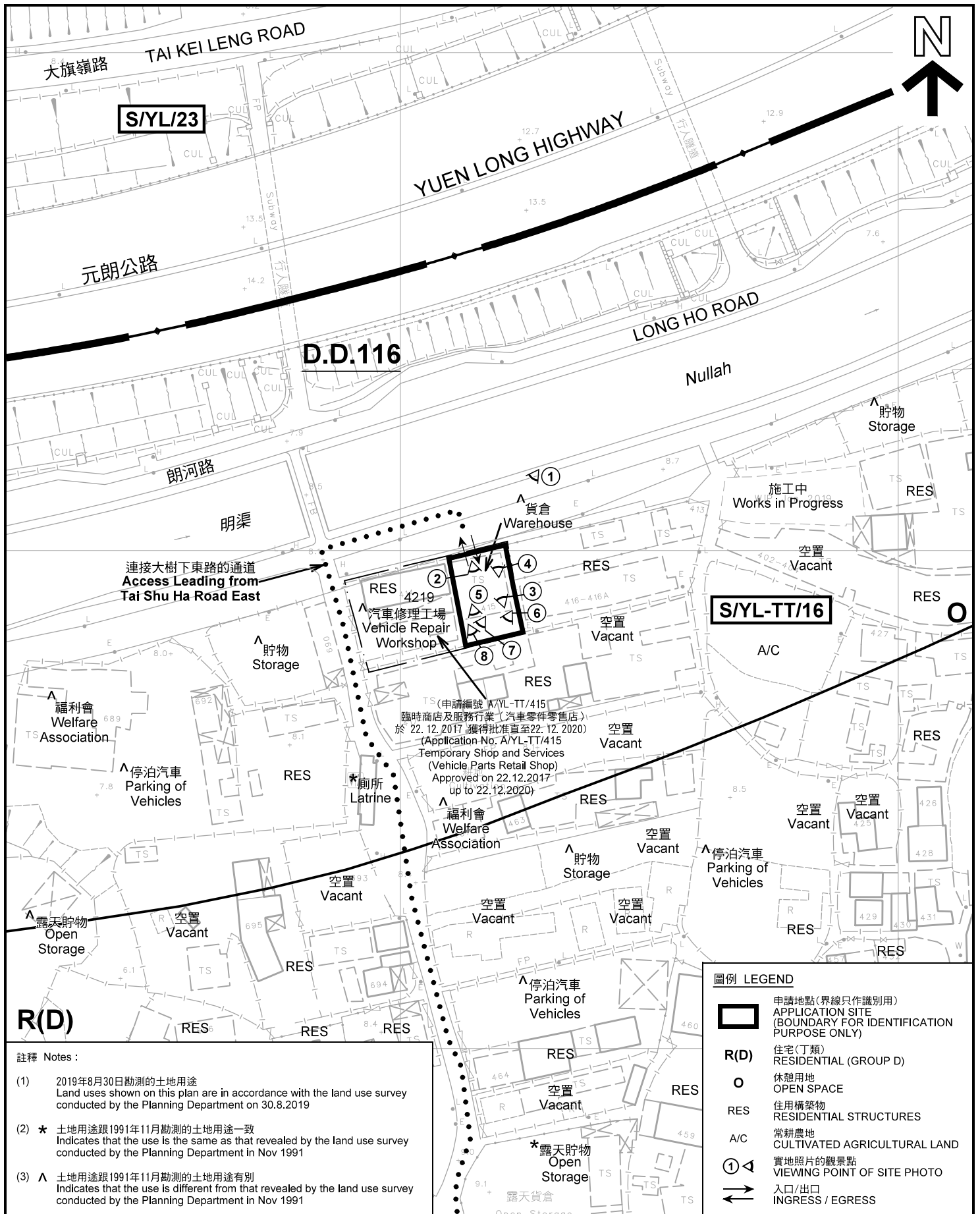

S/YL/23

D.D.116

S/YL-TT/16

R(D)

註釋 Notes:

- (1) 2019年8月30日勘測的土地用途
Land uses shown on this plan are in accordance with the land use survey conducted by the Planning Department on 30.8.2019
- (2) * 土地用途跟1991年11月勘測的土地用途一致
Indicates that the use is the same as that revealed by the land use survey conducted by the Planning Department in Nov 1991
- (3) ^ 土地用途跟1991年11月勘測的土地用途有別
Indicates that the use is different from that revealed by the land use survey conducted by the Planning Department in Nov 1991

圖例 LEGEND

- 申請地點(界線只作識別用)
APPLICATION SITE
(BOUNDARY FOR IDENTIFICATION PURPOSE ONLY)
- R(D) 住宅(丁類)
RESIDENTIAL (GROUP D)
- O 休憩用地
OPEN SPACE
- RES 住用構築物
RESIDENTIAL STRUCTURES
- A/C 常耕農地
CULTIVATED AGRICULTURAL LAND
- ① 實地照片的觀景點
VIEWING POINT OF SITE PHOTO
- 入口/出口
INGRESS / EGRESS

平面圖 SITE PLAN

本摘要圖於2019年10月9日擬備，所根據的資料為測量圖編號 6-NW-15C
EXTRACT PLAN PREPARED ON 9.10.2019
BASED ON SURVEY SHEET No. 6-NW-15C

擬議臨時商店及服務行業(雜貨店)(為期5年)
元朗大棠丈量約份第116約地段第4219號(部分)
PROPOSED TEMPORARY SHOP AND SERVICES
(GROCERY STORE) FOR A PERIOD OF 5 YEARS
LOT 4219 (PART) IN D.D.116, TAI TONG, YUEN LONG

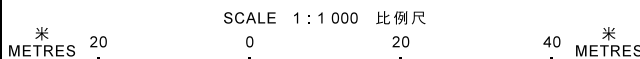

規劃署
PLANNING
DEPARTMENT



參考編號
REFERENCE No.
A/YL-TT/483

圖 PLAN
A-2

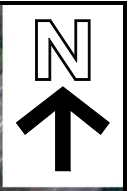

圖例 LEGEND

 申請地點 (界線只作識別用)
APPLICATION SITE
(BOUNDARY FOR IDENTIFICATION
PURPOSE ONLY)

本摘要圖於2019年10月8日擬備，所根據的資料為地政總署於2018年3月13日拍得的航攝照片編號 E034884C
EXTRACT PLAN PREPARED ON 8.10.2019
BASED ON AERIAL PHOTO No.
E034884C TAKEN ON 13.3.2018
BY LANDS DEPARTMENT

航攝照片 AERIAL PHOTO

擬議臨時商店及服務行業(雜貨店)(為期5年)
元朗大棠丈量約份第116約地段第4219號(部分)
PROPOSED TEMPORARY SHOP AND SERVICES
(GROCERY STORE) FOR A PERIOD OF 5 YEARS
LOT 4219 (PART) IN D.D.116, TAI TONG, YUEN LONG

規劃署
PLANNING
DEPARTMENT



參考編號
REFERENCE No.
A/YL-TT/483

圖 PLAN
A-3



實地照片 SITE PHOTOS

本圖於2019年10月8日擬備，所根據的資料為攝於2019年9月11日的實地照片
PLAN PREPARED ON 8.10.2019
BASED ON SITE PHOTOS
TAKEN ON 11.9.2019

擬議臨時商店及服務行業(雜貨店)(為期5年)
元朗大棠丈量約份第116約地段第4219號(部分)
PROPOSED TEMPORARY SHOP AND SERVICES
(GROCERY STORE) FOR A PERIOD OF 5 YEARS
LOT 4219 (PART) IN D.D.116, TAI TONG, YUEN LONG

規劃署
PLANNING
DEPARTMENT



參考編號
REFERENCE No.
A/YL-TT/483

圖 PLAN
A-4a



4

申請地點 (地下)
APPLICATION SITE (G/F)



5

申請地點 (地下)
APPLICATION SITE (G/F)



6

申請地點 (地下)
APPLICATION SITE (G/F)



7

申請地點 (地下)
APPLICATION SITE (G/F)



8

申請地點 (一樓)
APPLICATION SITE (1/F)

實地照片 SITE PHOTOS

本圖於2019年10月8日擬備，所根據的資料為攝於2019年9月11日的實地照片
PLAN PREPARED ON 8.10.2019
BASED ON SITE PHOTOS
TAKEN ON 11.9.2019

擬議臨時商店及服務行業(雜貨店)(為期5年)
元朗大棠丈量約份第116約地段第4219號(部分)
PROPOSED TEMPORARY SHOP AND SERVICES
(GROCERY STORE) FOR A PERIOD OF 5 YEARS
LOT 4219 (PART) IN D.D.116, TAI TONG, YUEN LONG

規劃署
PLANNING
DEPARTMENT



參考編號
REFERENCE No.
A/YL-TT/483

圖 PLAN
A-4b