

**Legend**

- The Application Site
- Peripheral Planting
- Fence Wall
- Ancillary Office / Structures / Shelter
- 3.5m x 16m Loading & Unloading Bay
- Existing Footpath on Government Land for Public Passage

**Layout Plan**

Temporary Vehicle Repair Workshop,  
 Open Storage of Scrap Metal, Construction Machinery,  
 Building / Recycling Materials with  
 Ancillary Workshop and Packaging Activities  
 Various Lots in DD119 & DD121 and Adjoining Government Land,  
 Tong Yan San Tsuen, Yuen Long



**Plan 3**

**PlanArch Consultants Ltd.**

Revision:                      Date: 14.1.2020

(摘錄自申請人於 25. 2. 2020 呈交的申請書)  
 (Extract from Applicant's  
 Submission of 25.2.2020)

參考編號 REFERENCE No. <b>A/YL-TYST/1008</b>	繪圖 DRAWING <b>A-1</b>
--	--------------------------

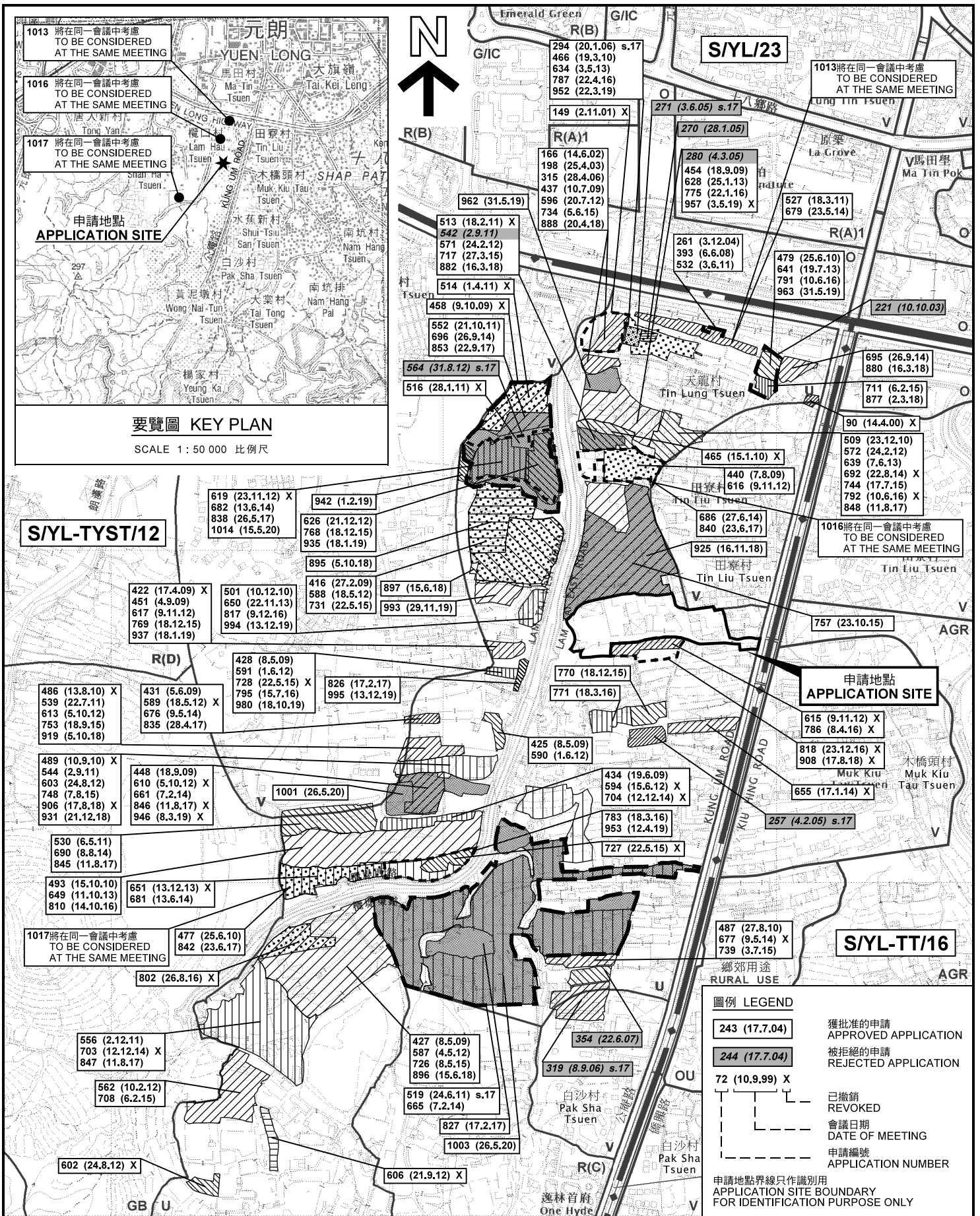

**要覽圖 KEY PLAN**

SCALE 1: 50 000 比例尺

**圖例 LEGEND**

- 243 (17.7.04) 獲批准的申請 APPROVED APPLICATION
- 244 (17.7.04) 被拒絕的申請 REJECTED APPLICATION
- 72 (10.9.99) X 已撤銷 REVOKED
- 會議日期 DATE OF MEETING
- 申請編號 APPLICATION NUMBER

申請地點界線只作識別用  
APPLICATION SITE BOUNDARY  
FOR IDENTIFICATION PURPOSE ONLY

**位置圖及同類申請 LOCATION PLAN WITH SIMILAR APPLICATIONS**

臨時汽車修理工場及露天存放廢金屬、建築機械及  
建築材料/回收物料連附屬工場及包裝活動(為期3年)  
元朗唐人新村丈量約份第119約及第121約多個地段和毗連政府土地  
TEMPORARY VEHICLE REPAIR WORKSHOP AND  
OPEN STORAGE OF SCRAP METAL, CONSTRUCTION MACHINERY AND  
BUILDING / RECYCLING MATERIALS WITH ANCILLARY WORKSHOP AND  
PACKAGING ACTIVITIES FOR A PERIOD OF 3 YEARS  
VARIOUS LOTS IN D.D.119 AND D.D.121 AND  
ADJOINING GOVERNMENT LAND, TONG YAN SAN TSUEN, YUEN LONG  
SCALE 1: 7 500 比例尺

米 100 0 100 200 300 米  
METRES

本摘要圖於2020年6月3日擬備，  
所根據的資料為於2018年9月4日  
核准的分區計劃大綱圖編號 S/YL-TYST/12  
EXTRACT PLAN PREPARED ON 3.6.2020  
BASED ON OUTLINE ZONING PLAN No.  
S/YL-TYST/12 APPROVED ON 4.9.2018

**規劃署  
PLANNING  
DEPARTMENT**



參考編號  
REFERENCE No.

A/YL-TYST/1008

圖 PLAN

A-1a



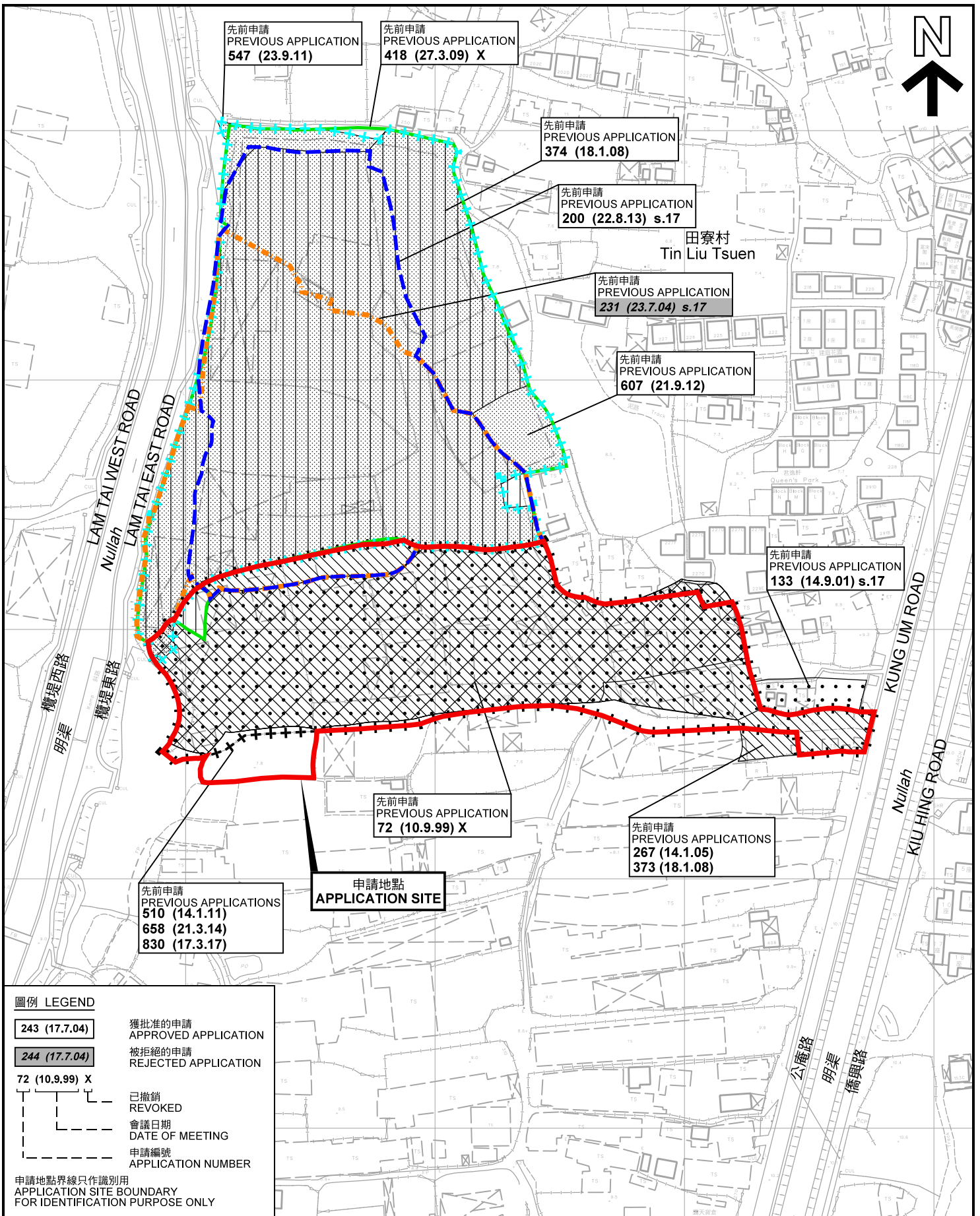

**先前申請圖 PREVIOUS APPLICATIONS PLAN**

臨時汽車修理工場及露天存放廢金屬、建築機械及  
 建築材料/回收物料連附屬工場及包裝活動(為期3年)  
 元朗唐人新村丈量約份第119約及第121約多個地段和毗連政府土地  
 TEMPORARY VEHICLE REPAIR WORKSHOP AND  
 OPEN STORAGE OF SCRAP METAL, CONSTRUCTION MACHINERY AND  
 BUILDING / RECYCLING MATERIALS WITH ANCILLARY WORKSHOP AND  
 PACKAGING ACTIVITIES FOR A PERIOD OF 3 YEARS  
 VARIOUS LOTS IN D.D.119 AND D.D.121 AND  
 ADJOINING GOVERNMENT LAND, TONG YAN SAN TSUEN, YUEN LONG

規劃署  
**PLANNING  
 DEPARTMENT**



參考編號  
 REFERENCE No.

圖 PLAN

A/YL-TYST/1008

A-1b

本摘要圖於2020年5月25日擬備，所根據的  
 資料為測量圖編號 6-NW-14C、6-NW-14D、  
 6-NW-19A 及 6-NW-19B  
 EXTRACT PLAN PREPARED ON 25.5.2020  
 BASED ON SURVEY SHEETS No.  
 6-NW-14C, 6-NW-14D, 6-NW-19A  
 & 6-NW-19B

SCALE 1 : 2 000 比例尺

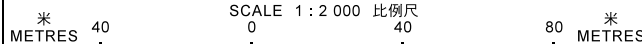

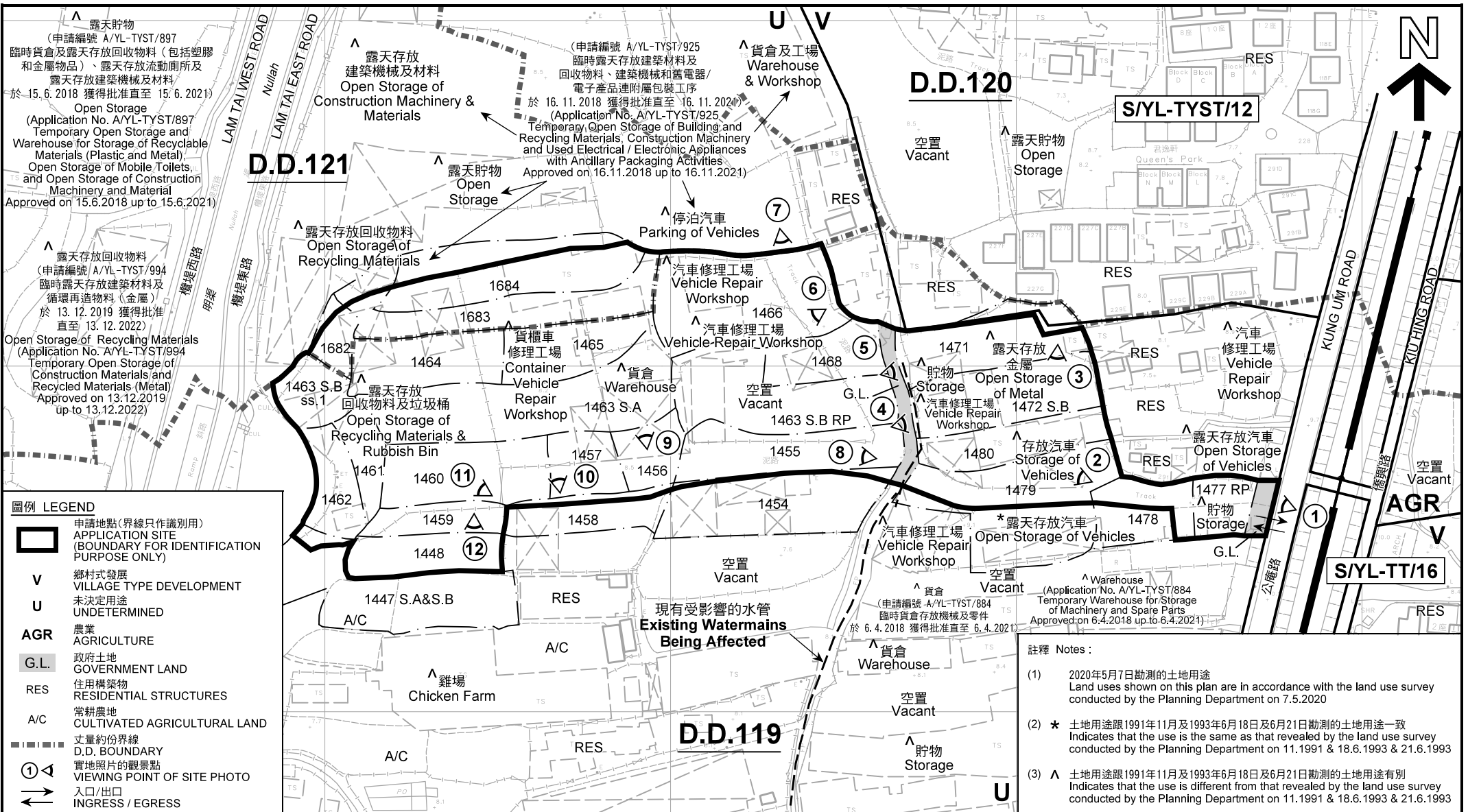

**圖例 LEGEND**

- 申請地點(界線只作識別用)  
APPLICATION SITE (BOUNDARY FOR IDENTIFICATION PURPOSE ONLY)
- V** 鄉村式發展  
VILLAGE TYPE DEVELOPMENT
- U** 未決定用途  
UNDETERMINED
- AGR** 農業  
AGRICULTURE
- G.L.** 政府土地  
GOVERNMENT LAND
- RES** 住用構築物  
RESIDENTIAL STRUCTURES
- A/C** 常耕農地  
CULTIVATED AGRICULTURAL LAND
- 丈量約份界線  
D.D. BOUNDARY
- 實地照片的觀景點  
VIEWING POINT OF SITE PHOTO
- 入口/出口  
INGRESS / EGRESS

- 註釋 Notes:**
- (1) 2020年5月7日勘测的土地用途  
Land uses shown on this plan are in accordance with the land use survey conducted by the Planning Department on 7.5.2020
  - (2) \* 土地用途跟1991年11月及1993年6月18日及6月21日勘测的土地用途一致  
Indicates that the use is the same as that revealed by the land use survey conducted by the Planning Department on 11.1991 & 18.6.1993 & 21.6.1993
  - (3) ^ 土地用途跟1991年11月及1993年6月18日及6月21日勘测的土地用途有別  
Indicates that the use is different from that revealed by the land use survey conducted by the Planning Department on 11.1991 & 18.6.1993 & 21.6.1993

本摘要圖於2020年5月25日擬備，所根據的資料為測量圖編號 6-NW-14C、6-NW-14D、6-NW-19A 及 6-NW-19B  
EXTRACT PLAN PREPARED ON 25.5.2020 BASED ON SURVEY SHEETS No. 6-NW-14C, 6-NW-14D, 6-NW-19A & 6-NW-19B

**平面圖 SITE PLAN**

臨時汽車修理工場及露天存放廢金屬、建築機械及建築材料/回收物料連附屬工場及包裝活動(為期3年)  
元朗唐人新村丈量約份第119約及第121約多個地段和毗連政府土地  
TEMPORARY VEHICLE REPAIR WORKSHOP AND OPEN STORAGE OF SCRAP METAL, CONSTRUCTION MACHINERY AND BUILDING / RECYCLING MATERIALS WITH ANCILLARY WORKSHOP AND PACKAGING ACTIVITIES FOR A PERIOD OF 3 YEARS  
VARIOUS LOTS IN D.D.119 AND D.D.121 AND ADJOINING GOVERNMENT LAND, TONG YAN SAN TSUEN, YUEN LONG

SCALE 1 : 1 500 比例尺

0 20 40 60 METRES

**規劃署  
PLANNING  
DEPARTMENT**

參考編號  
REFERENCE No. **A/YL-TYST/1008**

圖 PLAN **A-2**





LAM TAI WEST ROAD  
LAM TAI EAST ROAD  
Nullah

KUNG UM ROAD  
KIU HING ROAD  
Nullah

橫堤西路  
橫堤東路

公庵路  
橋頭路

圖例 LEGEND



申請地點(界線只作識別用)  
APPLICATION SITE  
(BOUNDARY FOR IDENTIFICATION  
PURPOSE ONLY)

本摘要圖於2020年5月20日擬備，所根據的資料為地政總署於2019年9月29日拍得的航攝照片編號 E067315C  
EXTRACT PLAN PREPARED ON 20.5.2020  
BASED ON AERIAL PHOTO No.  
E067315C TAKEN ON 29.9.2019  
BY LANDS DEPARTMENT

航攝照片 AERIAL PHOTO

臨時汽車修理工場及露天存放廢金屬、建築機械及建築材料/回收物料連附屬工場及包裝活動(為期3年)  
元朗唐人新村丈量約份第119約及第121約多個地段和毗連政府土地  
TEMPORARY VEHICLE REPAIR WORKSHOP AND OPEN STORAGE OF SCRAP METAL, CONSTRUCTION MACHINERY AND BUILDING / RECYCLING MATERIALS WITH ANCILLARY WORKSHOP AND PACKAGING ACTIVITIES FOR A PERIOD OF 3 YEARS  
VARIOUS LOTS IN D.D.119 AND D.D.121 AND ADJOINING GOVERNMENT LAND, TONG YAN SAN TSUEN, YUEN LONG

規劃署  
PLANNING  
DEPARTMENT



參考編號  
REFERENCE No.  
A/YL-TYST/1008

圖 PLAN  
A-3



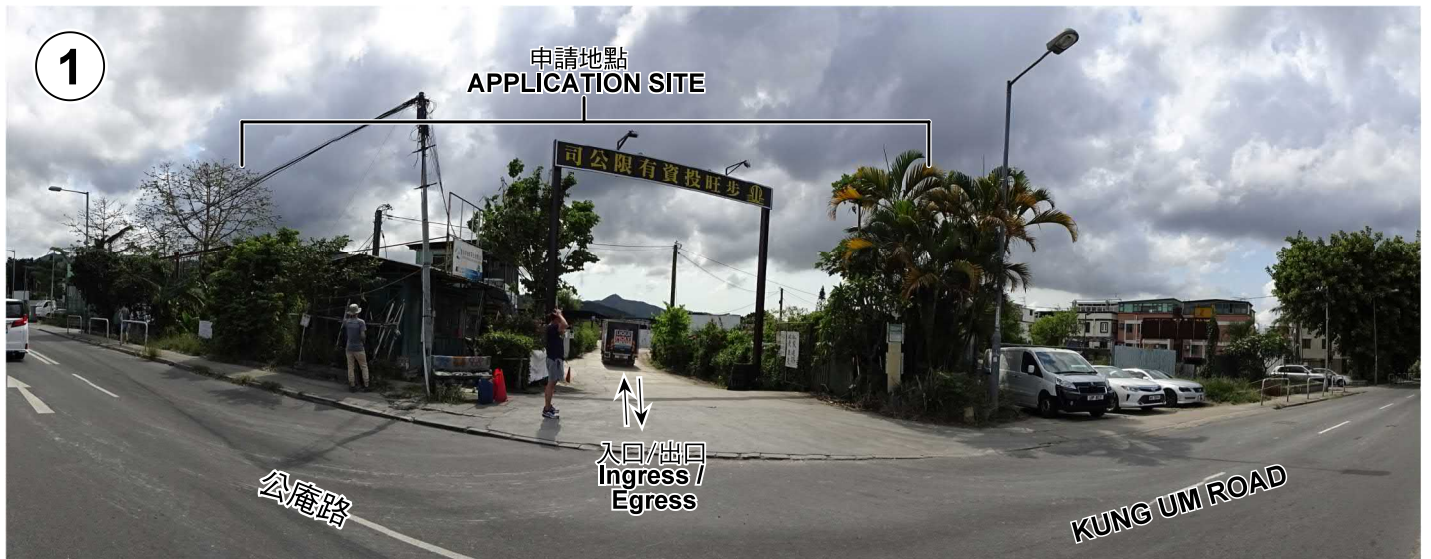

本圖於2020年5月20日擬備，所根據的資料為攝於2019年5月7日的實地照片  
 PLAN PREPARED ON 20.5.2020  
 BASED ON SITE PHOTOS  
 TAKEN ON 7.5.2020

**實地照片 SITE PHOTOS**

臨時汽車修理工場及露天存放廢金屬、建築機械及  
 建築材料/回收物料連附屬工場及包裝活動（為期3年）  
 元朗唐人新村丈量約份第119約及第121約多個地段和毗連政府土地  
 TEMPORARY VEHICLE REPAIR WORKSHOP AND  
 OPEN STORAGE OF SCRAP METAL, CONSTRUCTION MACHINERY AND  
 BUILDING / RECYCLING MATERIALS WITH ANCILLARY WORKSHOP AND  
 PACKAGING ACTIVITIES FOR A PERIOD OF 3 YEARS  
 VARIOUS LOTS IN D.D.119 AND D.D.121 AND  
 ADJOINING GOVERNMENT LAND, TONG YAN SAN TSUEN, YUEN LONG

規劃署  
**PLANNING  
 DEPARTMENT**



參考編號  
 REFERENCE No.  
**A/YL-TYST/1008**

圖 PLAN  
**A-4a**





本圖於2020年5月20日擬備，所根據的資料為攝於2019年5月7日的實地照片  
 PLAN PREPARED ON 20.5.2020  
 BASED ON SITE PHOTOS  
 TAKEN ON 7.5.2020

**實地照片 SITE PHOTOS**

臨時汽車修理工場及露天存放廢金屬、建築機械及  
 建築材料/回收物料連附屬工場及包裝活動（為期3年）  
 元朗唐人新村丈量約份第119約及第121約多個地段和毗連政府土地  
 TEMPORARY VEHICLE REPAIR WORKSHOP AND  
 OPEN STORAGE OF SCRAP METAL, CONSTRUCTION MACHINERY AND  
 BUILDING / RECYCLING MATERIALS WITH ANCILLARY WORKSHOP AND  
 PACKAGING ACTIVITIES FOR A PERIOD OF 3 YEARS  
 VARIOUS LOTS IN D.D.119 AND D.D.121 AND  
 ADJOINING GOVERNMENT LAND, TONG YAN SAN TSUEN, YUEN LONG

規劃署  
 PLANNING  
 DEPARTMENT



參考編號  
 REFERENCE No.  
 A/YL-TYST/1008

圖 PLAN  
 A-4b





本圖於2020年5月25日擬備，所根據的資料為攝於2019年5月7日的實地照片  
 PLAN PREPARED ON 25.5.2020  
 BASED ON SITE PHOTOS  
 TAKEN ON 7.5.2020

**實地照片 SITE PHOTOS**

臨時汽車修理工場及露天存放廢金屬、建築機械及  
 建築材料/回收物料連附屬工場及包裝活動（為期3年）  
 元朗唐人新村丈量約份第119約及第121約多個地段和毗連政府土地  
 TEMPORARY VEHICLE REPAIR WORKSHOP AND  
 OPEN STORAGE OF SCRAP METAL, CONSTRUCTION MACHINERY AND  
 BUILDING / RECYCLING MATERIALS WITH ANCILLARY WORKSHOP AND  
 PACKAGING ACTIVITIES FOR A PERIOD OF 3 YEARS  
 VARIOUS LOTS IN D.D.119 AND D.D.121 AND  
 ADJOINING GOVERNMENT LAND, TONG YAN SAN TSUEN, YUEN LONG

規劃署  
 PLANNING  
 DEPARTMENT



參考編號  
 REFERENCE No.  
 A/YL-TYST/1008

圖 PLAN  
 A-4c