

Application Site

<p>Project 項目名稱: Proposed Temporary Open Storage of Construction Machinery, Construction Material with Ancillary Repair Workshop & Office for a Period of 3 Years at Lots 2418(Part), 2420, 2421, 2740RP, 2741, 2742, 2744, 2745 S.A, 2745 S.B, 2746, 2747, 2748(Part) & Adjoining Government Land in D.D. 120, Tong Yan San Tsuen, Yuen Long, N.T.</p>	<p>Drawing Title 圖名: Location Plan</p>	<p>Remarks 備註: ●●● Vehicular Access Leading to Kung Um Road</p>
	<p>Drawing No. 圖號: Figure 2</p>	<p>Scale 比例: 1:7500</p>

(摘錄自申請人於 17. 4. 2020 呈交的申請書)
 (Extract from Applicant's Submission of 17.4.2020)

<p>參考編號 REFERENCE No. AYL-TYST/1016</p>	<p>繪圖 DRAWING A-1</p>
--	------------------------------------

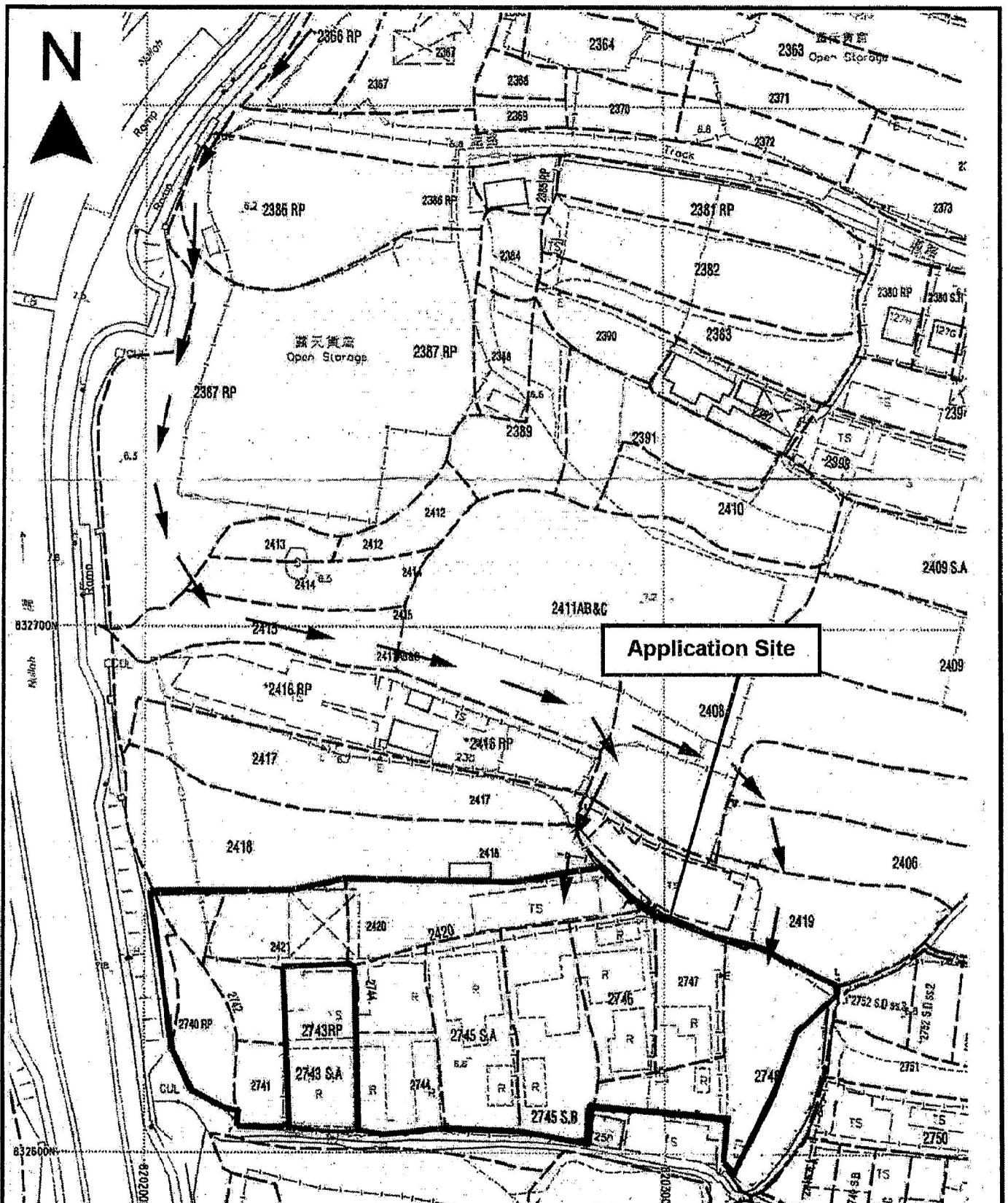



<p>Project 項目名稱: Proposed Temporary Open Storage of Construction Machinery, Construction Material with Ancillary Repair Workshop & Office for a Period of 3 Years at Lots 2418(Part), 2420, 2421, 2740RP, 2741, 2742, 2744, 2745 S.A, 2745 S.B, 2746, 2747, 2748(Part) & Adjoining Government Land in D.D. 120, Tong Yan San Tsuen, Yuen Long, N.T.</p>	<p>Drawing Title 圖目: Site Plan</p> <hr/> <p>Drawing No. 圖號: Figure 1</p>	<p>Remarks 備註: Vehicular Access Leading to Kung Um Road</p> <hr/> <p>Scale 比例: 1:1000</p>
--	--	---

(摘錄自申請人於 17. 4. 2020 呈交的申請書)
 (Extract from Applicant's Submission of 17.4.2020)

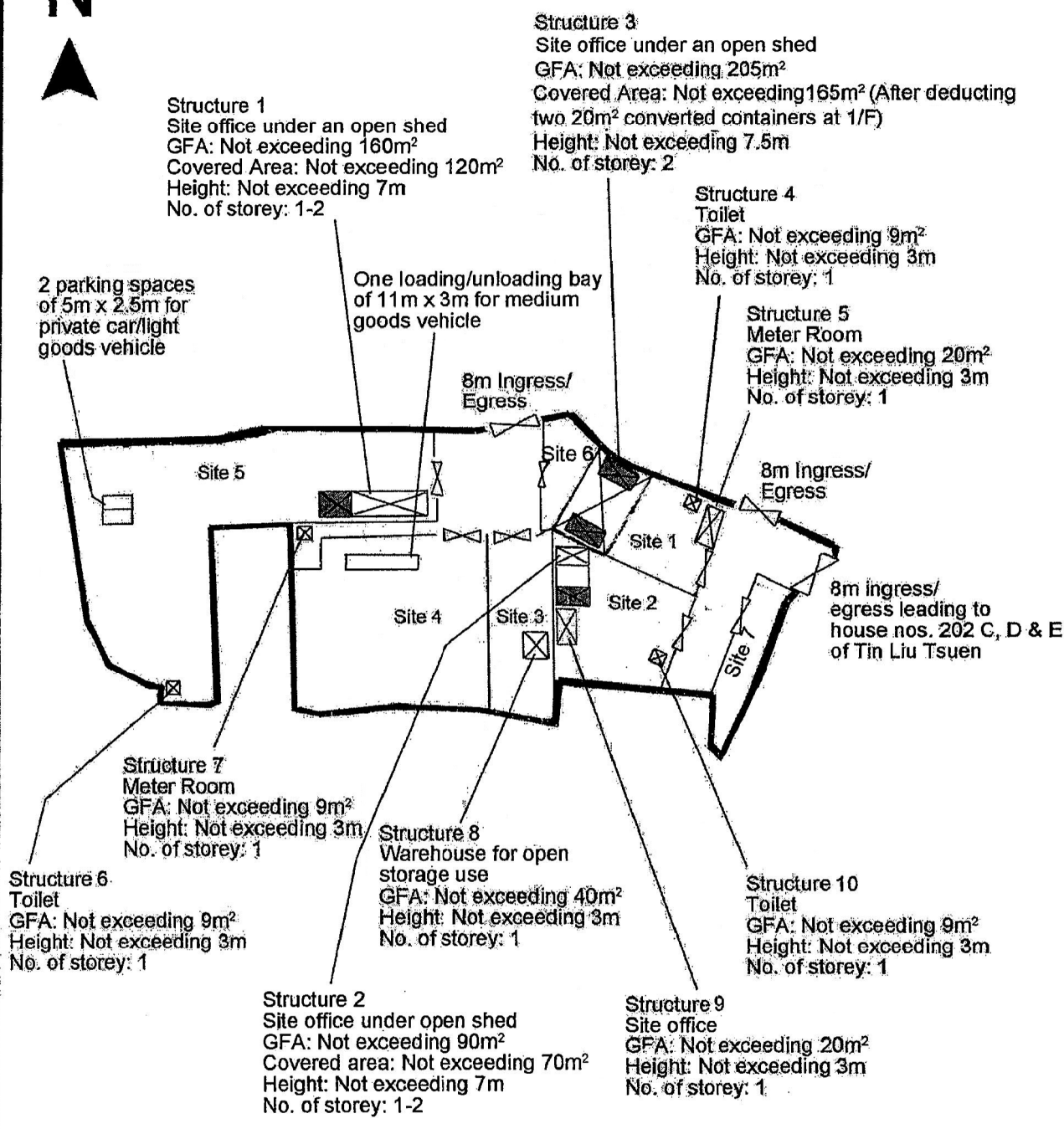
參考編號 REFERENCE No. AYL-TYST/1016	繪圖 DRAWING A-2
---	--------------------------



Site 1: Open storage of construction machinery, construction material and ancillary repair workshop
 Sites 2, 3, 4, 5, 6 & 7: Open storage of construction machinery and construction material



<p>Project 項目名稱: Proposed Temporary Open Storage of Construction Machinery, Construction Material with Ancillary Repair Workshop & Office for a Period of 3 Years at Lots 2418(Part), 2420, 2421, 2740RP, 2741, 2742, 2744, 2745 S.A, 2745 S.B, 2746, 2747, 2748(Part) & Adjoining Government Land in D.D. 120, Tong Yan San Tsuen, Yuen Long, N.T.</p>	<p>Drawing Title 圖名: Proposed Layout Plan</p> <p>Drawing No. 圖號: Figure 3</p>	<p>Remarks 備註:  1-storey structure  2-storeys structure</p> <p>Scale 比例: 1:1000</p>
---	---	---

(摘錄自申請人於 17. 4. 2020 呈交的申請書)
 (Extract from Applicant's Submission of 17.4.2020)

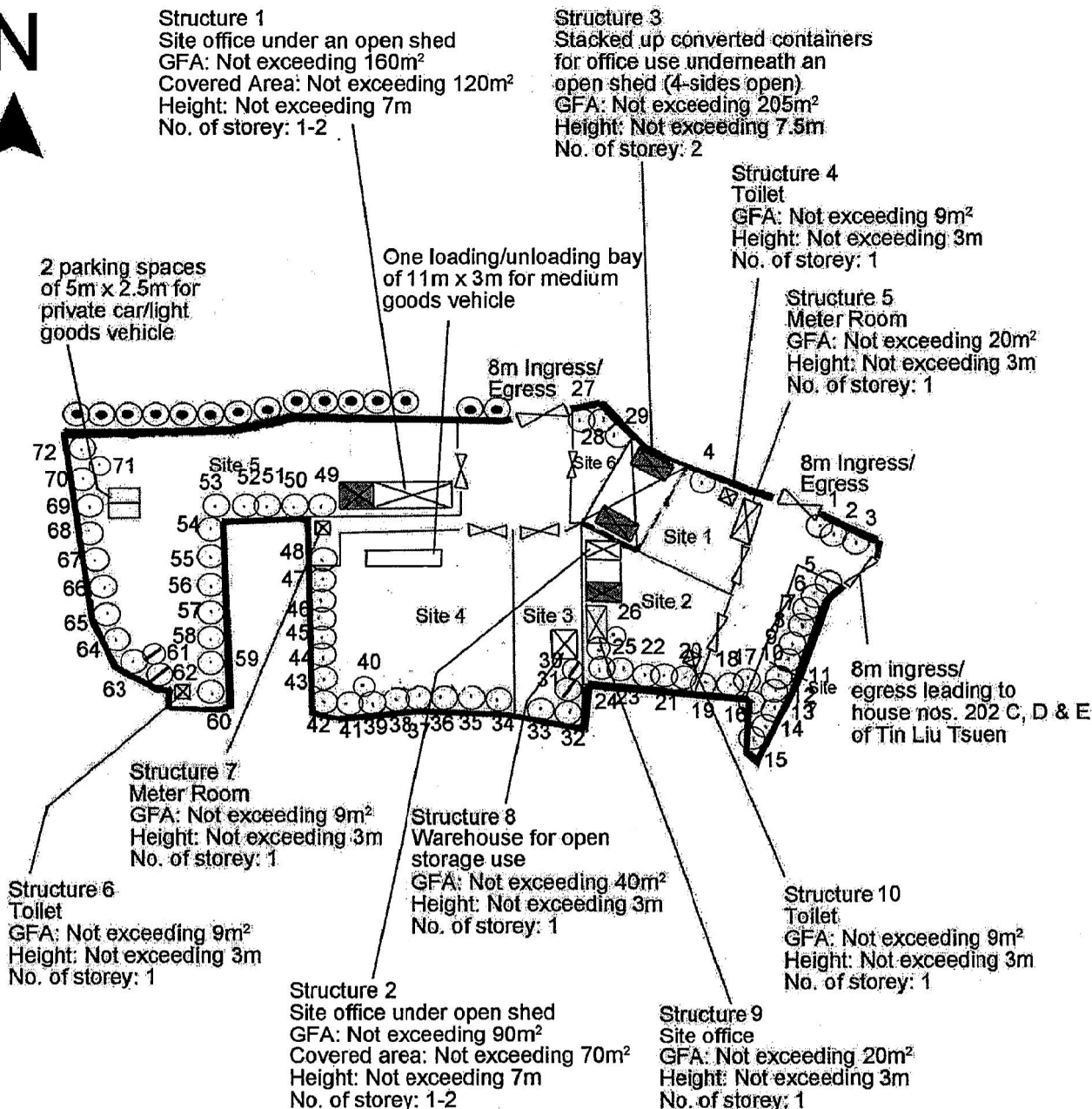
<p>參考編號 REFERENCE No. AYL-TYST/1016</p>	<p>繪圖 DRAWING A-3</p>
--	-----------------------------------

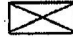

Tree	Approximate Height	Spacing	Quantity
Existing Trees to be preserved	3m to 6m	3m	72
Existing trees along the common boundary of adjoining open storage yard (TPB Ref. A/YL-TYST/882)	3.5m to 5m	3m	15

Project 項目名稱: Proposed Temporary Open Storage of Construction Machinery, Construction Material with Ancillary Repair Workshop & Office for a Period of 3 Years at Lots 2418(Part), 2420, 2421, 2740RP, 2741, 2742, 2744, 2745 S.A, 2745 S.B, 2746, 2747, 2748(Part) & Adjoining Government Land in D.D. 120, Tong Yan San Tsuen, Yuen Long, N.T.	Drawing Title 圖目: Proposed Landscape & Tree Preservation Plan	Remarks 備註:  1-storey structure  2-storeys structure
	Drawing No. 圖號: Figure 4	

(摘錄自申請人於 17. 4. 2020 呈交的申請書)
 (Extract from Applicant's Submission of 17.4.2020)

參考編號 REFERENCE No. A/YL-TYST/1016	繪圖 DRAWING A-4
--	--------------------------

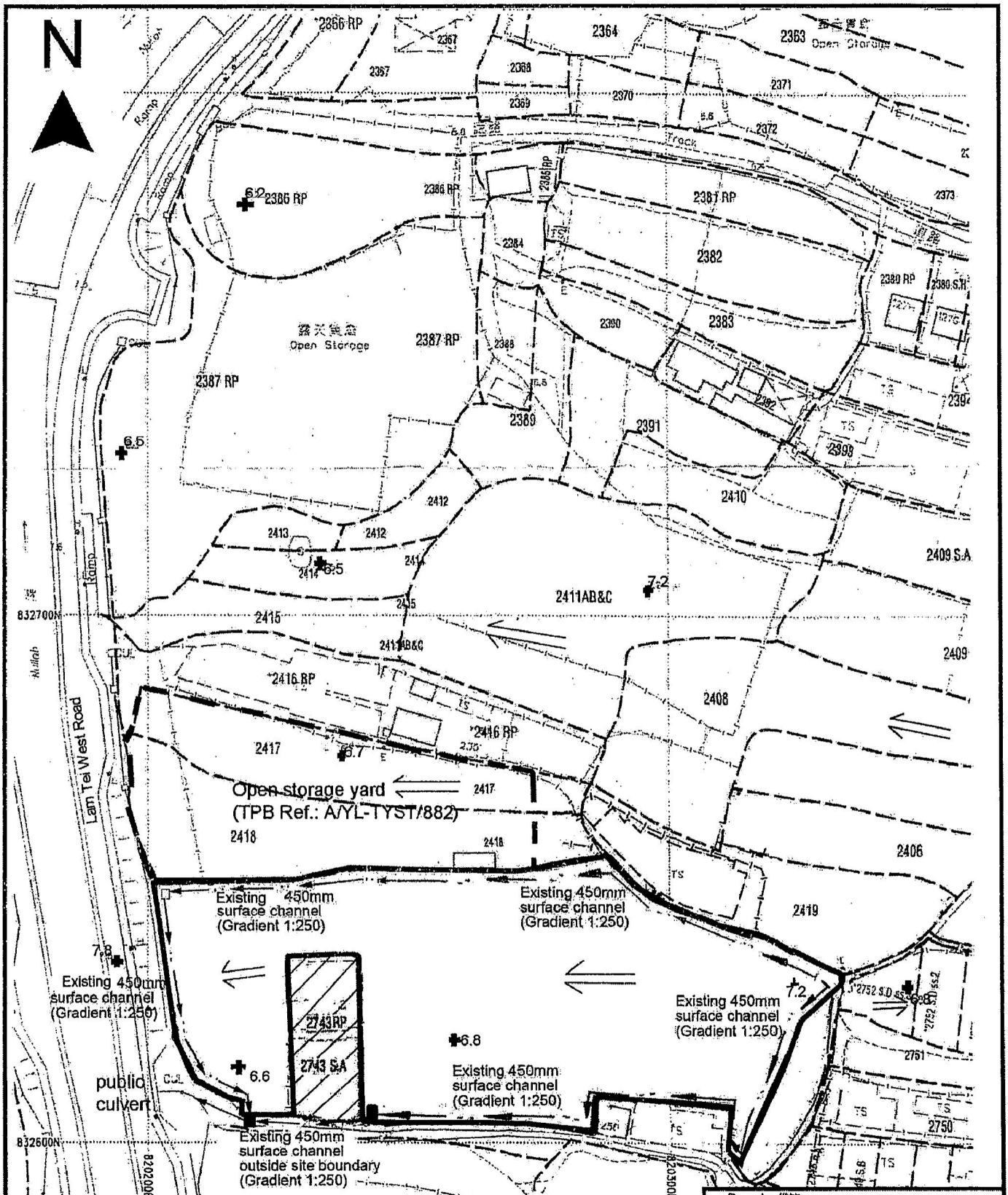

Project 項目名稱:
Proposed Temporary Open Storage of Construction Machinery, Construction Material with Ancillary Repair Workshop & Office for a Period of 3 Years at Lots 2418(Part), 2420, 2421, 2740RP, 2741, 2742, 2744, 2745 S.A, 2745 S.B, 2746, 2747, 2748(Part) & Adjoining Government Land in D.D. 120, Tong Yan San Tsuen, Yuen Long, N.T.

Drawing Title 圖目:
As-built Drainage Plan

Drawing No. 圖號:
Figure 5

- Remarks 備註:
- Existing catchpit
 - ← Existing 450mm surface channel
 - ⇐ Flow of surface runoff
 - Application site
 - ▨ External catchment

Scale 比例:
1:1000

(摘錄自申請人於 17. 4. 2020 呈交的申請書)
 (Extract from Applicant's Submission of 17.4.2020)

參考編號 REFERENCE No. AYL-TYST/1016	繪圖 DRAWING A-5
---	--------------------------

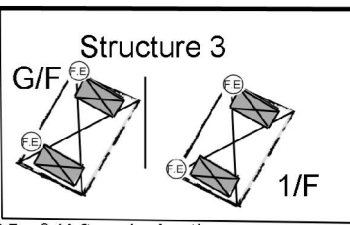
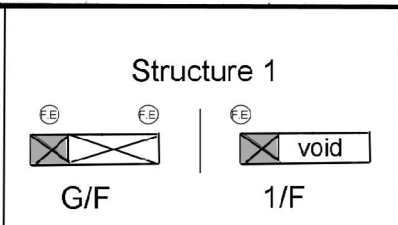

Structure 1
 Site office under an open shed
 GFA: Not exceeding 160m²
 Covered Area: Not exceeding 120m²
 Height: Not exceeding 7m
 No. of storey: 1-2

Structure 3
 Site office under an open shed
 GFA: Not exceeding 205m²
 Covered Area: Not exceeding 165m² (After deducting two 20m² converted containers at 1/F)
 Height: Not exceeding 7.5m
 No. of storey: 2

Structure 4
 Toilet
 GFA: Not exceeding 9m²
 Height: Not exceeding 3m
 No. of storey: 1

Structure 5
 Meter Room
 GFA: Not exceeding 20m²
 Height: Not exceeding 3m
 No. of storey: 1

2 parking spaces of 5m x 2.5m for private car/light goods vehicle

One loading/unloading bay of 11m x 3m for medium goods vehicle

8m Ingress/Egress

8m Ingress/Egress

8m ingress/egress leading to house nos. 202 C, D & E of Tin Liu Tsuen

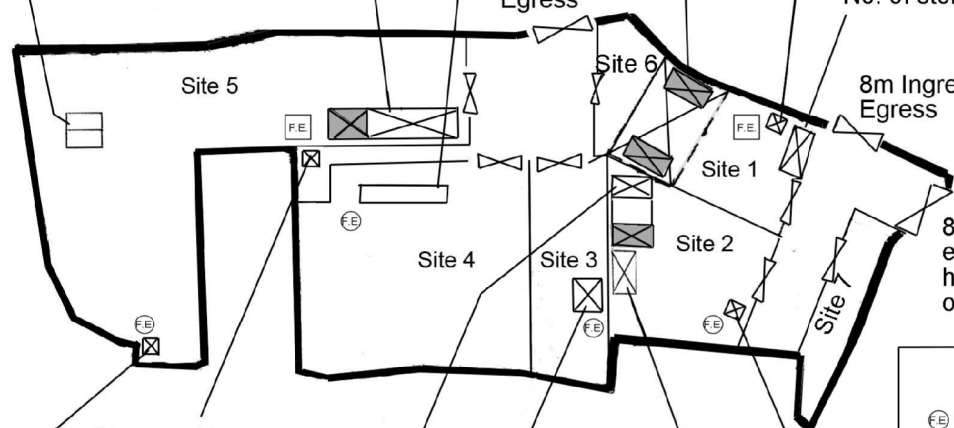

Structure 7
 Meter Room
 GFA: Not exceeding 9m²
 Height: Not exceeding 3m
 No. of storey: 1

Structure 8
 Warehouse for open storage use
 GFA: Not exceeding 40m²
 Height: Not exceeding 3m
 No. of storey: 1

Structure 6
 Toilet
 GFA: Not exceeding 9m²
 Height: Not exceeding 3m
 No. of storey: 1

Structure 10
 Toilet
 GFA: Not exceeding 9m²
 Height: Not exceeding 3m
 No. of storey: 1

Structure 2
 Site office under open shed
 GFA: Not exceeding 90m²
 Covered area: Not exceeding 70m²
 Height: Not exceeding 7m
 No. of storey: 1-2

Structure 9
 Site office
 GFA: Not exceeding 20m²
 Height: Not exceeding 3m
 No. of storey: 1

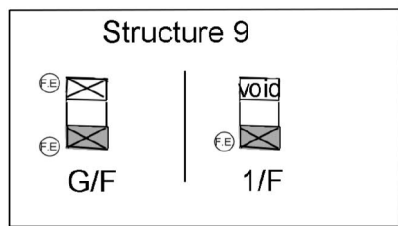

Site 1: Open storage of construction machinery, construction material and ancillary repair workshop
 Sites 2, 3, 4, 5, 6 & 7: Open storage of construction machinery and construction material

<p>Project 項目名稱: Proposed Temporary Open Storage of Construction Machinery, Construction Material with Ancillary Repair Workshop & Office for a Period of 3 Years at Lots 2418(Part), 2420, 2421, 2740RP, 2741, 2742, 2744, 2745 S.A, 2745 S.B, 2746, 2747, 2748(Part) & Adjoining Government Land in D.D. 120, Tong Yan San Tsuen, Yuen Long, N.T.</p>	<p>Drawing Title 圖目: Proposed Fire Service Installations Plan</p> <p>Drawing No. 圖號: Figure 1</p>	<p>Remarks 備註: 1-storey structure 2-storeys structure 9 litre water type fire extinguisher 5kg carbon dioxide fire extinguisher</p> <p>Scale 比例: 1:1000</p>
---	---	---

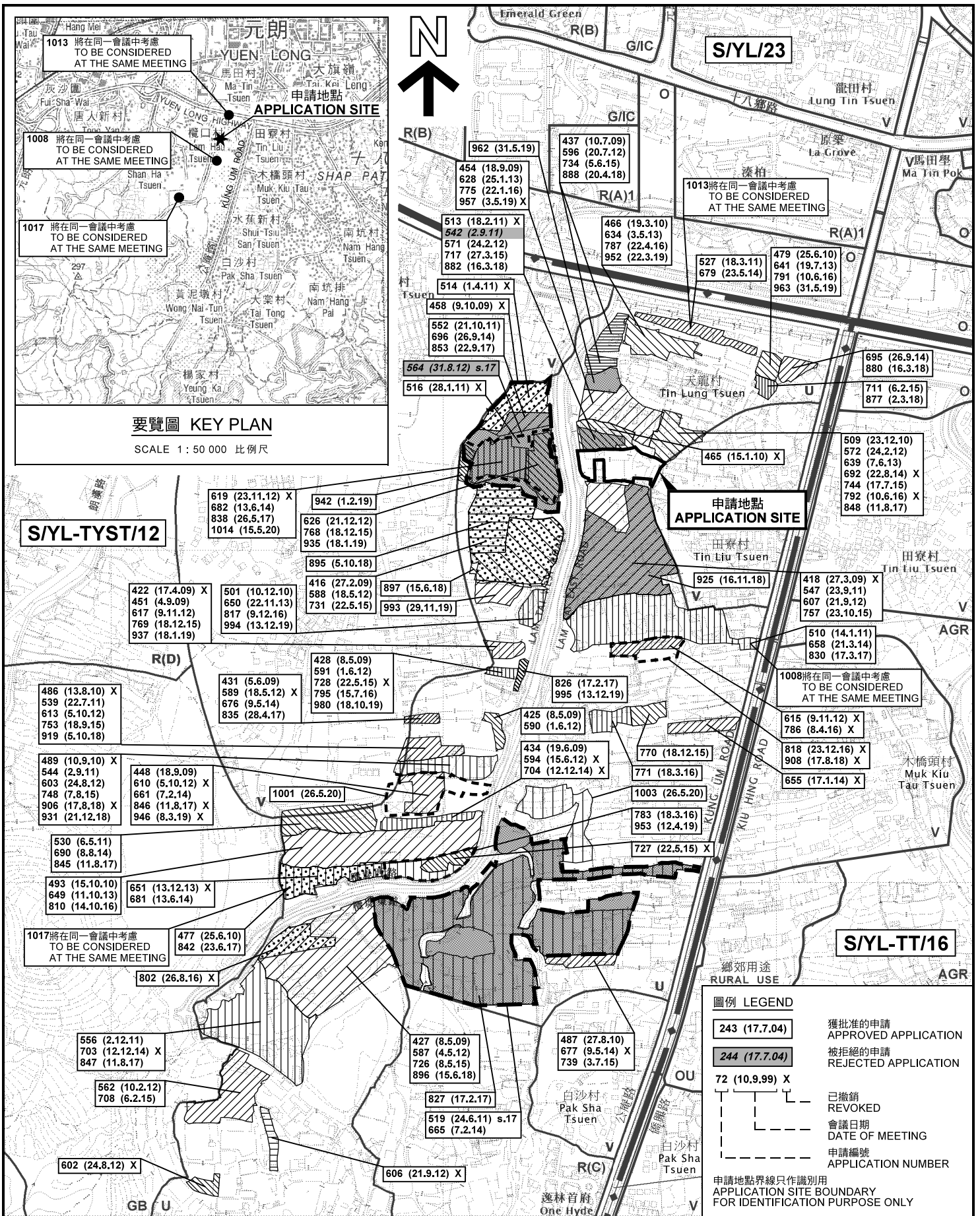

要覽圖 KEY PLAN

SCALE 1 : 50 000 比例尺

位置圖及同類申請 LOCATION PLAN WITH SIMILAR APPLICATIONS

本摘要圖於2020年6月3日擬備，所根據的資料為於2018年9月4日核准的分區計劃大綱圖編號 S/YL-TYST/12 EXTRACT PLAN PREPARED ON 3.6.2020 BASED ON OUTLINE ZONING PLAN No. S/YL-TYST/12 APPROVED ON 4.9.2018

臨時露天存放建築機械及建築材料
連附屬維修工場及辦公室的規劃許可續期(為期3年)
元朗唐人新村丈量約份第120約地段第2418號(部分)、第2420號、第2421號、第2740號餘段、第2741號、第2742號、第2744號、第2745號A分段、第2745號B分段、第2746號、第2747號及第2748號(部分)和毗連政府土地
RENEWAL OF PLANNING APPROVAL FOR TEMPORARY OPEN STORAGE OF CONSTRUCTION MACHINERY AND CONSTRUCTION MATERIAL WITH ANCILLARY REPAIR WORKSHOP AND OFFICE FOR A PERIOD OF 3 YEARS
LOTS 2418 (PART), 2420, 2421, 2740 RP, 2741, 2742, 2744, 2745 S.A, 2745 S.B, 2746, 2747 AND 2748 (PART) IN D.D.120 AND ADJOINING GOVERNMENT LAND, TONG YAN SAN TSUEN, YUEN LONG
SCALE 1 : 7 500 比例尺

米 100 0 100 200 300 米
METRES METRES

圖例 LEGEND

- 243 (17.7.04) 獲批准的申請 APPROVED APPLICATION
- 244 (17.7.04) 被拒絕的申請 REJECTED APPLICATION
- 72 (10.9.99) X 已撤銷 REVOKED
- 會議日期 DATE OF MEETING
- 申請編號 APPLICATION NUMBER

申請地點界線只作識別用
APPLICATION SITE BOUNDARY FOR IDENTIFICATION PURPOSE ONLY

**規劃署
PLANNING
DEPARTMENT**



參考編號
REFERENCE No.

A/YL-TYST/1016

圖 PLAN

A-1a



先前申請
PREVIOUS APPLICATION
440 (7.8.09)

先前申請
PREVIOUS APPLICATION
616 (9.11.12)

申請地點
APPLICATION SITE

先前申請
PREVIOUS APPLICATIONS
686 (27.6.14)
840 (23.6.17)

圖例 LEGEND

243 (17.7.04)

獲批准的申請
APPROVED APPLICATION

72 (10.9.99)

會議日期
DATE OF MEETING

申請編號
APPLICATION NUMBER

申請地點界線只作識別用
APPLICATION SITE BOUNDARY
FOR IDENTIFICATION PURPOSE ONLY

田寮村
Tin Liu Tsuen

先前申請圖 PREVIOUS APPLICATIONS PLAN

臨時露天存放建築機械及建築材料
連附屬維修工場及辦公室的規劃許可續期 (為期3年)
元朗唐人新村丈量約份第120約地段第2418號(部分)、第2420號、
第2421號、第2740號餘段、第2741號、第2742號、第2744號、第2745號A分段、
第2745號B分段、第2746號、第2747號及第2748號(部分)和毗連政府土地
RENEWAL OF PLANNING APPROVAL FOR TEMPORARY OPEN STORAGE OF
CONSTRUCTION MACHINERY AND CONSTRUCTION MATERIAL WITH
ANCILLARY REPAIR WORKSHOP AND OFFICE FOR A PERIOD OF 3 YEARS
LOTS 2418 (PART), 2420, 2421, 2740 RP, 2741, 2742, 2744, 2745 S.A,
2745 S.B, 2746, 2747 AND 2748 (PART) IN D.D.120 AND
ADJOINING GOVERNMENT LAND, TONG YAN SAN TSUEN, YUEN LONG
SCALE 1 : 1 000 比例尺

米 METRES 20 0 20 40 米 METRES

本摘要圖於2020年5月26日擬備，所根據的資料為測量圖編號 6-NW-14C 及 6-NW-14D
EXTRACT PLAN PREPARED ON 26.5.2020
BASED ON SURVEY SHEETS No.
6-NW-14C & 6-NW-14D

規劃署
PLANNING
DEPARTMENT



參考編號
REFERENCE No.

A/YL-TYST/1016

圖 PLAN

A-1b

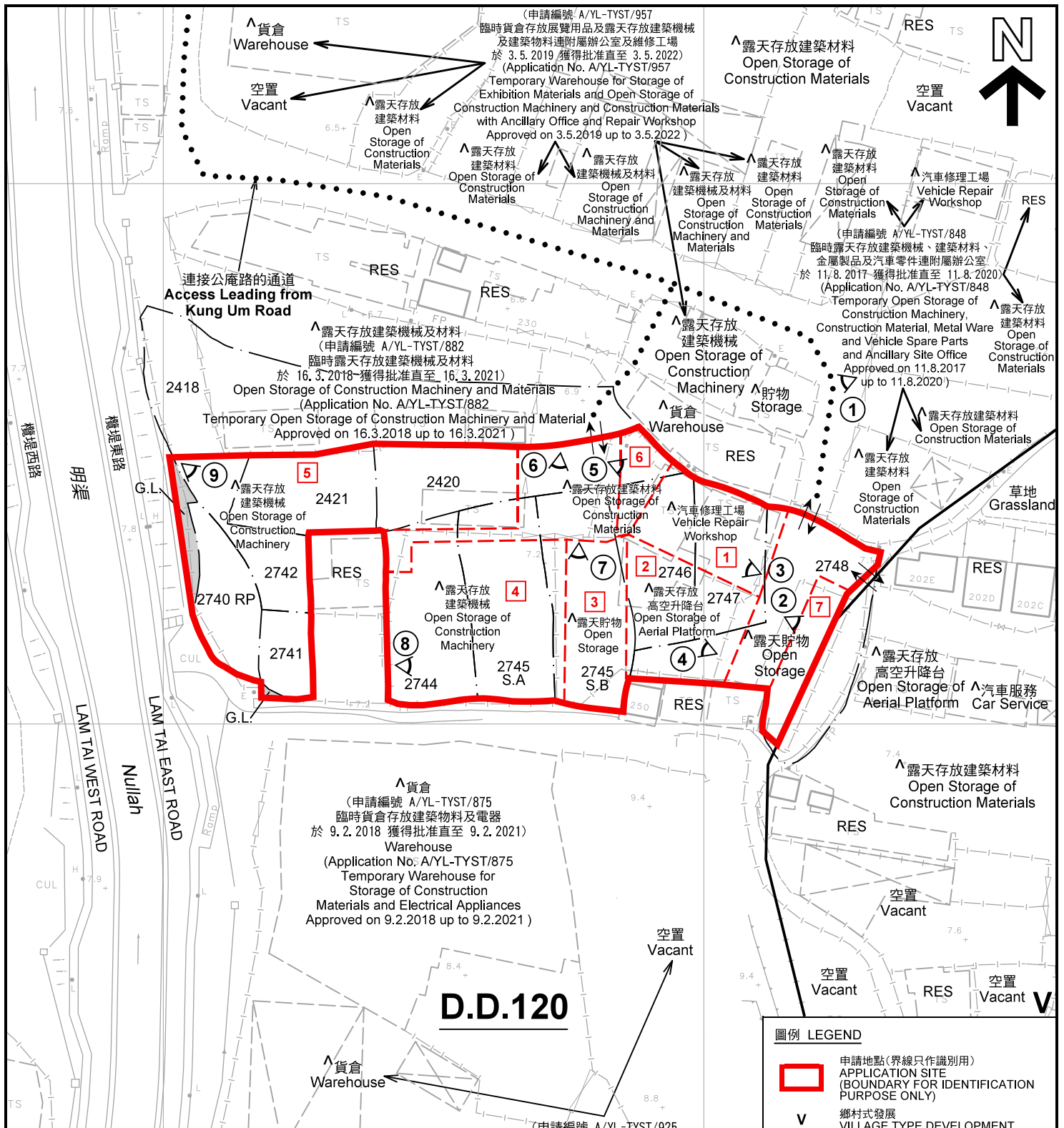

註釋 Notes:

- (1) 2020年5月20日勘測的土地用途
Land uses shown on this plan are in accordance with the land use survey conducted by the Planning Department on 20.5.2020
- (2) * 土地用途跟1993年6月21日勘測的土地用途一致
Indicates that the use is the same as that revealed by the land use survey conducted by the Planning Department on 21.6.1993
- (3) ^ 土地用途跟1993年6月21日勘測的土地用途有別
Indicates that the use is different from that revealed by the land use survey conducted by the Planning Department on 21.6.1993

(申請編號 A/YL-TYST/925)
臨時露天存放建築材料及回收物料、
建築機械和舊電器/電子產品連附屬包裝工序
於 16.11.2018 獲得批准直至 16.11.2021)
(Application No. A/YL-TYST/925
Temporary Open Storage of
Building and Recycling Materials,
Construction Machinery and Used
Electrical/Electronic Appliances
with Ancillary Packaging Activities
Approved on 16.11.2018 up to 16.11.2021)

圖例 LEGEND

- 申請地點(界線只作識別用)
APPLICATION SITE
(BOUNDARY FOR IDENTIFICATION
PURPOSE ONLY)
- V 鄉村式發展
VILLAGE TYPE DEVELOPMENT
- U 未決定用途
UNDETERMINED
- G.L. 政府土地
GOVERNMENT LAND
- RES 住用構築物
RESIDENTIAL STRUCTURES
- ① 實地照片的觀景點
VIEWING POINT OF SITE PHOTO
- ↔ 入口/出口
INGRESS / EGRESS
- 1 場區編號
COMPARTMENT No.

平面圖 SITE PLAN

臨時露天存放建築機械及建築材料
連附屬維修工場及辦公室的規劃許可(為期3年)
元朗唐人新村丈量約份第120約地段第2418號(部分)、第2420號、
第2421號、第2740號餘段、第2741號、第2742號、第2744號、第2745號A分段、
第2745號B分段、第2746號、第2747號及第2748號(部分)和毗連政府土地
RENEWAL OF PLANNING APPROVAL FOR TEMPORARY OPEN STORAGE OF
CONSTRUCTION MACHINERY AND CONSTRUCTION MATERIAL WITH
ANCILLARY REPAIR WORKSHOP AND OFFICE FOR A PERIOD OF 3 YEARS
LOTS 2418 (PART), 2420, 2421, 2740 RP, 2741, 2742, 2744, 2745 S.A,
2745 S.B, 2746, 2747 AND 2748 (PART) IN D.D.120 AND
ADJOINING GOVERNMENT LAND, TONG YAN SAN TSUEN, YUEN LONG
SCALE 1 : 1 000 比例尺

本摘要圖於2020年6月2日擬備，所根據的資料為測量圖編號 6-NW-14C 及 6-NW-14D
EXTRACT PLAN PREPARED ON 2.6.2020
BASED ON SURVEY SHEETS No.
6-NW-14C & 6-NW-14D

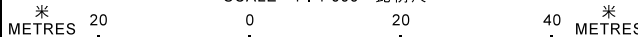

**規劃署
PLANNING
DEPARTMENT**



參考編號
REFERENCE No.

A/YL-TYST/1016

圖 PLAN

A-2

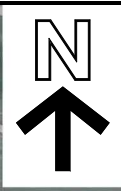

連接公庵路的通道
Access Leading from
Kung Um Road

天龍村
Tin Lung Tsuen

田寮村
Tin Liu Tsuen

圖例 LEGEND

 申請地點(界線只作識別用)
APPLICATION SITE
(BOUNDARY FOR IDENTIFICATION
PURPOSE ONLY)

本摘要圖於2020年5月27日擬備，所根據的資料為地政總署於2019年9月29日拍得的航攝照片編號 E067315C
EXTRACT PLAN PREPARED ON 27.5.2020
BASED ON AERIAL PHOTO No.
E067315C TAKEN ON 29.9.2019
BY LANDS DEPARTMENT

航攝照片 AERIAL PHOTO

臨時露天存放建築機械及建築材料
連附屬維修工場及辦公室的規劃許可續期(為期3年)
元朗唐人新村丈量約份第120約地段第2418號(部分)、第2420號、
第2421號、第2740號餘段、第2741號、第2742號、第2744號、第2745號A分段、
第2745號B分段、第2746號、第2747號及第2748號(部分)和毗連政府土地
RENEWAL OF PLANNING APPROVAL FOR TEMPORARY OPEN STORAGE OF
CONSTRUCTION MACHINERY AND CONSTRUCTION MATERIAL WITH
ANCILLARY REPAIR WORKSHOP AND OFFICE FOR A PERIOD OF 3 YEARS
LOTS 2418 (PART), 2420, 2421, 2740 RP, 2741, 2742, 2744, 2745 S.A,
2745 S.B, 2746, 2747 AND 2748 (PART) IN D.D.120 AND
ADJOINING GOVERNMENT LAND, TONG YAN SAN TSUEN, YUEN LONG

規劃署
PLANNING
DEPARTMENT



參考編號
REFERENCE No.
A/YL-TYST/1016

圖 PLAN
A-3



1

申請地點
APPLICATION SITE

連接公庵路的通道
Access Leading from
Kung Um Road



2

申請地點
(場區編號 7)
APPLICATION SITE
(Compartment No. 7)



3

申請地點
(場區編號 1)
APPLICATION SITE
(Compartment No. 1)

實地照片 SITE PHOTOS

本圖於2020年5月27日擬備，所根據的資料為攝於2020年5月20日的實地照片
PLAN PREPARED ON 27.5.2020
BASED ON SITE PHOTOS
TAKEN ON 20.5.2020

臨時露天存放建築機械及建築材料
連附屬維修工場及辦公室的規劃許可續期 (為期3年)
元朗唐人新村丈量約份第120約地段第2418號(部分)、第2420號、
第2421號、第2740號餘段、第2741號、第2742號、第2744號、第2745號A分段、
第2745號B分段、第2746號、第2747號及第2748號(部分)和毗連政府土地
RENEWAL OF PLANNING APPROVAL FOR TEMPORARY OPEN STORAGE OF
CONSTRUCTION MACHINERY AND CONSTRUCTION MATERIAL WITH
ANCILLARY REPAIR WORKSHOP AND OFFICE FOR A PERIOD OF 3 YEARS
LOTS 2418 (PART), 2420, 2421, 2740 RP, 2741, 2742, 2744, 2745 S.A,
2745 S.B, 2746, 2747 AND 2748 (PART) IN D.D.120 AND
ADJOINING GOVERNMENT LAND, TONG YAN SAN TSUEN, YUEN LONG

規劃署
PLANNING
DEPARTMENT



參考編號
REFERENCE No.
A/YL-TYST/1016

圖 PLAN
A-4a



4

申請地點
(場區編號 2)
APPLICATION SITE
(Compartment No. 2)



5

申請地點
(場區編號 6)
APPLICATION SITE
(Compartment No. 6)



6

申請地點
APPLICATION SITE

實地照片 SITE PHOTOS

臨時露天存放建築機械及建築材料
連附屬維修工場及辦公室的規劃許可續期 (為期3年)
元朗唐人新村丈量約份第120約地段第2418號(部分)、第2420號、
第2421號、第2740號餘段、第2741號、第2742號、第2744號、第2745號A分段、
第2745號B分段、第2746號、第2747號及第2748號(部分)和毗連政府土地
RENEWAL OF PLANNING APPROVAL FOR TEMPORARY OPEN STORAGE OF
CONSTRUCTION MACHINERY AND CONSTRUCTION MATERIAL WITH
ANCILLARY REPAIR WORKSHOP AND OFFICE FOR A PERIOD OF 3 YEARS
LOTS 2418 (PART), 2420, 2421, 2740 RP, 2741, 2742, 2744, 2745 S.A,
2745 S.B, 2746, 2747 AND 2748 (PART) IN D.D.120 AND
ADJOINING GOVERNMENT LAND, TONG YAN SAN TSUEN, YUEN LONG

本圖於2020年5月27日擬備，所根據的資料為攝於2020年5月20日的實地照片
PLAN PREPARED ON 27.5.2020
BASED ON SITE PHOTOS
TAKEN ON 20.5.2020

規劃署
PLANNING
DEPARTMENT



參考編號
REFERENCE No.
A/YL-TYST/1016

圖 PLAN
A-4b



申請地點
(場區編號 3)
APPLICATION SITE
(Compartment No. 3)



申請地點
(場區編號 4)
APPLICATION SITE
(Compartment No. 4)



申請地點
(場區編號 5)
APPLICATION SITE
(Compartment No. 5)

實地照片 SITE PHOTOS

臨時露天存放建築機械及建築材料
連附屬維修工場及辦公室的規劃許可續期 (為期3年)
元朗唐人新村丈量約份第120約地段第2418號(部分)、第2420號、
第2421號、第2740號餘段、第2741號、第2742號、第2744號、第2745號A分段、
第2745號B分段、第2746號、第2747號及第2748號(部分)和毗連政府土地
RENEWAL OF PLANNING APPROVAL FOR TEMPORARY OPEN STORAGE OF
CONSTRUCTION MACHINERY AND CONSTRUCTION MATERIAL WITH
ANCILLARY REPAIR WORKSHOP AND OFFICE FOR A PERIOD OF 3 YEARS
LOTS 2418 (PART), 2420, 2421, 2740 RP, 2741, 2742, 2744, 2745 S.A,
2745 S.B, 2746, 2747 AND 2748 (PART) IN D.D.120 AND
ADJOINING GOVERNMENT LAND, TONG YAN SAN TSUEN, YUEN LONG

規劃署
**PLANNING
DEPARTMENT**



本圖於2020年5月27日擬備，所根據的資料為攝於2020年5月20日的實地照片
PLAN PREPARED ON 27.5.2020
BASED ON SITE PHOTOS
TAKEN ON 20.5.2020

參考編號
REFERENCE No.
A/YL-TYST/1016

圖 PLAN
A-4c