

<p>Project 項目名稱: Proposed Temporary Warehouse for Storage of Home Appliance and Furniture for a Period of 3 Years at Lots 1937 (Part), 1945 (Part), 1946 (Part), 1947 (Part), 1948, 1954 (Part), 1955, 1956 (Part), 1957 (Part) in D.D.117 & Adjoining Government Land, Yuen Long, N.T.</p>	<p>Drawing Title 圖目: Location Plan</p>	<p>Remarks 備註: ●●● Vehicular Access Leading to Kung Um Road</p>
	<p>Drawing No. 圖號: Figure 2</p>	<p>Scale 比例: 1:7500</p>

(摘錄自申請人於 24.6.2020 呈交的申請書)
 (Extract from Applicant's Submission of 24.6.2020)

<p>參考編號 REFERENCE No. A/YL-TYST/1041</p>	<p>繪圖 DRAWING A-1</p>
--	------------------------------------

N

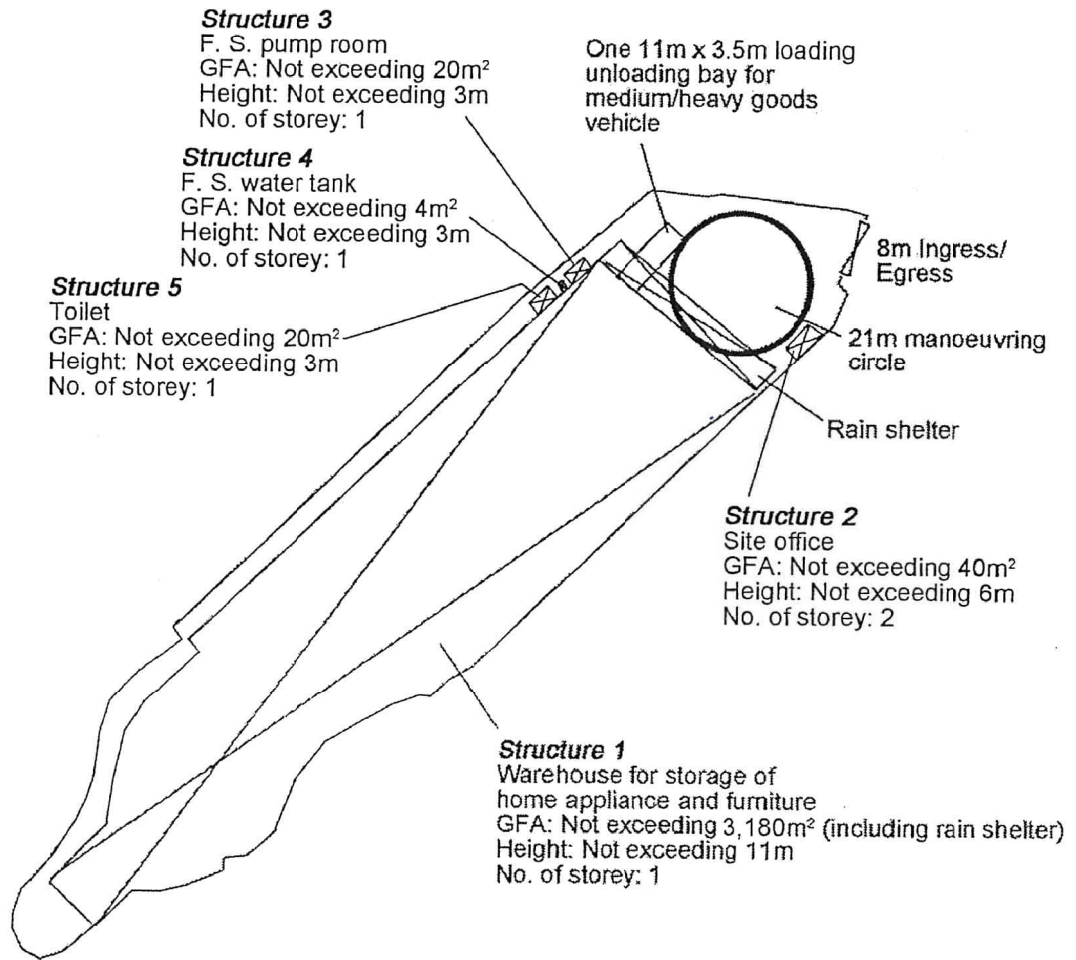

Project 項目名稱: Proposed Temporary Warehouse for Storage of Home Appliance and Furniture for a Period of 3 Years at Lots 1937 (Part), 1945 (Part), 1946 (Part), 1947 (Part), 1948, 1954 (Part), 1955, 1956 (Part), 1957 (Part) in D.D.117 & Adjoining Government Land, Yuen Long, N.T.	Drawing Title 圖名: Proposed Layout Plan	Remarks 備註:
	Drawing No. 圖號: Figure 3	Scale 比例: 1:1000

(摘錄自申請人於 24. 6. 2020 提交的申請書)
(Extract from Applicant's Submission of 24.6.2020)

參考編號 REFERENCE No. A/YL-TYST/1041	繪圖 DRAWING A-2
---	-------------------

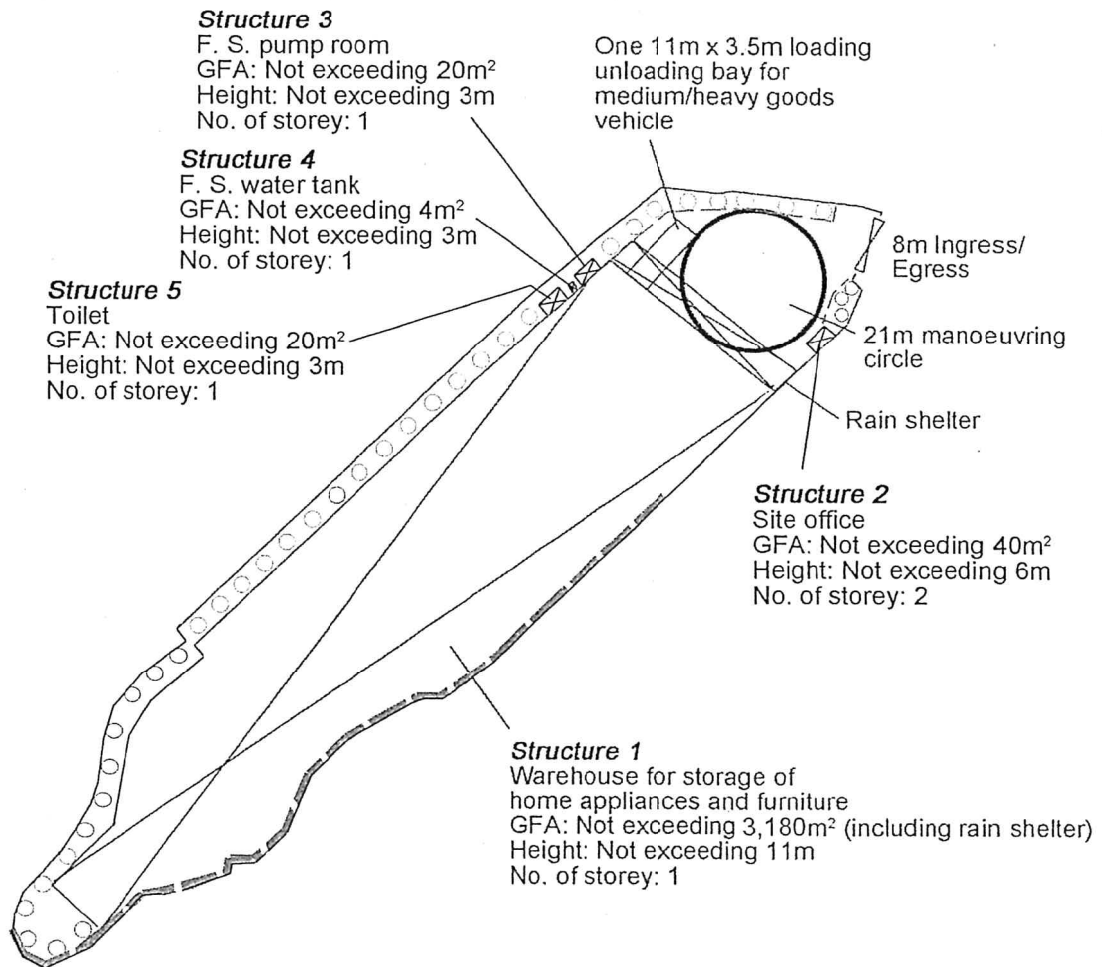

Tree	Approximate Height	Spacing
○ Proposed <i>Bauhinia blakeana</i>	2.75m	4m
□ Proposed <i>Pyrostegia ignea</i>	300mm	1,500mm

Project 項目名稱: Proposed Temporary Warehouse for Storage of Home Appliance and Furniture for a Period of 3 Years at Lots 1937 (Part), 1945 (Part), 1946 (Part), 1947 (Part), 1948, 1954 (Part), 1955, 1956 (Part), 1957 (Part) in D.D.117 & Adjoining Government Land, Yuen Long, N.T.	Drawing Title 圖名: Proposed Landscape & Tree Preservation Plan	Remarks 備註: — Proposed kerb at a minimum 1m away from the proposed trees
	Drawing No. 圖號: Figure 4	Scale 比例: 1:1000

(摘錄自申請人於 24. 6. 2020 提交的申請書)
(Extract from Applicant's Submission of 24.6.2020)

參考編號 REFERENCE No. AYL-TYST/1041	繪圖 DRAWING A-3
--	-------------------

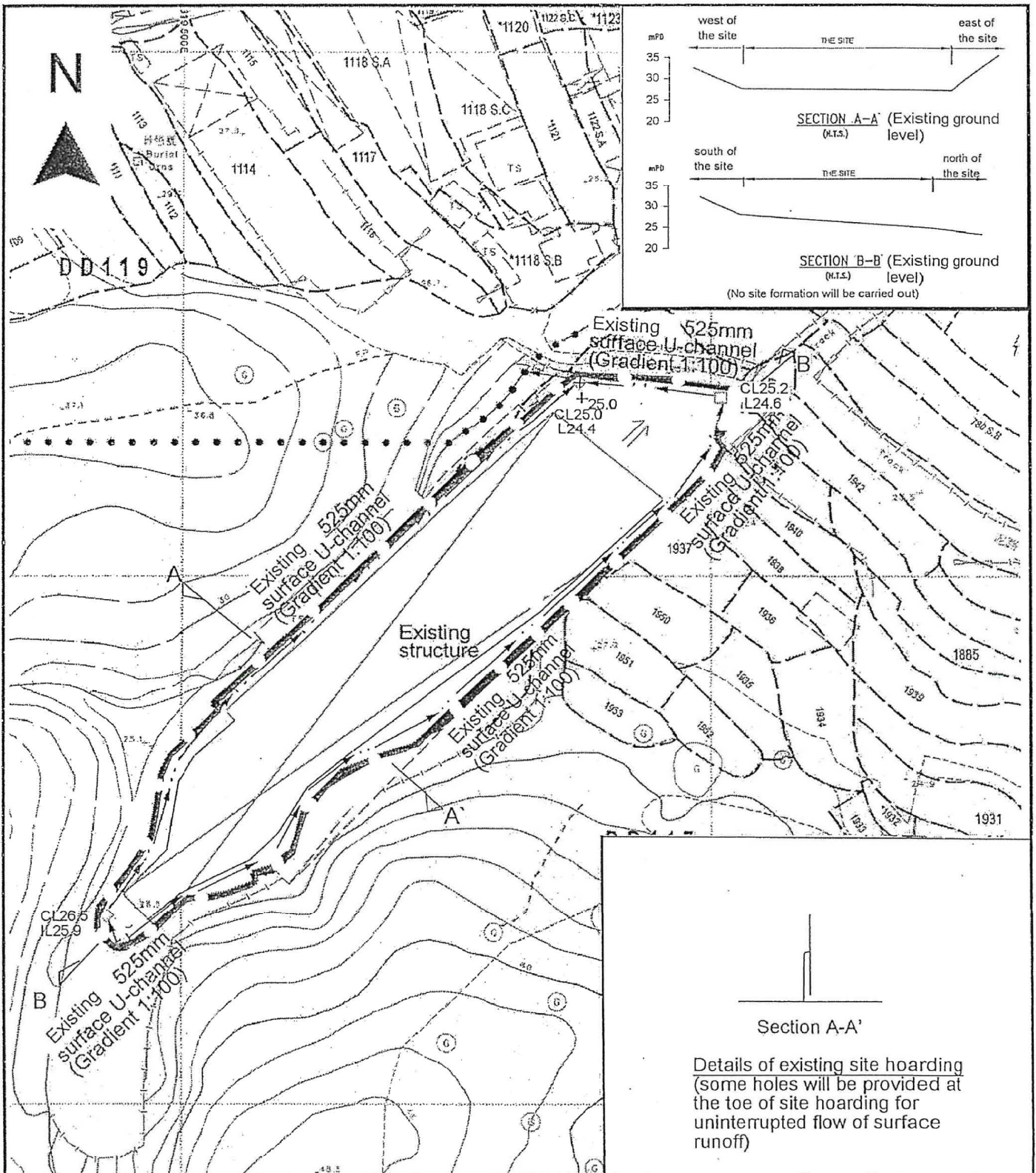

<p>Project 項目名稱: Proposed Temporary Warehouse for Storage of Home Appliance and Furniture for a Period of 3 Years at Lots 1937 (Part), 1945 (Part), 1946 (Part), 1947 (Part), 1948, 1954 (Part), 1955, 1956 (Part), 1957 (Part) in D.D.117 & Adjoining Government Land, Yuen Long, N.T.</p>	<p>Drawing Title 圖名: As-built Drainage Plan</p>	<p>Remarks 備註: +25.0 Level (in mPD) □ catchpit ← Flow of Surface Runoff Existing hoarding ⊗ Terminal catchpit</p>
<p>Drawing No. 圖號: Figure 5</p>		<p>Scale 比例: 4:1000</p>

(摘錄自申請人於 24. 6. 2020 提交的申請書)
(Extract from Applicant's Submission of 24.6.2020)

<p>參考編號 REFERENCE No. A/YL-TYST/1041</p>	<p>繪圖 DRAWING A-4</p>
--	---------------------------

APPENDIX I

PLANNING APPLICATION No.Lots 1937 (Part), 1945 (Part), 1946 (Part), 1947 (Part), 1946,1954 (Part), 1955, 1956, 1957 (Part), in D.D. 177 & Adjoining Government Land, Yuen Long, N.T.

F. S. NOTES:

1. GENERAL

- 1.1 FIRE SERVICE INSTALLATIONS SHALL BE PROVIDED IN ACCORDANCE WITH THE CODES OF PRACTICE FOR MINIMUM FIRE SERVICE INSTALLATIONS AND EQUIPMENT AND INSPECTION, TESTING AND MAINTENANCE OF INSTALLATIONS AND EQUIPMENT 2012 (COP 2012), FSD CIRCULAR LETTERS AND THE HONG KONG WATERWORKS STANDARD REQUIREMENTS.
- 1.2 ALL TUBES AND FITTINGS SHALL BE G.M.S. TO BS1387 MEDIUM GRADE WHERE PIPEWORK UP TO $\phi 150\text{mm}$.
- 1.3 ALL TUBES AND FITTINGS SHALL BE DUCTILE IRON TO BS EN45 K12 WHERE PIPEWORK ABOVE $\phi 150\text{mm}$.
- 1.4 ALL DRAIN PIPES SHALL BE DISCHARGED TO A CONSPICUOUS POSITION WITHOUT THE POSSIBILITY OF BEING SUBMERGED.
- 1.5 ALL PUDDLE FLANGES SHALL BE MADE OF DUCTILE IRON
- 1.6 THE AGGREGATE AREA OF OPENABLE WINDOWS NOT LESS THAN 6.25% OF THE FLOOR AREA OF THE STRUCTURE
- 1.7 VENTILATION/AIR CONDITIONING SYSTEM NOT TO BE PROVIDED.

2. HOSE REEL SYSTEM

- 2.1 NEW FIRE HOSE REEL SHALL BE PROVIDED AS INDICATED ON PLAN TO ENSURE THAT EVERY PART OF THE BUILDING CAN BE REACHED BY A LENGTH OF NOT MORE THAN 30m HOSE REEL TUBING.
- 2.2 THE WATER SUPPLY FOR HOSE REEL SYSTEM WILL BE FED FROM A NEW 2m³ F.S. FIBREGLASS WATER TANK VIA TWO HOSE REEL PUMPS (DUTY/STANDBY) LOCATED INSIDE FS PUMP ROOM AT EXTERNAL AREA.
- 2.3 HOSE REEL PUMPS SHALL BE STARTED BY ACTUATION OF ANY BREAKGLASS UNIT FITTED ASIDE EACH HOSE REEL SETS
- 2.4 ALL FIRE HOSE REEL OUTLETS SHOULD BE HOUSED IN GLASS FRONTED CABINET SECURED UNDER LOCK & KEY.
- 2.5 ALL FIRE HOSE REEL SHOULD BE PROVIDED WITH FSD APPROVED TYPE INSTRUCTION PLATE & WSD WARNING PLATE
- 2.6 SECONDARY ELECTRICITY SUPPLY DIRECTLY TEE OFF BEFORE CLP'S INCOMING MAIN SWITCH SHALL BE PROVIDED FOR THE FH/HR PUMPS.

3. AUTOMATIC SPRINKLER SYSTEM

- 3.1 NEW AUTOMATIC SPRINKLER SYSTEM SHALL BE PROVIDED AND INSTALLED IN ACCORDANCE WITH LPC RULES FOR AUTOMATIC SPRINKLER INSTALLATIONS INCORPORATING BS EN 12845: 2003 (INCLUDING TECHNICAL BULLETINS, NOTES, COMMENTAR AND RECOMMENDATIONS) AND FSD CIRCULAR LETTER NOTES, COMMENTAR AND RECOMMENDATIONS AND FSD CIRCULAR LETTER NO. 3/2006 AND 3/2012. THE CLASSIFICATION OF THE OCCUPANCIES WILL BE ORDINARY HAZARD GROUP III.
- 3.2 ONE NEW 135m³ SPRINKLER WATER TANK WILL BE PROVIDED AS INDICATED ON PLAN. THE TOWN MAIN WATER SUPPLY WILL BE FED FROM SINGLE END.
- 3.3 TWO NEW SPRINKLER PUMPS (DUTY/STANDBY) AND ONE JOCKEY PUMP SHALL BE PROVIDED IN FS PUMP ROOM LOCATED AT EXTERNAL AREA.
- 3.4 NEW SPRINKLER CONTROL VALVE SET AND SPRINKLER INLET SHALL BE PROVIDED AS INDICATED ON PLAN.
- 3.5 A TEST VALVE SHALL BE PROVIDED FOR EACH ZONE OF SPRINKLER PIPE. THIS VALVE SHALL BE AT A CONSPICUOUS POSITION THAT WATER CAN BE DRAINED AWAY EASILY.
- 3.6 ALL SUBSIDIARY STOP VALVES TO BE ELECTRIC MONITORING TYPE.
- 3.7 ALL ELECTRIC TYPE VALVES SHOULD GIVE VISUAL SIGNALS TO FIRE SERVICE MAIN SUPERVISORY CONTROL PANEL TO INDICATE THE STATUS (OPEN/CLOSE) OF THE VALVES.
- 3.8 SECONDARY ELECTRICITY SUPPLY DIRECTLY TEE OFF BEFORE CLP'S INCOMING MAIN SWITCH SHALL BE PROVIDED FOR THE SPRINKLER PUMPS.
- 3.9 THE SPRINKLER SYSTEM DESIGN IS BASED ON THE FOLLOWINGS:
HAZARD CLASS : ORDINARY HAZARD GROUP III
TYPE OF STORAGE : FREE STANDING
STORAGE CATEGORY : CATEGORY I
MAXIMUM STORAGE HEIGHT : 4.0m
SPRINKLER PROTECTION : CEILING PROTECTION ONLY

4. FIRE ALARM SYSTEM

- 4.1 NEW FIRE ALARM SYSTEM SHALL BE PROVIDED IN ACCORDANCE WITH BS 5839-1:2002 4:2-2008 AND FSD CIRCULAR LETTERS NO. 1/2009 & 3/2010.
- 4.2 NEW BREAKGLASS UNITS AND FIRE ALARM BELLS SHALL BE PROVIDED AT ALL NEW FIRE HOSE REEL POINTS. THE FIRE ALARM INSTALLATION WILL BE INTEGRATED WITH THE HOSE REEL SYSTEM.

5. EMERGENCY LIGHTING

- 5.1 EMERGENCY LIGHTING SHALL BE PROVIDED IN ACCORDANCE WITH 'BS 5226-PART 1 :2011 AND BS EN 1838 :2013', COVERING ALL AREA. EMERGENCY LIGHTINGS SHALL BE BACKED UP BY BUILT-IN BATTERY AND CAPABLE OF MAINTAINING FUNCTION OF NOT LESS THAN 2 HOURS IN CASE OF POWER FAILURE

6. EXIT SIGN

- 6.1 ALL EXIT SIGNS/DIRECTIONAL EXIT SIGNS SHALL BE PROVIDED IN ACCORDANCE WITH SECTION 5.10 OF COP 2012 AND FSD CIRCULAR LETTER NO. 5/2008. FOR THE BUILDING. EXIT SIGNS/DIRECTIONAL EXIT SIGNS SHALL BE BACKED UP BY BUILT-IN BATTERY AND CAPABLE OF MAINTAINING FUNCTION OF NOT LESS THAN 2 HOURS IN CASE OF POWER FAILURE.

7. PORTABLE APPLIANCES

- 7.1 PORTABLE HAND OPERATED APPLIANCES SHALL BE PROVIDED AS INDICATED ON PLAN.

LEGEND

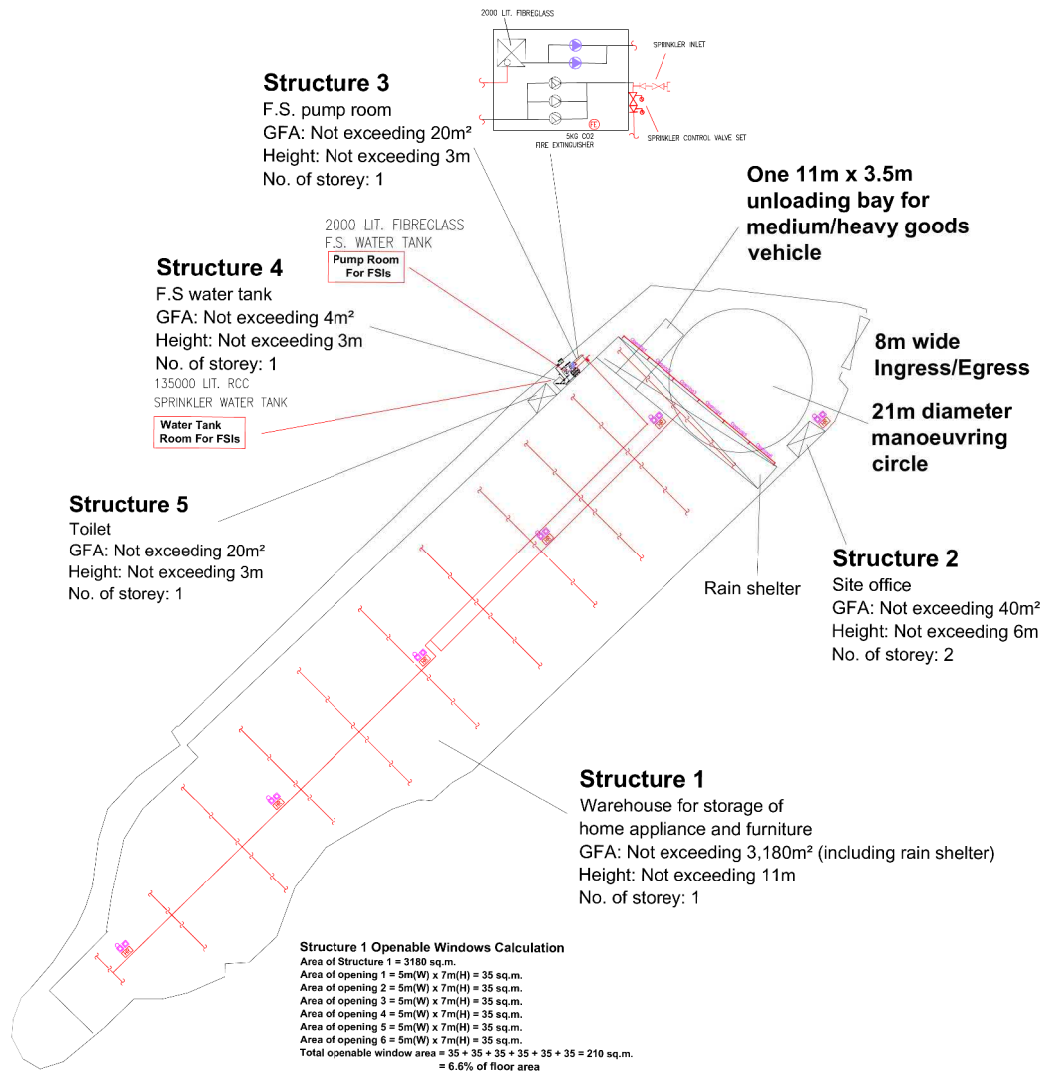

Structure 1 Openable Windows Calculation
 Area of Structure 1 = 3160 sq.m.
 Area of opening 1 = 5m(W) x 7m(H) = 35 sq.m.
 Area of opening 2 = 5m(W) x 7m(H) = 35 sq.m.
 Area of opening 3 = 5m(W) x 7m(H) = 35 sq.m.
 Area of opening 4 = 5m(W) x 7m(H) = 35 sq.m.
 Area of opening 5 = 5m(W) x 7m(H) = 35 sq.m.
 Area of opening 6 = 5m(W) x 7m(H) = 35 sq.m.
 Total openable window area = 35 + 35 + 35 + 35 + 35 + 35 = 210 sq.m.
 = 6.6% of floor area

PROJECT : Proposed Temporary Warehouse for Storage of Home Appliance and Furniture for a Period of 3 Years at Lots 1937 (Part), 1945 (Part), 1946 (Part), 1947 (Part), 1948,1954 (Part), 1955, 1956, 1957 (Part), in D.D. 177 & Adjoining Government Land, Yuen Long, N.T.	DRAWING TITLE : F.S. Notes, Legend, Fire Service Installation Layout Plan	ARCHITECT :	CONSULTANT :	FIRE SERVICE CONTRACTOR : Century Fire Service Engineering Co., Ltd.	NAME : C.K.NG	DATE : 30 MAY 2020	DRAWING NO : FS-02	REV. : 0
					CHECKED BY :	SCALE :		
					APPROVED BY :	SOURCE : B.O.O Ref. BD F.S.D. Ref. FP		
REV	DESCRIPTION	DATE						

(摘錄自申請人於 9.7.2020 呈交的進一步資料)
 (Extract from Applicant's Further Information Submitted on 9.7.2020)

參考編號 REFERENCE No. A/YL-TYST/1041	繪圖 DRAWING A-5
---	-------------------

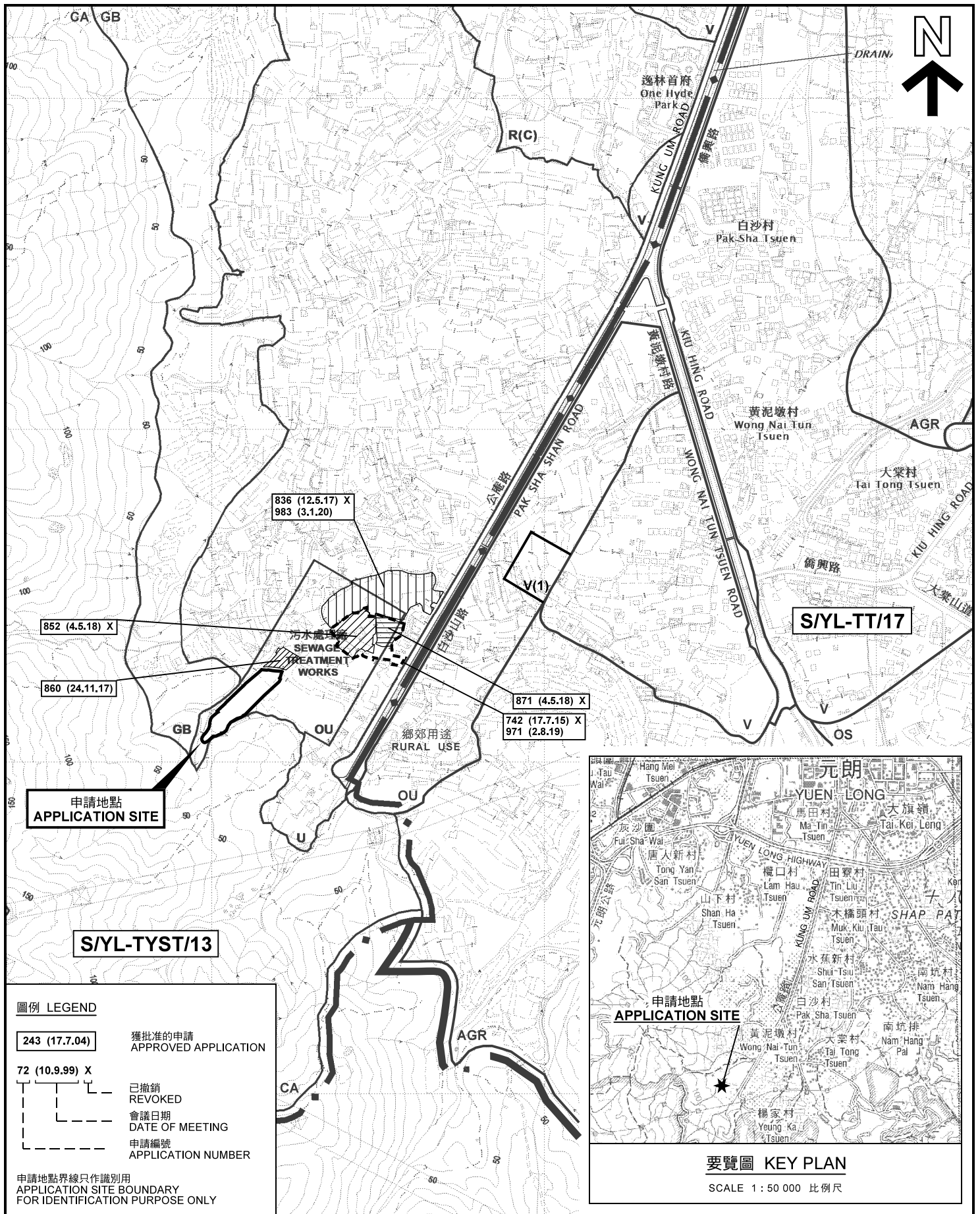

圖例 LEGEND

- 243 (17.7.04) 獲批准的申請
APPROVED APPLICATION
- 72 (10.9.99) X 已撤銷
REVOKED
- 會議日期
DATE OF MEETING
- 申請編號
APPLICATION NUMBER

申請地點界線只作識別用
APPLICATION SITE BOUNDARY
FOR IDENTIFICATION PURPOSE ONLY

本摘要圖於2020年7月30日擬備，
所根據的資料為於2020年7月10日
展示的分區計劃大綱圖編號 S/YL-TYST/13
EXTRACT PLAN PREPARED ON 30.7.2020
BASED ON OUTLINE ZONING PLAN No.
S/YL-TYST/13 EXHIBITED ON 10.7.2020

位置圖及同類申請 LOCATION PLAN WITH SIMILAR APPLICATIONS

臨時貨倉存放家庭電器及傢俬 (為期3年)
元朗唐人新村丈量約份第117約地段第1937號(部分)、第1945號(部分)、
第1946號(部分)、第1947號(部分)、第1948號、第1954號(部分)、第1955號、
第1956號(部分)及第1957號(部分)和毗連政府土地
TEMPORARY WAREHOUSE FOR STORAGE OF
HOME APPLIANCE AND FURNITURE FOR A PERIOD OF 3 YEARS
LOTS 1937 (PART), 1945 (PART), 1946 (PART), 1947 (PART), 1948,
1954 (PART), 1955, 1956 (PART) AND 1957 (PART) IN D.D.117 AND
ADJOINING GOVERNMENT LAND, TONG YAN SAN TSUEN, YUEN LONG
SCALE 1 : 7 500 比例尺

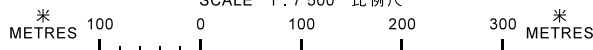

要覽圖 KEY PLAN

SCALE 1 : 50 000 比例尺

**規劃署
PLANNING
DEPARTMENT**



參考編號
REFERENCE No.

A/YL-TYST/1041

圖 PLAN

A-1a

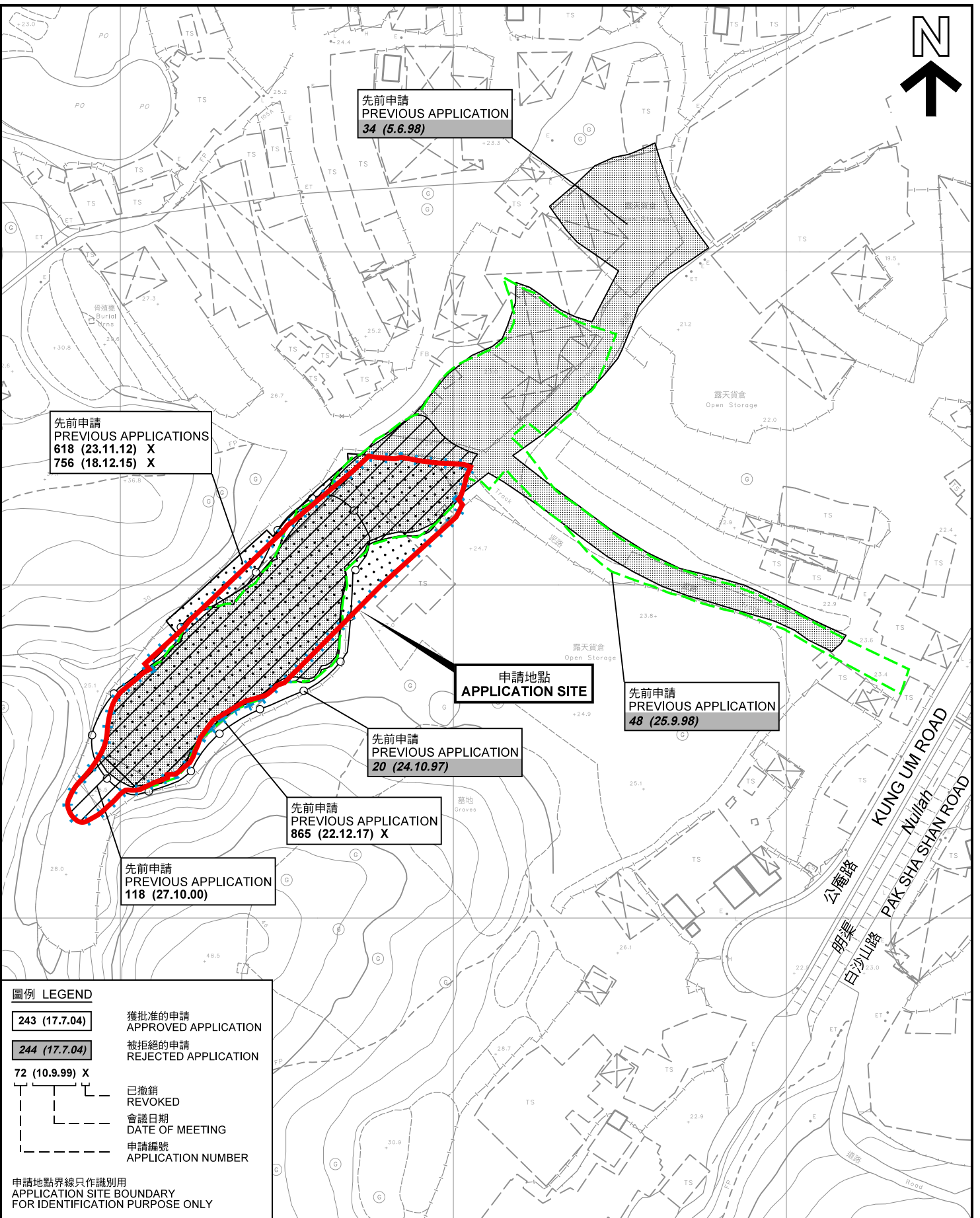

先前申請
PREVIOUS APPLICATION
34 (5.6.98)

先前申請
PREVIOUS APPLICATIONS
618 (23.11.12) X
756 (18.12.15) X

申請地點
APPLICATION SITE

先前申請
PREVIOUS APPLICATION
48 (25.9.98)

先前申請
PREVIOUS APPLICATION
20 (24.10.97)

先前申請
PREVIOUS APPLICATION
865 (22.12.17) X

先前申請
PREVIOUS APPLICATION
118 (27.10.00)

圖例 LEGEND

- 243 (17.7.04) 獲批准的申請
APPROVED APPLICATION
- 244 (17.7.04) 被拒絕的申請
REJECTED APPLICATION
- 72 (10.9.99) X 已撤銷
REVOKED
- 會議日期
DATE OF MEETING
- 申請編號
APPLICATION NUMBER

申請地點界線只作識別用
APPLICATION SITE BOUNDARY
FOR IDENTIFICATION PURPOSE ONLY

先前申請圖 PREVIOUS APPLICATIONS PLAN

臨時貨倉存放家庭電器及傢俱 (為期3年)
元朗唐人新村丈量約份第117約地段第1937號(部分)、第1945號(部分)、
第1946號(部分)、第1947號(部分)、第1948號、第1954號(部分)、第1955號、
第1956號(部分)及第1957號(部分)和毗連政府土地
TEMPORARY WAREHOUSE FOR STORAGE OF
HOME APPLIANCE AND FURNITURE FOR A PERIOD OF 3 YEARS
LOTS 1937 (PART), 1945 (PART), 1946 (PART), 1947 (PART), 1948,
1954 (PART), 1955, 1956 (PART) AND 1957 (PART) IN D.D.117 AND
ADJOINING GOVERNMENT LAND, TONG YAN SAN TSUEN, YUEN LONG
SCALE 1 : 1 500 比例尺

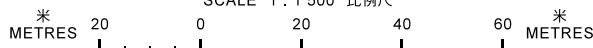

規劃署
PLANNING
DEPARTMENT



參考編號
REFERENCE No.
A/YL-TYST/1041

圖 PLAN
A-1b

本摘要圖於2020年7月30日擬備，所根據的資料為測量圖編號 6-NW-23B、23D、24A 及 24C
EXTRACT PLAN PREPARED ON 30.7.2020
BASED ON SURVEY SHEETS No.
6-NW-23B, 23D, 24A & 24C

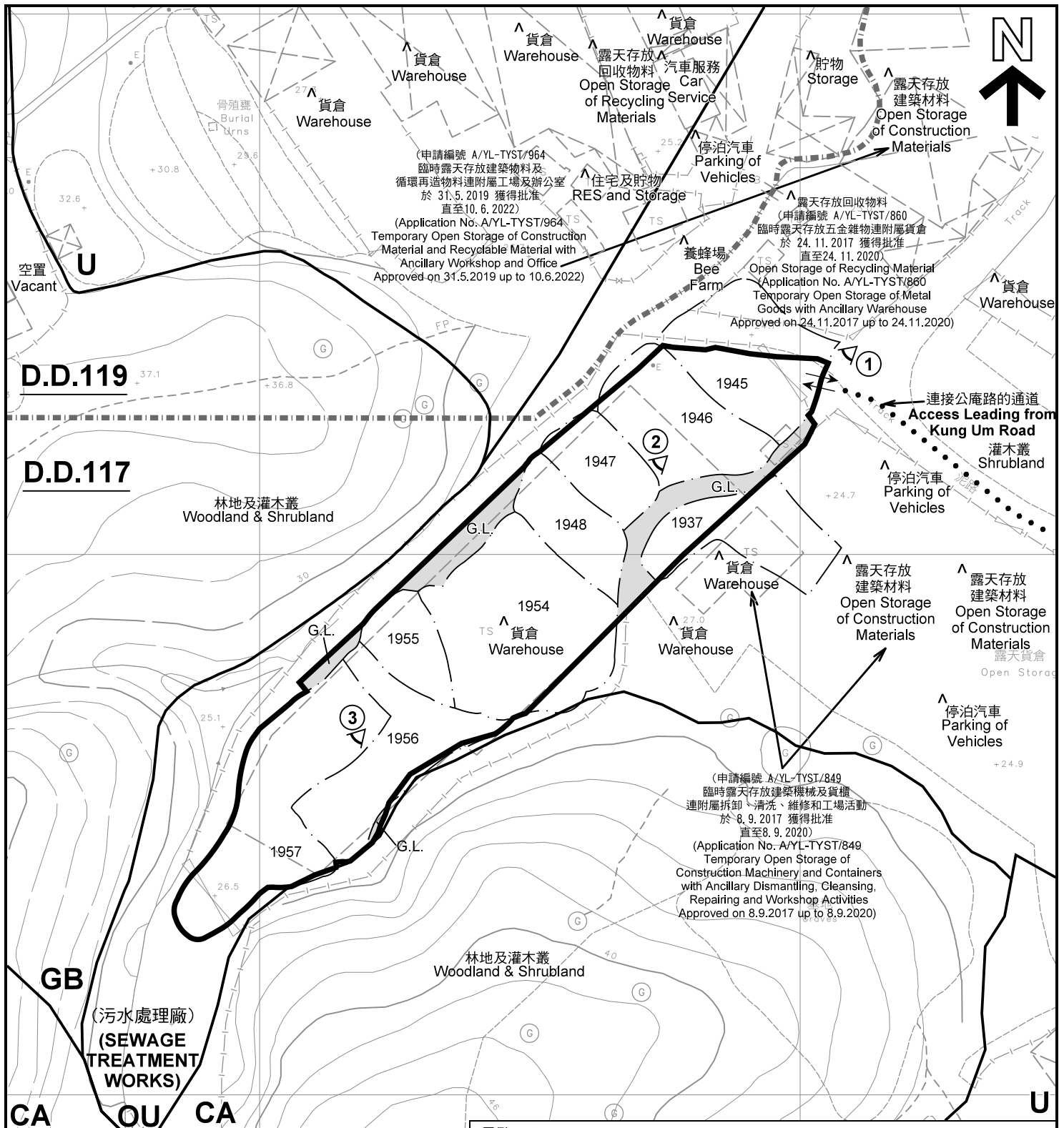

註釋 Notes:

- (1) 2020年7月6日勘測的土地用途
Land uses shown on this plan are in accordance with the land use survey conducted by the Planning Department on 6.7.2020
- (2) * 土地用途跟1993年6月21日勘測的土地用途一致
Indicates that the use is the same as that revealed by the land use survey conducted by the Planning Department on 21.6.1993
- (3) ^ 土地用途跟1993年6月21日勘測的土地用途有別
Indicates that the use is different from that revealed by the land use survey conducted by the Planning Department on 21.6.1993

圖例 LEGEND

- | | | | |
|--|--|--|---|
| | 申請地點(界線只作識別用)
APPLICATION SITE
(BOUNDARY FOR IDENTIFICATION
PURPOSE ONLY) | | 政府土地
GOVERNMENT LAND |
| | 未決定用途
UNDETERMINED | | 住用構築物
RESIDENTIAL STRUCTURES |
| | 綠化地帶
GREEN BELT | | 丈量約份界線
D.D. BOUNDARY |
| | 自然保育區
CONSERVATION AREA | | 實地照片的觀景點
VIEWING POINT OF SITE PHOTO |
| | 其他指定用途
OTHER SPECIFIED USES | | 入口/出口
INGRESS / EGRESS |

平面圖 SITE PLAN

臨時貨倉存放家庭電器及傢俱(為期3年)
元朗唐人新村丈量約份第117約地段第1937號(部分)、第1945號(部分)、
第1946號(部分)、第1947號(部分)、第1948號、第1954號(部分)、第1955號、
第1956號(部分)及第1957號(部分)和毗連政府土地
TEMPORARY WAREHOUSE FOR STORAGE OF
HOME APPLIANCE AND FURNITURE FOR A PERIOD OF 3 YEARS
LOTS 1937 (PART), 1945 (PART), 1946 (PART), 1947 (PART), 1948,
1954 (PART), 1955, 1956 (PART) AND 1957 (PART) IN D.D.117 AND
ADJOINING GOVERNMENT LAND, TONG YAN SAN TSUEN, YUEN LONG
SCALE 1 : 1 000 比例尺

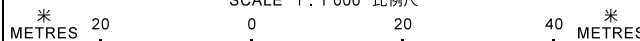

本摘要圖於2020年8月4日擬備，所根據的資料為測量圖編號 6-NW-23B、23D、24A 及 24C
EXTRACT PLAN PREPARED ON 4.8.2020
BASED ON SURVEY SHEETS No.
6-NW-23B, 23D, 24A & 24C

規劃署
PLANNING
DEPARTMENT



參考編號
REFERENCE No.

A/YL-TYST/1041

圖 PLAN

A-2



圖例 LEGEND



申請地點(界線只作識別用)
APPLICATION SITE
(BOUNDARY FOR IDENTIFICATION
PURPOSE ONLY)

本摘要圖於2020年7月30日擬備，所根據的資料為地政總署於2019年11月4日拍得的航攝照片編號 E074274C
EXTRACT PLAN PREPARED ON 30.7.2020
BASED ON AERIAL PHOTO No.
E074274C TAKEN ON 4.11.2019
BY LANDS DEPARTMENT

航攝照片 AERIAL PHOTO

臨時貨倉存放家庭電器及傢俱(為期3年)
元朗唐人新村丈量約份第117約地段第1937號(部分)、第1945號(部分)、
第1946號(部分)、第1947號(部分)、第1948號、第1954號(部分)、第1955號、
第1956號(部分)及第1957號(部分)和毗連政府土地
TEMPORARY WAREHOUSE FOR STORAGE OF
HOME APPLIANCE AND FURNITURE FOR A PERIOD OF 3 YEARS
LOTS 1937 (PART), 1945 (PART), 1946 (PART), 1947 (PART), 1948,
1954 (PART), 1955, 1956 (PART) AND 1957 (PART) IN D.D.117 AND
ADJOINING GOVERNMENT LAND, TONG YAN SAN TSUEN, YUEN LONG

規劃署
PLANNING
DEPARTMENT



參考編號
REFERENCE No.
A/YL-TYST/1041

圖 PLAN
A-3



申請地點
APPLICATION SITE

1

連接公庵路的通道
Access Leading from
Kung Um Road



申請地點
APPLICATION SITE

2

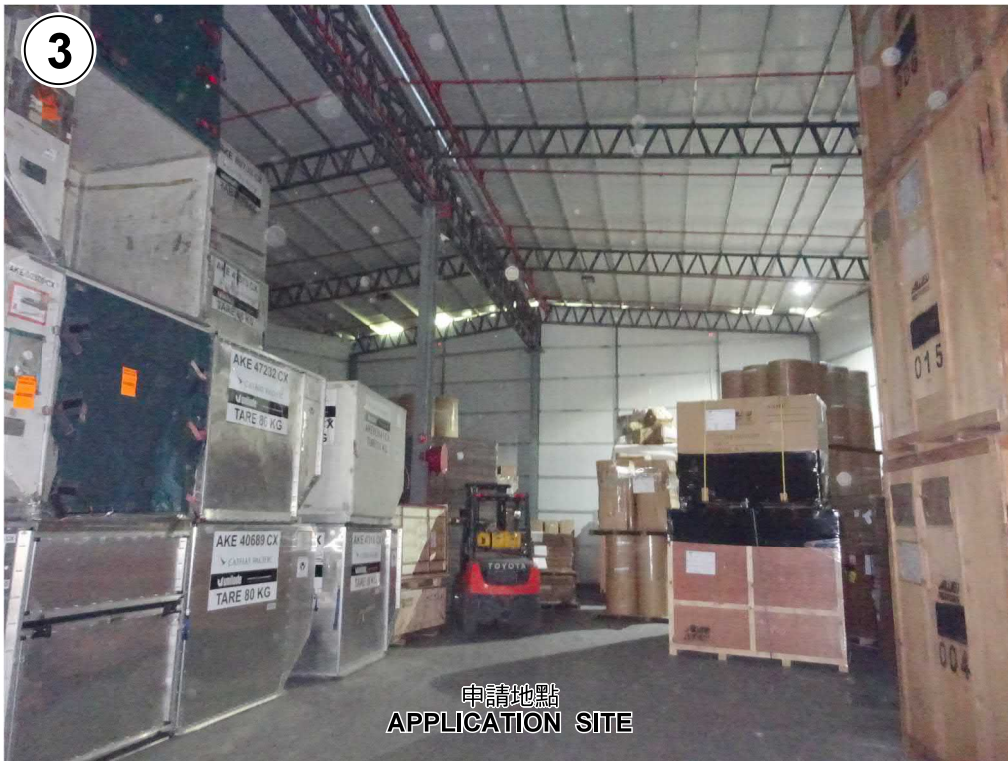

申請地點
APPLICATION SITE

3

本圖於2020年8月4日擬備，所根據的資料為攝於2020年7月3日的實地照片
PLAN PREPARED ON 4.8.2020
BASED ON SITE PHOTOS
TAKEN ON 3.7.2020

實地照片 SITE PHOTOS

臨時貨倉存放家庭電器及傢俱（為期3年）
元朗唐人新村丈量約份第117約地段第1937號(部分)、第1945號(部分)、
第1946號(部分)、第1947號(部分)、第1948號、第1954號(部分)、第1955號、
第1956號(部分)及第1957號(部分)和毗連政府土地
TEMPORARY WAREHOUSE FOR STORAGE OF
HOME APPLIANCE AND FURNITURE FOR A PERIOD OF 3 YEARS
LOTS 1937 (PART), 1945 (PART), 1946 (PART), 1947 (PART), 1948,
1954 (PART), 1955, 1956 (PART) AND 1957 (PART) IN D.D.117 AND
ADJOINING GOVERNMENT LAND, TONG YAN SAN TSUEN, YUEN LONG

規劃署
PLANNING
DEPARTMENT



參考編號
REFERENCE No.
A/YL-TYST/1041

圖 PLAN
A-4