

Legend

- The Application Site
 - Pedestrian Access
- Base Plan Extracted from Lot Index Plan No. KD0135022018
 Prepared by the District Survey Office / Kowloon on 28.2.2018

Site Plan

Temporary Place of Recreation & Sports (Martial Arts Training Ground) for a Period of 5 Years at Lot No. 1034 S.A. RP (Part) and Adjoining Government Land in DD121, Tong Yan San Tsuen, Yuen Long

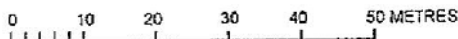

Plan 2

PlanArch Consultants Ltd.





Revision: Date: 16.3.2018

(摘錄自申請人於 9.5.2018 呈交的申請書)
 (Extract from Applicant's Submission of 9.5.2018)

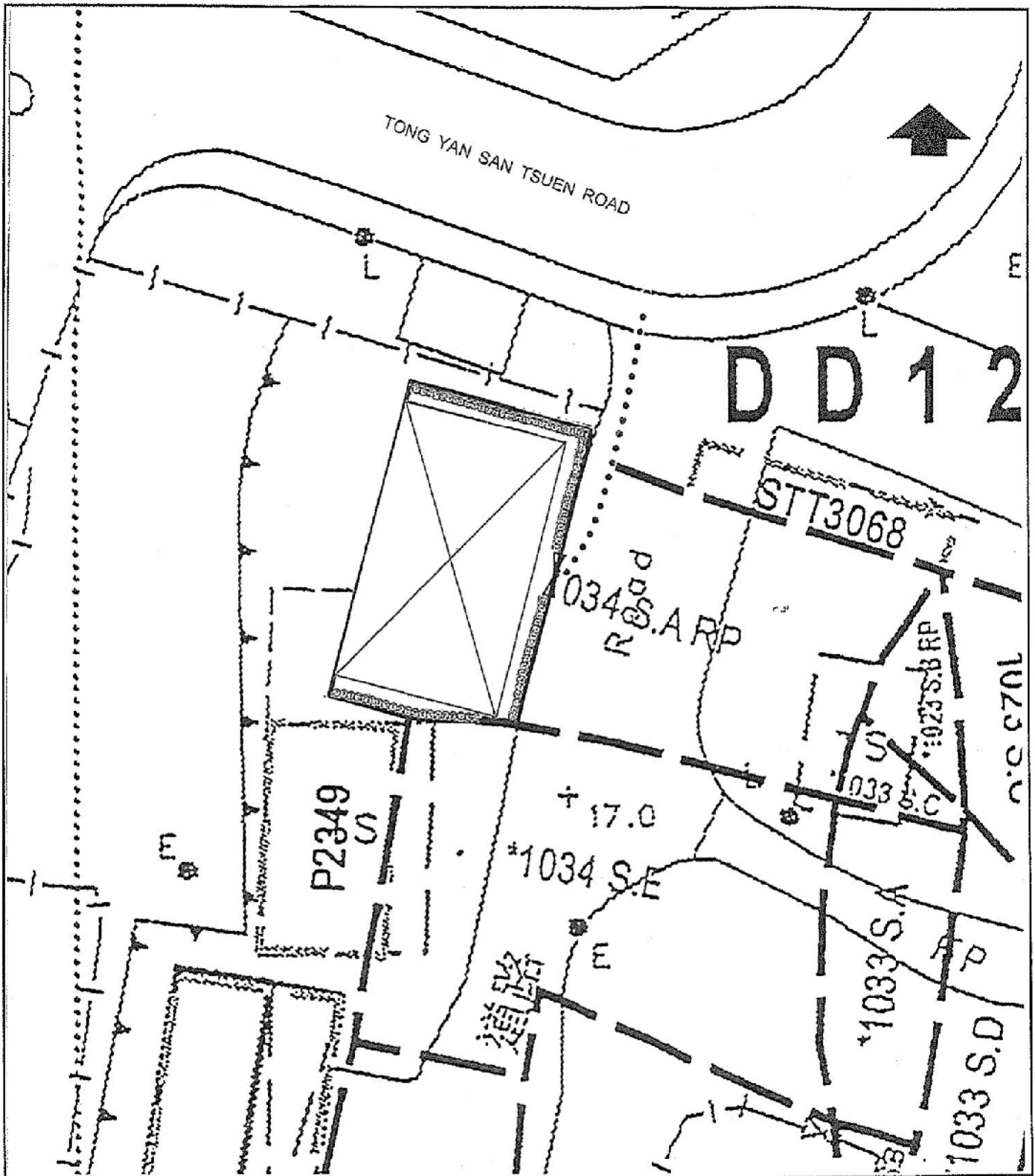
參考編號
 REFERENCE No.
AYL-TYST/900

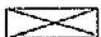
繪圖 **DRAWING**
A-1

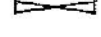

<p>Legend</p> <ul style="list-style-type: none">  The Application Site  Structure  Peripheral Planting  Ingress/Egress  Pedestrian Access 	<p style="text-align: center;">Layout Plan</p> <p style="text-align: center;">Temporary Place of Recreation & Sports (Martial Arts Training Ground) for a Period of 5 Years at Lot No. 1034 S.A. RP (Part) and Adjoining Government Land in DD121, Tong Yan San Tsuen, Yuen Long</p> <p style="text-align: center;">0 5 10 15 METRES</p>	<p style="text-align: center;">Plan 3</p> <p style="text-align: center;">PlanArch Consultants Ltd.</p> <p>Revision: Date: 19.3.2018</p>
--	--	---

(摘錄自申請人於 9.5.2018 呈交的申請書)
(Extract from Applicant's
Submission of 9.5.2018)

<p>參考編號 REFERENCE No. AYL-TYST/900</p>	<p>繪圖 DRAWING A-2</p>
--	---------------------------

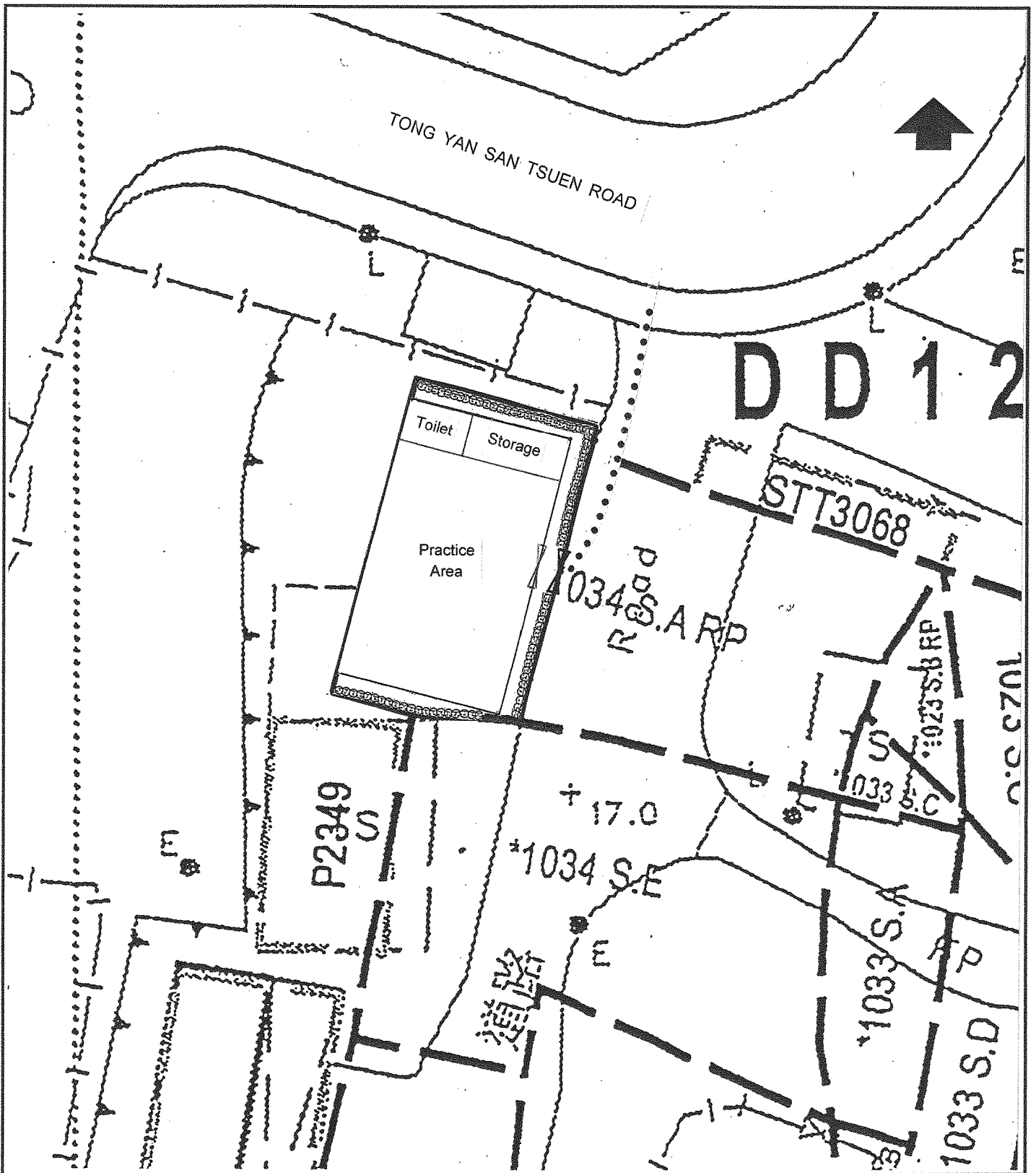

Legend

- The Application Site
- Peripheral Planting
- Ingress/Egress
- Pedestrian Access

Internal Layout Plan

Temporary Place of Recreation & Sports
 (Martial Arts Training Ground) for a Period of 5 Years
 at Lot No. 1034 S.A. RP (Part) and
 Adjoining Government Land in DD121,
 Tong Yan San Tsuen, Yuen Long



Plan 4

PlanArch Consultants Ltd.

Revision: Date: 20.6.2018

(摘錄自申請人於 20.6.2018 呈交的進一步資料)
 (Extract from Applicant's Further
 Information Submitted on 20.6.2018)

參考編號
 REFERENCE No.
 AYL-TYST/900

繪圖 DRAWING
 A-3

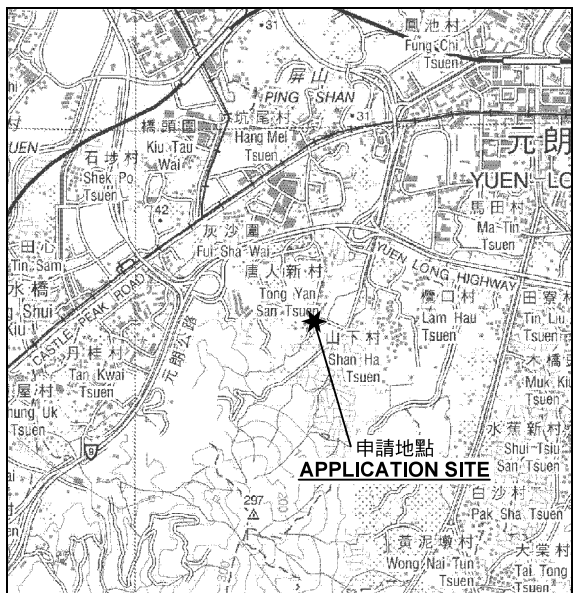

要覽圖 KEY PLAN

SCALE 1 : 50 000 比例尺

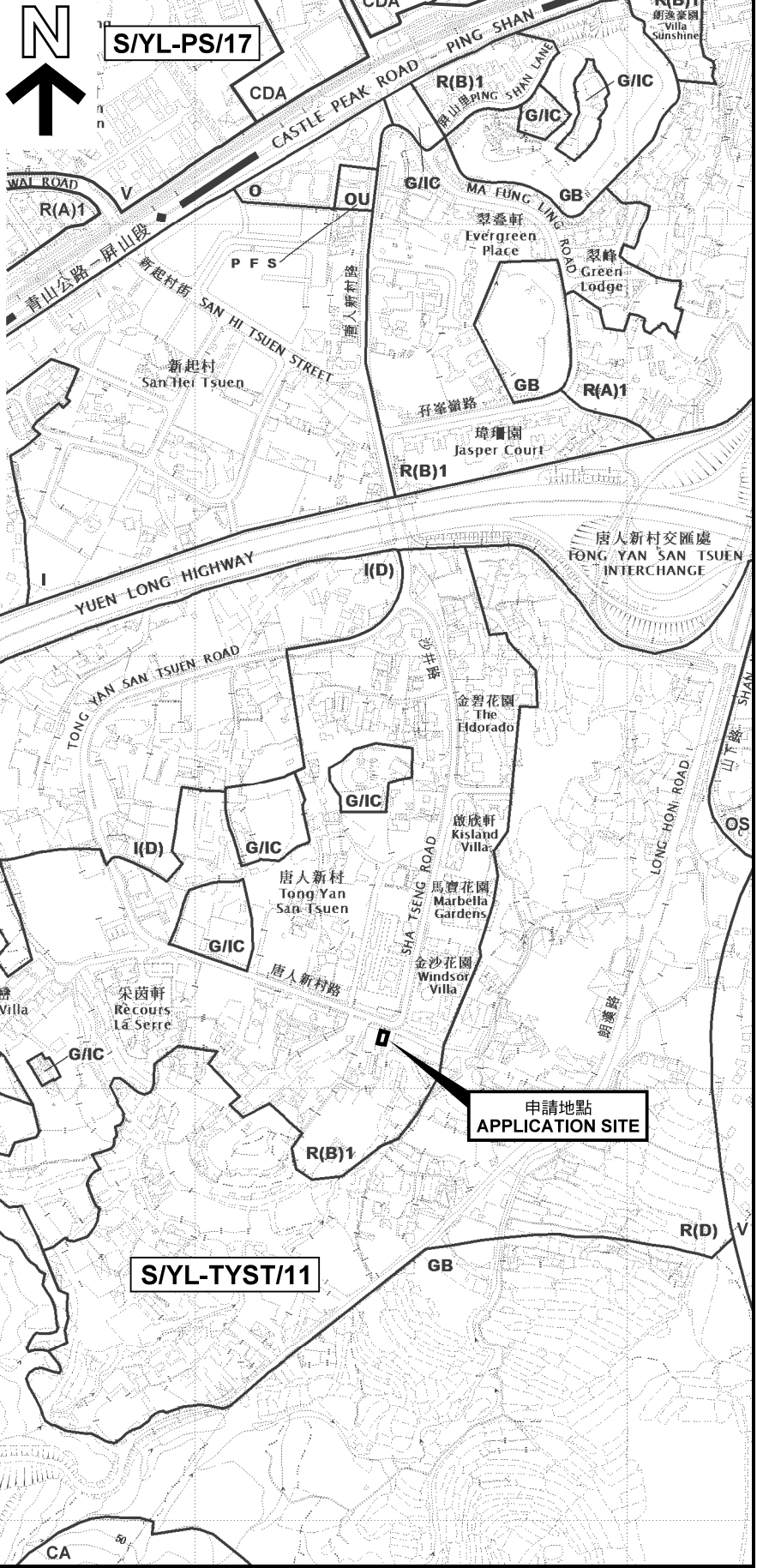

位置圖 LOCATION PLAN

申請地點界線只作識別用
APPLICATION SITE BOUNDARY
FOR IDENTIFICATION PURPOSE ONLY

本摘要圖於2018年6月7日擬備，
所根據的資料為於2017年9月29日
展示的分區計劃大綱圖編號 S/YL-TYST/11
EXTRACT PLAN PREPARED ON 7.6.2017
BASED ON OUTLINE ZONING PLAN No.
S/YL-TYST/11 EXHIBITED ON 29.9.2017

擬議臨時康體場所（國術體育會）（為期5年）
元朗唐人新村丈量約份第121約地段第1034號A分段餘段（部分）及毗連政府土地
PROPOSED TEMPORARY PLACE OF RECREATION AND SPORTS
(MARTIAL ARTS TRAINING VENUE) FOR A PERIOD OF 5 YEARS
LOT 1034 S.A RP (PART) IN D.D.121 AND ADJOINING GOVERNMENT LAND,
TONG YAN SAN TSUEN, YUEN LONG

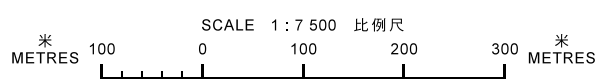

規劃署
PLANNING
DEPARTMENT



參考編號
REFERENCE No.
A/YL-TYST/900

圖 PLAN
A-1

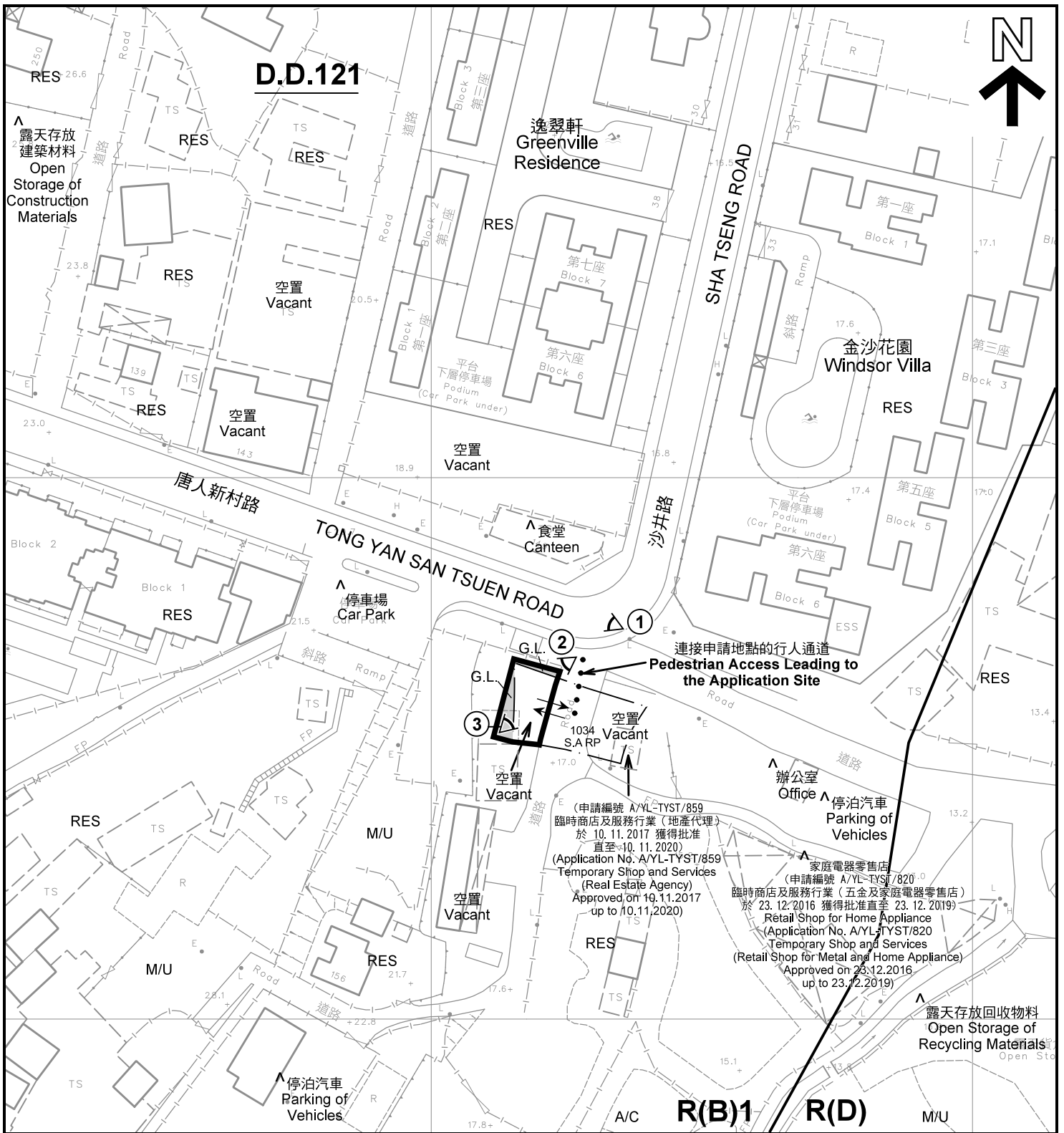

註釋 Notes :

- (1) 2018年5月18日勘測的土地用途
Land uses shown on this plan are in accordance with the land use survey conducted by the Planning Department on 18.5.2018
- (2) * 土地用途跟1993年6月18日、1993年6月21日及1993年7月14日勘測的土地用途一致
Indicates that the use is the same as that revealed by the land use survey conducted by the Planning Department on 18.6.1993, 21.6.1993 & 14.7.1993
- (3) ^ 土地用途跟1993年6月18日、1993年6月21日及1993年7月14日勘測的土地用途有別
Indicates that the use is different from that revealed by the land use survey conducted by the Planning Department on 18.6.1993, 21.6.1993 & 14.7.1993

圖例 LEGEND

- 申請地點(界線只作識別用)
APPLICATION SITE (BOUNDARY FOR IDENTIFICATION PURPOSE ONLY)
- R(B)** 住宅(乙類)
RESIDENTIAL (GROUP B)
- R(D)** 住宅(丁類)
RESIDENTIAL (GROUP D)
- G.L.** 政府土地
GOVERNMENT LAND
- RES 住用構築物
RESIDENTIAL STRUCTURES
- M/U 荒地
UNUSED LAND
- A/C 常耕農地
CULTIVATED AGRICULTURAL LAND
- 實地照片的觀景點
VIEWING POINT OF SITE PHOTO
- 入口/出口
INGRESS / EGRESS

平面圖 SITE PLAN

擬議臨時康體場所(國術體育會)(為期5年)
元朗唐人新村丈量約份第121約地段第1034號A分段餘段(部分)及毗連政府土地
PROPOSED TEMPORARY PLACE OF RECREATION AND SPORTS
(MARTIAL ARTS TRAINING VENUE) FOR A PERIOD OF 5 YEARS
LOT 1034 S.A RP (PART) IN D.D.121 AND ADJOINING GOVERNMENT LAND,
TONG YAN SAN TSUEN, YUEN LONG

SCALE 1 : 1 000 比例尺

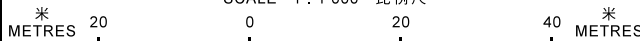

**規劃署
PLANNING
DEPARTMENT**



參考編號
REFERENCE No.
A/YL-TYST/900

**圖 PLAN
A-2**

本摘要圖於2018年6月14日擬備, 所根據的資料為測量圖編號 6-NW-13D
EXTRACT PLAN PREPARED ON 14.6.2018
BASED ON SURVEY SHEET No.
6-NW-13D

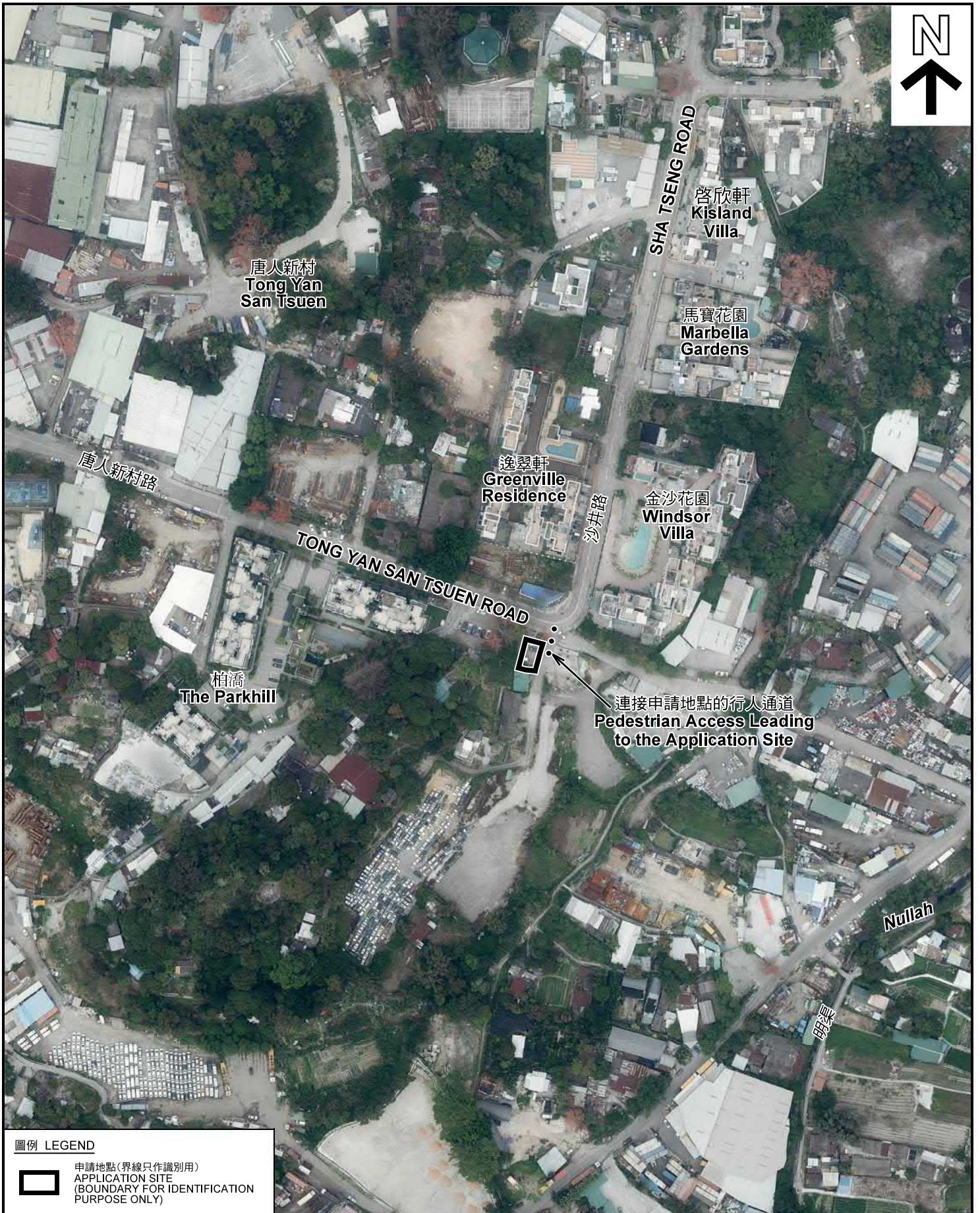

圖例 LEGEND



申請地點(界線只作識別用)
APPLICATION SITE
(BOUNDARY FOR IDENTIFICATION
PURPOSE ONLY)

本摘要圖於2018年6月12日擬備，所根據的資料為地政總署於2018年3月13日拍得的航攝照片編號 E034871C
EXTRACT PLAN PREPARED ON 12.6.2018
BASED ON AERIAL PHOTO No.
E034871C TAKEN ON 13.3.2018
BY LANDS DEPARTMENT

航攝照片 AERIAL PHOTO

擬議臨時康體場所(國術體育會)(為期5年)
元朗唐人新村丈量約份第121約地段第1034號A分段餘段(部分)及毗連政府土地
PROPOSED TEMPORARY PLACE OF RECREATION AND SPORTS
(MARTIAL ARTS TRAINING VENUE) FOR A PERIOD OF 5 YEARS
LOT 1034 S.A RP (PART) IN D.D.121 AND ADJOINING GOVERNMENT LAND,
TONG YAN SAN TSUEN, YUEN LONG

規劃署
PLANNING
DEPARTMENT



參考編號
REFERENCE No.
AYL-TYST/900

圖 PLAN
A-3

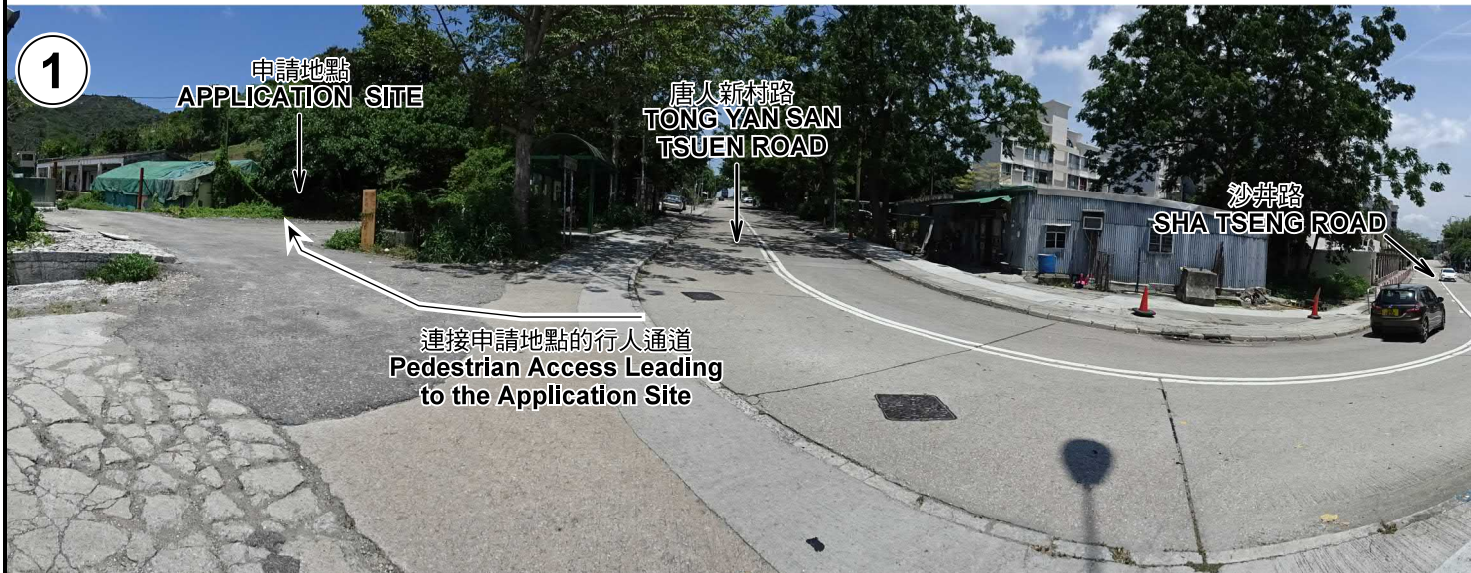

申請地點界線只作識別用 APPLICATION SITE BOUNDARY FOR IDENTIFICATION PURPOSE ONLY

實地照片 SITE PHOTOS

擬議臨時康體場所（國術體育會）（為期5年）
元朗唐人新村丈量約份第121約地段第1034號A分段餘段（部分）及毗連政府土地
PROPOSED TEMPORARY PLACE OF RECREATION AND SPORTS
(MARTIAL ARTS TRAINING VENUE) FOR A PERIOD OF 5 YEARS
LOT 1034 S.A RP (PART) IN D.D.121 AND ADJOINING GOVERNMENT LAND,
TONG YAN SAN TSUEN, YUEN LONG

規劃署
PLANNING
DEPARTMENT



本圖於2018年6月20日擬備，所根據的資料為攝於2018年5月18日的實地照片
PLAN PREPARED ON 20.6.2018
BASED ON SITE PHOTOS
TAKEN ON 18.5.2018

參考編號
REFERENCE No.
A/YL-TYST/900

圖 PLAN
A-4