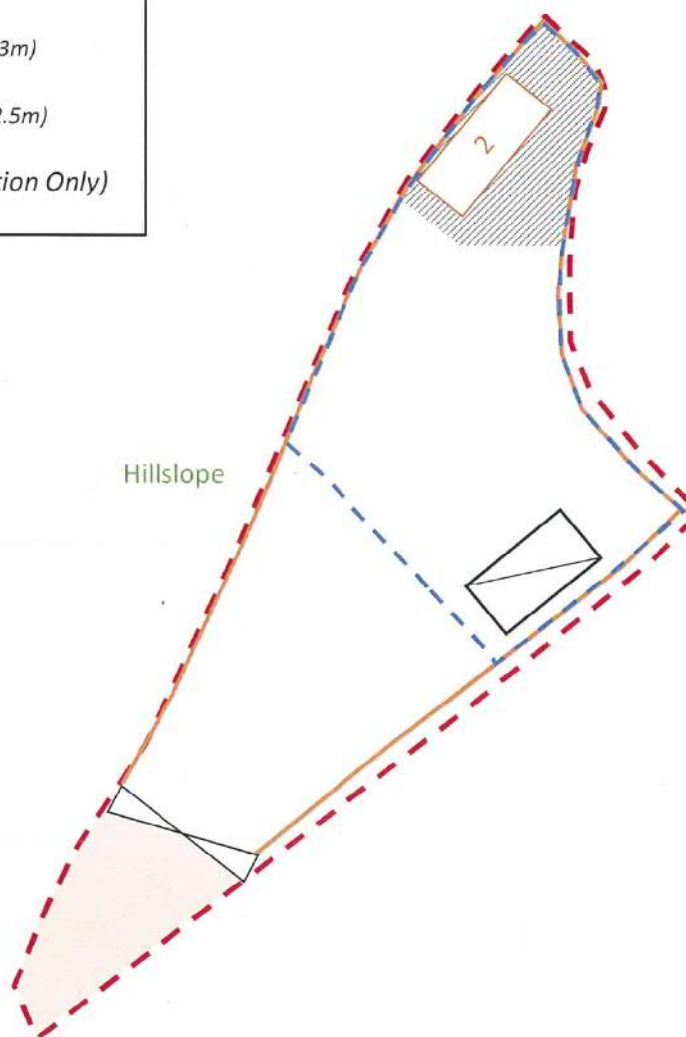

LEGEND:

-  The Application Site
-  Set Back Area
-  Structure
-  Container (2-storey)
-  Platform
(Connecting to upper Container)
-  Ingress/Egress (Width: 5.5m)
-  Fencing (Height: 2.8-5.3m)
-  Parking Space (5m x 2.5m)
(For Identification Only)

**Project:**

Section 16 Planning Application for Temporary Vehicle Repair Workshop with Ancillary Site Office (For Contractor Vehicles serving Public Works) for a Period of 3 Years at Lot 1 (Part) in D.D. 84, Ping Che, N.T.

Title:

Indicative Layout Plan

Ref.: ADCL/PLG-10153-L005/F001

Figure:

1

Scale:

Not to scale

Date:

Sep 2018



參考編號

REFERENCE No. A/NE-TKL/600

繪圖 DRAWING R-1

(來源 : 附件 A)
(Source : Annex A)

LEGEND:

The Application Site



Set Back Area



Structure



Container (2-storey)



Platform



Ingress/Egress (Width: 5.5m)



Fencing (Height: 2.8-5.3m)



New Planted Tree

(Species: *Ficus microcarpa*;
Total: 16 nos.; Min. Height: 2.75m;
Interval: 2.5m to 3m spacing)

(For Identification Only)

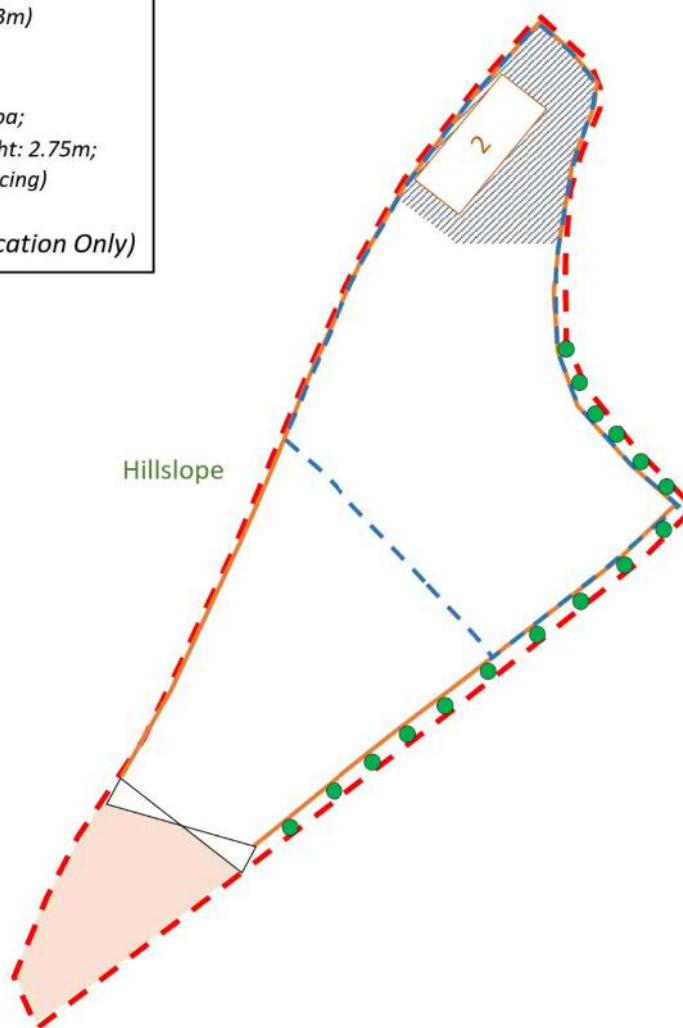
**Project:**

Section 16 Planning Application for Temporary Vehicle Repair Workshop with Ancillary Site Office (For Contractor Vehicles serving Public Works) for a Period of 3 Years at Lot 1 (Part) in D.D. 84, Ping Che, N.T.

Title:

Proposed Landscape Plan

Figure:

6

Scale:

Not to scale

Date:

June 2018

Ref.: ADCL/PLG-10153-R001/F006



AIKON DEVELOPMENT CONSULTANCY LTD.

參考編號

REFERENCE No. A/NE-TKL/600

繪圖 DRAWING R-2

(來源 : 附件 A)
(Source : Annex A)

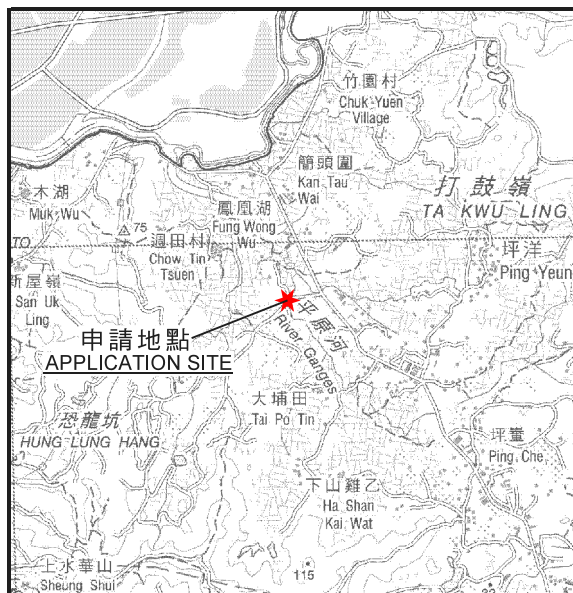

要覽圖 KEY PLAN

SCALE 1 : 50 000 比例尺

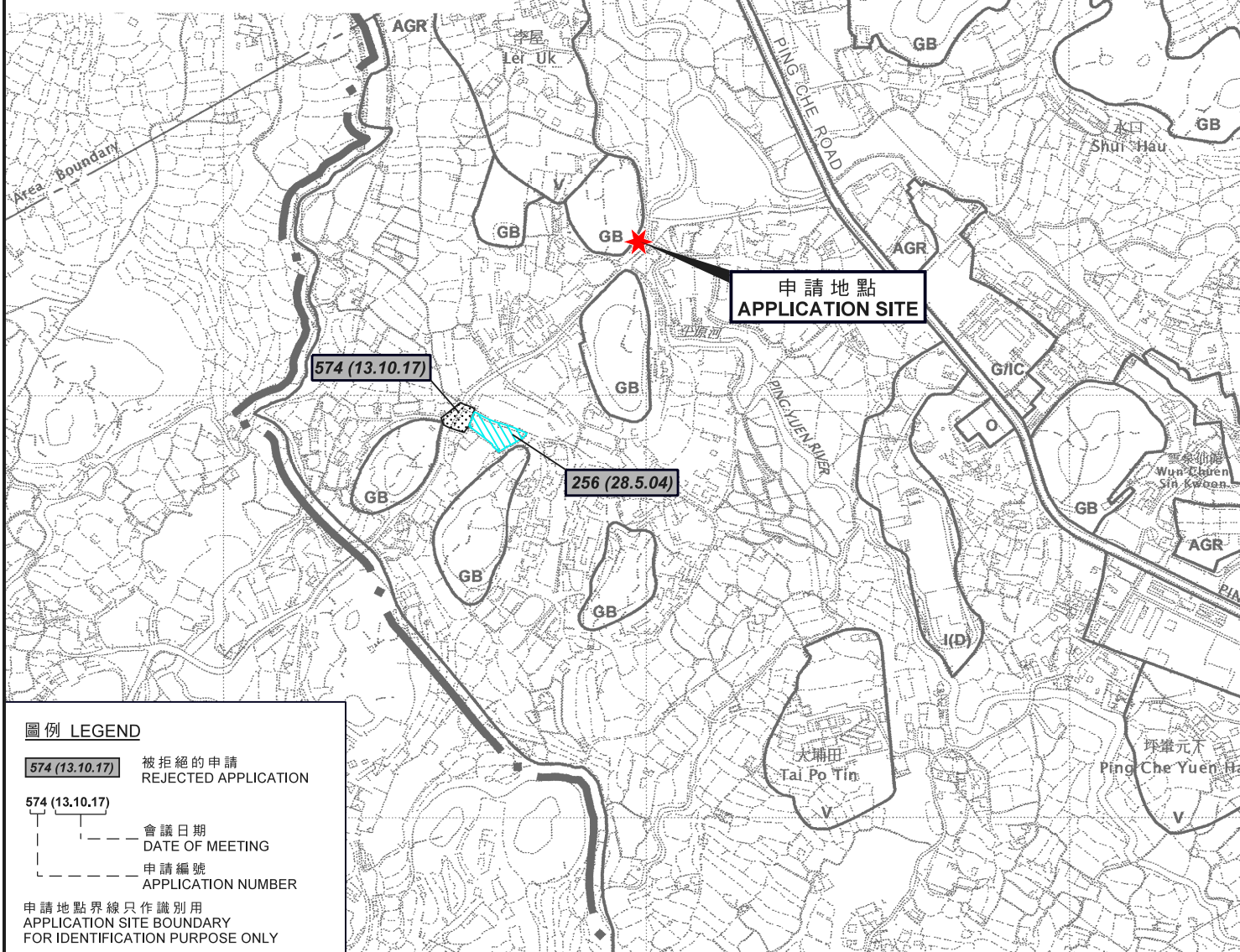

圖例 LEGEND

- 574 (13.10.17) 被拒絕的申請
REJECTED APPLICATION
- 574 (13.10.17) 會議日期
DATE OF MEETING
- 574 (13.10.17) 申請編號
APPLICATION NUMBER

申請地點界線只作識別用
APPLICATION SITE BOUNDARY
FOR IDENTIFICATION PURPOSE ONLY

位置圖 LOCATION PLAN

擬議臨時汽車修理工場 (公共工程承建商車輛)
連附設地盤辦公室 (為期3年)
新界打鼓嶺坪壩丈量約份第84約地段第1號(部分)
PROPOSED TEMPORARY VEHICLE REPAIR WORKSHOP WITH
ANCILLARY SITE OFFICE FOR CONTRACTOR VEHICLES
SERVING PUBLIC WORKS FOR A PERIOD OF 3 YEARS
LOT 1 (PART) IN D.D. 84, PING CHE, TA KWU LING, N.T.

SCALE 1 : 7 500 比例尺
米 100 0 100 200 300 米
METRES

規劃署
PLANNING
DEPARTMENT



參考編號
REFERENCE No.
A/NE-TKL/600

圖 PLAN
R-1

本摘要圖於2019年5月9日擬備，
所根據的資料為於2010年2月2日核准的
分區計劃大綱圖編號S/NE-TKL/14
EXTRACT PLAN PREPARED ON 9.5.2019
BASED ON OUTLINE ZONING PLAN
No. S/NE-TKL/14 APPROVED ON 2.2.2010

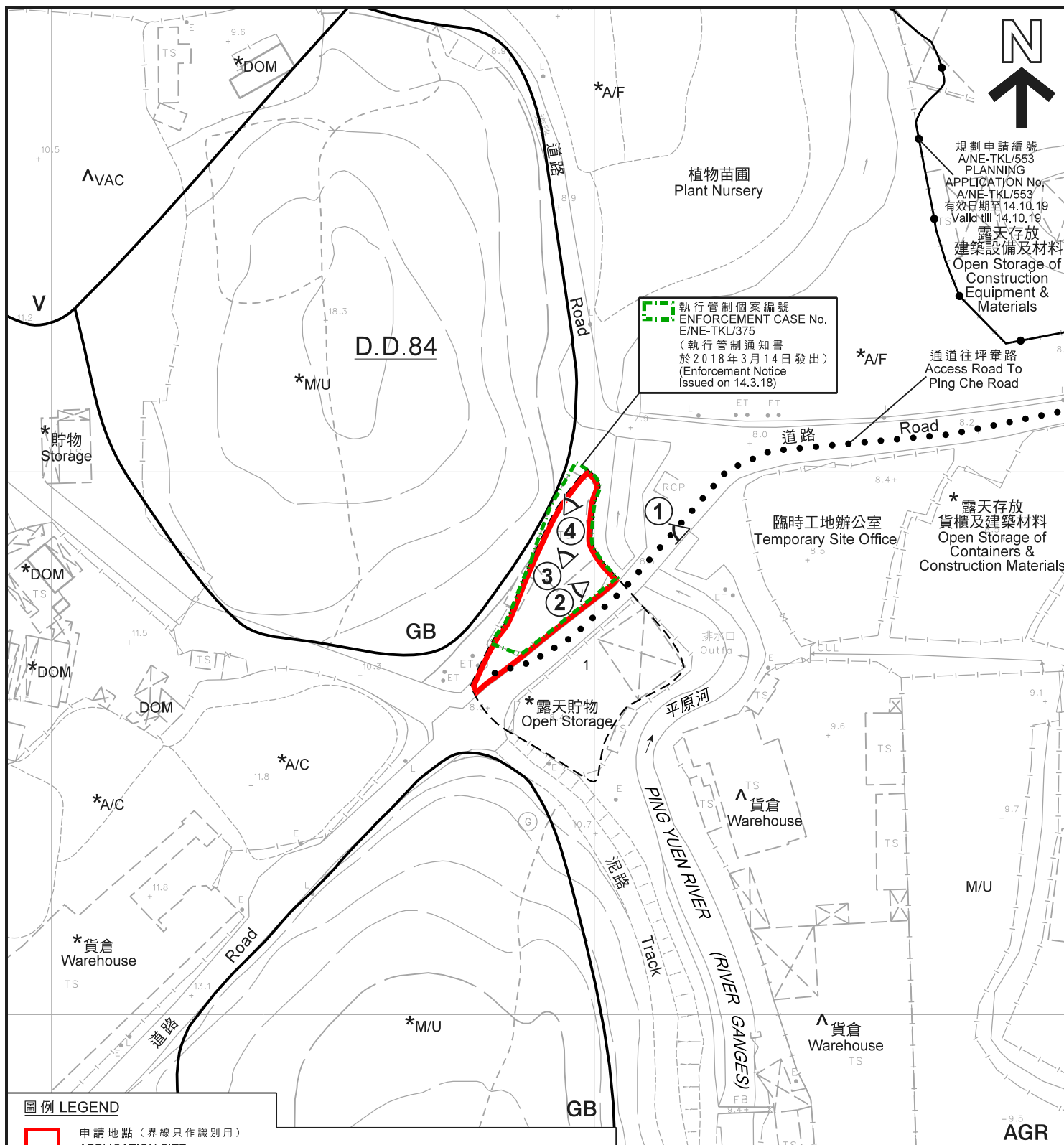

圖例 LEGEND

- 申請地點** (界線只作識別用)
APPLICATION SITE
(BOUNDARY FOR IDENTIFICATION
PURPOSE ONLY)
- AGR** 農業
AGRICULTURE
- GB** 綠化地帶
GREEN BELT
- V** 鄉村式發展
VILLAGE TYPE DEVELOPMENT
- ①** 實地照片的觀景點
VIEWING POINT OF SITE PHOTO

- A/C** 常耕農地
ACTIVE AGRICULTURAL LAND
- A/F** 休耕農地
FALLOW AGRICULTURAL LAND
- DOM** 住用構築物
DOMESTIC STRUCTURE
- M/U** 荒地
UNUSED LAND
- VAC** 空置
VACANT

註釋 Notes:

- (1) 2019年4月15日勘測的土地用途
Land uses shown on this plan are in accordance with the land use survey conducted by the Planning Department on 15.4.2019
- (2) * 土地用途跟1991年1月3日勘測的土地用途一致
Indicates that the use is the same as that revealed by the land use survey conducted by the Planning Department on 3.1.1991
- (3) ^ 土地用途跟1991年1月3日勘測的土地用途有別
Indicates that the use is different from that revealed by the land use survey conducted by the Planning Department on 3.1.1991

平面圖 SITE PLAN

擬議臨時汽車修理工場 (公共工程承建商車輛)
連附設地盤辦公室 (為期3年)
新界打鼓嶺坪輦丈量約份第84約地段第1號 (部分)
PROPOSED TEMPORARY VEHICLE REPAIR WORKSHOP WITH
ANCILLARY SITE OFFICE FOR CONTRACTOR VEHICLES
SERVING PUBLIC WORKS FOR A PERIOD OF 3 YEARS
LOT 1 (PART) IN D.D. 84, PING CHE, TA KWU LING, N.T.

SCALE 1 : 1 000 比例尺

米 20 0 20 40 米
METRES

規劃署
PLANNING
DEPARTMENT



參考編號
REFERENCE No.
A/NE-TKL/600

圖 PLAN
R-2

本摘要圖於2019年4月29日擬備，
所根據的資料為測量圖編號
3-NW-18C
EXTRACT PLAN PREPARED ON 29.4.2019
BASED ON SURVEY SHEET No.
3-NW-18C



圖例 LEGEND

申請地點（界線只作識別用）
APPLICATION SITE
(BOUNDARY FOR IDENTIFICATION
PURPOSE ONLY)

本摘要圖於2019年4月23日擬備，
所根據的資料為地政總署
於2018年3月12日拍得的航攝照片
編號E034435C
EXTRACT PLAN PREPARED ON 23.4.2019
BASED ON AERIAL PHOTO No. E034435C
TAKEN ON 12.3.2018 BY
LANDS DEPARTMENT

航攝照片 AERIAL PHOTO

擬議臨時汽車修理工場（公共工程承建商車輛）
連附設地盤辦公室（為期3年）
新界打鼓嶺坪輦丈量約份第84約地段第1號（部分）
PROPOSED TEMPORARY VEHICLE REPAIR WORKSHOP WITH
ANCILLARY SITE OFFICE FOR CONTRACTOR VEHICLES
SERVING PUBLIC WORKS FOR A PERIOD OF 3 YEARS
LOT 1 (PART) IN D.D. 84, PING CHE, TA KWU LING, N.T.

規劃署
PLANNING
DEPARTMENT

參考編號
REFERENCE No.
A/NE-TKL/600

圖 PLAN
R-3



實地照片 SITE PHOTOS

擬議臨時汽車修理工場（公共工程承建商車輛）
連附設地盤辦公室（為期3年）
新界打鼓嶺坪輦丈量約份第84約地段第1號（部分）
PROPOSED TEMPORARY VEHICLE REPAIR WORKSHOP WITH
ANCILLARY SITE OFFICE FOR CONTRACTOR VEHICLES
SERVING PUBLIC WORKS FOR A PERIOD OF 3 YEARS
LOT 1 (PART) IN D.D. 84, PING CHE, TA KWU LING, N.T.

規劃署
PLANNING
DEPARTMENT



參考編號
REFERENCE No.
A/NE-TKL/600

圖 PLAN
R-4a

本圖於2019年4月23日擬備，所根據
的資料為攝於2019年4月15日
的實地照片
PLAN PREPARED ON 23.4.2019 BASED ON
SITE PHOTOS TAKEN ON 15.4.2019



申請地點
APPLICATION SITE



申請地點的內部情景(一樓)
INSIDE OF APPLICATION SITE (1/F)

實地照片 SITE PHOTOS

擬議臨時汽車修理工場（公共工程承建商車輛）
連附設地盤辦公室（為期3年）
新界打鼓嶺坪輦丈量約份第84約地段第1號（部分）
PROPOSED TEMPORARY VEHICLE REPAIR WORKSHOP WITH
ANCILLARY SITE OFFICE FOR CONTRACTOR VEHICLES
SERVING PUBLIC WORKS FOR A PERIOD OF 3 YEARS
LOT 1 (PART) IN D.D. 84, PING CHE, TA KWU LING, N.T.

規劃署
PLANNING
DEPARTMENT



參考編號
REFERENCE No.
A/NE-TKL/600

圖 PLAN
R-4b

本圖於2019年4月23日擬備，所根據
的資料為攝於2019年4月15日
的實地照片
PLAN PREPARED ON 23.4.2019 BASED ON
SITE PHOTOS TAKEN ON 15.4.2019