

FOR FEHD REFERENCE	AREA (SQ.M.)
G.F.A.	234

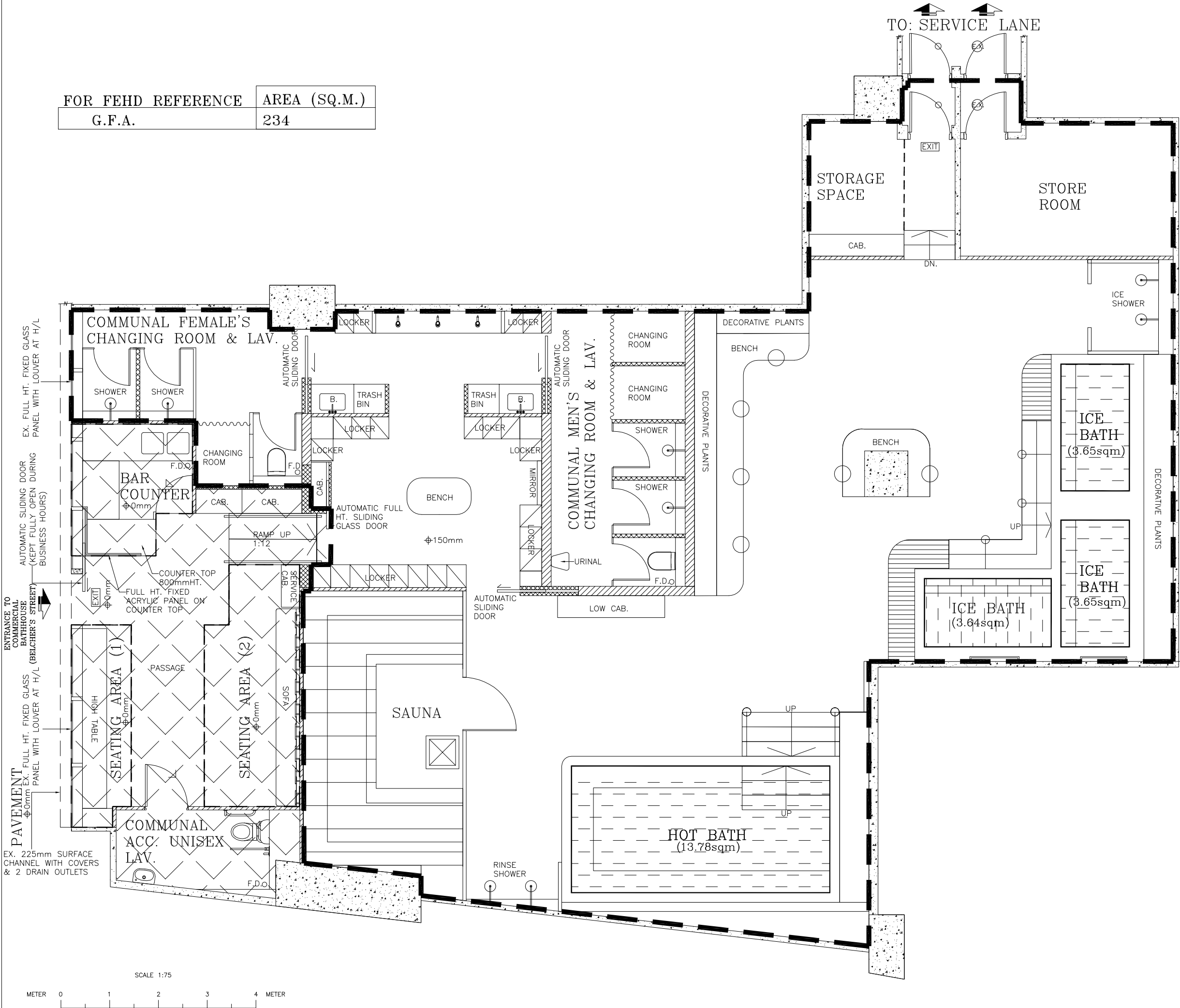

- NOTE :
- 1) ALL MEASUREMENT MUST BE CHECKED AT SITE.
  - 2) DO NOT SCALE DRAWING.
  - 3) DRAWING IS NOT VALID FOR CONSTRUCTION UNLESS EXPRESSEDLY CERTIFIED.
  - 4) DRAWING AND COPY-RIGHT ARE PROPERTY OF THE ARTS & DESIGN CONSULTANCY LIMITED.

LEGEND :

- EXISTING FULL HT. F.R.P. S.C. DOOR
- FULL HT. S.C. DOOR WITH F.R.R. -/60/60
- FULL HT. S.C. DOOR
- S.C. LOW DOOR 800mmHT.
- LICENCE AREA
- NON-LICENCE AREA UNDER THE SAME MANAGEMENT & CONTROL BY THE APPLICANT OF LIGHT REFRESHMENT RESTAURANT LICENCE
- FULL HT. BLOCK WALL PARTITION WITH F.R.R. -/60/60
- FULL HT. BLOCK WALL PARTITION
- FULL HT. WOODEN PARTITION
- EXISTING STRUCTURE WALL/COLUMN

A	FIRST ISSUE	JELLY	16-07-25	CL
REV.	DESCRIPTION	DRAWN	DATE	CHECKED
<div> <div> <div> ARTS &amp; DESIGN CONSULTANCY LTD.  雅仕顧問有限公司  (專業飲食牌照顧問)  HKQAA ISO9001:2015 CERTIFIED COMPANY  UNIT B, 11/F., FUK ON BUILDING,  NO. 1123 CANTON ROAD, MONGKOK, KLN.  九龍旺角廣東道1123號福安大廈11字樓B室  TEL. : 2787-2303 FAX : 2951-9574  Website: <a href="http://www.licenceconsultant.com">http://www.licenceconsultant.com</a>  E-mail: <a href="mailto:info@licenceconsultant.com">info@licenceconsultant.com</a> </div> </div> <div> </div> </div>				

PROJECT :

PROPOSED COMMERCIAL BATHHOUSE AT

LG/F ( Major Portion ),  
Kennedy 38,  
38 Belcher's Street,  
Hong Kong

DRAWING TITLE :

INDICATIVE LAYOUT PLAN

TYPE OF LICENCE :

COMMERCIAL BATHHOUSE LICENCE

ISSUE DATE : 16-07-25

REVISION : A

SCALE : 1:75 (A3)

DRAWN BY : JELLY

APPROVED : C.L.

FUEL USED : ELECTRICITY ONLY

FEHD REF.: X X X

BD REF.: X X X

FSD REF.: X X X

DWG NO.: J2503094

JOB NO.: J2503094-B

### **Entrance to proposed commercial bath house at Belcher's Street**

The proposed commercial bath house is **completely separated** from the upper residential floors, with **no intercommunication** whatsoever

Location of proposed commercial bath house at part of Shops 3-4 on the Lower Ground Floor, Belcher's Street

Area: 234 (SQ.M.)

**Legend :**



Proposed commercial bath house

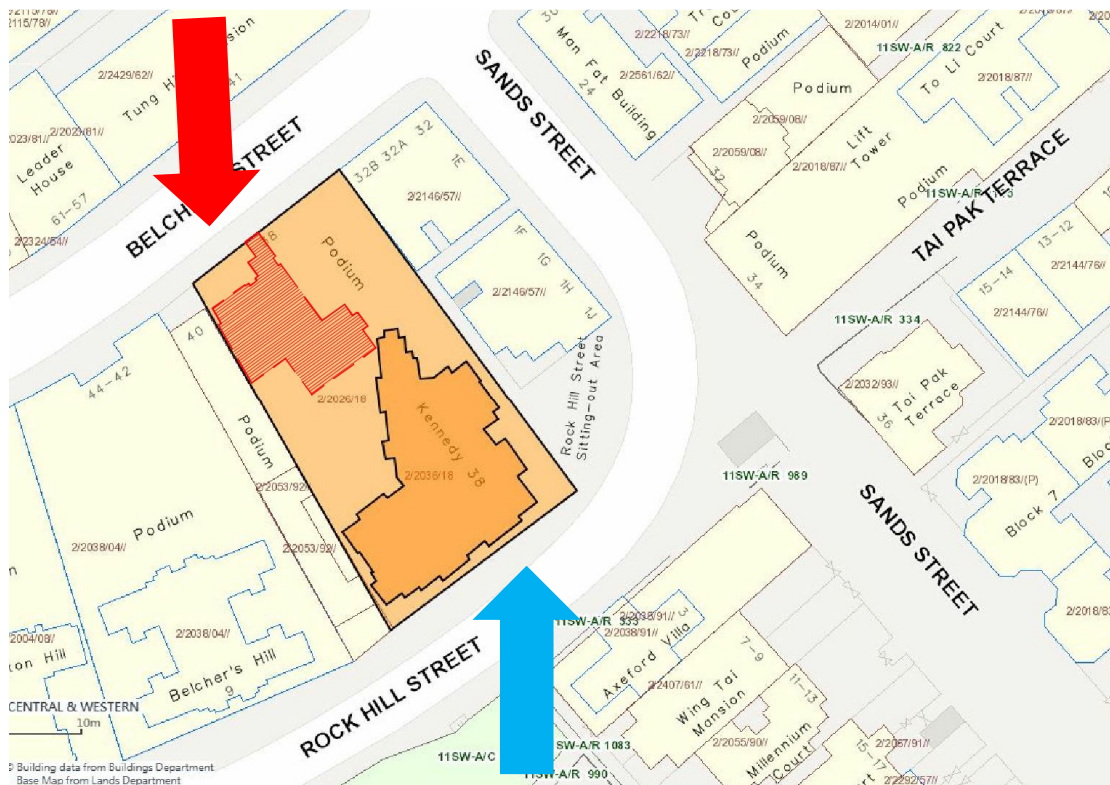

### **Entrance to upper floor domestic flats at Rock Hill Street**