**Responses-to-Comments Table and
Revised Sewerage Impact Assessment**

Prepared by

Ramboll Hong Kong Limited

**SECTION 16 PLANNING APPLICATION FOR PROPOSED
MINOR RELAXATION OF GROSS FLOOR AREA AND BUILDING
HEIGHT RESTRICTIONS FOR PERMITTED OFFICE USE AND
OTHER PERMITTED USES IN "COMMERCIAL (7)" ZONE
BOUNDED BY KING'S ROAD AND TAIKOO SHING ROAD,
QUARRY BAY**

SEWERAGE IMPACT ASSESSMENT

Date **May 2026**
Prepared by **Sally Chiu**
Assistant Environmental Consultant

Signed



Approved by

Tony Cheng
Senior Manager

Signed



Project Reference

SA1111KREI00

Document No.

R9433_v1.5.docx

No part of this document may be reproduced or transmitted, in any form or by any means electronic, mechanical, photographic, recording or otherwise, or stored in a retrieval system of any nature without the written permission of Ramboll Hong Kong Ltd, application for which shall be made to Ramboll Hong Kong Ltd, 21/F, BEA Harbour View Centre, 56 Gloucester Road, Wan Chai, Hong Kong.

Disclaimer: This report is made on behalf of Ramboll Hong Kong Ltd. No individual is personally liable in connection with the preparation of this report. By receiving this report and acting on it, the client or any third party relying on it accepts that no individual is personally liable in contract, tort or breach of statutory duty (including negligence).

Ramboll Hong Kong Limited

21/F, BEA Harbour View Centre
56 Gloucester Road, Wan Chai, Hong Kong

Tel: (852) 3465 2888
Fax: (852) 3465 2899
Email: hkinfo@ramboll.com

Q:\Projects\SA1111KREI00\04 Deliverables\01 SIA Report\v1.5\R9433_v1.5.docx

CHAPTERS

| | Page |
|--|----------|
| 1. INTRODUCTION | 1 |
| 1.1 Background and Objectives..... | 1 |
| 1.2 Proposed Development..... | 1 |
| 2. SEWERAGE IMPACT ASSESSMENT | 2 |
| 2.1 Scope of Work..... | 2 |
| 2.2 Assessment Criteria and Methodology | 2 |
| 2.3 Existing Sewerage System | 2 |
| 2.4 Wastewater Generated by the Existing and Proposed Development..... | 2 |
| 2.5 Assessment of Sewerage Impact | 3 |
| 3. CONCLUSION | 4 |

TABLES

| | | |
|-----------|--|---|
| Table 2-1 | Estimated Peak Flow from the Proposed Development..... | 3 |
|-----------|--|---|

FIGURES

| | |
|------------|---|
| Figure 1.1 | Location of "C(7)" Zone and 1111 King's Road Extension |
| Figure 1.2 | Indicative Floor Plan of 1111 King's Road Extension and Section Plan |
| Figure 2.1 | Existing Sewerage System in the Vicinity of the Subject Site |
| Figure 2.2 | Existing Sewerage System and Catchment Area in the Vicinity of the Subject Site |
| Figure 2.3 | Proposed Upgrading Sewerage System |

APPENDICES

| | |
|--------------|--|
| Appendix 2.1 | Detailed Sewerage Impact Assessment Calculations |
| Appendix 2.2 | Sewerage Record Plans obtained from DSD |

1. INTRODUCTION

1.1 Background and Objectives

- 1.1.1 The “Commercial (7)” (“C(7)”) zone bounded by King’s Road and Taikoo Shing Road on the Quarry Bay Outline Zoning Plan (OZP) consists of 1111 King’s Road (formerly known as Cityplaza One), Cityplaza and East Hong Kong.
- 1.1.2 The “C(7)” zone is subject to a maximum non-domestic gross floor area (GFA) of 123,129m² and is subject to 2 building height (BH) bands: 1111 King’s Road and East Hong Kong are subject to maximum BH of 135mPD; while Cityplaza in between 1111 King’s Road and East Hong Kong is subject to maximum BH of 45mPD.
- 1.1.3 In this planning application, to support office extension of 1111 King’s Road, extra GFA and BH is required for 1111 King’s Road. Therefore, two items that require planning permission from the Town Planning Board (the Board) are involved:
- Minor relaxation of the GFA restriction of “C(7)” zone from 123,129m² to 148,629m² (+25,500m² / 20.7%)
 - Minor relaxation of the BH restriction of 1111 King’s Road from 135mPD to 165mPD (+30m / 22.2%)
- 1.1.4 The increase in GFA and BH will be absorbed by 1111 King’s Road only, other buildings in the “C(7)” zone will not be affected.
- 1.1.5 The location of “C(7)” Zone and 1111 King’s Road extension is shown in **Figure 1.1**.
- 1.1.6 Ramboll Hong Kong Limited is commissioned by the project proponent to carry out sewerage impact assessment for the additional sewage generated from the development arising from the proposed minor relaxation of GFA and BH restrictions.

1.2 Proposed Development

- 1.2.1 The Applicant proposes additional GFA and BH to 1111 King’s Road for its extension above the existing office building. The proposed extension will be constructed on top of the existing office building, no changes to the existing 1111 King’s Road will be made.
- 1.2.2 The existing GFA of 1111 King’s Road is about 78,069m². This planning application applies for an increase in office GFA, bringing 13 new storeys to the existing office building of 1111 King’s Road, involving 25,500m² increase in GFA for office use. Out of the 13 new storeys, 10 storeys will be for office use, 2 floors are for mechanical and electrical (M&E) facilities, and 1 floor will be designated as refuge floor-cum-sky garden. **Figure 1.2** shows the indicative floor plan of 1111 King’s Road extension and section plan.
- 1.2.3 The tentative completion of Proposed Development is in Year 2029.

2. SEWERAGE IMPACT ASSESSMENT

2.1 Scope of Work

- 2.1.1 The aim of this SIA is to assess if existing sewerage network is sufficient to cope with the additional sewage flow from the Proposed Development and propose corresponding mitigation measures if necessary.

2.2 Assessment Criteria and Methodology

- 2.2.1 The Commercial and Industrial Floor Space Utilization Survey (CIFSUS) conducted by the Planning Department has been used to determine the worker density for various economic activities and planned usage types.
- 2.2.2 Environmental Protection Department's (EPD's) Guidelines for Estimating Sewage Flows for Sewage Infrastructure Planning, Version 1 (GESF) has been referred to for the purposes of estimating the quantity of the sewage generated from the Proposed Development. Sewage flow parameters and global peaking factors in this document have been adopted for this SIA.
- 2.2.3 According to the GESF, the overall unit flow is composed of flows due to employees and the associated activities. The following unit flow factors of commercial activities have been adopted in the SIA calculation in accordance with Tables T-1, T-2 and T-3 of the GESF:
- J6 – Finance, Insurance, Real Estate & Business Services: 0 m³/day
- 2.2.4 The catchment inflow, P_{CIF} of 1.25 (Shau Kei Wan), is adopted in catchment calculations.

2.3 Existing Sewerage System

- 2.3.1 According to the Geoinfo Map, the sewers discharged from Proposed Development will be conveyed to the existing public manhole **FMH7036295**.

2.4 Wastewater Generated by the Existing and Proposed Development

- 2.4.1 The increase in GFA covers the use of office use, M&E facilities and refuge floor-cum-sky garden. As a conservative assessment, it is assumed all additional area is for office use.
- 2.4.2 Detailed calculations of sewage generation from the Existing and Proposed Development are given in **Table 2-1** below and **Appendix 2.1**.

Table 2-1 Estimated Peak Flow from the Proposed Development

| Calculation for Sewage Generation Rate of the Proposed Development at the Subject Site | | | |
|---|---|-------------|---|
| 1. Office | | | |
| Assumed Area | = | 25500 | m ² |
| Assumed floor area per employee | = | 18.2 | m ² per employee -- (refer to Table 8 of CIFSUS – Financial, Insurance, Real Estate & Business Services) |
| Total number of employees | = | 1403 | employees |
| Design flow for commercial employees | = | 0.08 | m ³ /employee/day – (refer to Table T-3 of GESF – J6 Finance, Insurance, Real Estate & Business Services) |
| Sewerage generation rate | = | 112.2 | m ³ /day |
| Total Flow from the Proposed Development | | | |
| Flow rate | = | 112.2 | m ³ /day |
| Flow rate with P _{CF} | = | 140.3 | m ³ /day (refer to Table T-4 of GESF – Shau Kei Wan - 1.25) people (refer to Section 12 of GESF -- Contributing population is the Flow rate with P _{CF} ÷ 0.27, while 0.27 is the average unit flow factor of all typical residents plus employees) |
| Contributing population | = | 520 | (refer to Table T-5 of GESF for a population between 5,000 – 10,000 incl. stormwater allowance) |
| Peaking factor | = | 8 | |
| Peak flow | = | 13.0 | litre/sec |

2.5 Assessment of Sewerage Impact

- 2.5.1 Sewage generated from the Proposed Development will be discharged to the existing public manhole **FMH7036295** at Taikoo Shing Road as shown in **Figure 2.1**. The sewerage record plans obtained from Drainage Services Department (DSD) are attached in **Appendix 2.2**. Catchment in the vicinity of the Subject Site is shown in **Figure 2.2**.
- 2.5.2 Detailed calculation of sewage generation, peak flow estimation and the capacity of the public sewers can be referred to **Appendix 2.1**. Based on the assessment results, sewers (FMH7036243 to FMH7036248, FMH7036249 to **FMH7036270** and FSH7001300 to FMH7036294) would not have sufficient capacity for the future public sewers to cater for the sewage generated from the Proposed Development as well as the surrounding existing buildings.
- 2.5.3 Upgrading works on the sewers (FMH7036243 to FMH7036248, FMH7036249 to **FMH7036270** and FSH7001300 to FMH7036294) by the project proponent are required. About 383m of sewers required upgrading works. The details of the proposed upgrading sewers can be referred to **Table 12 of Appendix 2.1** and **Figure 2.3**.
- 2.5.4 The sewage generated from the Proposed Development would be conveyed to the nearby Tai Koo Shing Pumping Station (TKSPS) with its design capacity of **22,464m³/day** (i.e. 260 L/s). It will occupy 5% of the TKSPS which is deemed insignificant. Therefore, it can be deduced that the capacity of the TKSPS and the pipes connected to TKSPS are enough for the sewage generated from the Proposed Development. The contributions of sewage generated from the Subject Site on TKSPS can be referred to Table 13 of **Appendix 2.1**.
- 2.5.5 After the proposed upgrading pipe works, there would not have any adverse impact on the public sewerage system.

3. CONCLUSION

- 3.1.1 The potential sewerage impact arising from the Proposed Development has been quantitatively assessed by comparing the estimated sewage flow from the existing development and Proposed Development.
- 3.1.2 Based on the calculations as shown in **Appendix 2.1**, the increase in GFA for the Proposed Development would generate the peak flow of 13 L/s. Upgrading works on the sewers (FMH7036243 to FMH7036248, FMH7036249 to **FMH7036270** and FSH7001300 to FMH7036294) are required. About 383m of sewers required upgrading works.
- 3.1.3 The capacity of existing sewers and Tai Koo Shing Pumping Station are sufficient to cater for the sewage generated from the Proposed Development.
- 3.1.4 After the proposed upgrading pipe works, there would not have any adverse impact on the public sewerage system

Figure

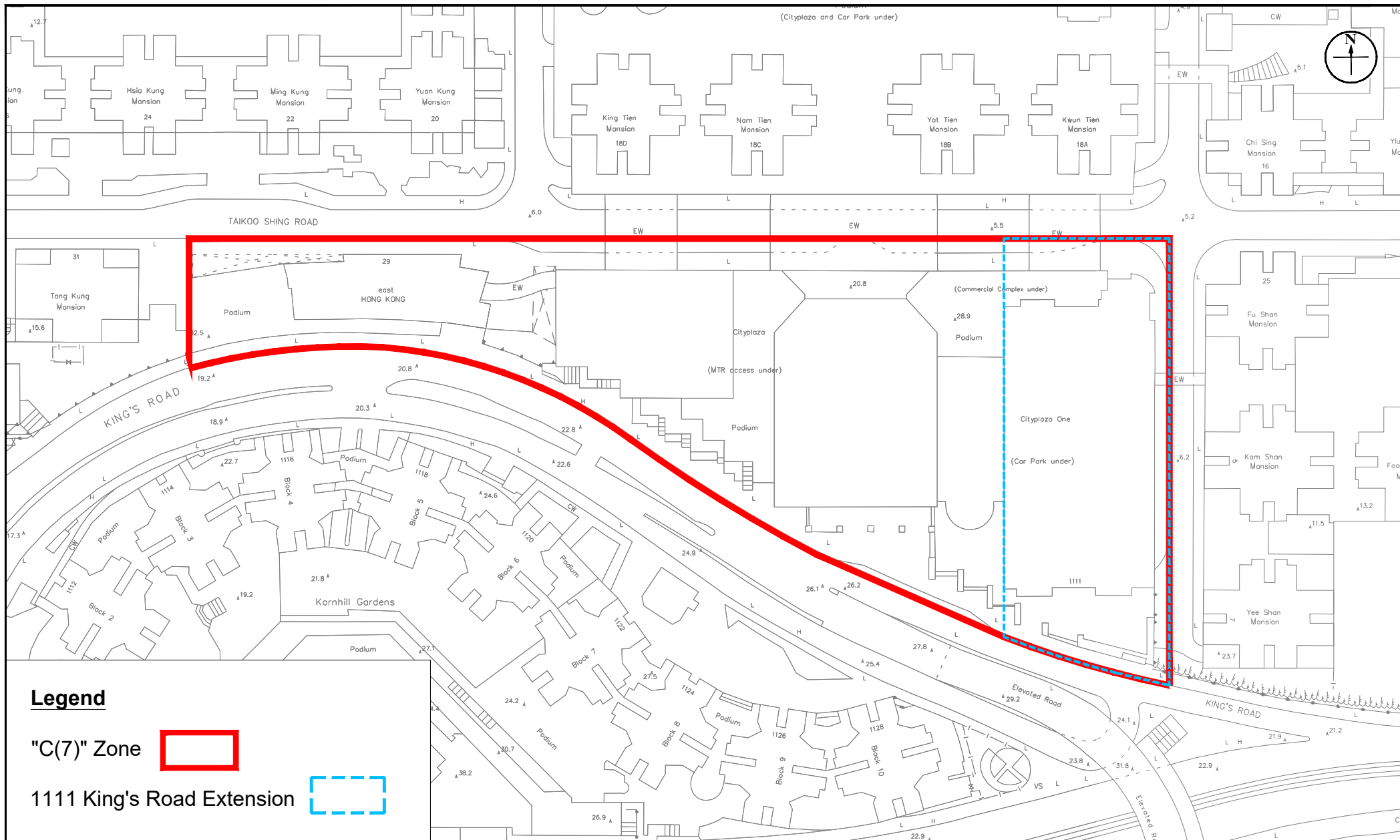

Legend

"C(7)" Zone



1111 King's Road Extension



Figure: 1.1

Title: Location of "C(7)" Zone and 1111 King's Road Extension

Project: Section 16 Planning Application for Proposed Minor Relaxation of Gross Floor Area and Building Height Restrictions for Permitted Office Use and Other Permitted Uses in "Commercial (7)" Zone Bounded by King's Road and Taikoo Shing Road, Quarry Bay

RAMBOLL

Drawn by: SC

Checked by: TC

Rev.: 1.1

Date: Dec 2025

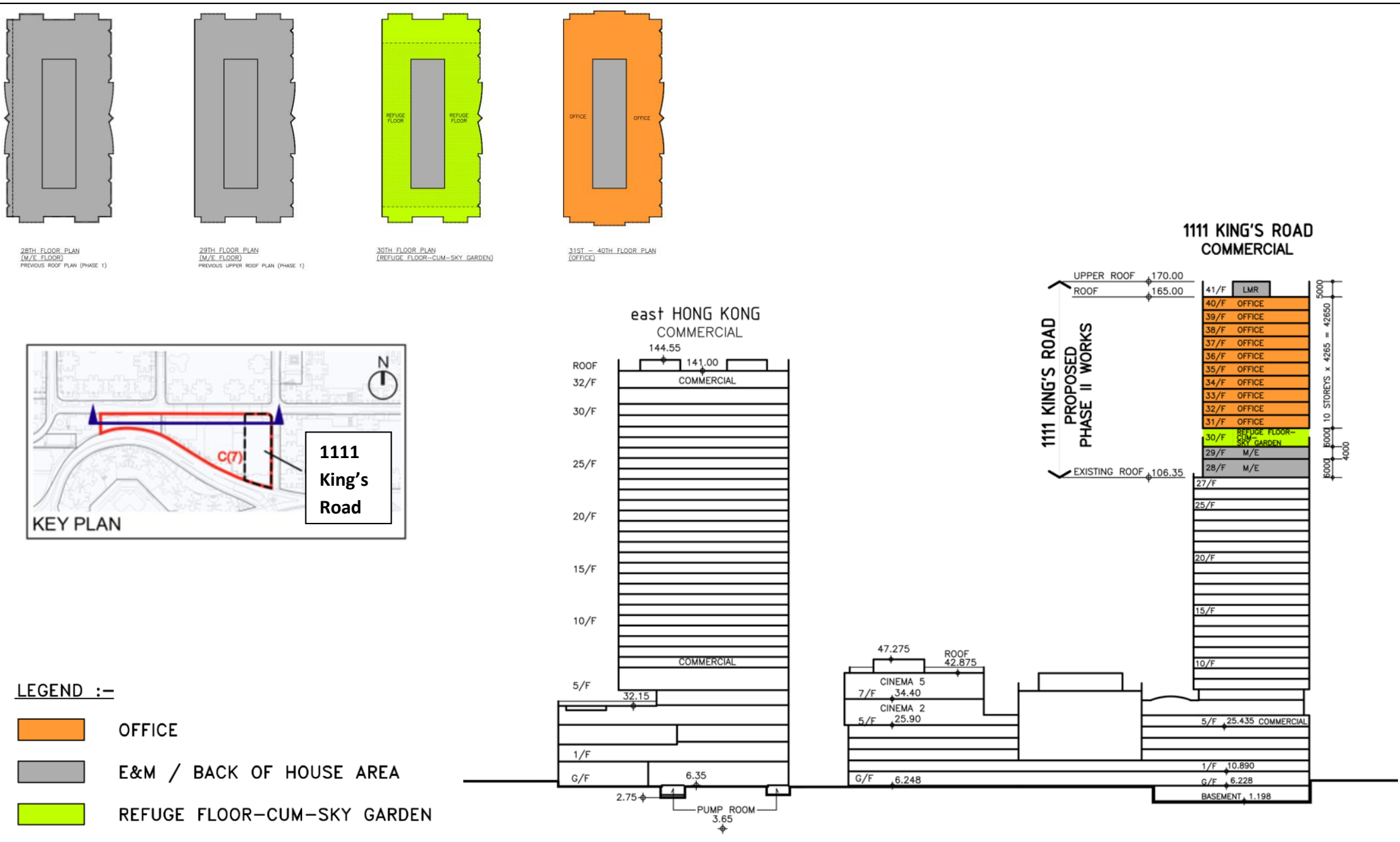

Figure: 1.2

Title: Indicative Floor Plan of 1111 King's Road Extension and Section Plan

Project: Section 16 Planning Application for Proposed Minor Relaxation of Gross Floor Area and Building Height Restrictions for Permitted Office Use and Other Permitted Uses in "Commercial (7)" Zone bounded by King's Road and Taikoo Shing Road, Quarry Bay



Drawn by: KW

Checked by: TC

Rev.: 1.0

Date: Dec 2025

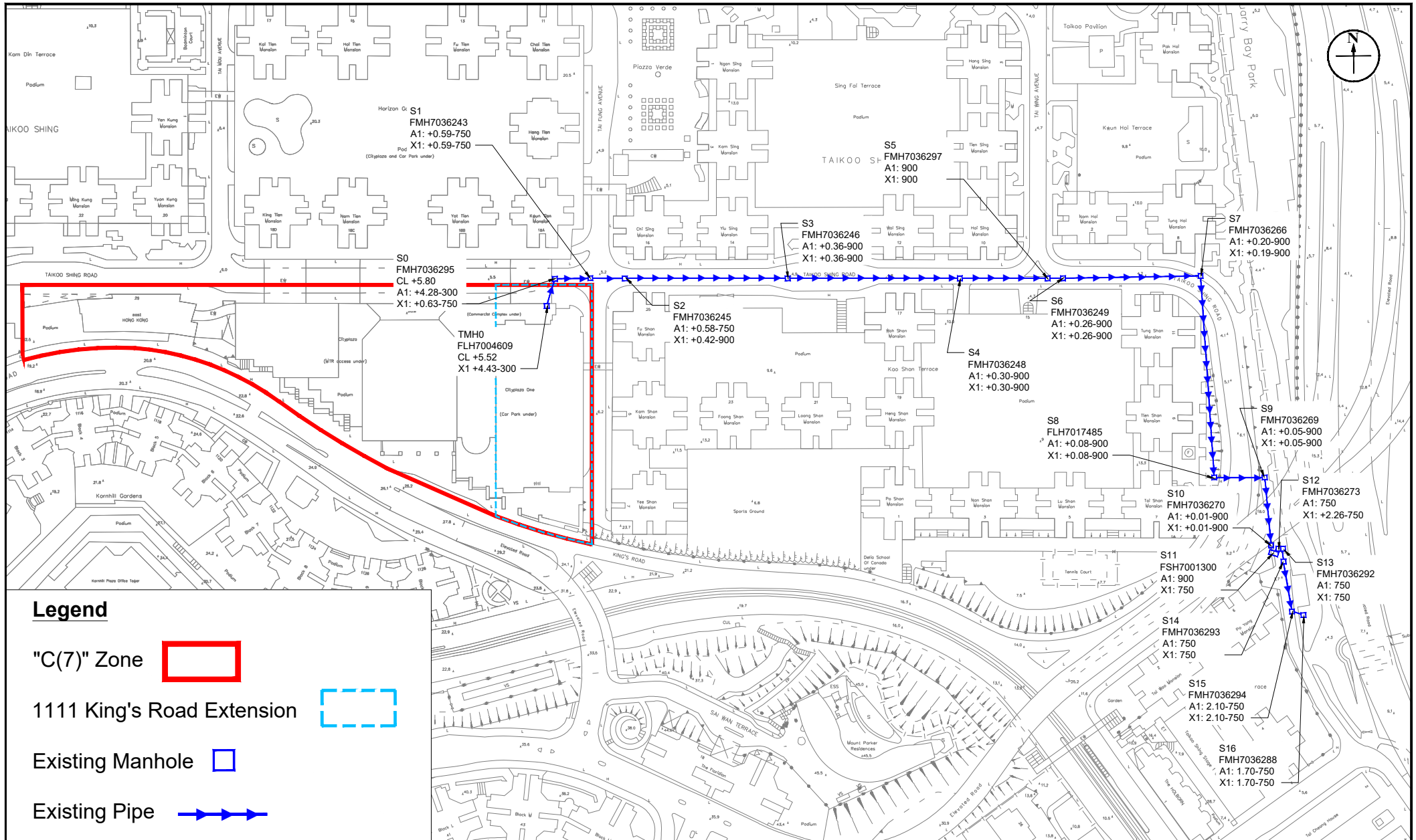

Figure: 2.1

Title: Existing Sewerage System in the Vicinity of the Subject Site

Project: Section 16 Planning Application for Proposed Minor Relaxation of Gross Floor Area and Building Height Restrictions for Permitted Office Use and Other Permitted Uses in "Commercial (7)" Zone Bounded by King's Road and Taikoo Shing Road, Quarry Bay

RAMBOLL

Drawn by: SC

Checked by: TC

Rev.: 1.0

Date: Dec 2025

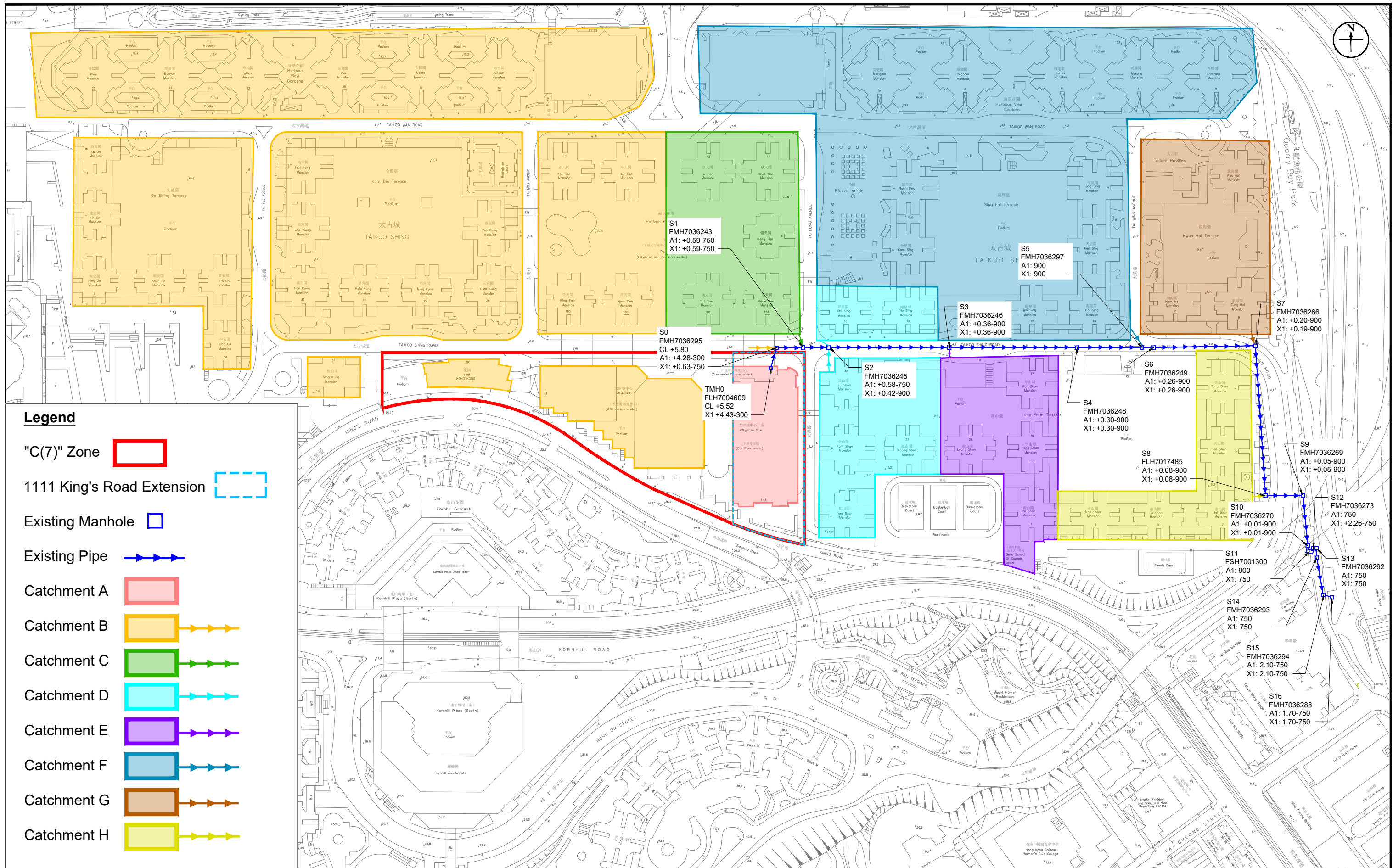

Figure: 2.2

Title: Existing Sewerage System and Catchment Area in the Vicinity of the Subject Site

Project: Section 16 Planning Application for Proposed Minor Relaxation of Gross Floor Area and Building Height Restrictions for Permitted Office Use and Other Permitted Uses in "Commercial (7)" Zone Bounded by King's Road and Taikoo Shing Road, Quarry Bay

RAMBOLL

Drawn by: SC

Checked by: TC

Rev.: 1.0

Date: Dec 2025

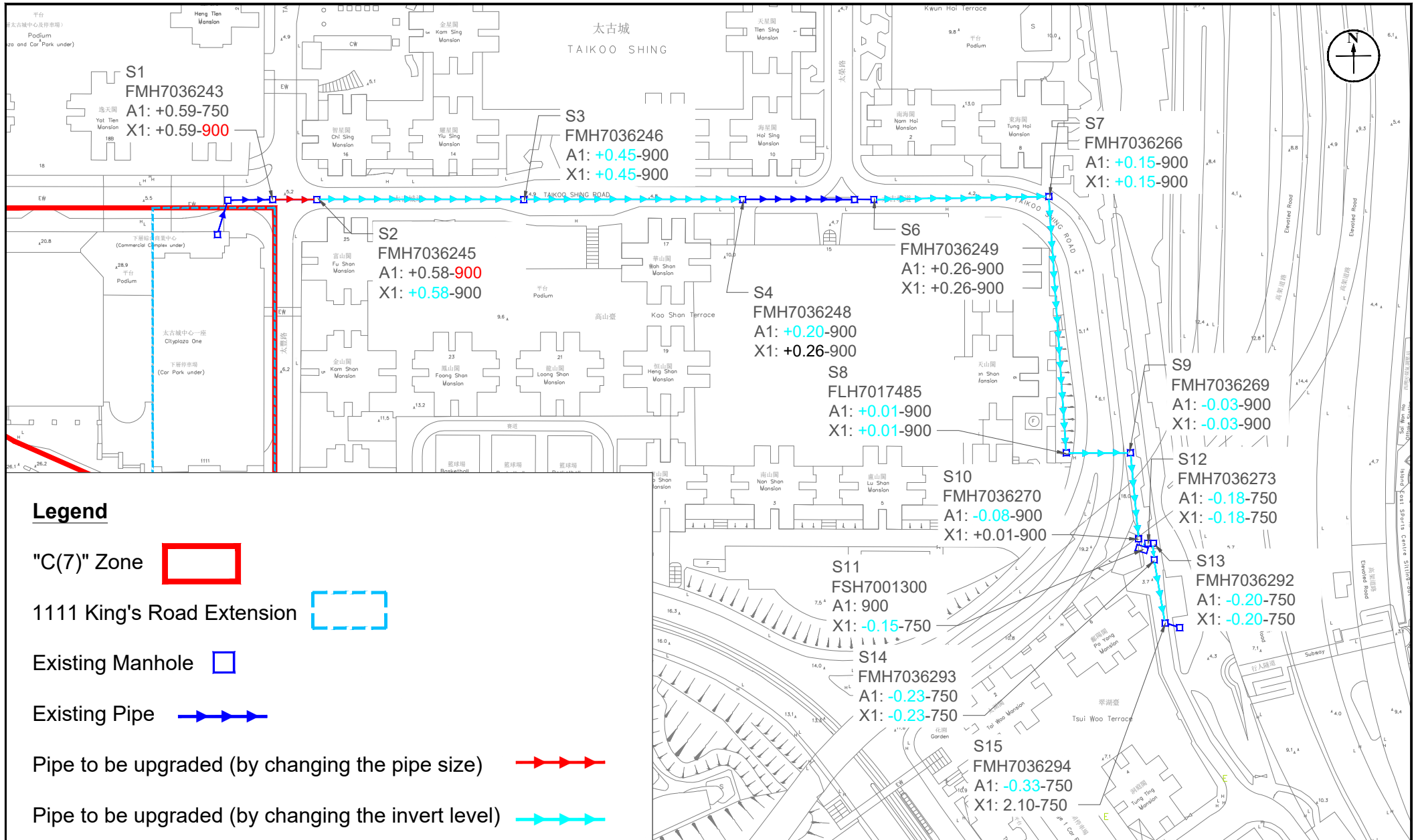

Appendix 2.1 Detailed Sewerage Impact Assessment Calculations

Table 1 Calculation for Sewage Generation Rate of the Future Development (Proposed Additional Office at 1111 King's Road)

| | | | |
|---|---|--------------------|---|
| 1. Office | | | |
| Assumed area | = | 25500 | m ² |
| Assumed floor area per employee | = | 18.2 | m ² per employee -- (refer to Table 8 of CIFSUS - Financial, Insurance, Real Estate & Business Services) |
| Total number of employees | = | 1403 | employees |
| Design flow for commercial employees | = | 0.08 | m ³ /employee/day -- (refer to Table T-2 of GESF - J6 Finance, Insurance, Real Estate & Business Services) |
| Sewage generation rate | = | 112.2 | m ³ /day |
| Total Flow from the Future Development | | | |
| Flow rate | = | 112.2 | m ³ /day |
| Flow rate with P _{CIF} | = | 140.3 | m ³ /day (refer to Table T-4 of GESF - Shau Kei Wan - 1.25) |
| Contributing population | = | 520 | people (refer to Section 12 of GESF -- Contributing population is the Flow rate with P _{CIF} ÷ 0.27, while 0.27 is the average unit flow factor of all typical residents plus employees) |
| Peaking factor | = | 8 | (refer to Table T-5 of GESF for a population <1,000 incl. stormwater allowance) |
| Peak flow | = | <u>13.0</u> | litre/sec |

Table 2 Calculation for Sewage Generation Rate of Catchment A

1. 1111 King's Road

| | | | |
|--------------------------------------|---|--------------|---|
| Assumed area | = | 78069 | m ² |
| Assumed floor area per employee | = | 18.2 | m ² per employee -- (refer to Table 8 of CIFSUS - Financial, Insurance, Real Estate and Business Services) |
| Total number of employees | = | 4294.0 | employees |
| Design flow for commercial employees | = | 0.08 | m ³ /employee/day -- (refer to Table T-2 of GESF - J6 Finance, Insurance, Real Estate and Business Services) |
| Sewage generation rate | | 343.5 | m ³ /day |

Total Flow from the Future Development and Catchment A

| | | | |
|---------------------------------|---|--------------------|---|
| Flow rate | = | 455.8 | m ³ /day |
| Flow rate with P _{CIF} | = | 569.7 | m ³ /day (refer to Table T-4 of GESF - Shau Kei Wan - 1.25) |
| Contributing population | = | 2110 | people (refer to Section 12 of GESF -- Contributing population is the Flow rate with P _{CIF} ÷ 0.27, while 0.27 is the average unit flow factor of all typical residents plus employees) |
| Peaking factor | = | 6 | (refer to Table T-5 of GESF for a population between 1,000 - 5,000 incl. stormwater allowance) |
| Peak flow | = | <u><u>39.6</u></u> | litre/sec |

Table 3 Calculation for Sewage Generation Rate of Catchment B

| | | | |
|---|---|----------------|--|
| 1a. On Shing Terrace | | | |
| Number of units | = | 1357 | units (from Centaline: https://hk.centanet.com/estate/en/Taikoo-Shing/2-OVDUURFSJJ) |
| Number of residents | = | 3800 | residents (refer to Census and Statistics Department 2021 data - average household size of 2.8 in Eastern) |
| Design flow | = | 0.27 | m ³ /day (Private R2 in Table T-1 of GESF) |
| Sewage generation rate | = | 1026.0 | m ³ /day |
| 1b. Restaurants | | | |
| Assumed area | = | 2201 | m ² |
| Assumed floor area per employee | = | 19.6 | m ² per employee -- (refer to Table 8 of CIFSUS - Restaurant) |
| Total number of employees | = | 112 | employees |
| Design flow for commercial employees | = | 1.58 | m ³ /employee/day -- (refer to Table T-2 of GESF - J10 Restaurant & Hotels) |
| Sewage generation rate | = | 177.4 | m ³ /day |
| 2. Kam Din Terrace | | | |
| Number of units | = | 1663 | units (from centaline: https://hk.centanet.com/estate/en/Taikoo-Shing-Kam-Din-Terrace/2-OVDUURFSSJ) |
| Number of residents | = | 4656 | residents (refer to Census and Statistics Department 2021 data - average household size of 2.8 in Eastern) |
| Design flow | = | 0.27 | m ³ /day (Private R2 in Table T-1 of GESF) |
| Sewage generation rate | = | 1257.1 | m ³ /day |
| 3a. East Hong Kong | | | |
| Assumed area | = | 21476.8 | m ² (measured in Geoinfo Map 784 m2 x 29 storeys x 80% + Podium: 1370 x 3 storeys x 80%) |
| Assumed floor area per employee | = | 31.3 | m ² per employee -- (refer to Table 8 of CIFSUS - Hotels and Boarding Houses) |
| Total number of employees | = | 687 | employees |
| Design flow for commercial employees | = | 1.58 | m ³ /employee/day -- (refer to Table T-2 of GESF - J10 Restaurant & Hotels) |
| Sewage generation rate | = | 1085.9 | m ³ /day |
| 3b. East Hong Kong (Outdoor Swimming Pool) | | | |
| Assumed area | = | 300 | m ² (Assumed 100m x 3m) |
| Assumed depth of water | = | 1.5 | m |
| Volume of water | = | 450.0 | m ³ |
| Turnover Rate | = | 6.0 | hr (CAP132, Section 42 Swimming Pools Regulation (open air pool)) |
| Surface loading rate of filter | = | 50.0 | m ³ /m ² /hr |
| Filter areas required | = | 1.5 | m ² |
| Backwashing flow rate | = | 30.0 | m ³ /m ² /hr |
| Design flow for backwashing | = | 45.0 | m ³ /hr |
| Backwash duration | = | 3.0 | min/day |
| Backwash generation rate | = | 2.25 | m ³ /day |
| Backwash generation rate | = | 12.5 | litre/sec |
| 4a. City Plaza (Retail) | | | |
| Assumed Area | = | 20046 | m ² (Assume 85% of GFA is Retail) |
| Assumed floor area per employee | = | 29.4 | m ² per employee -- (refer to Table 8 of CIFSUS - All Economic Activities (All Types)) |
| Total number of employees | = | 682.0 | employees |
| Design flow for commercial employees | = | 0.28 | m ³ /employee/day -- (refer to Table T-2 of GESF) |
| Sewage generation rate | = | 191.0 | m ³ /day |
| 4b. City Plaza (F&B) | | | |
| Assumed Floor Area | = | 3538 | m ² (Assume 15% of GFA is F&B) |
| Assumed floor area per employee | = | 19.6 | m ² per employee -- (refer to Table 8 of CIFSUS - Restaurant) |
| Total number of employees | = | 180 | employees |
| Design flow for commercial employees | = | 1.58 | m ³ /employee/day -- (refer to Table T-2 of GESF - J10 Restaurant & Hotels) |
| Sewage generation rate | = | 285.1 | m ³ /day |

5a. Harbour View Gardens (West)

| | | | |
|------------------------|---|---------------|--|
| Number of units | = | 1328 | units (from Centaline: https://hk.centanet.com/estate/en/Taikoo-Shing/2-OVDUURFSUJ) |
| Number of residents | = | 3718 | residents (refer to Census and Statistics Department 2021 data - average household size of 2.8 in Eastern) |
| Design flow | = | 0.27 | m ³ /day (Private R2 in Table T-1 of GESF) |
| Sewage generation rate | = | 1003.9 | m ³ /day |

5b. Swimming Pool in Harbour View Gardens

| | | | |
|--------------------------------|---|-------------|---|
| Assumed area | = | 248.7 | m ² |
| Assumed depth of water | = | 1.5 | m |
| Volume of water | = | 373.0 | m ³ |
| Turnover Rate | = | 6.0 | hr (CAP132, Section 42 Swimming Pools Regulation (open air pool)) |
| Surface loading rate of filter | = | 50.0 | m ³ /m ² /hr |
| Filter areas required | = | 1.2 | m ² |
| Backwashing flow rate | = | 30.0 | m ³ /m ² /hr |
| Design flow for backwashing | = | 37.3 | m ³ /hr |
| Backwash duration | = | 3.0 | min/day |
| Backwash generation rate | = | 1.86 | m ³ /day |
| Backwash generation rate | = | 10.4 | litre/sec |

6. 14 Tai Koo Wan Road

| | | | |
|--------------------------------------|---|-------------|---|
| Assumed Area | = | 32962 | m ² |
| Assumed floor area per employee | = | 29.4 | m ² per employee -- (refer to Table 8 of CIFSUS - All Economic Activities (All Types)) |
| Total number of employees | = | 1121 | employees |
| Design flow for commercial employees | = | 0.08 | m ³ /employee/day -- (refer to Table T-2 of GESF) |
| Sewage generation rate | = | 89.7 | m ³ /day |

7a. Horizon Gardens (Kai Tien Mansion, Hoi Tien Mansion, King Tien Mansion, Nam Tien Mansion)

| | | | |
|------------------------|---|--------------|--|
| Number of units | = | 768 | units |
| Number of residents | = | 2150 | residents (refer to Census and Statistics Department 2021 data - average household size of 2.8 in Eastern) |
| Design flow | = | 0.27 | m ³ /day (Private R2 in Table T-1 of GESF) |
| Sewage generation rate | = | 580.5 | m ³ /day |

7b. Swimming Pool in Horizon Gardens

| | | | |
|--------------------------------|---|-------------|---|
| Assumed area | = | 490.0 | m ² |
| Assumed depth of water | = | 1.5 | m |
| Volume of water | = | 735.0 | m ³ |
| Turnover Rate | = | 6.0 | hr (CAP132, Section 42 Swimming Pools Regulation (open air pool)) |
| Surface loading rate of filter | = | 50.0 | m ³ /m ² /hr |
| Filter areas required | = | 2.5 | m ² |
| Backwashing flow rate | = | 30.0 | m ³ /m ² /hr |
| Design flow for backwashing | = | 73.5 | m ³ /hr |
| Backwash duration | = | 3.0 | min/day |
| Backwash generation rate | = | 3.68 | m ³ /day |
| Backwash generation rate | = | 20.4 | litre/sec |

**8a. Half of City Plaza (Under Horizon Gardens)
(Retail)**

| | | | |
|--------------------------------------|---|--------------|---|
| Assumed Area | = | 21619 | m ² (Assume 80% of GFA is retail) |
| Assumed floor area per employee | = | 29.4 | m ² per employee -- (refer to Table 8 of CIFSUS - All Economic Activities (All Types)) |
| Total number of employees | = | 735 | employees |
| Design flow for commercial employees | = | 0.28 | m ³ /employee/day -- (refer to Table T-2 of GESF) |
| Sewage generation rate | = | 205.8 | m ³ /day |

**8b. Half of City Plaza (Under Horizon Gardens)
(F&B)**

| | | | |
|--------------------------------------|---|--------------|--|
| Assumed Floor Area | = | 5405 | m ² (Assume 20% of GFA is F&B) |
| Assumed floor area per employee | = | 19.6 | m ² per employee -- (refer to Table 8 of CIFSUS - Restaurant) |
| Total number of employees | = | 276 | employees |
| Design flow for commercial employees | = | 1.58 | m ³ /employee/day -- (refer to Table T-2 of GESF - J10 Restaurant & Hotels) |
| Sewage generation rate | = | 435.5 | m ³ /day |

Total Flow from the Catchment B

| | | | |
|--------------------------------|---|--------------|--|
| Flow rate | = | 6337.7 | m ³ /day |
| Flow rate with P _{CF} | = | 7922.1 | m ³ /day (refer to Table T-4 of GESF - Shau Kei Wan - 1.25) |
| Contributing population | = | 29341 | people (refer to Section 12 of GESF -- Contributing population is the Flow rate with P _{CF} ÷ 0.27, while 0.27 is the average unit flow factor of all typical residents plus employees) |
| Peaking factor | = | 4 | (refer to Table T-5 of GESF for a population between 1,000 - 5,000 incl. stormwater allowance) |
| Peak flow | = | 366.8 | litre/sec |

Total Flow from the Future Development and Catchment A and B to Manhole FMH7036295

| | | | |
|-----------------------------------|---|---------------------|--|
| Flow rate | = | 6793.5 | m ³ /day |
| Flow rate with P _{CF} | = | 8491.8 | m ³ /day (refer to Table T-4 of GESF - Shau Kei Wan - 1.25) |
| Contributing population | = | 31451 | people (refer to Section 12 of GESF -- Contributing population is the Flow rate with P _{CF} ÷ 0.27, while 0.27 is the average unit flow factor of all typical residents plus employees) |
| Peaking factor | = | 4 | (refer to Table T-5 of GESF for a population between 10,000 - 50,000 incl. stormwater allowance) |
| Peak flow (without swimming pool) | = | 393.1 | litre/sec |
| Peak flow (with swimming pool) | = | <u>436.4</u> | litre/sec |

Table 4 Calculation for Sewage Generation Rate of Catchment C

1a. Horizons Garden (Fu Tien Mansion, Choi Tien Mansion, Heng Tien Mansion, Yat Tien Mansion, Kwun Tien Mansion)

| | | | |
|------------------------|---|--------------|--|
| Number of units | = | 960 | units |
| Number of residents | = | 2688 | residents (refer to Census and Statistics Department 2021 data - average household size of 2.8 in Eastern) |
| Design flow | = | 0.27 | m ³ /day (Private R2 in Table T-1 of GESF) |
| Sewage generation rate | = | 725.8 | m ³ /day |

2a. Half of City Plaza (Under Horizon Gardens)

| | | | |
|--------------------------------------|---|--------------|---|
| Assumed Area | = | 21919 | m ² (Assume 80% of GFA is retail) |
| Assumed floor area per employee | = | 29.4 | m ² per employee -- (refer to Table 8 of CIFSUS - All Economic Activities (All Types)) |
| Total number of employees | = | 745 | employees |
| Design flow for commercial employees | = | 0.28 | m ³ /employee/day -- (refer to Table T-2 of GESF) |
| Sewage generation rate | = | 208.7 | m ³ /day |

2b. Half of City Plaza (Under Horizon Gardens) (F&B)

| | | | |
|--------------------------------------|---|--------------|--|
| Assumed Floor Area | = | 5480 | m ² (Assume 20% of GFA is F&B) |
| Assumed floor area per employee | = | 19.6 | m ² per employee -- (refer to Table 8 of CIFSUS - Restaurant) |
| Total number of employees | = | 279 | employees |
| Design flow for commercial employees | = | 1.58 | m ³ /employee/day -- (refer to Table T-2 of GESF - J10 Restaurant & Hotels) |
| Sewage generation rate | = | 441.6 | m ³ /day |

Total Flow from the Catchment C

| | | | |
|---------------------------------|---|-------------|---|
| Flow rate | = | 1376.0 | m ³ /day |
| Flow rate with P _{CIF} | = | 1720.0 | m ³ /day (refer to Table T-4 of GESF - Shau Kei Wan - 1.25) |
| Contributing population | = | 6370 | people (refer to Section 12 of GESF -- Contributing population is the Flow rate with P _{CIF} ÷ 0.27, while 0.27 is the average unit flow factor of all typical residents plus employees) |
| Peaking factor | = | 5 | (refer to Table T-5 of GESF for a population between 1,000 - 5,000 incl. stormwater allowance) |
| Peak flow | = | 99.5 | litre/sec |

Total Flow from the Future Development and Catchment A, B and C to FMH7036243

| | | | |
|-----------------------------------|---|---------------------|---|
| Flow rate | = | 8169.4 | m ³ /day |
| Flow rate with P _{CIF} | = | 10211.8 | m ³ /day (refer to Table T-4 of GESF - Shau Kei Wan - 1.25) |
| Contributing population | = | 37822 | people (refer to Section 12 of GESF -- Contributing population is the Flow rate with P _{CIF} ÷ 0.27, while 0.27 is the average unit flow factor of all typical residents plus employees) |
| Peaking factor | = | 4 | (refer to Table T-5 of GESF for a population between 10,000 - 50,000 incl. stormwater allowance) |
| Peak flow (without swimming pool) | = | 472.8 | litre/sec |
| Peak flow (with swimming pool) | = | <u>516.0</u> | litre/sec |

Table 5 Calculation for Sewage Generation Rate of Catchment D

| | | |
|---|---|---|
| 1. Fu Shan Mansion | | |
| Number of units | = | 216 units |
| Number of residents | = | 605 residents (refer to Census and Statistics Department 2021 data - average household size of 2.8 in Eastern) |
| Design flow | = | 0.27 m ³ /day (Private R2 in Table T-1 of GESF) |
| Sewage generation rate | = | 163.4 m ³ /day |
| 2. Kam Shan Mansion | | |
| Number of units | = | 216 units |
| Number of residents | = | 605 residents (refer to Census and Statistics Department 2021 data - average household size of 2.8 in Eastern) |
| Design flow | = | 0.27 m ³ /day (Private R2 in Table T-1 of GESF) |
| Sewage generation rate | = | 163.4 m ³ /day |
| 3. Yee Shan Mansion | | |
| Number of units | = | 216 units |
| Number of residents | = | 605 residents (refer to Census and Statistics Department 2021 data - average household size of 2.8 in Eastern) |
| Design flow | = | 0.27 m ³ /day (Private R2 in Table T-1 of GESF) |
| Sewage generation rate | = | 163.4 m ³ /day |
| 4. Foong Shan Mansion | | |
| Number of units | = | 216 units |
| Number of residents | = | 605 residents (refer to Census and Statistics Department 2021 data - average household size of 2.8 in Eastern) |
| Design flow | = | 0.27 m ³ /day (Private R2 in Table T-1 of GESF) |
| Sewage generation rate | = | 163.4 m ³ /day |
| 5. Chi Sing Mansion | | |
| Number of units | = | 208 units |
| Number of residents | = | 582 residents (refer to Census and Statistics Department 2021 data - average household size of 2.8 in Eastern) |
| Design flow | = | 0.27 m ³ /day (Private R2 in Table T-1 of GESF) |
| Sewage generation rate | = | 157.1 m ³ /day |
| 6. Yiu Sing Mansion | | |
| Number of units | = | 208 units |
| Number of residents | = | 582 residents (refer to Census and Statistics Department 2021 data - average household size of 2.8 in Eastern) |
| Design flow | = | 0.27 m ³ /day (Private R2 in Table T-1 of GESF) |
| Sewage generation rate | = | 157.1 m ³ /day |
| 7. Restaurants | | |
| Assumed area | = | 661 m ² |
| Assumed floor area per employee | = | 19.6 m ² per employee -- (refer to Table 8 of CIFSUS - Restaurant) |
| Total number of employees | = | 34 employees |
| Design flow for commercial employees | = | 1.58 m ³ /employee/day -- (refer to Table T-2 of GESF - J10 Restaurant & Hotels) |
| Sewage generation rate | = | 53.3 m ³ /day |
| Total Flow from the Catchment D | | |
| Flow rate | = | 1020.9 m ³ /day |
| Flow rate with P _{CIF} | = | 1276.2 m ³ /day (refer to Table T-4 of GESF - Shau Kei Wan - 1.25) |
| Contributing population | = | 4727 people (refer to Section 12 of GESF -- Contributing population is the Flow rate with P _{CIF} ÷ 0.27, while 0.27 is the average unit flow factor of all typical residents plus employees) |
| Peaking factor | = | 6 (refer to Table T-5 of GESF for a population between 1,000 - 5,000 incl. stormwater allowance) |
| Peak flow | = | 88.6 litre/sec |
| Total Flow from the Future Development and Catchment A, B, C and D to FMH7036245 | | |
| Flow rate | = | 9190.4 m ³ /day |
| Flow rate with P _{CIF} | = | 11488.0 m ³ /day (refer to Table T-4 of GESF - Shau Kei Wan - 1.25) |
| Contributing population | = | 42548 people (refer to Section 12 of GESF -- Contributing population is the Flow rate with P _{CIF} ÷ 0.27, while 0.27 is the average unit flow factor of all typical residents plus employees) |
| Peaking factor | = | 4 (refer to Table T-5 of GESF for a population between 10,000 - 50,000 incl. stormwater allowance) |
| Peak flow (without swimming pool) | = | 531.9 litre/sec |
| Peak flow (with swimming pool) | = | <u>575.1</u> litre/sec |

Table 6 Calculation for Sewage Generation Rate of Catchment E

| | | | |
|--|---|---------------------|--|
| 1. Po Shan Mansion | | | |
| Number of units | = | 216 | units |
| Number of residents | = | 605 | residents (refer to Census and Statistics Department 2021 data - average household size of 2.8 in Eastern) |
| Design flow | = | 0.27 | m ³ /day (Private R2 in Table T-1 of GESF) |
| Sewage generation rate | = | 163.4 | m ³ /day |
| 2. Heng Shan Mansion | | | |
| Number of units | = | 216 | units |
| Number of residents | = | 605 | residents (refer to Census and Statistics Department 2021 data - average household size of 2.8 in Eastern) |
| Design flow | = | 0.27 | m ³ /day (Private R2 in Table T-1 of GESF) |
| Sewage generation rate | = | 163.4 | m ³ /day |
| 3. Wah Shan Mansion | | | |
| Number of units | = | 216 | units |
| Number of residents | = | 605 | residents (refer to Census and Statistics Department 2021 data - average household size of 2.8 in Eastern) |
| Design flow | = | 0.27 | m ³ /day (Private R2 in Table T-1 of GESF) |
| Sewage generation rate | = | 163.4 | m ³ /day |
| 4. Loong Shan Mansion | | | |
| Number of units | = | 216 | units |
| Number of residents | = | 605 | residents (refer to Census and Statistics Department 2021 data - average household size of 2.8 in Eastern) |
| Design flow | = | 0.27 | m ³ /day (Private R2 in Table T-1 of GESF) |
| Sewage generation rate | = | 163.4 | m ³ /day |
| 5. Delia School of Canada | | | |
| Total number of teachers & staff | = | 160 | people (information from https://en.wikipedia.org/wiki/DSC_International_School,_Hong_Kong) |
| Design flow for teachers & staff | = | 0.28 | m ³ /person/day (refer to Table T-2 of GESF , Community, Social & Personal Services) |
| Total number of students | = | 1300 | people (information from https://en.wikipedia.org/wiki/DSC_International_School,_Hong_Kong) |
| Design flow for students | = | 0.04 | m ³ /person/day (refer to Table T-2 of GESF, School Student) |
| Sewage Generation rate | = | 96.8 | m ³ /day |
| Total Flow from the Catchment E | | | |
| Flow rate | = | 750.2 | m ³ /day |
| Flow rate with P _{CF} | = | 937.8 | m ³ /day (refer to Table T-4 of GESF - Shau Kei Wan - 1.25) |
| Contributing population | = | 3473 | people (refer to Section 12 of GESF -- Contributing population is the Flow rate with P _{CF} ÷ 0.27, while 0.27 is the average unit flow factor of all typical residents plus employees) |
| Peaking factor | = | 6 | (refer to Table T-5 of GESF for a population between 1,000 - 5,000 incl. stormwater allowance) |
| Peak flow | = | 65.1 | litre/sec |
| Total Flow from the Future Development and Catchment A, B, C, D and E to FMH7036246 | | | |
| Flow rate | = | 9940.6 | m ³ /day |
| Flow rate with P _{CF} | = | 12425.7 | m ³ /day (refer to Table T-4 of GESF - Shau Kei Wan - 1.25) |
| Contributing population | = | 46021 | people (refer to Section 12 of GESF -- Contributing population is the Flow rate with P _{CF} ÷ 0.27, while 0.27 is the average unit flow factor of all typical residents plus employees) |
| Peaking factor | = | 4 | (refer to Table T-5 of GESF for a population between 10,000 - 50,000 incl. stormwater allowance) |
| Peak flow (without swimming pool) | = | 575.3 | litre/sec |
| Peak flow (with swimming pool) | = | <u>618.5</u> | litre/sec |

Table 7 Calculation for Sewage Generation Rate of Catchment F

| | | |
|---|---|---|
| 1. 12 Tai Koo Wan Road | | |
| Assumed Area | = | 41512.8 m ² |
| Assumed floor area per employee | = | 18.2 m ² per employee -- (refer to Table 8 of CIFSUS - Financial, Insurance, Real Estate and Business Services) |
| Total number of employees | = | 2283.0 employees |
| Design flow for commercial employees | = | 0.08 m ³ /employee/day -- (refer to Table T-2 of GESF - J6 Finance, Insurance, Real Estate and Business Services) |
| Sewage generation rate | = | 182.6 m ³ /day |
| 2a. Harbour View Gardens (East) | | |
| Number of units | = | 1071 units (from Centaline: https://hk.centanet.com/estate/en/Taikoo-Shing-Harbour-View-Gardens-East/2-OVDUURF50J) |
| Number of residents | = | 2999 residents (refer to Census and Statistics Department 2021 data - average household size of 2.8 in Eastern) |
| Design flow | = | 0.27 m ³ /day (Private R2 in Table T-1 of GESF) |
| Sewage generation rate | = | 809.7 m ³ /day |
| 2b. Swimming Pool in Harbour View Gardens | | |
| Assumed area | = | 280.0 m ² |
| Assumed depth of water | = | 1.5 m |
| Volume of water | = | 420.0 m ³ |
| Turnover Rate | = | 6.0 hr (CAP132, Section 42 Swimming Pools Regulation (open air pool)) |
| Surface loading rate of filter | = | 50.0 m ³ /m ² /hr |
| Filter areas required | = | 1.4 m ² |
| Backwashing flow rate | = | 30.0 m ³ /m ² /hr |
| Design flow for backwashing | = | 42.0 m ³ /hr |
| Backwash duration | = | 3.0 min/day |
| Backwash generation rate | = | 2.10 m ³ /day |
| Backwash generation rate | = | 11.7 litre/sec |
| 3. Nuan Sing Mansion | | |
| Number of units | = | 208 units (from https://zh.wikipedia.org/zh-hk/%E5%A4%AA%E5%8F%A4%E5%9F%8E) |
| Number of residents | = | 582 residents (refer to Census and Statistics Department 2021 data - average household size of 2.8 in Eastern) |
| Design flow | = | 0.27 m ³ /day (Private R2 in Table T-1 of GESF) |
| Sewage generation rate | = | 157.1 m ³ /day |
| 4. Kam Sing Mansion | | |
| Number of units | = | 208 units (from https://zh.wikipedia.org/zh-hk/%E5%A4%AA%E5%8F%A4%E5%9F%8E) |
| Number of residents | = | 582 residents (refer to Census and Statistics Department 2021 data - average household size of 2.8 in Eastern) |
| Design flow | = | 0.27 m ³ /day (Private R2 in Table T-1 of GESF) |
| Sewage generation rate | = | 157.1 m ³ /day |
| 5. Wai Sing Mansion | | |
| Number of units | = | 208 units (from https://zh.wikipedia.org/zh-hk/%E5%A4%AA%E5%8F%A4%E5%9F%8E) |
| Number of residents | = | 582 residents (refer to Census and Statistics Department 2021 data - average household size of 2.8 in Eastern) |
| Design flow | = | 0.27 m ³ /day (Private R2 in Table T-1 of GESF) |
| Sewage generation rate | = | 157.1 m ³ /day |
| 5. Hoi Sing Mansion | | |
| Number of units | = | 208 units (from https://zh.wikipedia.org/zh-hk/%E5%A4%AA%E5%8F%A4%E5%9F%8E) |
| Number of residents | = | 582 residents (refer to Census and Statistics Department 2021 data - average household size of 2.8 in Eastern) |
| Design flow | = | 0.27 m ³ /day (Private R2 in Table T-1 of GESF) |
| Sewage generation rate | = | 157.1 m ³ /day |
| 6. Tien Sing Mansion | | |
| Number of units | = | 208 units (from https://zh.wikipedia.org/zh-hk/%E5%A4%AA%E5%8F%A4%E5%9F%8E) |
| Number of residents | = | 582 residents (refer to Census and Statistics Department 2021 data - average household size of 2.8 in Eastern) |
| Design flow | = | 0.27 m ³ /day (Private R2 in Table T-1 of GESF) |
| Sewage generation rate | = | 157.1 m ³ /day |
| 7. Hang Sing Mansion | | |
| Number of units | = | 208 units (from https://zh.wikipedia.org/zh-hk/%E5%A4%AA%E5%8F%A4%E5%9F%8E) |
| Number of residents | = | 582 residents (refer to Census and Statistics Department 2021 data - average household size of 2.8 in Eastern) |
| Design flow | = | 0.27 m ³ /day (Private R2 in Table T-1 of GESF) |
| Sewage generation rate | = | 157.1 m ³ /day |
| 8. Restaurants | | |
| Assumed area | = | 662 m ² |
| Assumed floor area per employee | = | 19.6 m ² per employee -- (refer to Table 8 of CIFSUS - Restaurant) |
| Total number of employees | = | 34 employees |
| Design flow for commercial employees | = | 1.58 m ³ /employee/day -- (refer to Table T-2 of GESF - J10 Restaurant & Hotels) |
| Sewage generation rate | = | 53.3 m ³ /day |
| Total Flow from the Catchment F | | |
| Flow rate | = | 1988.6 m ³ /day |
| Flow rate with P _{CF} | = | 2485.7 m ³ /day (refer to Table T-4 of GESF - Shau Kei Wan - 1.25) |
| Contributing population | = | 9206 people (refer to Section 12 of GESF -- Contributing population is the Flow rate with P _{CF} ÷ 0.27, while 0.27 is the average unit flow factor of all typical residents plus employees) |
| Peaking factor | = | 5 (refer to Table T-5 of GESF for a population between 1,000 - 5,000 incl. stormwater allowance) |
| Peak flow | = | 143.8 litre/sec |
| Total Flow from the Future Development and Catchment A, B, C, D, E and F to FMH7036297 | | |
| Flow rate | = | 11929.1 m ³ /day |
| Flow rate with P _{CF} | = | 14911.4 m ³ /day (refer to Table T-4 of GESF - Shau Kei Wan - 1.25) |
| Contributing population | = | 55228 people (refer to Section 12 of GESF -- Contributing population is the Flow rate with P _{CF} ÷ 0.27, while 0.27 is the average unit flow factor of all typical residents plus employees) |
| Peaking factor | = | 4 (refer to Table T-5 of GESF for a population between 5,000 - 10,000 incl. stormwater allowance) |
| Peak flow (without swimming pool) | = | 690.2 litre/sec |
| Peak flow (with swimming pool) | = | 745.2 litre/sec |

Table 8 Calculation for Sewage Generation Rate of Catchment G

| | | |
|--|---|--|
| 1. Pak Hoi Mansion | | |
| Number of units | = | 216 units (from https://zh.wikipedia.org/zh-hk/%E5%A4%AA%E5%8F%A4%E5%9F%8E) |
| Number of residents | = | 605 residents (refer to Census and Statistics Department 2021 data - average household size of 2.8 in Eastern) |
| Design flow | = | 0.27 m ³ /day (Private R2 in Table T-1 of GESF) |
| Sewage generation rate | = | 163.4 m ³ /day |
| 2. Nam Hoi Mansion | | |
| Number of units | = | 216 units (from https://zh.wikipedia.org/zh-hk/%E5%A4%AA%E5%8F%A4%E5%9F%8E) |
| Number of residents | = | 605 residents (refer to Census and Statistics Department 2021 data - average household size of 2.8 in Eastern) |
| Design flow | = | 0.27 m ³ /day (Private R2 in Table T-1 of GESF) |
| Sewage generation rate | = | 163.4 m ³ /day |
| 3. Tung Hoi Mansion | | |
| Number of units | = | 216 units (from https://zh.wikipedia.org/zh-hk/%E5%A4%AA%E5%8F%A4%E5%9F%8E) |
| Number of residents | = | 605 residents (refer to Census and Statistics Department 2021 data - average household size of 2.8 in Eastern) |
| Design flow | = | 0.27 m ³ /day (Private R2 in Table T-1 of GESF) |
| Sewage generation rate | = | 163.4 m ³ /day |
| 4. Swimming Pool in Kwun Hoi Terrace | | |
| Assumed area | = | 200.0 m ² |
| Assumed depth of water | = | 1.5 m |
| Volume of water | = | 300.0 m ³ |
| Turnover Rate | = | 6.0 hr (CAP132, Section 42 Swimming Pools Regulation (open air pool)) |
| Surface loading rate of filter | = | 50.0 m ³ /m ² /hr |
| Filter areas required | = | 1.0 m ² |
| Backwashing flow rate | = | 30.0 m ³ /m ² /hr |
| Design flow for backwashing | = | 30.0 m ³ /hr |
| Backwash duration | = | 3.0 min/day |
| Backwash generation rate | = | 1.50 m ³ /day |
| Backwash generation rate | = | 8.3 litre/sec |
| 5. Saint Anna Anglo Chinese Kindergarten | | |
| Total number of teachers & staff | = | 16 people (information from https://kap2024.azurewebsites.net/edb/schoolinfo.php?lanq=en&schid=5939&district=hkeast&category=&voucher=&schoolno=&schoolname=%E8%B1%96%E5%AE%89%E5%A8%9C%E4%B8%AD%E8%BB%B1%E6%96%87%E5%B9%BC%E7%A8%9A%E5%9C%92&othe) |
| Design flow for teachers & staff | = | 0.28 m ³ /person/day (refer to Table T-2 of GESF , Community, Social & Personal Services) |
| Total number of students | = | 173 people (information from https://kap2024.azurewebsites.net/edb/schoolinfo.php?lanq=en&schid=5939&district=hkeast&category=&voucher=&schoolno=&schoolname=%E8%B1%96%E5%AE%89%E5%A8%9C%E4%B8%AD%E8%BB%B1%E6%96%87%E5%B9%BC%E7%A8%9A%E5%9C%92&othe) |
| Design flow for students | = | 0.04 m ³ /person/day (refer to Table T-2 of GESF, School Student) |
| Sewage Generation rate | = | 11.4 m ³ /day |
| Total Flow from the Catchment G | | |
| Flow rate | = | 501.5 m ³ /day |
| Flow rate with P _{CF} | = | 626.8 m ³ /day (refer to Table T-4 of GESF - Shau Kei Wan - 1.25) |
| Contributing population | = | 2322 people (refer to Section 12 of GESF -- Contributing population is the Flow rate with P _{CF} ÷ 0.27, while 0.27 is the average unit flow factor of all typical residents plus employees) |
| Peaking factor | = | 6 (refer to Table T-5 of GESF for a population between 1,000 - 5,000 incl. stormwater allowance) |
| Peak flow | = | 43.5 litre/sec |
| Total Flow from the Future Development and Catchment A, B, C, D, E, F and G to FMH7036266 | | |
| Flow rate | = | 12430.6 m ³ /day |
| Flow rate with P _{CF} | = | 15538.2 m ³ /day (refer to Table T-4 of GESF - Shau Kei Wan - 1.25) |
| Contributing population | = | 57549 people (refer to Section 12 of GESF -- Contributing population is the Flow rate with P _{CF} ÷ 0.27, while 0.27 is the average unit flow factor of all typical residents plus employees) |
| Peaking factor | = | 4 (refer to Table T-5 of GESF for a population between 10,000 - 50,000 incl. stormwater allowance) |
| Peak flow (without swimming pool) | = | 714.8 litre/sec |
| Peak flow (with swimming pool) | = | 778.1 litre/sec |

Table 9 Calculation for Sewage Generation Rate of Catchment H

1. Nan Shan Mansion

| | | | |
|------------------------|---|--------------|---|
| Number of units | = | 216 | units (from https://zh.wikipedia.org/zh-hk/%E5%A4%AA%E5%8F%A4%E5%9F%8E) |
| Number of residents | = | 605 | residents (refer to Census and Statistics Department 2021 data - average household size of 2.8 in Eastern) |
| Design flow | = | 0.27 | m ³ /day (Private R2 in Table T-1 of GESF) |
| Sewage generation rate | = | 163.4 | m ³ /day |

2. Lu Shan Mansion

| | | | |
|------------------------|---|--------------|---|
| Number of units | = | 216 | units (from https://zh.wikipedia.org/zh-hk/%E5%A4%AA%E5%8F%A4%E5%9F%8E) |
| Number of residents | = | 605 | residents (refer to Census and Statistics Department 2021 data - average household size of 2.8 in Eastern) |
| Design flow | = | 0.27 | m ³ /day (Private R2 in Table T-1 of GESF) |
| Sewage generation rate | = | 163.4 | m ³ /day |

3. Tai Shan Mansion

| | | | |
|------------------------|---|--------------|---|
| Number of units | = | 216 | units (from https://zh.wikipedia.org/zh-hk/%E5%A4%AA%E5%8F%A4%E5%9F%8E) |
| Number of residents | = | 605 | residents (refer to Census and Statistics Department 2021 data - average household size of 2.8 in Eastern) |
| Design flow | = | 0.27 | m ³ /day (Private R2 in Table T-1 of GESF) |
| Sewage generation rate | = | 163.4 | m ³ /day |

4. Tien Shan Mansion

| | | | |
|------------------------|---|--------------|---|
| Number of units | = | 216 | units (from https://zh.wikipedia.org/zh-hk/%E5%A4%AA%E5%8F%A4%E5%9F%8E) |
| Number of residents | = | 605 | residents (refer to Census and Statistics Department 2021 data - average household size of 2.8 in Eastern) |
| Design flow | = | 0.27 | m ³ /day (Private R2 in Table T-1 of GESF) |
| Sewage generation rate | = | 163.4 | m ³ /day |

5. Tung Shan Mansion

| | | | |
|------------------------|---|--------------|---|
| Number of units | = | 216 | units (from https://zh.wikipedia.org/zh-hk/%E5%A4%AA%E5%8F%A4%E5%9F%8E) |
| Number of residents | = | 605 | residents (refer to Census and Statistics Department 2021 data - average household size of 2.8 in Eastern) |
| Design flow | = | 0.27 | m ³ /day (Private R2 in Table T-1 of GESF) |
| Sewage generation rate | = | 163.4 | m ³ /day |

Total Flow from the Catchment H

| | | | |
|---------------------------------|---|-------------|---|
| Flow rate | = | 816.8 | m ³ /day |
| Flow rate with P _{CIF} | = | 1020.9 | m ³ /day (refer to Table T-4 of GESF - Shau Kei Wan - 1.25) |
| Contributing population | = | 3781 | people (refer to Section 12 of GESF -- Contributing population is the Flow rate with P _{CIF} ÷ 0.27, while 0.27 is the average unit flow factor of all typical residents plus employees) |
| Peaking factor | = | 6 | (refer to Table T-5 of GESF for a population between 1,000 - 5,000 incl. stormwater allowance) |
| Peak flow | = | 70.9 | litre/sec |

Total Flow from the Future Development and Catchment A, B, C, D, E, F, G and H to FMH7036270

| | | | |
|-----------------------------------|---|--------------|---|
| Flow rate | = | 13247.3 | m ³ /day |
| Flow rate with P _{CIF} | = | 16559.2 | m ³ /day (refer to Table T-4 of GESF - Shau Kei Wan - 1.25) |
| Contributing population | = | 61330 | people (refer to Section 12 of GESF -- Contributing population is the Flow rate with P _{CIF} ÷ 0.27, while 0.27 is the average unit flow factor of all typical residents plus employees) |
| Peaking factor | = | 4 | (refer to Table T-5 of GESF for a population between <50,000 incl. stormwater allowance) |
| Peak flow (without swimming pool) | = | 754.6 | litre/sec |
| Peak flow (with swimming pool) | = | 817.8 | litre/sec |

Table 10 Hydraulic Capacity of Existing Sewers

| Segment | Manhole Reference | Manhole Reference | Pipe Dia. (mm) | Pipe Length (m) | Invert Level 1 (mPD) | Invert Level 2 (mPD) | g (m/s ²) | k _s (m) | s | v (m ² /s) | V (m/s) | Area (m ²) | Q (m ³ /s) | Estimated Capacity (L/s) | Remark |
|-----------|-------------------|-------------------|----------------|-----------------|----------------------|----------------------|-----------------------|--------------------|--------|-----------------------|---------|------------------------|-----------------------|--------------------------|---------|
| TMH0 - S0 | FLH7004609 | FMH7036295 | 300 | 10.3 | 4.43 | 4.28 | 9.81 | 0.0003 | 0.0146 | 0.000001 | 2.07 | 0.071 | 0.1 | 146.1 | |
| S0 - S1 | FMH7036295 | FMH7036243 | 750 | 13.4 | 0.63 | 0.59 | 9.81 | 0.0030 | 0.0030 | 0.000001 | 1.24 | 0.442 | 0.5 | 548.2 | |
| S1 - S2 | FMH7036243 | FMH7036245 | 750 | 14.3 | 0.59 | 0.58 | 9.81 | 0.0060 | 0.0007 | 0.000001 | 0.54 | 0.442 | 0.2 | 238.1 | |
| S2 - S3 | FMH7036245 | FMH7036246 | 900 | 70.3 | 0.42 | 0.36 | 9.81 | 0.0060 | 0.0009 | 0.000001 | 0.67 | 0.636 | 0.4 | 427.9 | |
| S3 - S4 | FMH7036246 | FMH7036248 | 900 | 74.3 | 0.36 | 0.30 | 9.81 | 0.0060 | 0.0008 | 0.000001 | 0.65 | 0.636 | 0.4 | 416.2 | |
| S4 - S5 | FMH7036248 | FMH7036297 | 900 | 37.6 | 0.3 | N/A | 9.81 | 0.0030 | 0.0067 | 0.000001 | 2.09 | 0.636 | 1.3 | 1327.7 | (5) (6) |
| S5 - S6 | FMH7036297 | FMH7036249 | 900 | 5.9 | N/A | 0.26 | 9.81 | 0.0030 | 0.0067 | 0.000001 | 2.09 | 0.636 | 1.3 | 1327.7 | (5) (6) |
| S6 - S7 | FMH7036249 | FMH7036266 | 900 | 59.3 | 0.26 | 0.2 | 9.81 | 0.0060 | 0.0010 | 0.000001 | 0.73 | 0.636 | 0.5 | 466.0 | |
| S7 - S8 | FMH7036266 | FLH7017485 | 900 | 87.5 | 0.19 | 0.08 | 9.81 | 0.0060 | 0.0013 | 0.000001 | 0.82 | 0.636 | 0.5 | 519.5 | |
| S8 - S9 | FLH7017485 | FMH7036269 | 900 | 21.3 | 0.08 | 0.05 | 9.81 | 0.0060 | 0.0014 | 0.000001 | 0.86 | 0.636 | 0.6 | 550.2 | |
| S9 - S10 | FMH7036269 | FMH7036270 | 900 | 27.6 | 0.05 | 0.01 | 9.81 | 0.0060 | 0.0014 | 0.000001 | 0.88 | 0.636 | 0.6 | 557.7 | |
| S10 - S11 | FMH7036270 | FSH7001300 | 900 | 2.4 | 0.01 | N/A | 9.81 | 0.0030 | 0.0067 | 0.000001 | 2.09 | 0.636 | 1.3 | 1327.7 | (5) (6) |
| S11 - S12 | FSH7001300 | FMH7036273 | 750 | 1.7 | N/A | N/A | 9.81 | 0.0030 | 0.0067 | 0.000001 | 1.86 | 0.442 | 0.8 | 819.7 | (5) (6) |
| S12 - S13 | FMH7036273 | FMH7036292 | 750 | 0.9 | 2.26 | N/A | 9.81 | 0.0030 | 0.0067 | 0.000001 | 1.86 | 0.442 | 0.8 | 819.7 | (5) (6) |
| S13 - S14 | FMH7036292 | FMH7036293 | 750 | 5.0 | N/A | N/A | 9.81 | 0.0030 | 0.0067 | 0.000001 | 1.86 | 0.442 | 0.8 | 819.7 | (5) (6) |
| S14 - S15 | FMH7036293 | FMH7036294 | 750 | 21.1 | N/A | 2.1 | 9.81 | 0.0030 | 0.0067 | 0.000001 | 1.86 | 0.442 | 0.8 | 819.7 | (5) (6) |
| S15 - S16 | FMH7036294 | FMH7036288 | 750 | 4.7 | 2.1 | 1.7 | 9.81 | 0.0030 | 0.0843 | 0.000001 | 6.60 | 0.442 | 2.9 | 2917.5 | |

Remarks: (1) g=gravitational acceleration; k_s=equivalent sand roughness; s=gradient; v=kinematic viscosity of water; V=mean velocity

(2) The values of k_s = 6.0mm and 3.0mm is used for the calculation of slimed concrete sewer, poor condition @mean velocity = approximately 0.75m/s and 1.2m/s (based on Table 5: Recommended Roughness Values in Sewerage Manual)

(3) The value of velocity (V) is referred to the Tables for the hydraulic design of pipes, sewers and channels (8th edition)

(4) Equation used:
$$V = \sqrt{(8gDs) \log\left(\frac{k_s}{3.7D} + \frac{2.51v}{D\sqrt{(2gDs)}}\right)}$$

(5) N/A = No information is provided in the geoinfo map and sewerage plan provided by DSD.

(6) As there are no invert level information for FMH7036297, FSH7001300, FMH7036273, FMH7036292 and FMH7036293, the slopes of the segments are assumed to be in 1/150.

Table 11 Contributions of Sewage generated from the subject site and Catchments

| Segment | Manhole Reference | Manhole Reference | Pipe Dia. (mm) | Pipe Length (m) | Gradient | Estimated Capacity (L/s) | Included Catchment | Estimated Flow from the Proposed Development only (L/s) | Contributed by the Proposed Development only (%) | Estimated Flow from the Proposed Development and Catchments (L/s) | Contributed by the Proposed Development and Catchments (%) | Status | Remark |
|-----------|-------------------|-------------------|----------------|-----------------|----------|--------------------------|--|---|--|---|--|--------|--------|
| TMH0 - S0 | FLH7004609 | FMH7036295 | 300 | 10.3 | 0.0146 | 146.1 | Proposed Development + Catchment A | 13.0 | 8.9 | 39.6 | 27.1 | OK | |
| S0 - S1 | FMH7036295 | FMH7036243 | 750 | 13.4 | 0.0030 | 548.2 | Proposed Development + Catchment A+B | 13.0 | 2.4 | 436.4 | 79.6 | OK | |
| S1 - S2 | FMH7036243 | FMH7036245 | 750 | 14.3 | 0.0007 | 238.1 | Proposed Development + Catchment A+B+C | 13.0 | 5.5 | 516.0 | 216.7 | Spill | |
| S2 - S3 | FMH7036245 | FMH7036246 | 900 | 70.3 | 0.0009 | 427.9 | Proposed Development + Catchment A+B+C+D | 13.0 | 3.0 | 575.1 | 134.4 | Spill | |
| S3 - S4 | FMH7036246 | FMH7036248 | 900 | 74.3 | 0.0008 | 416.2 | Proposed Development + Catchment A+B+C+D+E | 13.0 | 3.1 | 618.5 | 148.6 | Spill | |
| S4 - S5 | FMH7036248 | FMH7036297 | 900 | 37.6 | 0.0067 | 1327.7 | Proposed Development + Catchment A+B+C+D+E | 13.0 | 1.0 | 618.5 | 46.6 | OK | |
| S5 - S6 | FMH7036297 | FMH7036249 | 900 | 5.9 | 0.0067 | 1327.7 | Proposed Development + Catchment A+B+C+D+E+F | 13.0 | 1.0 | 745.2 | 56.1 | OK | |
| S6 - S7 | FMH7036249 | FMH7036266 | 900 | 59.3 | 0.0010 | 466.0 | Proposed Development + Catchment A+B+C+D+E+F | 13.0 | 2.8 | 745.2 | 159.9 | Spill | |
| S7 - S8 | FMH7036266 | FLH7017485 | 900 | 87.5 | 0.0013 | 519.5 | Proposed Development + Catchment A+B+C+D+E+F+G | 13.0 | 2.5 | 778.1 | 149.8 | Spill | |
| S8 - S9 | FLH7017485 | FMH7036269 | 900 | 21.3 | 0.0014 | 550.2 | Proposed Development + Catchment A+B+C+D+E+F+G+H | 13.0 | 2.4 | 817.8 | 148.6 | Spill | |
| S9 - S10 | FMH7036269 | FMH7036270 | 900 | 27.6 | 0.0014 | 557.7 | Proposed Development + Catchment A+B+C+D+E+F+G+H | 13.0 | 2.3 | 817.8 | 146.6 | Spill | |
| S10 - S11 | FMH7036270 | FSH7001300 | 900 | 2.4 | 0.0067 | 1327.7 | Proposed Development + Catchment A+B+C+D+E+F+G+H | 13.0 | 1.0 | 817.8 | 61.6 | OK | |
| S11 - S12 | FSH7001300 | FMH7036273 | 750 | 1.7 | 0.0067 | 819.7 | Proposed Development + Catchment A+B+C+D+E+F+G+H | 13.0 | 1.6 | 817.8 | 99.8 | Spill | |
| S12 - S13 | FMH7036273 | FMH7036292 | 750 | 0.9 | 0.0067 | 819.7 | Proposed Development + Catchment A+B+C+D+E+F+G+H | 13.0 | 1.6 | 817.8 | 99.8 | Spill | |
| S13 - S14 | FMH7036292 | FMH7036293 | 750 | 5.0 | 0.0067 | 819.7 | Proposed Development + Catchment A+B+C+D+E+F+G+H | 13.0 | 1.6 | 817.8 | 99.8 | Spill | |
| S14 - S15 | FMH7036293 | FMH7036294 | 750 | 21.1 | 0.0067 | 819.7 | Proposed Development + Catchment A+B+C+D+E+F+G+H | 13.0 | 1.6 | 817.8 | 99.8 | Spill | |
| S15 - S16 | FMH7036294 | FMH7036288 | 750 | 4.7 | 0.0843 | 2917.5 | Proposed Development + Catchment A+B+C+D+E+F+G+H | 13.0 | 0.4 | 817.8 | 28.0 | OK | |

Table 12 Hydraulic Capacity of Proposed Upgrading Sewer

| Segment | Manhole Reference | Manhole Reference | Pipe Dia. (mm) | Pipe Length (m) | Invert Level 1 (mPD) | Invert Level 2 (mPD) | g (m/s ²) | k _s (m) | s | v (m ² /s) | V (m/s) | Area (m ²) | Q (m ³ /s) | Estimated Capacity (L/s) | Estimated Flow from the Proposed Development and Catchments (L/s) | Contributed by the Proposed Development and Catchments (%) | Status |
|-----------|-------------------|-------------------|----------------|-----------------|----------------------|----------------------|-----------------------|--------------------|--------|-----------------------|---------|------------------------|-----------------------|--------------------------|---|--|--------|
| S1 - S2 | FMH7036243 | FMH7036245 | 900 | 14.3 | 0.59 | 0.58 | 9.81 | 0.0003 | 0.0007 | 0.000001 | 0.87 | 0.636 | 0.6 | 556.5 | 516 | 92.7 | OK |
| S2 - S3 | FMH7036245 | FMH7036246 | 900 | 70.3 | 0.58 | 0.45 | 9.81 | 0.0003 | 0.0019 | 0.000001 | 1.44 | 0.636 | 0.9 | 914.5 | 575 | 62.9 | OK |
| S3 - S4 | FMH7036246 | FMH7036248 | 900 | 74.3 | 0.45 | 0.20 | 9.81 | 0.0003 | 0.0034 | 0.000001 | 1.95 | 0.636 | 1.2 | 1238.8 | 619 | 49.9 | OK |
| S6 - S7 | FMH7036249 | FMH7036266 | 900 | 59.3 | 0.26 | 0.15 | 9.81 | 0.0003 | 0.0019 | 0.000001 | 1.44 | 0.636 | 0.9 | 915.9 | 745 | 81.4 | OK |
| S7 - S8 | FMH7036266 | FLH7017485 | 900 | 87.5 | 0.15 | 0.01 | 9.81 | 0.0003 | 0.0016 | 0.000001 | 1.34 | 0.636 | 0.8 | 849.6 | 778 | 91.6 | OK |
| S8 - S9 | FLH7017485 | FMH7036269 | 900 | 21.3 | 0.01 | -0.03 | 9.81 | 0.0003 | 0.0019 | 0.000001 | 1.45 | 0.636 | 0.9 | 922.2 | 818 | 88.7 | OK |
| S9 - S10 | FMH7036269 | FMH7036270 | 900 | 27.6 | -0.03 | -0.08 | 9.81 | 0.0003 | 0.0018 | 0.000001 | 1.42 | 0.636 | 0.9 | 904.8 | 818 | 90.4 | OK |
| S11 - S12 | FSH7001300 | FMH7036273 | 750 | 1.7 | -0.15 | -0.18 | 9.81 | 0.0003 | 0.0176 | 0.000001 | 4.02 | 0.442 | 1.8 | 1774.2 | 818 | 46.1 | OK |
| S12 - S13 | FMH7036273 | FMH7036292 | 750 | 0.9 | -0.18 | -0.20 | 9.81 | 0.0003 | 0.0211 | 0.000001 | 4.39 | 0.442 | 1.9 | 1941.3 | 818 | 42.1 | OK |
| S13 - S14 | FMH7036292 | FMH7036293 | 750 | 5.0 | -0.20 | -0.23 | 9.81 | 0.0003 | 0.0060 | 0.000001 | 2.33 | 0.442 | 1.0 | 1030.5 | 818 | 79.4 | OK |
| S14 - S15 | FMH7036293 | FMH7036294 | 750 | 21.1 | -0.23 | -0.33 | 9.81 | 0.0003 | 0.0047 | 0.000001 | 2.07 | 0.442 | 0.9 | 913.8 | 818 | 89.5 | OK |

- Remarks:
- (1) g=gravitational acceleration; k_s=equivalent sand roughness; s=gradient; v=kinematic viscosity of water; V=mean velocity
 - (2) The values of k_s = 1.5mm and 0.3mm is used for the calculation of slimed uPVC sewer, poor condition @mean velocity = approximately 0.75m/s and 1.2m/s (based on Table 5: Recommended Roughness Values in Sewerage Manual)
 - (3) The value of velocity (V) is referred to the Tables for the hydraulic design of pipes, sewers and channels (8th edition)
 - (4) Equation used: $V = \sqrt{(8gDs) \log\left(\frac{k_s}{3.7D} + \frac{2.51v}{D\sqrt{(2gDs)}}\right)}$

Table 13 Contributions of Sewage generated from the Subject Site on Tai Koo Shing Pumping Station (TKSPS)

| Design Capacity of Tai Koo Shing Pumping Station (m3/day) | Design Capacity of Tai Koo Shing Pumping Station (L/s) | Estimated Flow from the Proposed Development (L/s) | Contributed by the Proposed Development (%) |
|--|---|---|--|
| 22464 | 260 | 13.0 | 5% |

Appendix 2.2 Sewerage Record Plans obtained from DSD

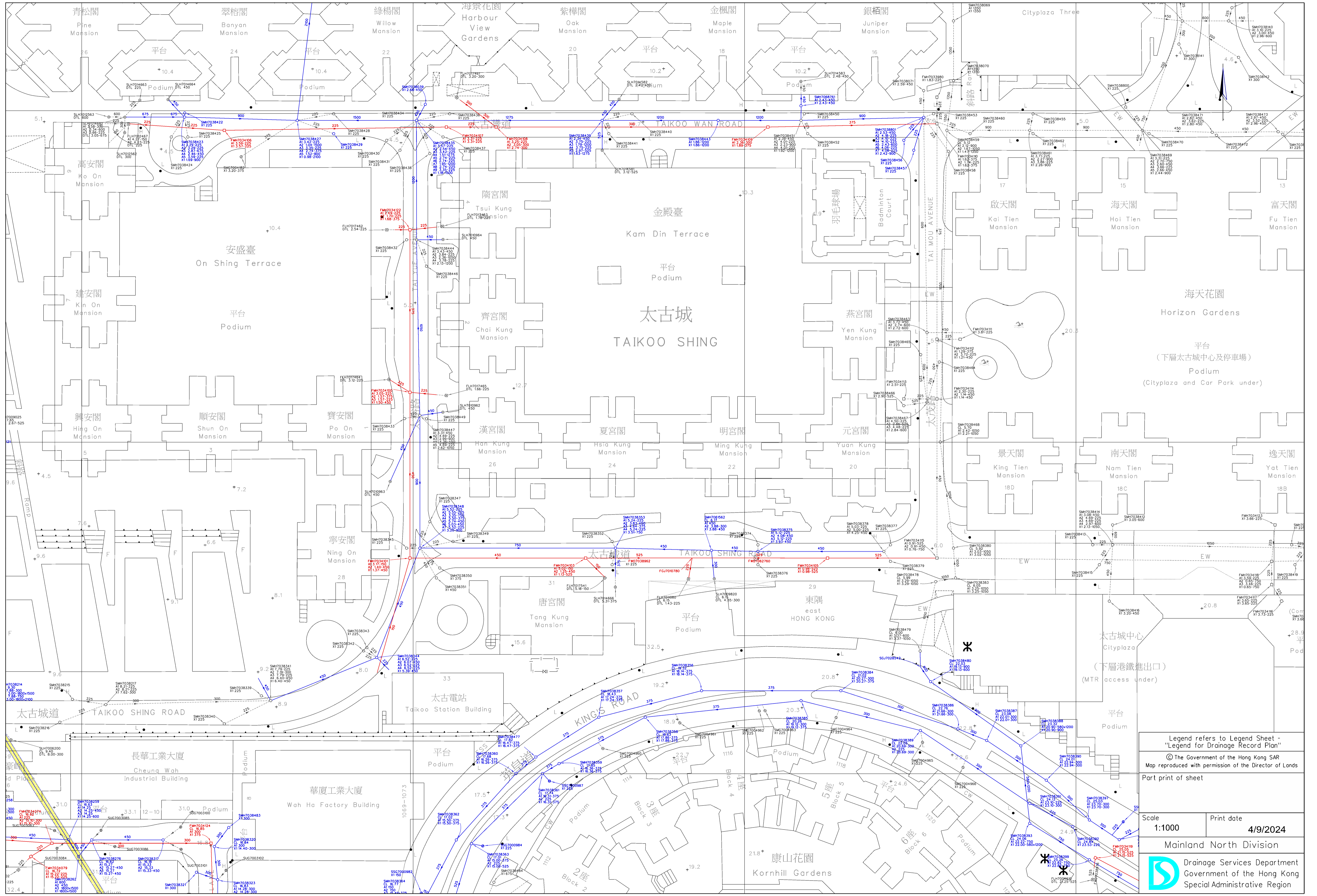

Legend refers to Legend Sheet -
 "Legend for Drainage Record Plan"
 © The Government of the Hong Kong SAR
 Map reproduced with permission of the Director of Lands
 Part print of sheet

| | |
|-------------------------|------------|
| Scale | Print date |
| 1:1000 | 4/9/2024 |
| Mainland North Division | |
| | |

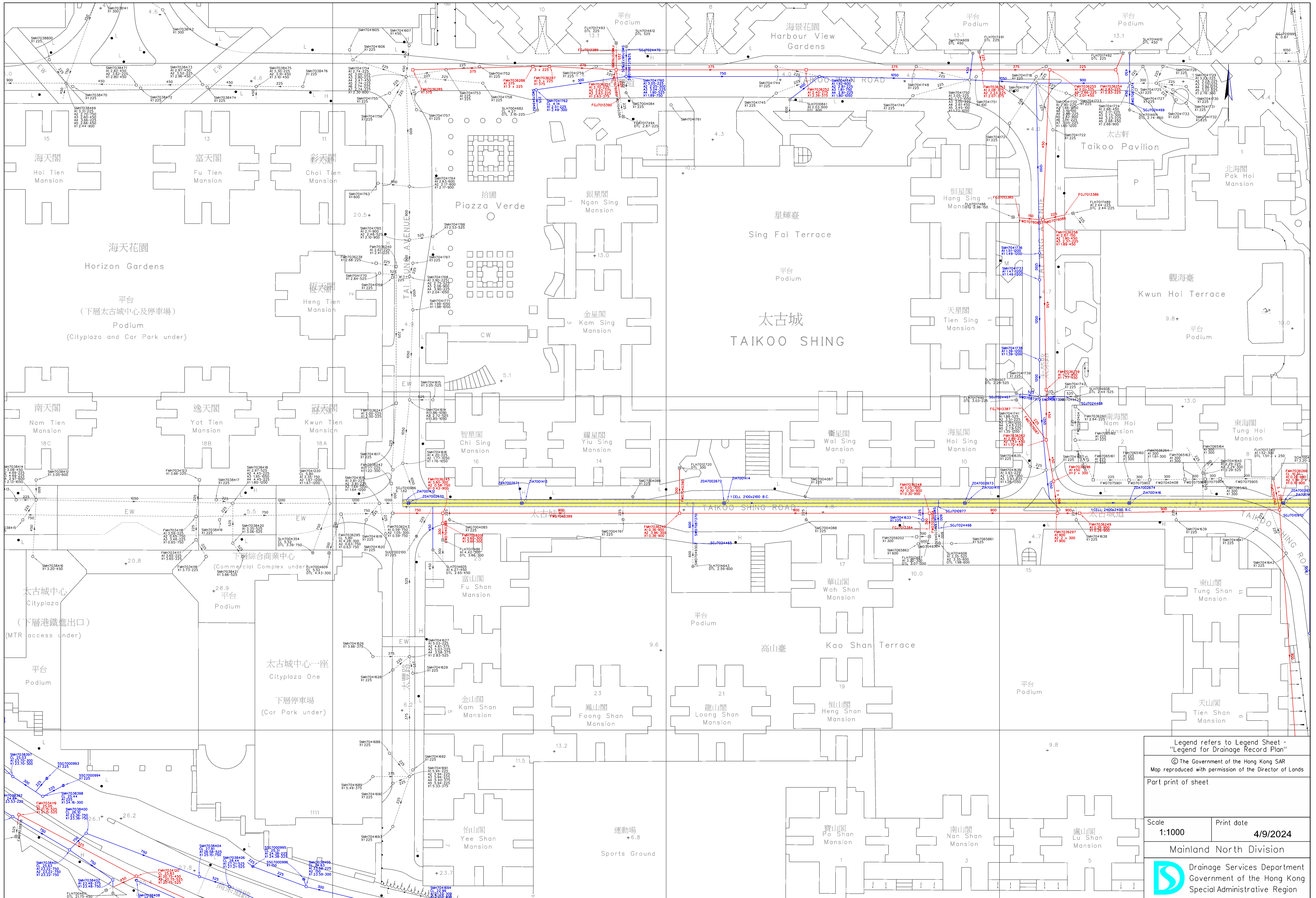

Legend refers to Legend Sheet -
 "Legend for Drainage Record Plan"
 © The Government of the Hong Kong SAR
 Map reproduced with permission of the Director of Lands
 Part print of sheet

| | |
|-----------------|------------------------|
| Scale 1:1000 | Print date 4/9/2024 |
|-----------------|------------------------|

Mainland North Division
 Drainage Services Department
 Government of the Hong Kong
 Special Administrative Region

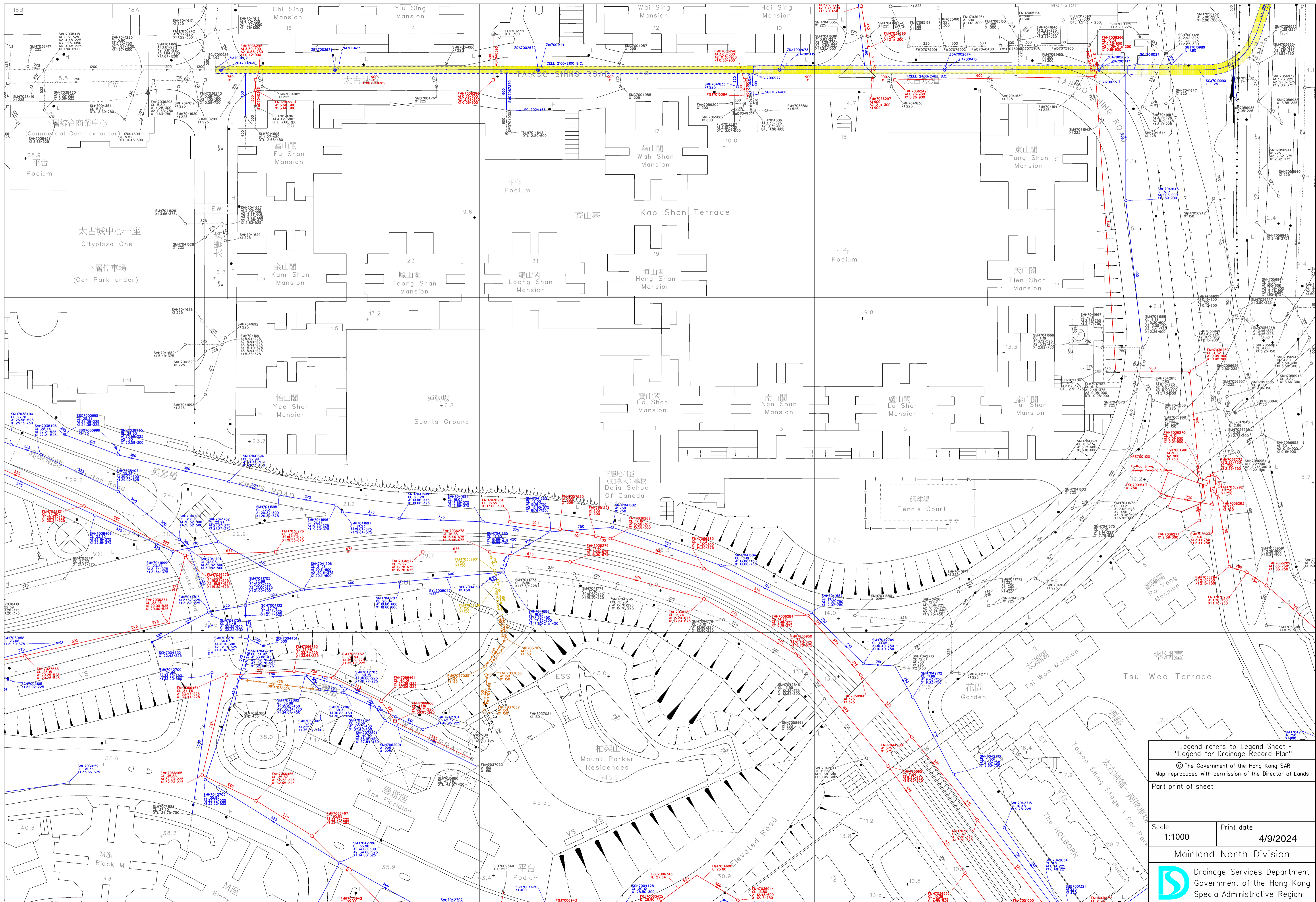

Legend refers to Legend Sheet -
 "Legend for Drainage Record Plan"
 © The Government of the Hong Kong SAR
 Map reproduced with permission of the Director of Lands
 Part print of sheet

Scale 1:1000
 Print date 4/9/2024

Mainland North Division



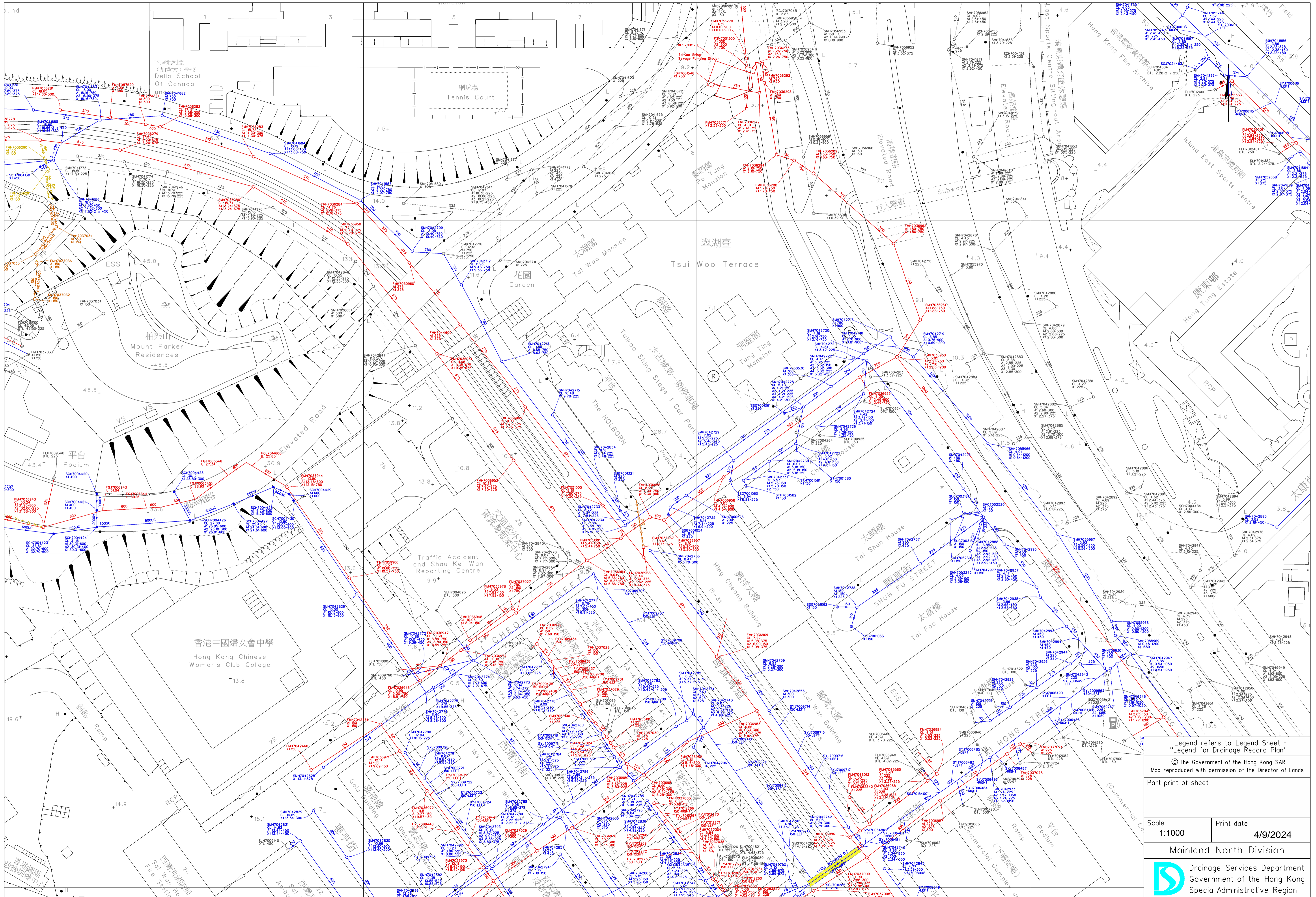

Legend refers to Legend Sheet -
"Legend for Drainage Record Plan"

© The Government of the Hong Kong SAR
Map reproduced with permission of the Director of Lands

Part print of sheet

| | |
|--------|------------|
| Scale | Print date |
| 1:1000 | 4/9/2024 |

Mainland North Division

 Drainage Services Department
Government of the Hong Kong
Special Administrative Region