

**Proposed SCAA Sports Link (“Place of Recreation, Sports or Culture”)  
at South China Athletic Association  
88 Caroline Hill Road in Wong Nai Chung  
S16 Planning Application**



**(Planning Application No: A/H7/189)**

**APPENDIX IV**

Drawings indicating the new/existing pedestrian route and vehicular access



**Legends**

-  Pedestrian Access
-  Vehicular Access

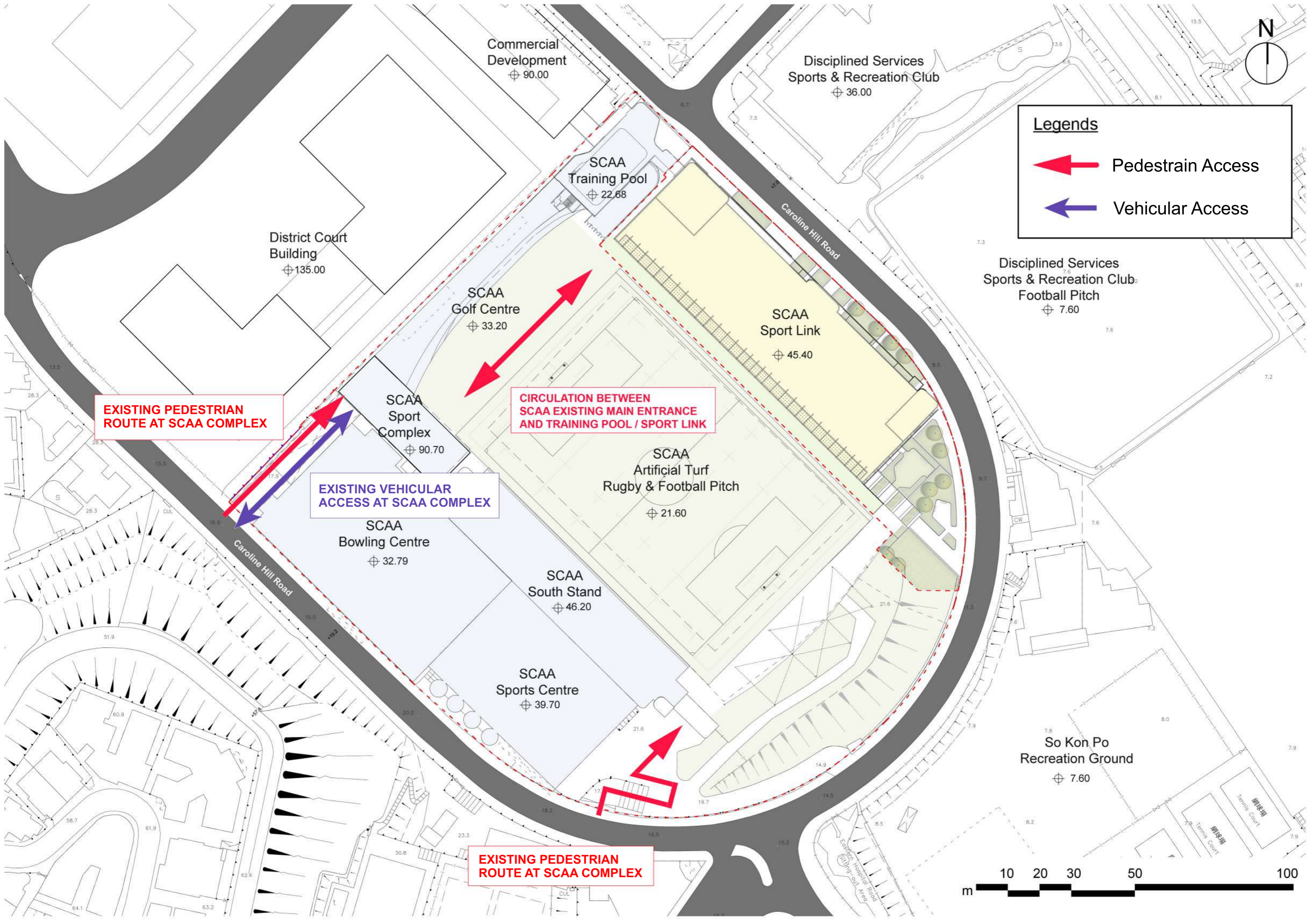

**EXISTING PEDESTRIAN ROUTE AT SCAA COMPLEX**

**EXISTING VEHICULAR ACCESS AT SCAA COMPLEX**

**CIRCULATION BETWEEN SCAA EXISTING MAIN ENTRANCE AND TRAINING POOL / SPORT LINK**

**EXISTING PEDESTRIAN ROUTE AT SCAA COMPLEX**



# Diagram for Pedestrian Access Route on G/F

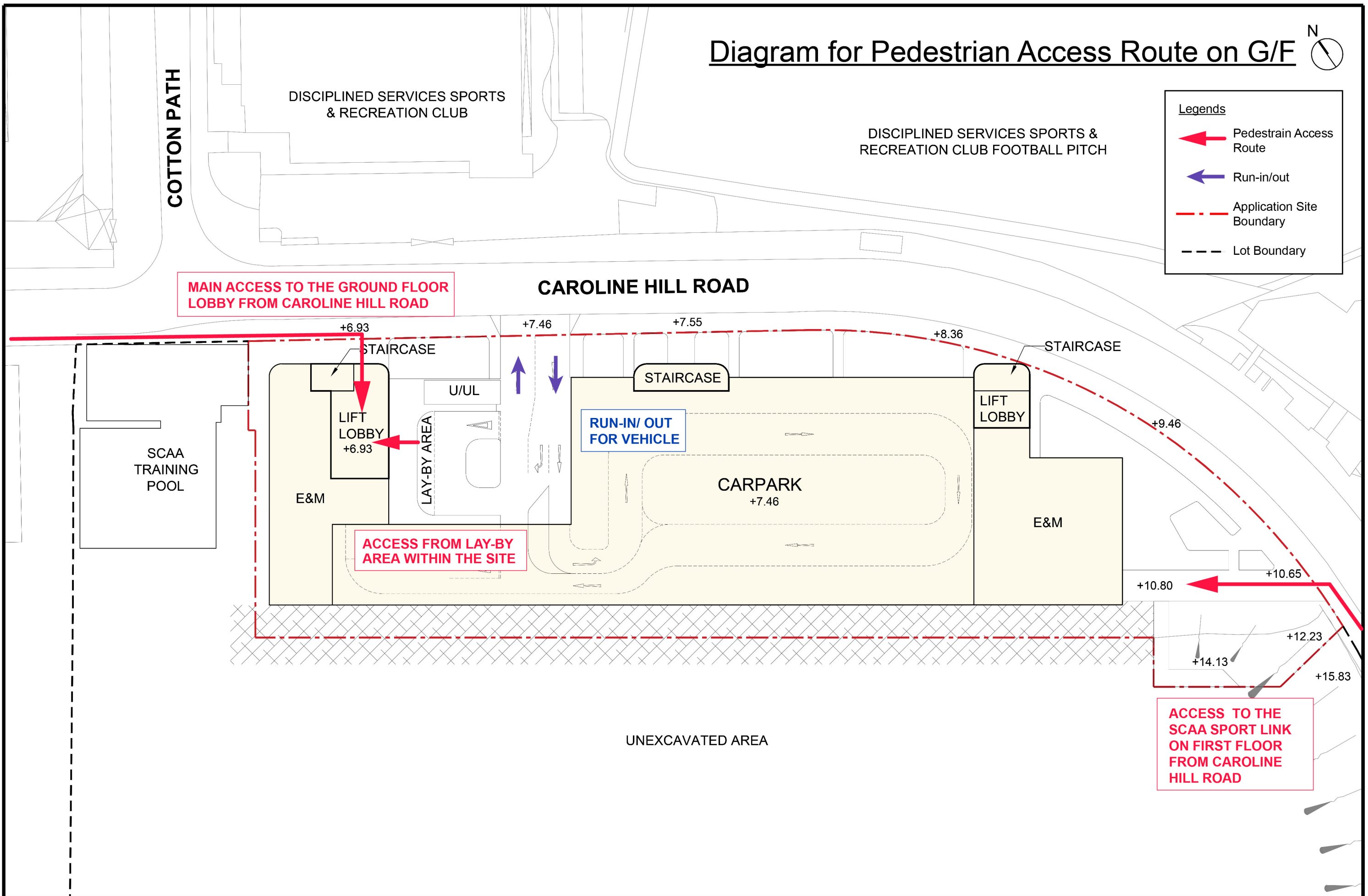

# Diagram for Pedestrian Access Route on 2/F

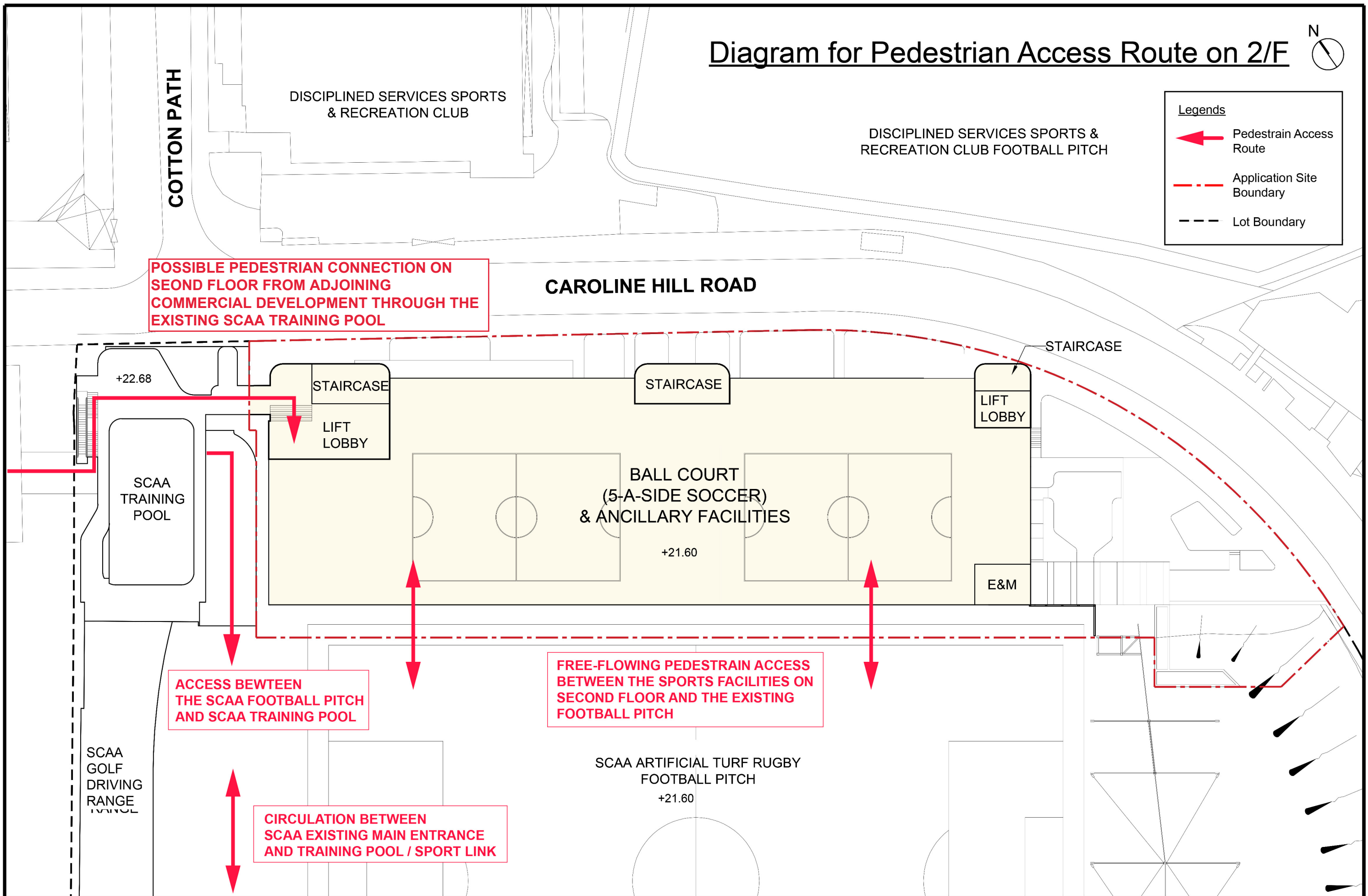

**Legends**

- Pedestrian Access Route
- Application Site Boundary
- Lot Boundary

**POSSIBLE PEDESTRIAN CONNECTION ON SEOND FLOOR FROM ADJOINING COMMERCIAL DEVELOPMENT THROUGH THE EXISTING SCAA TRAINING POOL**

**ACCESS BEWTEN THE SCAA FOOTBALL PITCH AND SCAA TRAINING POOL**

**FREE-FLOWING PEDESTRAIN ACCESS BETWEEN THE SPORTS FACILITIES ON SECOND FLOOR AND THE EXISTING FOOTBALL PITCH**

**CIRCULATION BETWEEN SCAA EXISTING MAIN ENTRANCE AND TRAINING POOL / SPORT LINK**