

Proposed Temporary Logistics Centre & Ancillary Staff Canteen for a Period of 3 Years

at

Lots 2427 (Part), 2430 (Part), 2431 (Part), 2432 (Part), 2433 (Part), 2434, 2435, 2436 (Part), 2437 (Part), 2438 S.A RP (Part), 2438 S.B (Part), 2439 (Part), 2962 (Part), 2976 (Part), 2977 S.A (Part), 2977 S.B (Part), 2978, 2979 (Part) & 2980 (Part) in D.D.129, Lau Fau Shan, Yuen Long, N.T.

Annex 1 Estimated Traffic Generation

- 1.1 The application site is abutting a short vehicular access leading from Lau Fau Shan Road. The application site has been approved for logistics centre for a period of 3 years in 2015, 2018, 2020, 2022 & 2023. (TPB Ref.: A/YL-HT/953, A/HSK/50, A/HSK/216, 389 & 439)
- 1.2 Although the application site is intended for logistics centre use, traffic generated by the proposed development is not significant because the logistics centre is not significant in size.
- 1.3 The estimated average traffic generation and traffic generation rate at peak hours are as follow:

	<u>Average Traffic Generation Rate</u> (pcu/hr)	<u>Average Traffic Attraction Rate</u> (pcu/hr)	<u>Traffic Generation Rate at Peak Hours</u> (pcu/hr)	<u>Traffic Attraction Rate at Peak Hours</u> (pcu/hr)
Medium goods vehicle/ heavy goods vehicle	0.38	0.38	2	2
Container trailer	0.75	0.75	3	3
Total	1.13	1.13	5	5

Note 1: The opening hour of the proposed development is restricted to 7:00 a.m. to 11:00 p.m. from Mondays and Saturdays. No operation will be held on Sundays and public holidays;

Note 2: The pcu of medium goods vehicle/heavy goods vehicle and container trailers is assumed as 2 and 3 respectively; &

Note 3: Morning peak is defined as 7:00a.m. to 9:00a.m. whereas afternoon peak is defined as 5:00p.m. to 7:00p.m.

- 1.4 In association with the proposed use, adequate space for manoeuvring and logistics purpose would be provided. Due to the fact that the application site is directly linked with Yuen Long Highway via Lau Fau Shan Road, Tin Wah Road and Tin Ying Road, the proposed development being applied would not aggravate the traffic condition of adjacent area.

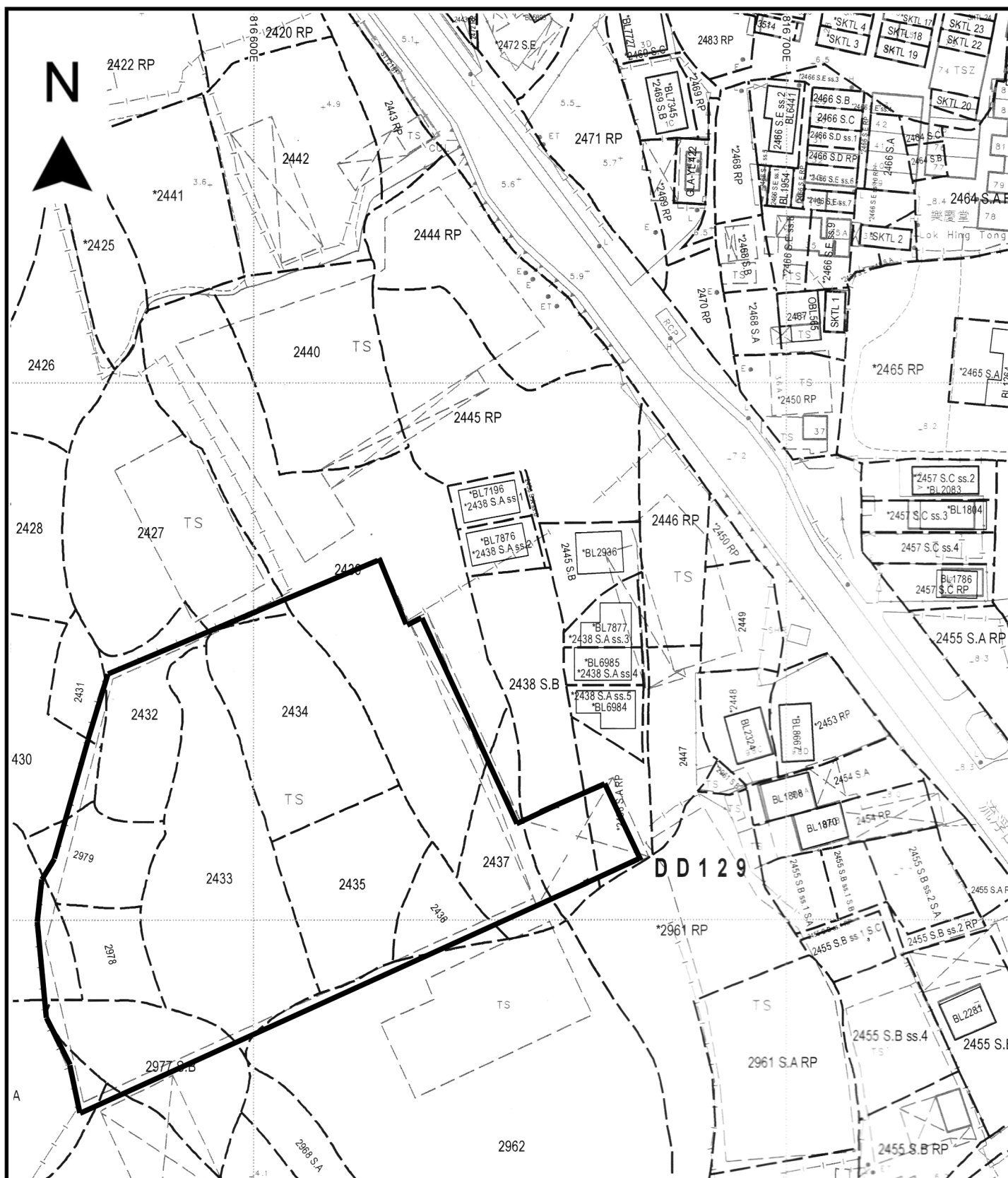

Project 項目名稱:

Proposed Temporary Logistics Centre & Ancillary Staff Canteen for a Period of 3 Years at Lots 2427 (Part), 2430 (Part), 2431 (Part), 2432 (Part), 2433 (Part), 2434, 2435, 2436 (Part), 2437 (Part), 2438 S.A RP (Part), 2438 S.B (Part), 2439 (Part), 2962 (Part), 2976 (Part), 2977 S.A (Part), 2977 S.B (Part), 2978, 2979 (Part) & 2980 (Part) in D.D.129, Lau Fau Shan, Yuen Long, N.T.

Drawing Title 圖目:

Site Plan

Drawing No. 圖號:

Figure 1

Remarks 備註:

Scale 比例:

1:1000

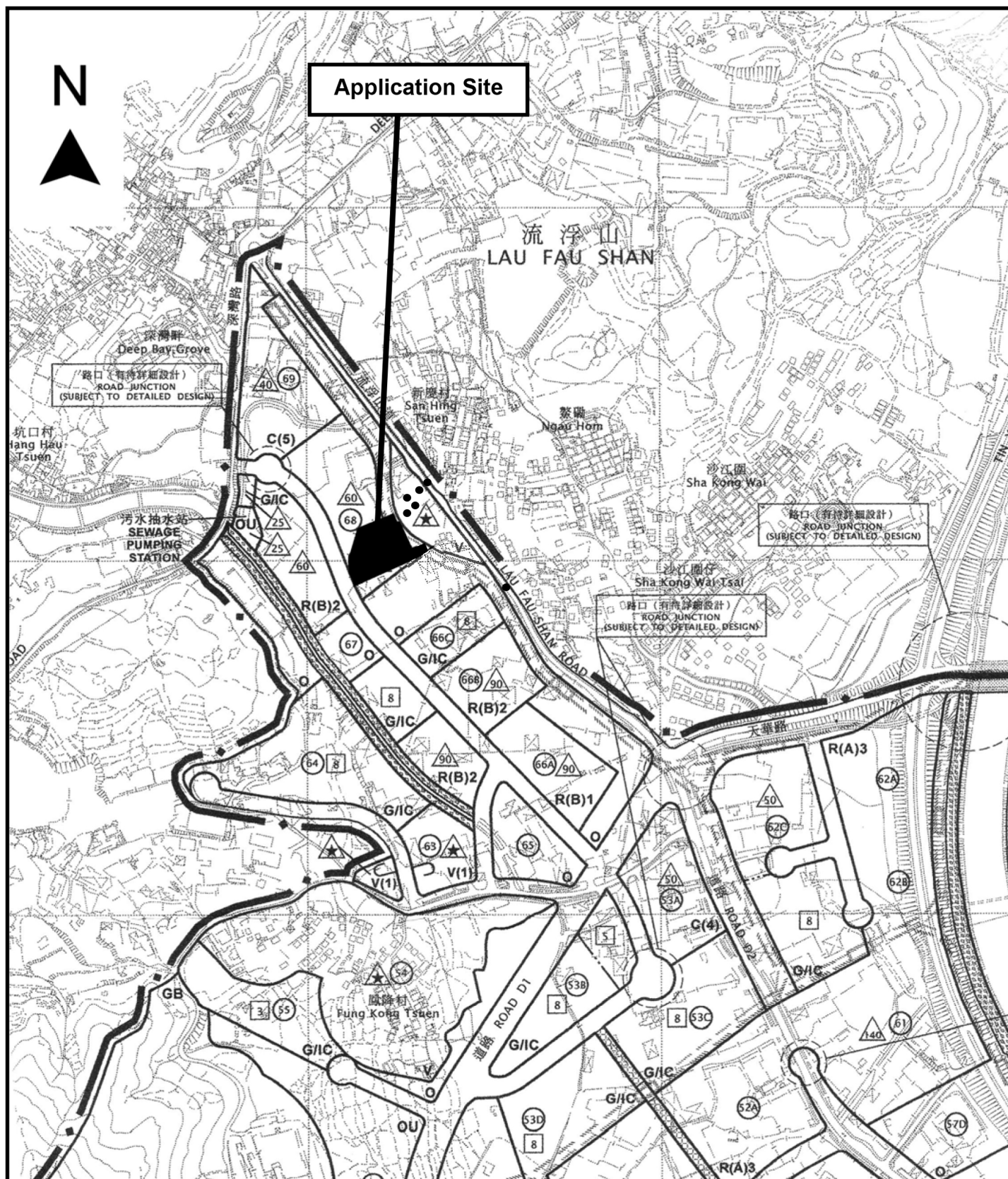

Project 項目名稱:

Proposed Temporary Logistics Centre & Ancillary Staff Canteen for a Period of 3 Years at Lots 2427 (Part), 2430 (Part), 2431 (Part), 2432 (Part), 2433 (Part), 2434, 2435, 2436 (Part), 2437 (Part), 2438 S.A RP (Part), 2438 S.B (Part), 2439 (Part), 2962 (Part), 2976 (Part), 2977 S.A (Part), 2977 S.B (Part), 2978, 2979 (Part) & 2980 (Part) in D.D.129, Lau Fau Shan, Yuen Long, N.T.

Drawing Title 圖目:

Location Plan

Drawing No. 圖號:

Figure 2

Remarks 備註:

● ● ● Vehicular access leading from Ping Ha Road

Scale 比例:

1:7500

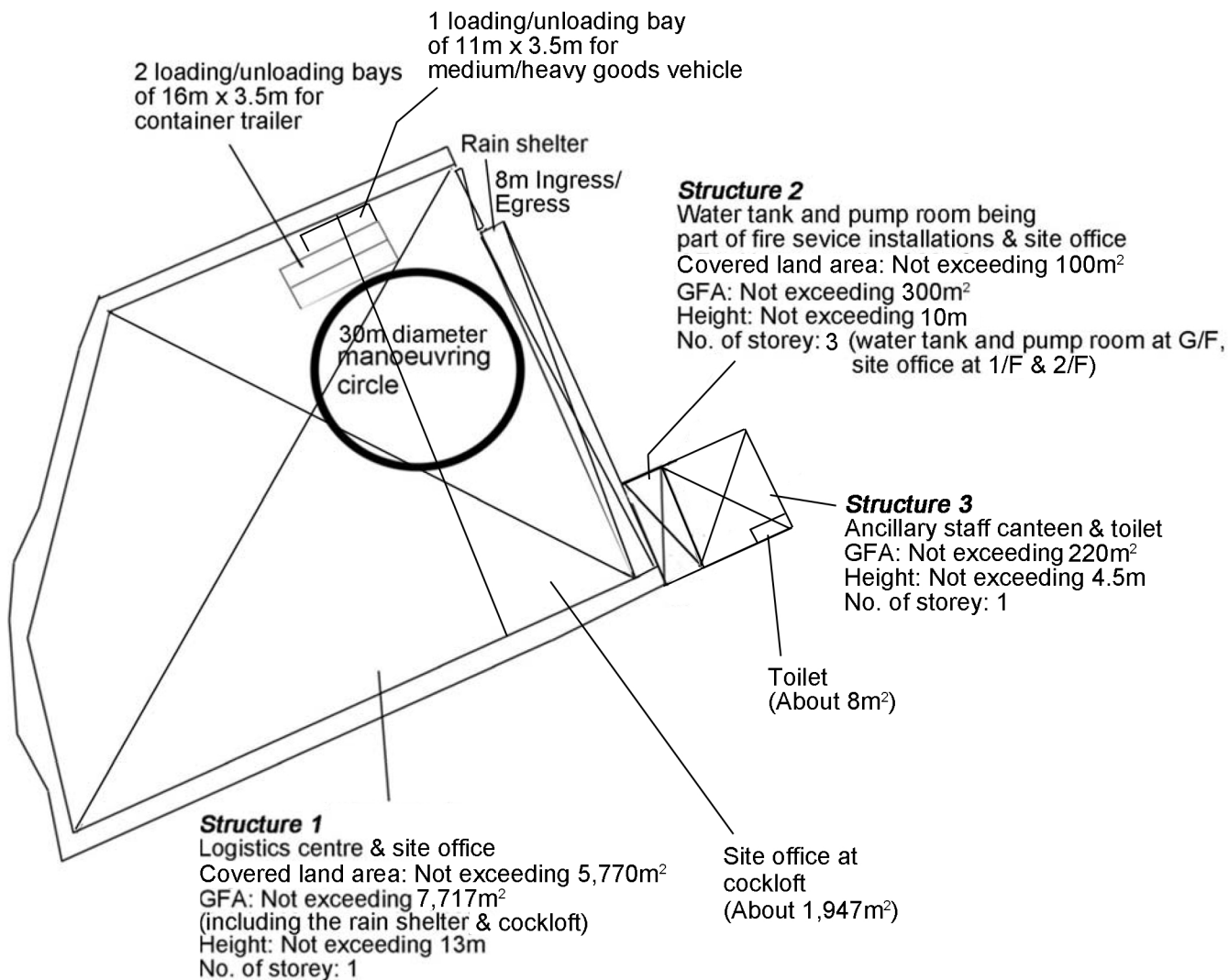

Project 項目名稱:

Proposed Temporary Logistics Centre & Ancillary Staff Canteen for a Period of 3 Years at Lots 2427 (Part), 2430 (Part), 2431 (Part), 2432 (Part), 2433 (Part), 2434, 2435, 2436 (Part), 2437 (Part), 2438 S.A RP (Part), 2438 S.B (Part), 2439 (Part), 2962 (Part), 2976 (Part), 2977 S.A (Part), 2977 S.B (Part), 2978, 2979 (Part) & 2980 (Part) in D.D.129, Lau Fau Shan, Yuen Long, N.T.

Drawing Title 圖目:

Proposed Layout Plan

Drawing No. 圖號:

Figure 3

Remarks 備註:

Scale 比例:

1:1000

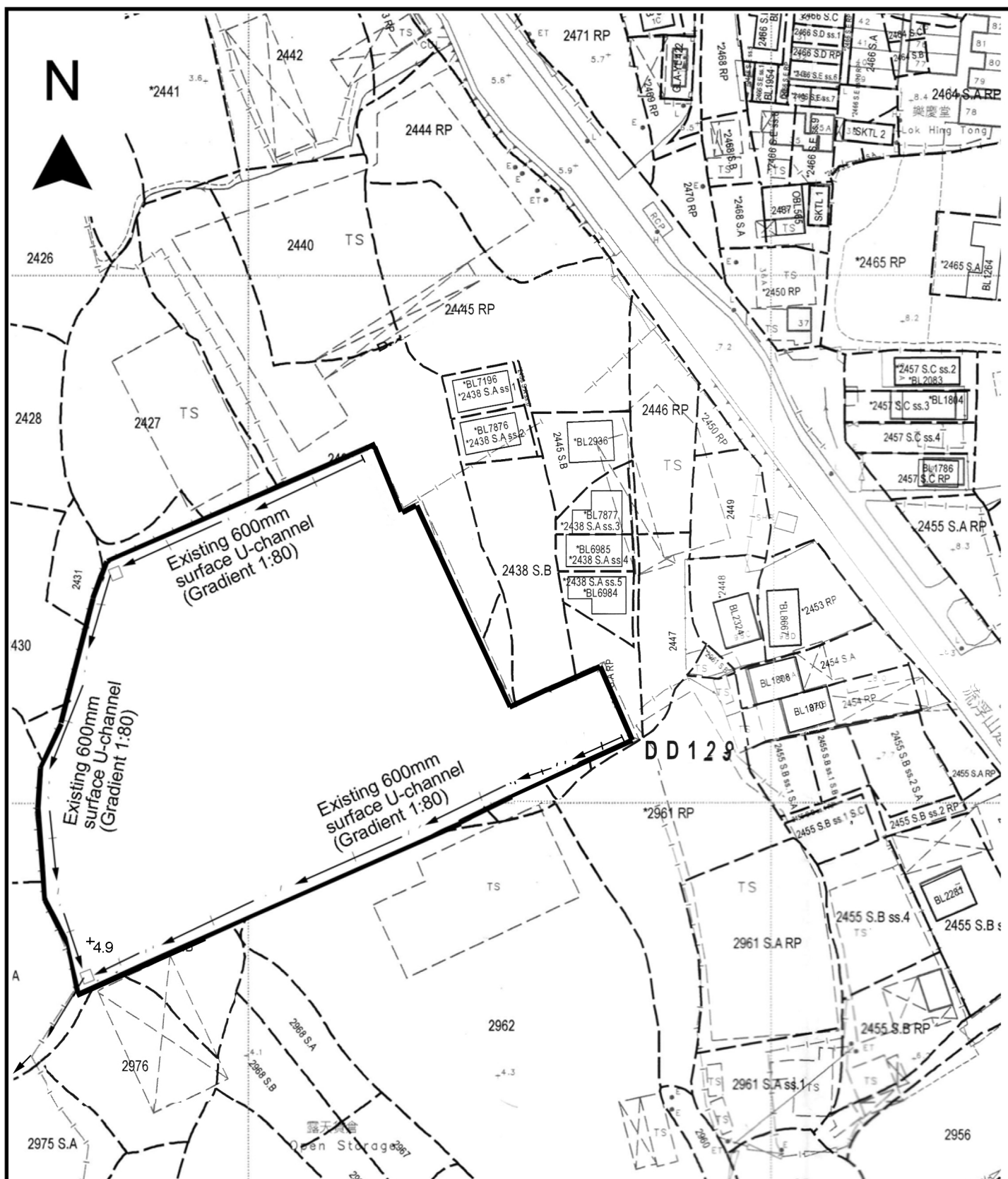

Project 項目名稱:

Proposed Temporary Logistics Centre & Ancillary Staff Canteen for a Period of 3 Years at Lots 2427 (Part), 2430 (Part), 2431 (Part), 2432 (Part), 2433 (Part), 2434, 2435, 2436 (Part), 2437 (Part), 2438 S.A RP (Part), 2438 S.B (Part), 2439 (Part), 2962 (Part), 2976 (Part), 2977 S.A (Part), 2977 S.B (Part), 2978, 2979 (Part) & 2980 (Part) in D.D.129, Lau Fau Shan, Yuen Long, N.T.

Drawing Title 圖目:

As-built Drainage Plan

Drawing No. 圖號:

Figure 4

Remarks 備註:

☐ Catchpit

⇐ Flow of surface runoff

+4.9 Level (in mPD)

Scale 比例:

1:1000