

LOCATION OF THE APPLICATION SITE

APPLICATION SITE AREA : 3,037 m² (ABOUT)

VEHICULAR ACCESS

ACCESSIBLE FROM FUNG KONG TSUEN ROAD VIA A LOCAL ACCESS

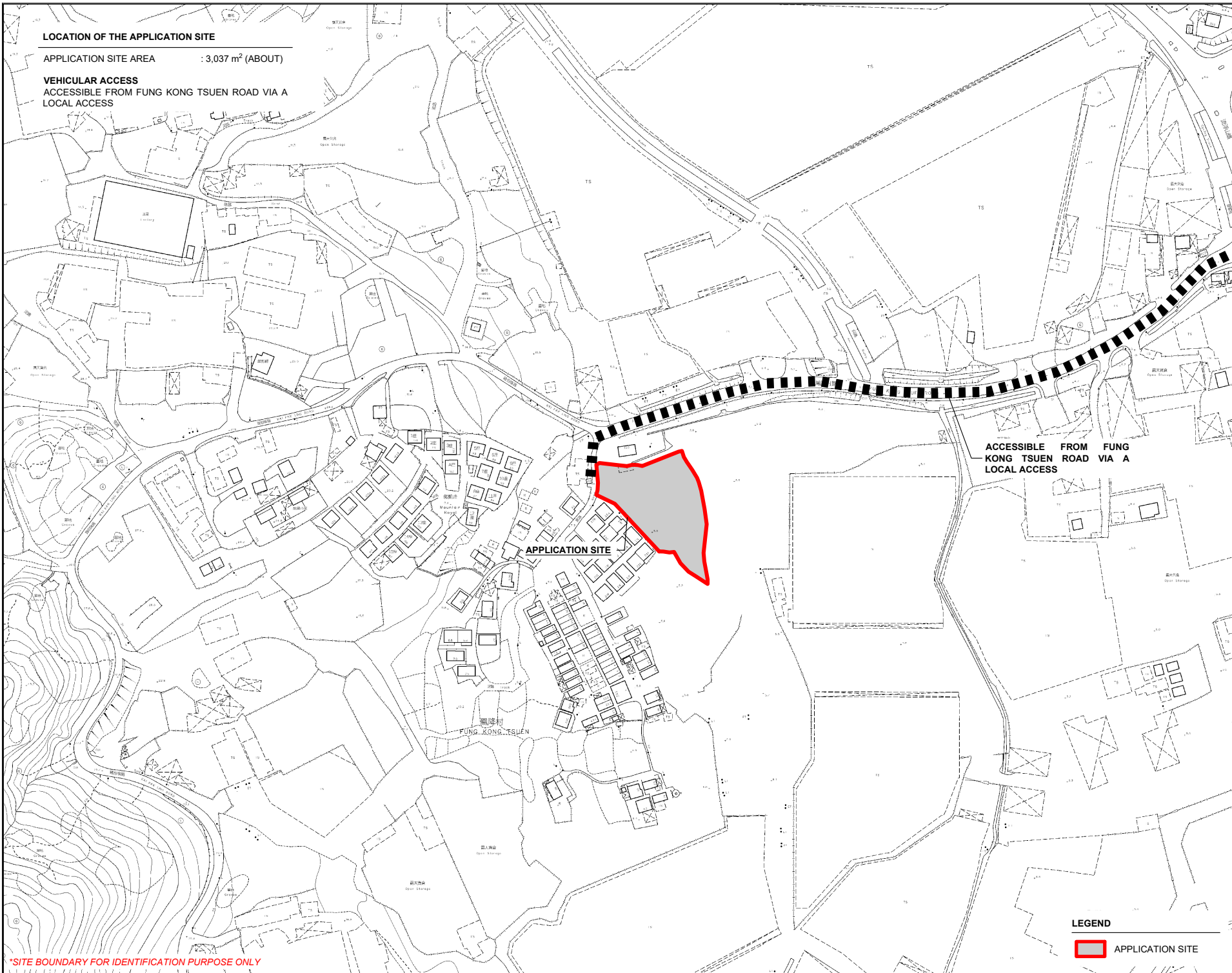
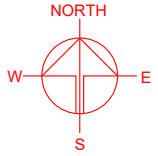

*SITE BOUNDARY FOR IDENTIFICATION PURPOSE ONLY

LEGEND

 APPLICATION SITE

PLANNING CONSULTANT



PROJECT

TEMPORARY PUBLIC VEHICLE PARK (EXCLUDING CONTAINER VEHICLE) FOR A PERIOD OF 5 YEARS

SITE LOCATION

VARIOUS LOTS IN D.D. 128 AND D.D. 129, FUNG KONG TSUEN, YUEN LONG, NEW TERRITORIES

SCALE
1 : 3000 @ A4

| | |
|----------------|-------------------|
| DRAWN BY MN | DATE 23.2.2026 |
|----------------|-------------------|

| | |
|------------|------|
| REVISED BY | DATE |
|------------|------|

| | |
|-------------|------|
| APPROVED BY | DATE |
|-------------|------|

DWG. TITLE
LOCATION PLAN

| | |
|-------------------|-------------|
| DWG NO. PLAN 1 | VER. 001 |
|-------------------|-------------|

ZONING OF THE APPLICATION SITE

APPLICATION SITE AREA : 3,037 m² (ABOUT)
 OUTLINE ZONING PLAN : APPROVED HUNG SHUI KIU AND HA TSUEN OZP
 OZP PLAN NO. : S/HSK/2
 ZONING OF THE SITE : "VILLAGE TYPE DEVELOPMENT" ("V")

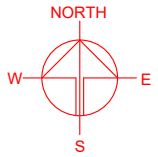

*SITE BOUNDARY FOR IDENTIFICATION PURPOSE ONLY

LEGEND
 APPLICATION SITE

PLANNING CONSULTANT



PROJECT

TEMPORARY PUBLIC VEHICLE PARK (EXCLUDING CONTAINER VEHICLE) FOR A PERIOD OF 5 YEARS

SITE LOCATION

VARIOUS LOTS IN D.D. 128 AND D.D. 129, FUNG KONG TSUEN, YUEN LONG, NEW TERRITORIES

SCALE
 1 : 3000 @ A4

DRAWN BY: MN DATE: 23.2.2026

REVISED BY: DATE:

APPROVED BY: DATE:

DWG. TITLE
 ZONING OF THE SITE

DWG NO.: PLAN 2 VER.: 001

DEVELOPMENT PARAMETERS

| | | |
|-----------------------|------------------------|---------|
| APPLICATION SITE AREA | : 3,037 m ² | (ABOUT) |
| COVERED AREA | : 136 m ² | (ABOUT) |
| UNCOVERED AREA | : 2,901 m ² | (ABOUT) |
| | | |
| PLOT RATIO | : 0.05 | (ABOUT) |
| SITE COVERAGE | : 4 % | (ABOUT) |
| | | |
| NO. OF STRUCTURE | : 3 | |
| DOMESTIC GFA | : NOT APPLICABLE | |
| NON-DOMESTIC GFA | : 163 m ² | (ABOUT) |
| TOTAL GFA | : 163 m ² | (ABOUT) |
| | | |
| BUILDING HEIGHT | : 3.5 m - 6.5 m | (ABOUT) |
| NO. OF STOREY | : 1 - 2 | |

| STRUCTURE | USE | COVERED AREA | GROSS FLOOR AREA | BUILDING HEIGHT |
|--------------|------------------------|---------------------------------|---------------------------------|------------------------|
| B1 | CARETAKER OFFICE | 42m ² (ABOUT) | 42m ² (ABOUT) | 3.5m (ABOUT)(1-STOREY) |
| B2 | SITE OFFICE | 27m ² (ABOUT) | 54m ² (ABOUT) | 6.5m (ABOUT)(2-STOREY) |
| B3 | COVERED PARKING SPACES | 67m ² (ABOUT) | 67m ² (ABOUT) | 3.5m (ABOUT)(1-STOREY) |
| TOTAL | | 136m² (ABOUT) | 163m² (ABOUT) | |

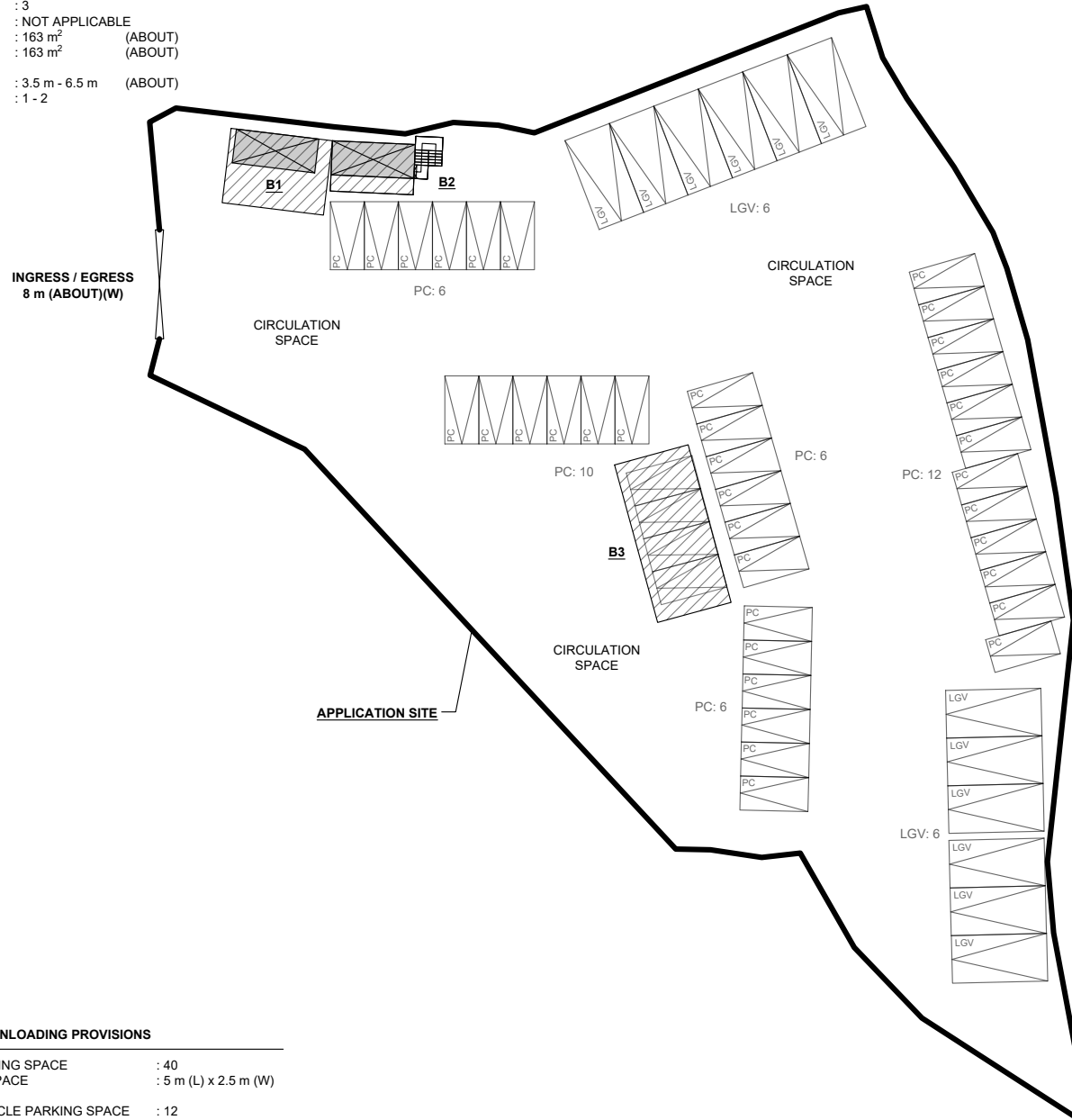
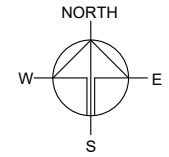

PARKING AND LOADING / UNLOADING PROVISIONS

| | |
|--|-----------------------|
| NO. OF PRIVATE CAR PARKING SPACE | : 40 |
| DIMENSION OF PARKING SPACE | : 5 m (L) x 2.5 m (W) |
| | |
| NO. OF LIGHT GOODS VEHICLE PARKING SPACE | : 12 |
| DIMENSION OF L/UL SPACE | : 7 m (L) x 3.5 m (W) |

*SITE BOUNDARY FOR IDENTIFICATION PURPOSE ONLY

LEGEND

- APPLICATION SITE
- STRUCTURE (ENCLOSED)
- STRUCTURE (CANOPY)
- INGRESS / EGRESS
- PARKING SPACE (PRIVATE CAR)
- PARKING SPACE (LIGHT GOODS VEHICLE)

PLANNING CONSULTANT



PROJECT

TEMPORARY PUBLIC VEHICLE PARK (EXCLUDING CONTAINER VEHICLE) FOR A PERIOD OF 5 YEARS

SITE LOCATION

VARIOUS LOTS IN D.D. 128 AND D.D. 129, FUNG KONG TSUEN, YUEN LONG, NEW TERRITORIES

SCALE

1 : 500 @ A4

| | |
|----------|-----------|
| DRAWN BY | DATE |
| MN | 23.2.2026 |

| | |
|------------|------|
| REVISED BY | DATE |
| | |

| | |
|-------------|------|
| APPROVED BY | DATE |
| | |

DWG. TITLE
LAYOUT PLAN

| | |
|---------|------|
| DWG NO. | VER. |
| PLAN 4 | 001 |

SWEPT PATH ANALYSIS

TYPE OF VEHICLE : LIGHT GOODS VEHICLE
 DIMENSION OF VEHICLE : 2.1 m (W) X 5.2 m (L)

SWEPT PATHS GENERATED BY AUTODESK VEHICLE TRACKING

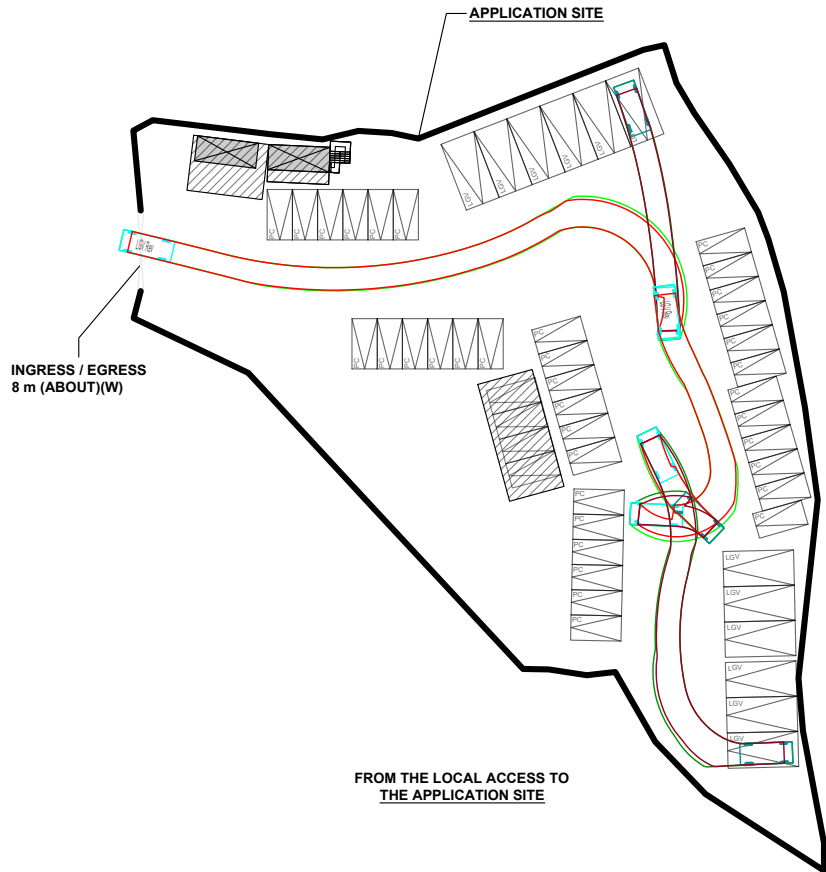

FROM THE LOCAL ACCESS TO THE APPLICATION SITE

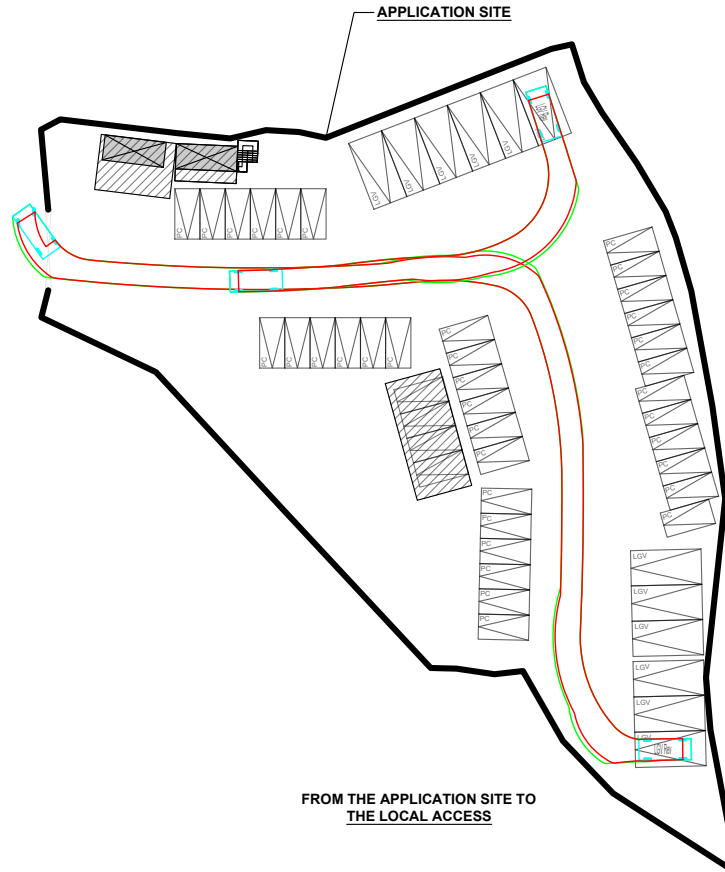

FROM THE APPLICATION SITE TO THE LOCAL ACCESS

LEGEND

- APPLICATION SITE
- STRUCTURE (ENCLOSED)
- STRUCTURE (CANOPY)
- INGRESS / EGRESS
- PARKING SPACE (PRIVATE CAR)
- PARKING SPACE (LIGHT GOODS VEHICLE)
- LIGHT GOODS VEHICLE
- SWEPT PATH ANALYSIS

*SITE BOUNDARY FOR IDENTIFICATION PURPOSE ONLY

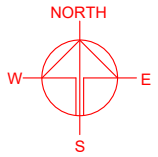

PLANNING CONSULTANT



PROJECT

TEMPORARY PUBLIC VEHICLE PARK (EXCLUDING CONTAINER VEHICLE) FOR A PERIOD OF 5 YEARS

SITE LOCATION

VARIOUS LOTS IN D.D. 128 AND D.D. 129, FUNG KONG TSUEN, YUEN LONG, NEW TERRITORIES

SCALE

1 : 750 @ A4

DRAWN BY

MN

DATE

23.2.2026

CHECKED BY

DATE

APPROVED BY

DATE

DWG. TITLE

SWEPT PATH ANALYSIS

DWG NO.

PLAN 5

VER.

001