

Project 項目名稱:

Proposed Temporary Logistics Centre and Ancillary Parking of Vehicle for a Period of 3 Years at Lots 3150 RP(Part), 3151 RP(Part), 3152 RP(Part), 3162 RP, 3163 RP(Part), 3164(Part), 3165, 3166, 3167 S.A(Part), 3168(Part), 3169(Part), 3177(Part), 3178(Part), 3179, 3180, 3181 S.A(Part), 3181 RP(Part), 3182, 3183(Part), 3184(Part), 3187 RP(Part) and 3188 RP(Part) in D.D. 129, & Adjoining Government Land, Ha Tsuen, Yuen Long, N.T.

Drawing Title 圖紙標題:

Extract from  
OZP  
No. S/HSK/2



Drawing No. 圖號:

Remarks 備註:

Scale 比例:



N



**Structure 3**  
 F.S. Water Tank  
 GFA: Not exceeding 45m<sup>2</sup>  
 No. of storey: 1  
 Height: Not exceeding 5m

**Structure 7**  
 F.S. Pump  
 GFA: Not exceeding 21m<sup>2</sup>  
 No. of storey: 1  
 Height: Not exceeding 3m

**Structure 2**  
 Water Meter Room  
 GFA: Not exceeding 4m<sup>2</sup>  
 No. of storey: 1  
 Height: Not exceeding 3m

**Structure 4**  
 Converted container  
 for site office use  
 GFA: Not exceeding 40m<sup>2</sup>  
 No. of storey: 1  
 Height: Not exceeding 3m

**Structure 1**  
 Site Office  
 GFA: Not exceeding 220m<sup>2</sup>  
 No. of storey: 2  
 Height: Not exceeding 8m

6 parking spaces of  
 16m x 3.5m for  
 container vehicle

**Structure 10**  
 Toilet  
 GFA: Not exceeding 8m<sup>2</sup>  
 No. of storey: 1  
 Height: Not exceeding 3m

Ingress/  
 Egress

5 parking spaces of  
 5m x 2.5m for  
 private car

5 parking spaces  
 of 11m x 3.5m for  
 medium/heavy goods  
 vehicle

**Structure 9**  
 Converted container  
 for forklift parking  
 GFA: Not exceeding 40m<sup>2</sup>  
 No. of storey: 1  
 Height: Not exceeding 3m

Ramp leading  
 to the  
 warehouse

**Structure 6**  
 Electrical Meter Room  
 GFA: Not exceeding 4m<sup>2</sup>  
 No. of storey: 1  
 Height: Not exceeding 3m

2 Loading/unloading bay  
 of 11m x 3.5m for heavy  
 goods vehicle

**Structure 8**  
 Toilet  
 GFA: Not exceeding 8m<sup>2</sup>  
 No. of storey: 1  
 Height: Not exceeding 3m

**Structure 5**  
 Logistics centre  
 GFA: Not exceeding 5,491m<sup>2</sup>  
 No. of storey: 1  
 Height: Not exceeding 7.62m

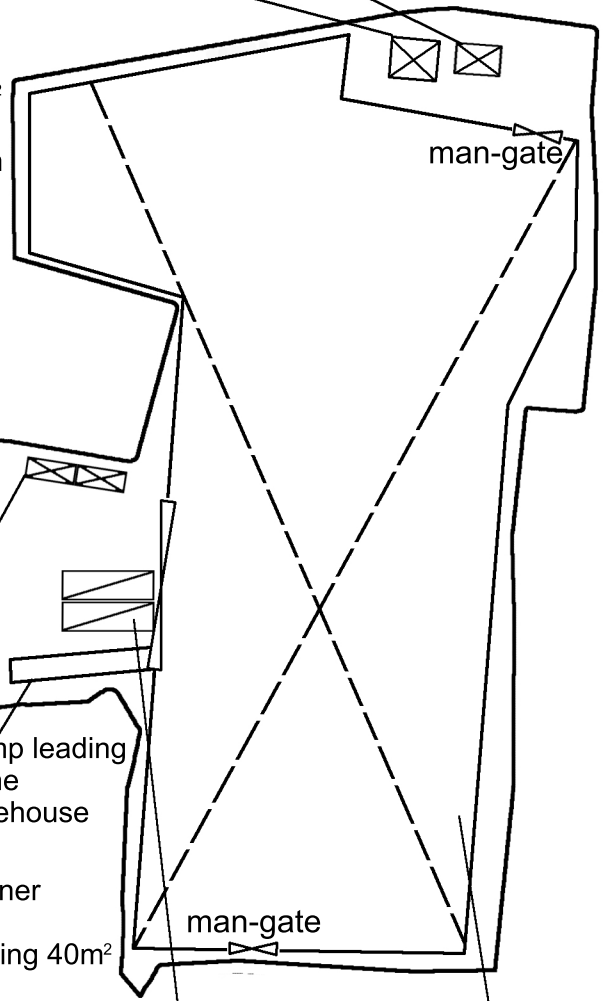

Project 項目名稱:

Proposed Temporary Logistics Centre and Ancillary  
 Parking of Vehicle for a Period of 3 Years at Lots  
 3150 RP(Part), 3151 RP(Part), 3152 RP(Part),  
 3162 RP, 3163 RP(Part), 3164(Part), 3165, 3166,  
 3167 S.A(Part), 3168(Part), 3169(Part), 3177(Part),  
 3178(Part), 3179, 3180, 3181 S.A(Part),  
 3181 RP(Part), 3182, 3183(Part), 3184(Part),  
 3187 RP(Part) and 3188 RP(Part) in D.D. 129, &  
 Adjoining Government Land, Ha Tsuen, Yuen Long,  
 N.T.

Drawing Title 圖紙標題:

Layout Plan



Drawing No. 圖號:

Remarks 備註:

Scale 比例:

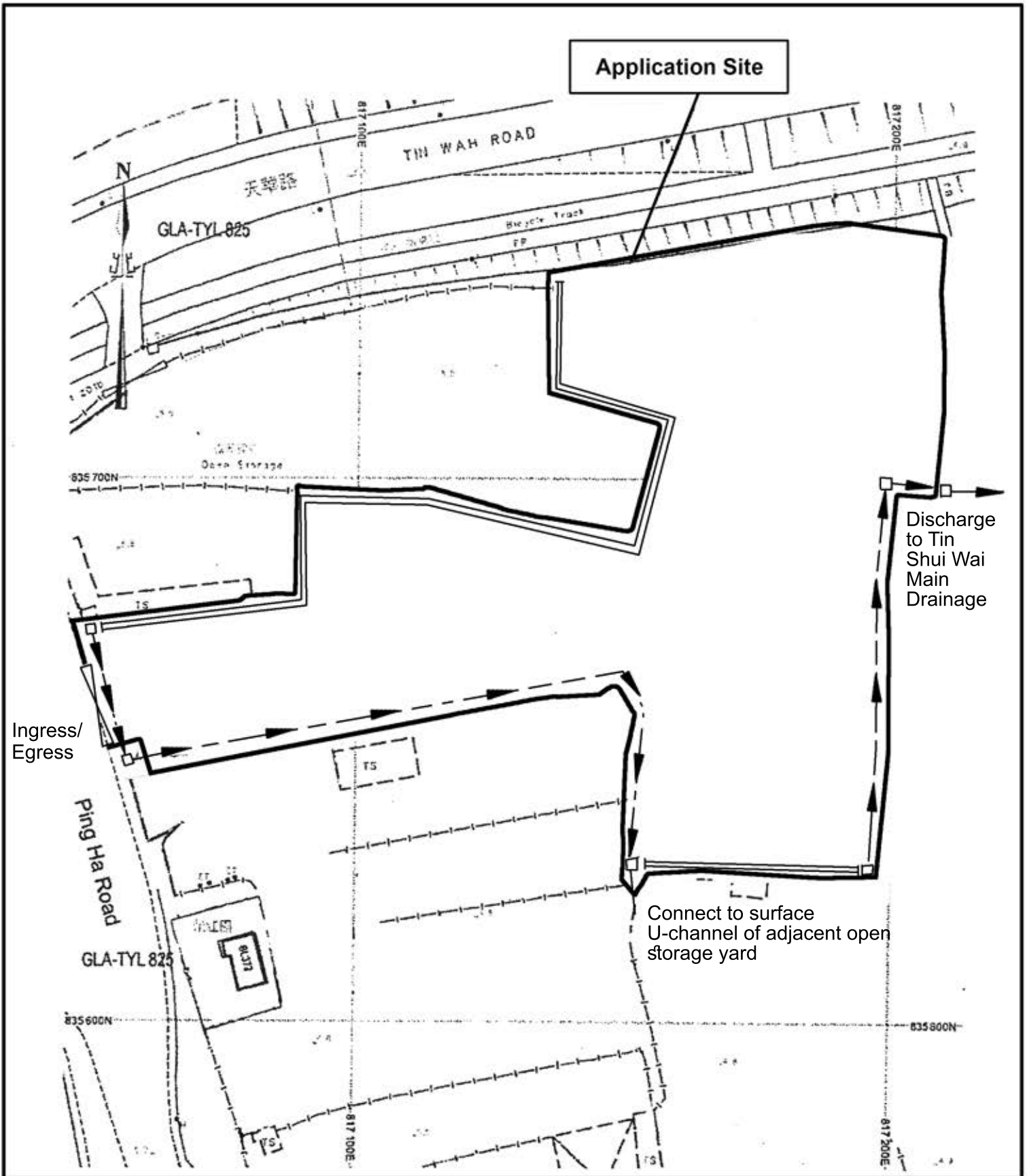

Project 項目名稱:

Proposed Temporary Logistics Centre and Ancillary Parking of Vehicle for a Period of 3 Years at Lots 3150 RP(Part), 3151 RP(Part), 3152 RP(Part), 3162 RP, 3163 RP(Part), 3164(Part), 3165, 3166, 3167 S.A(Part), 3168(Part), 3169(Part), 3177(Part), 3178(Part), 3179, 3180, 3181 S.A(Part), 3181 RP(Part), 3182, 3183(Part), 3184(Part), 3187 RP(Part) and 3188 RP(Part) in D.D. 129, & Adjoining Government Land, Ha Tsuen, Yuen Long, N.T.

Drawing Title 圖紙標題:

As-built Drainage Plan  
(Accepted for previous  
planning permission  
No. A/HSK/227 )

Drawing No. 圖號:

Remarks 備註:

- Existing 375mm surface U-channel
- Existing 12" high concrete kerb to prevent the flow of surface runoff from the site to adjacent area
- Catchpit

Scale 比例:



Tree	Approximate Height	Spacing	Quantity
Existing <i>Ficus microcarpa</i> (Chinese Banyan)	About 3m to 5m	About 3m	103
Existing <i>Melaleuca leucadendra</i>	About 3m to 4.5m	About 3m	14
Newly planted <i>Bauhinia blakeana</i>	About 2.75m	About 3m	29

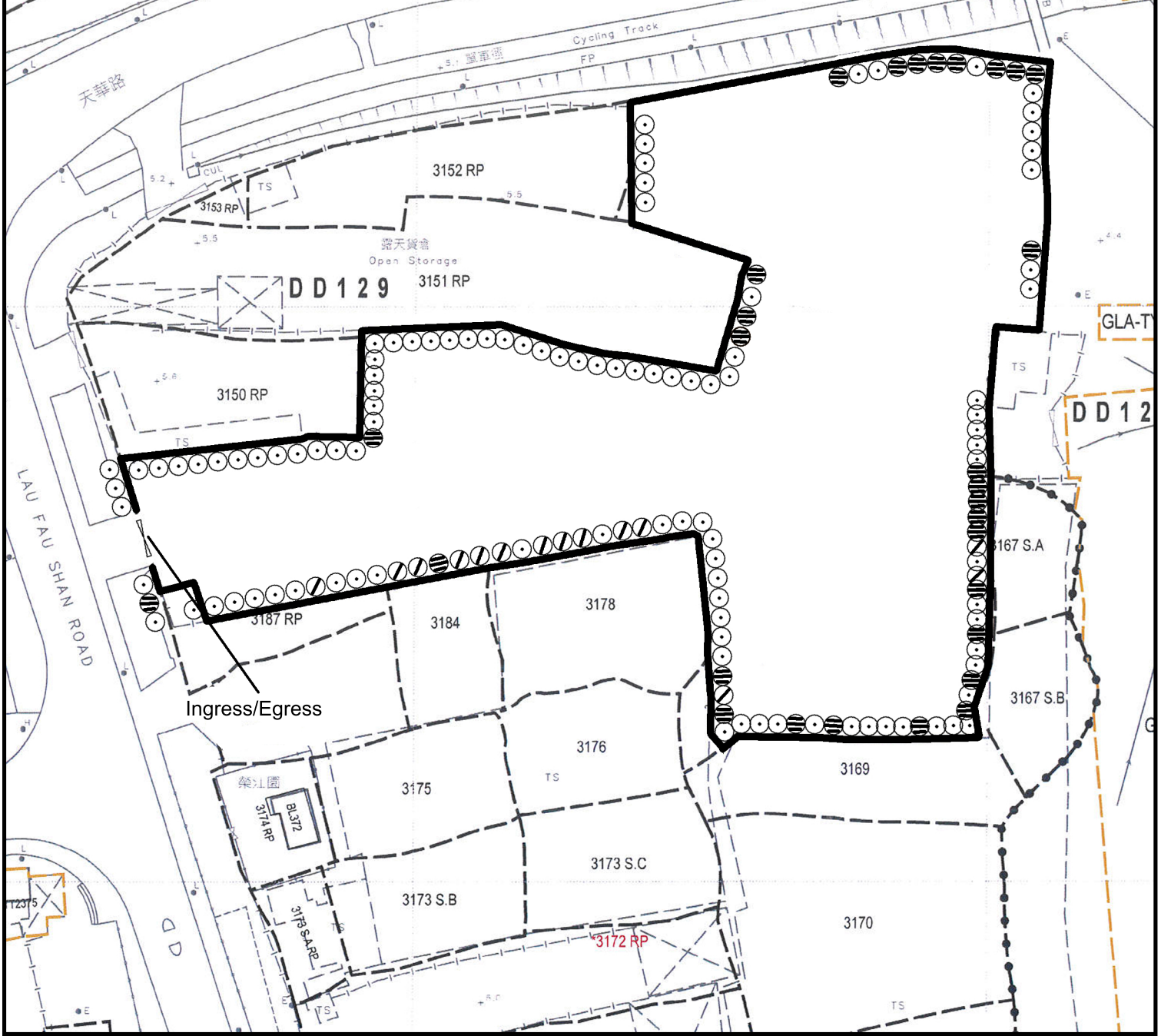

Project 項目名稱:  
**Application No.A/HSK/227:  
 Temporary Logistics Centre and Ancillary  
 Parking of Vehicles For a Period of 3 Years**

Drawing Title 圖紙標題:  
**Existing  
 Landscape &  
 Tree  
 Preservation  
 Plan**



Remarks 備註:

Drawing No. 圖號:

Scale 比例:

**APPENDIX I**

Proposed Temporary Logistics Centre and Ancillary Parking of Vehicle for a Period of 3 Years at Lots 3150 RP(Part), 3151 RP(Part), 3152 RP(Part), 3162 RP, 3163 RP(Part), 3164(Part), 3165, 3166, 3167 S.A(Part), 3168(Part), 3169(Part), 3177(Part), 3178(Park), 3179, 3180, 3181 S.A(Part), 3181 RP(Part), 3182, 3183(Part), 3184(Part), 3187 RP(Park) and 3188 RP (Park), in D.D. 129.& Adjoining Government Land Ha Tsuen, Yuen Long, N.T.

**F.S. NOTES:**

**1. GENERAL**

- 1.1 FIRE SERVICE INSTALLATIONS SHALL BE PROVIDED IN ACCORDANCE WITH THE CODES OF PRACTICE FOR MINIMUM FIRE SERVICE INSTALLATIONS AND EQUIPMENT AND INSPECTION, TESTING AND MAINTENANCE OF INSTALLATIONS AND EQUIPMENT 2012 (COP 2012), FSD CIRCULAR LETTERS AND THE HONG KONG WATERWORKS STANDARD REQUIREMENTS.
- 1.2 ALL TUBES AND FITTINGS SHALL BE G.M.S. TO BS1387 MEDIUM GRADE WHERE PIPEWORK UP TO #150mm.
- 1.3 ALL TUBES AND FITTINGS SHALL BE DUCTILE IRON TO BS EN545 K12 WHERE PIPEWORK ABOVE #150mm.
- 1.4 ALL DRAIN PIPES SHALL BE DISCHARGED TO A CONSPICUOUS POSITION WITHOUT THE POSSIBILITY OF BEING SUBMERGED.
- 1.5 ALL PUDDLE FLANGES SHALL BE MADE OF DUCTILE IRON
- 1.6 THE AGGREGATE AREA OF OPENABLE WINDOWS NOT LESS THAN 6.25% OF THE FLOOR AREA OF THE STRUCTURE

**2. HOSE REEL SYSTEM**

- 2.1 NEW FIRE HOSE REEL SHALL BE PROVIDED AS INDICATED ON PLAN TO ENSURE THAT EVERY PART OF THE BUILDING CAN BE REACHED BY A LENGTH OF NOT MORE THAN 30m HOSE REEL TUBING.
- 2.2 THE WATER SUPPLY FOR HOSE REEL SYSTEM WILL BE FED FROM A NEW 2m<sup>3</sup> F.S. FIBREGLASS WATER TANK VIA TWO HOSE REEL PUMPS (DUTY/STANDBY) LOCATED INSIDE FS PUMP ROOM AT EXTERNAL AREA.
- 2.3 HOSE REEL PUMPS SHALL BE STARTED BY ACTUATION OF ANY BREAKGLASS UNIT FITTED ASIDE EACH HOSE REEL SETS
- 2.4 ALL FIRE HOSE REEL OUTLETS SHOULD BE HOUSED IN GLASS FRONTED CABINET SECURED UNDER LOCK & KEY.
- 2.5 ALL FIRE HOSE REEL SHOULD BE PROVIDED WITH FSD APPROVED TYPE INSTRUCTION PLATE & WSD WARNING PLATE
- 2.6 SECONDARY ELECTRICITY SUPPLY DIRECTLY TEE OFF BEFORE CLP'S INCOMING MAIN SWITCH SHALL BE PROVIDED FOR THE FH/HR PUMPS.

**3. AUTOMATIC SPRINKLER SYSTEM**

- 3.1 NEW AUTOMATIC SPRINKLER SYSTEM SHALL BE PROVIDED AND INSTALLED IN ACCORDANCE WITH LPC RULES FOR AUTOMATIC SPRINKLER INSTALLATIONS INCORPORATING BS EN 12845: 2003 (INCLUDING TECHNICAL BULLETINS, NOTES, COMMENTAR AND RECOMMENDATIONS) AND FSD CIRCULAR LETTER NOTES, COMMENTAR AND RECOMMENDATIONS) AND FSD CIRCULAR LETTER NO. 3/2006 AND 3/2012. THE CLASSIFICATION OF THE OCCUPANCIES WILL BE ORDINARY HAZARD GROUP III.
- 3.2 ONE NEW 90m<sup>3</sup> SPRINKLER WATER TANK WILL BE PROVIDED AS INDICATED ON PLAN. THE TOWN MAIN WATER SUPPLY WILL BE FED FROM SINGLE END.
- 3.3 TWO NEW SPRINKLER PUMPS (DUTY/STANDBY) AND ONE JOCKEY PUMP SHALL BE PROVIDED IN FS PUMP ROOM LOCATED AT EXTERNAL AREA.
- 3.4 NEW SPRINKLER CONTROL VALVE SET AND SPRINKLER INLET SHALL BE PROVIDED AS INDICATED ON PLAN.
- 3.5 A TEST VALVE SHALL BE PROVIDED FOR EACH ZONE OF SPRINKLER PIPE. THIS VALVE SHALL BE AT A CONSPICUOUS POSITION THAT WATER CAN BE DRAINED AWAY EASILY.
- 3.6 ALL SUBSIDIARY STOP VALVES TO BE ELECTRIC MONITORING TYPE.
- 3.7 ALL ELECTRIC TYPE VALVES SHOULD GIVE VISUAL SIGNALS TO FIRE SERVICE MAIN SUPERVISORY CONTROL PANEL TO INDICATE THE STATUS (OPEN/CLOSE) OF THE VALVES.
- 3.8 SECONDARY ELECTRICITY SUPPLY DIRECTLY TEE OFF BEFORE CLP'S INCOMING MAIN SWITCH SHALL BE PROVIDED FOR THE SPRINKLER PUMPS.
- 3.9 THE SPRINKLER SYSTEM DESIGN IS BASED ON THE FOLLOWINGS:  
HAZARD CLASS : ORDINARY HAZARD GROUP III  
TYPE OF STORAGE : POST-PALLET (ST2)  
STORAGE CATEGORY : CATEGORY I  
MAXIMUM STORAGE HEIGHT : 3.5m  
SPRINKLER PROTECTION : CEILING PROTECTION ONLY

**4. FIRE ALARM SYSTEM**

- 4.1 NEW FIRE ALARM SYSTEM SHALL BE PROVIDED IN ACCORDANCE WITH BS 5839-1:2002 +A2:2008 AND FSD CIRCULAR LETTERS NO. 1/2009 & 3/2010.
- 4.2 NEW BREAKGLASS UNITS AND FIRE ALARM BELLS SHALL BE PROVIDED AT ALL NEW FIRE HOSE REEL POINTS. THE FIRE ALARM INTALLATION WILL BE INTEGRATED WITH THE HOSE REEL SYSTEM.
- 4.3 A NEW FIRE ALARM CONTROL PANEL SHALL BE PROVIDED TO RECEIVE ALL FIRE ALARM SIGNALS FROM BREAKGLASS UNITS AND SPRINKLER FLOW SWITCHES AND TRANSMIT THE SAME TO THE CFATS VIA DIRECT LINK.

**5. EMERGENCY LIGHTING**

- 5.1 EMERGENCY LIGHTING SHALL BE PROVIDED IN ACCORDANCE WITH 'BS 5266-PART 1 :2011 AND BS EN 1838 :2013', COVERING ALL AREA. EMERGENCY LIGHTINGS SHALL BE BACKED UP BY BUILT-IN BATTERY AND CAPABLE OF MAINTAINING FUNCTION OF NOT LESS THAN 2 HOURS IN CASE OF POWER FAILURE

**6. EXIT SIGN**

- 6.1 ALL EXIT SIGNS/DIRECTIONAL EXIT SIGNS SHALL BE PROVIDED IN ACCORDANCE WITH 'BS 5266-PART 1 AND FSD CIRCULAR LETTER NO. 5/2008, AND SECTION 5.10 OF COP 2012 FOR THE BUILDING. EXIT SIGNS/DIRECTIONAL EXIT SIGNS SHALL BE BACKED UP BY BUILT-IN BATTERY AND CAPABLE OF MAINTAINING FUNCTION OF NOT LESS THAN 2 HOURS IN CASE OF POWER FAILURE.

**7. PORTABLE APPLIANCES**

- 7.1 PORTABLE HAND OPERATED APPLIANCES SHALL BE PROVIDED AS INDICATED ON PLAN.

**Structure 5 Openable Windows Calculation**

Area of Structure 1 = 5491sq.m.  
 Area of opening 1 = 6.0m(W) x 5.5m(H) = 33 sq.m.  
 Area of opening 2 = 6.0m(W) x 5.5m(H) = 33 sq.m.  
 Area of opening 3 = 6.0m(W) x 5.5m(H) = 33 sq.m.  
 Area of opening 4 = 6.0m(W) x 5.5m(H) = 33 sq.m.  
 Area of opening 5 = 6.0m(W) x 5.5m(H) = 33 sq.m.  
 Area of opening 6 = 6.0m(W) x 5.5m(H) = 33 sq.m.  
 Area of High Bay Window (H.B.W.) 1 = 2.0m(H) x 60m = 120 sq.m.  
 Area of High Bay Window (H.B.W.) 2 = 2.0m(H) x 12m = 24 sq.m.  
 Area of High Bay Window (H.B.W.) 3 = 2.0m(H) x 12m = 24 sq.m.  
 Total openable window area = 33 + 33 + 33 + 33 + 33 + 33 + 120 + 24 + 24 = 366 sq.m.  
 = 6.66% of floor area

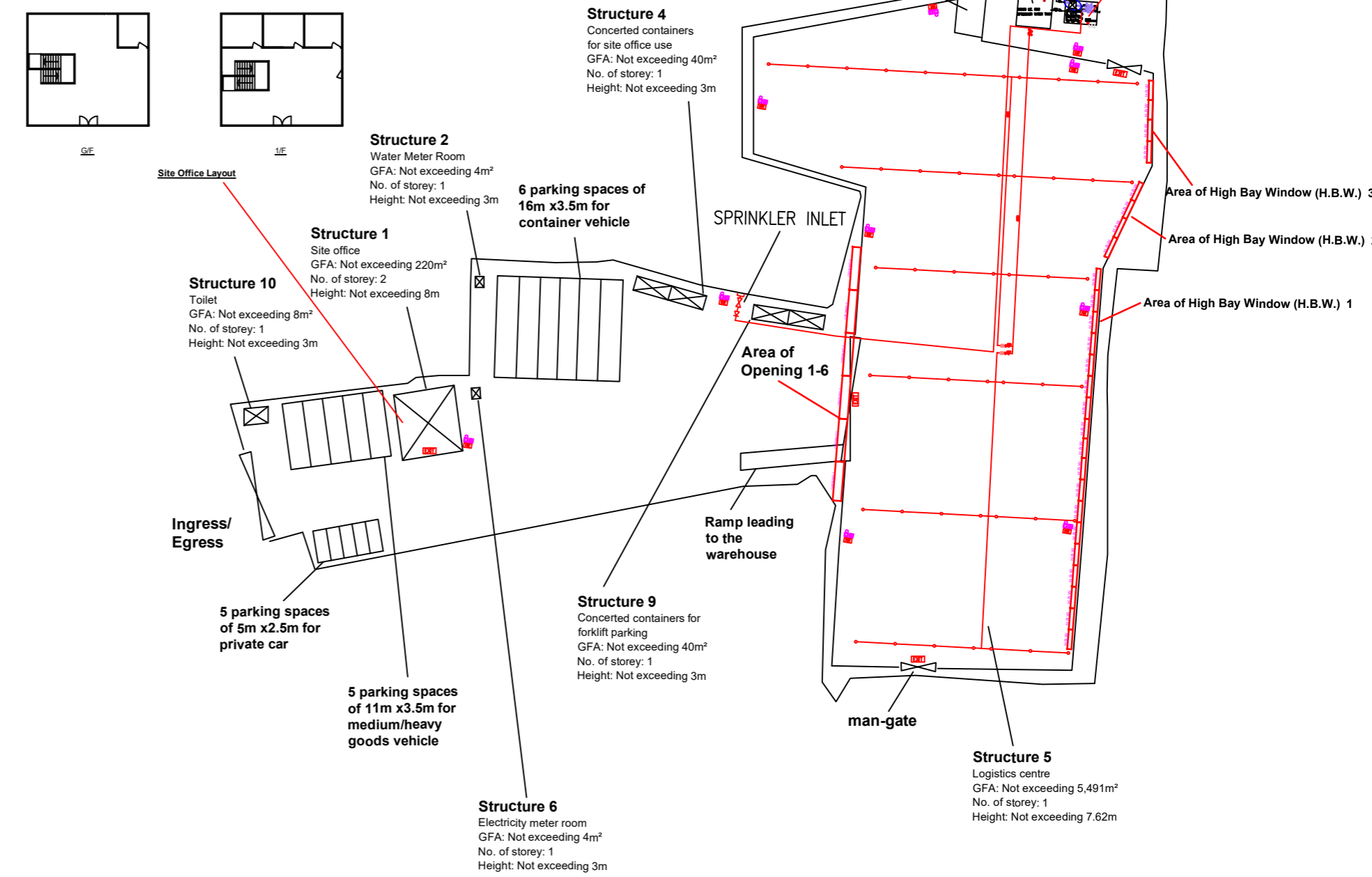

**LEGEND**

- |                  |                  |                                |                             |                 |
|------------------|------------------|--------------------------------|-----------------------------|-----------------|
| HOSE REEL        | EMERGENCY LIGHT  | 5KG CO2 FIRE EXTINGUISHER      | SPRINKLER CONTROL VALVE SET | PUMP SET        |
| BREAK GLASS UNIT | EXIT SIGN        | SPRINKLER HEAD (ON PLAN)       | GATE VALVE                  | Y-TYPE STRAINER |
| FIRE ALARM BELL  | NON-RETURN VALVE | SUBSIDIARY VALVE / FLOW SWITCH | GATE TYPE (With MONITORING) | SPRINKLER INLET |

PROJECT : Proposed Temporary Logistics Centre and Ancillary Parking of Vehicle for a Period of 3 Years at Lots 3150 RP(Part), 3151 RP(Part), 3152 RP(Part), 3162 RP, 3163 RP(Part), 3164(Part), 3165, 3166, 3167 S.A(Part), 3168(Part), 3169(Part), 3177(Part), 3178(Park), 3179, 3180, 3181 S.A(Part), 3181 RP(Part), 3182, 3183(Part), 3184(Part), 3187 RP(Park) and 3188 RP (Park), in D.D. 129.& Adjoining Government Land Ha Tsuen, Yuen Long, N.T.	DRAWING TITLE : <b>F.S. Notes, Legend, Fire Service Installation Layout Plan</b>	ARCHITECT :	CONSULTANT :	FIRE SERVICE CONTRACTOR : <b>Century Fire Service Engineering Co., Ltd.</b>	NAME	DATE	DRAWING NO : <b>FS-01</b>	REV. <b>0</b>
		REV	DESCRIPTION	DATE	DRAWN BY C.K.NG	14 MAY 2020	SCALE : 1 : 300 (A0)	SOURCE : B.O.O. Ref. BD F.S.D. Ref. FP
		CHECKED BY	APPROVED BY					