

LAND STATUS OF THE APPLICATION SITE

APPLICATION SITE AREA : 278.7m²(ABOUT±1m²)

AREA OF PRIVATE LAND : 278.7m²(ABOUT)(100%)

AREA OF GOVERNMENT : NOT APPLICABLE

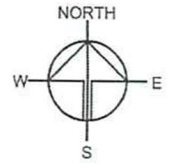

Drawing No. P01	Ver. 02
Project PROPOSED TEMPORARY PLACE OF RECREATION, SPORTS OR CULTURE (HOBBY FARM) FOR A PERIOD OF 3 YEARS	
LOT NOS. 1886 AND 1890RP IN D.D. 1, TUNG CHUNG, TUNG CHUNG ROAD, LANTAU ISLAND, NEW TERRITORIES	
Drawing Title LAND STATUS OF THE SITE	
Scale of A4	
Drawn	Date 27-6-2025
Revised	Date

DEVELOPMENT PARAMETERS

APPLICATION SITE AREA : 278.7m²(ABOUT±1m²)
 COVERED AREA : 123.4m²(ABOUT)
 UNCOVERED AREA : 155.3m²(ABOUT)

AREA OF FARMLAND : 70m²(ABOUT)
 PAVED AREA : 85.3m²(ABOUT)

NO. OF STRUCTURE : 1
 DOMESTIC GFA : N/A
 NON-DOMESTIC GFA : 123.4m²(ABOUT)
 BUILDING HEIGHT : Not more than 7m high
 NO. OF STOREY : 1

STRUCTURE PROPOSED USE COVERED AREA GFA BUILDING HEIGHT

STRUCTURE	PROPOSED USE	COVERED AREA	GFA	BUILDING HEIGHT
B1	Reception Centre, Electric Meter Room, Aquaponics Reference, Fish&Farm tool storage, Green Houses	123.4m ² (ABOUT)	123.4m ² (ABOUT)	Not more than 7m high(1-STOREY)
TOTAL		123.4m²(ABOUT)	123.4m²(ABOUT)	

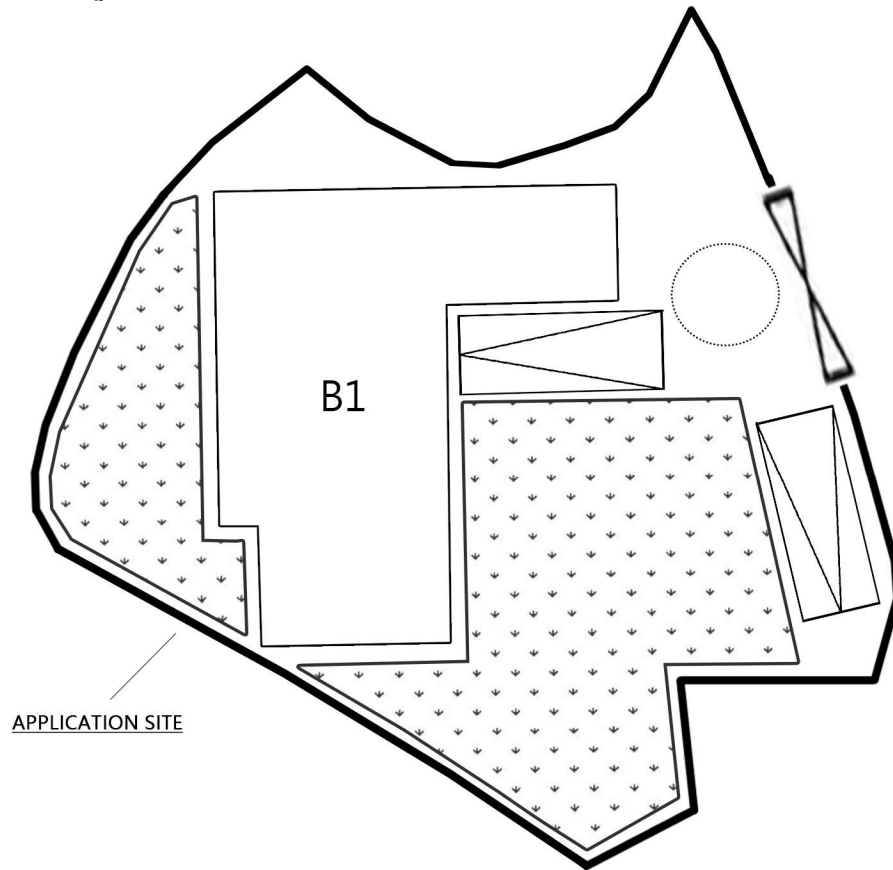
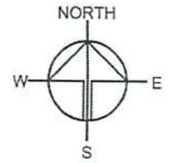

LEGEND

- APPLICATION SITE
- STRUCTURE
- PARKING SPACE
- INGRESS / EGRESS (6m)
- CIRCULATION SPACE
- FARMLAND

Drawing No. P02	Ver. 05
Project PROPOSED TEMPORARY PLACE OF RECREATION, SPORTS OR CULTURE (HOBBY FARM) FOR A PERIOD OF 3 YEARS	
LOT NOS. 1886 AND 1890RP IN D.D. 1, TUNG CHUNG, TUNG CHUNG ROAD, LANTAU ISLAND, NEW TERRITORIES	
Drawing Title LAYOUT PLAN	
Scale of A4	
Drawn	Date 08-07-2025
Revised	Date

Floor Plan(B1)

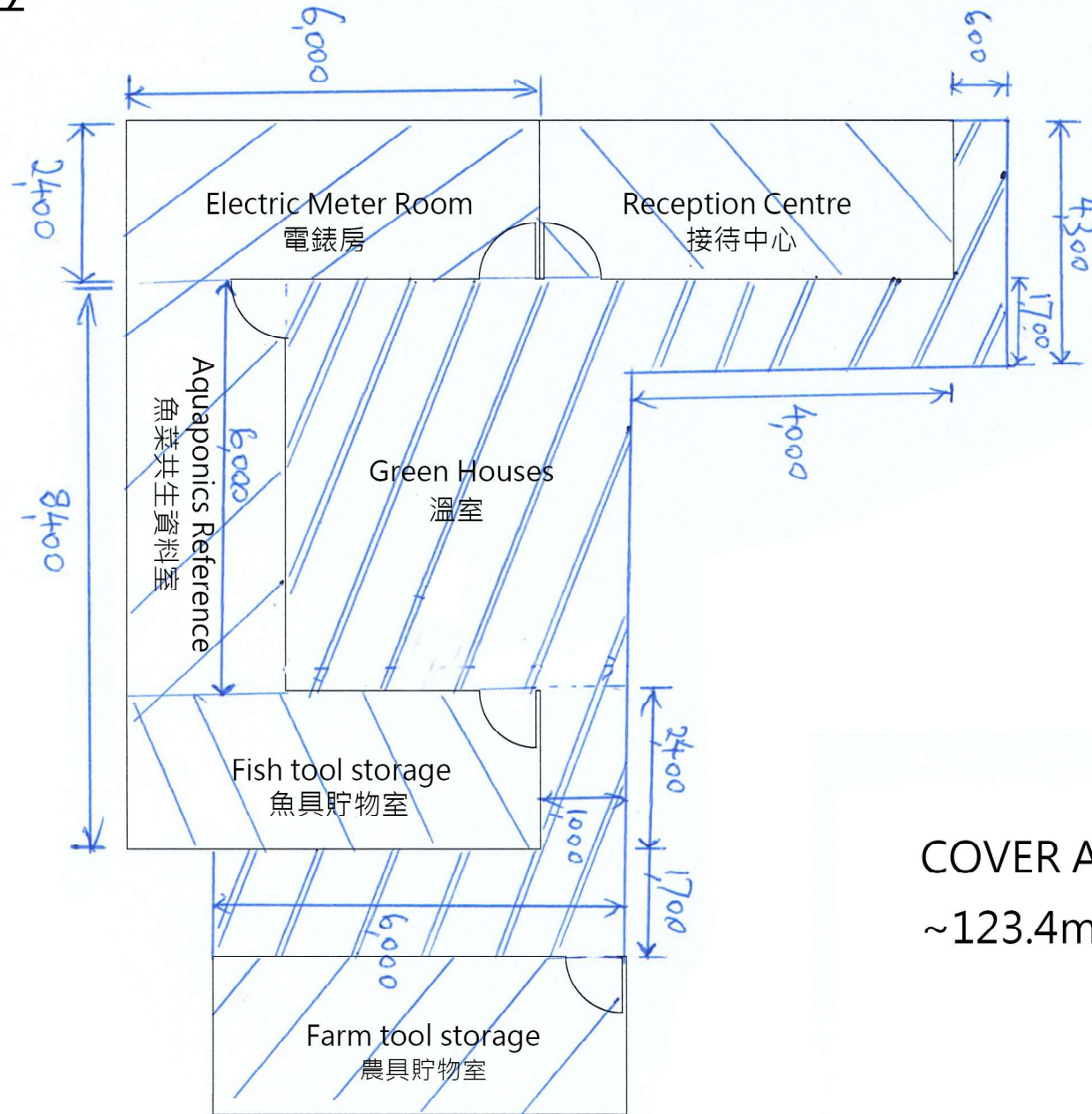

COVER AREA :
~123.4m²

消防設施

DEVELOPMENT PARAMETERS

APPLICATION SITE AREA : 278.7m²(ABOUT±1m²)
 COVERED AREA : 123.4m²(ABOUT)
 UNCOVERED AREA : 155.3m²(ABOUT)

AREA OF FARMLAND : 70m²(ABOUT)
 PAVED AREA : 85.3m²(ABOUT)

NO. OF STRUCTURE : 1
 DOMESTIC GFA : N/A
 NON-DOMESTIC GFA : 123.4m²(ABOUT)
 BUILDING HEIGHT : Not more than 7m high
 NO. OF STOREY : 1

STRUCTURE PROPOSED USE COVERED AREA GFA BUILDING HEIGHT

STRUCTURE	PROPOSED USE	COVERED AREA	GFA	BUILDING HEIGHT
B1	Reception Centre, Electric Meter Room, Aquaponics Reference, Fish&Farm tool storage, Green Houses	123.4m ² (ABOUT)	123.4m ² (ABOUT)	Not more than 7m high(1-STOREY)
TOTAL		123.4m²(ABOUT)	123.4m²(ABOUT)	

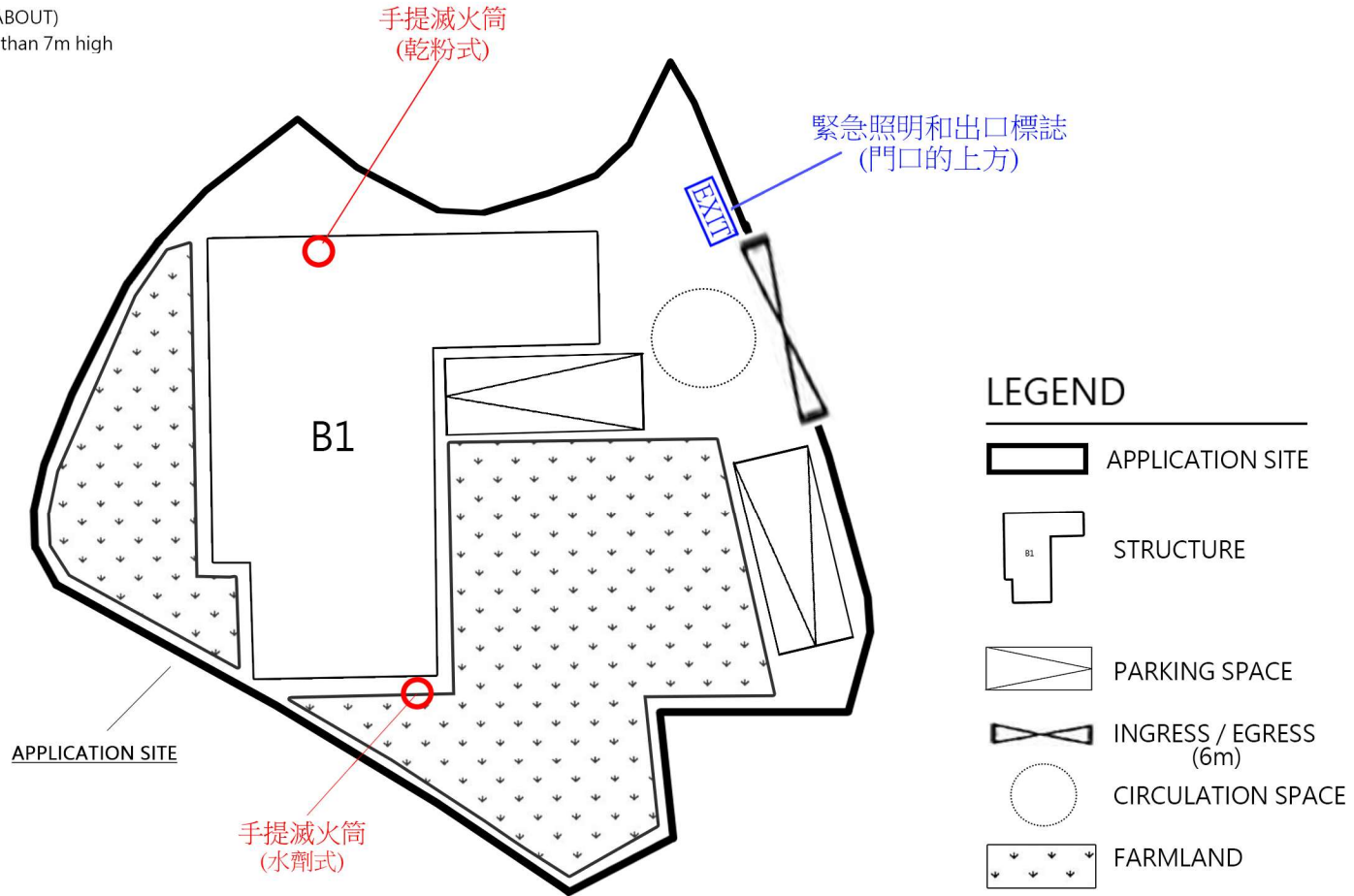
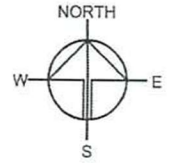

Drawing No. P02	Ver. 05
Project PROPOSED TEMPORARY PLACE OF RECREATION, SPORTS OR CULTURE (HOBBY FARM) FOR A PERIOD OF 3 YEARS	
LOT NOS. 1886 AND 1890RP IN D.D. 1, TUNG CHUNG, TUNG CHUNG ROAD, LANTAU ISLAND, NEW TERRITORIES	
Drawing Title LAYOUT PLAN	
Scale of A4	
Drawn	Date 08-07-2025
Revised	Date

渠務工程圖則

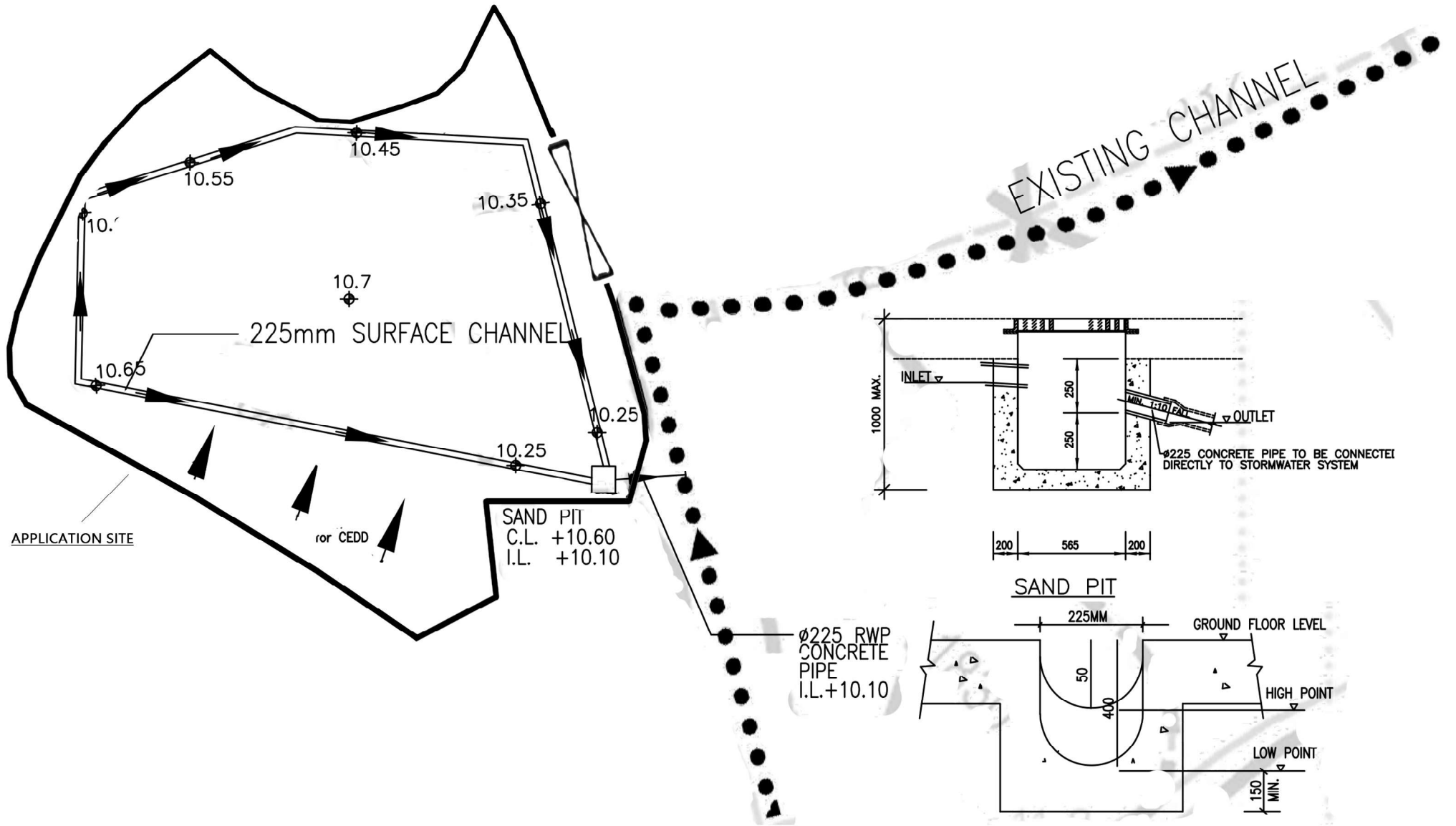

Location : TC Lot 1890RP & 1886 Pipe No. : _____

Refer to IOP Formula is

Reference

$$v = 8 Q / \sqrt{\Theta} D^2$$

where

Q = Flow Rate (l/min)

(Area x Precipitation)

$$= 320 \text{ sq. m } \times 200 \text{ mm/hr}$$

$$= 64 \text{ cu.m/hr}$$

$$= 1067 \text{ l/min}$$

D = Pipe Diameter (mm)

Θ = Defined in terms of the angle

$$= 2 \cos^{-1} ((1 - 2 d) / D)$$

d / D = Proportional depth of the flow (Say **1 / 5** full for pipe)

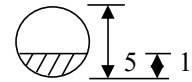

v = Velocity (Say **0.5** m/s Minimum self-cleansing velocity)

when

$$\Theta = 2 \cos^{-1} ((1 - 2 d) / D)$$

$$= 2 \cos^{-1} ((1 - 2 \times 1) / 5)$$

$$= 2 \cos^{-1} -0.20$$

$$= 3.54$$

Rain water connection pipe size is

$$v = 8 Q / \sqrt{\Theta} D^2$$

$$0.50 = 8533 / 1.883 D^2$$

$$1.883 D^2 = 8533.33 / 0.5$$

$$1.883 D^2 = 17066.67$$

$$D^2 = 17066.67 / 1.883$$

$$D^2 = 9065.32$$

$$D = 95.21 \text{ mm dia.}$$

$$\text{Say } = \mathbf{225} \text{ mm dia.}$$