

LEVEL 4 FLOOR PLAN

PART-PLAN (NOT TO SCALE)



SCHOOL NAME :

Up to U Education Centre (Kai Tak)

昇之堂教育中心 (啟德)

SCHOOL ADDRESS :

Shop M2-415, Level 4, Kai Tak Mall 2,

Kai Tak Sports Park,

Kai Tak, Kowloon City, Kowloon

九龍 九龍城 啟德 啟德體育園啟德零售館2，
4樓M2-415號舖

Authroized Agent :

IP lok Meng
IP lok Meng

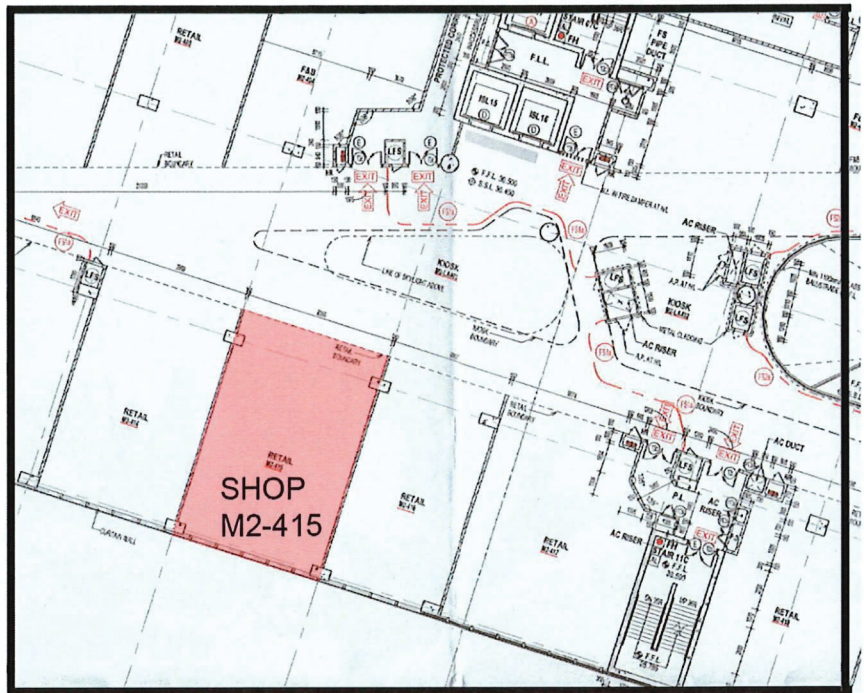

PROPOSED SCHOOL LAYOUT PLAN (SCALE - 1 : 100 @ A4 PAPER)



SHOPPING ARCADE CORRIDOR

SLIDE-FLOD SECURITY SHUTTER
SHALL BE FULLY OPEN DURING SCHOOL OPERATION HOURS

7380
EX. FIXED WINDOWS

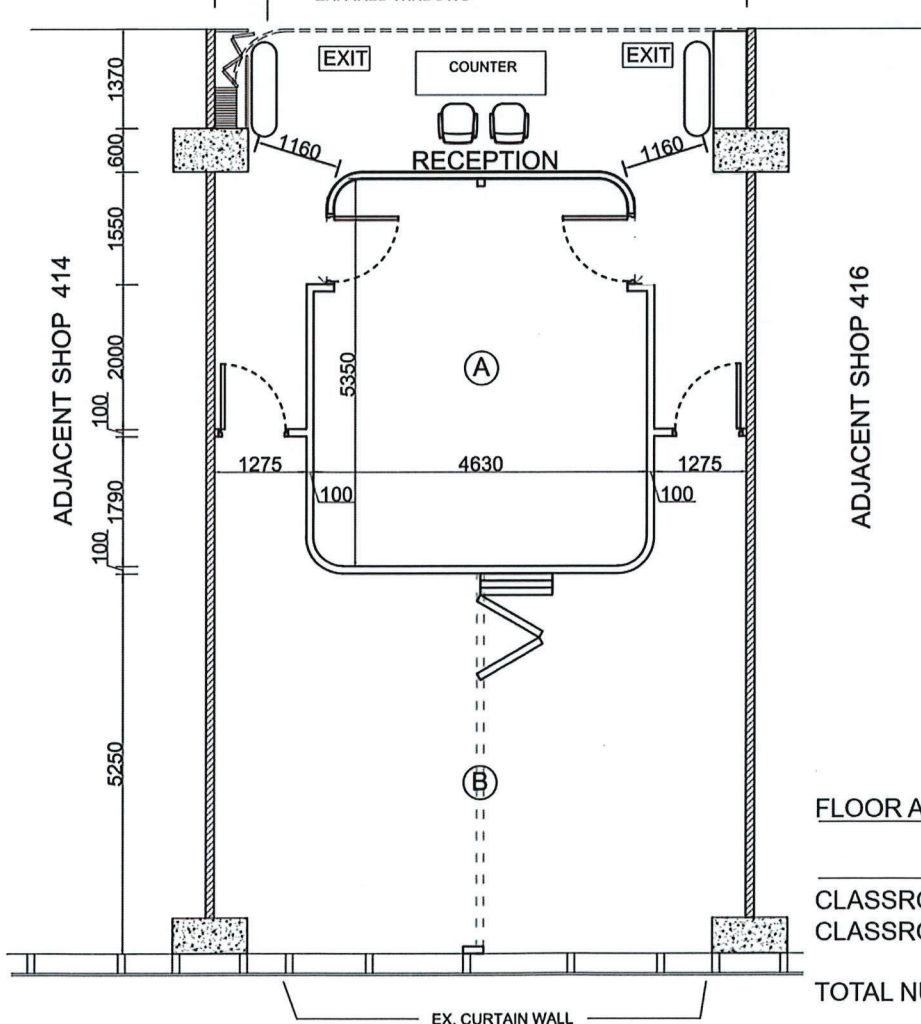

REMARKS :

- EXISTING CONCRETE WALL PARTITION / COLUMN (FULL HEIGHT)
- EXISTING SOLID BLOCK WALL PARTITION (FULL HEIGHT)
- LIGHT WEIGHT GYPSUM BOARD WALL PARTITION (ABOUT 80MM TH)
- NEW TIMBER DOOR WITH VISION PANEL UNLESS OTHERWISE STATED
- NEW METAL SLIDE-FOLD PARTITION
- NEW EMERGENCY LIGHTS ARE INSTALLED AT H/L WITH RECHARGEABLE BATTERY
- NEW CEILING-TYPE VISUAL FIRE ALARM
- NEW EXIT SIGN AT H/L WITH RECHARGEABLE BATTERY

FLOOR AREA OF THE PREMISES : 93.17 M2

| | AREA | STUDENTS | TEACHERS |
|---------------|----------|----------|----------|
| CLASSROOM A : | 23.73 M2 | 15 NOS. | 2 NOS. |
| CLASSROOM B : | 38.29 M2 | 31 NOS. | 2 NOS. |

TOTAL NUMBER OF POPULATION : 50 NOS. (MAX).

DRG.NO.: SK-01